

FINAL TRENCH REPORT: D900

Trench Supervisor: Kostas Chalikias (K-C)

Trench Assistants: Jessie Walker, Richard Parker, Brad Raveling, Katie Rayner, Alecia Wells

Trench Workmen: Vangelis Phiorakis, Stelios Koutsakis, Manolis Maniadakis, Vangelis Grammatikakis, Matina Papadaki

D900 is located north of **D500**, south of **D1000** and west of **D600**. Work in this area was completed from 14 June-04 July 2006. The benchmark used was **R25** (+357,111).

Excavation in trench **D900** was conducted to explore the area north of the Prytaneion.

Loci and Pail Descriptions:

Topsoil: D901.01-03

Slopewash/Erosion/Tumble: D901.05-09

Roofing clay/Tumble: D906.01-09

Hearth: D908.01-02

Altar: D907.01-04

Habitation debris: D909.01-04

Wall cleanings: D902.01, D903.01

Architectural Features:

D902: E-W wall in the north.

D903: N-S wall in the west.

D904: N-S wall in the southeast.

D905: E-W wall in the south.

D907: Altar in the middle of the room.

D908: hearth, built up against the north face of the altar.

Verbose Pail Descriptions:

Pails **D901.01-03** removed ~30cm of topsoil from the area north of the Prytaneion and exposed the wall D902. Pail **D901.05** exposed the wall tumble and uncovered the walls D904, D905 and D903. Pail **D901.06** removed tumble and slopewash and exposed the eroded bedrock west of D903. This pail also revealed two mill stones (obj.2,5) and figurines (obj.3,4). Pail **D901.07** removed roofing clay south of D903 and southwest of D907 and exposed the packing under the floor in the southwest corner of the room. This pail revealed a miniature pot (obj.6) and a fragmentary preserved bronze phiale (?) (obj.7). Pail **D901.08** removed ~10cm of tumble and roofing clay in the area east of D907 and produced a lot of bones and pumice. Pail **D901.09** removed ~10cm of roofing clay east of D907 and also removed some of the tumble in the NE corner of the room. Pail **D906.01** removed tumble and roofing clay in the south part of the room and defined the east limits of D907. This pail produced bones east of D907. Pail **D906.02** removed roofing clay east and northeast of D907. Pail **D906.03** removed some rocks from the

southeast corner of the room and exposed the roofing clay. Pail **D907.01** got more definition of the altar by cleaning the soil from the top. The altar-cleaning revealed a figurine-fragment (obj.1). Pail **D906.03** also exposed carbon and pumice between D904 and D907 and revealed a triton shell south of D907. Pail **D906.04** removed tumble north of D907. Pail **D906.05** removed tumble from the northwest and northeast corner of the room and exposed patches of roofing clay in the northeast corner. Pail **D907.02** removed tumble around the altar and exposed some figurines and a miniature pot (obj.2). Pail **D906.06** removed some roofing clay around D907. Pail **D907.03** was the cleaning of the altar. We took out 6 figurine-fragments (obj. 3,4,6,7,9,10), a miniature pot (obj.5) and a triton shell (obj.8). Pail **D906.07** removed ~10cm of roofing clay south of D907 and exposed ashy soil with carbon. This pail produced pumice and a head of a daedalic female figurine (obj.3), west of D907. This pail also revealed the hearth D908, north of D907. Pail **D906.08** defined the limits of the hearth, removed tumble north of D908 and roofing clay from the northeast corner of the room. This pail produced bones north of D908 and a modified sea pebble (obj.4). Pail **D908.01** was cleaning the topsoil from the hearth. Pail **D906.09** removed ~20-25cm (2 passes) of roofing clay from the northeast corner of the room and produced ashy soil with carbon. It also produced pumice, bones and a spindle whorl (obj.6). Pail **D903.01** removed tumble to define the north limits of D903 and the west limits of D902. This pass produced ashy soil and a goat horn among the bones. Pail **D902.01** defined the west limits of D902 and exposed a doorway or opening to D1001. Pail **D909.01** (habitation debris) removed thin patches of roofing clay and exposed the floor surface and eroded floor near D905. This pail produced pumice and bones. Pail **D909.02** removed the light yellow roofing clay around D907 where the floor is well preserved and near D904 where the floor is partially eroded. The soil produced pumice, bones and carbon. Pail **D909.03** exposed the foundations of D903, removed roofing clay northwest of D908, south of D907, between D907 and D904 and northeast of D908 and produced pumice and bones. It also revealed a bronze plaque (obj.1) northwest of D908 and near D903. Pail **D908.02** removed the soil from the hearth and produced some small pieces of wood charcoal. Pail **D909.04** removed some roofing clay from the northeast corner of the room, exposed the floor and produced some bones. Pail **D907.04** was cleaning of the altar during conservation.

Conclusions

Excavation in D900 revealed a shrine with an altar (D907) and a hearth (D908). D900 is an irregularly shaped room bounded in the south by wall D905, in the east by wall D904, in the north by wall D902 and in the west by wall D903. The room is 5,80m in length and max. 2,50 in depth (near D902). The best preserved wall is the north wall (D902) of which 3m of its length and 1,65m of its height survives. In general, the northern half of the room had more tumble than the rest of the room. Patches of roofing clay were mounted near the northeast corner and also near the southeast corner of the room. Excavation in this room didn't expose intense burning. The floor surface was of packed clay, which extends throughout the room. The floor is, for the most part, well preserved. Excavation in D900 revealed several figurines (geometric-archaic?), cult objects and a triton shell. Most of the finds were lying on the top of the altar (D907) or south of it. The cleaning of the hearth (D908) produced some bones. The area east of the altar and near the wall D904 was especially rich with bone material. There was also found pumice across the room. The shrine was probably connected by a doorway with the storage room D1000.

Year 2006 Trench/Locus D 900 Excavator K-C**Elevations**

Benchmark used:

Reading on

Benchmark:

H.I.:

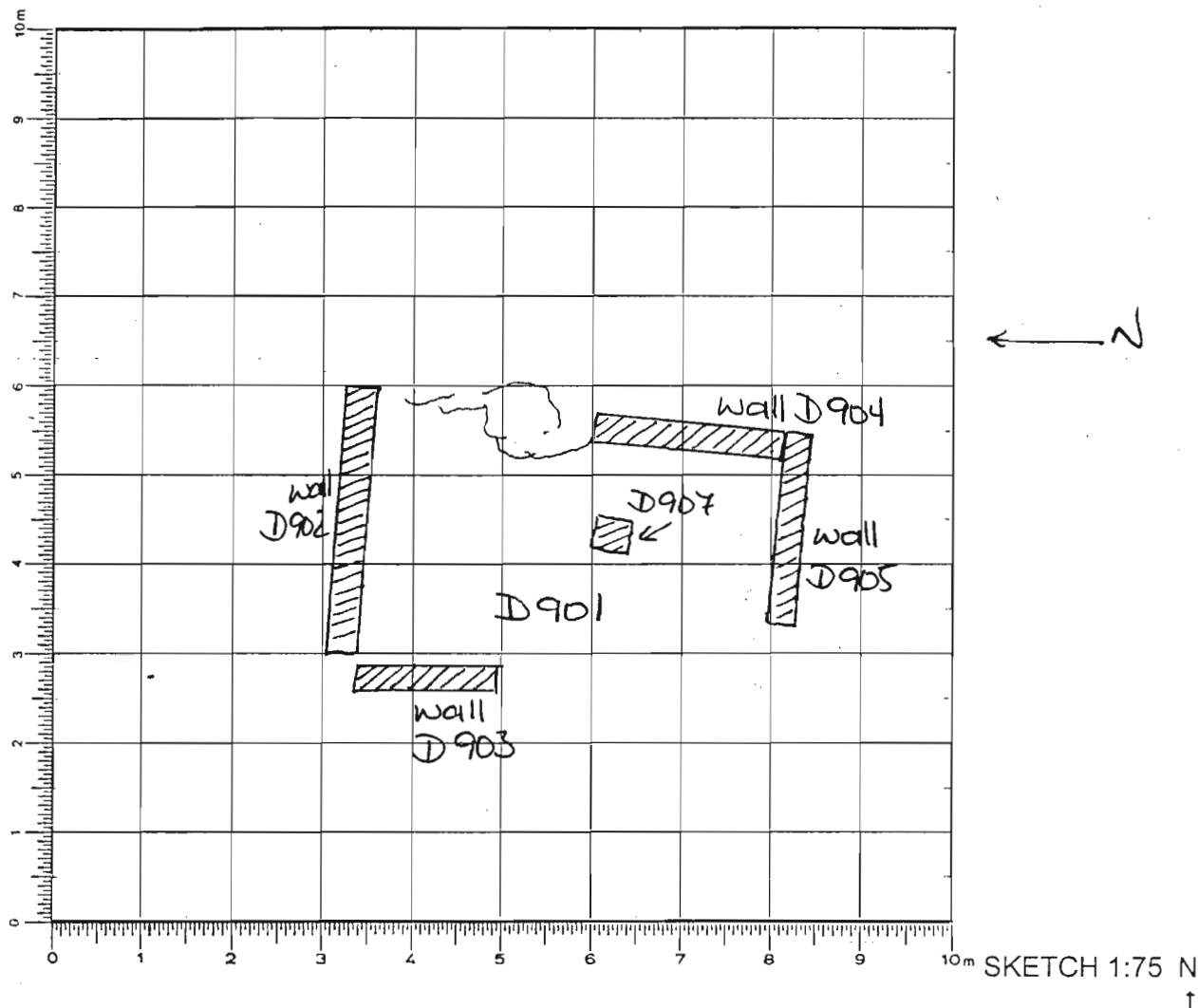

DEFINITION/DESCRIPTION of LOCUS (explain why you changed locus numbers):

Today's date: 14 JUNE Locus above: D 606Locus parameters: trench D 600 (modern terrace wall D606) in the east and D 500 in the southVerbal description: modern surface ~~excavated~~

• Locus Interpretative Comments (What do you think this is? DATE your comments, continue on additional pages if necessary):

Year 2006

Trench/Locus

D 904

Excavator

K-C

Locus/Pottery Pail Number	Weight of Sherds	Number of Sherds	Chronology & Comments
D 901.01	8,060 kg	124	Hell, LA, A, LG, LM III C.
D 901.02	3,190 kg	44	Early Modern, Hell, LA
D 901.03	2,980 kg	78	Early Modern, Hell, LA, LG, PG, LM III C
D 901.04	8,120 kg	65	Hell, Early 5 th , LA, LM III C.
D 901.05	1,310 kg	23	Hell, LA, LG?, LM III C
D 901.06	2,800 kg	66	LA, O, EO, LM III C?
D 901.07	3,330 kg	418	LA, A, O, EO, LG-EO
D 901.08	2,930 kg	212	LA, A, O, LM III C
D 901.09	2,780 kg	350	Early 5 th , LA, A, EO, LG-EO

OBJECTS

Object Number	Associated Pottery Pail	Identification (material/form)	Location	Elevation	Catalogue Number
01	J 901.02	stone tool	Surface collection		
02	D 901.06	mill stone	2. pass		
03	D 901.06	statuette	near the paved structure		
04	D 901.06	figurine ^{fragments}	" "		
05	D 901.06	mill stone	tumble		
06	D 901.07	miniature pot			
07	D 901.07	bronze object			
08					

ADDITIONAL COLLECTED MATERIAL

[illegible]

Year 2006 Trench/Locus D 901 Excavator K.C

DESCRIPTION of PROGRESS of EXCAVATION [date each entry and identify associated pottery pail(s)]: 14 JUNE 06 (p. pails: D 901.01/901.02)

We are "digging" the 1. pass of D 900 (modern surface) with kaswades. We already uncovered the foundations/ or bench of a building (civic building?).

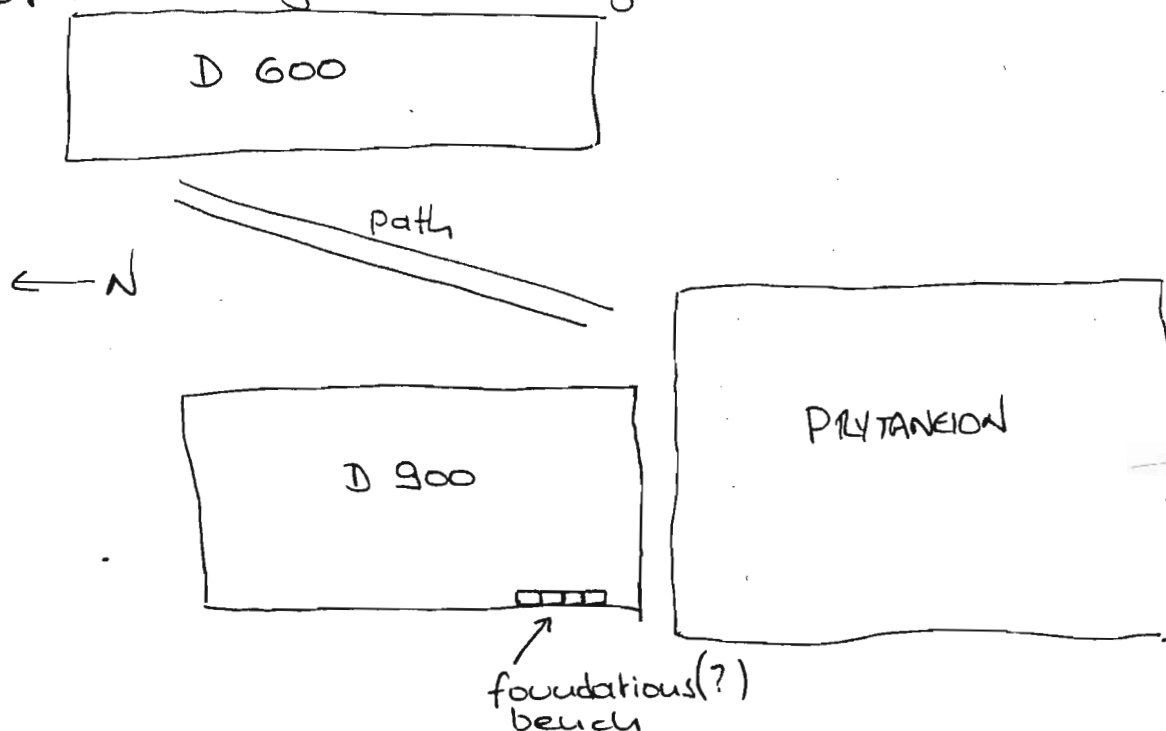

15. JUNE 06

We are continuing with the 1 pass of D 900 (p. pail: D 901.03 / S part of the trench, D 901.04 / N part of the trench)

We finished the 1. pass. We didn't find bones but found ² big iron-fragments (maybe from the bench D 600?).

We continued with a new p. pail (D. 901.05) in the S part of the trench. We are digging now the 2. pass of the "tumble" (frnjwba). We uncovered wall remains in the S and E of D 901.

The p. pails D. 901.03/04/05/ were finished and closed.

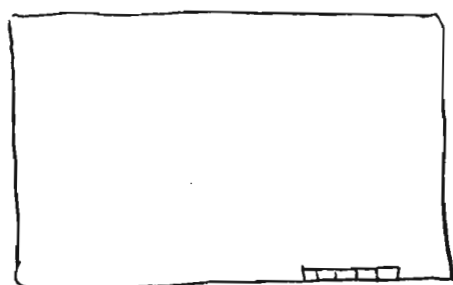

DESCRIPTION of PROGRESS of EXCAVATION [date each entry and identify associated pottery pail(s)]:

1: 0,623: 357,224
2: 1,03: 356,817
3: 1,125: 356,722
4: 2,78: 355,067
5: 2,575: 355,272
6: 2,29: 355,557
7: 2,05: 355,797
8: 2,45: 355,397
9: 2,32: 355,527

10: 2,575 : 355,272
11: 3,01 : 354,837
12: 3,56 : 354,287
13: 3,285 : 354,567
14: 2,84 : 355,007
15: 1,99 : 355,857
16: 1,61 : 356,237

17: 3, 17 : 354, 677
18: 3, 17 : 354, 677

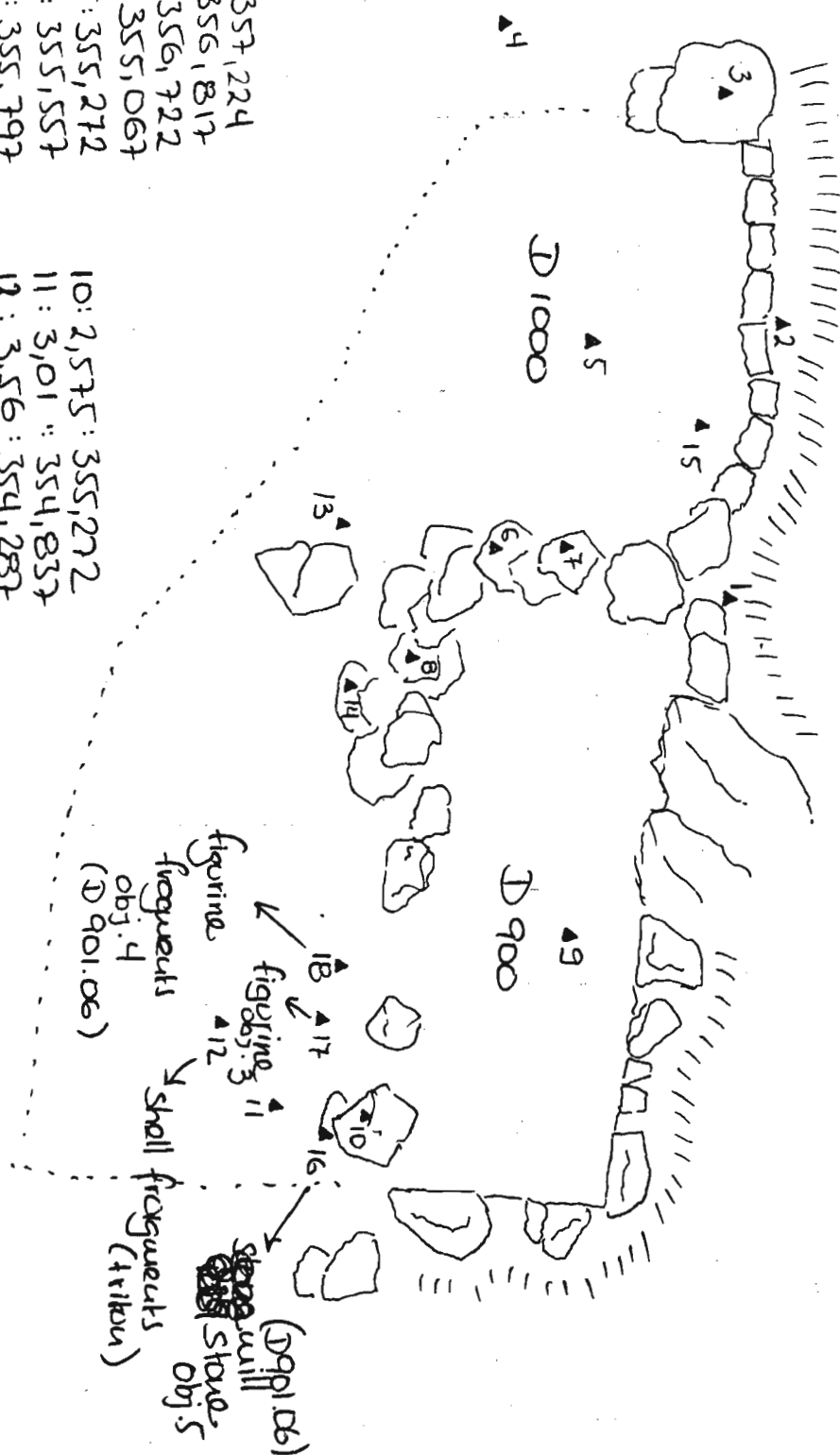

Bottom of ID 901.01-06.

R 25: 357, 111
Reading on B: 07736
H. 1: 357, 1847

Year 2006 Trench/Locus D 901 Excavator K-C

DESCRIPTION of PROGRESS of EXCAVATION [date each entry and identify associated pottery find(s)]: 16 JUNE 06

After digging the 2. passes of D 901 (p. find: D 901.01, 2, 3, 4, 5, 6, 7) we got more definition of the space/room in the SE corner of D 901. The room was filled (tumble) with big rocks from above. After 50-70 cm of digging we reached a layer filled with fine pottery (from screen), some figurine-fragments (terracotta), fragments of a bronze object, a miniature pot with carbonised material. Under this layer we found a surface with light yellow roofing clay and the remains of a paved structure.

North of the room D 901 the excavation uncovered the remains of a wall*, that separates the trench in two sections. We're gonna call the new section: trench D 1000. D 1000 was part of D 900 but after digging the first 2. passes and the expansion of so many walls, it is necessary to separate the section in two trenches.

We also found a course of big irregular boulders ^(D 903) west of D 901. We think that these rocks could be the foundation of the room D 901. In the N ~~and~~ part and NE corner of room D 901 we found a lot of rocks (tumble), probably from the collapsed wall D 902.

* called D 902

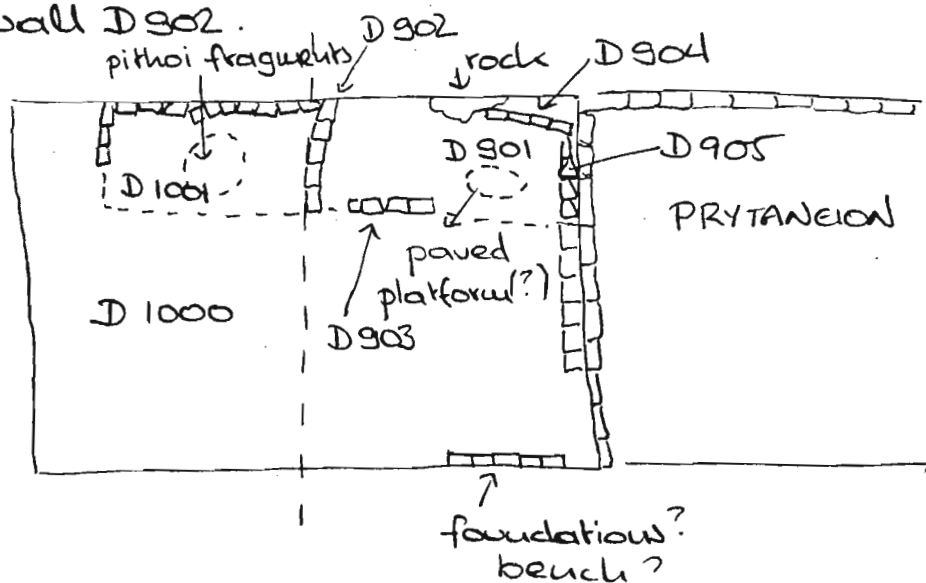

In the SE corner of D 901 we uncovered the well preserved remains of the E-wall of the room. It's called D 904.

The remains of the S-wall of D 901 (next to the Prytaneion) is called D 905.

DESCRIPTION of PROGRESS of EXCAVATION [date each entry and identify associated pottery pile(s)]:

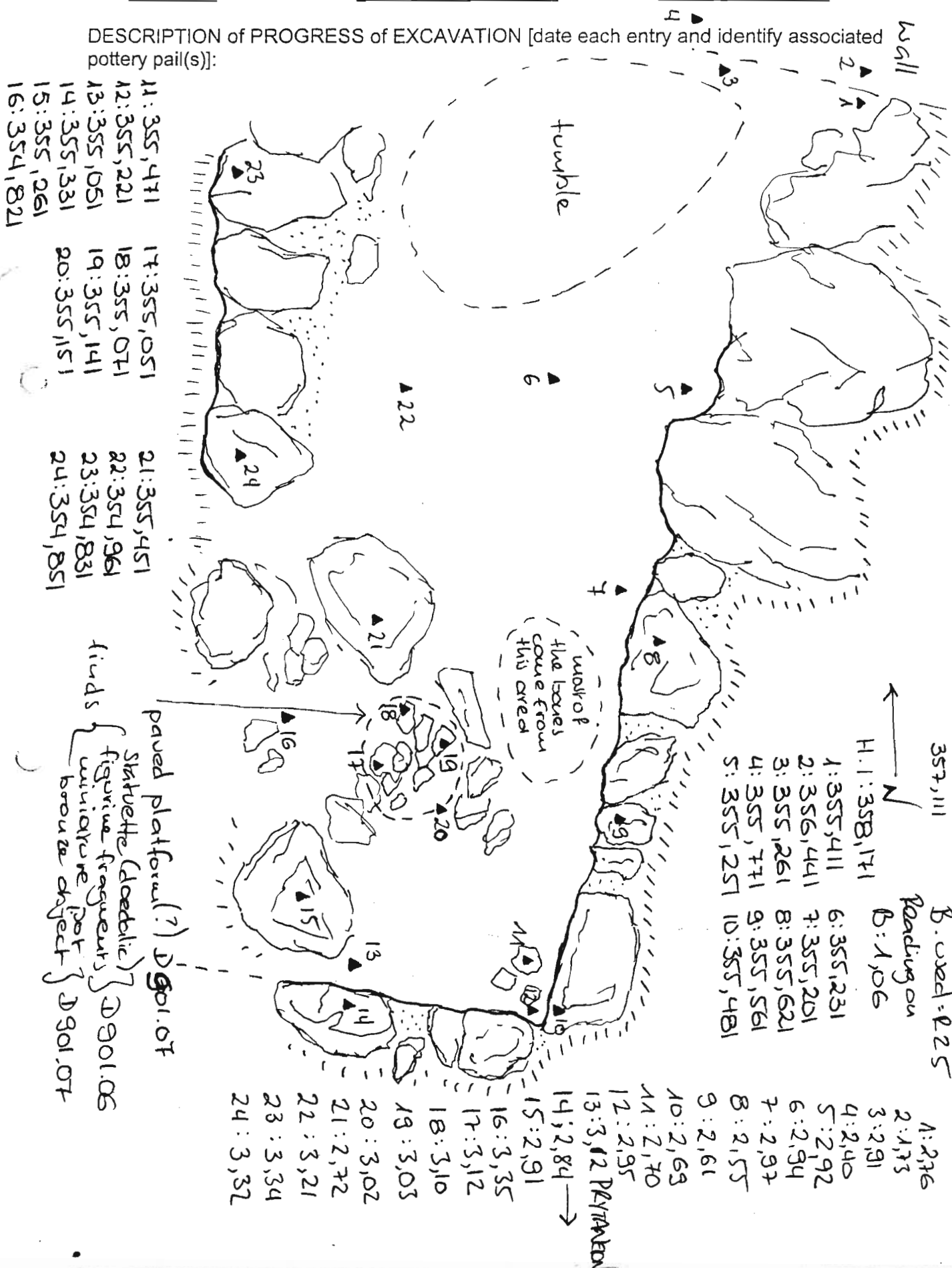

Year 2006 Trench/Locus D901 Excavator K-C

DESCRIPTION of PROGRESS of EXCAVATION [date each entry and identify associated pottery pail(s)]: 19 JUNE 06.

We started another pass (p. pail: D901.08) in the small area E of the paved area. ~~There~~ There is still no change in the matrix. We have a lot of bones (some big pieces) - see sketch plan and shells. We also found pumice. Under the surface we are digging are remains of roofing clay.

Pottery description: decorated pithoi sherds, amphora and oinochoe handles, ledge rimmed bowls, painted fine ware, base of a kaul, handle of a lekane.

(We took one standard soil sample. We are screening the dirt from this pass. P. pail D901.08 was finished and closed. We are continuing with p. pail D901.09. We didn't found bones. We had some pumice (from screen). We are still digging a small pass ~~E~~ E of the "paved structure". There is no change in the matrix. We removed the stone packing (collapsed wall D902) from the NE corner of D901, down to a depth of some 20-25 cm. We also removed some rocks E of the "paved structure". Unfortunately we didn't found anything. We screened more than 50 zembilia.

After finishing the pass we got more definition of the wall D902 and D904. D902 with 4 courses of irregular rocks leans to the S. It's best preserved near the NE corner of D901. In D904 we already uncovered two regular horizontal courses ~~with~~ of big rocks with NE → SW orientation. We still need more definition for D905 and D903.

The p. pail D901.09 was finished and closed.

Year 2006 Trench/Locus D 906 Excavator U-C**Elevations**

Benchmark used:

Reading on

Benchmark:

H.I.:

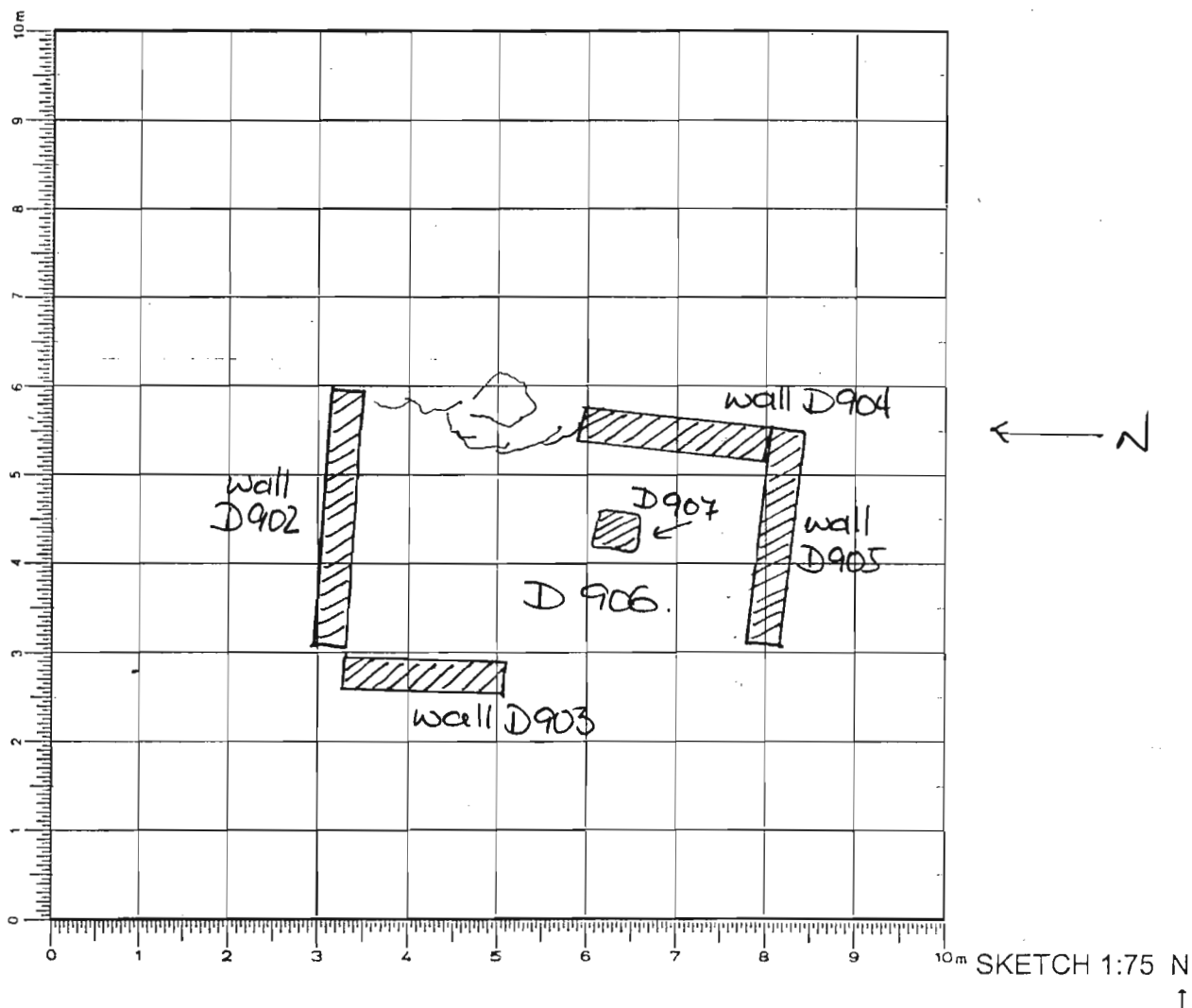

DEFINITION/DESCRIPTION of LOCUS (explain why you changed locus numbers):

Today's date: 20 JUNE 06 Locus above: D 906Locus parameters: D 902 in the N, D 904 in the E, D 905 in the S and D 903 in the W/roofing clayVerbal description: It's the tumble/surface in room D 901 in the same height as the paved feature D 907.

Locus Interpretative Comments (What do you think this is? DATE your comments, continue on additional pages if necessary):

AZORIA Project

p.2

Year 2006 Trench/Locus D 906 Excavator U-C

Locus/Pottery Pail Number	Weight of Sherds	Number of Sherds	Chronology & Comments
D 906.01	2,050 kg	308	LA, A, LG-EO
D 906.02	1,120 kg	185	Late Classical? LA, A, LG, PG, LM IIC
D 906.03	1,610 kg	292	LA, A, D, EO, LM IIC
D 906.04	2,420 kg	121	LA, A, O
D 906.05	1,620 kg	118	LA, A
D 906.06	0,235 kg	12	A
D 906.07	1,980 kg	118	LA, A, O, LM IIC
D 906.08	5,490 kg	374	LA, A, D, EO, LG(?), LM IIC
D 906.09	2,160 kg	165	LA, A, O, EO, LM IIC

OBJECTS

Object Number	Associated Pottery Pail	Identification (material/form)	Location	Elevation	Catalogue Number
1	D 906.01	figurine body			
2	D 906.03	fragment of mill stone			
3	D 906.07	figurine body			
4	D 906.08	sea pebble			
5	D 906.03	slag			
6	D 906.09	spindle whorl			

ADDITIONAL COLLECTED MATERIAL

Locus/Pottery Pail Number	Bones	Shell	Carbon	Pumice	Soil Sample	Other (specify)
D 906.01	1 + 1 screen			✓	2 intensive	
D 906.02	1 + 1 screen			✓		
D 906.03	1 + 1 screen		✓	✓	3 intensive + 1 standard	
D 906.04	1 + 1 screen			✓	1 intensive	
D 906.05	1 + 1 screen			✓	1 intensive	
D 906.07	1 + 1 screen	✓	✓	1 + 1 screen	8 intensive + 1 standard	
D 906.08	1 + 1 screen		2 boxes	1 + 1 screen	1 standard + 3 intensive	
D 906.09	1 + 1 screen	✓	1 box	1 + 1 screen	1 standard	

Year 2008 Trench/Locus D 906 Excavator K-C

DESCRIPTION of PROGRESS of EXCAVATION [date each entry and identify associated pottery pail(s)]: 20 JUNE 08

We gave D 901 a new locus nr. after digging the first 3 passes. It's called D 906 and the paved structure in the middle of it: D 907. We started with p.pail D 906.01. We already took 2 intensive soil samples. 1 ~~found here~~ E of D 907 and 1 N of D 907. The trouble is still continuing in this pass. We found some bones near the paved structure (D 907). Most of the bones came from the surface close to D 907*. We found the E part and the SE corner of the paved ~~feature~~ feature D 907. We screened 25 zembilia of D 906.01. We found pumice. D 906.01 was finished and closed. and bones.

We are continuing the pass with p.pail: D 906.02. We found some bones. There is still no change in the matrix. We have yellow brown soil with small inclusions. We took a standard soil sample. We didn't finished the pass. The p.pail D 906.02 was finished and closed.

Measurements:

Wall D 902 : length: 3 m / height: 1,10 (in the E corner), 0,50 m (in the S corner) / width: 0,50 m

D 903 : length: 1,85 m / height: 0,35 / width: 0,50 - 0,55 m.

D 904 : length: 2,10 m / height: 0,60 m / width: 0,35 - 0,40 m

D 905 : length: 1,70 m / height: 0,55 m / width: 0,40 - 0,45 m
↓
in the SE corner.

* Among them a boar tusk.

Year 2006 Trench/Locus D 906 Excavator K-C.

DESCRIPTION of PROGRESS of EXCAVATION [date each entry and identify associated pottery pail(s)]: 21 JUNE 06

We finished the pass (p.pails: D 906.01/02) but left some rocks in the NE corner of D 906. The rocks could be part of a bench(?). We started with a new pass (p.pail: D 906.03). We are digging to a depth of some 20 cm and removing the rocks ^(+tumble) from the SE corner of the room. There is no change in the matrix. We have the remains of roofing clay preserved in the SE corner of the room. We got more definition of D 907 by cleaning the surface near this paved feature*. We already took 4 intensive soil ^(D 906.03 / D 907.01) samples from the top, S, E, N of D 907. After cleaning the soil from the top of D 907 we found a figurine fragment ^(D 907.01) (PG?). The other fragment of the figurine is still in situ. Between D 904 and D 907 we found a lot of carbon. We are screening the dirt. We found some pumice. S of D 907 we found a big shell (still in situ). NE of D 907 the soil is full with carbonised material. We got more definition of D 904. The wall blocks include large rocks and boulder-sized stones, probably of local dolomite and limestone. The boulders were bonded by mud mortar. N of D 907 we used the kasma to remove the tumble and get more definition of D 902 and the NE corner of the room (bench?). We continued with p.pail D 906.04. We took 1 intensive soil sample N of D 907. It's soil with carbonised material. We still don't have a clear definition for the NE corner of the room. We found some pumice in the screen from D 906.04. We still don't have the NW and NE limits of D 907. The rocks we uncovered, probably smashed the N part of the paved feature D 907. We expect more definition in the next pass. The p.pail D 906.04 was finished and closed.

* We started in the new locus with p.pail: D 907.01. The pail was finished and closed.

DESCRIPTION of PROGRESS of EXCAVATION [date each entry and identify associated pottery pail(s)]: 21. JUNE 06. After p. pail: D 906. 01/02/03/04.

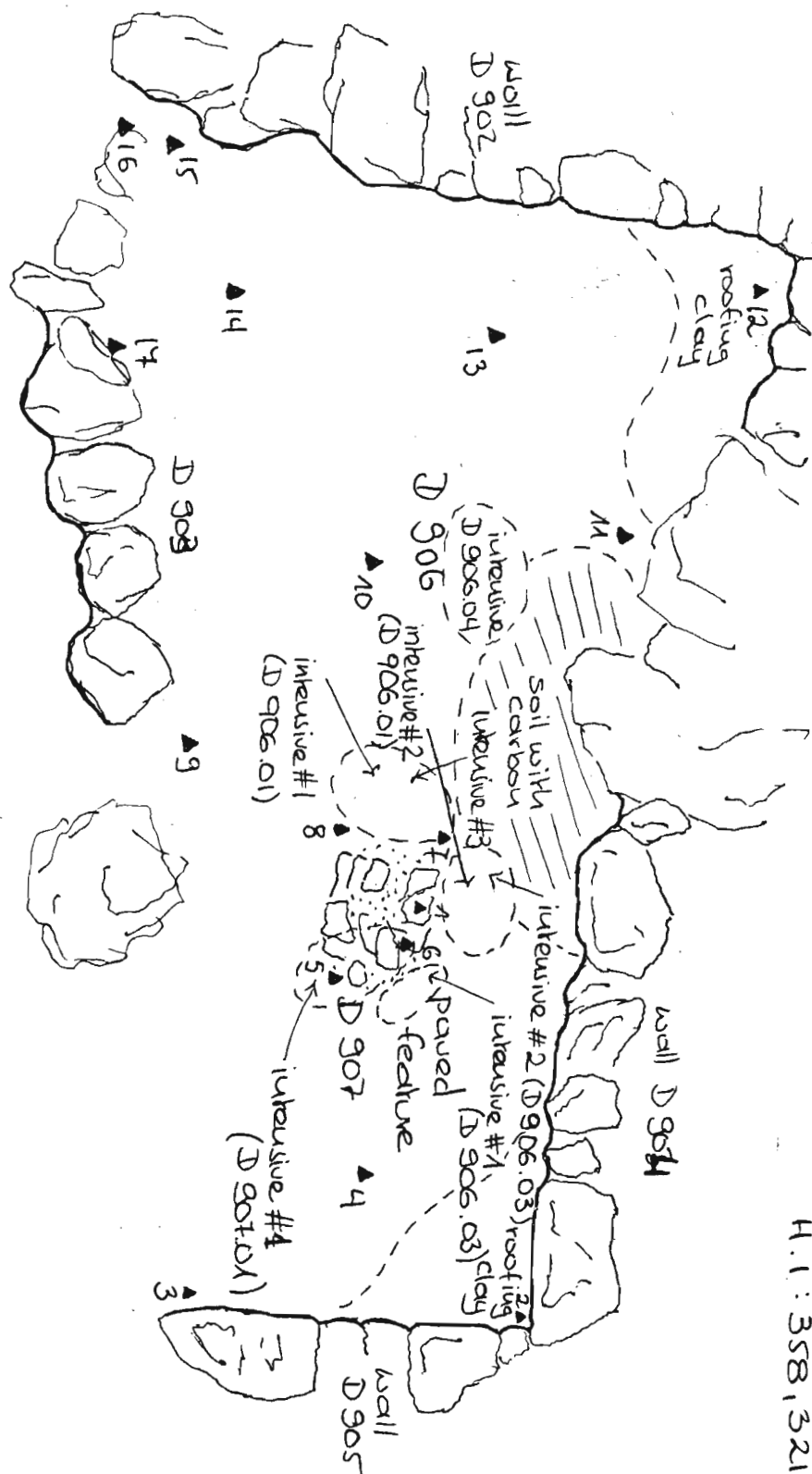

Feeding on B: 1, 2, 3
R 25: 357, 111
H. 1: 358, 321

1 (figure D 307.01): ~~2000~~ 3,15
Object 1

- $$\begin{array}{l} 2:3,33 \\ 3:3,38 \\ 4:3,41 \\ 5:3,32 \\ 6:3,16 \end{array}$$

10. 7 3 4 5 6 7 8 9 10 11 12 13 14 15 16 17 18 19 20 21 22 23 24 25 26 27 28 29 30 31 32 33 34 35 36 37 38 39 40 41 42 43 44 45 46 47 48 49 50 51 52 53 54 55 56 57 58 59 60 61 62 63 64 65 66 67 68 69 70 71 72 73 74 75 76 77 78 79 80 81 82 83 84 85 86 87 88 89 90 91 92 93 94 95 96 97 98 99 100

- 11: 3, 04
12: 3, 02
13: 3, 26
14: 2, 59
15: 3, 42
16: 3, 42
17: 3, 32

- 1: 355, 171
2: 354, 931
3: 354, 941
4: 354, 911
5: 355, 001
6: 355, 161
7: 355, 091
8: 354, 941
9: 354, 841

- 10 : 355,021
11 : 355,251
12 : 355,301
13 : 355,061
14 : 355,731
15 : 354,901
16 : 355,201
17 : 355,001

Year 2006 Trench/Locus D 906 Excavator UK-C

DESCRIPTION of PROGRESS of EXCAVATION [date each entry and identify associated pottery pail(s)]: 22 JUNE 06.

We started with p.pail D 906.05. We removed some rocks from the tumble in the NW corner of the room. We took 1 intensive soil sample. We also took some rocks from the NE corner of the room (we thought it could be a bench) and exposed the roofing clay, that lies higher, because it was protected by the wall. We still need more definition for the NW corner of the room*. The tumble is going deeper there. The p.pail D 906.05 was finished and closed. We had 1 bone bag + 1 ^{from the} screen. Pumice was found too (screen). We screened over 20 zembilia.

Start of a new p.pail: D 907.02. We are ^{removing} taking the rocks around the paved feature D 907 to get more definition for D 907. We took 7 intensive soil samples. One of the samples came from the clearing of the top of the construction. ~~By~~ ^{By} cleaning the rocks of D 907 we uncovered at least three figurine fragments and a miniature pot. Most of the soil from D 907 had carbonized material.

D 907 was probably a paved platform/altar with rectangular shape. ~~Most of the preserved parts~~ The N part of D 907 is better preserved and was built ^{durable + iron stone} with flat schist stones. There are at least 3 ^{horizontal} courses of flat stones with ~~and~~ ^{clay} mortar (?) between them. The limits of D 907 in the S have not yet been defined. Most of the material (offerings?) from the altar lies probably under a deep layer of roofing clay. We're gonna find out the next days. The p.pail D 907.02 was finished and closed. The room is 5,80m in length and max. 2,50 in depth.

* The limits of D 902 and D 903 in the NW corner of the room ~~have~~ ^{have} not yet been defined.

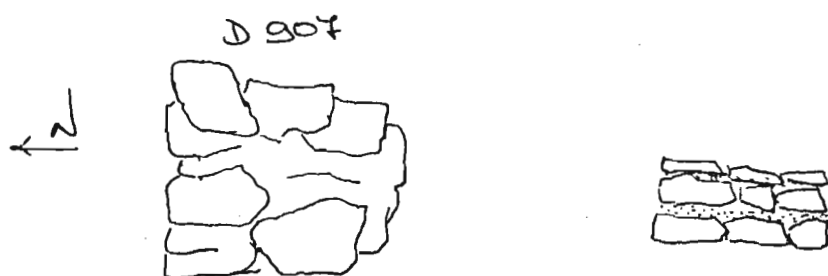

Year 2006 Trench/Locus D 906/903 Excavator L-C

DESCRIPTION of PROGRESS of EXCAVATION [date each entry and identify associated pottery pail(s)]:

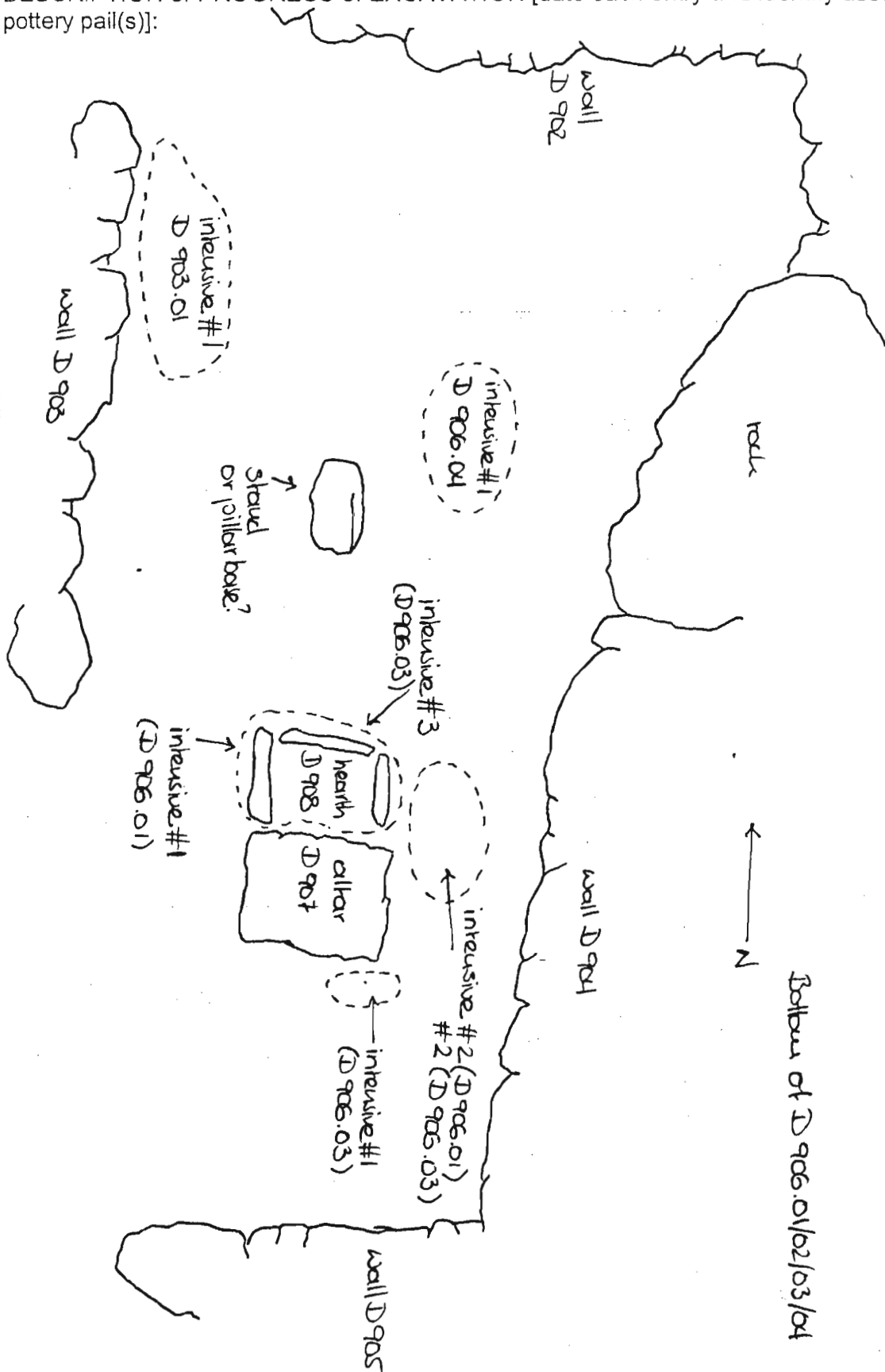

Year 2006 Trench/Locus D 906 Excavator K-C

DESCRIPTION of PROGRESS of EXCAVATION [date each entry and identify associated pottery pail(s)]: 24 JUNE 06.

We are digging into the roofing clay (new pass), starting from the SW part of the room with p.pail D 906.07. The soil is hard packed with small inclusions, ash and pieces of carbon. We took 1 standard s. sample and 8 intensive soil samples from the SE corner of the room (where we found two big pieces of charcoal), S of D 907, W of D 907, E, ~~and~~ N and NE of D 907. W of D 907 we found the body with the head of a daedalic female figurine (D 906.07, obj. 3). Over 20 zembilia of dirt where screened. We found pottery, bones and pumice. Pumice came from D 906.07 but also from the screen. Among the finds were some sea-shells. The excavation revealed the 4. course of horizontal flat stones of the N-face of D 907. Before we finished the pail D 906.07, two flat stones were uncovered directly N of D 907. Between these two stones we found ashy soil. Maybe we found the remains of a hearth. The p.pail D 906.07 was finished and closed. We didn't finish the pass.

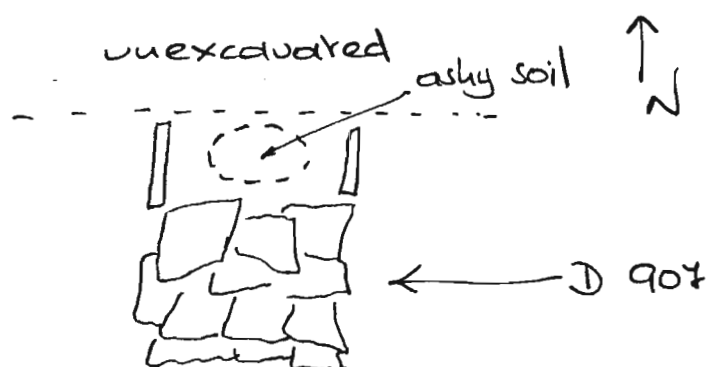

Year 2006 Trench/Locus D 906 Excavator K-C

DESCRIPTION of PROGRESS of EXCAVATION [date each entry and identify associated pottery pail(s)]: 28 JUNE 06.

We are continuing the pass from 27 JUNE. P. pail: D 906.08.
 We found the closing ~~of the~~ of the structure (hearth?) north of D 907. It's called D 908. The "hearth" is built up against the paved feature D 907 and is bordered by three large flat stones. We took 1 intensive s. sample from D 908 ^(p. pail: D 908.01) after cleaning the construction. The soil ~~was~~ in and close to D 908 is very ashy with some pieces of carbon. We took a sample of carbon from D 908 ^(D 908.01) and a sample from D 906 (D 906.08).
 We took 1 standard and 3 intensive s. samples (N, NE of D 908) from D 906.08. All the dirt was screened (over 30 zumbidia). We found a lot of pumice (1 + 1 bag from the screen).
 Comparing to the last days we found more pottery. Mainly pithoi ~~and~~ sherds and painted fine ware. We found a modified sea pebble (obj. 4, D 906.08). We found some bones, mainly from the area N of D 908. N of D 908 we were digging into a layer with big rocks. Many of these rocks, probably from a collapsed wall, damaged the floor. Near the tumble we were cleaning D 903 to get more definition of the wall construction. In the NE corner we were digging into the roofing clay, which lies higher than other patches of sealing clay in the room. The soil (except the dirt from the tumble) is ^{light} yellow and hard packed with small inclusions, pieces of carbon and ash. The p. pail D 906.08 was finished and closed.

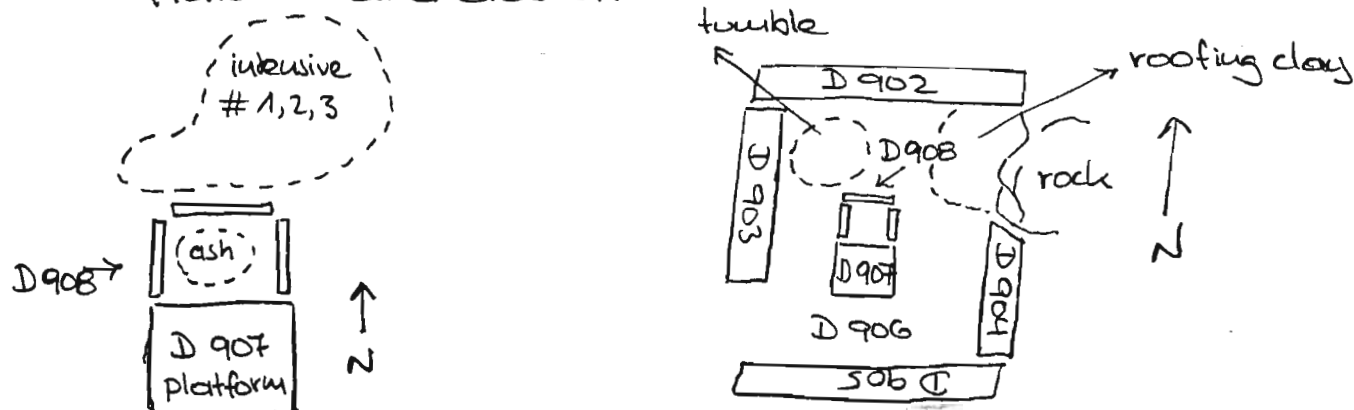

Year 2006 Trench/Locus D 906 Excavator K-C.

DESCRIPTION of PROGRESS of EXCAVATION [date each entry and identify associated pottery pail(s)]: 29 JUNE 06. (p. pail : D 906.09)

We finished the pass from the 27 JUNE. We took 2 small pails from the NE corner of the room. It's the roofing debris, that lies higher in this part of the room. We took 1 standard soil sample. The soil is still hard packed with small inclusions, light yellow with pieces of carbon and ash. We found near the NE corner a spindle whorl (obj. 6). We found a lot of pottery from the NE corner, mainly pithoi fragments and painted fine ware. We had pumice, some big pieces, found also near the NE corner of the room. Pumice came from the screen too. We also had a sea shell among the finds. After cleaning the trench we took elevations. The p. pail D 906.09 was finished and closed.

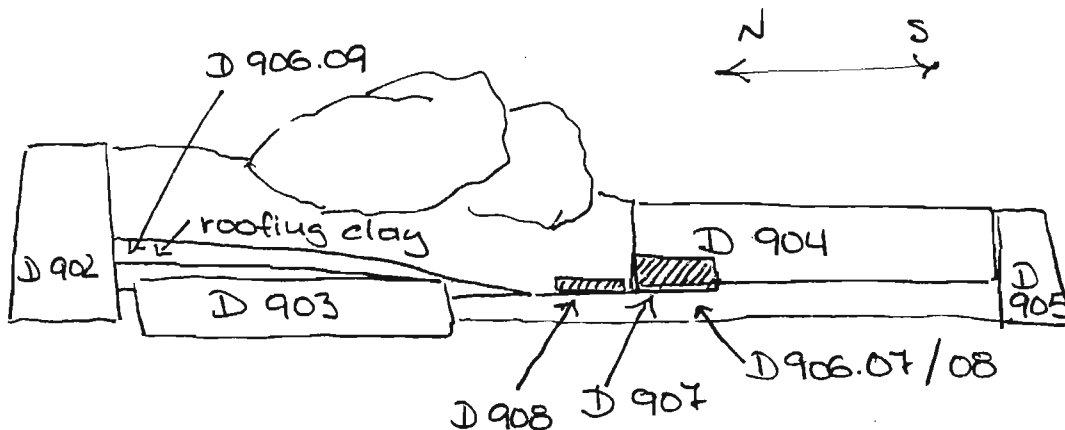

Year 2006 Trench/Locus D 906 Excavator K-C

DESCRIPTION of PROGRESS of EXCAVATION [date each entry and identify associated pottery (all(s))]:

29 JUNE 06

1: 355,411
2: 355,431
3: 354,881
4: 355,141

5: 355,031
6: 354,741
7: 354,301
8: 354,841
9: 354,681
10: 354,791
11: 354,781
12: 354,851
13: 354,851
14: 354,881
15: 354,831
16: 354,811
17: 354,881

18: 355,111
19: 354,137
20: 358,481

← N

1: 3,07
2: 3,05
3: 3,60
4: 3,34
5: 3,45
6: 3,71
7: 3,58
8: 3,64
9: 3,80
10: 3,69
11: 3,70
12: 3,63
13: 3,63
14: 3,60
15: 3,65
16: 3,67
17: 3,60
18: 3,69: 354,791
19: 3,69: 354,791
20: 3,73: 354,751
21: 3,63: 354,851
22: 3,60: 354,881
23: 3,65: 354,831
24: 3,46: 355,021
25: 3,58: 354,901
26: 3,70: 354,781
27: 2,71: 355,544
28: 2,56: 355,491

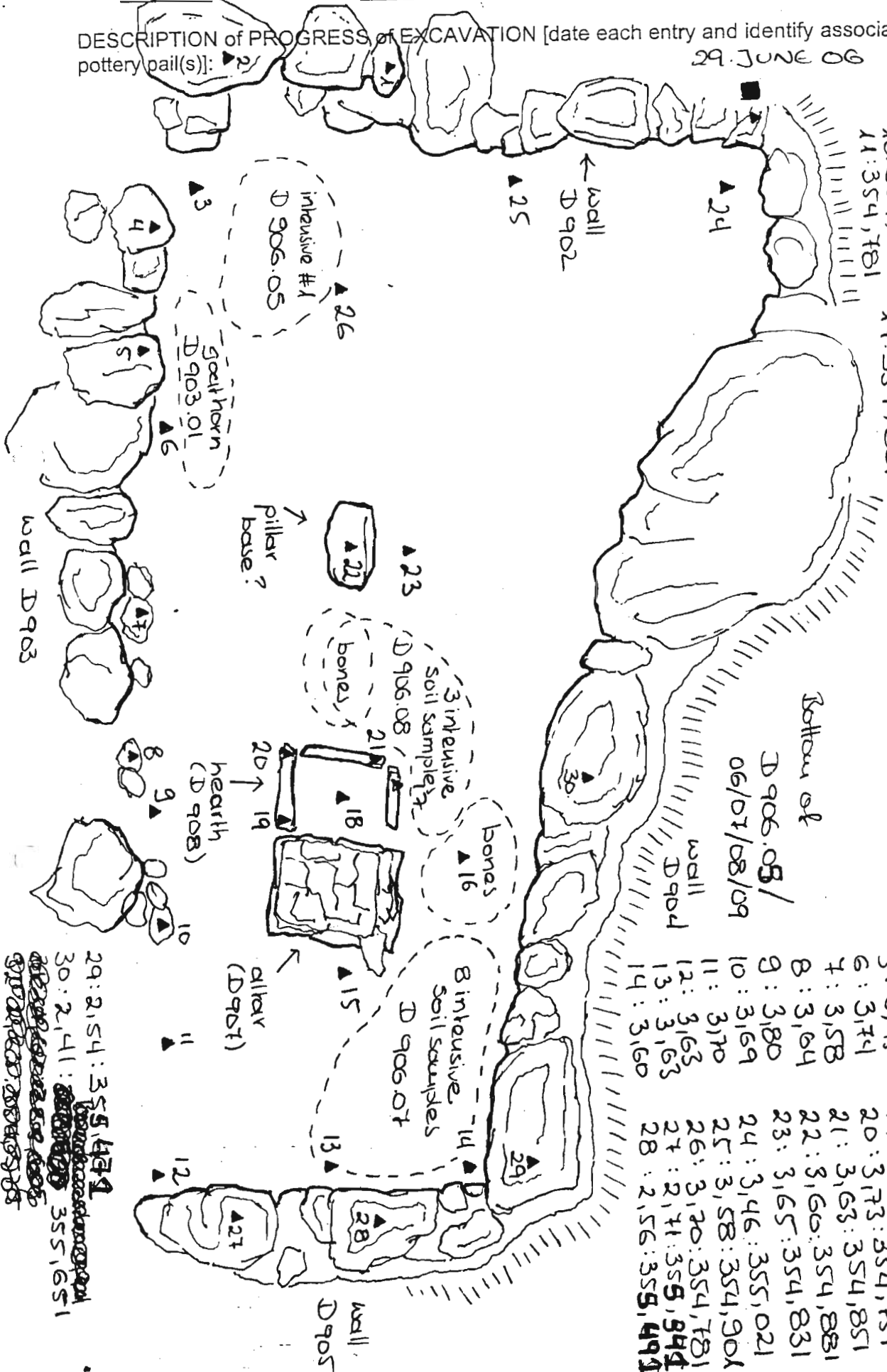

29: 2,54: 355,431
30: 2,41: 355,651
31: 2,41: 355,651
32: 2,41: 355,651
33: 2,41: 355,651
34: 2,41: 355,651
35: 2,41: 355,651
36: 2,41: 355,651
37: 2,41: 355,651
38: 2,41: 355,651
39: 2,41: 355,651
40: 2,41: 355,651
41: 2,41: 355,651
42: 2,41: 355,651
43: 2,41: 355,651
44: 2,41: 355,651
45: 2,41: 355,651
46: 2,41: 355,651
47: 2,41: 355,651
48: 2,41: 355,651
49: 2,41: 355,651
50: 2,41: 355,651
51: 2,41: 355,651
52: 2,41: 355,651
53: 2,41: 355,651
54: 2,41: 355,651
55: 2,41: 355,651
56: 2,41: 355,651
57: 2,41: 355,651
58: 2,41: 355,651
59: 2,41: 355,651
60: 2,41: 355,651
61: 2,41: 355,651
62: 2,41: 355,651
63: 2,41: 355,651
64: 2,41: 355,651
65: 2,41: 355,651
66: 2,41: 355,651
67: 2,41: 355,651
68: 2,41: 355,651
69: 2,41: 355,651
70: 2,41: 355,651
71: 2,41: 355,651
72: 2,41: 355,651
73: 2,41: 355,651
74: 2,41: 355,651
75: 2,41: 355,651
76: 2,41: 355,651
77: 2,41: 355,651
78: 2,41: 355,651
79: 2,41: 355,651
80: 2,41: 355,651
81: 2,41: 355,651
82: 2,41: 355,651
83: 2,41: 355,651
84: 2,41: 355,651
85: 2,41: 355,651
86: 2,41: 355,651
87: 2,41: 355,651
88: 2,41: 355,651
89: 2,41: 355,651
90: 2,41: 355,651
91: 2,41: 355,651
92: 2,41: 355,651
93: 2,41: 355,651
94: 2,41: 355,651
95: 2,41: 355,651
96: 2,41: 355,651
97: 2,41: 355,651
98: 2,41: 355,651
99: 2,41: 355,651
100: 2,41: 355,651

Year 2006 Trench/Locus D 901 Excavator K-C**Elevations**

Benchmark used:

Reading on

Benchmark: R 25

H.I.:

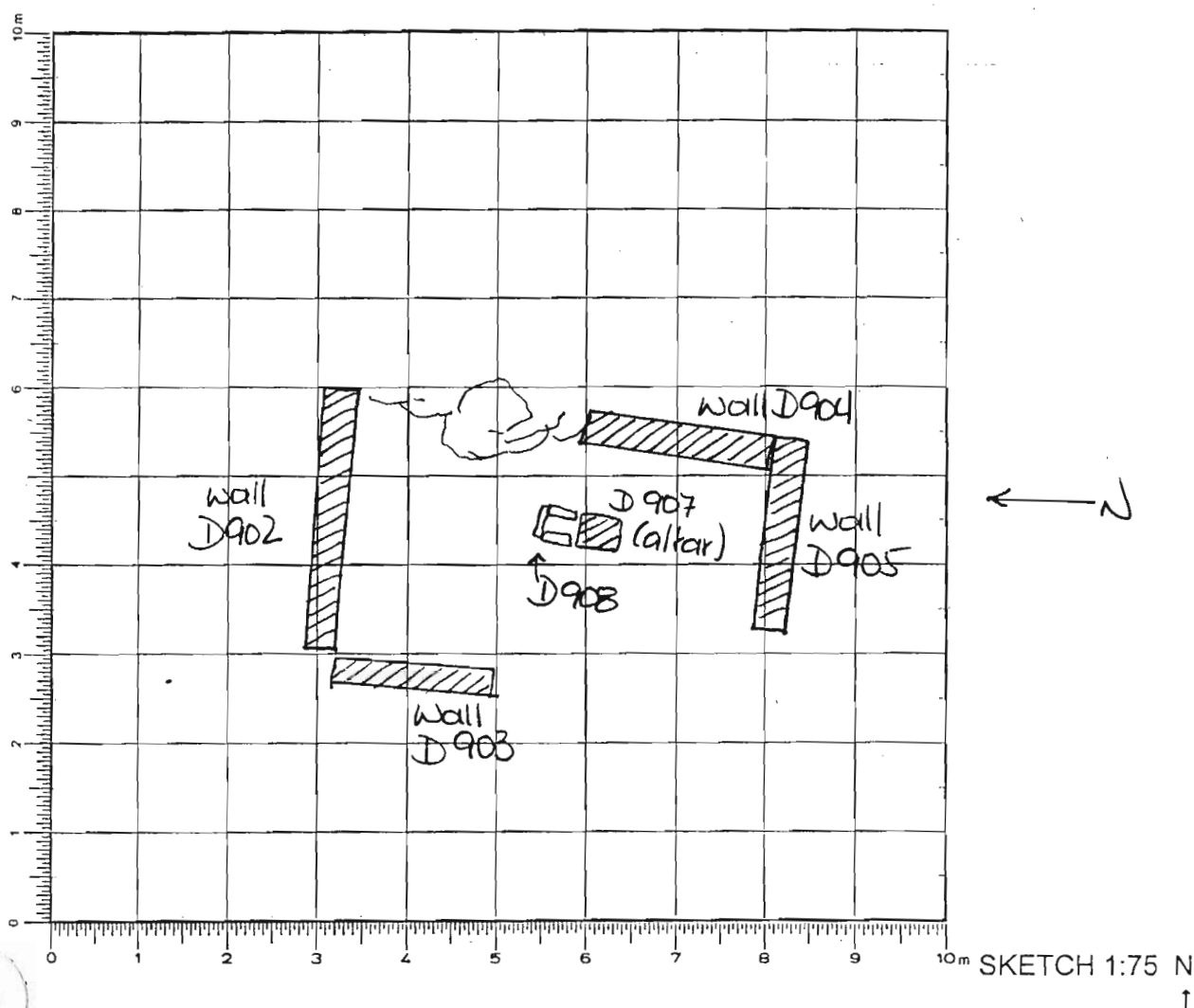
DEFINITION/DESCRIPTION of LOCUS (explain **why** you changed locus numbers):Today's date: 21. JUNE 06 Locus above: D 901Locus parameters: D 902 in the N, D 903 in the W, D 905 in the S.

Verbal description: D 907 is an altar with rectangular shape. The feature was built with flat schist, dolomite and sideropetres stones. There are at least 4 horizontal courses of ~~flat~~ flat stones in each side, bounded with clay.

Locus Interpretative Comments (What do you think this is? DATE your comments, continue on additional pages if necessary):

[illegible]

Object Number	Associated Pottery Pail	Identification (material/form)	Location	Elevation	Catalogue Number
1	D 907.01	figurine fragment			
2	D 907.02	handle of min. pot			
3	D 907.03	figurine fragment			
4	D 907.03	" "			
5	" "	miniature pot			
6	" "	figurine body			
7	" "	" " fragment			
8	" "	shell			
9	" "	female figurine			

figure frequent

[illegible]

Year 2006 Trench/Locus D907 Excavator U-C

DESCRIPTION of PROGRESS of EXCAVATION [date each entry and identify associated pottery pail(s)]: 21. JUNE 06 Pail D907.01

We got more definition of D907 by cleaning the surface near this paved feature. Pail D907.01 was finished and closed.

22. JUNE 06. Pail D907.02.

We are removing the rocks around the paved feature D907 to get more definition of the structure. We took 7 intensive soil samples. One of the samples came from the cleaning of the top of the construction. By cleaning the rocks of D907 we uncovered at least three figurine fragments and a miniature pot. Most of the soil from D907 had carbonized material. Pail D907.02 was finished and closed.

Year 2006 Trench/Locus D 907 Excavator K-C.DESCRIPTION of PROGRESS of EXCAVATION [date each entry and identify associated pottery find(s)]: 21. JUNE 06

paved structure : D 907

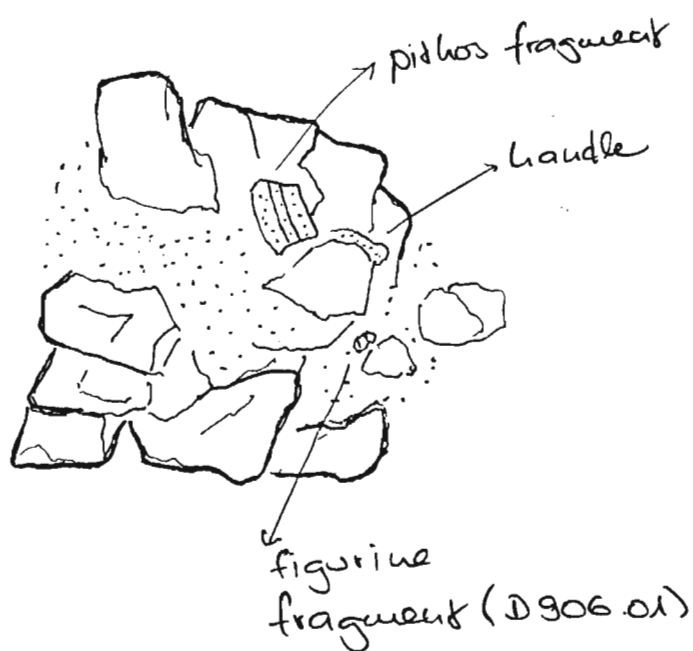
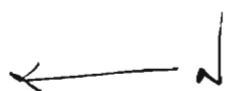

Year 2006 Trench/Locus D 907 Excavator V-C

DESCRIPTION of PROGRESS of EXCAVATION [date each entry and identify associated pottery pail(s)]: 23 JUNE 06

1: 355,131
2: 355,061
3: 355,111
4: 355,221
5: 355,241

6: 355,091
7: 355,171
8: 355,141
9: 355,051
10: 355,041
11: 354,981

R: 25: 357,111

Reading on B: 1,13

H.1: 358,241

← N

D 907.03

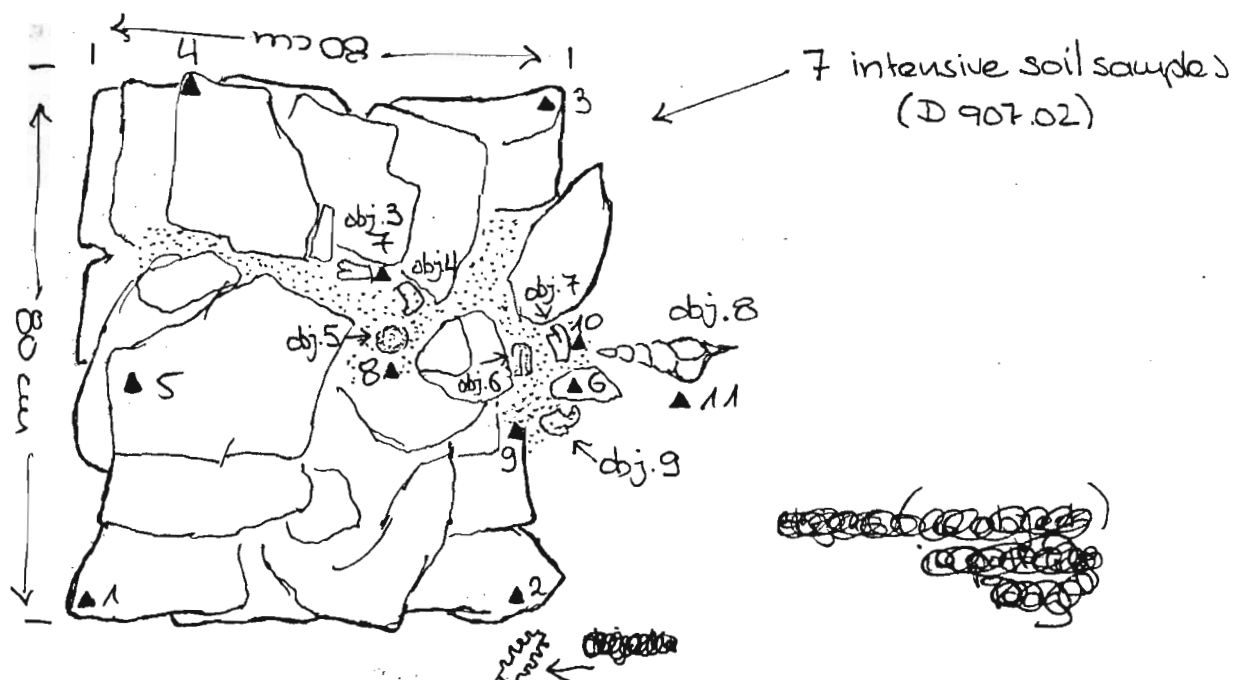

1: 3,11 5: 3,40 9: 3,19
2: 3,18 6: 3,15 10: 3,20
3: 3,13 7: 3,07 11: 3,26
4: 3,02 8: 3,10

Year 2006 Trench/Locus D 907 Excavator L-C.DESCRIPTION of PROGRESS of EXCAVATION [date each entry and identify associated pottery pail(s)]: 23 JUNE 06.P. pail: D 907.03.

After taking elevations, Rod drew the platform. Then we cleared the top soil from D 907. The dirt was bagged as intensive soil sample. We also took all the small finds from the paved feature. For the pottery recovered near D 907 we had a new p. pail: D 906.06.

Finds: D 907.03

- obj. 3 : figurine fragment
- 4 : -- -- (animal)
- 5 : miniature pot
- 6 : figurine body (cylindrical)
- 7 : figurine fragment
- 8 : triton shell
- 9 : female figurine
- 10 : figurine fragment

P. pails D 907.03 and D 906.06 were finished and closed.

AZORIA Project

p. _____

Year 2006 Trench/Locus D 907 / 908 Excavator K-C

DESCRIPTION of PROGRESS of EXCAVATION [date each entry and identify associated pottery pail(s)]:

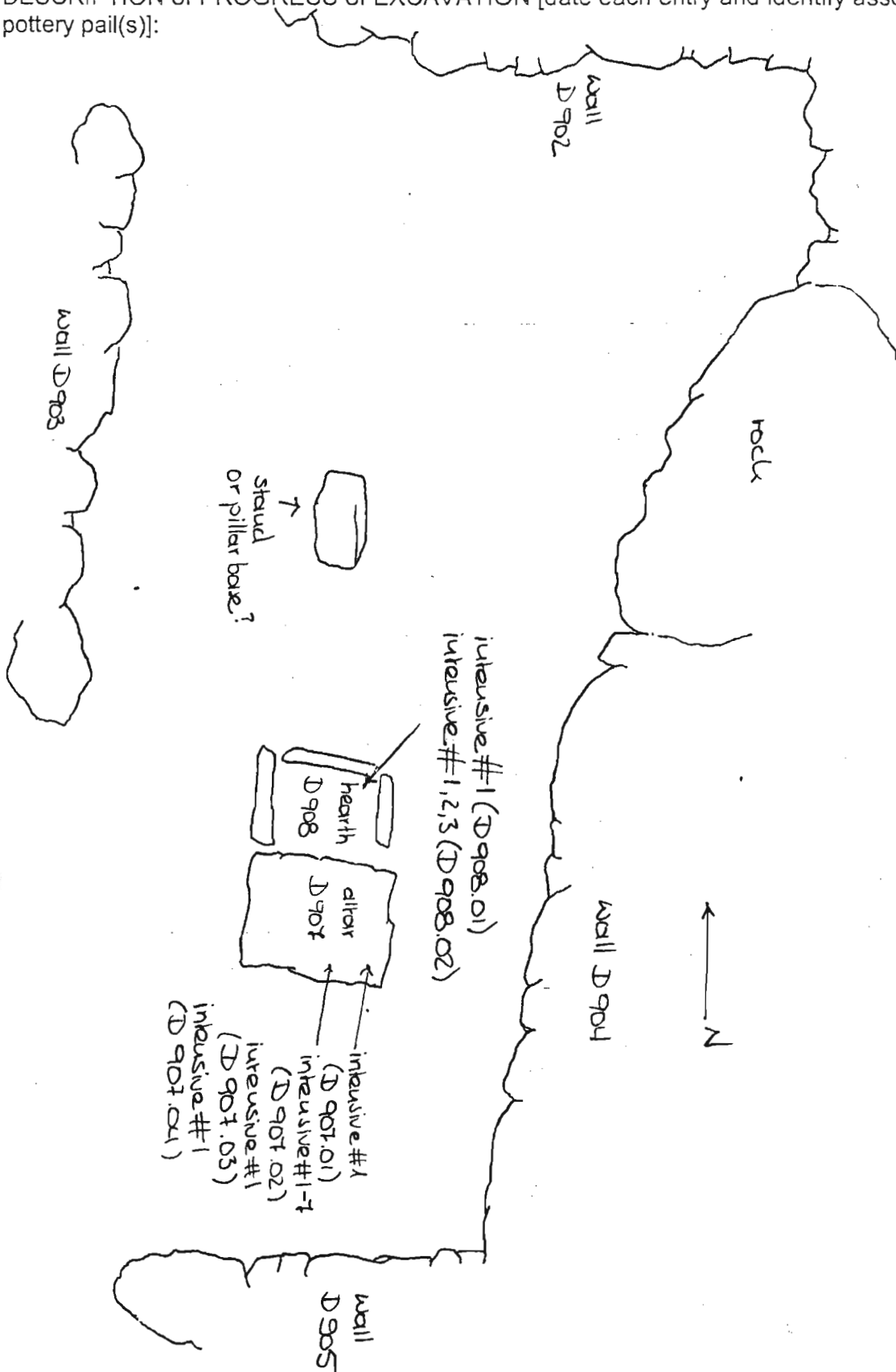

AZORIA Project

p.1

Year 2006 Trench/Locus D 803 Excavator K-C

Elevations

Benchmark used:

Reading on

Benchmark:

H.I.:

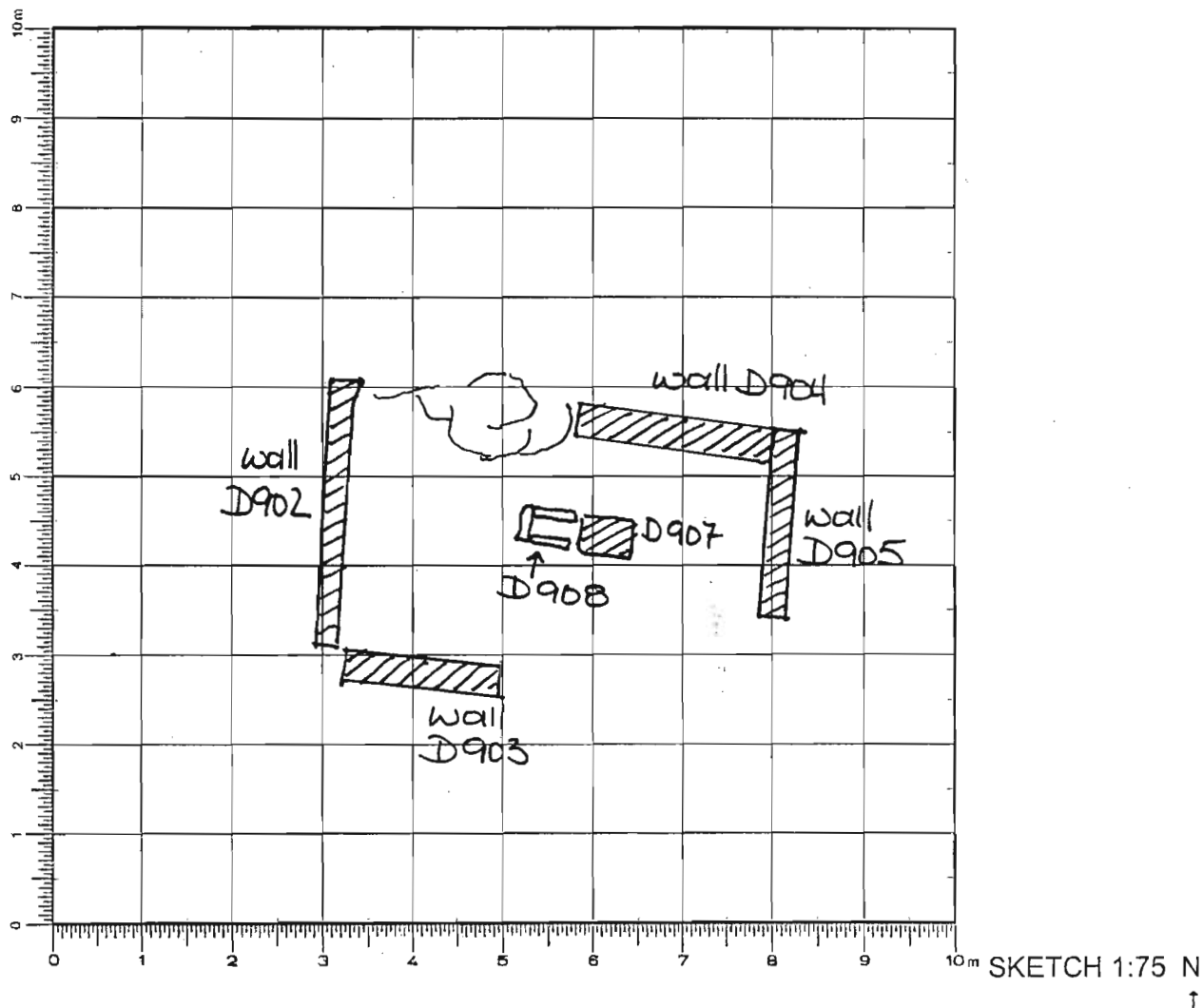

DEFINITION/DESCRIPTION of LOCUS (explain **why** you changed locus numbers):

Today's date: 23 JUNE 06 Locus above:

Locus parameters: D 902 in the NE, D 905 in the S and D 908 in the E.

Verbal description: One course of ⁴ big flat stones with NE → SW orientation.

Locus Interpretative Comments (What do you think this is? DATE your comments, continue on additional pages if necessary):

These rocks could be the foundations of the W-wall of the room.

p.2

[illegible][illegible][illegible]

Year 2006 Trench/Locus D 903 Excavator K-C

DESCRIPTION of PROGRESS of EXCAVATION [date each entry and identify associated pottery pail(s)]: 23 JUNE 06.

After sweeping the trench (room D 901), photos were taken.

We started digging the NW corner of the room (p. pail: D 903.01.). We must find out the N limits of D 903 and the W limits of D 902. Big rocks, probably from the tumble were removed from the NW corner of the room.

The excavation revealed the ^{continuation of the} 2. course of D 903. The stones are smaller in size than the first 4 big flat boulders of D 903. We still need more definition of D 903. We didn't find the rocks that formed the corner of the room.

Probably they were eroded away. We noticed many (over 40) small land shells and carbonized material. We took one intensive soil sample. Among the finds near D 903 was a goat horn (bone bag). The pottery pail D 903.01 was finished and closed. We screened all the dirt from D 903. We found pumice.

Year 2006 Trench/Locus D 902 Excavator K-C**Elevations**

Benchmark used:

Reading on

Benchmark:

H.I.:

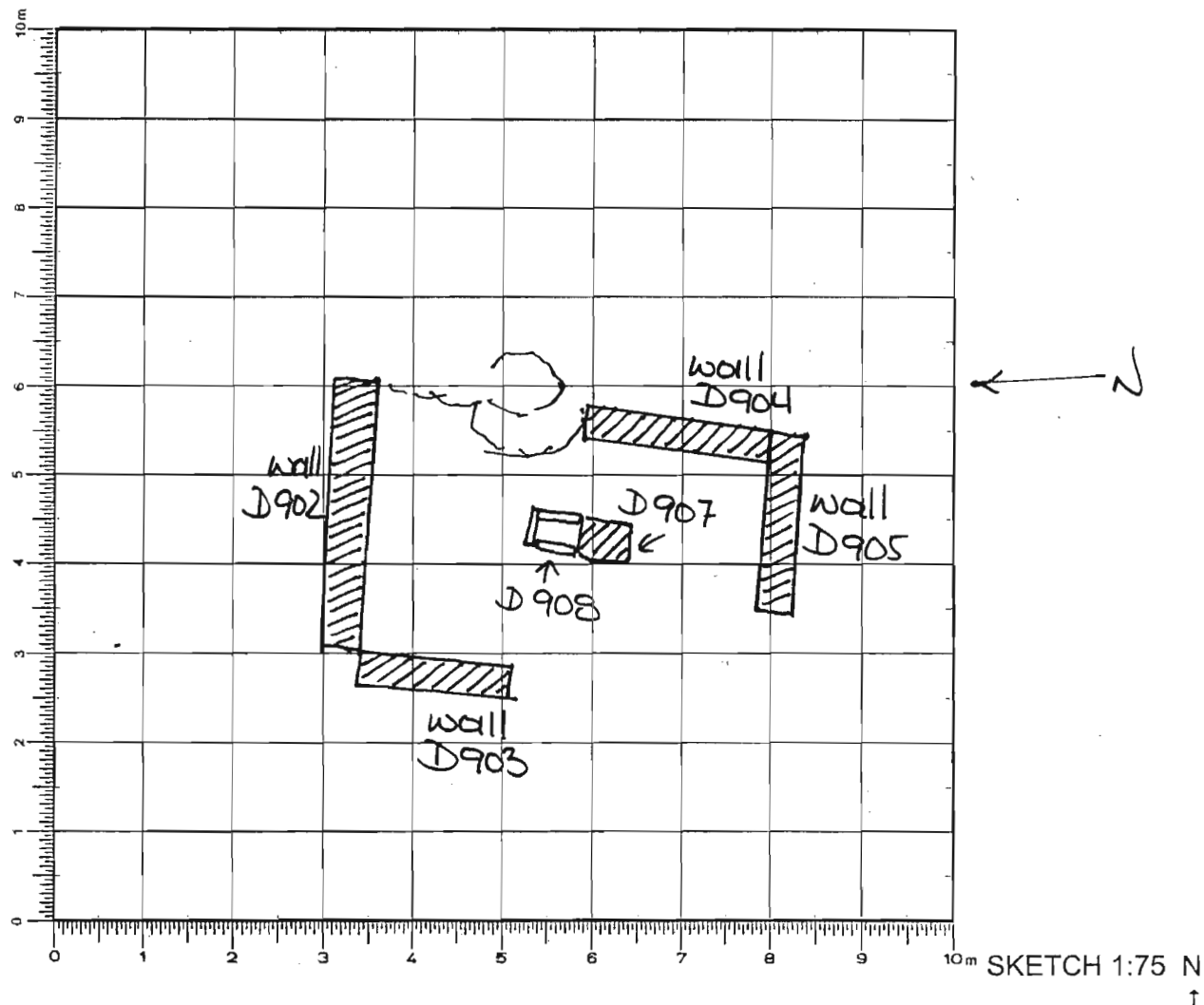
DEFINITION/DESCRIPTION of LOCUS (explain **why** you changed locus numbers):Today's date: 27 JUNE 06 Locus above:Locus parameters: D 1000 in the N, D908 in the S, D903 in the WVerbal description: well preserved wall of which 3m of its length and 1,65 of its height survives.

Locus Interpretative Comments (What do you think this is? DATE your comments, continue on additional pages if necessary):

p.2

[illegible][illegible][illegible]

Year 2006 Trench/Locus D 902 Excavator K-C

DESCRIPTION of PROGRESS of EXCAVATION [date each entry and identify associated pottery pail(s)]: 23. JUNE 06

We started digging the NW corner of the room D901 (p. pail: D ~~901~~⁹⁰³). We removed a lot of rocks and got more definition of the wall D902. The wall is ~~good~~^{well} preserved in the NE corner of the room. In the NW corner the wall seems to be builded with small and medium sized irregular stones. Some big boulders lie on the top. It's really unusual for a wall of this period (archaic?) to be built like this. Especially when you compare the construction of the wall in the NE corner with the unregular builded rocks of the NW corner. What we think is, that the rocks in the NW part of D902 filled the space of a doorway between D902 and D903. There are 4 big rocks in the middle of D902, that could form the E doorjamb. We think that room D901 was connected with room D1001 in the N by a doorway.

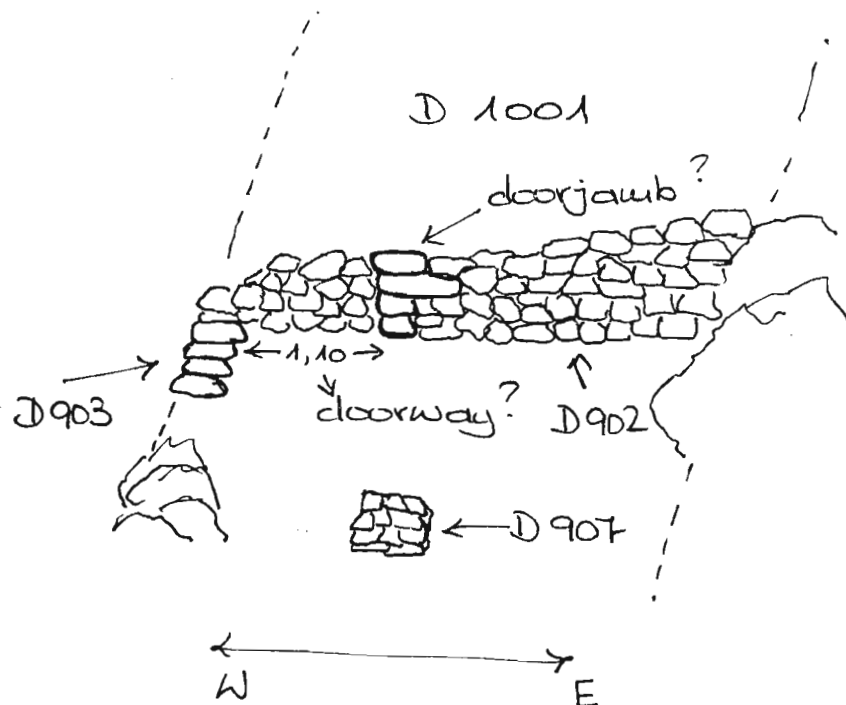

Year 2006 Trench/Locus D 902 Excavator K-C

DESCRIPTION of PROGRESS of EXCAVATION [date each entry and identify associated pottery pail(s)]: 27 JUNE 06

Before D 902.01

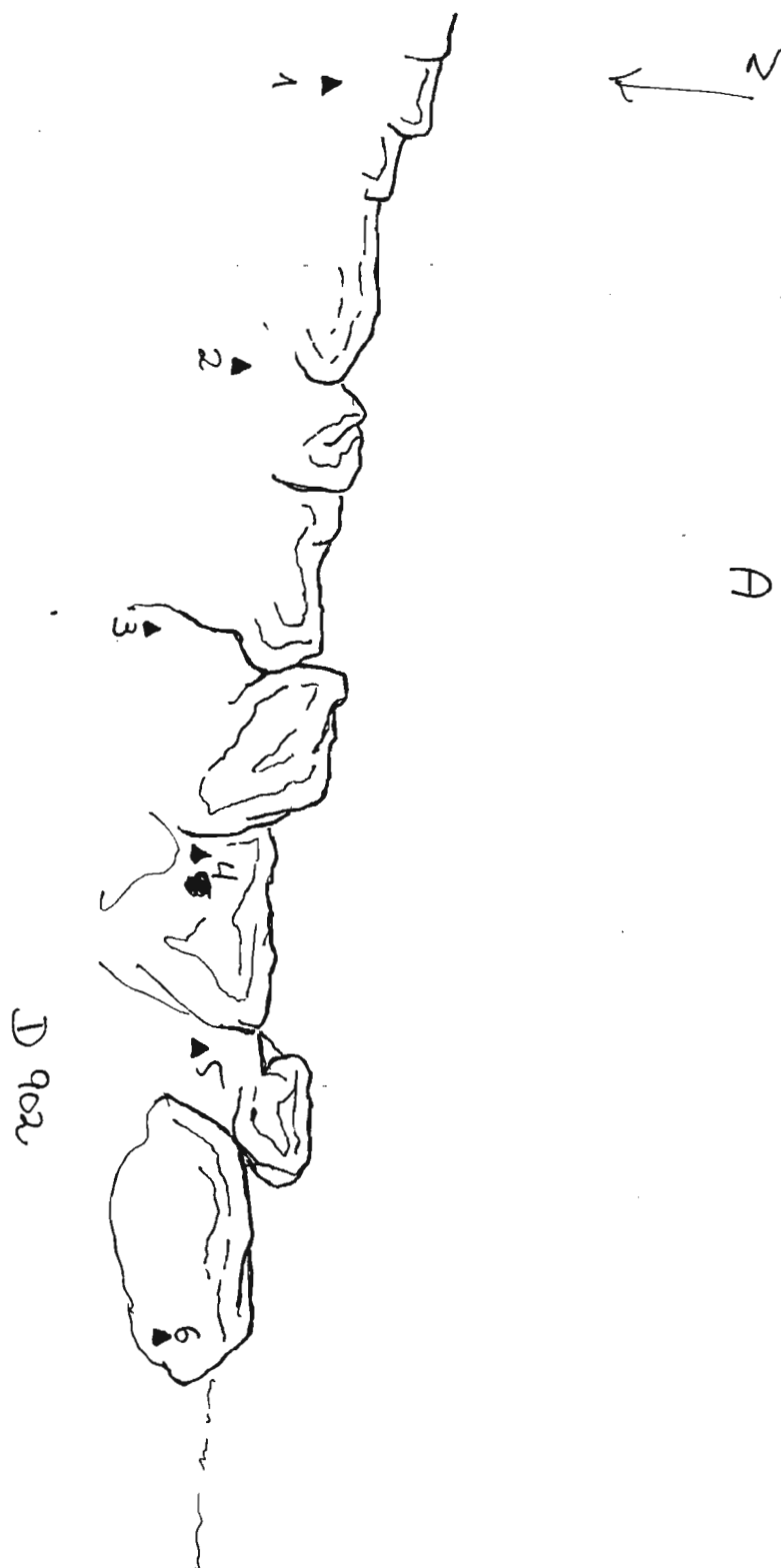

D 906.

A 25: 357, 111
 Leading on B: 1, 13
 H. 1: 358, 241
 1: 1, 81 : 356, 431
 2: 2, 38 : 355, 861
 3: 2, 45 : 355, 791
 4: 2, 67 : 355, 571
 5: 2, 89 : 355, 351
 6: 2, 83 : 355, 411

Year 2006 Trench/Locus D 902 Excavator K-C

DESCRIPTION of PROGRESS of EXCAVATION [date each entry and identify associated pottery pail(s)]: 27. JUNE 06. p.pail: D 902.01

We started digging the wall D 902 in the NW corner of the room to find out if we have a doorway. After removing some rocks from D 902 we found a horizontal course of big rocks (W → E orientation) that blocks the entrance to D 1001 room in the N. We stopped digging D 902. We're gonna get more definition for the "doorway" after digging the room D 1001 in the N. The p.pail D 902.01 was finished and closed. All the dirt was screened. We had some bones from the screen.

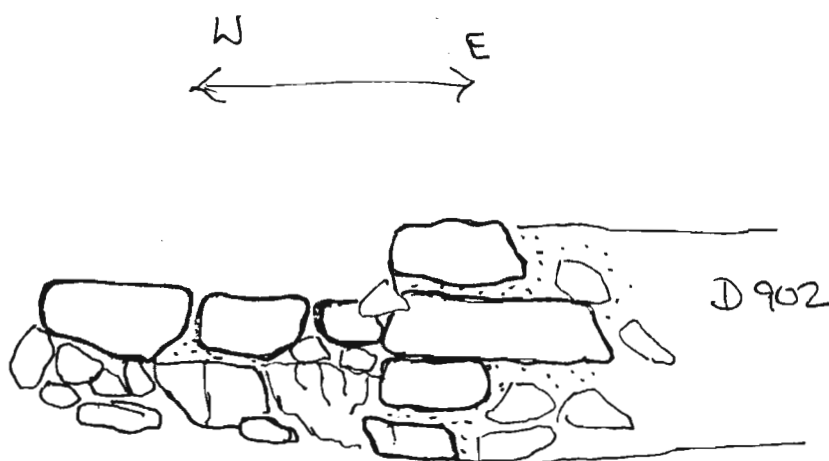

Year 2006 Trench/Locus D908 Excavator K-C**Elevations**

Benchmark used:

Reading on

Benchmark:

H.I.:

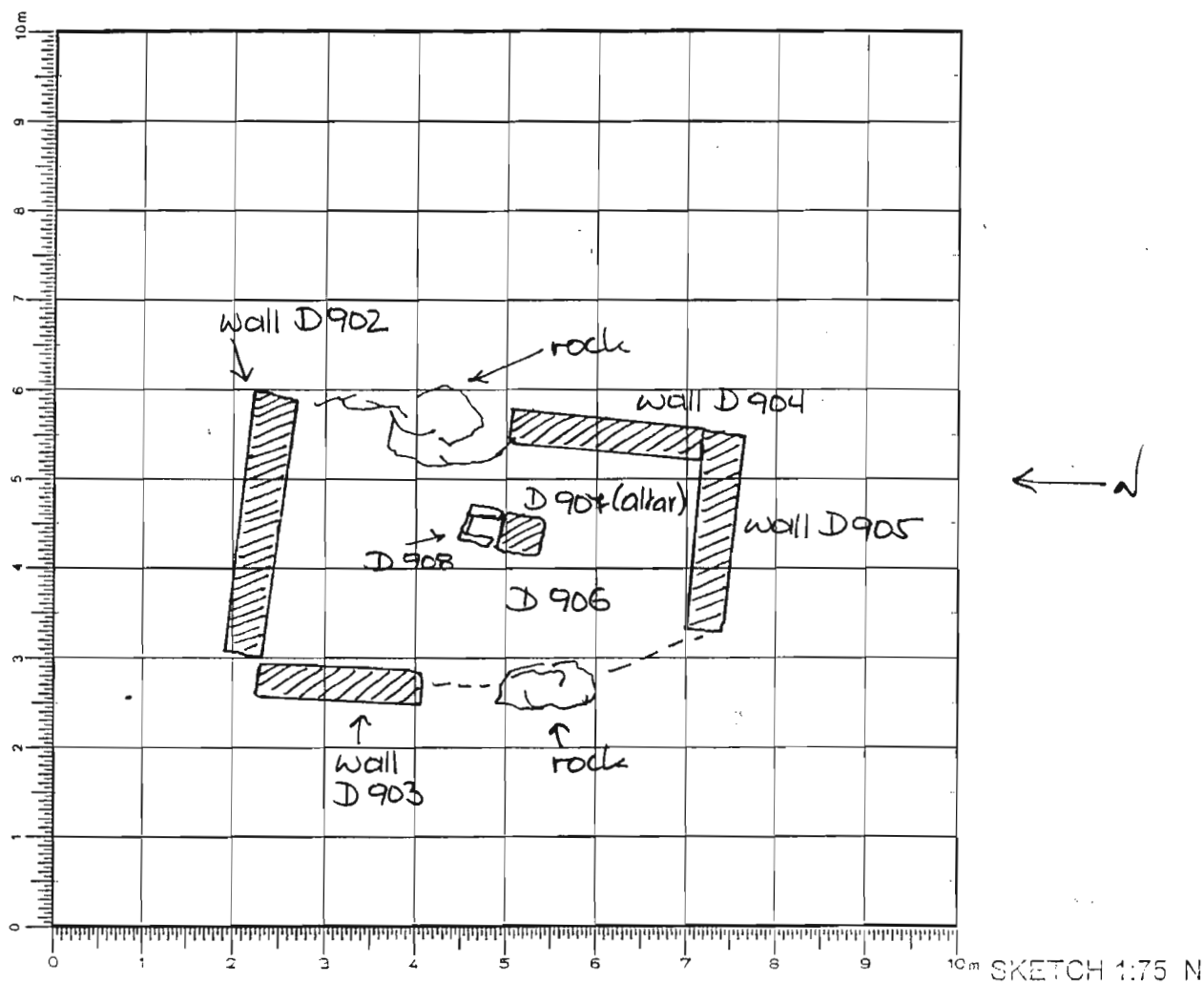
DEFINITION/DESCRIPTION of LOCUS (explain **why** you changed locus numbers):Today's date: 28 JUNE 06 Locus above:Locus parameters: D902 in the N, D903 in the W.Verbal description: hearth built up against D907.

Locus Interpretative Comments (What do you think this is? DATE your comments, continue on additional pages if necessary):

AZORIA Project

P. ____

Year 2006 Trench/Locus D 908 Excavator K-C

DESCRIPTION of PROGRESS of EXCAVATION [date each entry and identify associated pottery pail(s)]: 28. JUNE 06. Pail D908.01.

We cleared the feature D908 (hearth) and took 1 intensive
the top of soil sample. The soil in and close to D908
is very ashy with some pieces of carbon. We took a sample
of carbon from D908. D908.01 was finished and closed.

Year 2006 Trench/Locus D 908 Excavator K-C

DESCRIPTION of PROGRESS of EXCAVATION [date each entry and identify associated pottery pail(s)]: 04 JULY 06. (p.pail: D 908.02)

We started digging the hearth in small passes. In the 1 pass we found small pieces of wood charcoal (1 box). The soil is hard packed with small inclusions, light yellow to orange (burnt clay?) near the N flat stone. We took 1 intensive s. sample. (#1)

The 2. pass didn't produced any carbonized material. No change in the matrix. We took 1 intensive soil sample. (#2)

With the 3. pass we finished digging in the hearth. We took another intensive s. sample. (#3). We exposed 2 courses of schist flat stones from the N side of the altar.

The hearth produced 1 bone fragment, no pottery and no pumice. We took all the dirt as intensive soil samples.

The p.pail D908.02 was finished and closed.

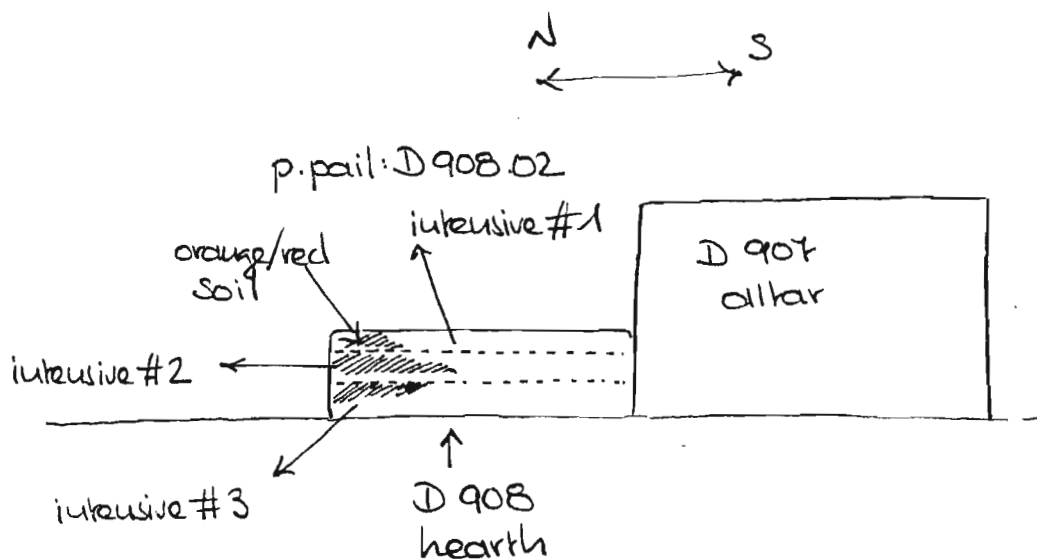

AZORIA Project

p.1

Year 2006 Trench/Locus D 909 Excavator K-C

Elevations

Benchmark used:

Reading on

Benchmark:

H.I.:

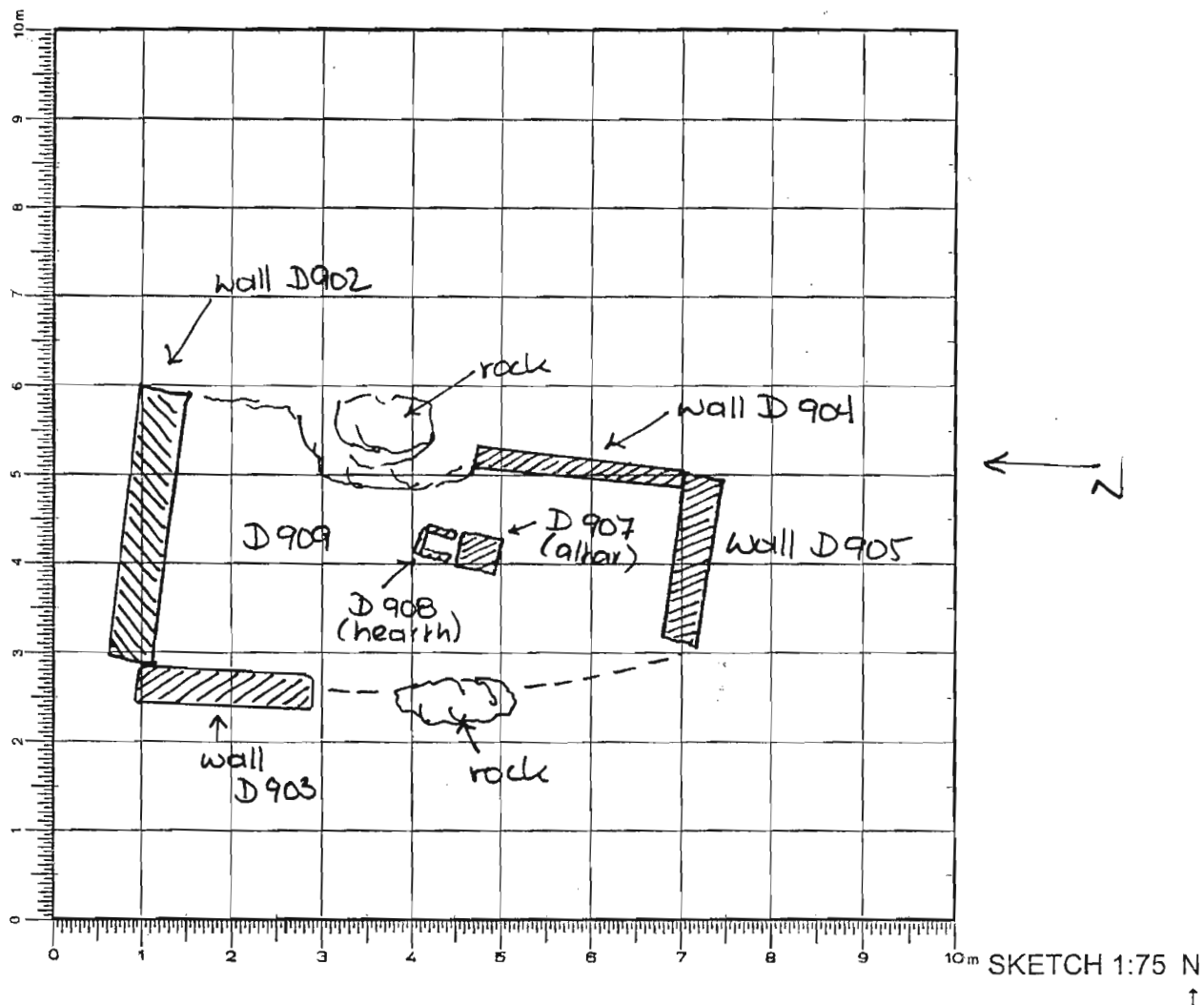

DEFINITION/DESCRIPTION of LOCUS (explain **why** you changed locus numbers):

Today's date: 29 June 06 Locus above:

Locus parameters: D 902 in the N, D 903 in the W, D 904 in the E, D 905 in the S.

Verbal description: floor surface with habitation debris.

Locus Interpretative Comments (What do you think this is? DATE your comments, continue on additional pages if necessary):

Year 2006

Trench/Locus

D 909

Excavator U-C

[illegible]

OBJECTS

[illegible]

ADDITIONAL COLLECTED MATERIAL

[illegible]

Year 2006 Trench/Locus D 909 Excavator K-C.DESCRIPTION of PROGRESS of EXCAVATION [date each entry and identify associated pottery pail(s)]: 29 JUNE 06. (p. pail: D 909.01)

D 909 is the floor surface in D 901 room with the habitation debris. We are digging a pass from the SW part of the room continuing to the SE corner. We found some pumice, bones and pottery (fine ware) from the screen. The floor surface is not so well preserved and compact in the SW corner. The p. pail D 909.01 was finished and closed.

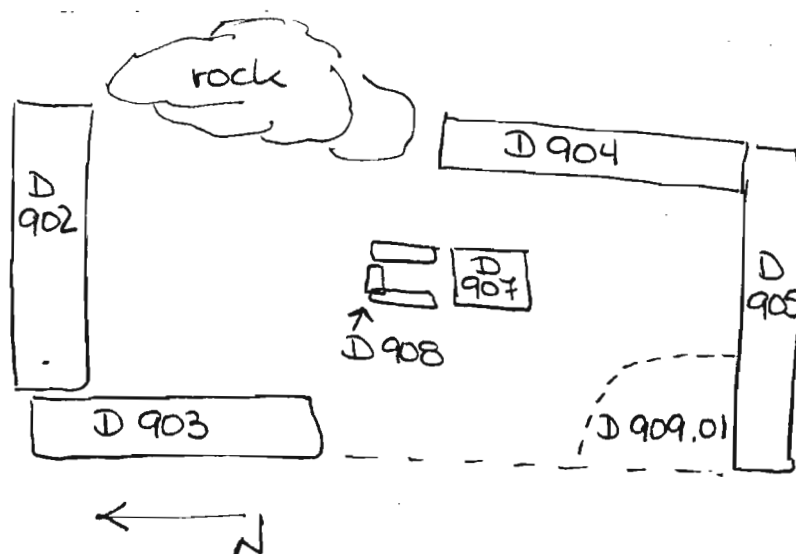

Year 2006 Trench/Locus D 909 Excavator K-C

DESCRIPTION of PROGRESS of EXCAVATION [date each entry and identify associated pottery pail(s)]: 30 JUNE 06 (p. pail D 909.02)

We are continuing the pass from the 29 JUNE. The floor surface is well preserved near the platform and between D 904 and D 904. The floor is hard and compact with light yellow color (like the sealing clay). Near the walls D 905 and D 904 the floor surface is eroded and we exposed the package (small rocks, light red soil) under the floor. Near the walls, the floor surface was probably lying higher. Near the platform we found some fine ware sherds. Unfortunately the floor surface was clean from offerings (figurines, shells, etc.).

- Digging the floor we got more definition of D 904 and exposed the foundations of the platform. We found some pieces of carbon near the platform (SE of D 904). We took 1 standard and 3 intensive soil samples (all near D 904). The floor is also well preserved NE of D 908 (hearth?). The soil was screened and we found some bones and pumice. We didn't finish the pass. Monday we're gonna dig the NW part of the room. The p. pail D 909.02 was finished and closed.

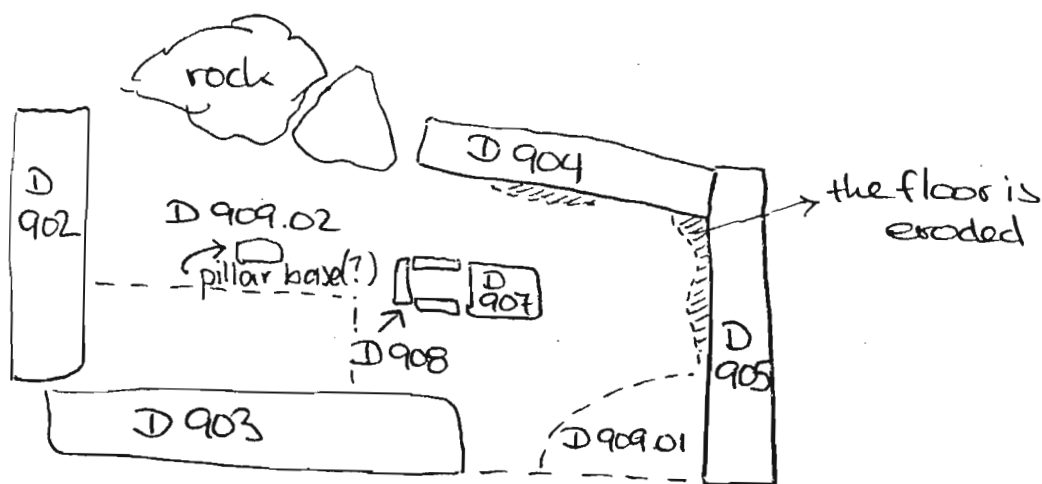

Year 2006 Trench/Locus D 909 Excavator K-C

DESCRIPTION of PROGRESS of EXCAVATION [date each entry and identify associated pottery pail(s)]: 03. JULY 06. (p. pail D 909.03)

We are continuing the pass from the 30. JUNE. We got more definition for D 903 by removing some rocks and exposing the foundations of D 903. NW of D 908 we found some burnt seeds (modern?) and took 1 intensive s. sample. We also took 3 intensive samples near D 908 and between D 907 and D 904 because we found small pieces of carbon and ash. NW of D 908 (near D 903) we found a bronze plaque(?) (obj. 1). All the dirt was screened. We found pumice, bones and some sherds (from the screen). We found a lot of pottery, mainly pithoi sherds and fine ware. SW of D 907 we found a flat stone ^(schist) sitting on the floor surface. We took another small pass S of D 907, between D 907 and D 904 and NE of D 908 and removed the last thin layer of roofing clay sitting on the floor surface. Near the foundations of D 903, S of D 907 and near the NE corner of the room we exposed the package under the floor surface. We took 1 standard soil sample. The p. pail D 909.03 was finished and closed.

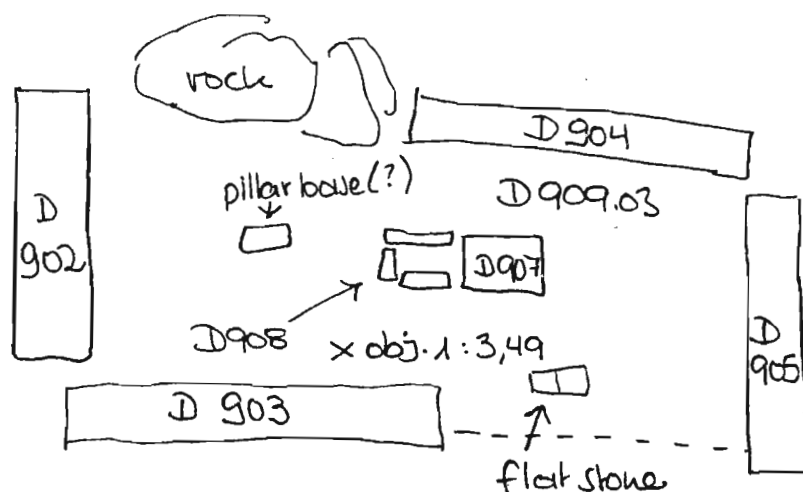

Reading on B: 0.99
R 25: 357, 111

Year 2006 Trench/Locus D 909 Excavator K-C

DESCRIPTION of PROGRESS of EXCAVATION [date each entry and identify associated pottery pail(s)]: 04. JULY 06 (p. pail: D 909.04)

We finished the locus D 909 with a last small pass in the NE corner of the room. We took the last thin layer of sealing clay over the floor and exposed the floor surface. We found pottery, mainly fine ware sherds. We found some bones (1+1 from the screen). We didn't find any pumice. The room/trench was cleaned for photo. The p. pail D 909.04 was finished and closed.

Year 2006 Trench/Locus D 909 Excavator K-C

DESCRIPTION of PROGRESS of EXCAVATION [date each entry and identify associated pottery pail(s)]: 04 JULY 06

1: 3, 21: 354, 841
2: 3, 31: 354, 741
3: 3, 33: 354, 751
4: 3, 22: 354, 861
5: 3, 44: 354, 641
6: 3, 32: 354, 761

7: 3, 39: 354, 691
8: 3, 37: 354, 711
9: 3, 41: 354, 671
10: 3, 41: 354, 671
11: 3, 45: 354, 631
12: 3, 33: 354, 751

13: 3, 40: 354, 681
14: 3, 35: 354, 731
15: 3, 33: 354, 751
16: 3, 20: 354, 881
17: 3, 34: 354, 741
18: 3, 45: 354, 631
19: 3, 39: 354, 691

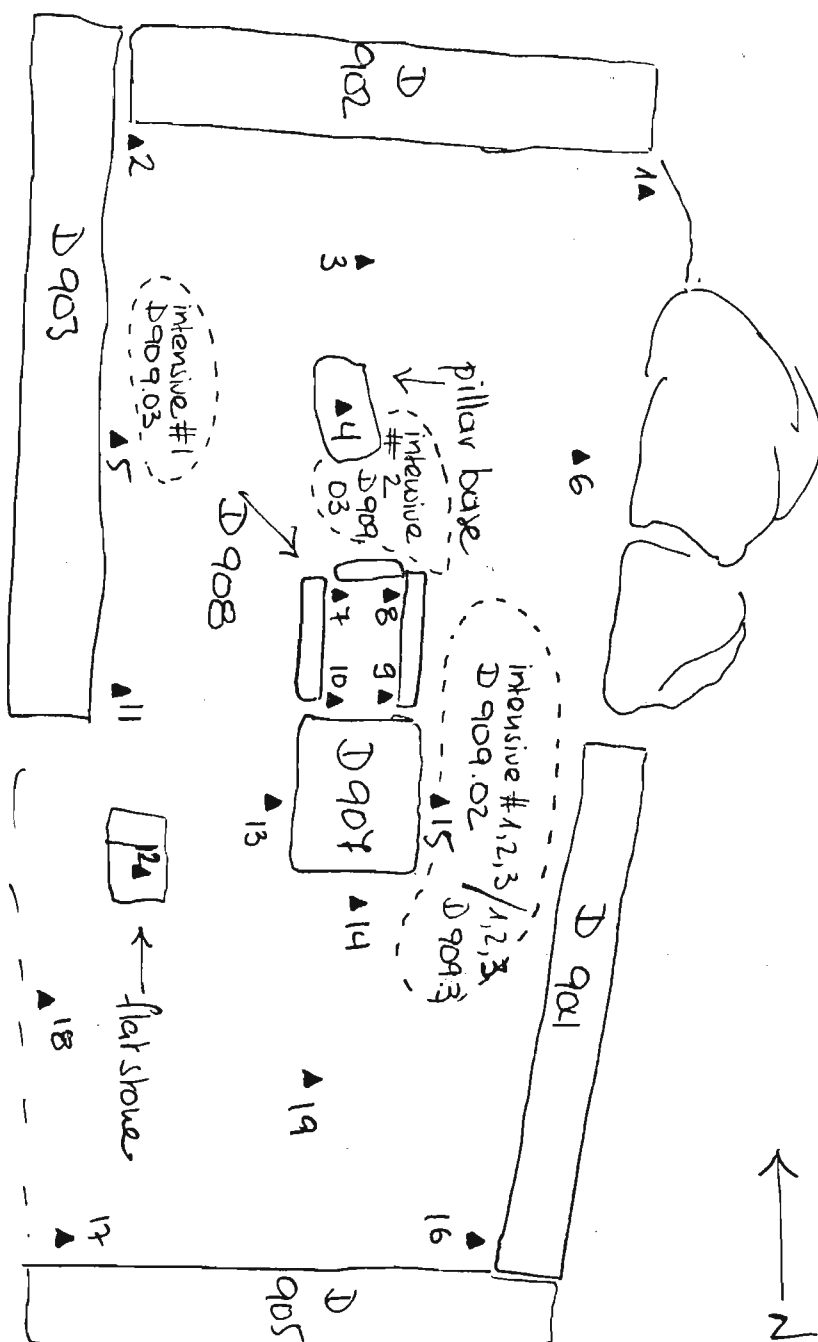

Bottom of D 909. 01/02/03/04

Reading on B: 0, 97
R 25: 357, 111
H. 1: 358, 081

Year 2006 Trench/Locus _____ Excavator K-C

DESCRIPTION of PROGRESS of EXCAVATION [date each entry and identify associated pottery pail(s)]:

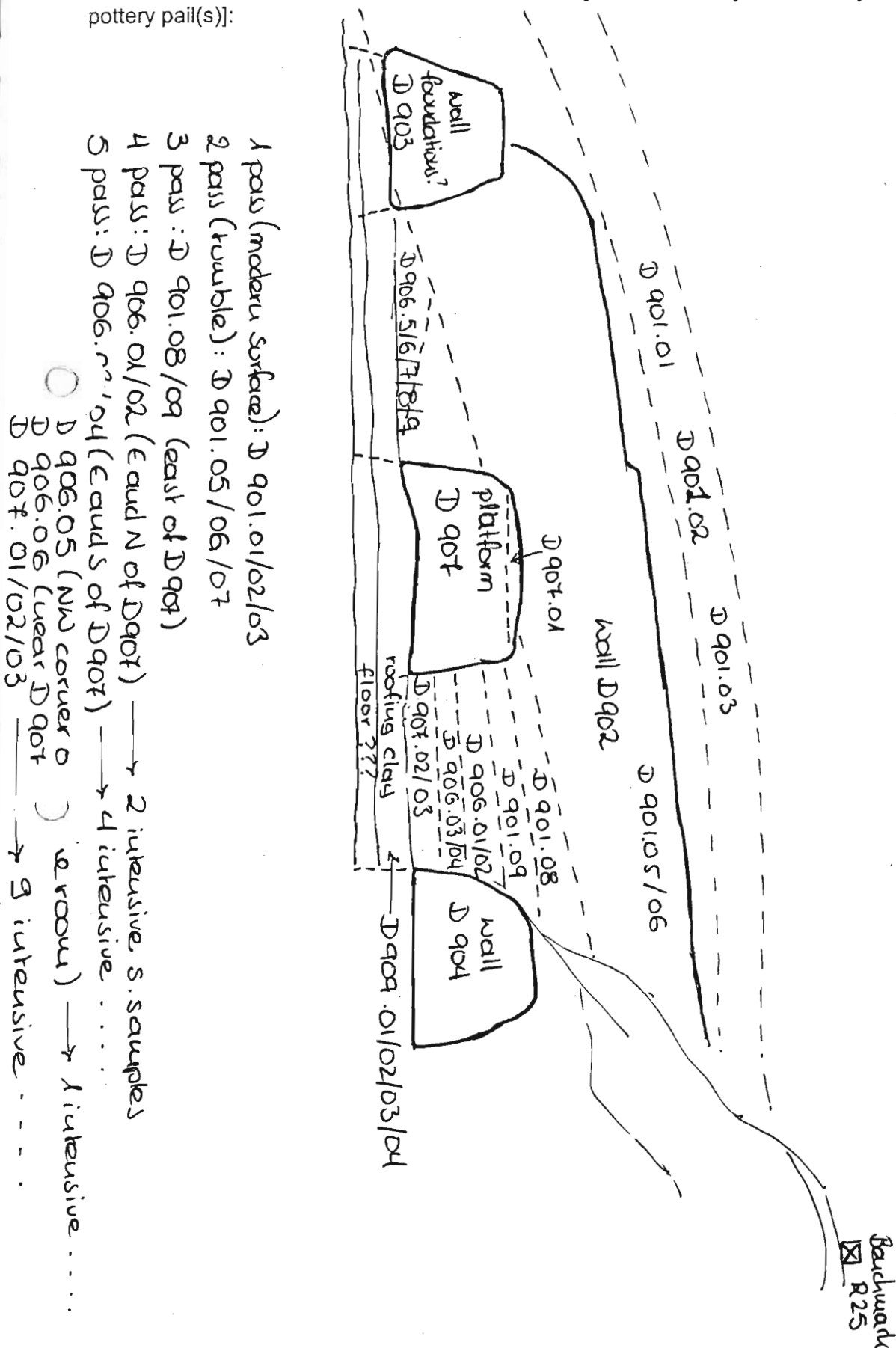

1 pass (modern surface): D 901.01/02/03

2 pass (trouble): D 901.05/06/07

3 pass: D 901.08/09 (east of D 904)

4 pass: D 906.01/02 (E and N of D 907) → 2 intensive S. samples

5 pass: D 906.03/04 (E and S of D 907) → 4 intensive

D 906.05 (NW corner of D 907) → 1 intensive

D 906.06 (near D 907)

D 907.01/02/03 → 3 intensive