

Azoria 2004
B1500 Final Trench Report
RQC

B1500 is a ~ 4x5 meter room bounded to the north by trench **B2200** and to south by trench **B700**. B1500 was previously excavated to the habitation surface (Archaic) in the 2003 dig season by Gloria Park. B1500 is a storage room with central hearth **B1512**, a doorway south to B700, and a stepped doorway north to B2200. There is a stone bench in the southwest corner of the room. B1500 is bounded by walls **B707** to east, **B711** to south, **B1505** to west, and **B1507** to north.

Excavation in B1500 this year was conducted to determine whether final Neolithic habitation levels like those in trenches B1200 and B700 to south exist underneath Archaic floor levels in B1500. Excavation was conducted from 31 May 04 – 17 June 04. Rob Cuthrell was the trench supervisor. Trench assistants were Clara Scarry, Cait Johnson, Rachel McCleery, and Carolyn Edey. The workman was Nikoli Speliarotis.

Brief Loci & Pail descriptions:

Pottery resting on Archaic surface	B1513.1-6
First Archaic surface and packing	B1514.1,5
Second Archaic surface and packing	B1514.2-4,6
Early Iron Age / LMIIC surface and packing	B1515.1-7
Floor packing / mixed level	B1515.8 ; B1516.1-10
Mixed fill in deep depressions	B1516.11-12
Final sweepings	B1516.13

Excavation in B1500 began in the area west of the central hearth to wall B1505 and from wall B711 to wall 1507. A scarp was made around the stone bench in the southwest corner. Excavation area was about 2 meters wide east-west, 4.5 meters wide north-south. Area of excavation later extended ~1 meter east in area south of central hearth.

Pails **B1513.1-6** removed pottery resting on the surface of the first Archaic floor left from 2003 dig season. Two schist pithos lids were removed from the northwestern corner of the trench, one ~35cm in diameter, the other ~50cm in diameter. A loom weight was also recovered while removing exposed pottery.

The first pass removing the uppermost Archaic floor surface (**B1514.1, B1514.5** in extension south of hearth) revealed a second Archaic floor surface underneath and defined the top of a central concentration of stones. Second Archaic floor was much like the first, grey packed clay included with pebbles and carbon flecks. The top of a door pivot was uncovered in the northwestern edge of the trench. One possible stone burnisher was recovered in pail **B1514.1**, two stone burnishers were recovered from pail **B1514.5**.

Second Archaic surface was removed as **B1514.2-3** (**B1514.6** in extension south of hearth), packing underneath was removed as **B1514.4**. Two threshold stones associated with northwestern door pivot were exposed under the northern portion of wall B1505. Door pivot was found to be resting on bottom of this pail, on an EIA/LMIIC surface

exposed at bottom of B1514. The EIA/LMIIC surface exposed at the bottom of B1514 was referred to in the notebook as a third Archaic surface, later found to be earlier in date when pottery taken from area was read. More of the large central stone concentration (eroded bedrock) was exposed. A chipped stone flake and two possible stone burnishers were recovered from the sieve in pail **B1514.2**, one stone burnisher was recovered from pail **B1514.3**.

The Early Iron Age / LMIIC surface and packing were removed as **B1515.1-7**. Central concentration of eroded bedrock was further exposed. Bottom of **B1515.5** appeared relatively smooth and regular, may have been the remnants of an earlier EIA/LMIIC surface. Some Archaic pottery was recovered while excavating this locus, probably due to the unevenness of excavation forced by concentrations of eroded bedrock as well as more eroded bedrock in the central and northern portions of the trench. Archaic pottery recovered from this locus probably represent remains from the bottom of the second Archaic floor surface directly above in areas where either the Archaic floor packing intrudes into EIA/LMIIC surface or where excavation had not yet completely removed packing for second Archaic floor. Two large boulders underlying wall B1505 but offset ~15 cm east of the Archaic wall were exposed with this locus, they are probably part of an earlier wall. One stone burnisher was recovered from pail **B1515.1**, a polished stone was recovered from the screen in pail **B1515.2**, and a clear polished stone was recovered from the eastern edge of **B1515.6**. The bottom of locus B1515 was level with the **bottom of Archaic wall B1507** at the northern edge of the trench.

Three small built features were exposed in the central eroded bedrock concentration while excavating this locus and were further defined with B1516. Two are small, roughly circular, shallow ashy areas surrounded by stones in the southeastern and south-central area of the central concentration, both 20-30cm in diameter. No carbon inside these. Third feature is a roughly square schist-built small hearth just under the northeast corner of the stone bench scarp. Feature is 30-40 cm in diameter, filled with ash, carbon, bone, and pottery. Most of gray floor packing was removed with this locus, transitional grey/red clay exposed at bottom of locus.

B1516.1-10 consists of transition between floor packing to dark red clay and down to bedrock in most areas of the trench. Pails **B1516.1,3** were taken from area north of central eroded bedrock concentration, these exposed more bedrock in northern half of trench and were the last pails taken from that area. Excavation in this locus continued to expose the central eroded bedrock concentration, as well as another concentration of stones in the southern portion of the trench that was found to continue eastwards into trench extension south of Archaic hearth. Eroded bedrock removed in area around central stone concentration. Some stones revealed in the southern portion of the trench appeared roughly linear, but were not regular enough to determine whether they represent built features or tumble/bedrock. Bottom of this locus was lower than walls B1507 and B711, above bottom of wall B1505 (early boulders). One stone burnisher was recovered in pail **B1516.8**. **B1515.8** exposed bedrock in central portion of trench extension, grey clay depression exposed in southern portion of extension, EIA/LMIIC surface/packing was not well preserved in this area. One chipped stone flake was recovered from pail **B1515.8**. Pails **B1516.6,9** removed hard-packed, possibly burnt dark red clay from area just north of wall B711, area mostly sterile. Pottery recovered from this locus mainly LMIIC/Final Neolithic with some Archaic pottery. Two depressions filled with

grey/brown soil were exposed at bottom of this locus. The **bottom of southern Archaic wall B711** was exposed midway through locus **B1516**. The bottoms of the two threshold stones associated with door pivot were exposed in B1516. The bottom of western wall B1505 was not exposed during excavation in B1516.

A depression filled with probable foundation packing for wall B711 was exposed in southern portion of trench extension, excavated as **B1516.11**. LMIIC and Archaic pottery recovered. Another central deep depression filled with grayish/red carbon-flecked soil (just south of central stone accumulation) was excavated as **B1516.12**. Final Neolithic, LMIIC, and Archaic pottery recovered. These two depressions may represent pits where massive bedrock was removed during Archaic period to prepare a level floor surface. Fill in the depressions from the Archaic period would account for the Archaic pottery present in EIA/LMIIC floor and packing underneath above the area of these pails.

Discussion:

Excavation in B1500 did not reveal significant final Neolithic levels such as in B700 to south. Three surfaces, two Archaic and one EIA, were excavated. Features associated with possible EIA/LMIIC surface are useful in determining the architectural phases of the room. Door pivot and threshold stones, as well as the two large boulders incorporated into wall B1505 but aligned ~15cm to east of it, are all possibly associated with EIA/LMIIC surface. These could all be remnants of an earlier structure on which the Archaic structure was built. Area above threshold stones appears to be filled with tumble. Another possibility is that the door pivot was sunk into Archaic floor to level of EIA/LMIIC surface and that Archaic floor in threshold stone area was lower than in other areas. In any case, the boulders incorporated into wall B1505 do not appear to have been placed as part of Archaic wall and are probably associated with some earlier phase architecture.

The exposed bottom of B1500 excavated this season appeared was unequivocally bedrock in at least the northern half of the trench. In the southern half, bottom appears to be bedrock possibly mixed with rock tumble from possible pre-Archaic features. The accumulations of stones in the southern portion of the trench are too disarticulated to make any definite conclusions as to their nature and/or their associations with final Neolithic architecture to south in trench B700. It is unclear what relationship the small ashy pits and hearth around central eroded bedrock concentration have with floor surfaces and architecture. All were uncovered below level of EIA/LMIIC surface, but were mostly barren of pottery and unable to be dated. These may have been present as very small pits hearths in association with EIA/LMIIC floor or earlier levels that aren't well preserved. The two depressions filled with grey clay/pebbles/pottery are likely pits created with the removal of boulders protruding through EIA/LMIIC floors during the Archaic phase. Removal and leveling fill during Archaic explains the presence of Archaic pottery in the area beneath EIA/LMIIC floor.

Year 04 Trench/Locus B1513 Excavator RQC

Elevations

Benchmark used:

Reading on

Benchmark: R9-355.63H.I.: ~~1.115~~

1.115

① 2.564

R9+HI =
356.745

② 2.572

③ 2.634

④ 2.567

⑤ 2.653

⑥ 2.705

⑦ 2.685

⑧ 2.708

⑨ 2.703

R9 - 355.63

HI: 1.465 R9+HI =
357.095

⑩ 2.868

⑪ 2.845

⑫ 2.905

⑬ 2.858

R11 - 355.86

⑭ 2.920

HI: 1.283

⑮ 2.950

⑯ 2.884

R11+HI =

⑰ 2.962

357.143

⑱ 3.022

⑲ 2.985

⑳ 3.008

㉑ 3.020

★ = Rocks removed
in B1513.6Not to
Scale

SKETCH 1.75

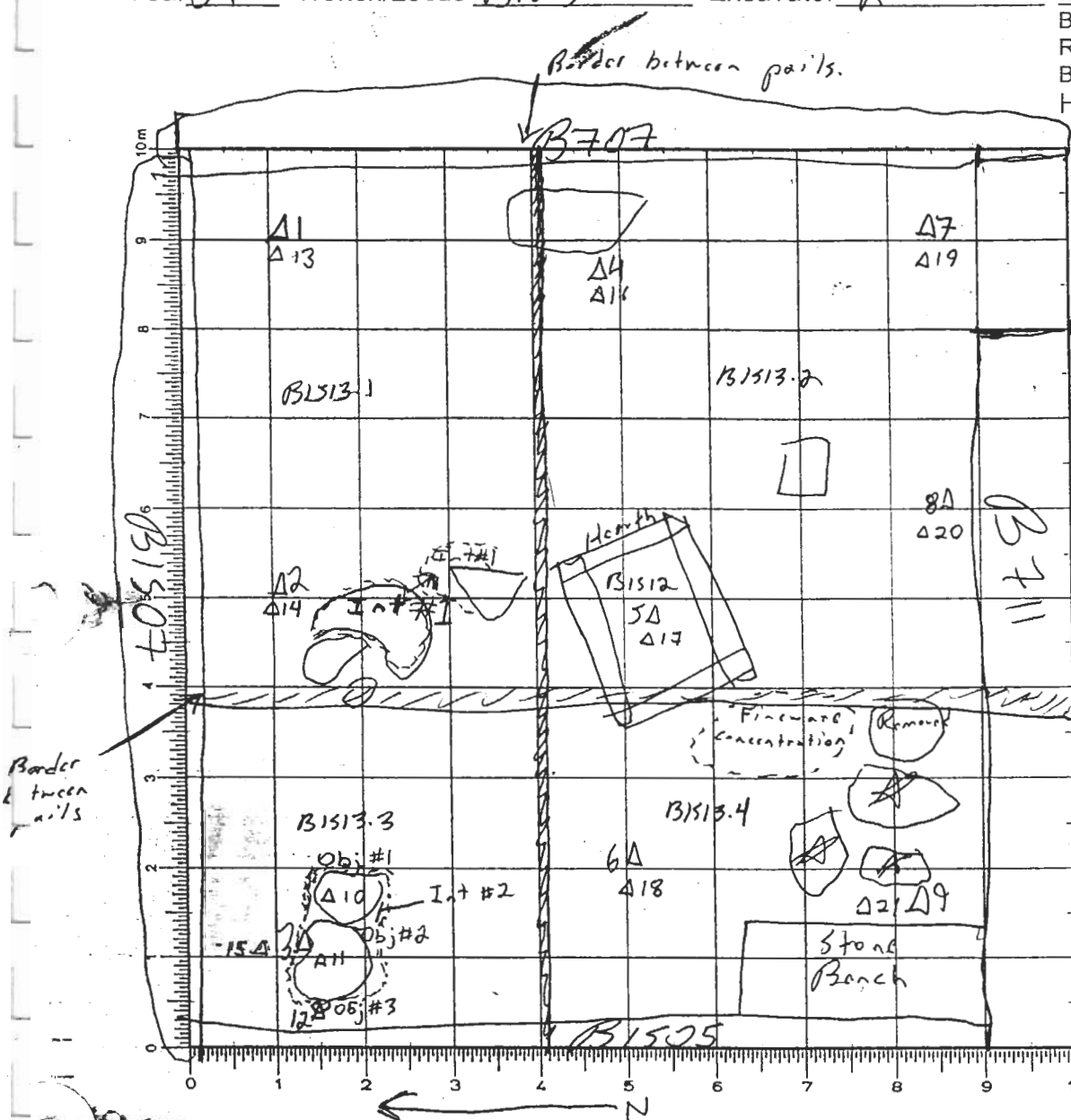

DEFINITION/DESCRIPTION of LOCUS (explain why you changed locus numbers):

Today's date: ~~31 May 04~~ 31 May 04 Locus above: B150

Locus parameters: Pottery above floor surface - surface exposed since 2003 season.

B1513 bounded by walls B1505, B1507, B707, B711.

Verbal description: Pottery scatters above floor surface, below floor deposit/roosting clay B1508. Locus divided into ~~four~~ quadrants as ~~shown~~ above. (B1513.1 - B1513.4). B1513.5 consists of loose dirt and rocks swept from the surface of B1513 and from atop and around walls B1507, B707, B711, and B1505.Locus Interpretative Comments (What do you think this is? DATE your comments, continue on additional pages if necessary): 31 May 04Intensive soil sample #1 From several small carbon sources in NE quadrant as noted above. ~~Quadrants~~ B1513.1 swept, pottery and bone removed from surface, soil removed, screened through 1/4" screen. NE quadrant B1513.1 finished.

Year 04 Trench/Locus B1513 Excavator RC

DESCRIPTION of PROGRESS of EXCAVATION [date each entry and identify associated pottery pail(s)]:

1 June 04! Beginning surface sweep of NW quadrant B1513.3, removing pottery and bone from surface, soil removed screened 1/4". Objects #1 and 2 are flat stone slabs, possibly pithos lids.

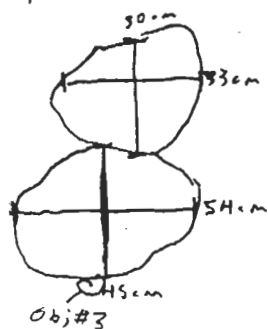

Obj #3 is a possible stone tool, ~5cm diameter, round, hole through it. Loom weight? Soil under pedestated pithos lids taken as Intensive soil sample #2. NW Quadrant, pail B1513.3, completed. All pottery & bone removed from surface and soil under pithos lids. SW quadrant B1513.4 started, surface will be swept for pottery sherds and bone. Fineware vessel(?) pottery scatter west of hearth. Pail B1513.4 (SW Quadrant) completed and closed. Surface scanned for pottery & bone. Fineware vessel sherds recovered from pottery concentration west of hearth. SE quadrant (pail B1513.2) opened,

surface will be swept, pottery & bone removed. Pail B1513.2 (SE quadrant) completed and closed, pottery removed from surface, no bone found. Standard soil sample taken from random areas in B1513.1, B1513.2, B1513.3, and B1513.4, 5 liters.

1 June 04! B1513.1-B1513.5 represent the last pottery and bone atop the Archaic floor surface in B1500. The trench was opened during the 2003 excavation season but was not finished due to time constraint. Pails B1513.1-B1513.5 were taken to recover the small pottery scatters remaining atop the floor surface. Loose rocks that had fallen from perimeter walls were removed, as well as several ~~flat~~ were found to have pottery beneath. The locus was divided into quadrants to allow greater spatial control of recovered pottery. Pail B1513.5 was composed of loose dust, rocks, pottery, and vegetation that was exposed on the floor surface. Soil across the locus consisted of grey clay patches mixed with darker red floor surfaces. Potsherds, pebbles, and some bone was embedded in the grey clay & floor surface. A carbon patch in B1513.1 was taken as Intensive soil sample #1. Two flat greyish clay in B1513.1 was taken as Intensive soil sample #1. Two flat rocks (sketched above) in B1513.3 were thought to be pithos lids. These were removed from B1513 as objects 1 ~~and~~ 2 and the soil beneath, consisting of dark burned patches and pottery inclusions, was taken as Intensive soil sample #2. A standard soil sample was taken randomly from pails B1513.1-B1513.4. A smooth rock with a hole in it, possibly a loom weight, was recovered underneath the western edge of the larger pithos lid (Obj #2), and was recorded as Object #3. Pails B1513.2, B1513.3, and B1513.4 were completed today. After final elevations are taken tomorrow, the trench will be closed. Benchmark RR9 appears to have moved ~6cm since last season, and it will no longer be used for elevations. All soil removed from the trench (pails B1513.1-B1513.5) was screened 1/4". ~~At~~ Bottom of B1513 was swept & photographed. Elevations 1-9 are starting elevations of the top of B1513. Elevations 10-12 are elevations of objects 1-3.

2 June 04! Final elevations (13-21) were taken of the bottom of B1513

Elevations:	6) 354.040	11) 354.250	16) 354.259	(21) 354.123	1-9: Top of B1513
1) 354.181	7) 354.060	12) 354.190	17) 354.181		10-12: Objects 1-3
2) 354.173	8) 354.037	13) 354.285	(18) 354.121		13-21: Bottom of B1513
3) 354.111	9) 354.042	14) 354.223	19) 354.158		
4) 354.178	10) 354.227	(15) 354.193	20) 354.135		
5) 354.092					

Year 04 Trench/Locus ~~B72~~ B1513 Excavator RZC

DESCRIPTION of PROGRESS of EXCAVATION [date each entry and identify associated pottery find(s)]:

4 June 04 / Pail B1513.6 is the soil just below three rocks removed from the southern portion of B1513. These rocks are marked with an ~~A~~ on page 1. Rocks were resting on Archaic floor surface of B1513.

Year 04 Trench/Locus B1514 Excavator ROC**Elevations**

Benchmark used:

Reading on

Benchmark:

H.I.:

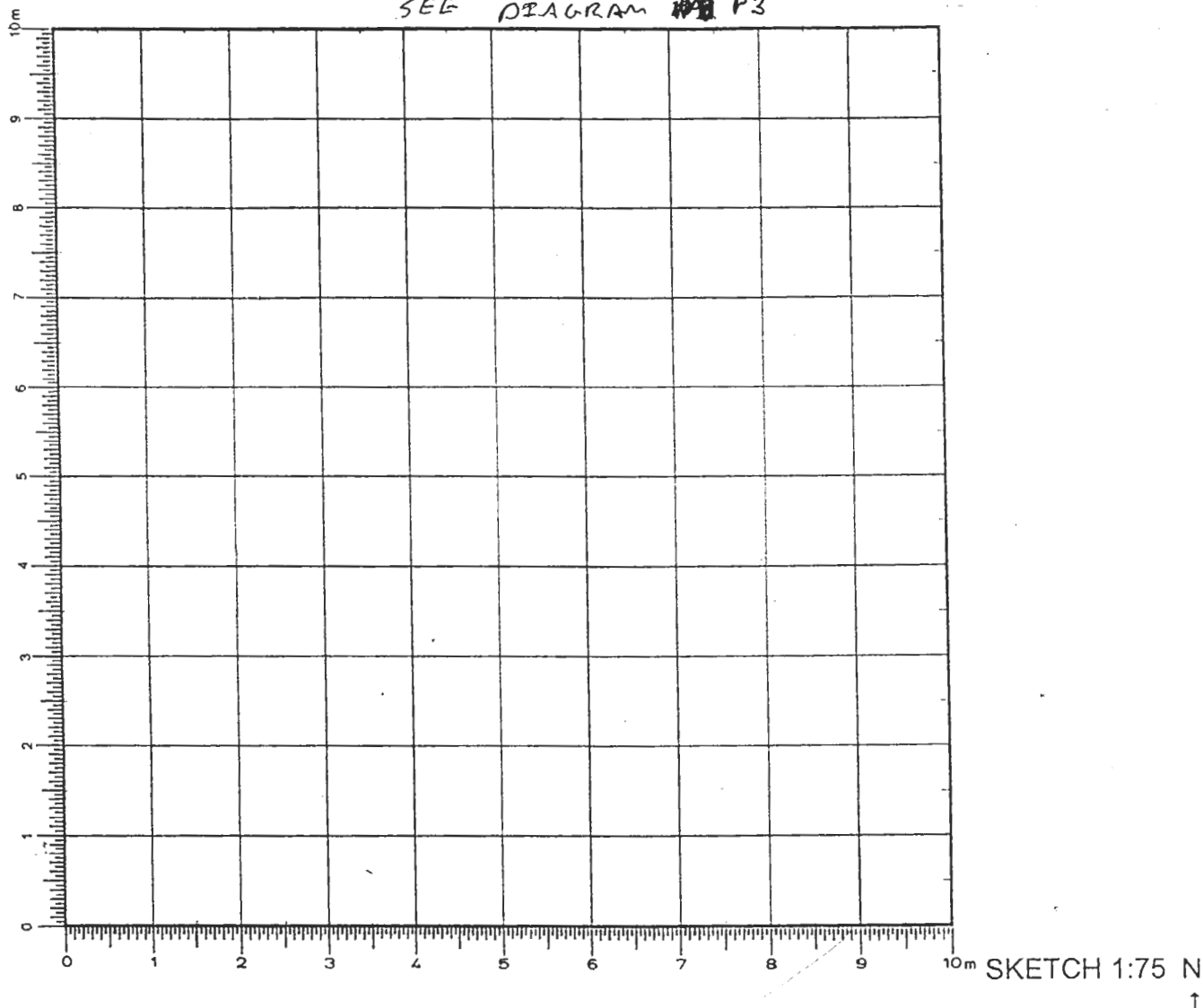
SEE DIAGRAM ~~10~~ P3

DEFINITION/DESCRIPTION of LOCUS (explain why you changed locus numbers):

Today's date: 9 JUNE 04Locus above: B1513

Locus parameters: THE ~~WESTERN~~ PORTION OF B1500 BOUNDED ON THE NORTH BY WALL B107, ON THE SOUTH BY WALL B711, ON THE WEST BY THAT PORTION OF B1505 NORTH OF THE STONE BENCH, AND ON THE EAST BY A N-S LINE DRAWN ~15CM WEST OF THE HEARTH. SEE DIAGRAM P3.

Verbal description:

9 JUNE 04 B1514 IS THE ~~WESTERN~~ ARCHAIC FLOOR SURFACE OF THE WESTERN PORTION OF B1500 AS DESCRIBED ABOVE. SURFACE IS GREY, COMPACTED CLAY WITH MANY PEBBLE & SOME FIST-SIZE ROCK INCLUSIONS. FEW POT SHELDS EMBEDDED IN SURFACE, BUT MOST WERE REMOVED AS B1513. WE ARE GOING TO MAKE PASSES OVER THE ARCHAIC FLOOR ~~TO~~ TO BRING THE SURFACE DOWN TO THE LEVEL OF FINAL NEOLITHIC SIMILAR TO THAT IN B700 + B1200.

Locus Interpretative Comments (What do you think this is? DATE your comments, continue on additional pages if necessary):

9 JUNE 04 [PAUL B1514.1] IS OUR INITIAL PASS OVER THE ARCHAIC FLOOR SURFACE. PASS IS ~5CM DEEP, WE ARE REMOVING THE GREY CLAY FLOOR PACKING WITH PEBBLE & SMALL STONE INCLUSIONS. WE ARE COMING DOWN ONTO REDDISH CLAY WITH THIS PASS IN THE NORTHEASTERN PORTION OF THE LOCUS. ALL SOIL REMOVED IS BEING SCREENED 1/4". A STANDARD SOIL SAMPLE WAS TAKEN RANDOMLY FROM B1514.1, 5 LITERS.

AZORIA Project

p.2

Year 04 Trench/Locus B1514 Excavator RJC

Locus/Pottery Pail Number	Weight of Sherds	Number of Sherds	Chronology & Comments
B1514.1	1.695 kg	139 140	Q, ARCHAIC LM III C, ORIENT, ARCHAIC
B1514.2	1.672 kg	139	Q, ARCHAIC
B1514.3	1.135 kg	17	ARCHAIC
B1514.4	1.350 kg	52	LG-EO, LM III C
B1514.5	1.950 kg	112	LATE ARCHAIC, FN, LM III C
B1514.6	1.180 kg	32	LM III C, LG, ARCHAIC

OBJECTS

Object Number	Associated Pottery Pail	Identification (material/form)	Location	Elevation	Catalogue Number
1	B1514.1	Stone Burnisher?	See diagram p 3	?	
2	B1514.2	Stone Burnisher?	See diagram p 3		
3	B1514.2	Sea stone / tool?	See diagram p 3		
4	B1514.2	CHIA STONE FLAKE	1/4" SCREEN		
5	B1514.3	STONE BURNISHER?	Southern end of B1514.3		
6	B1514.5	Stone Burnisher?	See diagram p 5		
7	B1514.5	BURNISHER	DIAGRAM p 5		

ADDITIONAL COLLECTED MATERIAL

Locus/Pottery Pail Number	Bones	Shell	Carbon	Pumice	Soil Sample	Other (specify)
B1514.1	2 ^{std} 1/4"			1	6 ^{std} Int #1-5	
B1514.2	2 ^{std} 1/4"				2 ^{std} Int #6-7	CLIP stone
B1514.3	2 ^{std} 1/4"			1		
B1514.4	2 ^{std} 1/4"				1 ^{std} Int #8	
B1514.5	2 ^{std} 1/4"		1		2 ^{std} Int #8-9	
B1514.6 B1514.6	2 ^{std} 1/4"		1	1		

DESCRIPTION of PROGRESS of EXCAVATION [date each entry and identify associated pottery pail(s)]:

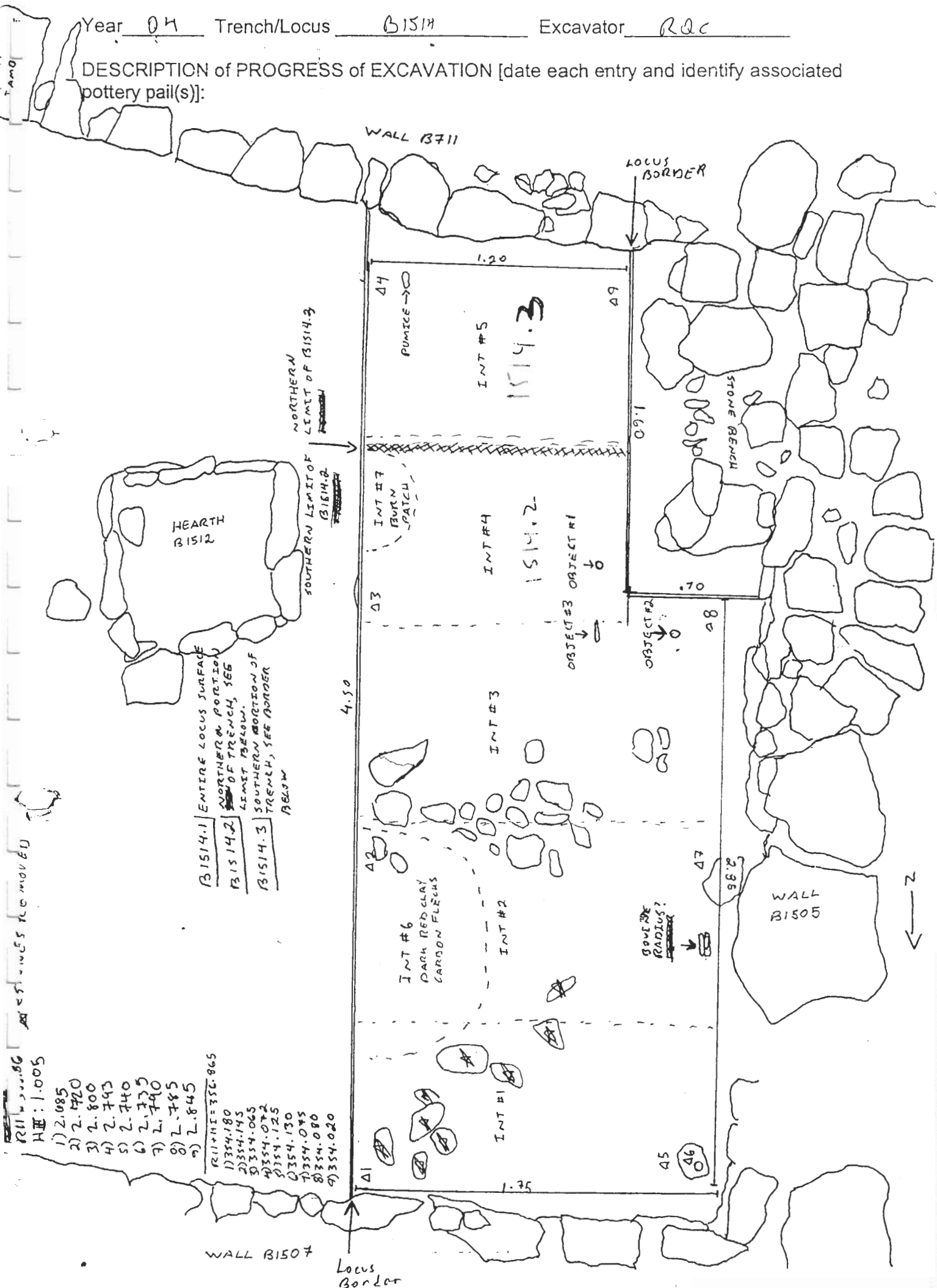

Year 04 Trench/Locus B1514 Excavator ROC

DESCRIPTION of PROGRESS of EXCAVATION [date each entry and identify associated pottery pail(s)]:

NOT SOIL
SAMPLES 1-5
WERE TAKEN
IN THIS
MANNER

9 JUNE 04 AN INTENSIVE SOIL SAMPLE WILL BE TAKEN EVERY METER OF THIS PASS, STARTING IN THE NORTHERN EDGE OF THE LOCUS. EACH INTENSIVE SOIL SAMPLE WILL BE 10 LITERS. SEE DIAGRAM P3 FOR LOCATIONS OF INTENSIVE SAMPLES. A DOOR SWIVEL STONE / COLUMN BASE WAS UNCOVERED IN THE NORTHWESTERN CORNER OF B1514, 15CM DIAMETER, INDENTATION ON WESTERN SIDE OF THE STONE. OBJECT #1 IS A SMOOTH STONE BURNISHER (?) ~3CM IN DIAMETER. SEE DIAGRAM P3 FOR LOCATION. SOIL UNDERNEATH PAIL B1514.1 IS LIGHTER GREYISH RED IN THE NORTHERN PORTION OF THE LOCUS, BECOMING MUCH DARKER RED AS THE LOCUS PROCEEDS SOUTHWARD. SEVERAL FIST-SIZE AND LARGER ROCKS EMBEDDED IN ~~THE~~ SURFACE AT BOTTOM OF B1514.1, POSSIBLE ROCK CONCENTRATION IN CENTRAL PORTION OF LOCUS, SEE DIAGRAM P3. SOIL AT BOTTOM OF B1514.1 APPEARS REDDEST IN CENTRAL PORTION OF LOCUS, LIGHTENING BACK TO GREYISH RED AS WE REACH THE SOUTHERN EDGE OF THE LOCUS. SEVERAL POTSHERDS - COARSE AND FINEWARE - WERE RECOVERED WHILE DIGGING. SEVERAL BONES WERE RECOVERED WHILE DIGGING & WERE BAGGED. ELEVATIONS 1-9 ON P3 ARE THE BOTTOM OF B1514.1 AND THE TOP OF THE STONE DOOR SWIVEL / COLUMN BASE. ONE CHUNK OF PUMICE WAS RECOVERED FROM THE SOUTHEAST CORNER OF THE LOCUS, SEE DIAGRAM P3. SOIL ~~IN~~ B1514.1 FLAKING OFF POSSIBLE SECOND, EARLIER FLOOR. WE THINK THE SURFACE REVEALED BY B1514.1 MAYBE AN EARLIER ARCHAIC SURFACE SIMILAR TO THE EARLIER ARCHAIC SURFACE REACHED IN B724, IN THE TRENCH JUST SOUTH OF THIS ONE. B700. SURFACE EXPOSED BY B1514.1 APPEARS LOWER THAN THE WEST WALL, ABOUT EVEN WITH THE BOTTOM OF THE LOWEST COURSE OF THE NORTH WALL; HIGHER THAN THE LOWEST COURSE OF THE ~~WESTERN~~ WALL. A PORTION OF A SHATTERED ~~BOVINE~~ ^{BOVINE} RADIUS(?) WAS UNCOVERED IN THE CENTRAL ~~WESTERN~~ PORTION OF THE LOCUS. NOT MANY FIST-SIZE OR LARGER STONES EMBEDDED IN GREYISH SOIL ON SOUTHERN PORTION OF LOCUS - POSSIBLE SURFACE AS MENTIONED ABOVE. PAIL B1514.1 WAS COMPLETED & CLOSED, SURFACE WAS PHOTOGRAPHED.

WITH PAIL B1514.2 WE ARE MAKING ANOTHER SHALLOW PASS ~5CM DEEP OVER THE ENTIRE AREA OF LOCUS B1514. WITH THIS PASS WE WILL CONTINUE TO COME DOWN ON AND DEFINE THE EMBEDDED ROCK CONCENTRATION AND THE RED CLAY THAT APPEARS TO UNDERLIE THE ARCHAIC FLOOR SURFACE. OBJECT #2 IS A SMALL, ROUNDED PEBBLE RECOVERED FROM THE CENTRAL EASTERN PORTION OF THE TRENCH, ~2cm DIAMETER. OBJECT #3 IS AN ELONGATED SEA STONE FROM THE SAME AREA, BROKEN. SEE DIAGRAM P3 FOR LOCATIONS OF OBJECTS. INTENSIVE SOIL SAMPLE #6 IS A 10 LITER SAMPLE FROM DARK RED / CARBON FLECKED SOIL FROM THE WESTERN CENTRAL PORTION OF B1514, SEE DIAGRAM P3. INTENSIVE SOIL SAMPLE #7 IS THE SOIL FROM AROUND AND BELOW A SMALL BURN PATH IN THE WESTERN / SOUTHERN PORTION OF B1514, ~8 LITERS. PAIL B1514.2 WAS NOT COMPLETED ACROSS THE ENTIRE SURFACE OF B1514 TODAY. WE FINISHED THE PASS OVER THE NORTHERN PORTION OF THE LOCUS UP TO ABOUT ONE METER NORTH OF WALL B711, THE SOUTHERN BORDER OF THE LOCUS. SOIL EXPOSED AT BOTTOM OF B1514.2 IS GREYISH TOWARDS THE NORTHERN PORTION OF THE LOCUS, BECOMING VERY DARK RED NORTH ~~OF~~ AND AROUND THE CENTRAL STONE CONCENTRATION. ~~THE~~ SOIL MATRIX IN AND AROUND CENTRAL STONE CONCENTRATION CONSISTS OF PEBBLE TO FIST SIZE STONE INCLUSIONS THICKLY CONCENTRATED. WE ARE TRYING TO LEAVE ALL STONES RELATED TO CENTRAL STONE CONCENTRATION IN SITU AS WE COME DOWN UPON IT. SOIL IN SOUTHERN PORTION OF LOCUS B1514 BECOMES VERY LIGHT GREY TO YELLOWISH IN THE MATRIX AND BELOW B1514.2. TOMORROW THE REMAINDER OF SOIL IN THE SOUTHERN PORTION OF B1514 WHICH WOULD HAVE BEEN TAKEN AS PART OF B1514.2 WILL BE TAKEN AS B1514.3.

10 JUNE 04 TODAY WE BEGIN BY REMOVING THE REMAINING SOIL FROM OUR PASS B1514.2 YESTERDAY. B1514.3 WILL COMPLETE PASS B1514.2 FROM YESTERDAY BY REMOVING ABOUT ~5CM OF SOIL FROM THE AREA ABOUT ONE METER NORTH OF WALL B711 TO WALL B711, SEE DIAGRAM P3. SOIL REMOVED IN B1514.3 IS GREYISH / BROWN, WE HAVE NOT YET REACHED THE DARK RED CLAY THAT UNDERLIES THE ARCHAIC FLOOR. ALL SOIL REMOVED WILL BE SCREENED 1/4". SOIL MATRIX IS SMALL PEBBLES, POTSHERDS, AND A FEW PIECES OF BONE. B1514.3 WAS COMPLETED & CLOSED. OBJECT #5 IS STONE BURNISHER FROM SOUTH OF B1514.1. PAIL B1514.4 WILL BE A SHALLOW PASS ~5CM DEEP, SEE DIAGRAM P5. FOR BORDER OF RED CLAY. ELEVATIONS 1-13 ARE OF THE BOTTOM OF B1513.2 & B1513.3, AS WELL AS THE TOPS OF SEVERAL ROCKS EMBEDDED IN THE EXPOSED SURFACE. PAIL B1514.4 BEGAN OVER THE NORTHERN PORTION OF B1514, NORTH OF THE CENTRAL ROCK CONCENTRATION.

DESCRIPTION of PROGRESS of EXCAVATION [date each entry and identify associated pottery pile(s)]:

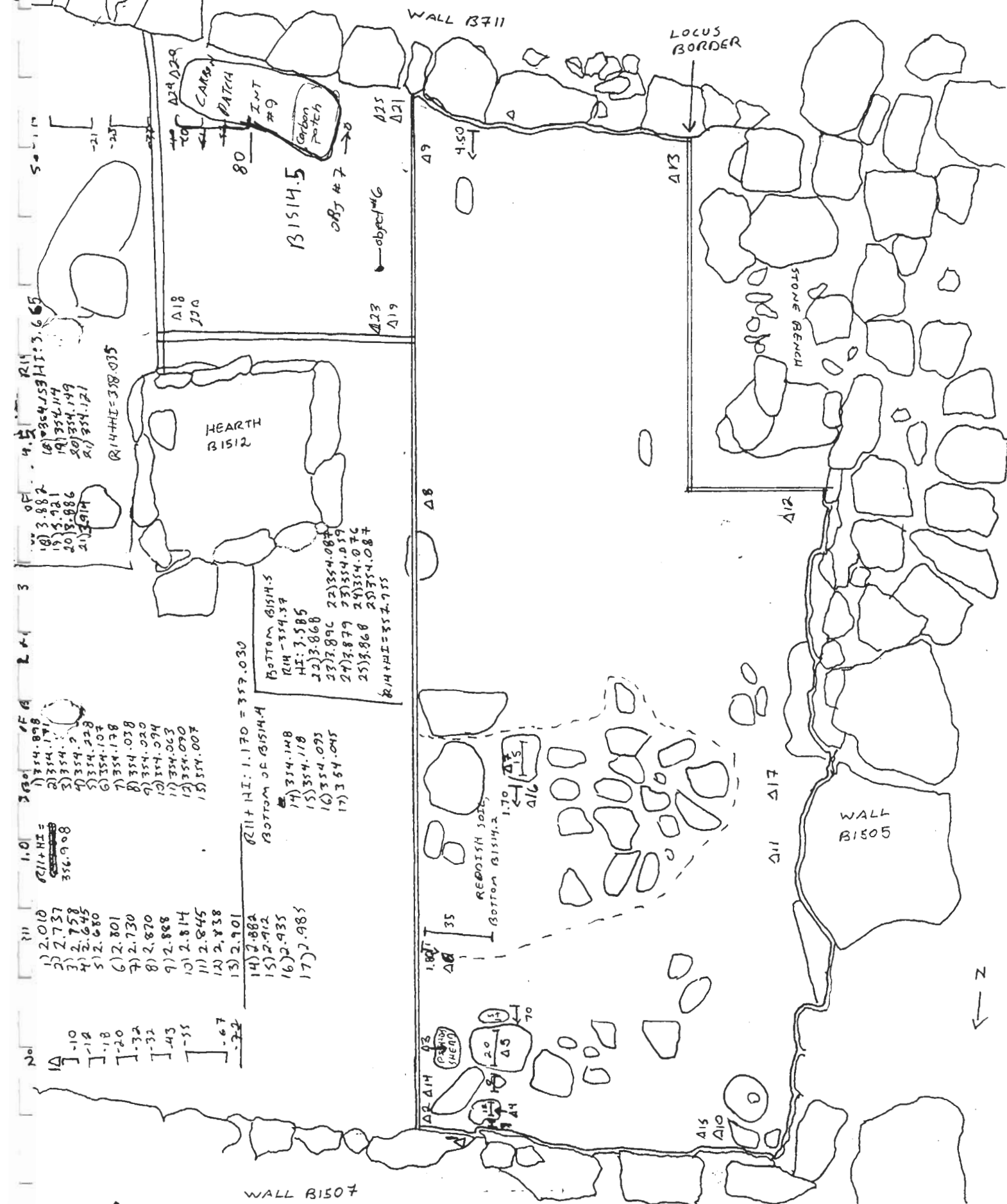

Year 04 Trench/Locus B1514 Excavator RQC

DESCRIPTION of PROGRESS of EXCAVATION [date each entry and identify associated pottery pail(s)]:

10 JUNE 04 ABOUT 5 CM OF SOIL WAS REMOVED OVER THIS AREA, AND A GREY CLAY ARCHAIC SURFACE WAS EXPOSED UNDERNEATH. THIS SURFACE IS THOUGHT TO BE A THIRD ARCHAIC SURFACE CONTEMPORARY WITH THE SURFACE EXPOSED AT THE BOTTOM OF B1514.2 + B1514.3 IN THE SOUTHERN PORTION OF THE TRENCH. THE LINEAR ACCUMULATION OF STONES IN THE ~~NORTH~~ NORTHEASTERN PORTION OF THE TRENCH WAS FOUND TO BE ROCK TUMBLE RESTING ON THE THIRD ARCHAIC SURFACE. THESE STONES WERE REMOVED TO EXPOSE THE THIRD ARCHAIC SURFACE IN THAT AREA. REMOVED STONES ARE MARKED WITH A X ON P.5. ALL SOIL REMOVED FROM B1514.4 WAS SCREENED 1/4" BONE + POTTERY SHERDS WERE RECOVERED AND BAGGED. SOIL REMOVED IN B1514.4 REVEALED TWO THRESHOLD STONES WEST OF DOOR PIVOT STONE IN THE NW CORNER OF B1514.4, PIVOT STONE APPEARS TO BE RESTING ON THIRD ARCHAIC SURFACE REVEALED BY B1514.2, B1514.3, + B1514.4. THE CENTRAL STONE CONCENTRATION SURROUNDED BY VERY DARK RED CLAY IS THOUGHT TO BE ERODED BEDROCK THAT CUTS THROUGH THE 2ND AND 3RD ARCHAIC SURFACES. THIS CONCENTRATION IS THOUGHT TO HAVE BEEN CONSOLIDATED AT THE TIME THE 2ND + 3RD ARCHAIC FLOORS WERE CONSTRUCTED, AND THE ARCHAIC SURFACES CONSTRUCTED AROUND IT. AFTER B1514.4 WAS COMPLETED, THE SURFACE OF BOTTOM OF B1514 (THE POSSIBLE THIRD ARCHAIC FLOOR) WAS SWEEP AND PHOTOGRAPHED. THE SOIL AT THE BOTTOM OF B1514 (POSS. ARCHAIC FLOOR) WILL BE REMOVED AS B1515. ELEVATIONS 14-19 ARE THE BOTTOM OF B1514.4.

16 JUNE 04 TODAY WE ARE EXTENDING B1514 OVER THE AREA DIRECTLY SOUTH OF THE STONE HEARTH IN B1500, SEE DIAGRAM P.5 FOR LOCATION OF EXTENSION.
 PAIL B1514.5 WILL REMOVE 15CM OF SOIL FROM THE SURFACE OF THE FIRST ARCHAIC FLOOR TO EXPOSE THE 2ND ARCHAIC SURFACE FOUND AT THE BOTTOM OF B1514.1. SOIL REMOVED IN THIS PAIL IS SAME AS B1514.1, GREY CLAY FLOOR PACKING INCLUDED WITH POTTERY AND BONE. A 10 LITER SOIL SAMPLE WAS TAKEN FROM RANDOM 1/4" SOIL REMOVED IN B1514.5. SURFACE OF B1514.1 WAS EXPOSED SINCE 2003 EXCAVATION SEASON. OBJECTS #6 + 7 ARE ~~2~~ POLISHED FLAT STONES, POSSIBLE BURNISHERS? BOTH 13CM DIAMETER, SEE DIAGRAM P.5 FOR LOCATION. LARGE CARBON PATCH REMOVED FROM SOUTHERN PORTION OF PAIL B1514.5 AREA, SEE DIAGRAM P.5 FOR LOCATION. MANY POT SHERDS + BONES RECOVERED WHILE EXCAVATING. ALL SOIL REMOVED WAS SCREENED 1/4" CARBON CHUNKS > 1CM IN DIAMETER WERE RECOVERED FROM THE CARBON PATCH + BAGGED SEPARATELY. ALL SOIL REMOVED FROM CARBON PATCH WAS TAKEN AS INT SOIL SAMPLE #9, 10 LITERS. SURFACE EXPOSED UNDER B1514.5 IS VERY SMOOTH AND REGULAR PACKED GREY CLAY, WHICH REPRESENTS THE TOP OF THE 2ND ARCHAIC FLOOR SURFACE. SOME PEBBLES EMBEDDED IN SURFACE, CARBON FLECKS + POTTERY EMBEDDED. SURFACE EXPOSED AT BOTTOM OF B1514.5 WAS SWEEP + PHOTOGRAPHED, PAIL B1514.5 WAS COMPLETED + CLOSED.

PAIL B1514.6 CONTINUES TO TAKE DOWN THE SURFACE EXPOSED BY B1514.5, 15CM DEEP PASS REMOVING SECOND ARCHAIC SURFACE AND PACKING BENEATH IN SAME AREA AS B1514.5 ON DIAGRAM P.5. SOIL MATRIX IS REDDISH/GREY CLAY WITH PEBBLE INCLUSIONS, POTTERY, BONE, + CARBON ALSO INCLUDED. TOPS OF EMBEDDED STONES FIRST-SIZE AND LARGER EXPOSED AT THE BOTTOM OF PASS. SOIL REDDEST IN + AROUND EMBEDDED STONES. GREYISH, REGULAR SURFACE EXPOSED IN B1514.6 AREA WEST OF LINEAR EMBEDDED STONES. POSSIBLY THIRD ARCHAIC SURFACE LIKE THAT AT TOP OF B1515.1. BOULDER UNDERNEATH PLAKA EAST OF BOTTOM OF B1514.6, IF IT IS A 3RD ARCHAIC SURFACE, IS THOUGHT TO BE SAME SURFACE AS THE SURFACE THE NW DOOR PIVOT IS RESTING ON, SAME AS TOP OF B1515.1.

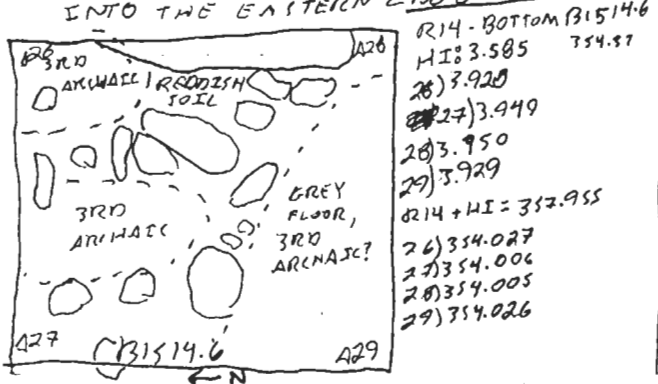

Year 04 Trench/Locus B1515 Excavator RLC

Elevations

Benchmark used:

Reading on

Benchmark:

H.I.:

SEE DIAGRAM P3.

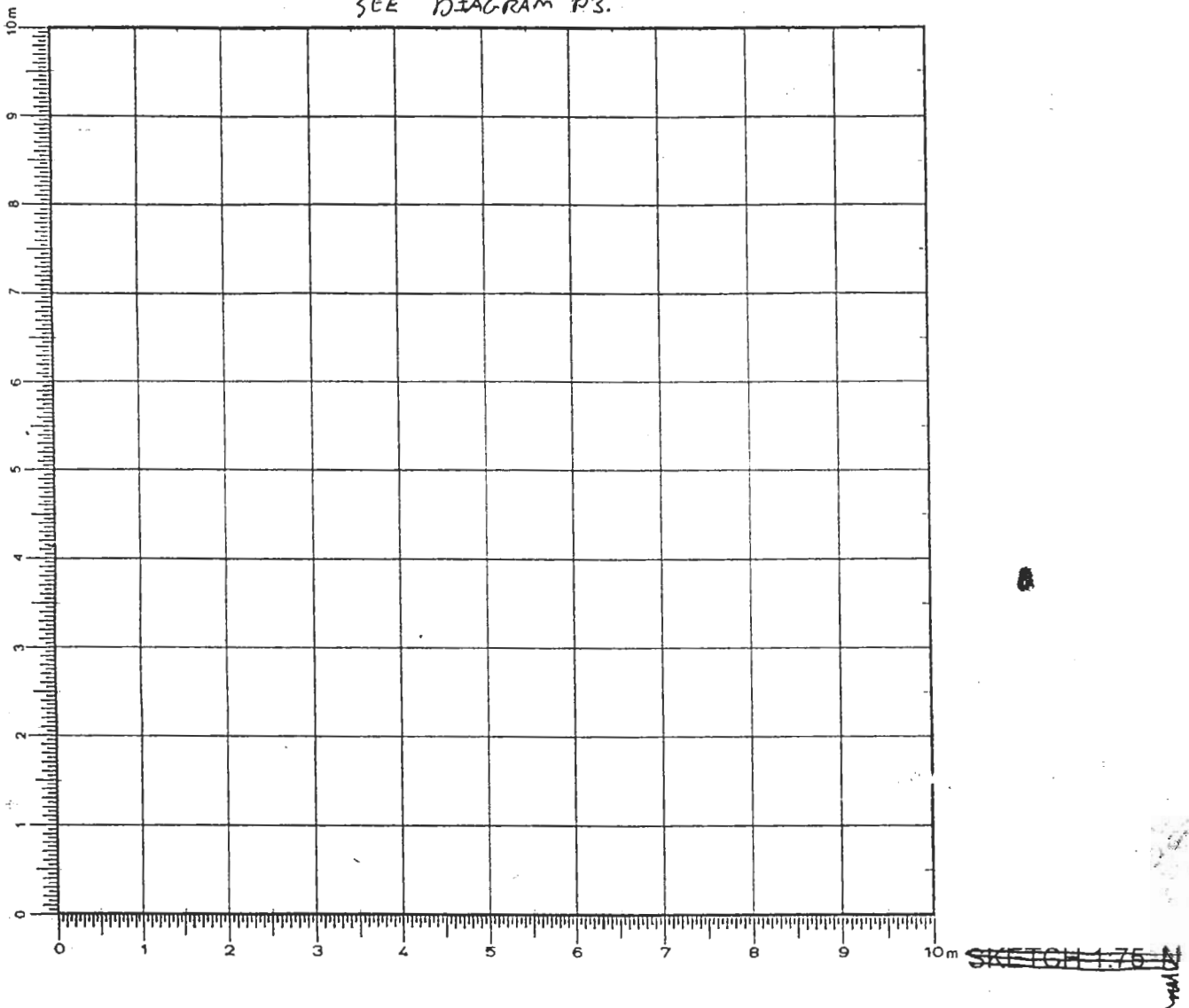

DEFINITION/DESCRIPTION of LOCUS (explain why you changed locus numbers):

Today's date: 10 JUNE 04Locus above: B1514

Locus parameters: BORDERED ON NORTH BY WALL B1507, ON WEST BY WALL B1505, ON SOUTH BY WALL B1711, AND ON EAST BY A LINE DRAWN ~20cm WEST OF HEARTH B1512.
SEE DIAGRAM P3. (ACTUALLY EIA/LMIC)

Verbal description: B1515 IS THE THIRD ARCHAIC FLOOR SURFACE WE HAVE UNCOVERED IN B1500. IT WAS OVERLAIN BY TWO OTHER ARCHAIC FLOORS COMPRISED OF GREY CLAY, HARD-PACKED, WITH PEBBLE & EMBEDDED PIST-SIZE ROCK INCLUSIONS. THE FLOOR SURFACE IS BROKEN IN THE CENTRAL PORTION OF THE LOCUS BY A STONE CONCENTRATION SURROUNDED BY RED CLAY, THIS IS THOUGHT TO BE AN OUTCROP OF ERODED BEDROCK AROUND WHICH THE FLOOR WAS BUILT.

Locus Interpretative Comments (What do you think this is? DATE your comments, continue on additional pages if necessary): 10 JUNE 04

PALL B1515.1 IS A ~5CM PASS OVER THE PORTION OF THE LOCUS NORTH OF THE CENTRAL STONE CONCENTRATION IN B1515. SOIL MATRIX IS GREY BECOMING MORE REDDISH TOWARDS THE BOTTOM OF THE PASS, INCLUSIONS OF PEBBLES, SOME POTTERY SHERDS, SOME BONE. ALL SOIL REMOVED IS BEING SCREENED 1/4". OBJECT #1 IS A ROUNDED STONE BURNISHER (?) ~5cm DIAMETER PULLED FROM DIRT FROM THE NORTHERN PORTION OF B1515.1. PASS SHALLOWS TO ~3-5 CM ON EASTERN EDGE OF THE LOCUS, VERY RED SOIL REVEALED UNDER NEATH. ON WESTERN

Year 04 Trench/Locus B1515 Excavator RQC

Locus/Pottery Pail Number	Weight of Sherds	Number of Sherds	Chronology & Comments
B1515.1	.240kg	43	LG-EO, LM ^{III} C
B1515.2	.295kg	54	LG-EO, LM ^{III} C
B1515.3	.240kg	10	LM ^{III} C
B1515.4	.265kg	14	LG-EO, LM ^{III} C
B1515.5	.200kg	34	ARCHAIC, LG, LM ^{III} C
B1515.6	.130kg	10	LM ^{III} C + ?
B1515.7	.120kg	28	LG-EO, LM ^{III} C
B1515.8	.310kg	20	ARCHAIC, LG, LM ^{III} C

OBJECTS

Object Number	Associated Pottery Pail	Identification (material/form)	Location	Elevation	Catalogue Number
1	B1515.1	Stone Burnisher	Northern portion B1515.1		
2	B1515.2	Polished Stone	SCREEN SCREEN		
3	B1515.6	CLEAR POLISHED STONE	EASTERN EDGE B1515.6, SCREEN		
4	B1515.8	CHIP STONE FLAKE, RETOUCH?	SCREEN		

ADDITIONAL COLLECTED MATERIAL

Locus/Pottery Pail Number	Bones	Shell	Carbon	Pumice	Soil Sample	Other (specify)
B1515.1	2 ^{std} 1/4"				1 ^{std}	
B1515.2	2 ^{std} 1/4"					
B1515.3	2 ^{std} 1/4"					
B1515.4	2 ^{std} 1/4"				1 INT #1	
B1515.5	2 ^{std} 1/4"					
B1515.6	2 ^{std} 1/4"					
B1515.7	2 ^{std} 1/4"				2 INT #2+3	
B1515.8	2 ^{std} 1/4"			1	1 INT #4	

Year 04 Trench/Locus B1515 Excavator RLC

DESCRIPTION of PROGRESS of EXCAVATION [date each entry and identify associated pottery pair(s)]:

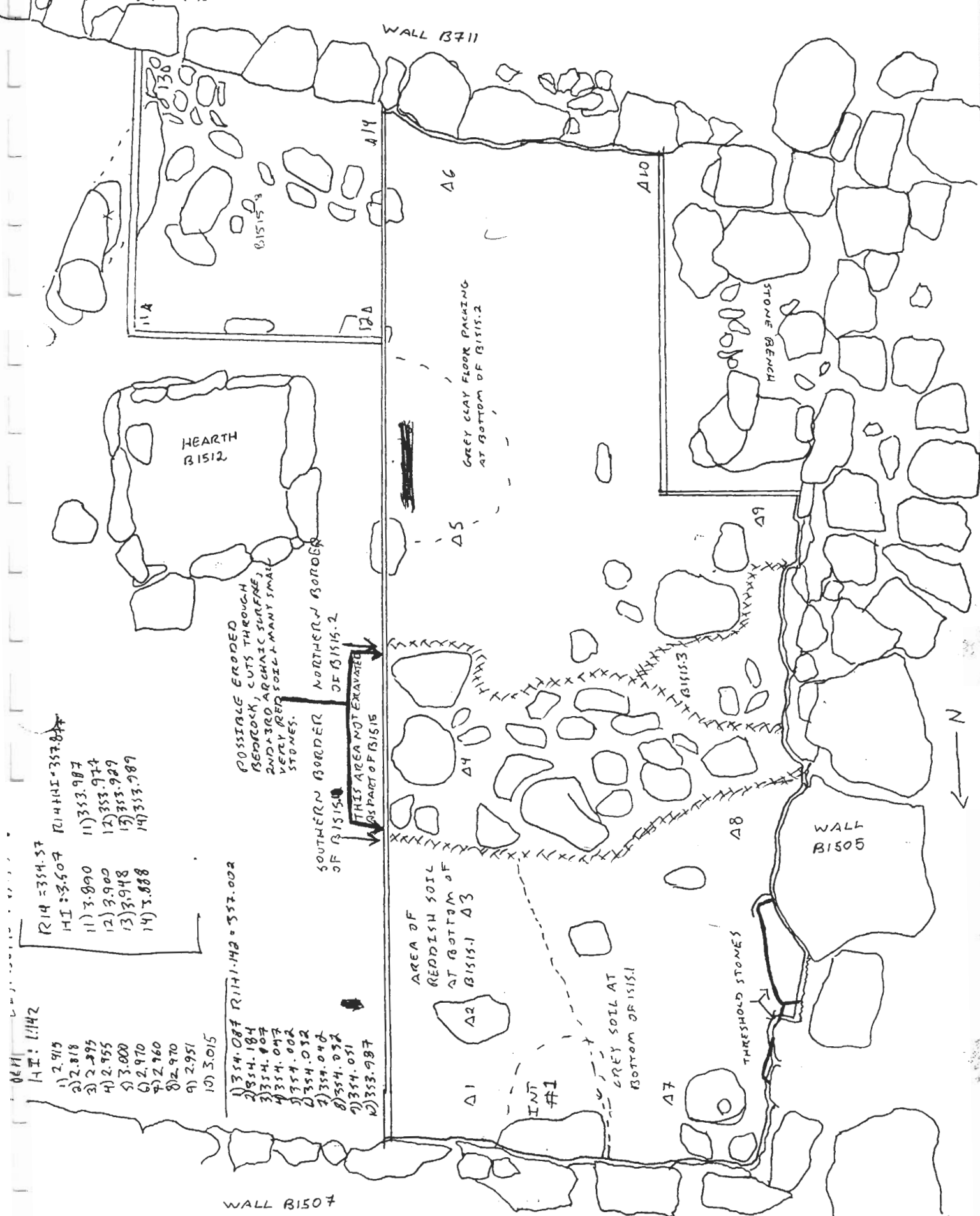

Year 04 Trench/Locus B1515 Excavator RAC

DESCRIPTION of PROGRESS of EXCAVATION [date each entry and identify associated pottery pail(s)]:

10 JUNE 04 | EDGE OF LOCUS; GREYISH SOIL CONTINUES TO UNDERLIE THE BOTTOM OF B1515.1. SURFACE REVEALED BY B1515.1 HAS MANY ROCK & PEBBLE INCLUSIONS (ROCKS) OF ABOUT FIST-SIZE. WE ARE NOW BELOW THE BOTTOM OF THE DOOR PIVOT IN THE NORTHWEST CORNER OF B1515. WE ARE CONTINUING TO COME DOWN ON THE TOP & SIDES OF TWO THRESHOLD STONES REVEALED IN B1514.4. ~~OBJECT #1 FROM THE NORTHERN PORTION OF B1515.1 IS A STONE~~ SEE DIAGRAM P.3. FOR LOCATION OF B1515.1 AND AREAS OF GREYISH SOIL REMAINING UNDERNEATH. PAIL 1515.1 WAS COMPLETED & CLOSED. A STANDARD SOIL SAMPLE WAS TAKEN OF 1515.1, 5 LITERS.

PAIL B1515.2 IS A PASS OVER THE SOUTHERN PORTION OF B1515, SOUTH OF THE CENTRAL STONE CONCENTRATION, SEE DIAGRAM P.3. 4-7 CM OF GREY ARCHAIC SURFACE CLAY WITH PEBBLE INCLUSIONS WAS REMOVED, FROM THE SOUTHERN ~~BORDER~~ BORDER OF B1515 TO THE EDGE OF THE CENTRAL STONE CONCENTRATION AND THE REDDISH SOIL SURROUNDING IT. SOIL MATRIX WAS GREY CLAY FLOOR PACKING WITH PEBBLE & POTTERY INCLUSIONS, SOME BONE ALSO RECOVERED. ALL SOIL REMOVED WAS SCREENED 1/4". SURFACE REVEALED AT BOTTOM OF B1515.2 IS GREYISH CLAY IN THE CENTRAL PORTION OF THE PAIL BECOMING REDDISH TOWARDS THE SOUTHERN BORDER & THE CENTRAL STONE CONCENTRATION. OBJECT #2 IS A SMALL POLISHED STONE RECOVERED FROM THE SCREEN FROM SOIL IN THE SOUTHERN PORTION OF B1515.2, STONE IS 1 CM DIAMETER. WE ENDED THE DAY WITH SOME GREYISH SOIL ^{LEFT} OVER THE EASTERN PORTION OF THE LOCUS, JUST EAST OF THE CENTRAL STONE CONCENTRATION, THIS PORTION OF GREY SOIL WILL BE TAKEN DOWN TO THE SAME LEVEL AS BOTTOM OF B1515.2 TOMORROW, PAIL WILL BE CALLED B1515.3. WE WILL THEN CONTINUE MAKING PASSES OVER THE PORTIONS OF THE SURFACE WHERE THE GREY CLAY FLOOR PACKING REMAINS UNTIL WE BRING THE SURFACE DOWN TO THE REDDISH SOIL UNDERNEATH.

11 JUNE 04 | WE BEGAN TODAY WITH PAIL B1515.3 OVER SOME REMAINING HIGHER GREY CLAY JUST WEST OF THE CENTRAL STONE CONCENTRATION. SEE DIAGRAM P.3 FOR PAIL LOCATION. PAIL B1515.3 WAS 3-5 CM DEEP, SOIL REMOVED WAS GREY CLAY WITH MANY PEBBLE INCLUSIONS COMING DOWN ON REDDISH-GREY SOIL WITH EMBEDDED FIST-SIZE & LARGER STONES. PAIL 1515.3 WAS COMPLETED & CLOSED, ALL SOIL REMOVED WAS SCREENED 1/4", SOME POTTERY & BONE WAS RECOVERED WHILE DIGGING.

PAIL B1515.4 IS A 3-7 CM PASS OVER THE REMAINING GREY CLAY IN THE PORTION OF B1515 NORTH OF THE CENTRAL STONE CONCENTRATION. SOUTHERN BORDER OF B1515.4 IS SAME AS SOUTHERN BORDER OF B1515.1 ON DIAGRAM P.3, PASS IS DEEPEST IN THE WESTERN PORTION OF THE LOCUS, WHERE THE GREY CLAY IS ~5 CM DEEP, PASS SHALLOWS TO 2-3 CM IN THE EASTERN PART OF THE LOCUS, ENDING ~20 CM WEST OF THE EASTERN LOCUS BORDER, WHERE THE RED SOIL UNDERNEATH THE ARCHAIC SURFACE HAD ALREADY BEEN EXPOSED BY B1515.1. WE HAVE PLACED A SCARP AROUND THE DOOR PIVOT IN THE NW CORNER OF THE LOCUS SO THAT IT WILL NOT BE DISTURBED BY FURTHER EXCAVATION. INTENSIVE SOIL SAMPLE #1 IS ~8 LITERS OF GREY/RED SOIL HEAVILY FLECKED WITH CARBON FROM THE AREA JUST SOUTH OF THE LARGE EXPOSED STONE AT THE BOTTOM OF NORTH WALL B1507, SEE DIAGRAM P.3. PAIL B1515.4 WAS COMPLETED & CLOSED, ALL SOIL SCREENED 1/4", BONE & POTTERY RECOVERED ~~WHILE~~ WHILE EXCAVATING.

PAIL B1515.5 IS A PASS OF 4-5 CM OVER THE PORTION OF THE TRENCH SOUTH OF THE CENTRAL STONE CONCENTRATION. NORTHERN BORDER OF B1515.5 IS ABOUT THE SAME AS NORTHERN BORDER OF 1515.2 & 1515.3. PASS PROCEEDS SOUTH TO WALL B711. WE ARE REMOVING GREYISH ARCHAIC FLOOR PACKING DOWN TO THE DARK RED SOIL BELOW, SOIL MATRIX IS PEBBLE ~~AND~~ SMALL STONE INCLUSIONS, SOME POTTERY & BONE RECOVERED DURING EXCAVATION, ALL SOIL SCREENED 1/4". PAIL B1515.5 WAS COMPLETED & CLOSED. SURFACE EXPOSED UNDERNEATH IS BECOMING DARKER RED, CARBON-FLECKED, SURFACE EXPOSED IS RELATIVELY SMOOTH, NOT MANY LARGE EMBEDDED ROCKS IN SOUTHERN PORTION OF TRENCH. INTENSIVE SOIL SAMPLE #2 IS GREY/RED SOIL, CARBON FLECKED, FROM THE BOTTOM OF ARCHAIC

Year 04 Trench/Locus B1515 Excavator R2C

DESCRIPTION of PROGRESS of EXCAVATION [date each entry and identify associated pottery pail(s)]:

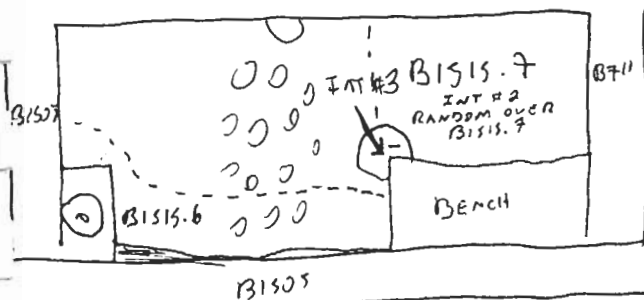
11 JUNE 04 ~~FLOOR PATCHING, SEE DIAGRAM P.3 FOR LOCATION~~

PAIL B1515.6 IS A SHALLOW PASS, 3-4 CM, OVER THE EDGE OF THE WESTERN PORTION OF B1515 ABOUT 40 CM EAST OF WALL B1505 UP TO WALL B1505, SEE DIAGRAM TO LEFT. WITH THIS PASS WE ARE REMOVING ~~THE~~ THE REMAINING GREYISH RED SOIL TO GET DOWN TO THE DARK RED SOIL UNDERNEATH. SOIL MATRIX IS GREYISH/RED WITH PEBBLE INCLUSIONS, COMING DOWN ON COBBLE-SIZE AND SMALLER STONES EMBEDDED UNDERNEATH.

OBJECT #3 IS A CLEAR POLISHED STONE ~1 CM DIAMETER PULLED FROM THE SCREEN FROM B1515.6. AS B1515.6 CONTINUES, WE ARE GOING DEEPER TOWARDS THE RED CLAY (~10 CM) TOWARDS THE WESTERN EDGE OF B1515. B1515.6 WILL INCLUDE SOIL FROM ALL REMAINING GREY CLAY PATCHES IN THE PORTION OF THE LOCUS NORTH OF THE NORTHERN EDGE OF THE STONE BENCH. B1515.6 STILL COMING DOWN ON FIRST SIZE AND SOME LARGER COBBLES ON WESTERN EDGE OF B1515.

★ DUE TO AN ERROR AT THE SCREEN, THE FIRST 3 ZEMBILIA OF SOIL FROM B1515.6 WERE ADDED TO BAGS 1515.5. THIS MEANS BONE & POTTERY BAGS FROM 1515.5 MAY INCLUDE MATERIAL RECOVERED FROM THE SOIL EXCAVATED AS B1515.6.

WITH PAIL B1515.6 WE ARE EXPOSING SEVERAL LARGE BOULDERS UNDERNEATH WALL B1505, WE ARE ALSO COMING DOWN ON AND DEFINING THE ~~WESTERN~~ WESTERN PORTION OF THE CENTRAL ROCK CONCENTRATION, SEVERAL BOULDERS (200+ CM DIAMETER) EXPOSED UNDERNEATH WEST PORTION OF CONCENTRATION, AS WELL AS MANY EMBEDDED COBBLE-SIZE STONES. PAIL B1515.6 WAS COMPLETED AND CLOSED, ONE ZEMBILIA WAS SCREENED FROM THE AREA, SEE NOTE ABOVE. SOME POTTERY & BONE RECOVERED DURING EXCAVATION, SURFACE EXPOSED IS DARK RED CLAY WITH MANY STONES EMBEDDED IN SURFACE.

PAIL B1515.7 IS ANOTHER SHALLOW (3-5 CM) PASS OVER THE PORTION OF B1515 ~~WEST~~ EAST OF THE STONE BENCH, REMOVING THE LAST BITS OF TRANSITIONAL GREY/RED SOIL TO COME DOWN ON THE ~~VERY~~ DARK RED SOIL BENEATH. FILL IS GREY/RED WITH SMALL PEBBLE INCLUSIONS & CARBON FLECKS. A 10 LITER INTENSIVE SOIL SAMPLE (#2) WAS TAKEN FROM SOIL REMOVED IN B1515.7. SEE DIAGRAM ABOVE FOR PAIL LOCATION. INTENSIVE SOIL SAMPLE #3 IS A SMALL CARBON/ASH PATCH JUST NE OF STONE BENCH, SEE DIAGRAM ABOVE, LARGE FLECKS OF CARBON INCLUDED IN SURFACE, SAMPLE IS 5 LITERS. ONE KNUCKLE BONE EMBEDDED IN SURFACE ABOVE AREA OF INTENSIVE #3. REMOVAL OF SOIL FROM B1515 HAS REVEALED WHAT APPEARS TO BE A HEAVILY PEBBLE & COBBLE-INCLUDED TRANSITIONAL AREA BETWEEN THE BOTTOM OF THIRD ARCHAEAL FLOOR SURFACE & FINAL NEOLITHIC LEVELS IN DARK RED SOIL SIMILAR TO THAT REVEALED IN THE FINAL TRANSITIONAL ARE B700 & B1200. THE LAST PASSES COMING DOWN ONTO THIS TRANSITIONAL ARE NOT HEAVILY INCLUDED WITH BONE OR POTTERY, SOME CARBON FLECKS EMBEDDED, PARTICULARLY IN SOUTHERN PORTION OF TRENCH. SEVERAL LARGE BOULDERS UNDERLYING WALL B1505 HAVE BEEN EXPOSED THROUGH REMOVAL OF B1515. THESE LIE IN A NORTH-SOUTH LINE UNDER AND ~10 CM TO THE EAST OF THE LOWEST COURSE OF ~~B1505~~ B1505. POSSIBLE TOP OF NEOLITHIC WALL? ANOTHER FEATURE HAS BEEN REVEALED, A CIRCULAR (?) ARRANGEMENT OF UPRIGHT STONES IN THE WESTERN PORTION OF THE CENTRAL STONE CONCENTRATION WITH A CENTRAL AREA ~15 CM IN DIAMETER CLEAR OF ROCK & PEBBLE INCLUSIONS. SOIL REMOVED FROM ABOVE THIS AREA IN B1515.6 REVEALS A LIGHT GREY SURFACE IN THE CENTRAL PORTION OF THE FEATURE WITH SMALL CARBON FLECKS, POSSIBLE SMALL HEARTH? PAIL B1515.7 WAS COMPLETED, CLOSED, SURFACE OF TRENCH WAS SWEEP AND PHOTOGRAPHED. ~~★ PAIL B1515.7~~

Year 04 Trench/Locus B1515 Excavator RJC

DESCRIPTION of PROGRESS of EXCAVATION [date each entry and identify associated pottery pail(s)]:

16 JUNE 04

PAIL B1515.8 IS AN EXTENSION OF THE B1515 LOCUS INTO THE AREA JUST SOUTH OF THE CENTRAL HEARTH, SEE DIAGRAM P.3 FOR LOCATION. WITH B1515.8 WE ARE REMOVING ~5CM OF RED CLAY AND PEBBLE INCLUSIONS EXPOSED AT THE BOTTOM OF B1514.6. THIS SOIL IS THOUGHT TO BE THE TOP OF THIRD ARCHAIC SURFACE AND PACKING UNDERNEATH. SURFACE OF B1515.8 SAME AS SURFACE OF B1515.1. SOIL MATRIX DARK REDDISH IN SOUTHERN PORTION OF B1515.8, MORE GREYISH IN NORTHERN SECTION, INCLUDED WITH PEBBLES & CARBON FLECHS, POSSIBLE FLOOR PACKING. EMBEDDED ROCKS IN SURFACE OF B1515.8 ARE BEING DEFINED WITH THIS PASS, POSSIBLE TOP OF STONE CONCENTRATION/ LINEAR ACCUMULATION. SOME GREYISH, CARBON-FLECHED SOIL EXPOSED AT BOTTOM OF PAIL, REDDISH AROUND STONE ACCUMULATION. FIRST SIZE & LARGER STONES EMBEDDED IN BOTTOM OF B1515.8. SEVERAL LARGER STONES, 720 CM EMBEDDED AS WELL. SOIL TOWARDS BOTTOM OF PASS HEAVILY INCLUDED WITH COBBLE-SIZE STONES, MANY PEBBLES, SOIL IN A STONE MATRIX IN SE CORNER OF B1515.8 GREYISH, POSSIBLE FLOOR PACKING? GREYISH/RED SOIL EXPOSED ELSEWHERE ON SURFACE. E-W LINEAR ACCUMULATION OF STONES EXPOSED, POSSIBLE FEATURE? SOIL MATRIX IN LINEAR ACCUMULATION IS VERY RED CLAY. SURFACE EXPOSED IS POSSIBLE PACKING FOR 3RD ARCHAIC FLOOR/ LMIII SURFACE. BOTTOM OF PASS APPEARS TO BE GETTING MORE STERILE, SOME CARBON FLECKING, VERY HEAVILY FIRST-SIZE STONE EMBEDDED. PAIL B1515.8 WAS COMPLETED, AREA SWEEP & PHOTOGRAPHED. SOME GREYISH/RED PACKING (?) IN BOTTOM OF PAIL REMAINS TO BE REMOVED, WE WILL CONTINUE REMOVING SOIL FROM THE AREA SOUTH OF HEARTH TOMORROW AS B1516.10, COMING DOWN TO EITHER FINAL NEOLITHIC OR POSSIBLE LMIII LEVELS.

Year 04 Trench/Locus B1516 Excavator RQCElevations

Benchmark used:

Reading on

Benchmark:

H.I.:

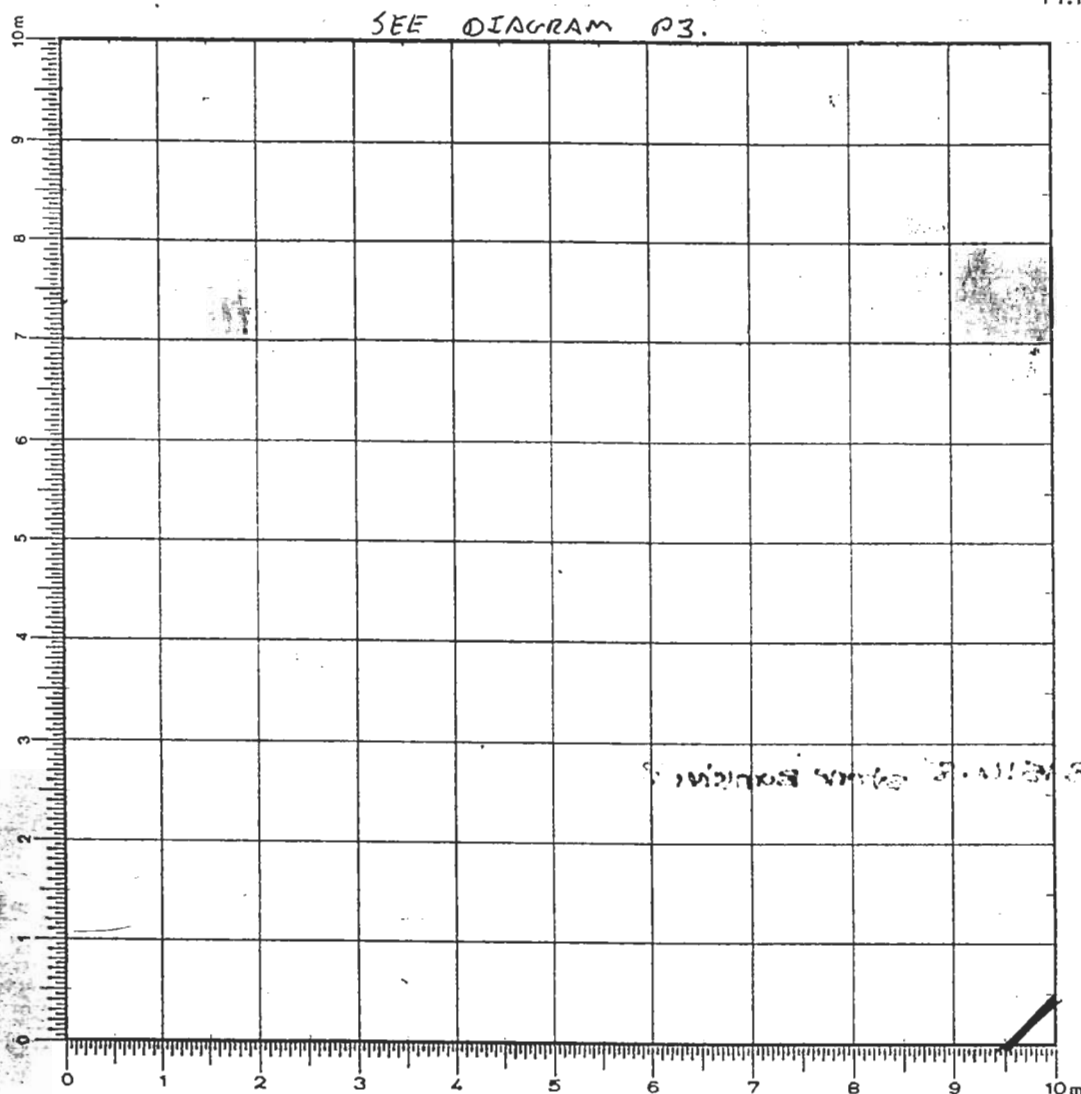

DEFINITION/DESCRIPTION of LOCUS (explain why you changed locus numbers):

Today's date: 14 JUNE 04

Locus above: B1515

Locus parameters: BOUNDED ON NORTH BY WALL B1504, ON SOUTH BY WALL B11, ON WEST BY WALL B1507, AND ON THE EAST BY A SCARP 20 CM WEST OF HEARTH B1512. ALSO BOUNDED BY SCARPS AROUND STONE BENCH IN SOUTH WEST CORNER & DOOR PIVOT IN NORTHWEST CORNER. SEE DIAGRAM P3.

Verbal description:

B1516 IS FLOOR PACKING BENEATH ARCHAIC SURFACE EXCAVATED AS B1515. SURFACE IS DARK RED CLAY INCLUDED VERY HEAVILY BY PEBBLES & COBBLES IN THE NORTHERN PORTION OF THE TRENCH. PEBBLES & COBBLES THOUGHT TO BE FLOOR PACKING ABOVE FINAL NEOLITHIC LEVELS AS IN B3700 & B1200. CENTER OF LOCUS CONSISTS OF STONE CONCENTRATION CUTTING THROUGH ARCHAIC FLOOR SURFACES ABOVE. CIRCULAR STONE FEATURE IN WESTERN PORTION OF CENTRAL STONE CONCENTRATION.

ALR

HW

B.1516

Locus Interpretative Comments (What do you think this is? DATE your comments, continue on additional pages if necessary):

14 JUNE 04 PALL B1516.1 IS A WSCM PASS OVER THE PORTION OF B1516 NORTH OF THE CENTRAL STONE CONCENTRATION. SOIL MATRIX IS RED CLAY VERY HEAVILY INCLUDED WITH PEBBLE & SMALL COBBLE-SIZE ROCKS. WE ARE COMING DOWN ONTO MORE DARK RED CLAY, STILL PEBBLE INCLUDED, QUITE STERILE. ONLY A FEW PIECES OF POTTERY & BONE RECOVERED FROM EXCAVATED SOIL. ALL SOIL REMOVED WAS SCREENED 1/4" SEVERAL LARGER ROCKS EMBEDDED IN BOTTOM OF B1516.1 WERE UNCOVERED, SEE DIAGRAM P3. FOR LOCATION OF B1516.1. B1516.1 WAS COMPLETED & CLOSED.

AZORIA Project

p.2

Year 04 Trench/Locus B1516 Excavator RQC

Locus/Pottery Pail Number	Weight of Sherds	Number of Sherds	Chronology & Comments
B1516.1	.160kg	12	LMIIIc, FN
B1516.2	.190kg	13	LMIIIc, ARCHAIC
B1516.3	.010kg	3	LMIIIc
B1516.4	.370kg	33	LMIIIc, LG, EO
B1516.5	.010kg	1	LMIIIc
B1516.6	.033 kg	3	EIA
B1516.7	.009kg	1	LMIIIc?
B1516.8	.170kg	29	FN, LMIIIc, ARCHAIC
B1516.9	.010kg	1	EIA
B1516.10	.215kg	25	FN, LMIIIc, ARCHAIC
B1516.11	.350kg	18	LMIIIc, ARCHAIC
B1516.12	.170kg	32	FN, LMIIIc, ARCHAIC

B1516.13

NO POTTERY?

OBJECTS

Object Number	Associated Pottery Pail	Identification (material/form)	Location	Elevation	Catalogue Number
1	B1516.8	stone Burnisher?	see pg 16		

ADDITIONAL COLLECTED MATERIAL

Locus/Pottery Pail Number	Bones	Shell	Carbon	Pumice	Soil Sample	Other (specify)
B1516.1	2 1/4" std				1 std	
B1516.2	2 1/4" std					
B1516.3	2 1/4" std					
B1516.4	2 1/4" std					
B1516.5	1 1/4" std					3 INT #1+2+3
B1516.6	2 1/4" std					1 INT #4
B1516.7	2 1/4" std					INT #5
B1516.8	2 1/4" std					1 INT #5
B1516.9	1 1/4" std					
B1516.10	2 1/4" std					
B1516.11	2 1/4" std					1 INT #6
B1516.12	2 1/4" std					1 INT #7
B1516.13	1 1/4" std					

DESCRIPTION of PROGRESS of EXCAVATION [date each entry and identify associated pottery pail(s)]:



Year 04 Trench/Locus B1516 Excavator RAC

DESCRIPTION of PROGRESS of EXCAVATION [date each entry and identify associated pottery pail(s)]:

14 JUNE 04 **PAIL B1516.2** IS A ~50CM PASS OVER THE PORTION OF B1516 SOUTH OF THE CENTRAL STONE CONCENTRATION, SEE DIAGRAM P.3. MATRIX IS RED/GREYISH PEBBLE-INCLUDED SOIL. A 5 LITER STANDARD SOIL SAMPLE WAS TAKEN FROM HIRT IN B1516.1 & B1516.2 ~~THE~~ SURFACE AT BOTTOM OF B1516.2 IS RED/GREYISH PEBBLE-INCLUDED, SOME POTSHERDS + CARBON FLECKS EMBEDDED IN SURFACE. POTTERY + BONE RECOVERY FROM SOIL REMOVED IN B1516.2, ALL SOIL SCREENED 1/4". PAIL B1516.2 WAS COMPLETED & CLOSED.

PAIL B1516.3 IS ANOTHER PASS OVER THE PORTION OF B1516 NORTH OF THE CENTRAL STONE CONCENTRATION, SAME PARAMETERS AS B1516.1 ON P.3. SOIL MATRIX CONTINUES TO BE HEAVILY PEBBLE & COBBLE INCLUDED, WE ARE REMOVING SOIL BETWEEN & AROUND THE LARGE ROCKS EXPOSED IN B1516.1 TO BETTER DEFINE THEM. THIS PAIL WILL ALSO DEFINE THE AREA BORDERING THE STONE CONCENTRATION TO THE NORTH. SOIL REMOVED APPEARS RELATIVELY STERILE; LITTLE POTTERY RECOVERED, FEW PIECES OF BONE RECOVERED WHILE EXCAVATING. MATRIX AT BOTTOM OF B1516.3 BECOMING HEAVILY INCLUDED WITH WHITISH CRUMBLY ROCK, LOOKS LIKE BEDROCK. B1516.3 WAS COMPLETED & CLOSED. SURFACE EXPOSED APPEARS TO BE STERILE ERODED BEDROCK.

PAIL B1516.4 IS A ~10 CM PASS OVER THE PORTION OF B1516 SOUTH OF THE CENTRAL ROCK CONCENTRATION, SAME PARAMETERS AS B1516.2 ON DIAGRAM P.3. SURFACE AT TOP OF PAIL IS STILL GREYISH/RED CLAY FLOOR PACKING, POTTERY, BONE & CARBON FLECK INCLUSIONS & MANY SMALL PEBBLES. WE ARE TAKING THE SURFACE FARTHER DOWN TOWARDS THE DARK RED CLAY UNDERNEATH, WHICH WE THINK MAY BE A CONTINUATION OF FINAL NEOLITHIC AS IN B700. INTENSIVE #1 IS 10 LITERS OF SOIL FROM THE AREA JUST EAST OF THE NORTHERN HALF OF THE STONE BENCH. PASS SHALLOWS AS IT CONTINUES SOUTH, REDDISH CLAY EXPOSED ~3-5 CM UNDER SURFACE OF B1516.4. INTENSIVE #3 IS A 10 LITER SAMPLE FROM THE AREA NE + N OF THE STONE BENCH, CARBON SOURCE TO AROUND 15 CM IN CENTER OF B1516.4 AREA, STILL SOME GREYISH SOIL UNDERNEATH. SOIL MATRIX HEAVILY INCLUDED WITH PEBBLES & COBBLES, PARTICULARLY TOWARDS CENTRAL STONE CONCENTRATION. CLAY REDDER AND CLOSER TO SURFACE TOWARDS CENTRAL STONE CONCENTRATION, PASS SHALLOWS TO ~5CM, SURFACE UNDERNEATH HEAVILY INCLUDED WITH STONE. SOIL REMOVED IN THIS PAIL POSSIBLY REPRESENTS ~~LATE~~ LATE MINDAN SURFACE & PACKING, SOME LM POTSHERDS RECOVERED DURING EXCAVATION. PAIL B1516.4 WAS NOT COMPLETED OVER THE ENTIRE AREA SOUTH OF THE CENTRAL STONE CONCENTRATION TODAY IT WILL BE COMPLETED TOMORROW AS PAIL B1516.5. SEE DIAGRAM BELOW FOR LOCATIONS OF INTENSIVE SOIL SAMPLES FROM B1516.4.

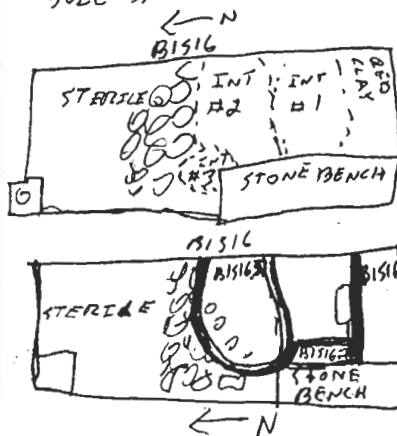

15 JUNE 04 **PAIL B1516.5** IS CONTINUING TO REMOVE GREY CLAY/REDDISH PACKING IN AREAS WHERE IT WAS NOT REMOVED YESTERDAY IN B1516.4 GREY/RED CLAY GOES DEEPEST IN THE AREA WHERE INTENSIVE #1 IS LOCATED ON THE DIAGRAM TO LEFT. TOWARDS CENTRAL STONE CONCENTRATION, RED CLAY WITH EMBEDDED COBBLES EXPOSED. B1516.5 ALSO CLEANED AROUND SCHIST-HEARTED FEATURE JUST NE OF STONE BENCH, AREA SAME AS LOCATION OF INT #3 ON DIAGRAM TO LEFT. SOIL AT BOTTOM OF B1516.5 IS GREYISH/RED, COBBLE & PEBBLE INCLUSIONS, BEDROCK-LIKE WHITISH CRUMBLY STONES COMING UP IN AREA OF STONE CONCENTRATION. NO BONE RECOVERED DURING EXCAVATION, ONE POTSHERD RECOVERED. ALL SOIL REMOVED ~~FOR~~ SCREENED 1/4". B1516.5 COMPLETED AND CLOSED. SEE DIAGRAM TO LEFT FOR LOCATION.

PAIL B1516.6 IS A PASS OVER THE DARK RED CLAY IN THE SOUTHERN PORTION OF B1516, DARK ~~RED~~ RED SOIL BEGINS ~1 METER NORTH OF WALL B711, PASS CONTINUES UP TO WALL, ~5CM DEEP. TOP OF PAIL B1516.6 THOUGHT TO BE A POSSIBLE LATE MINDAN SURFACE

Year 04Trench/Locus B1516Excavator RCC

DESCRIPTION of PROGRESS of EXCAVATION [date each entry and identify associated pottery pail(s)]:

15 JUNE 04:

CONTEMPORARY WITH POSSIBLE SURFACE REMOVED IN B1516.4. ~~SEE~~ SOIL MATRIX OF B1516.6 DIFFERENT FROM B1516.4, BURNT HARD-PAKED STERILE-RED CLAY, CRUMBLY, NO GREYISH SOIL MIXED WITHIN, NO APPARENT POTTERY OR BONE INCLUDED IN MATRIX. ALL SOIL REMOVED SCREENED 1/4". INTENSIVE SOIL SAMPLE #4 IS RANDOM SOIL TAKEN FROM B1516.6 SOIL AT BOTTOM OF B1516.6 IS STILL DARK RED HARD-PAKED BURNT CRUMBLY CLAY, SOME PEBBLES EMBEDDED. LESS BURNT CRUMBLY CLAY TOWARDS THE WESTERN PORTION OF B1516.6, ~~SEE~~ GREY SOIL AT TOP OF PAIL B1516.6 NEAR WALL ⁸¹¹ BOTTOM OF PAIL IN WESTERN PORTION BECOMES REDDISH, NOT CRUMBLY, STONES 7-10 CM EMBEDDED. SURFACE EXPOSED B1516.6 MORE YELLOWISH-RED IN ~~WEST~~ WESTERN PORTION OF AREA. AREA EXPOSED ON EAST EDGE VERY SMOOTH AND REGULAR, PART OF A SURFACE? ONE PIECE OF POTTERY RECOVERED WHILE EXCAVATING, COARSEWARE HANDLE FROM GREYISH SOIL AT TOP OF PAIL NEAR WALL. ONE PIECE OF BONE RECOVERED, ALL SOIL REMOVED SCREENED 1/4". PAIL COMPLETED & CLOSED. TOP OF A LINEAR ACCUMULATION OF STONES EXPOSED UNDERNEATH, ROUGHLY PARALLEL & 20 CM TO THE ~~WALL~~ NORTH OF WALL B711.

PAIL B1516.7 IS SOIL REMOVED WHILE DEFINING A GROUP OF ROCKS EMBEDDED IN THE EASTERN SCARP OF THE STONE BENCH. SOIL REDDISH-GREY, ROCKS & PEBBLES EMBEDDED. N/2 A ZEMBLU OF SOIL REMOVED, ALL SCREENED, SOME BONE & POTTERY RECOVERED. PAIL B1516.7 (COMPLETED & CLOSED). DEFINITION OF THE STONES IN EAST SCARP OF STONE BENCH SUGGESTS POSSIBLE WALL RUNNING NW-SE UNDER BENCH?

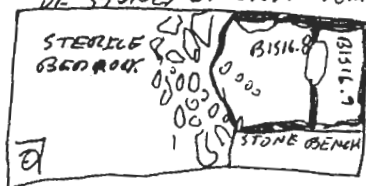

PAIL B1516.8 IS A PASS OVER THE PORTION OF THE TRENCH SOUTH OF THE CENTRAL STONE CONCENTRATION AND NORTH OF EMBEDDED BOULDER 1 METER NORTH OF WALL B711. SURFACE OF B1516.8 IS GREYISH-RED, FLOOR PACKING, CARBON-FLECKED, PEBBLE & POTTERY EMBEDDED IN EXPOSED SURFACE.

WE ARE REMOVING THIS PACKING TO REACH THE POSSIBLE FINAL NEOLITHIC LEVEL UNDERNEATH. SEE DIAGRAM TO LEFT FOR LOCATION OF B1516.8. SOIL MATRIX OF B1516.8 GREY, SLIGHTLY REDDISH DEEP ON N/S EDGES, DEEPENING TO 10 CM IN CENTER. STILL SOME REDDISH-GREY CLAY EXPOSED AT BOTTOM OF PASS. MANY PEBBLE & SMALL COBBLE INCLUSIONS. SEVERAL POSSIBLY NEOLITHIC POTSHERS RECOVERED, SOIL AT BOTTOM OF PASS BELONGING TO REDDISH CLAY ON NORTH & SOUTH BORDERS OF PAIL AREA. SURFACE EXPOSED AT BOTTOM OF B1516.8 GREY, EMBEDDED CARBON, SCHIST, POTTERY REMOVED APPEARS TO BE LATE MINOAN III & NEOLITHIC, ~~SEE~~ BOTTOM OF B1516.8 POSSIBLY TRANSITIONAL LEVEL BETWEEN FINAL NEOLITHIC LEVEL & BOTTOM OF LATE MINOAN III FLOOR PACKING. INTENSIVE SOIL SAMPLE #5 IS A 10 LITER SAMPLE OF SOIL FROM RANDOM LOCATIONS IN B1516.8. OBJECT #1 IS A POSSIBLE STONE BURNISHER, ~3 CM DIAMETER, SEE DIAGRAM P.6 FOR LOCATION.

PAIL B1516.9 IS A 5 CM PASS OVER HARD PACKED RED CLAY IN THE PORTION OF B1516 ONE METER NORTH OF WALL B711 TO WALL B711, SEE DIAGRAM ABOVE FOR LOCATION. SOIL MATRIX IS VERY HARD, DARK RED CLAY, SEEMS MOSTLY STERILE. WE ARE MAKING THIS PASS TO BETTER DEFINE THE LINEAR ACCUMULATION OF STONES RUNNING PARALLEL & 20 CM TO THE NORTH OF WALL B711, TO DETERMINE WHETHER THIS IS AN EARLY WALL, AS WELL AS TO EXPLORE THE NW-SE ACCUMULATION OF STONES BETWEEN THE LARGE ROCK AT THE SOUTHERN EDGE OF B1516 AND THE CORNER OF THE STONE BENCH. SOIL IN WESTERN PORTION OF PAIL SLIGHTLY GREYISH-RED AT TOP, BECOMING MORE REDDISH TOWARDS BOTTOM OF PASS. PAIL B1516.9 WAS COMPLETED & CLOSED, SURFACE EXPOSED IS LARGE ROCKS (7-20 CM) EMBEDDED IN THE HARD-PAKED REDDISH SOIL UNDERNEATH. ROCK ACCUMULATION PROBABLY REPRESENTS THE TOP OF AN EARLY WALL.

17 JUNE 04

PAIL B1516.10 IS AN EXTENSION OF LOCUS B1516 INTO THE AREA DIRECTLY SOUTH OF B1516'S CENTRAL STONE HEARTH. SEE DIAGRAM P.6 FOR LOCATION. SURFACE OF B1516.10 IS THOUGHT TO BE SAME LEVEL AS B1516. B1516.10 IS 5 CM PASS OVER EXPOSED STONES AND GREY-RED SOIL IN PAIL AREA. SOIL AROUND STONES IN PAIL AREA IS DARK RED, SOIL IN AREAS WITH FEW EMBEDDED STONES IS GREYISH-RED, CARBON-FLECKED,

Year 04 Trench/Locus B1516 Excavator RAC

DESCRIPTION of PROGRESS of EXCAVATION [date each entry and identify associated pottery pile(s)]:

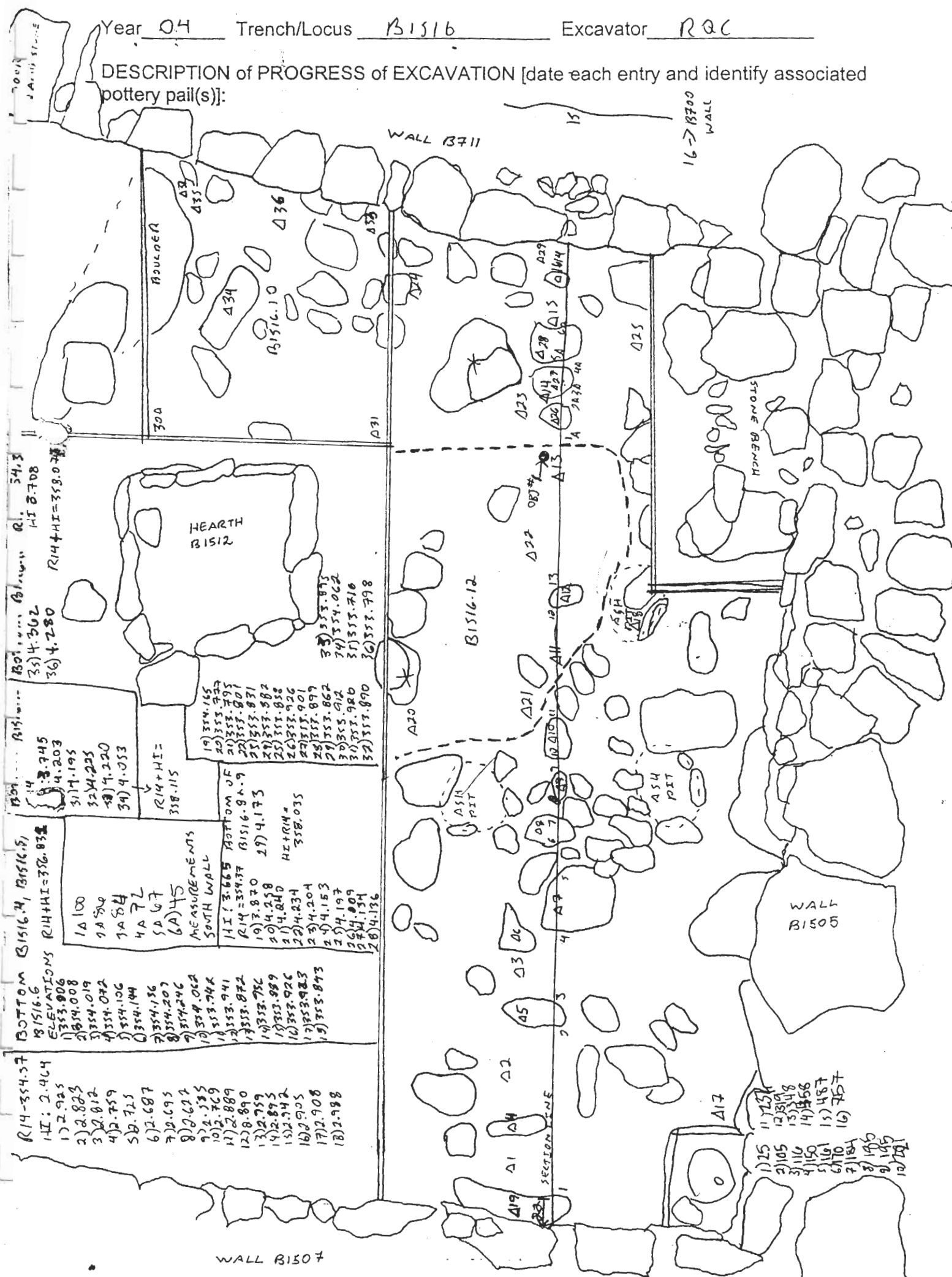

Year 04

Trench/Locus

B.1588

Excavator

RQC

pottery pail(s)]:

17 JUN 04

17 JUNE 04;
POSSIBLE FLOOR PACKING FOR THIRD ARCHAIC FLOOR IDENTIFIED AS TOP OF
PAUL BISIG.8? MANY FEET SIZE & LARGER ROCKS EMBEDDED IN SURFACE, PASS
IS EXPOSING MORE EMBEDDED STONES. PASS IS DEFINING EXPOSED STONES AND
IS EXPOSING MORE EMBEDDED STONES. PASS IS DEFINING EXPOSED STONES AND
EXPLORING THE BOTTOM OF WALL BTII. WITH OTHER PASS WE HAVE GONE BELOW THE
BOTTOM OF WALL BTII, BOTTOM OF PASS REVEALED MASS OF EMBEDDED FIST-SIZE
AND LARGER ROCKS, STILL SOME GREY CLAY IN AREAS, MOSTLY RED CLAY. POTTERY
AND ~~SOME~~ FEW PIECES OF BONE RECOVERED, MUCH OF SOIL IN REDDISH CLAY
AREAS SEEMS STERILE, GREY CLAY REMAINS ONLY IN SOUTHERN HALF OF PAUL
AREA, STILL FLOOR PACKING? ~~ALL~~ ALL GREY CLAY REMOVED FROM PORTION
OF PAUL NORTH OF LINEAR STONE ACCUMULATION RUNNING EAST-WEST THROUGH
PAUL AREA. ~~STILL~~ GREY GREY CLAY FLOOR PACKING REMAINING IN SOUTHERN HALF
OF PAUL AREA WILL BE REMOVED AS BISIG.11.
PACKING - FROM AREA SOUTH OF LINEAR
MATRIX IS GREYISH

PAIL AREA. OF PAIL AREA WILL BE DEEMED
PAIL B1516.11 WILL REMOVE GREY CLAY FLOOR PACKING FROM AREA SOUTH OF LINEAR
STONE ACCUMULATION, SEE DIAGRAM BELOW. SOIL MATRIX IS GREYISH
RED CARBON-FLECKED, POTTERY-INCLUDED & FIST-SIZE ROCK INCLUDED FLOOR PACKING
OR WALL FOUNDATION. SURFACE OF B1516.11 IS BELOW WALL B711, POTTERY ASSOCIATED
WITH THIS PAIL EMBEDDED UNDER WALL. SEVERAL FIST-SIZE
GREY CLAY CONTINUES

REMOVE GREY CLAY FLOOR PACKING FROM AREA SOUTH OF LINEAR ACCUMULATION, SEE DIAGRAM BELOW. SOIL MATRIX IS GREYISH POTTERY-INCLUDED & FIST-SIZE ROCK INCLUDED FLOOR PACKING. SURFACE OF B1516.11 IS BELOW WALL B711, POTTERY ASSOCIATED WITH THIS PAIL EMBEDDED UNDER WALL. SEVERAL FIST-SIZE STONES EMBEDDED IN GREY CLAY WERE REMOVED, GREY CLAY CONTINUES UNDERNEATH SOME LARGER (20CM) ROCKS EMBEDDED IN GREY CLAY APPEAR TO CONTINUE UNDER WALL B711, FOUNDATION PACKING OF GREY CLAY DEEPS QUITE DEEP IN SOUTHERN PORTION OF PAIL VIS-20 CM. POSSIBILITY THAT LARGE OBJECT/ROCK REMOVED FROM THIS AREA TO BUILD WALL B711 ATOP, AREA FILLED IN WITH GREY CLAY & ROCKS AS PACKING? BOTTOM OF B1516.11 IS REDDISH CRUMBLY CLAY WITH PEBBLE INCLUSIONS. SIMILAR TO BOTTOM OF B1516.8/9 IN REST OF LOCUS. NO LARGE ROCKS EMBEDDED IN BOTTOM OF B1516.11 IN DEEPEST AREA SOUTH OF LARGE BOULDER. B1516.11 WAS INCLUDED WITH POTTERY & BONE, INTENSIVE SOIL SAMPLE #6 IS A 1/2 LITER SAMPLE OF CARBON-FLECHED GREY CLAY FILL, FROM B1516.11. B1516.11 WAS COMPLETED & CLOSED, SWEPT & PHOTOGRAPHED.

CLAY FILL, RED CLAY, SWEET & PHOTOGRAPHED.

PAIL B1516.12 IS A PASS OVER THE CENTRAL PORTION OF THE TRENCH WEST OF THE STONE HEARTH, SEE DIAGRAM P.6. FOR LOCATION. SOIL MATRIX IS GREYISH/RED FLOOR PACKING, ~~FILL~~? 10 LITER INT SOIL SAMPLE #7 IS RANDOM SOIL REMOVED FROM B1516.12. SOIL MATRIX GREYISH/RED INCLUDED WITH CARBON FLECKS, FIST-SIZE STONES. WE ARE MAKING THIS PASS TO GET DOWN TO RED CLAY/POSSIBLE ~~FINAL~~ FINAL NEOLITHIC LEVEL. SOME POTTERY & BONE RECOVERED DURING EXCAVATION, POSSIBLE FN SHEPHERDS? B1516.12 WENT 20-25 CM DEEP, RED CLAY REACHED AT BOTTOM. SOME BONE & POTTERY RECOVERED. BOTTOM OF PAIL INCLUDED WITH PEBBLES & FIST-SIZE STONES, BUT SOIL REDDER THAN ABOVE.

STONES. STILL CARBON-FLEKED SOIL IN
PAIL B1516. 12 WAS COMPLETED + CLOSED.

PAIL B1516.13 WAS 1 ZEMBILL OF LOOSE SOIL SWEEP FROM TOP SURFACE OF B1500, IN FINAL
AREA EXCAVATED THIS YEAR ONLY. SURFACE OF B1500 EXCAVATED THIS YEAR WAS SWEEP.
FINAL PHOTOS TAKEN. ROCK CONCENTRATIONS AND FEATURES WILL BE DRAWN.

Year _____ Trench/Locus _____ Excavator _____

DESCRIPTION of PROGRESS of EXCAVATION [date each entry and identify associated pottery pail(s)]:

B1500 SECTION

