

## FINAL TRENCH REPORT: B2200 and B2300

Trenchmaster: Sneri Pak (SZP)

Trench Assistants: Karen Dunford, Blair Hodgkin, Matthew Rashotte, and Jerrod Siefert

Trench Workmen: Pandelis Hatzidakis, Manolis Maniadas

Datum Points: R11 (355.86 masl) and R14 (354.37 masl)

Excavation Dates: June 11<sup>th</sup> - July 2<sup>nd</sup>, 2004

Location: Trench B2200 is an irregularly shaped room located immediately north of B1500. The interior space is bounded in the east by wall B2203 (a continuation of wall B707), running N-S approximately 8.80 m long. The southern wall is B1507 (exposed in 2003), running E-S ca. 4.6 m long. The north wall B2309 runs E-W for 2.5 m. The western wall B2305 (poorly preserved) extends N-S approximately 6.3 m long.

Purpose of Excavation: To investigate the area into which the doorway in B1507, a large kitchen/production room leads and further clarify the nature of the complex comprised of B1500 and B700.

Depositional History: Excavation of B2200 ended with a floor surface of packed clay which extends throughout the interior space. The floor is well preserved with some pitting out SW of the central hearth and along the west side of the room. The floor level was determined by the several architectural features (including the threshold stone for the south staircase, the hearth, a bin and several plasters) and a number of ceramic scatters. These scatters and other finds from the habitation level were excavated as locus B2208 (floor surface debris, roofing clay and burnt material). Above this was a shallow stratum of tumble with evidence burning, locus B2205. Above this was a level of tumble which was denser in the northern half of the room. The southern half of the room, especially around the area of the doorway in wall B1507 was surprisingly clear of much tumble. The excavation of this trench began with the removal of B2201 which represents the modern surface material and fill (from the previous seasons).

Conclusions: This room is an area of food preparation and some level of textile manufacture. The hearth (almost twice the size of the hearth in B1500), the bin in the SE corner, and one in B2305 containing the large *pithos* base, the plethora of stone tools (querns and hand implements) and the variety of other ceramic vessels attest to its function as a kitchen. In addition, the discovery of worked metapodial bones (*gaitania*) and loomweights along wall B1507 may indicate the presence of a loom or at least the storage of weaving paraphernalia. The fenestrated stand (and perhaps the bronze tripod stand fragment, if in its original context) along with B2200's size and the general nature of the entire complex (including B1500 and B700) would suggest that the preparation and work from this area was public in nature. Furthermore, the recent excavation of additional work spaces/rooms further north (as well as the large room with monumental benches) lends added support for this hypothesis.

**Cut to the Chase:**

1. Floor: Archaic
2. B220a: habitation debris including clay, and burning
3. B220b: tumble and evidence of burning
4. B220c: tumble
5. B220d: modern surface material/ fill

**Architectural Features:**

1. B220e: N-S wall in east – northern continuation of wall B707
2. B230e: E-W wall in the north
3. B230f: N-S wall in west
4. B150f: E-W wall in south excavated in 2003 by GRP
5. B2210: Hearth
6. B220f: Stairs in B1507
7. Bin in the SE corner
8. Work platform in NE area of room

Year 2004 Trench/Locus B2200 Excavator 32PElevationsBenchmark used: R11

Reading on

Benchmark: 355.86 masl

H.I.:

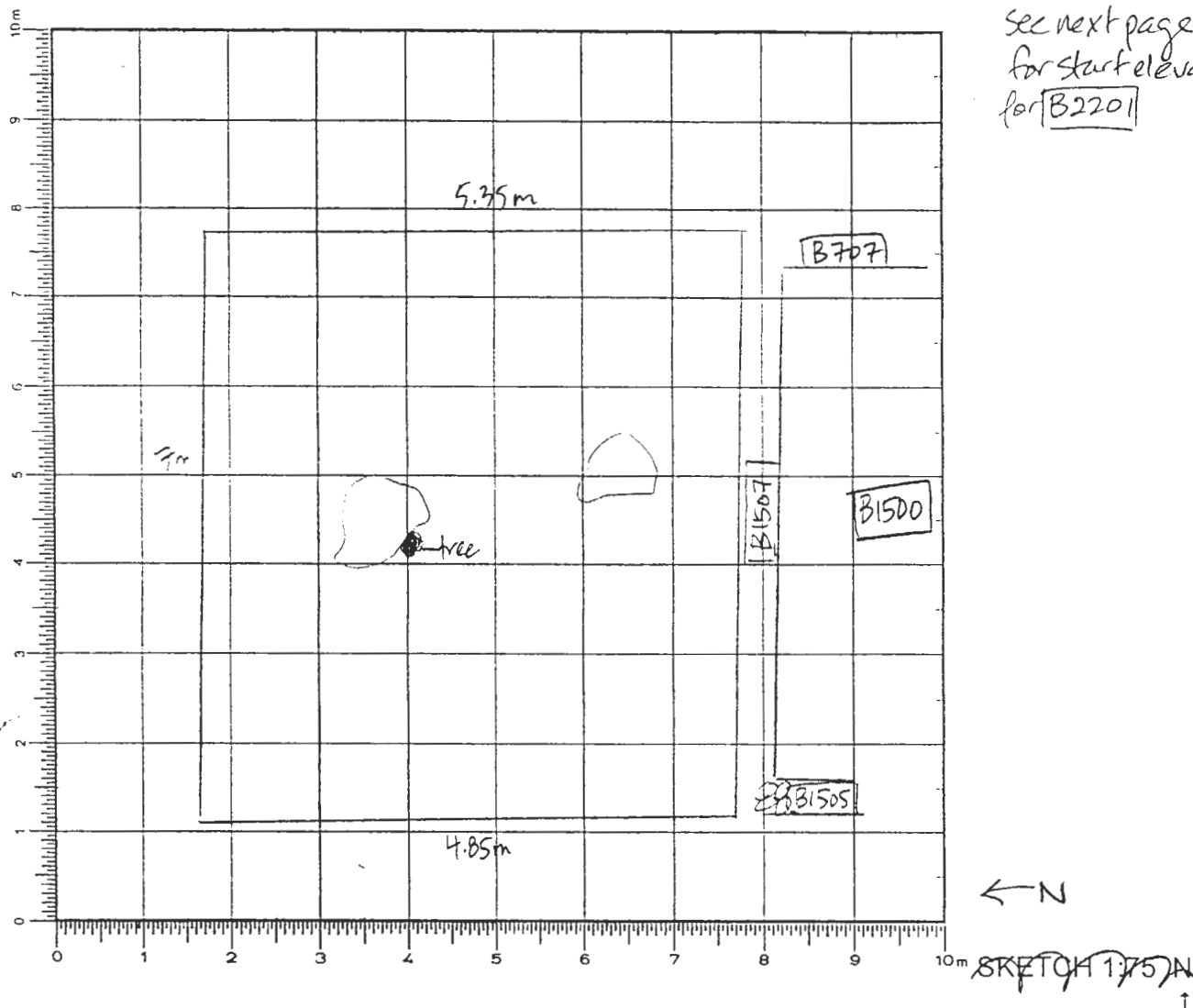
See next page  
for start elevation  
for B2201DEFINITION/DESCRIPTION of LOCUS (explain why you changed locus numbers):Today's date: 11 JUNE 04 Locus above:

Locus parameters:

Verbal description: This is the area immediately to the north of trench B1500 and extends ca. 4.85-5.35m northward - rectangular shape. There is a slope down ~~wards~~ ~~to the west~~ westward. The matrix is loose, ~~dark~~ red brown with many inclusions (medium-large stones) and vegetation - including a large boulder midway upslope and a tree trunk. Upslope (in eastern section of trench) there are many medium-larger stones. Initial clearing of stone wall (created in 2003) and dump took place in the 1st week of this season.

Locus Interpretative Comments (What do you think this is? DATE your comments, continue on additional pages if necessary): Wall B1507 to the south guides us - where does the doorway lead? This area is either an interior space or exterior space. → a possible work area next to the kitchen (B1500) or is it another storage room?



Year 2004 Trench/Locus B2201 Excavator S2P

DESCRIPTION of PROGRESS of EXCAVATION [date each entry and identify associated pottery pile(s)]:

11 JUNE 04:

Start elevations  
for B2201

Bench: R11 (355.86)

HT: (1.19) 357.05

1. (2.00) 355.05

2. (0.37) 356.68

3. (0.15) 356.90

4. (2.03) 355.02

5. (0.76) 356.29 7m

6. (1.18) 355.87

7. (0.58) 356.47

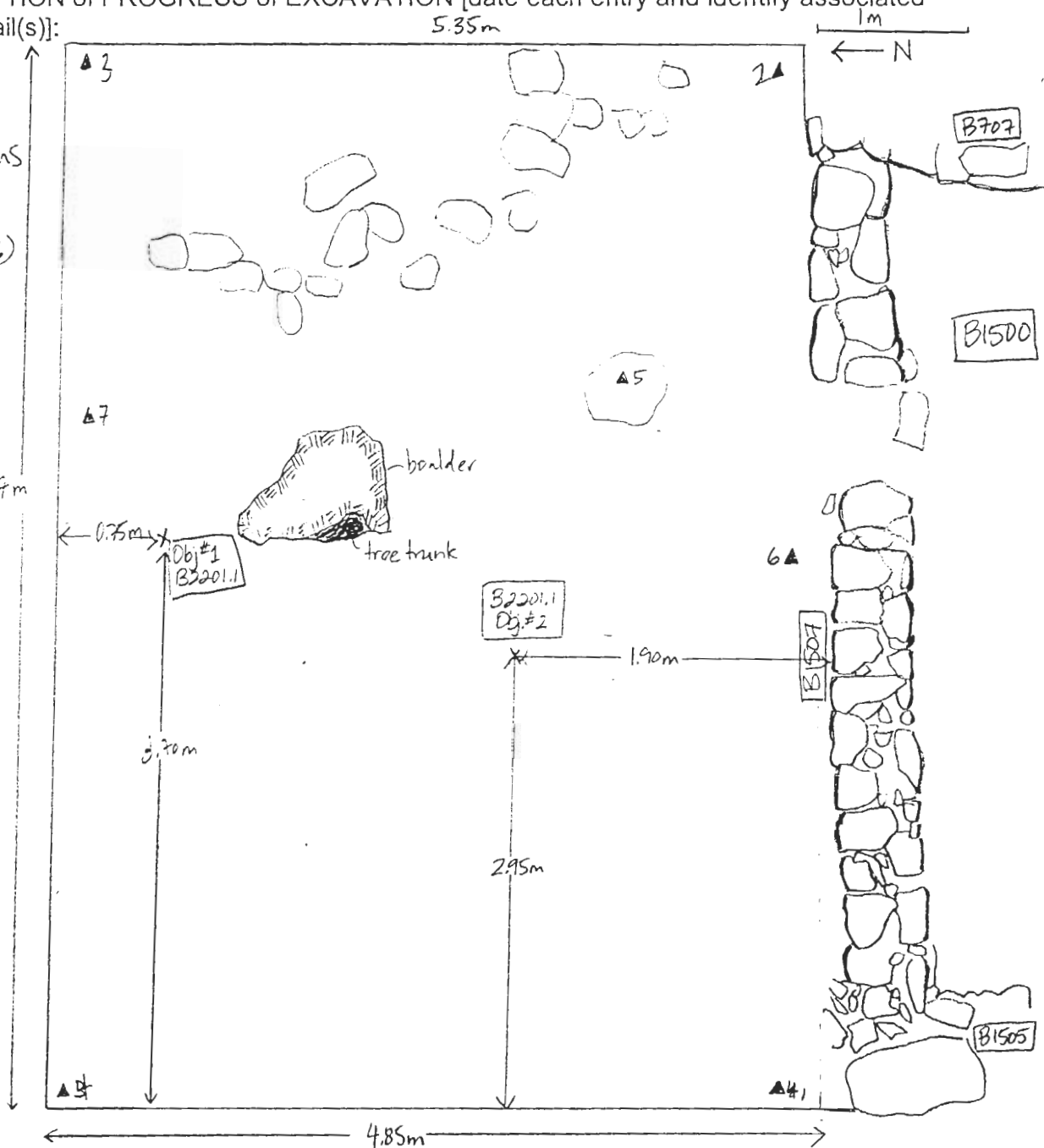

← DUMP  
(NW of D100)

! clearing of stone piles and brush (leftover from last year's dump material); measured out trench parameters; Start elevations  
! first pass with big pick to remove layer of topsoil ~ 15-20cm deep - moving upslope (W → E)

! Object # 1 - Assoc. B2201.1  
- possible stone tool?

location: 75cm from N baulk; 370cm from W baulk  
elevation: (1.24) 355.80  
Bench R11 (355.86)  
HT (1.18) 357.04

Year 2004 Trench/Locus B2201 Excavator SZP

DESCRIPTION of PROGRESS of EXCAVATION [date each entry and identify associated pottery pail(s)]:

11 JUNE 04: (cont) lots of pottery found; some bone and shell  
soil is loose and soft with many inclusions - red brown  
in colour.

Object #2 - B2201.1

possible stone tool?

location: 190 cm from S bank

295 cm from W bank

elevation: (1.67)  
355.37

Bench R11 (355.86)

H1 (1.18) 357.04

! New pottery pail for east portion of trench - B2201.2

! uncovered a wave of tumble in western half of trench → as  
found in B1500

! left 1m strip along S bank to prevent contamination in B1500 - to be  
excavated later carefully

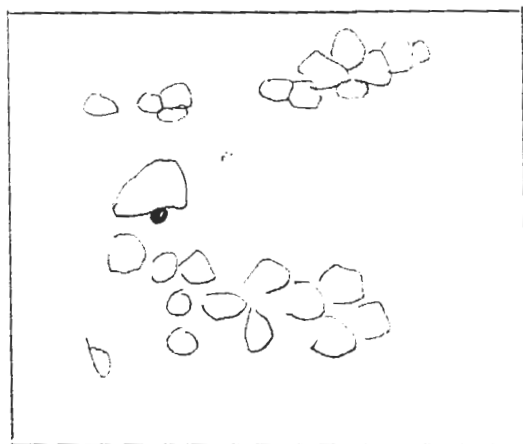

! pass not completed by day's end.

14 JUNE 04: Continued pass along one meter strip ~~in~~ along  
Southern limit and the eastern upslope area. B2201.3

! areas of tumble have been exposed esp. in the western  
section of trench

Object #1 - Assoc. B2201.3

- Spindle whorl

location: ~~50~~ 50 cm from S bank; 45 cm  
from W bank

elevation: bottom of locus

Year 2004 Trench/Locus B2201 Excavator SZP

DESCRIPTION of PROGRESS of EXCAVATION [date each entry and identify associated pottery pail(s)]:

14 JUNE 04: (cont)

: pebble found in SW corner of trench - 45cm from S bank  
and 115cm from W bank

: Object # 2 - Assoc. B2201.3  
- polished stone

location: 190cm from S bank  
190cm from E bank

elevation: bottom of locus.

: a linear configuration of stones, along a E-W axis

15 JUNE 04: cleaning and sweeping for photos - little bit  
of cleaning of humble and digging of NE corner (where  
it is extremely loose and pebbly (pre-bedrock material))

: pottery pail is B2201.4 - bone collected.

: Photos: 2 from West  
1 from NE

: ~~second~~ ~~pass~~ bottom elevations taken

Year 2004 Trench/Locus B2201 Excavator SZP

DESCRIPTION of PROGRESS of EXCAVATION [date each entry and identify associated pottery pile(s)]:

15 JUNE 04

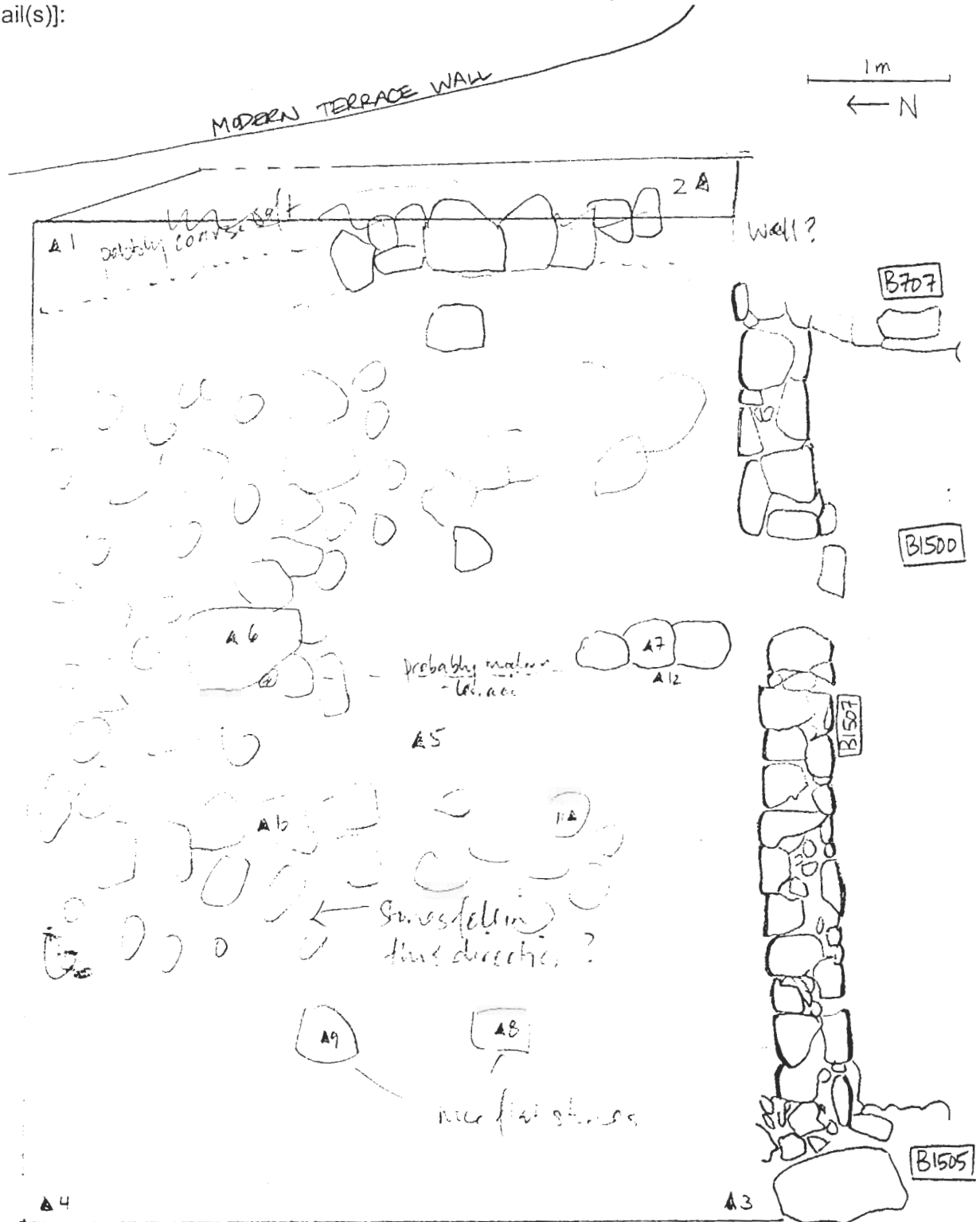

## BOTTOM ELEVATIONS FOR B2201

Bench R14 (354.37)

HI (2.45) 356.82 mask.

1. (0.18) 356.64

2. (0.16) 356.66

3. (1.85) 354.97

4. (1.87) 354.95

5. (1.32) 355.50

6. (0.52) 356.50

7. (0.93) 355.89

8. (1.79) 355.02

9. (1.77) 355.05

10. (1.41) 355.41

11. (1.38) 355.14

12. (1.23) 355.59



Year 2004 Trench/Locus B2202 Excavator SJPElevations

Benchmark used:

Reading on

Benchmark:

H.I.:

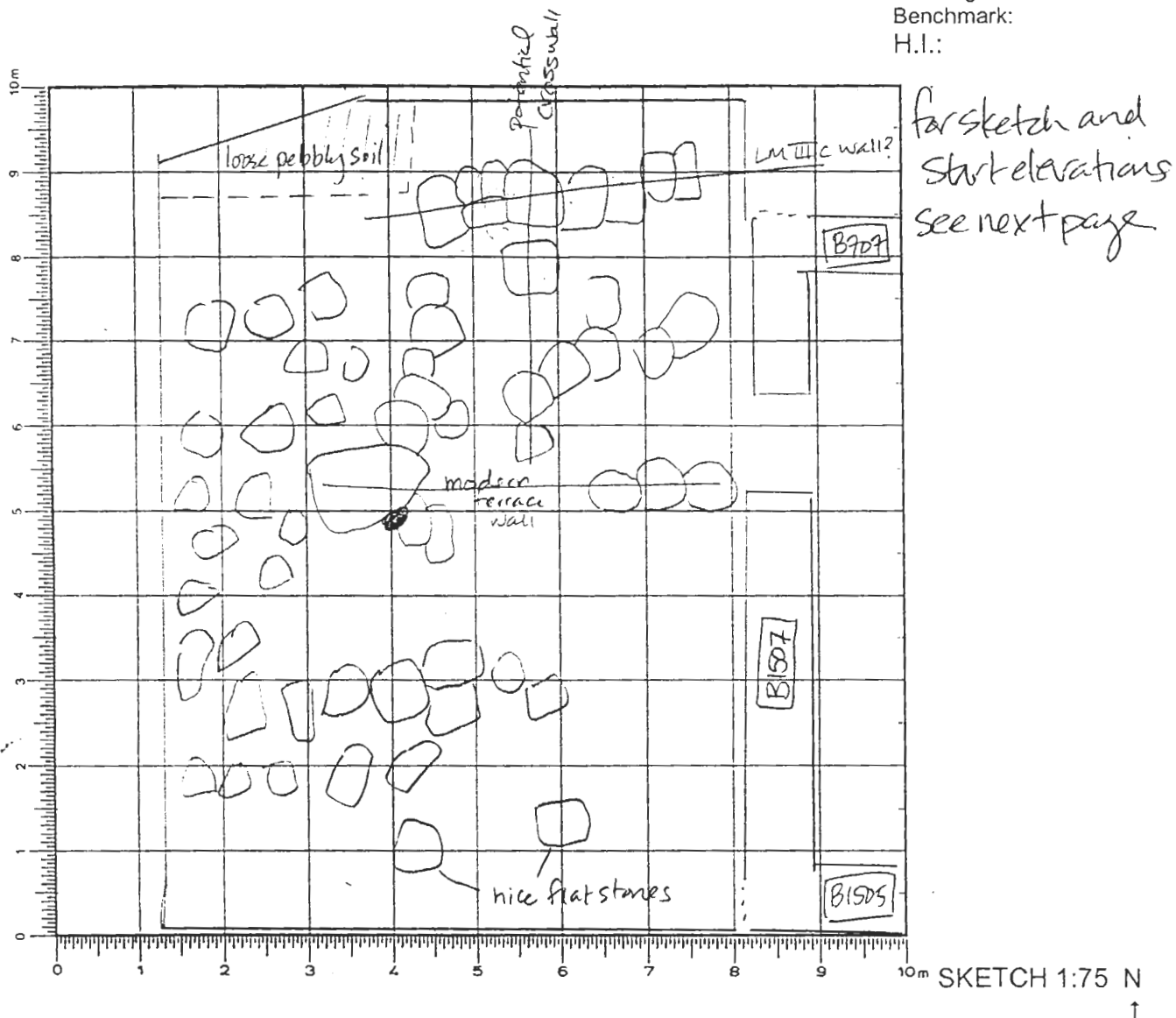
DEFINITION/DESCRIPTION of LOCUS (explain **why** you changed locus numbers):Today's date: 15 JUNE 04 Locus above: B2201

Locus parameters:

Verbal description: Locus B2202 consists of tumble though no sign of roofing clay/material is yet. Matrix is made of medium to large stones and the soil is red brown and fairly loose. The tumble is concentrated in the east and north ends of the trench - no evidence of tumble downslope along the west side or ~~along~~ <sup>in</sup> the southwest corner. There is a line of stones in the SE quad of the trench which appears to line up with the LM III C wall atop wall B707. There is also a line of stones (along N-S axis in line with S door jamb in wall B1507) which is a modern terrace wall.

Locus Interpretative Comments (What do you think this is? DATE your comments, continue on additional pages if necessary):

tumble

Locus/Pottery Pail Number	Weight of Sherds	Number of Sherds	Chronology & Comments
B2202.1	13.49kg	976	Lg, Archaic (LA), Hellenistic, "Ottoman"
B2202.2	1.365kg	104	LM III C, Archaic, Hellenistic
B2202.3	12.4kg	629	Hellenistic, Archaic
B2202.4	8.75kg	485	Hellenistic, Archaic, LM III C
B2202.5	12.90kg	685	LM III C, Archaic, Hellenistic
B2202.6	0.475kg	29	Archaic, LM III C
B2202.96	0.1.275kg	112	LM III C, EO, Archaic, Hellenistic
B2202.7	16.65kg	208	Archaic, Hellenistic
B2202.8	13.02kg	306	Archaic, Hellenistic
B2202.9	2.15kg	126	Archaic, Hellenistic
B2202.10	8.5kg	274	Hellenistic, Archaic, LM III C
B2202.11	13.250kg	315	LM III C, Archaic, Hellenistic
B2202.12	1.625kg	192	LM III C, Archaic
B2202.13	0.005kg	1	OBJECTS Archaic

Object Number	Associated Pottery Pail	Identification (material/form)	Location	Elevation	Catalogue Number
#1	B2202.1	possible stone tool?	150cm from S bank 425cm from W bank		
#1	B2202.2	stone quern frag.	10cm east of wall (B2203) 150cm from S bank		
#2	B2202.2	stone quern frag.	10cm east of wall (B2203) 150cm from S bank		
#1	B2202.3	ceramic disk	2m from S bank 2.9m from east bank		
#2	B2202.3	iron knife blade	1.2m from N bank 2m from W bank		
#1	B2202.4	iron nail	80cm from S bank 150cm from E bank		
#2	B2202.4	loom weight	1m from S bank 1.3m from E bank		
#1	B2202.8	possible stone tool?	found in sweep in S quadrant bottom of locus		
#2	B2202.8	stone quern	1.25m from W face of (B2203) 1.38m from S bank		
#1	B2202.10	stone quern	2m from N bank 2.1m from E bank		
#1	B2202.11	1rm slag			

ADDITIONAL COLLECTED MATERIAL

Locus/Pottery Pail Number	Bones	Shell	Carbon	Pumice	Soil Sample	Other (specify)
B2202.1	1	w/ bone			1 standard	pebble
B2202.2	1	w/ bone				
B2202.3	1					pebble
B2202.4	1					pebble
B2202.5	1				1 standard	pebble
B2202.6	1			1		
B2202.96	1					
B2202.7	1				1 standard	
B2202.8	1					pebble
B2202.9	1		3	1	1 standard	pebble
B2202.10	2 standard		1	1		pebble
B2202.11	1					pebble

B2202.12

1

3 intensive

pebble

B2202.13

1 intensive

Year 2004 Trench/Locus B2202 Excavator SZP

DESCRIPTION of PROGRESS of EXCAVATION [date each entry and identify associated pottery pair(s)]:

15 JUNE 04 : excavation of new locus - change in locus because this is the start of our layer of wall-tumble  
: two separate areas are being excavated

: pottery pair B2202.1 - associated with main pass of trench - begins upon the N-S line of tumble on the down slope and moving eastward to the west face of line of stones (N-S axis - probably a wall) - purpose to come down upon further tumble and to confirm nature of that wall - Bone found

: pottery pair B2202.2 - associated with area east of that potential wall (N-S) - a shallow pass in order to define an eastern face - soil here is extremely loose and crumbly - (see notebook for trench B which excavated a similar level producing much EIA pottery) - bone found

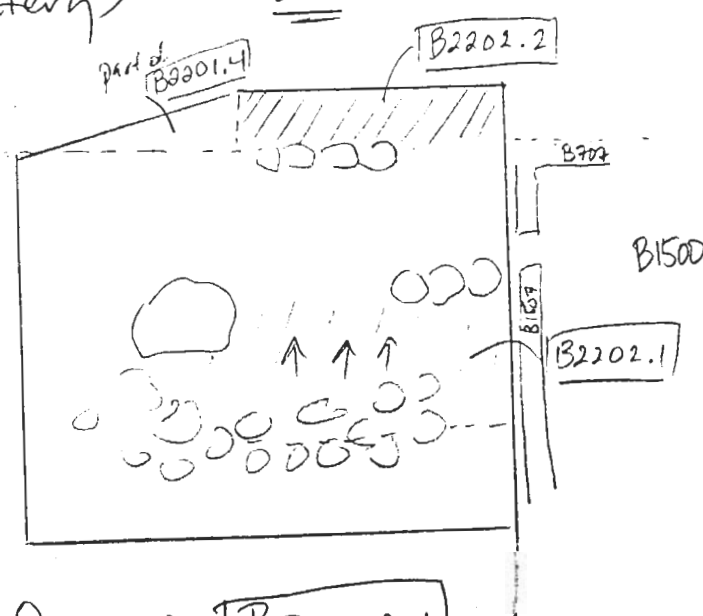

! Some shell found in B2202.1

Year 2004 Trench/Locus B2202 Excavator SZP

DESCRIPTION of PROGRESS of EXCAVATION [date each entry and identify associated pottery pail(s)]:

15 JUNE 04: (cont)

: eastern face of wall B2203 found during pass associated with B2202.2 -

: excavation of pass B2202.1 uncovers more wall tumble, especially along the north end of the trench. - however, the west side of trench (down slope) is bare.

Object #1 - assoc. B2202.1 location: 150 cm from S bank; 425 cm from W bank  
possible stone tool? elevation:

: pebble found near Object #1 B2202.1

: continued excavation of B2202.1 - unusual deposition of tumble (see diagram)

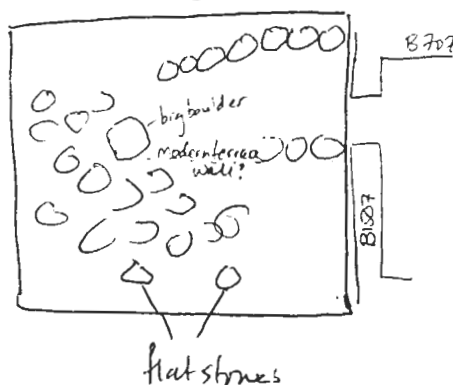

: Stone quern fragment - Object #1 B2202.2

location: 10 cm east of wall B2203; 180 cm from S bank  
elevation:

: another stone quern fragment found just beside Object #1  
↳ Object #2 B2202.2

location: same as Object #1 B2202.2  
elevation: same as Object #1 B2202.2

Year 2004 Trench/Locus B2202 Excavator SZP

DESCRIPTION of PROGRESS of EXCAVATION [date each entry and identify associated pottery find(s)]:

15 JUNE 04: Standard Soil Sample taken for B2202.1

! excavation of B2202.2 completed - east face of wall  
B2203 defined

! excavation of B2202.1 not completed in eastern end.

16 JUNE 04: Continued previous day's pass - removal of tumble

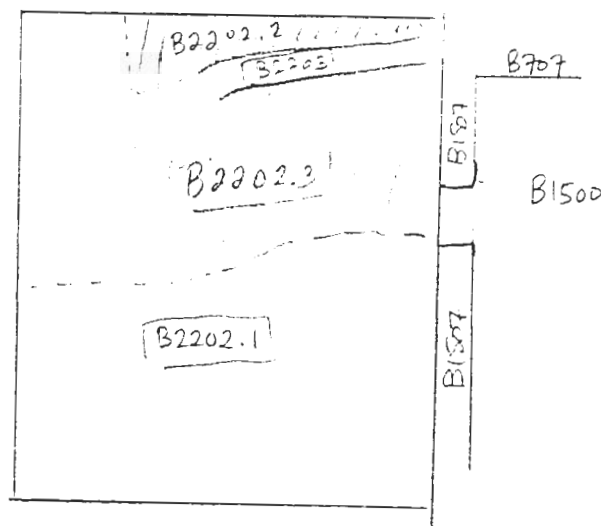

! Object #1 - B2202.3 location: 2m from South baulk; 2.9m from east baulk  
 - ceramic disk frag. elevation: (2.14) 355.90 R14 (354.37) 47 (3.67) 358.04

! Concentration of bone found along west face of wall B2203

! removal of very large bedrock boulder from middle of trench

! Soil is soft, red brown and full of many small (fist size) inclusions as well as tumble - > however very little tumble in the southern and western ends.

! potential northern continuation of wall B2203 - however this area requires more clarity

! 3 large stones making up the terrace wall in the South trench were removed

Year 2004 Trench/Locus B2202 Excavator SZP

DESCRIPTION of PROGRESS of EXCAVATION [date each entry and identify associated pottery pail(s)]:

16 JUNE 04: (cont)

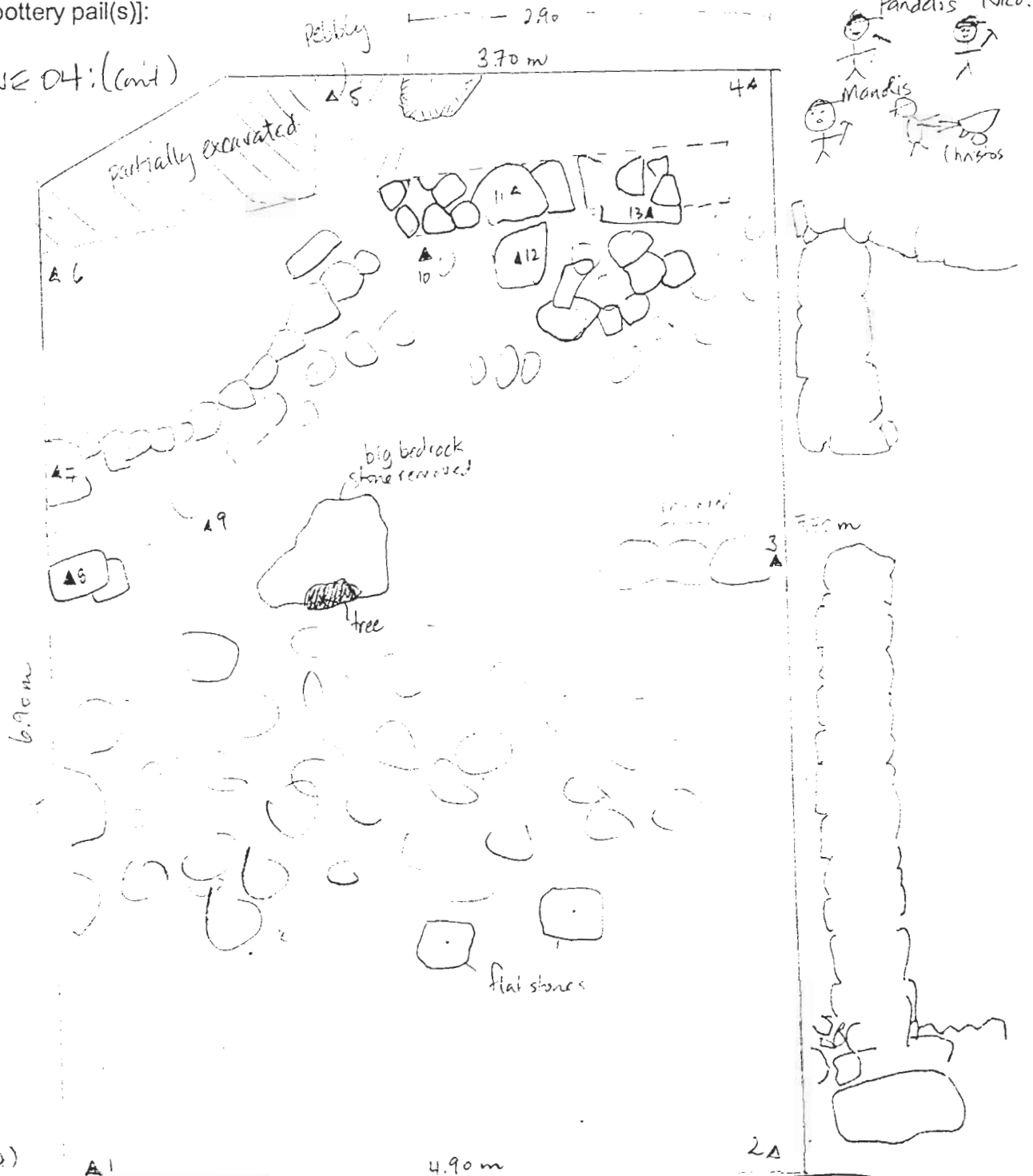

(354.52)

A1  
R14 HI (3.58) 357.95

4.90 m

ELEVATIONS FOR

B2202.4

1 (3.01) 354.94	7 (1.58) 356.37
2 (2.97) 354.98	8 (2.07) 355.88
3 (2.50) 355.45	9 (2.51) 355.44
4 (1.44) 356.51	10 (1.86) 356.09
5 (1.47) 356.48	11 (1.44) 356.51
6 (1.59) 356.36	12 (1.79) 356.16

13 (1.71) 356.24

Year 2004 Trench/Locus B2202 Excavator SZP

DESCRIPTION of PROGRESS of EXCAVATION [date each entry and identify associated pottery pail(s)]:

16 JUNE 04: (cont) pottery pail was full - new pottery pail is B2202.4 - associated with pass in SE quadrant - removal of tumble just west of wall B2203 - purpose to help define/clarity west face - pebble found

Object #2 - assoc. B2202.3 - found in West area of trench during sweep up - ~~prob~~  
 - iron knife blade location: 120 cm from N bank; 200 cm from W bank  
 elevation (2.85) 355.1 masl R14 (354.37)  
 H1 (3.58) 357.95

Object #1 - assoc. B2202.4  
 - iron nail location: 80 cm from S bank  
 150 cm from E bank HI  
 elevation (1.85) 356.10 masl ↑ same

Object #2 - assoc. B2202.4  
 - loomweight location: 100 cm from S bank  
 130 cm from E bank HI ↑ same  
 elevation (1.83) 356.12 masl

pass completed.

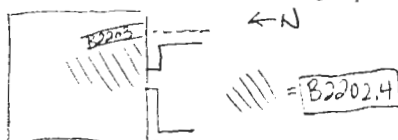

another pass with the big pick to get through the topsoil and tumble. - beginning downslope (ca 3.5 m from west scarp) and moving eastward to the west face of wall - pottery pail B2202.5

separate pail for area in NE quadrant (east of potential N-S line of stones) - pail B2202.6

using the big pick → a third course for wall B2203 was uncovered.



DESCRIPTION of PROGRESS of EXCAVATION [date each entry and identify associated pottery pair(s)]:

pbbles found, bone found

Standard soil sample taken B2202.5

End elevations B2202.6 AND  
Start for B2202.7

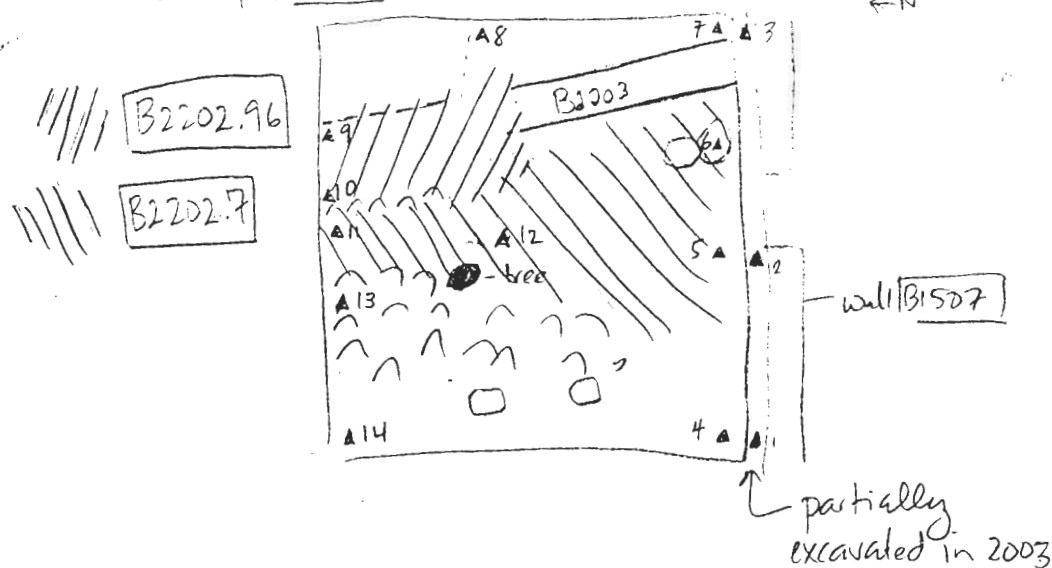

- another pass with the big pick - to bring down the topsoil down to level of the partially excavated area north of wall [B1507]
- : pottery pit is [B2202.7] - (mostly pits)
- : large stones of rubble removed. - lots of pottery;  
Some bone
- : full pottery bin → new pit [B2202.8] - new  
bone  
bone bag



Year 2004 Trench/Locus B2202 Excavator SZP

DESCRIPTION of PROGRESS of EXCAVATION [date each entry and identify associated pottery pail(s)]:

17 JUNE 04:  
(Cont)

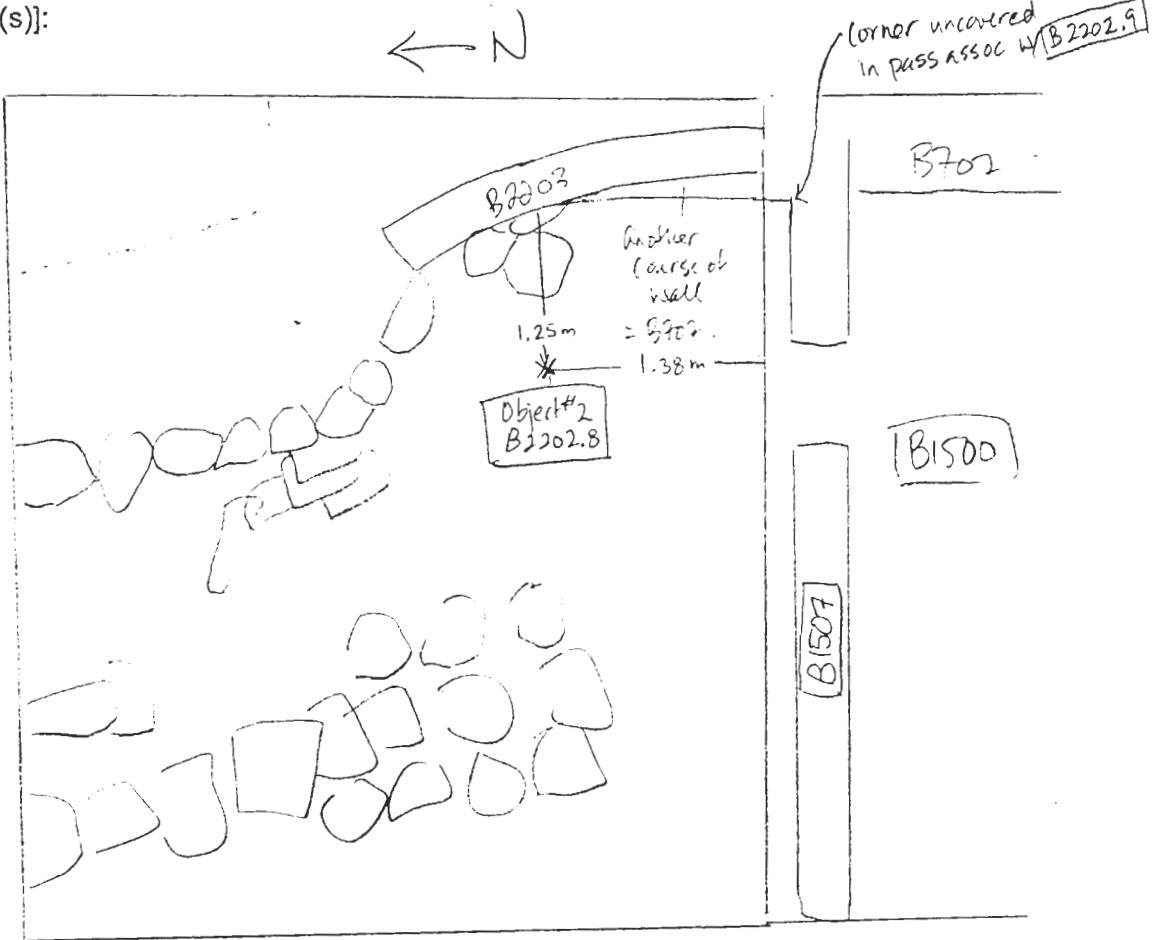

- ! Object # 1 - B2202.8 - no location found in clean up from big pick action - in SE quadrant.  
- possible stone lost? elevation: bottom of locus.

- ! Some carbon found - no sample taken.  
- found along west face of wall B2203  
- ca. 2.5 m from South bank.

- ! Object # 2 - B2202.8 - location: 1.25 m from W face of B2203  
1.38 from S bank.  
Stone guess. elevation: (2.593) HI (3.708) 358.098  
355.48 RI4 (354.37)

- ! pebbles found  
! another course of the wall found - same as B707

Year 2004 Trench/Locus B2202 Excavator SJP

DESCRIPTION of PROGRESS of EXCAVATION [date each entry and identify associated pottery pail(s)]:

- 17 JUNE 04: (cont) Standard soil pottery pail is full - new pail → B2202.9 - new bone bag
- Standard soil sample taken for pass associated w/ B2202.9
  - ! corner discovered in SE corner of trench where B1507 meets with B707 - pass completed, swept, and photographed; 1 from W, 1 from NW, 2 from SW.
- 18 JUNE 04: - elevations taken → next page.
- began removal of tumble - pottery pail is B2202.10 - Soil is still same so no new locus.
  - will screen random 5 zembilis
  - bone found

Object #1 B2202.10

Stone quern

location: 2m from N bank; 2.10 m from E bank  
 elevation: (2474)  
 355.561 masl

R14 H1 (3665)  
 = 358.035

- ! pumice and a little chunk of carbon found in screen
- ! removal of tumble → no definite signs of a cross wall to wall B2203

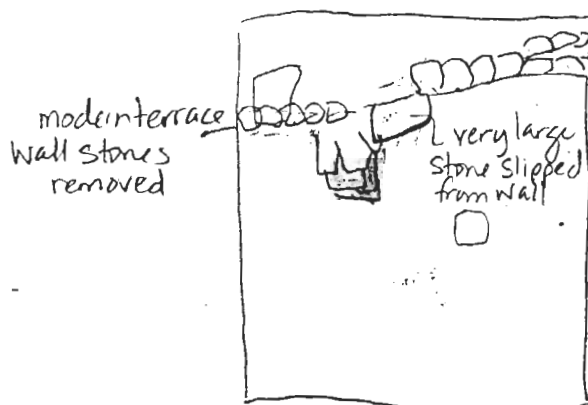

Year 2004 Trench/Locus B2202 Excavator SZP

DESCRIPTION of PROGRESS of EXCAVATION [date each entry and identify associated pottery pail(s)]:

18 JUNE 04! (cont)

\* Special note — pail B2202.6 — from 17 JUNE 04 — used twice, changed pail number (and all associated finds) to B2202.96

Start elevations for B2202.10

← N

Benchmark R14

HI (3.64) 355.01

1. (2.81) 355.2
2. (2.46) 355.55
3. (2.76) 355.25
4. (2.53) 355.48
5. (2.74) 355.27
6. (2.16) 355.85
7. (2.48) 355.53
8. (2.07) 355.94
9. (2.58) 355.43
10. (2.53) 355.48
11. (2.25) 355.76
12. (2.09) 355.92
13. (2.77) 355.24
14. (1.87) 356.14
15. (1.97) 356.04
16. (1.87) 356.14
17. (1.84) 356.12

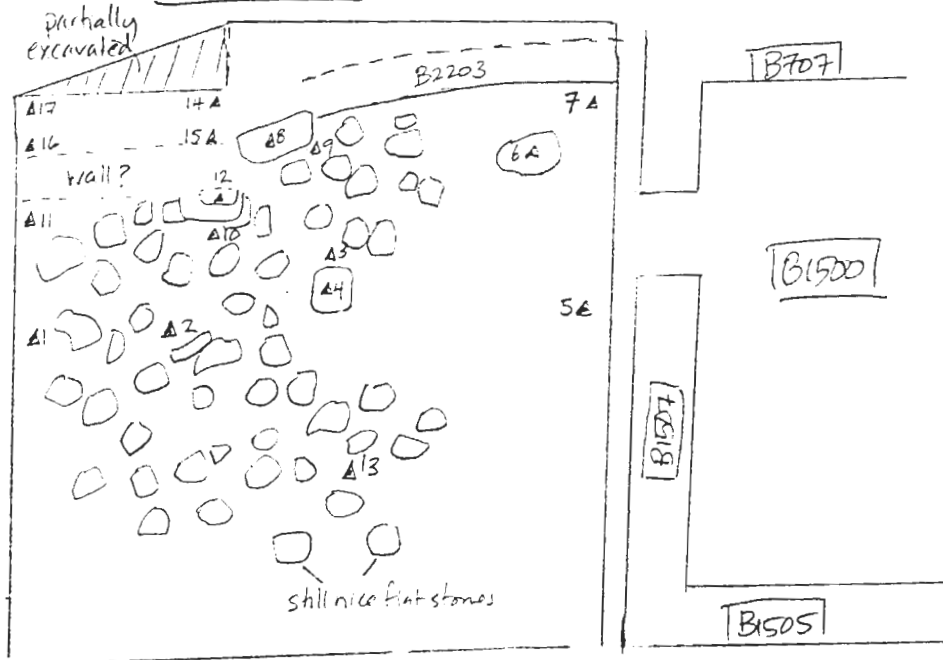

! removal of bundle → potential E-W wall based on stone accumulation NW of large slipped stone — but not clear

Year 2004 Trench/Locus B2202 Excavator SEP

DESCRIPTION of PROGRESS of EXCAVATION [date each entry and identify associated pottery pail(s)]:

21 JUNE 04:

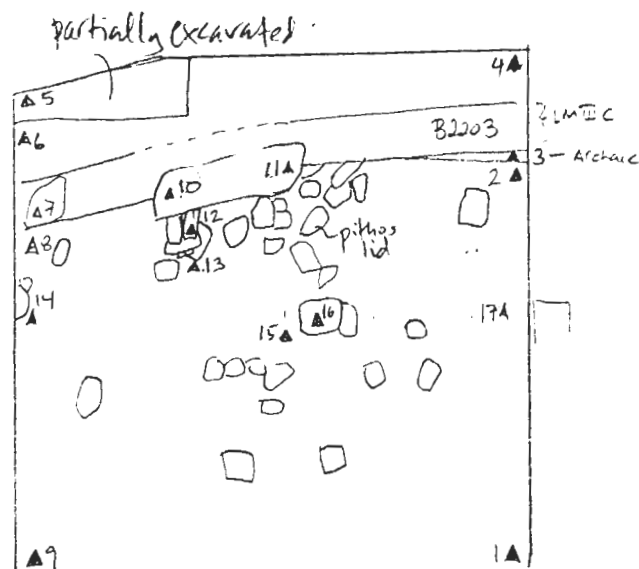

END ELEVATIONS FOR B2202.10

<u>B2202.10</u>		<u>end B2202.11</u>
BM R14 (354.39)		CL14
HI (3.67) 358.04		(3.68) 358.05
1. (3.06) 354.98		
2. (2.51) 355.53		(2.58) 355.47
3. (2.18) 355.86		
4. (1.58) 356.46		
5. (1.38) 356.66		
6. (2.0) 356.04		
7. (1.94) 356.10		
8. (2.38) 355.66		
9. (3.10) 354.94		
10. (2.29) 355.75		
11. (2.09) 355.95		
12. (2.12) 355.92		
13. (2.70) 355.34		(2.78) 355.27
14. (2.59) 355.45		
15. (2.80) 355.20		
16. (2.54) 355.50		
17. (2.80) 355.24		(2.78) 355.27

: finishing off pass - new pottery pail B2202.11; bone found

Object #1 B2202.11  
- iron slag

location: 2.10 from B1507  
1.30 from B2203

elevation: (2.15) 355.41 BM R14  
HI (3.69) 358.06

: concentration of carbon along B1507 elevation (2.69) R14  
= 355.37 HI (3.685)  
1.19 m from B2203 = 358.055  
10 cm from B1507

- large pithos shards from SE quadrant
- excavation slowed to allow for B2300 to achieve the same level as B2200  
in order to prevent potential contamination => slow day
- matrix is more compact along the west side of B2203 = roofing material?
- no clarity regarding W-E cross wall
- tumble throughout trench -> except for west side of trench (ca. 1.5 m strip)
- pithos lid (stone) found SW of large stone.

Year 2004 Trench/Locus B2202 Excavator SZP

DESCRIPTION of PROGRESS of EXCAVATION [date each entry and identify associated pottery pail(s)]:

22 JUNE 04: Because we're waiting for B2300 to excavate down to our level, we are ~~then~~ not making any major pass. A cluster of stones which we initially thought formed part of / fell from ~~over~~ a potential cross wall was removed - partly to help us clarify a cross wall, and partly with a view to the future removal of the large stone - which appears to have fallen westward from wall B2203.

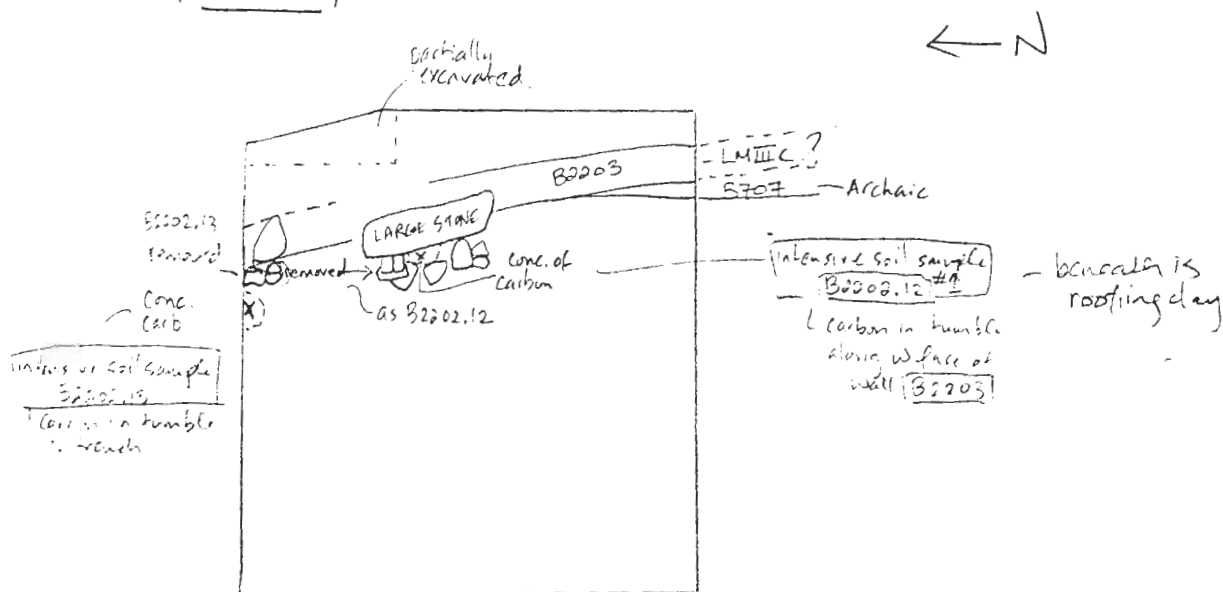

: pottery pail is B2202.12; bone found

: concentration of carbon found 2.80m from E bank along N bankline.  
elevation: (2.81) 355.32 R14 (354.37)  
HI (3.76) 358.13

: intensive soil sample taken of area of carbon concentration

B2202.13: carbon in tumble (N. trench)

: new pail B2202.13 → because this maybe the start of destruction material → excavation of B2300 is deeper and encroaching on N bankline → we are also removing large stones along the west face of B2203 (tumble) to the north.

Year 2004 Trench/Locus B2202 Excavator SJP

DESCRIPTION of PROGRESS of EXCAVATION [date each entry and identify associated pottery pail(s)]:

22 JUNE 04: (cont) concentration of carbon along the west side of extra large stone from wall B2203 - from pass ASSOC. w/ B2202.12

elevation (270) <sup>355.35</sup> H: (3.74) <sup>358.11</sup> R14

intensive soil sample taken - B2202.12 : carbon in tumble along w. face of wall B2203  
#1

#2

! also coming down upon roofing clay material in same area

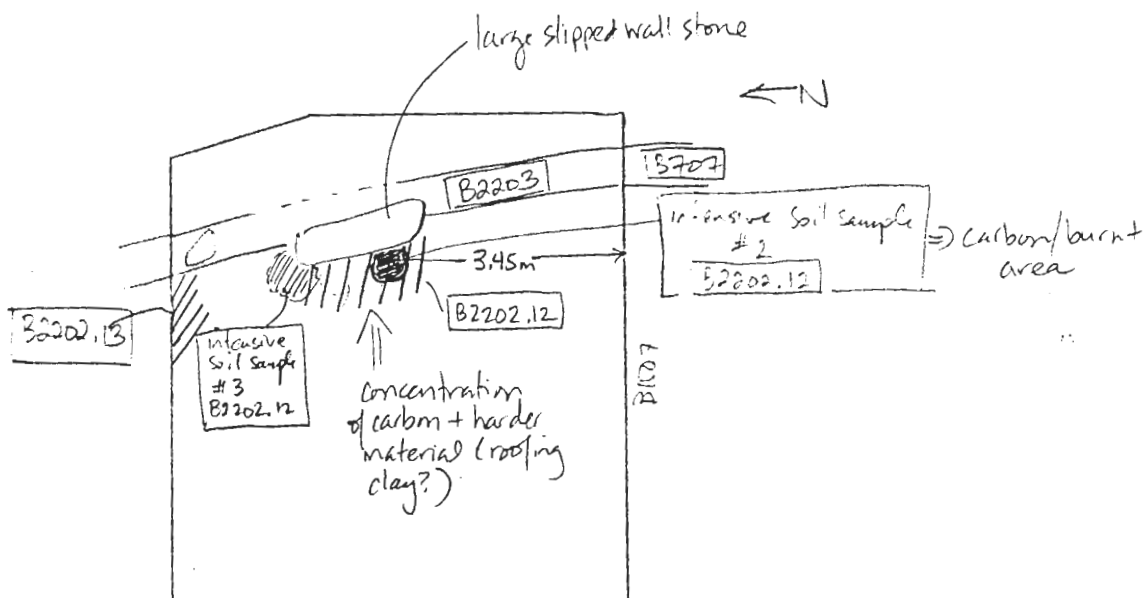

: removal of tumble west of and north of extra large stone.  
: defining west wall face of B2203

intensive soil sample taken - B2202.12 - carbon in tumble along w. face of wall B2203  
#3

Year 2004 Trench/Locus B2203 Excavator JZP

**Elevations**

Benchmark used:

Reading on

Benchmark:

H.I.:

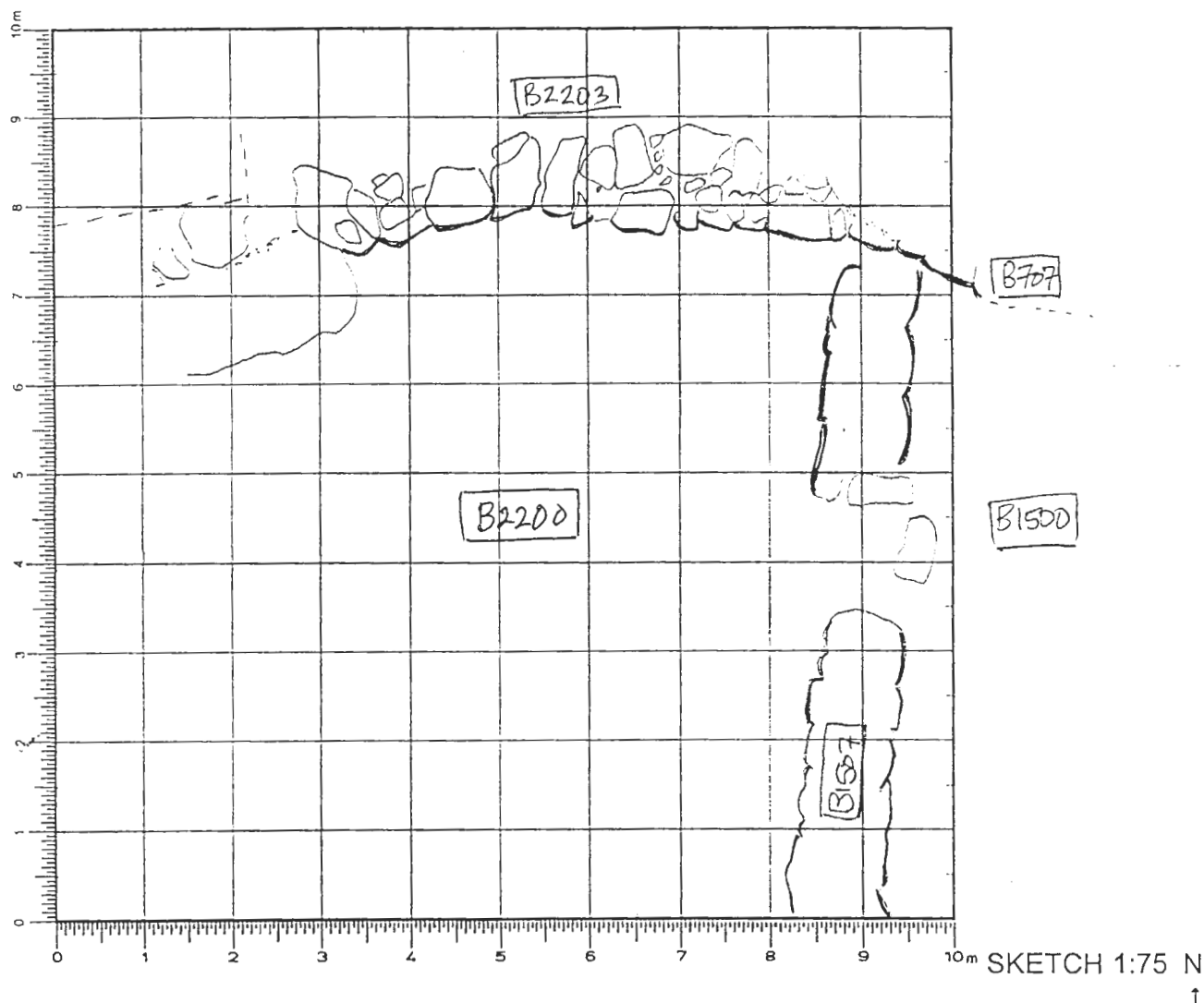

DEFINITION/DESCRIPTION of LOCUS (explain why you changed locus numbers):

Today's date: 15 JUNE 04 Locus above: B2202

Locus parameters:

Verbal description: This is the northern extent of wall B707 which runs N-S along the east side of trench B2200 - large to medium stones for the most part with one very large stone (which has slipped westward) - this stone is ca. 1.85 m long. Wall has 4-5 courses and is slightly ~~slightly~~ slipped westward.

Locus Interpretative Comments (What do you think this is? DATE your comments, continue on additional pages if necessary):

Archaic wall

## AZORIA Project

p.2

Year \_\_\_\_\_ Trench/Locus \_\_\_\_\_ Excavator \_\_\_\_\_

[illegible]

## OBJECTS

[illegible]

ADDITIONAL COLLECTED MATERIAL

[illegible]



Year 2004 Trench/Locus B2204 Excavator SAP

**Elevations**

Benchmark used:  
Reading on  
Benchmark:  
H.I.:

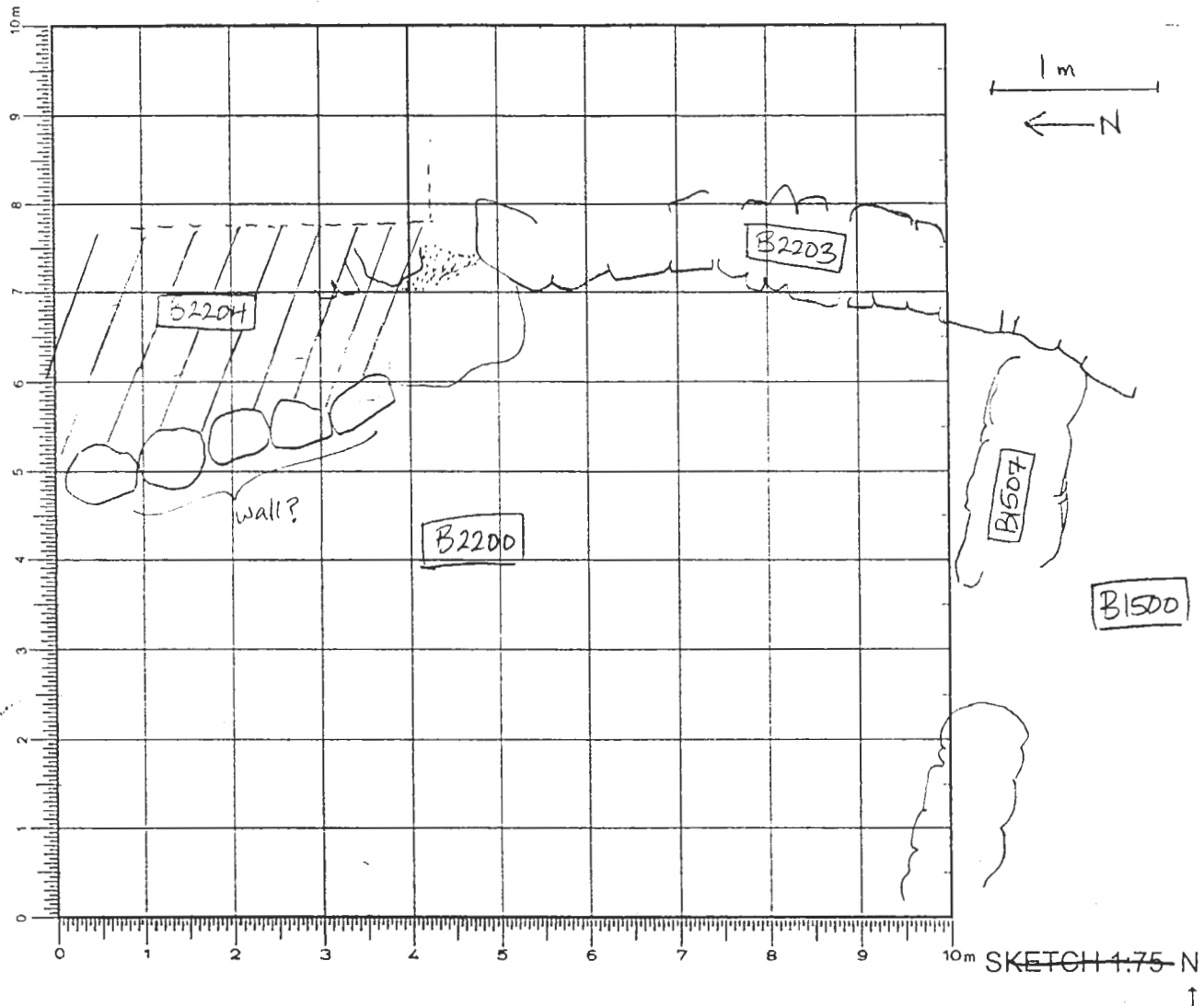

DEFINITION/DESCRIPTION of LOCUS (explain **why** you changed locus numbers):

Today's date: 17 JUNE 04 Locus above: B2202

Locus parameters:

Verbal description: This is the area east of potential wall continuation in north end (wall B2203). Given different locus to keep separate from material west of wall B2203 which is ~~the~~ an interior space. Matrix is full of tumble and there is a line (N-S) of medium sized stones which may be B2203 continuation

Locus Interpretative Comments (What do you think this is? DATE your comments, continue on additional pages if necessary):

tumble on wall B2203

[illegible]

## OBJECTS

[illegible]

ADDITIONAL COLLECTED MATERIAL

[illegible]

Year 2004 Trench/Locus B2204 Excavator SZP

DESCRIPTION of PROGRESS of EXCAVATION [date each entry and identify associated pottery pail(s)]:

- 17 JUNE 04: area east of potanic wall line in the north end of trench is given a new locus - kept separate from excavation rest of wall line and wall B707
- 100% screening
- Such a small area - will screen all of the soil.
  - pottery pail B2204.1 - bone found; standard soil sample taken
  - trying to define / clarify the transition between B707 extension into B2200 and northern section of wall (?) partially excavated

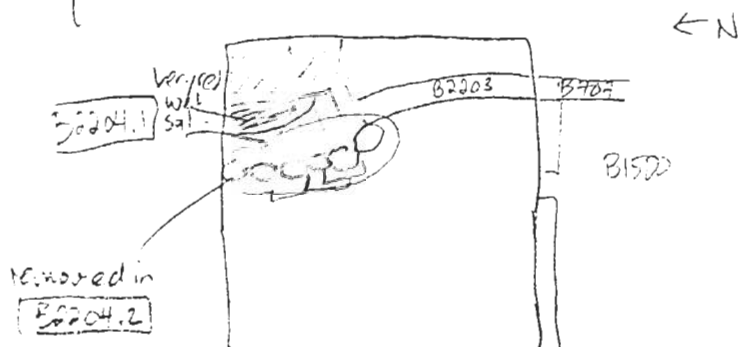

- Standard soil sample taken - B2204.1
- No real clarification on line of stones.
- very red, moist soil. along east of locus - 5YR 4/6.
- Some carbon found

18 JUNE 04: removal of stones which appear to be part of a modern terrace wall. - ~~the~~ ~~pass~~ pottery pail is B2204.2

- underneath these stones, we were able to uncover the northern extent of wall B2203 - and discovered that one of the fallen stones was actually much larger

Year 2004 Trench/Locus B2204 Excavator SZP

DESCRIPTION of PROGRESS of EXCAVATION [date each entry and identify associated pottery pail(s)]:

18 JUNE 04: (cait) than originally thought (ca. 1.8m) 1m  
← N

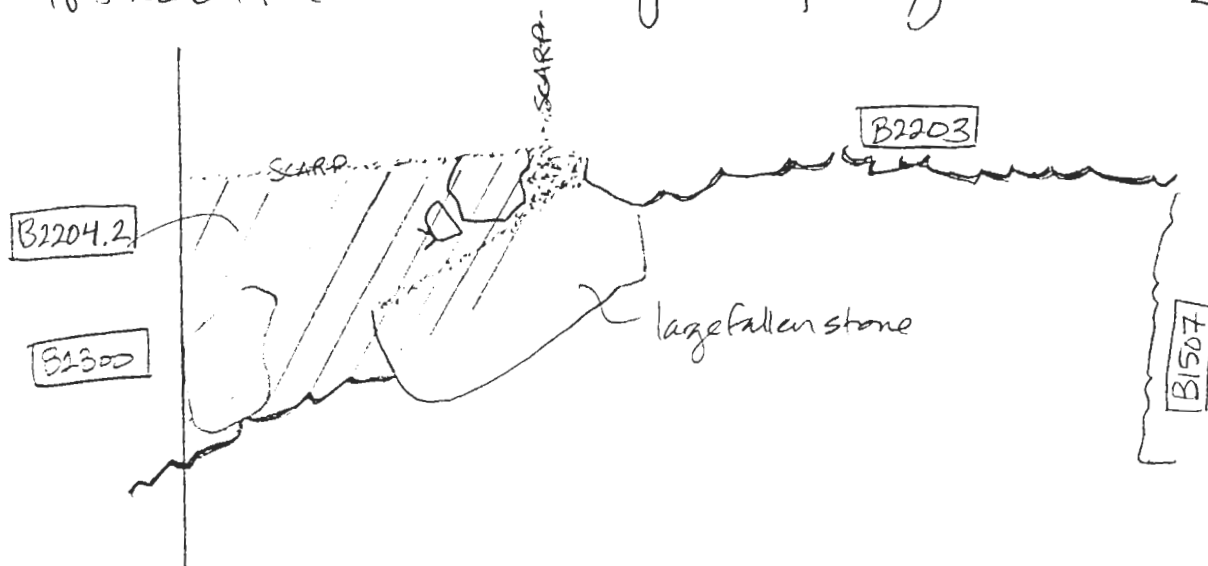

- ! two courses of the N extent of wall B2203 were found - appears that B2203 curves westward in the north - perhaps following the natural contour of the slope.
- ! bone found.
- ! extremely large fallen stone (fell westward off of wall B2203) obscures that section of the wall - attempt to remove it at this point while the ~~area~~ area west of the wall is currently ~~not~~ protected by soil and tumble.
- ! the north section of the large fallen stone broke off in attempt and it became clear that the southern end was too deep for removal at ~~current~~ present - perhaps another pass of interior space ~~will~~ will loosen it.

Year 2004 Trench/Locus B2205 Excavator SZP**Elevations**

Benchmark used:

Reading on

Benchmark:

H.I.:

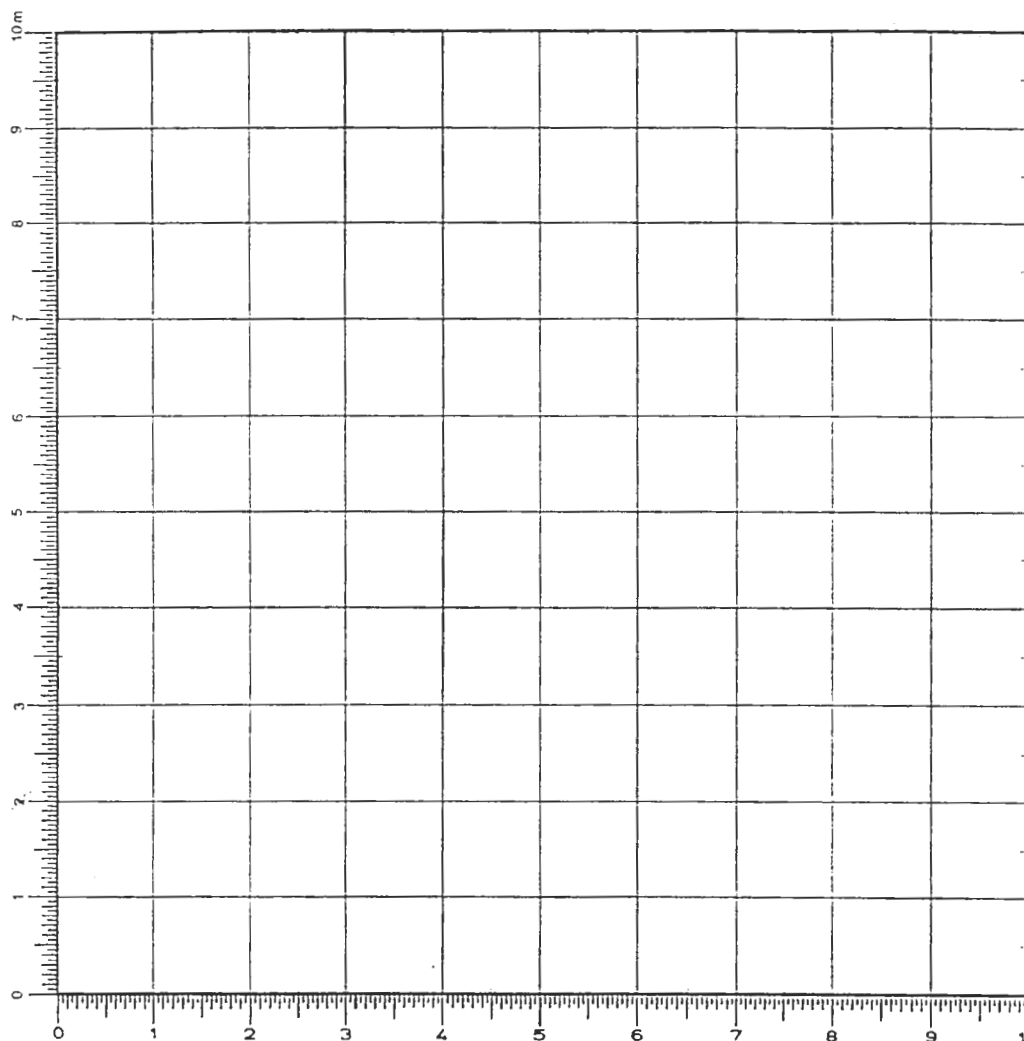

- see diagram  
next page  
for sketch.

SKETCH 1:75 N

DEFINITION/DESCRIPTION of LOCUS (explain why you changed locus numbers):

Today's date: 22 JUN 04 Locus above: B2202

Locus parameters:

Verbal description: New locus representing tumble with destruction debris (evidence of burning) - tumble (medium to large stones) - mostly concentrated in North half of trench. with smaller stones in the south

Locus Interpretative Comments (What do you think this is? DATE your comments, continue on additional pages if necessary):

tumble and burning => destruction level.

Year 2004 Trench/Locus B2205 Excavator SZP

p.2

Locus/Pottery Pail Number	Weight of Sherds	Number of Sherds	Chronology & Comments
B2205.1	11.170	230	EO, O, A
B2205.2	6.150	673	LMIIC, LG-O, O?, A, H?
B2205.3	6.650	629	O?, A, H?
B2205.4	0.270	84	LMIIC, LG, A, H
B2205.5	0.300	73	A
B2205.6	0.180	65	A (LA?)
B2205.7	0.450	79	A
B2205.8	15.225	72	A

### OBJECTS

Object Number	Associated Pottery Pail	Identification (material/form)	Location	Elevation	Catalogue Number
1	B2205.1	Stone pithos lid	1.30m from East face of B2203 2.20m from N face of B1507		
1	<del>B2205.2</del>	<del>stone bowl</del>	<del>2.20m from N face of B1507 1.20m from E face of B2205</del>		
2	B2205.2	bronze tripod stand	3.20m from N face of B1507 0.45m from E face of B2205		
1	B2205.5	stone disk			
2	B2205.5	stone disk			
1	B2205.6	bronze			
2	B2205.6	iron slag	from screen		

### ADDITIONAL COLLECTED MATERIAL

Locus/Pottery Pail Number	Bones	Shell	Carbon	Pumice	Soil Sample	Other (specify)
B2205.1	2 standard 1/4"		2	1	2 intensives standard	
B2205.2	2 standard 1/4"	w/ bone	1	1	21 intensives	
B2205.3	2		4	1	24 intensives	pebble
B2205.4	2			1	8 intensives	
B2205.5	2		1			pebble
B2205.6	1 1/4"				3 intensive	
B2205.7			1		2 intensive	
B2205.8	2 1/4" standard					

Year 2004 Trench/Locus B2205 Excavator SZP

more worked  
bone  
B2209 4  
July 15/04  
unburned

DESCRIPTION of PROGRESS of EXCAVATION [date each entry and identify associated pottery pair(s)]:

B2205.1

22 JUNE 04!

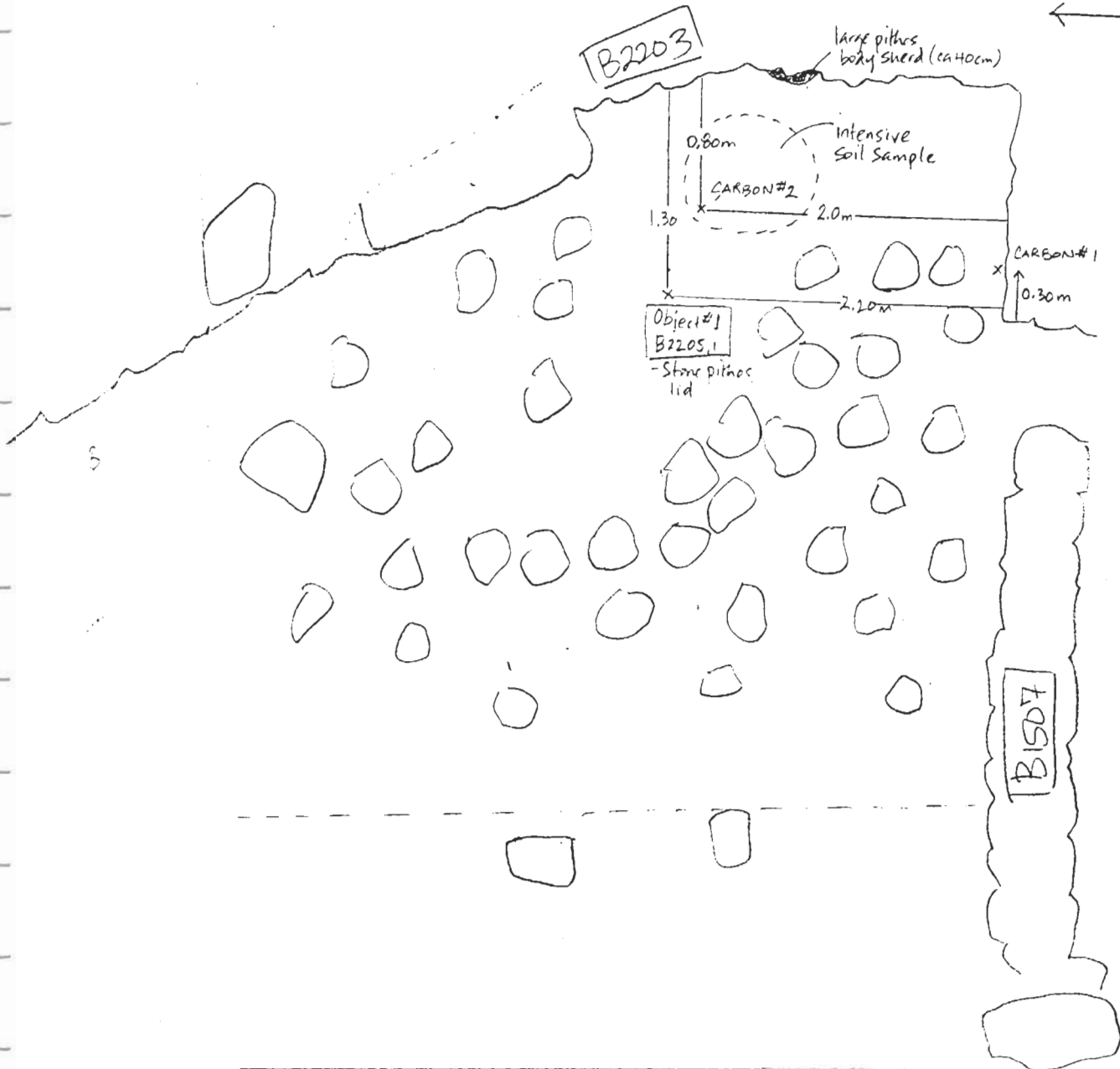
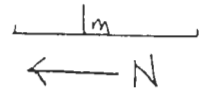

Year 2004 Trench/Locus B2205 Excavator SZP

DESCRIPTION of PROGRESS of EXCAVATION [date each entry and identify associated pottery pail(s)]:

B 22 JUNE 04: new locus for wall tumble/destruction (burnt debris)  
strata — B2205.1 pottery pail  
— removal of tumble large pithos body sherd (40cm wide).

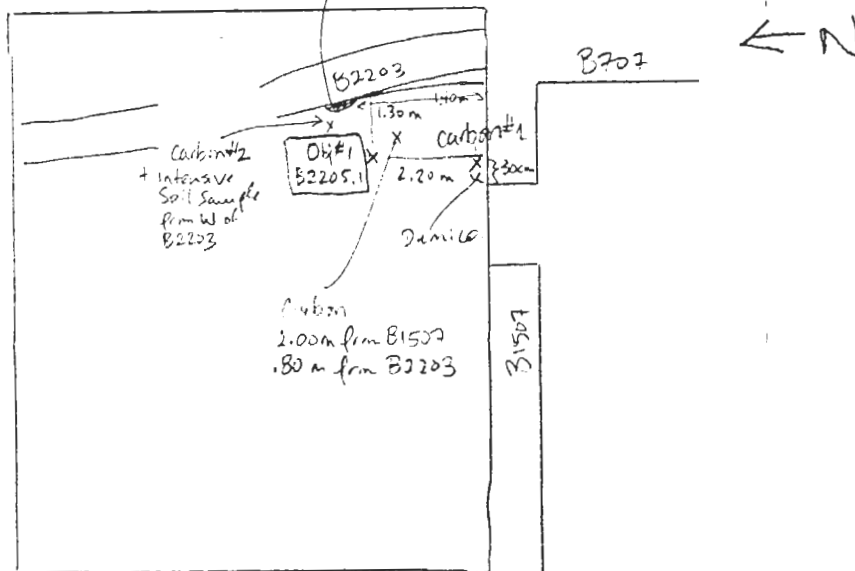

Object #1 — B2205.1 location: 1.30m from B2203  
2.20m from B2207 RH (3.74)  
— Stone pithos lid elevation: tp (2.63) 355.48 HI (3.74)

! concentration of carbon along N face of B1507 — sample #4  
taken 30cm east of east door jamb RH (354.37)  
elevation: (2.85) 355.26 HI (3.74)

! large stone which appears to have fallen off westward off of wall  
B2203 — was partially removed — it was the west face of  
wall B2203

! will screen ( $\frac{1}{4}$ " ) a random 5 zentiblis.

! many medium to large stones removed (ca. 25cm — 50cm)  
during pass

! Standard soil sample taken B2205.1

! large pithos sherds from SE corner area — as in previous  
passes



Year 2004 Trench/Locus B2205 Excavator SEP

DESCRIPTION of PROGRESS of EXCAVATION [date each entry and identify associated pottery pail(s)]:

HT (3.75)  $214 = 354.37$   
358.12

22 JUNE 04: (unit)

concentration of carbon found - <sup>carbon</sup> Sample taken #2

location: 2m from B1507; 0.80m from B2203

elevation (2.89) 355.23

also an intensive soil sample from area of carbon concentration  
- burnt material from W of B2203  
← N

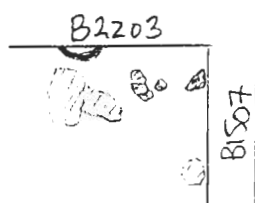

/// - burnt material  
\* - pottery shards

B2300 seems to have a burnt debris layer which runs along the west side of B2203 - higher floor level? - had expected floor to be much lower based on floor level in B1500

\* At centre - pumice found in pottery bags.

23 JUNE 04: Start elevations for ~~start~~ next pass - pottery pail

B2205.2; lane bag

! removal of tumble, pithos scatter, stone quern <sup>left for drawing</sup>

! stone quern visible on strata - Object #1 - B2205.2  
~~stone quern~~ <sup>not taken out today</sup>

! near the well. (N-S) along west side, found a bronze tripod stand (almost half with one foot)

Object #2 - B2205.2 -

Year 2004 Trench/Locus B2205 Excavator SZP

DESCRIPTION of PROGRESS of EXCAVATION [date each entry and identify associated pottery pail(s)]:

23 JUNE 04:

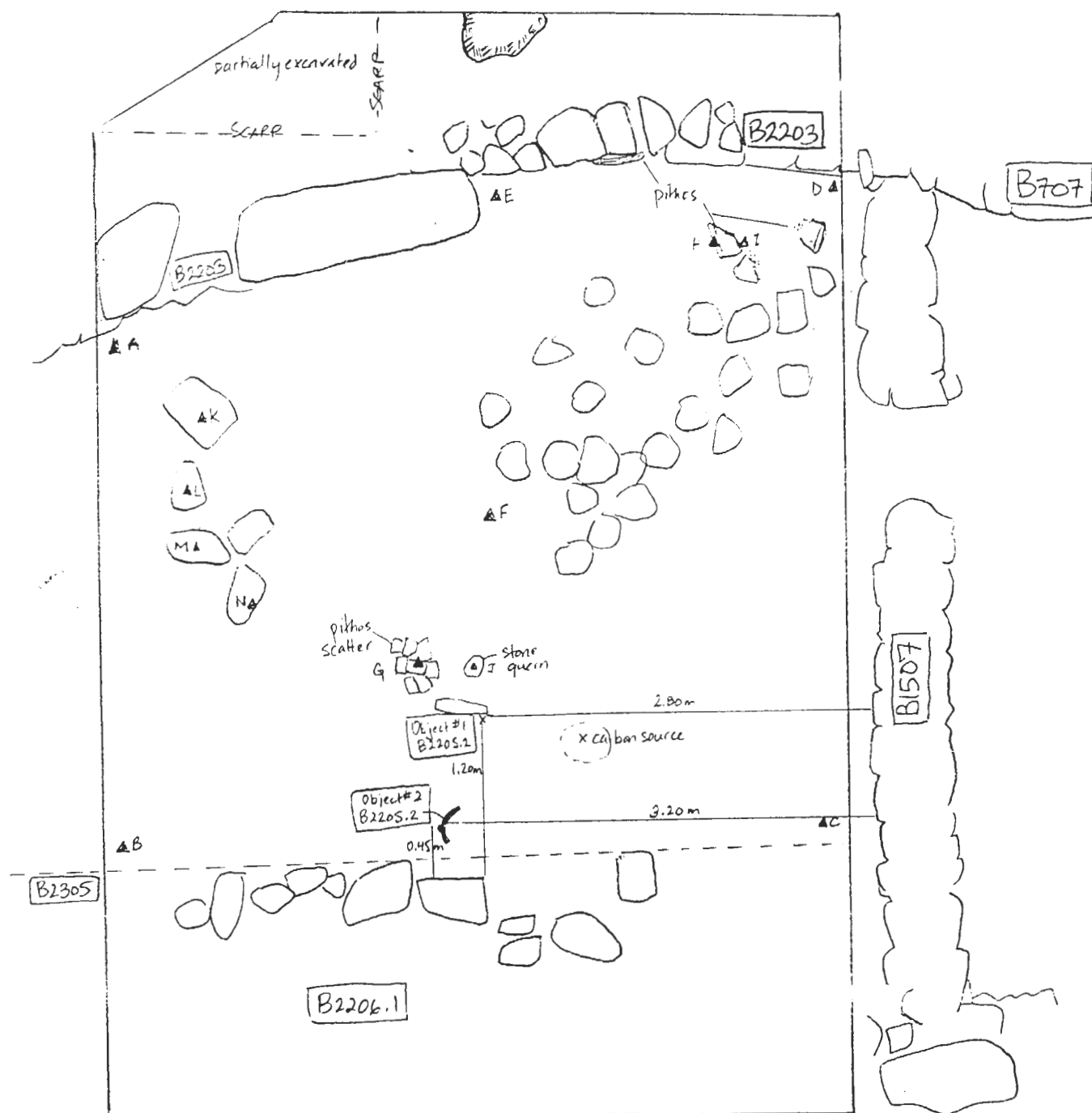

# START ELEVATIONS FOR B2205.2

A. (2.68) 355.39  
B. (2.98) 355.09  
C. (3.04) 355.03  
D. (2.77) 355.30  
E. (2.67) 355.40  
F. (2.97) 355.10  
G. (2.93) 355.14

H. (2.63) 355.44  
I. (2.80) 355.27  
J. (2.95) 355.12  
K. (2.66) 355.41  
L. (2.71) 355.36  
M. (2.75) 355.32  
N. (2.79) 355.28

Benchmark R14 (354.37)  
HI (3.70) 358.07

Benchmark R14  
HI (3.71) 358.08

Object #1 - B2205.2  
(3.07) 355.01

Object #2 - B2205.2  
top (2.97)  
bottom (3.04)  
carbon source (3.10)

Year 2004 Trench/Locus B2205 Excavator SEP

DESCRIPTION of PROGRESS of EXCAVATION [date each entry and identify associated pottery pile(s)]:

23 JUN 04: (cont). approx 1.20 m from east face of wall B2207

100% screening  
We found ~~the~~ 3 <sup>long</sup> stones (one small, 2 large) - ~~the~~ which forms the west boundary of a hearth. - within the hearth is a stone ~~quern~~ <sup>grain</sup> quern and to its north is a pithos scatter.  
! excavation of N area stopped until bronze stand was drawn in

! strategy to leave soil within the hearth and to dig out the exterior of the hearth. 1 - to be excavated later as different locus

! lots of burnt material around the hearth area (west and north sides still unknown) - intensive soil samples taken (see diagram for source).

Object # B - B2205.2 - stone tool?

location: 2.80 m from B1507  
1.20 m from west room  
(see p. 6 diagram)

! interior of hearth will not be excavated with this pass. -

! stones (which we thought might be a cross wall) in north section removed because we can see a pithos scatter underneath it

! Pithos fragments peaking out in SE corner of room turned out to be part of a large pithos base - contents of which will be left for excavation separately - contents will be an intensive soil sample.

! Scatter of pithos uncovered NW of ~~the~~ hearth

! in SE corner of room, large flat stone uncovered

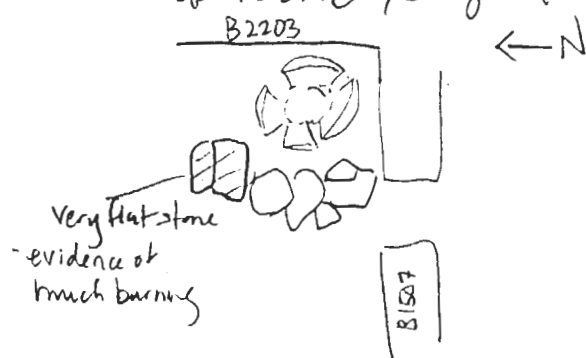

Year 2004 Trench/Locus B2205 Excavator S2P

DESCRIPTION of PROGRESS of EXCAVATION [date each entry and identify associated pottery pile(s)]:

23 JUNE 04: (cont)

INTENSIVE SOIL SAMPLES FOR B2205.2

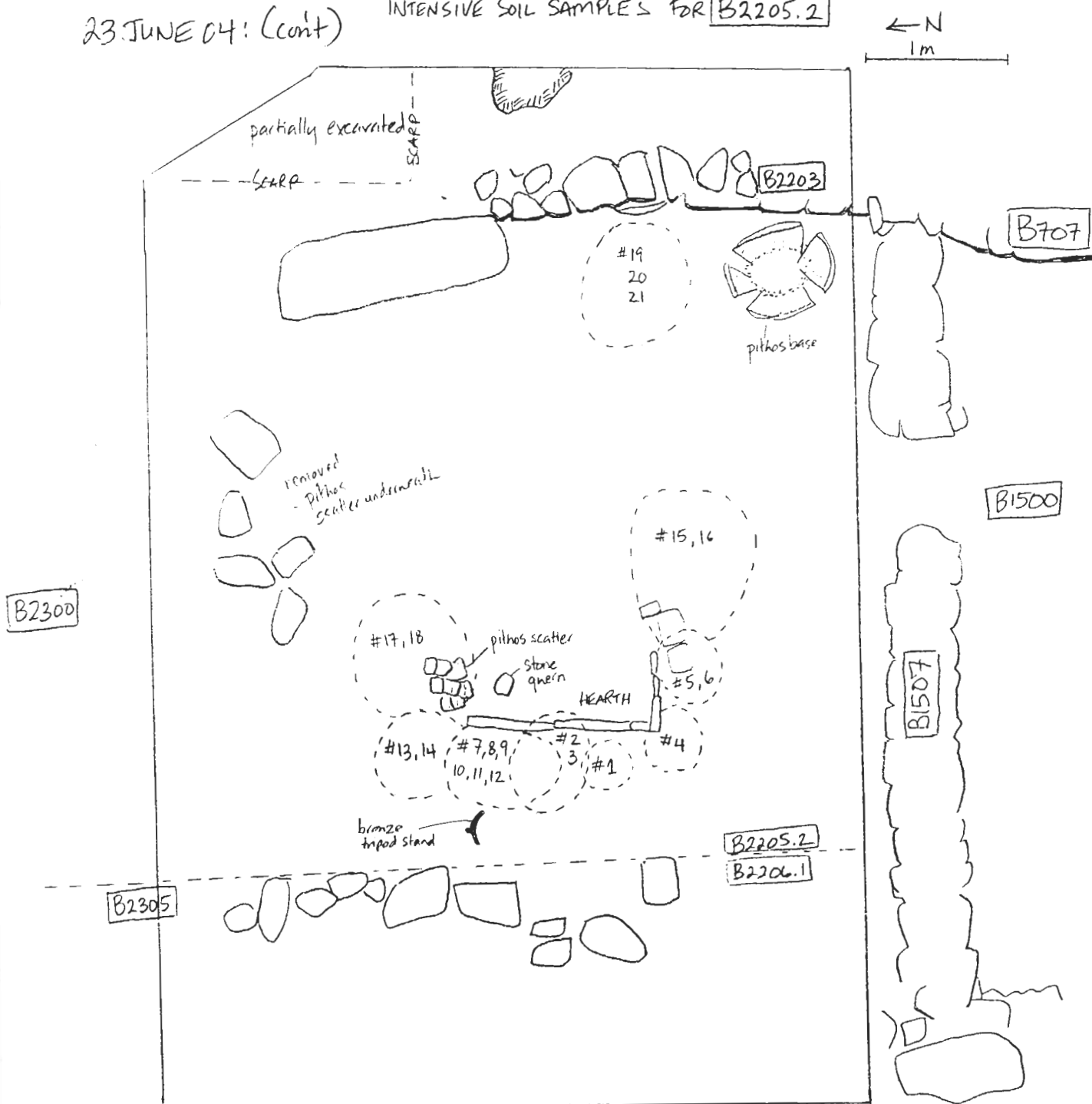

Year 2004 Trench/Locus B2205 Excavator SZP.

DESCRIPTION of PROGRESS of EXCAVATION [date each entry and identify associated pottery pail(s)]:

24 JUNE 03: continued pass from day before - new pottery pail is B2205.3

purpose to define parameters of large central hearth (esp. in the north and east sides), define pithos scatters, and find some sort of transition between B1500 and B2200  
cone found

large chunks of carbon found west of wall B2203 (southern)  
 → sample taken #1

deposit of roofing clay along west side of wall B2203  
 → intensive s.s. #1

deposit of carbon - large chunks found around pithos scatter in N section of trench.

→ sample taken #2

additional pithos scatters uncovered and defined in N section.

intensive s.s. #2, 3, 4 from N side → carbon source area.

another carbon source from SE quadrant

→ sample taken #3

→ intensive s.s. #5

pebbles found just along N side of W door jamb of B1507

intensive s.s. #6, 7 from N section → intense burn deposit

along west side of large fallen wall stone (from B2203) - burning  
 → intensive s.s. #8, 9, 10, 11, 12, 13, 14

additional intensive s.s. from area of carbon source #3  
 → #15, 16

intensive soil samples from just NW of carbon source #1  
 → #17, 18 → burning and roofing clay

wall B2203 drawn

pithos base from SE corner drawn,

DESCRIPTION of PROGRESS of EXCAVATION [date each entry and identify associated pottery pile(s)]:

light excavation of higher level in SE corner. → definition of pithos base; removed some tumbled stones by the E door jamb of B1507; left two upright stones in place until further clarification

found another upright stone roughly parallel to stones roughly  
30cm west of it → in between is a large flat surface (2 stones)  
→ another hearth with a warming stone?

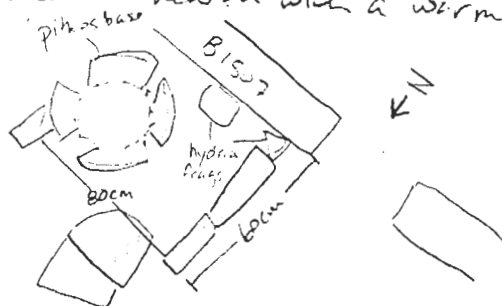

Questions → What is the transition for this area from B1500?

- identified two potential steps (at bottom in B1500) but upper steps ~~to~~ are obscured by rubble → will excavate separately as B2007

excavation of NE corner - cluster of stones  $\rightarrow$  ~~is~~ not removed as there is a potential bench/platform along wall B2203 in B2300 - will try to find its southern parameters

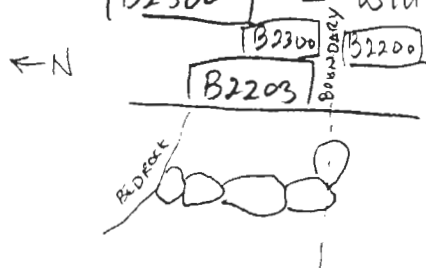

- found the southern limit of bench just along the boundary between B2300 and B2200

Year 2004 Trench/Locus B2205 Excavator SZP

DESCRIPTION of PROGRESS of EXCAVATION [date each entry and identify associated pottery pail(s)]:

24 JUNE 04! (continued)

- ! intensive S.S. # 19, 21, 20 from N of smaller hearth.
- ! Smaller hearth explains the concentration of carbon and other burnt material from that area.
- ! additional intensive S.S. # 22, 23, 24 from N section
- ! two plaques found to west of large stone fallen from B2203
- ! additional carbon sample # 4 - just west of large fallen stone.

Year 2004 Trench/Locus B2205 Excavator SJP

DESCRIPTION of PROGRESS of EXCAVATION [date each entry and identify associated pottery pile(s)]:

24 JUNE 04

Intensive Soil Samples for B2205.3

← N

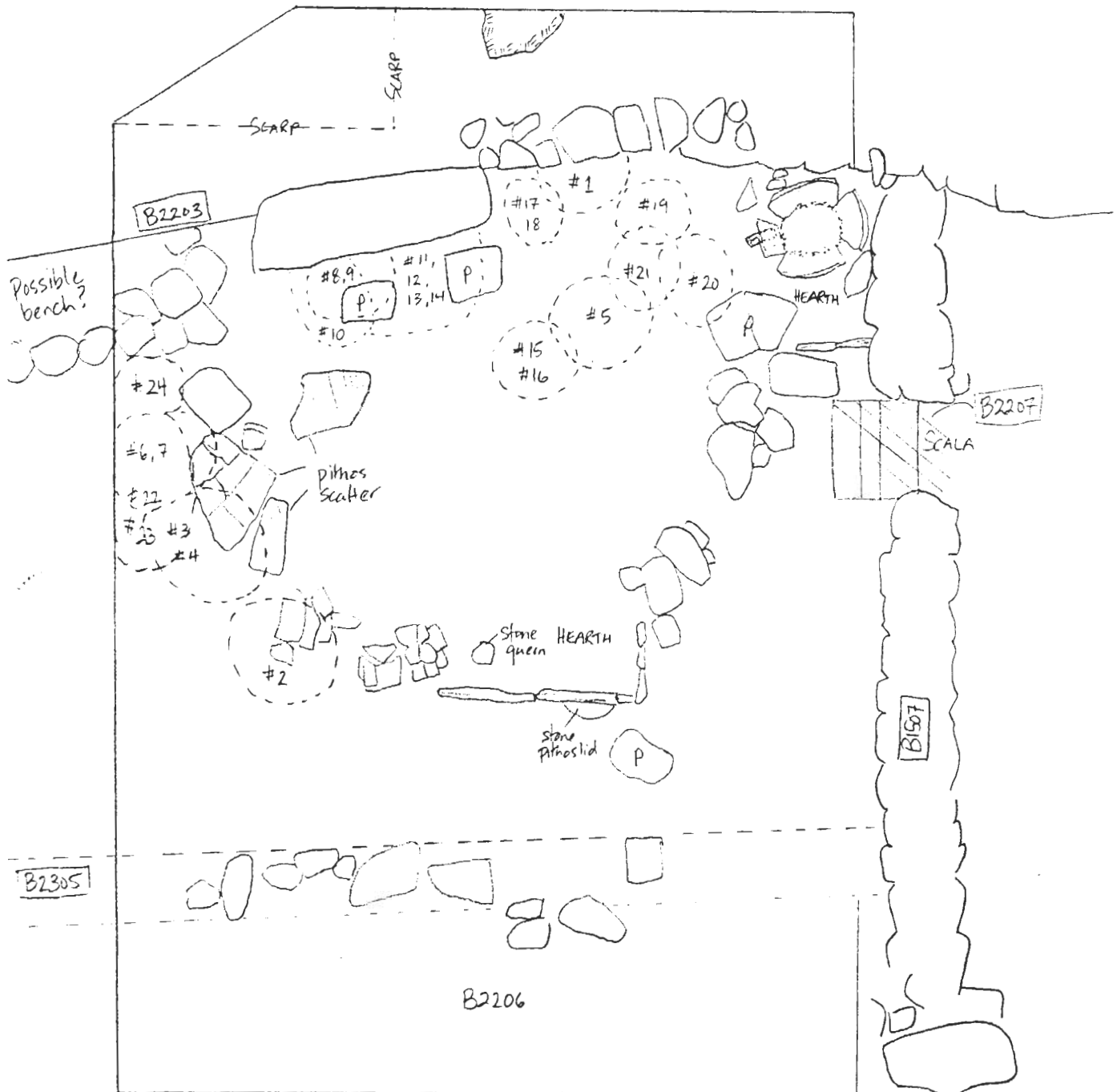





Year 2004 Trench/Locus B2205 Excavator SZP

DESCRIPTION of PROGRESS of EXCAVATION [date each entry and identify associated pottery pile(s)]:

25 JUNE 04: Continued pass from previous day - new pottery pile is B2205.4 - excavating higher level ~~at~~ against the W face of large stone fallen from B2203, moving south to north

100%  
screening

- lots of burnt material - intensive soil samples taken
- agrimi cores fragments found from this area → Bone
- soil is becoming more compact → perhaps floor surface?
- two planks just west of large fallen stone may indicate proximity of floor level - yet this area is still high compared to the level of the threshold step from the steps in B2207
- intense burning occurred along the west face of B2203 total of (8) intensive soil samples taken.
- pumice found

- Area in the SE corner of room - shallow pass in area immediately west and north of SE corner hearth - new pottery pile is B2205.5 - moving northward towards the area of the central hearth in anticipation of ~~finding~~ ~~the~~ of defining the SE and E ~~base~~ limits of central hearth. ; bone found

100%  
screening

- some tumbled stones removed from area just NE of Stairway

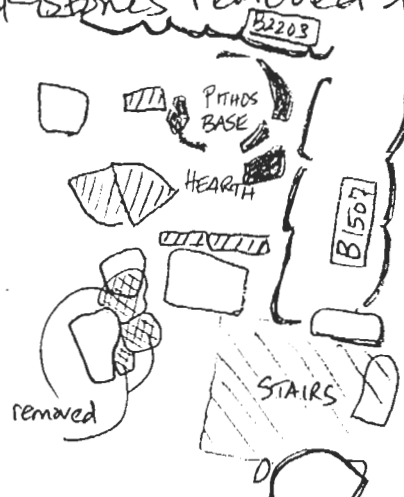

Year B2004 Trench/Locus B2205 Excavator SZP

DESCRIPTION of PROGRESS of EXCAVATION [date each entry and identify associated pottery pail(s)]:

25 JUNE 04: (cont) removed three tumble stones NE of stairs -  
 3 flat stones now remain in this area: the two most  
 easterly stones may form a division/barrier between the  
 SE corner hearth area and the stairwell. → the third  
 stone's ~~role~~ role (if any) is yet unknown. - this area is  
 still above the floor surface judging by the threshold stone  
 of stairwell

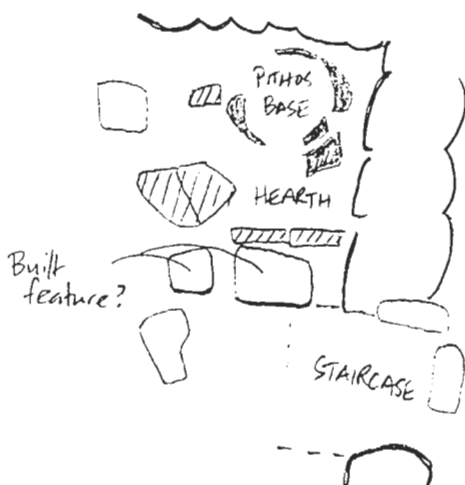

Object #1 - B2205.5 small stone disk - lid?

location: 0.75m from B1507; 1.40m from B2203  
 elevation: (3.62) 355.13 R14 354.37  
 HI (438) 358.75

! area of carbon just north of hearth plaka - sample taken  
 - carbonized area is rectangular in shape ~~app~~ with its  
 axis roughly N-S.

! one petable found N of west door jamb of B1507

Object #2 - B2205.5 small stone disk - lid?

location: 2.30m from B1507; 1.60m from SW corner  
 of large fallen stone  
 elevation: (3.62) 355.13 R14  
 HI (438) 358.75

Year 2004 Trench/Locus B2208 Excavator SZP

DESCRIPTION of PROGRESS of EXCAVATION [date each entry and identify associated pottery pile(s)]:

1 July 04! Summary of  
Loci

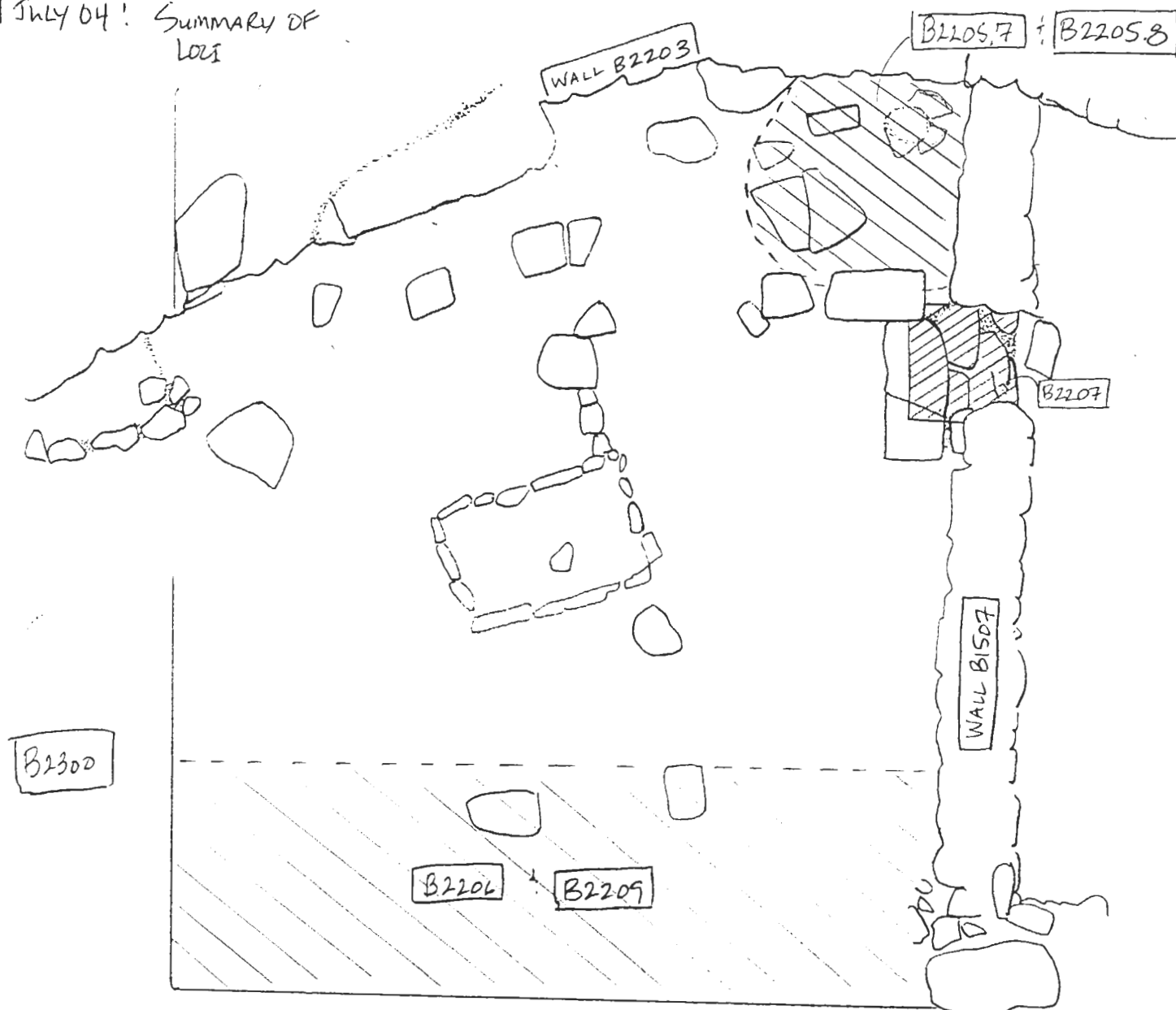

B2205.1 - entire room - tumble / roofing clay

B2205.2 - entire room - burnt material / roofing clay

B2205.3 entire room - burnt material / roofing clay

Year 2004 Trench/Locus B2205 Excavator SZP

DESCRIPTION of PROGRESS of EXCAVATION [date each entry and identify associated pottery pail(s)]:

25 JUNE 04: (cont.)

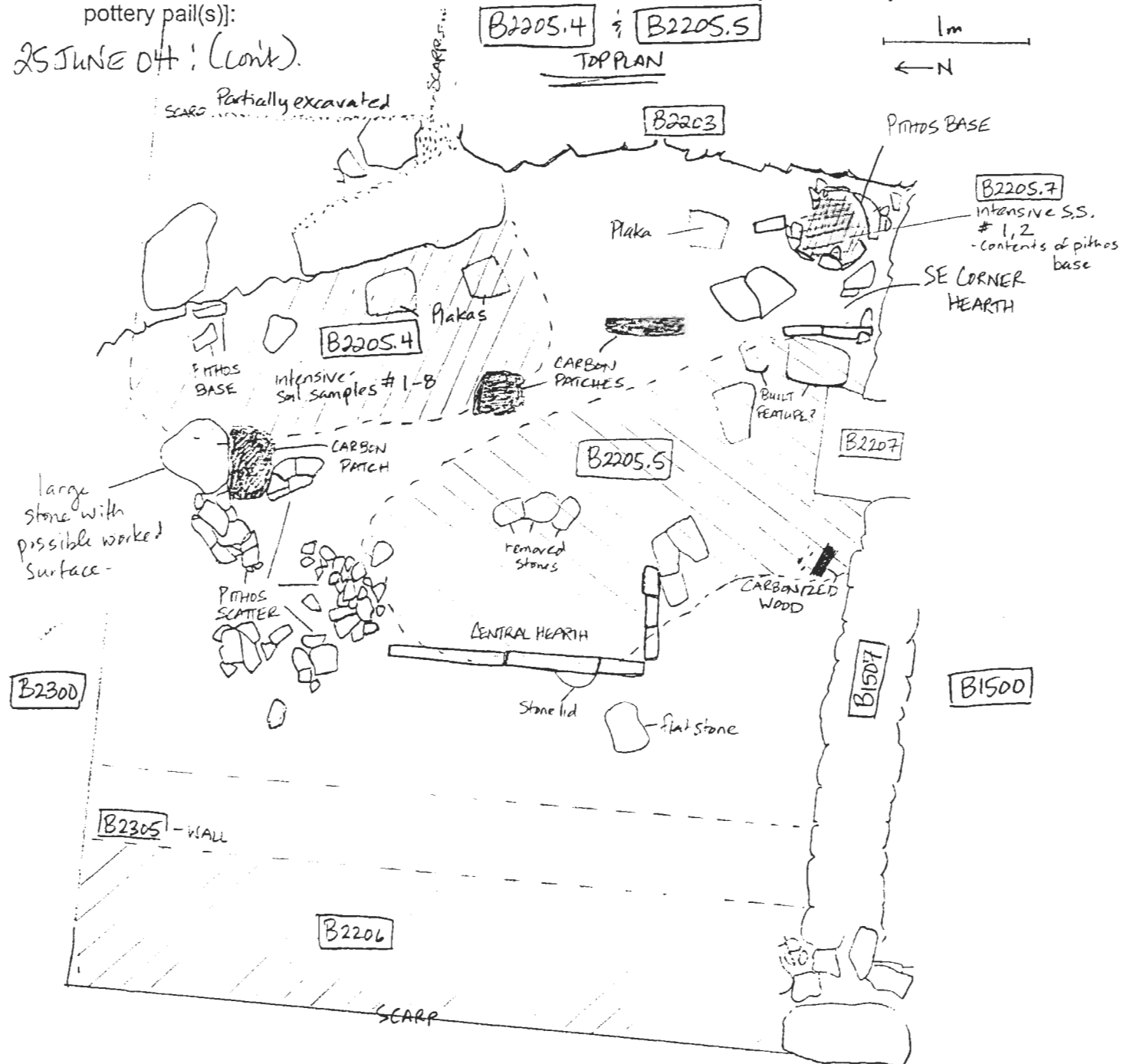

Year 2004 Trench/Locus B2205 Excavator SZP

DESCRIPTION of PROGRESS of EXCAVATION [date each entry and identify associated pottery pail(s)]:

25 JUNE 04! (cont)

B2205.6 TOP PLAN

1m  
← N

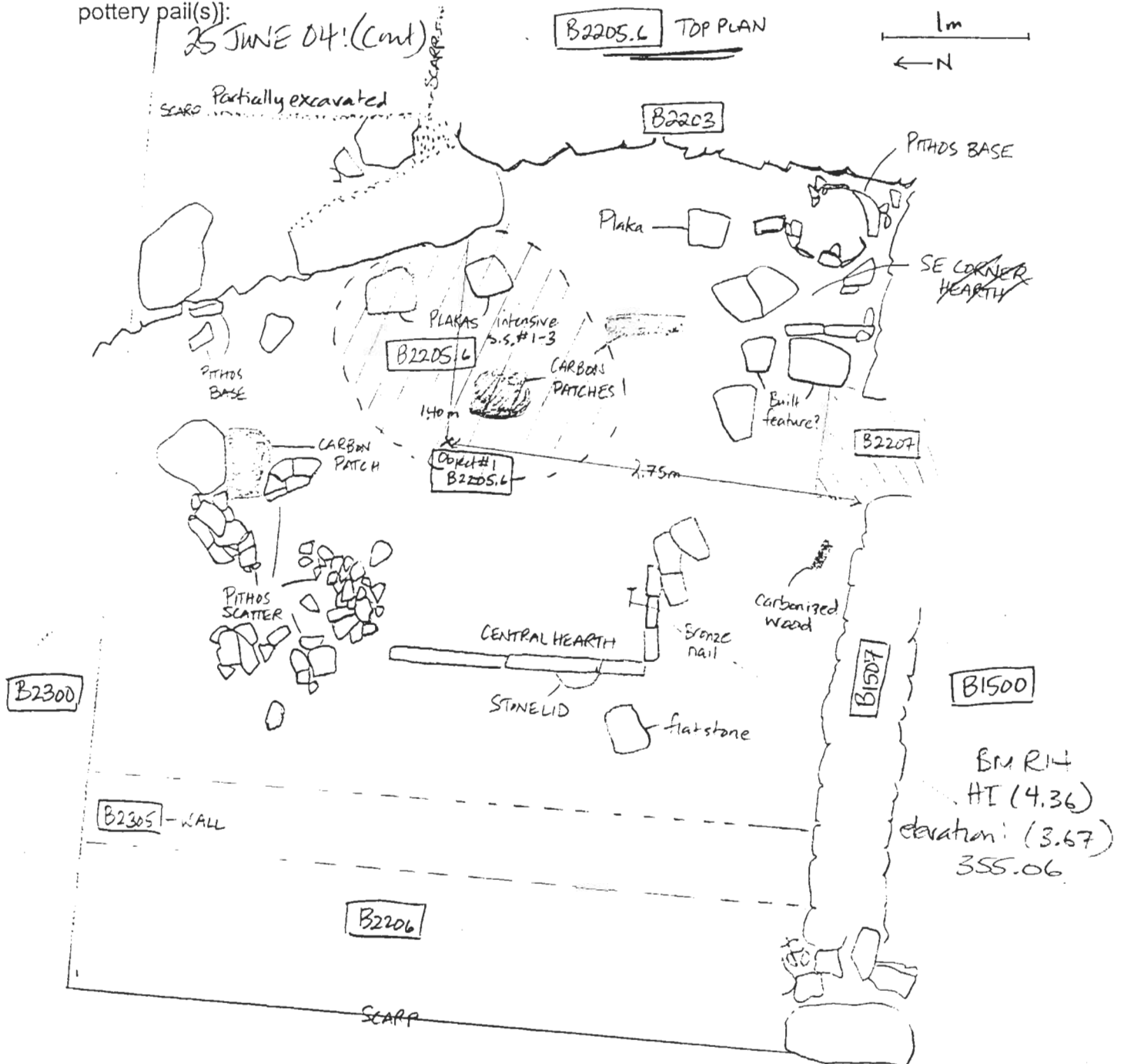

Year 2004 Trench/Locus B2205 Excavator SZP

DESCRIPTION of PROGRESS of EXCAVATION [date each entry and identify associated pottery pile(s)]:

25 JUNE 04: (cont) cluster of three stones which were pedestaled on the east side of the central hearth were removed - unfortunately ~~the~~ the northern and eastern boundaries of the central hearth were still not found.

Some carbon found in area east of central hearth.

\* found  
bronze nail  
in SW corner  
of central hearth  
↳ left in  
situ

pass completed - cleaning and sweeping of both  
[B2302] and [B2202] for photos  
from sweeping - noticed a carbonized chunk of wood  
preserved in matrix → just N of west doorjamb in [B1507]

! photos:

\* large stone in the NE trench may be worked on surface - possible work area or seat for working - this stone is just SW of platform/bench in [B2302]

! another shallow pass of area NE most of pit has scatter which is still above the expected surface level (confirmed to some degree by the threshold stone in the stairway of [B1507] — pass moving from NE towards SE in order to find N and E parameters of the central hearth — new pottery pile is [B2205.6]

! area of burning - especially area west of large fallen stone - intensive soil samples (3) bags taken.

! area of yellowish soil between the two plakias.  
! additional plakias found.

Object #1 - [B2205.6]

location: 2.75m from [B1507]  
1.40m from large fallen stone  
bronze fragment from knife? elevation: BM R14  
HT (4.36)  
(3.67) 355.06 masl.

Year 2004 Trench/Locus B2205 Excavator SJP

DESCRIPTION of PROGRESS of EXCAVATION [date each entry and identify associated pottery pail(s)]:

25 JUNE 05: (cont) coming upon burnt clay area.

Object #2 - B2205.6 - from screen.

iron slag

! no bone found - only 1/4" bone frag.

↳ this pass should be new locus

! light clean up in SE corner area, around pithos base → pottery pail is B2205.7

B2205.7

28 JUNE 05: continued pass from previous day in SE corner around pithos base - ~~pot~~ pail B2205.8  
bone found

! some pithos sherds collected but base lot intact

! completed pass.



Year 2004 Trench/Locus B2205 Excavator SZP

DESCRIPTION of PROGRESS of EXCAVATION [date each entry and identify associated pottery pail(s)]:

28 JUNE 05!

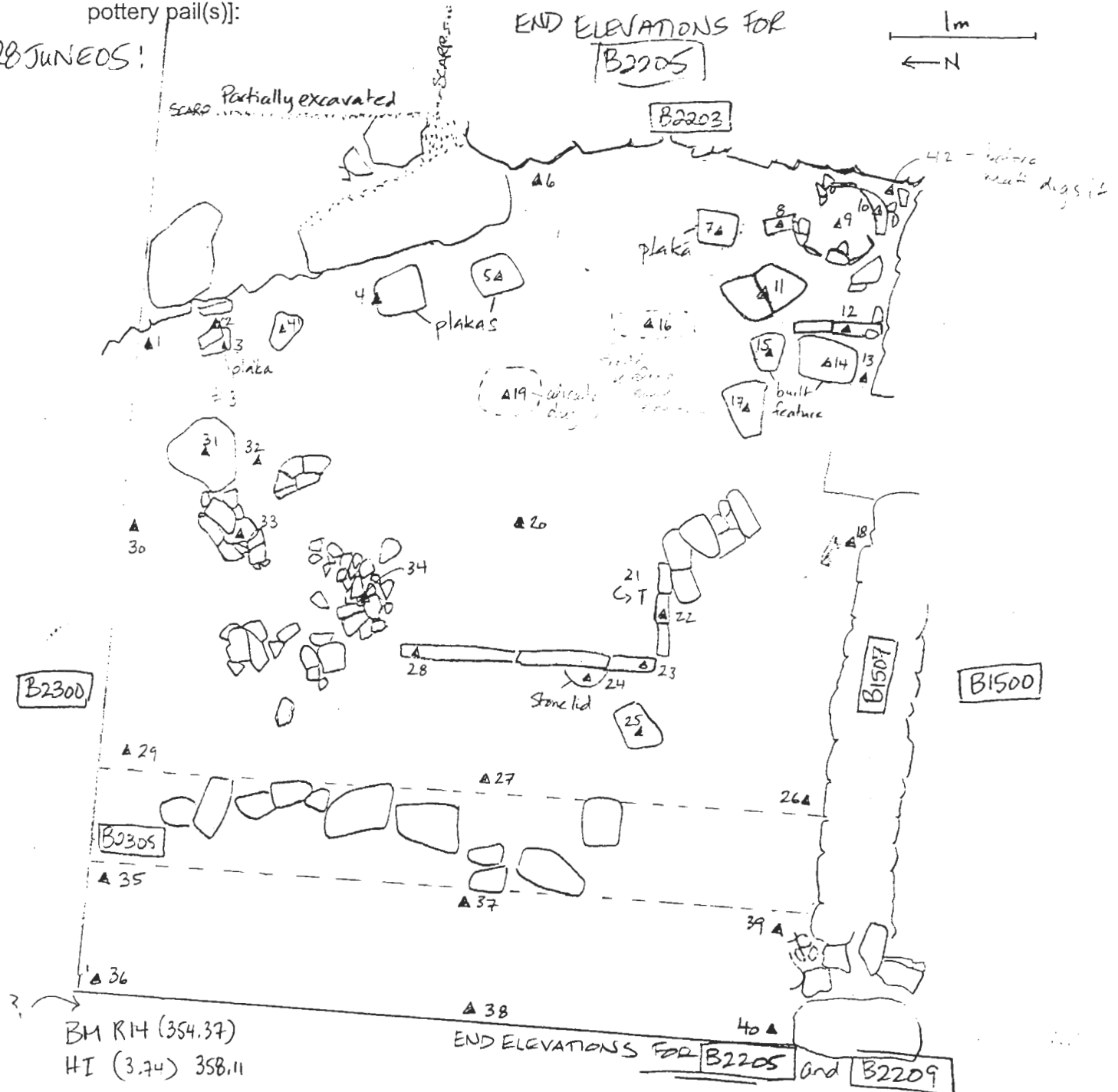

1. (2.985) 355.125	11. (2.91) 355.2	21. (3.04) 355.02	31. 2.69.	41 2.943
2. (2.72) 355.39	12. (2.785) 355.325	22. (3.02) 355.09	32. (2.998) 355.112	42. 2.815
3. (2.855) 355.255	13. (3.003) 355.107	23. (3.043) 355.067	33. 2.988	
4. (2.84) 355.27	14. (2.928) 355.182	24. (3.115) 354.995	34. 2.95	
5. (2.90) 355.21	15. (2.945) 355.165	25. (3.138) 354.972	35. 3.315	
6. (2.897) 355.213	16. (2.987) 355.123	26. (3.115) 354.995	36. 3.332	
7. (2.875) 355.235	17. (2.89) 355.12	27. (3.158) 354.95	37. 3.355	
8. (2.767) 355.343	18. (3.025) 355.085	28. 2.943	38. 3.363	
9. (2.963) 355.147	19. (2.995) 355.115	29. 3.045	39.	
10. (2.79) 355.32	20. (2.998) 355.112	30. 3.023	40.	

## Elevations

H.l.:

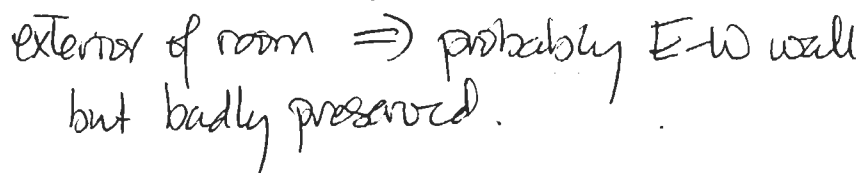



Year 2004 Trench/Locus B2206 Excavator SZP

DESCRIPTION of PROGRESS of EXCAVATION [date each entry and identify associated pottery pail(s)]:

23 JUNE 04: Excavation of area west of two plakias (see diagram) to remove loose ~~top~~ soil which may still contain topsoil material — also to see if there is a west wall (N-S axis). — soil is red-brown, loose with many fist size and smaller inclusions — pottery pail is B2206.1  
Bone found

! excavation began in the N and moved Southward —  
 approximate depth of 10-15 cm.  
 ! linear configuration of stones

24 JUNE 04: Second pass of area west of B2305 — in order to bring it down to level in B2300 and to further define the southern extent of wall ~~B2300~~ B2305  
 — pottery pail is B2206.2; bone found

100%  
 screening

Object #1 — B2206.2

— spindle whorl found in screen.  
 — pebble found.

Year 2004 Trench/Locus B2206 Excavator SZP

DESCRIPTION of PROGRESS of EXCAVATION [date each entry and identify associated pottery pail(s)]:

23 JUNE 04: (cont)

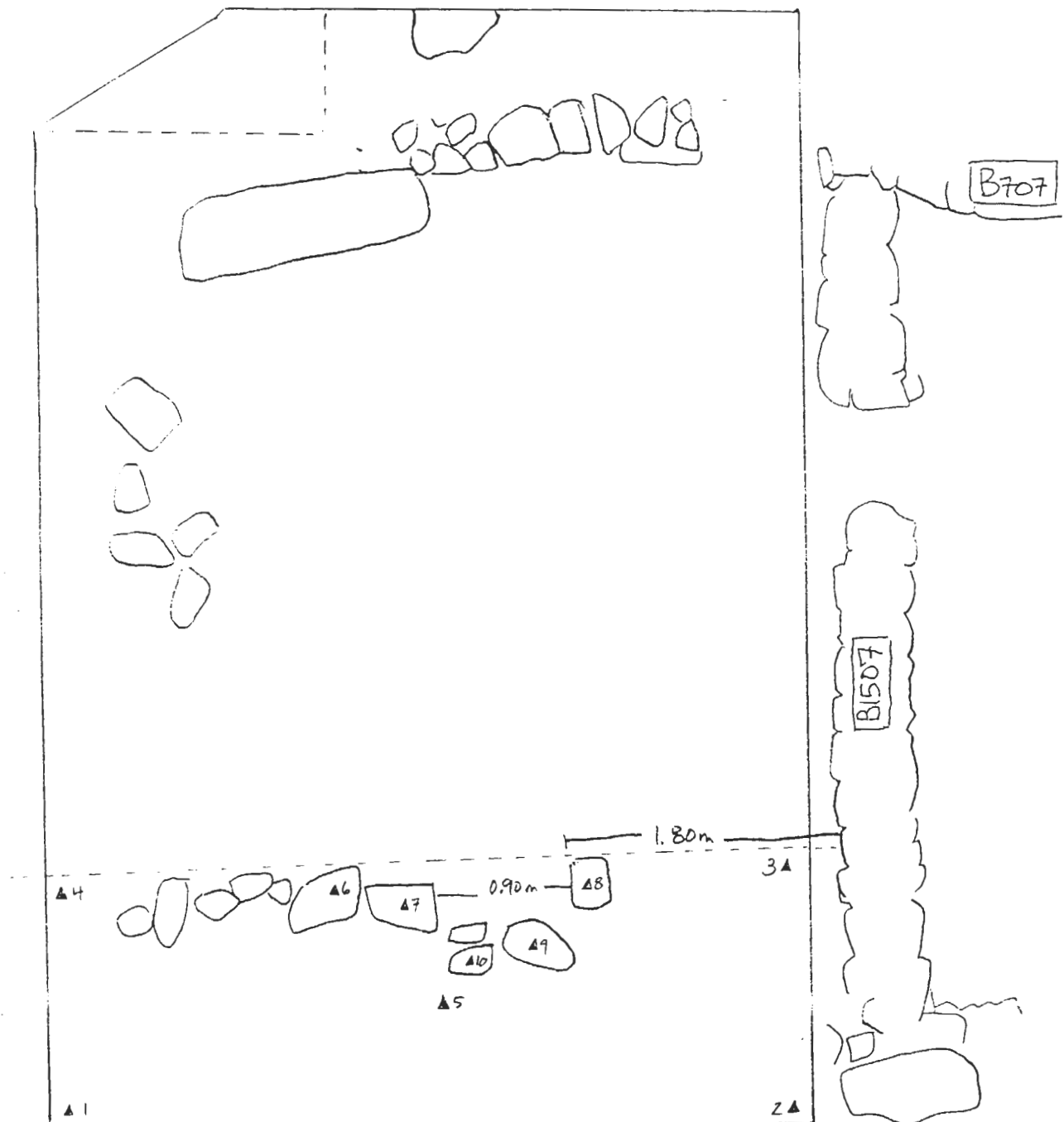

END ELEVATIONS FOR B2206.1

BM R14 (354.37)

HT (354) 357.91

1. (3.17)

2. (3.12)

3. (3.10)

4. (3.10)

5. (3.19) 354.72

6. (2.99)

7. (3.04) 354.87

8. (3.06) 354.85

9. (3.09)

10. (3.12)

Year 2004 Trench/Locus B2207 Excavator SEPElevations

Benchmark used:

Reading on

Benchmark:

H.I.:

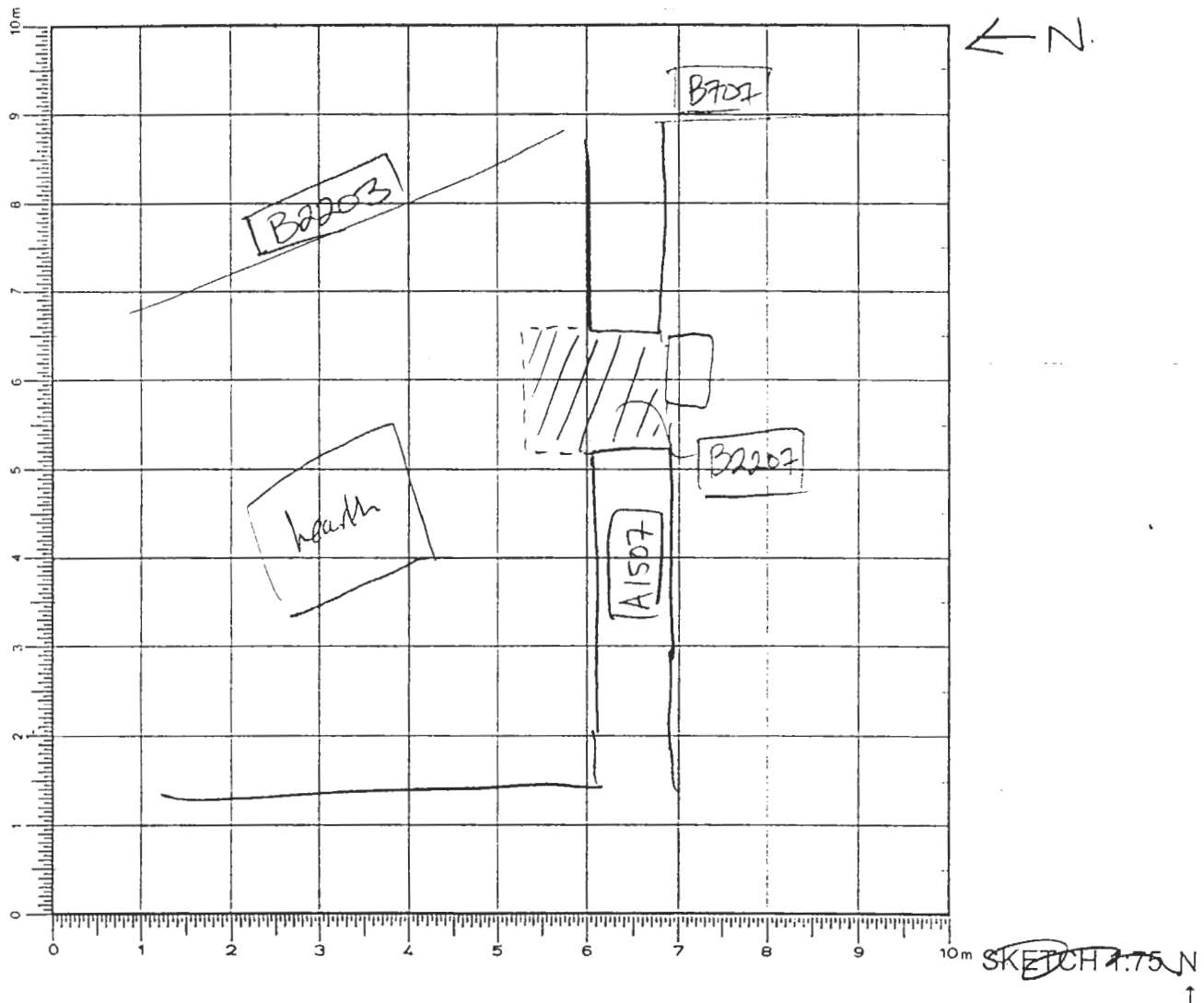

DEFINITION/DESCRIPTION of LOCUS (explain why you changed locus numbers):

Today's date: 24 JUNE 2004 Locus above:

Locus parameters:

Verbal description: This is the area between the doorjambos in A1507 and just north of doorway. - hard compact clay material

Locus Interpretative Comments (What do you think this is? DATE your comments, continue on additional pages if necessary):

Stairs <sup>to</sup> B1500 and B2200  
between

p.2

[illegible]

## OBJECTS

[illegible]

ADDITIONAL COLLECTED MATERIAL

[illegible]

Year 2004 Trench/Locus B2207 Excavator SZP

DESCRIPTION of PROGRESS of EXCAVATION [date each entry and identify associated pottery pail(s)]:

24 JUNE 04: new locus for doorway of B1507 - to find transition from B1500 into much higher area of B2200

105%  
screening

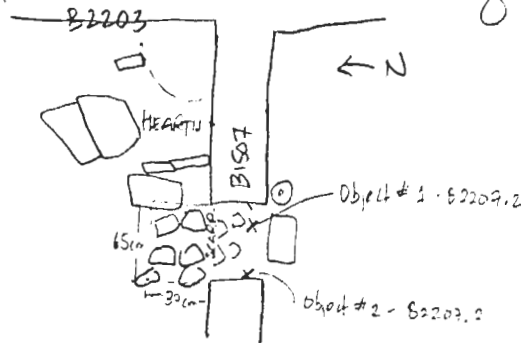

- Pottery pail is B2207.1

- uncovered the top step - covered with burnt material (probably from adjacent hearth) intensive s.s. # 1
- second pass - upon change in colour from red-brown to very red soil - new pottery pail B2207.2
- concentration of carbon (large chunks at 3rd step down)
  - sample taken # 1
  - intensive s.s. # 1, 2

elevations taken.

Object # 1 - B2207.2 & see diagram - on third step elevation.

not objects

Ceramic disk

elevation.

not objects: Object # 2 - B2207.2 joins

Ceramic disk

See diagram - on third step elevation.

4 steps found - excavation ended for day

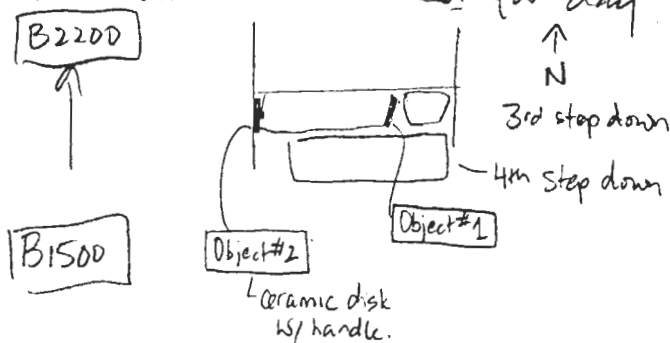



Year 2004 Trench/Locus B2207 Excavator SJP

DESCRIPTION of PROGRESS of EXCAVATION [date each entry and identify associated pottery pail(s)]:

HL (4.52) R14 388.89  
 A 3.93  
 B. 4.03  
 C. 4.17  
 D. - bottom B2207.1 (4.00)

12 bags  
down

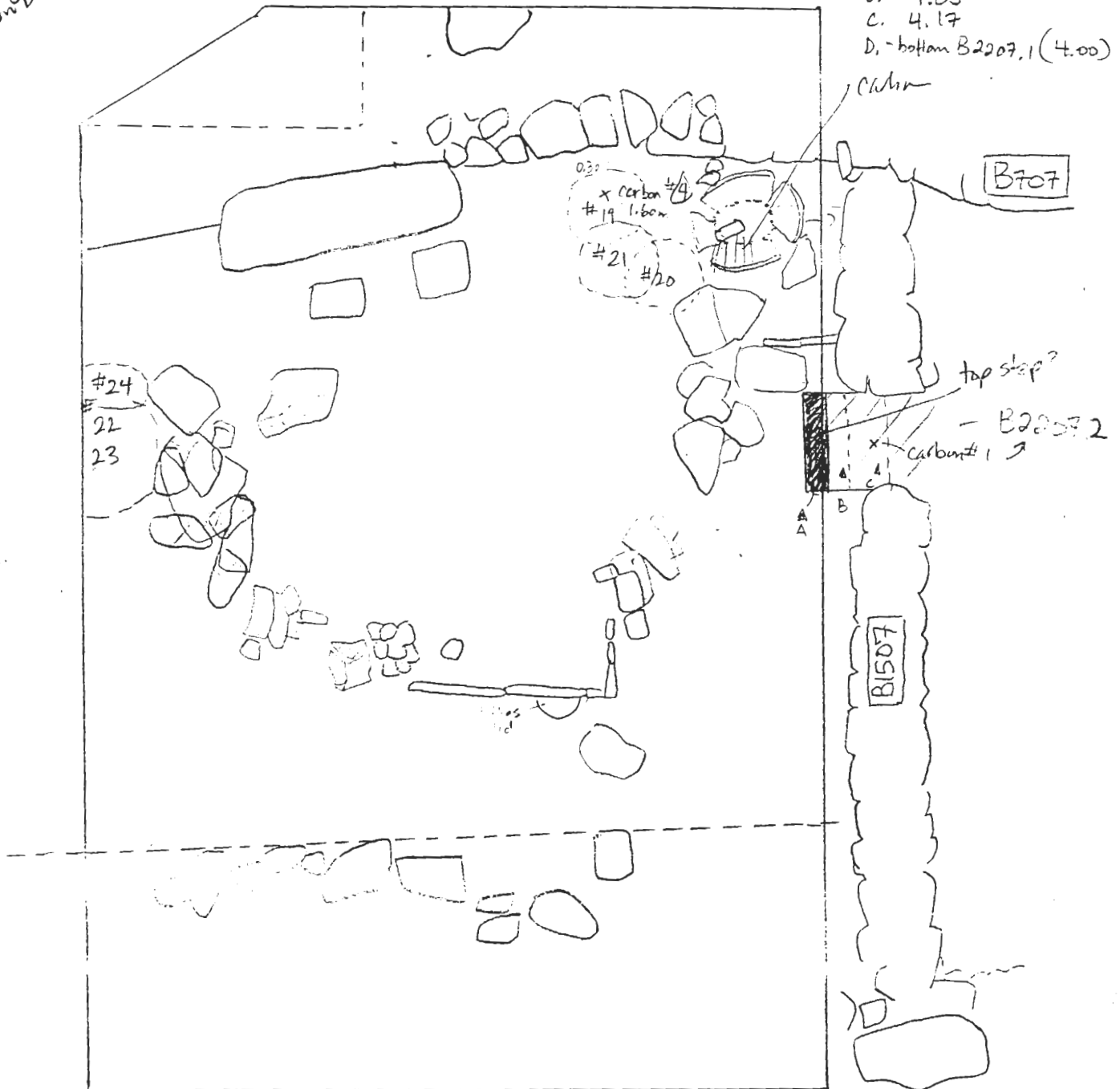

B2207.2 HL(4.52)

Obj. #1 (4.25)

Obj. #2 (4.17)

end elevat. 2 inch lower than step → B2207.1 - burnt material - intensive S.S.

B2207.2 - red soil - intensive S.S.  
 Carbon source on 3rd step (C)



Year 2004 Trench/Locus B2208 Excavator SZPElevations

Benchmark used:

Reading on

Benchmark:

H.I.:

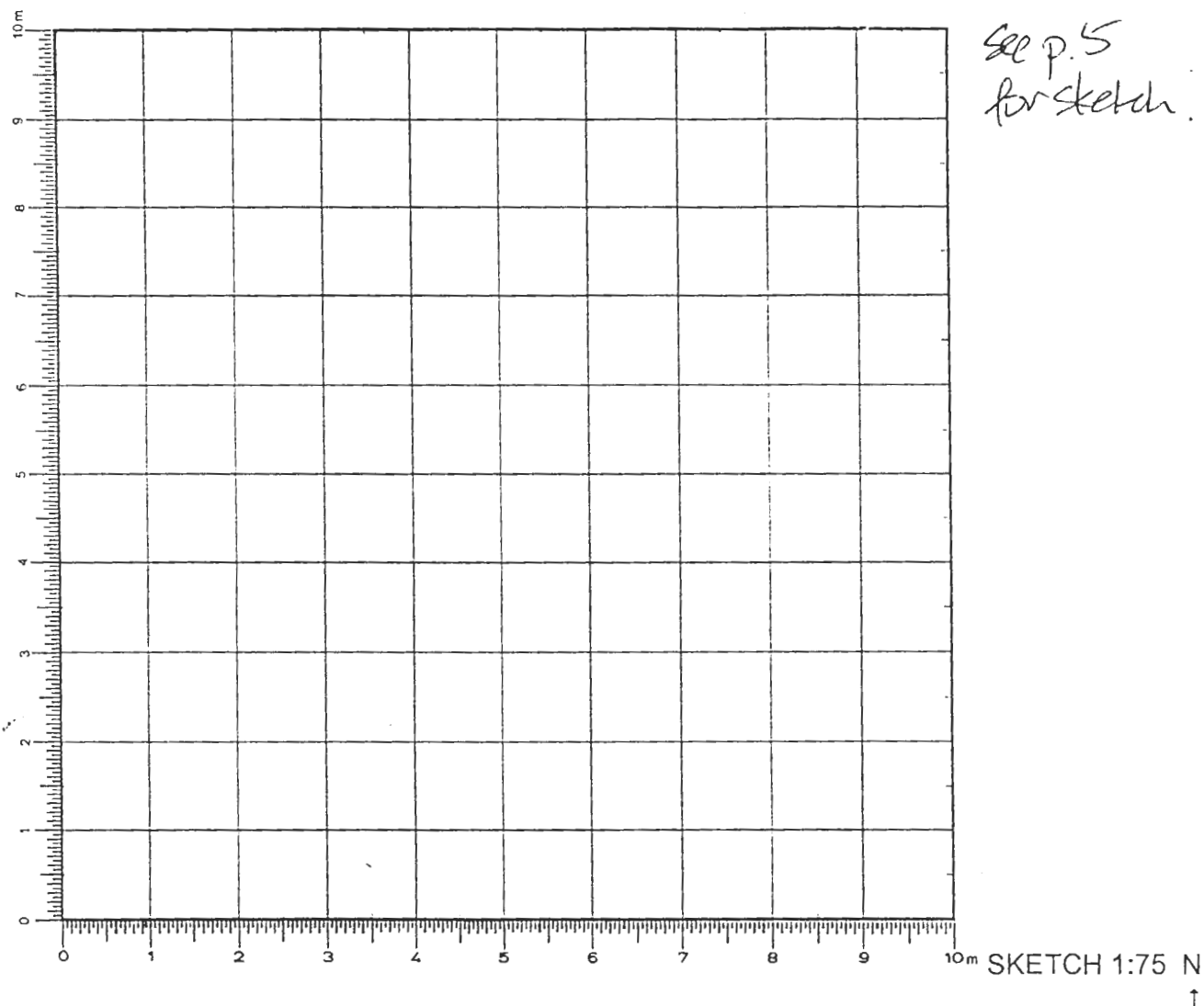
DEFINITION/DESCRIPTION OF LOCUS (explain **why** you changed locus numbers):Today's date: 28 JUNE 04 Locus above: 2205

Locus parameters:

Verbal description: The matrix is a hard clay material with ceramic scatters and a number of other objects. Very little bag away of tumble - there is a hearth in the centre of the room - evidence of burning (burnt clay and carbon) - there is a bin in the SE corner. - floor has been ~~to~~ close if not achieved in places

Locus Interpretative Comments (What do you think this is? DATE your comments, continue on additional pages if necessary):

habitation / destruction debris.

Locus/Pottery Pail Number	Weight of Sherds	Number of Sherds	Chronology & Comments
B2208.1	6.450	183	LG, A
B2208.2	4.945	372	A
B2208.3	14.125	44	A
B2208.4	1.637	254	A
B2208.5	4.285	302	LMIIIc, A
B2208.6	0.550	118	LMIIIc, A
B2208.7	0.850	253	A
B2208.8	0.085	84	A
B2208.9	0.005	6	A
B2208.10	0.010	8	A
B2208.11	0.975	336	LMIIIc, A
B2208.12	10.0 kg	20	Archaic

## OBJECTS

[illegible]

ADDITIONAL COLLECTED MATERIAL

[illegible]

p. 4 ~~12~~

[illegible]

## OBJECTS

[illegible]

ADDITIONAL COLLECTED MATERIAL

[illegible]

DESCRIPTION of PROGRESS of EXCAVATION [date each entry and identify associated pottery *pail*(s)]:

A horizontal line representing a beam of length  $l_m$ . Below the left end of the beam, there is a horizontal arrow pointing to the left, labeled with the letter  $N$ .

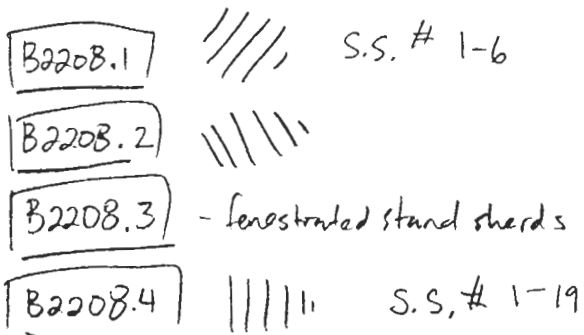

Year 2004 Trench/Locus B2208 Excavator SZP

DESCRIPTION of PROGRESS of EXCAVATION [date each entry and identify associated pottery pail(s)]:

- 100%  
screening
- 28 JUNE 04: new locus since we are below tumble level and approaching habitation debris just beneath the destruction level. This is the continuation of pass associated with B2205.6 - removal of roofing clay/destruction debris - Pass moved from higher level just north of the two plakas, moving northward towards the bench in B2300 - the new pottery pail is B2208.1 - bone found
- lots of burning and carbonized material - soil samples (intensives) taken - 6 intensive samples - separate pail B2208.3
  - intent to pull out pithos scatters in NE quadrant - however, scatter immediately west of large stone (possible work area) turned out to be a fenestrated stand - very large - part of same stand for which we had frags in B2202.10 - pieces of its base are in South section of B2209.2
    - \* large frags of aggrilus horn cores found around NE pithos base area - there was much burning
  - cleaned and drawn
  - paint material around fenestrated stand scatter collected as an intensive sample - B2208.3
- B2208.2
- area immediately east of central hearth - continued pass but changed pails to better pinpoint location of pails - finally found the eastern boundary of the central hearth - chased it out to northern end - defined entire central hearth - did not excavate within hearth (separate locus for later) - Scatter atop of N boundary of central hearth collected
  - bone found in B2208.2 - some burnt material but not really enough to warrant intensive soil sample.
- ASSOCIATED  
SS. # 4, 5, 6
- continued pass into NE quadrant - new pottery pail is B2208.4 - bone found - purpose to bring down level of SE corner to level of overall pass - lots of burnt materials - intensive soil samples taken (see diagram)
  - hitting upon bedrock floor surface along west face of B2203
    - floor surface found in SE corner

Year 2004 Trench/Locus B2208 Excavator SZP

DESCRIPTION of PROGRESS of EXCAVATION [date each entry and identify associated pottery pail(s)]:

28 JUN 2004: (cont) trying to define the eastern wall of corner hearth and to define the pithos base which partially obscures ~~the~~ east hearth

Object # 1 - B2208.4 - stone lid location: 0.80m from B2203  
elevation: 1.20m from B1507

! Stone quern found near the open end of <sup>corner</sup> hearth - left in situ - same elevation

! 20 intensive soil samples taken - #12-19 taken from area immediately NE of corner hearth and along wall B2203

Year 2004 Trench/Locus B2208 Excavator Rough

DESCRIPTION of PROGRESS of EXCAVATION [date each entry and identify associated pottery pile(s)]:

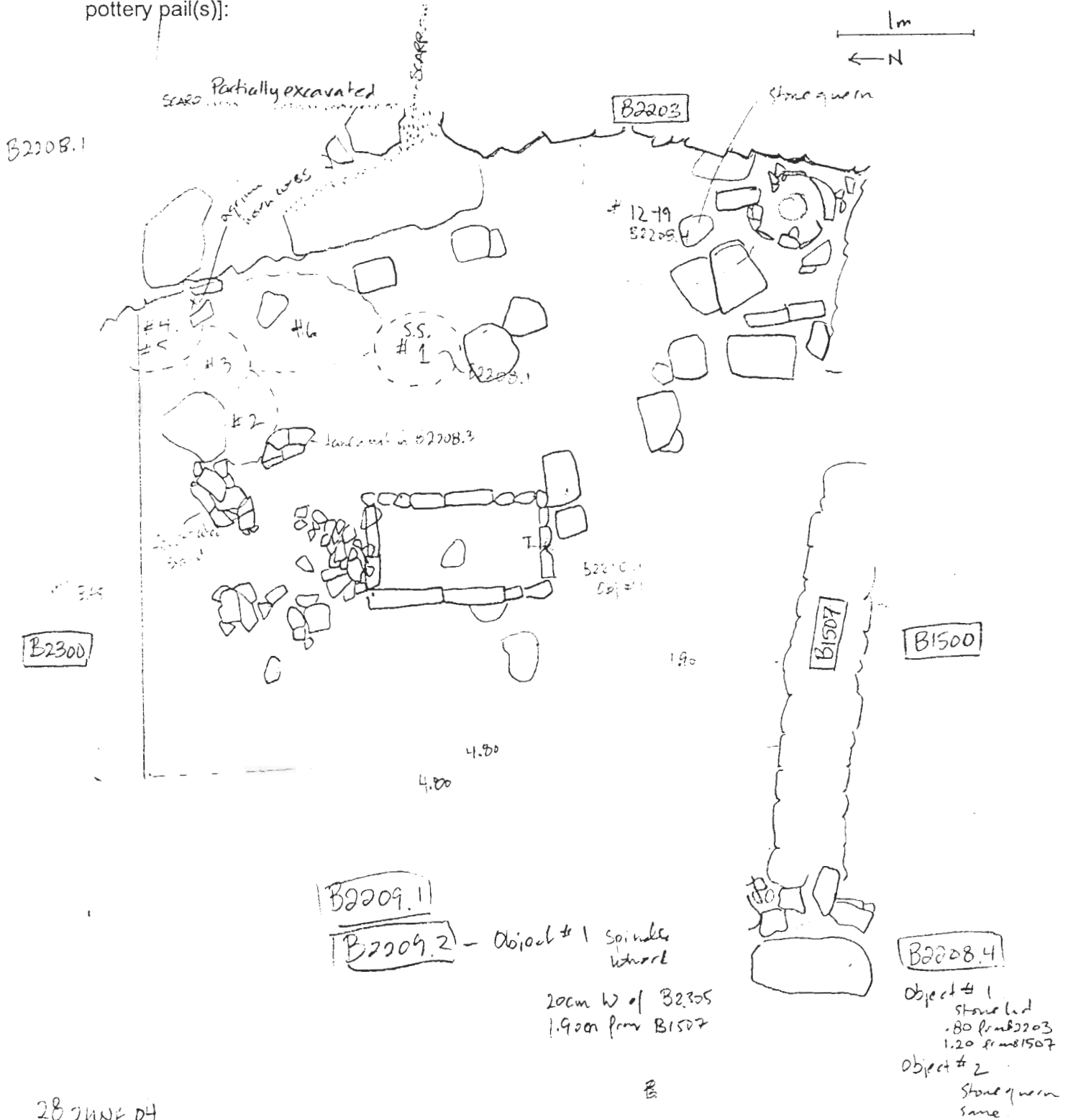

28 JUNE 04

B2208.1 - continued pass assoc w/ B2205.6

B2205.8 - SE corner.

B2208.2 - hearth area  
B2208.3 - fenestrated stand

B2208.4 - S. of hearth; north of stairs

B2208.1 - central hearth.  
Object #1



Year 2004 Trench/Locus B2208 Excavator JSP

DESCRIPTION of PROGRESS of EXCAVATION [date each entry and identify associated pottery pail(s)]:

29 JUNE 04: Continued pass from previous day - new pottery pail is B2208.5 - ~~the~~ excavation of corner hearth area

100%  
screening

and pithos base - burnt material taken as intensives especial with in ~~the~~ hearth itself; bone found

pithos base is in a plaka - no other stones forming the eastern boundary of the hearth. - not a hearth?

intensive S.S. #1-9 - within hearth

! neck of a table amphora found tipped into hearth eastward.

- contents of which - intensive S.S. #10

- flat stone (plaka?) just next to table amphora.

! stones which formed the west boundary of hearth seem to be pedestaled - probably tumble? - maybe not a hearth

! stones of west boundary of "hearth" removed. - our

\* hearth is not a hearth. - corner area behind built feature of stairwell with vessels, plakas and stone quern.

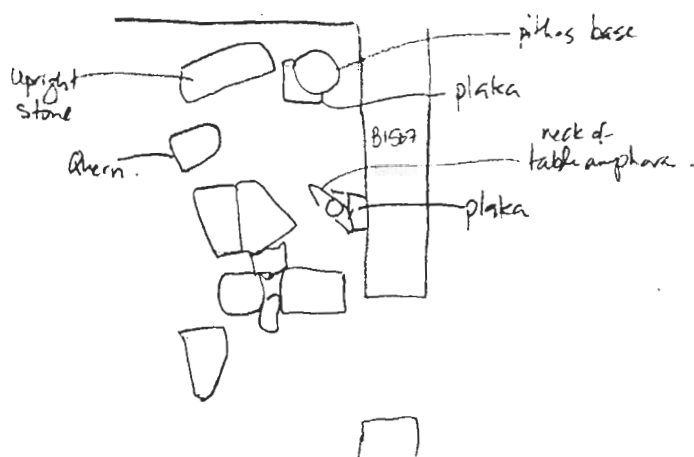

#11, 12, 13 - additional intensive soil samples

Year 2004 Trench/Locus B2208 Excavator SZP

DESCRIPTION of PROGRESS of EXCAVATION [date each entry and identify associated pottery pail(s)]:

29 JUNE 04: (cont)

Excavation of B2208.5 completed

! new pass in order to remove roofing clay from floor surface  
→ new pottery pail is B2208.6 - starting point will be the plaka just west of the SW corner of central (and now only) hearth - objective to chase out the floor using the plaka as a guide - bone bag

! movement of pass from N → S - no discernable floor surface is preserved west of hearth - surface is pitted out and pebbly and loose - stopped pass

! Standard soil sample taken of B2208.6 Object #1 - B2208.6  
- stone tool.  
location: 30cm south of hearth  
32cm from B2203  
elevation:

! new pass from SW corner of hearth - new pottery pail is

B2208.7 - moving south and then east  
- potential floor surface found - will chase this out. - western area is a little pebbly and not as compact as the NE area of room which seems to be the floor surface

- since this is the habitation debris - 100% intensive soil sampling

Object #1 - B2208.7

- stone tool

location: 60cm from B1507, <sup>1.6m</sup> ~~1.5m~~ from stone  
east of stair well BM R12  
elevation: (0.95) HI (2.19)  
355.06

! carbonized wood from just north of west door jamb in B1507 taken out - Carbon sample # 1 & 2  
- intensive s.s. # 3

Object #2 - B2208.7

- iron ring frags

location: 70cm of north of B1507  
1.95m from stone east  
of stair well. BM R12  
elevation: (0.99) 355.02 HI (2.19)

Year 2004 Trench/Locus B2208 Excavator SZP

DESCRIPTION of PROGRESS of EXCAVATION [date each entry and identify associated pottery pail(s)]:

29 JUNE 04: (cont)

iron ring has fresh breaks but intensive soil sample taken (#2) from which ring was found.

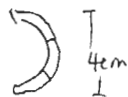

Object #3 - B2208.7

- spindle whorl

location: 25cm from B1507; 1.80m from W door jamb R12  
elevation (1.01) 355.0 HI (2.19).

problem of transition between top of stairs which may indicate a floor level and the ~~floor~~ ~~best~~ surface we have excavated to its west which is noticeably higher.

pumice found east of SE corner of hearth

pass stopped around area east of SE hearth.

little cleaning up of area around fenestrated stand  
scatter - intensive soil samples #13, 14

↳ still ~~same~~ same pail

\* See diagram with location spots for all intensive soil samples.

new pottery pail B2208.8 for area north of stairway - to clarify the transition between ~~lower level~~ threshold stone and the higher surface of the room.

all soil is taken as intensive soil samples - #1-6

threshold ~~stone~~ is very large, ca. 95cm (N-S) and are  
ca. 40-45cm wide  
2 stones which span

by day's end - no real clarification  
- potential floor surface north of the threshold stone - further excavation required

Year 2004 Trench/Locus B2208 Excavator SZP

DESCRIPTION of PROGRESS of EXCAVATION [date each entry and identify associated pottery pail(s)]:

29 JUNE 04

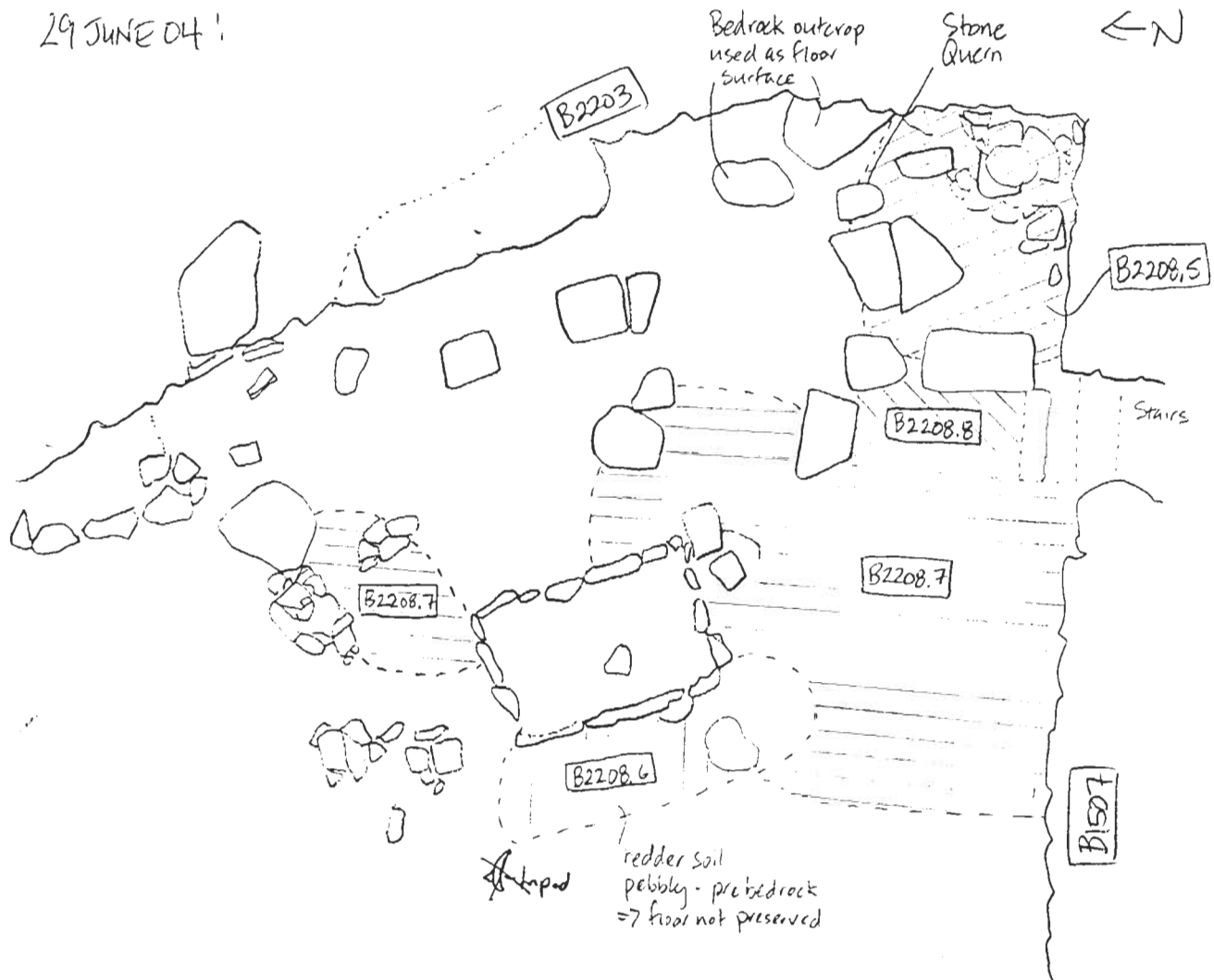

Year 2004 Trench/Locus B2208 Excavator SZP

DESCRIPTION of PROGRESS of EXCAVATION [date each entry and identify associated pottery pail(s)]:

SOIL SAMPLES FOR

← N

29 JUNE 04:

B2208.5, B2208.6,

B2208.8

B2203

Bedrock outcrop  
used as floor  
surface

stone quern

B2208.5

intensive soil samples  
#1-13

\* #10 - contents of  
table amphora

B2208.8

intensive soil  
samples #1-6

B2207

B2208.6

\* standard soil  
sample  
\* area of redder soil  
- pre bedrock material  
- floor not preserved here



Year 2004 Trench/Locus B2208 Excavator SEP

DESCRIPTION of PROGRESS of EXCAVATION [date each entry and identify associated pottery pail(s)]:

29 JUNE 04:

INTENSIVE SOIL SAMPLES FOR B2208.7



### SPECIAL NOTES

S.S. #3 - carbonized wood and immediate area

S.S. #2 - iron ring fragments found in this area (Object #2)

S.S. #8 - another shallow pass → this material is right atop floor surface and beneath S.S. #1, 2, 3

S.S. #12 - sweep up material from area south of hearth just atop floor surface

S.S. #13, 14 - area of fenestrated stand

Year 2004 Trench/Locus B2208 Excavator SZP

DESCRIPTION of PROGRESS of EXCAVATION [date each entry and identify associated pottery pail(s)]:

- 30 JUNE 04: little excavating around the SE corner of hearth.
- pottery pail [B2208.10] - no bone found. <sup>Intensive</sup> S.S.
  - : clearing of scatters in SE corner of room - pottery pail is [B2208.9]
  - : Continued pass north of stairway - new pottery pail is [B2208.11] - chasing out probable floor surface north of threshold stones.
  - : large concentration of bone fragments from just along w door jamb of [B1507] \* see below - Assoc. with intensive S.S. #28, 29.
  - : large concentration of pumice from along w door jamb of [B1507]
  - : Some small tumbled stones removed from just north of stairwell area.
  - : floor surface found north of stairwell and followed out northward to the hearth - Some flat stones originally thought to be plakas were removed as they were pedestaled high above the floor surface - burnt soil beneath them.
  - : a line of small stones exposed (running E-W) from the SE corner of hearth - areas of red burnt ~~soil~~ clay found in SE of hearth - assoc. w/ intensive S.S. #24, 27.
  - : two stone tools (querns? wetstones) found N of stair well
  - : vessel base found along [B1507] - ~~Soil~~ west of west door jamb
  - : Since this is just above the floor surface - we are collecting low/ intensive soil samples.
  - : total intensive S.S. (29) - see diagram for locations

Year 2004 Trench/Locus B2208 Excavator SZP

DESCRIPTION of PROGRESS of EXCAVATION [date each entry and identify associated pottery pail(s)]:

2 July 04: removal of pottery scatters and stone tools

Pottery pails: B2208.12 pithos scatter north of hearth

B2208.13 Fenestrated stand NE of hearth

B2208.14 - fine ware scatters N and E of hearth  
- orange fabric base north of wall  
B 1507

B2208.15 table amphora scatter from SE corner

B2208.16 pithos base in SE corner

B2208.13 - underneath fenestrated stand scatter, bone found and evidence of burning - intensive soil sample taken

B2208.15 - underneath amphora scatter, bone found and evidence of burning - intensive soil sample taken  
- concentration of bone frags - like the ones associated with ~~pail~~ pottery pail B2208.11 -hole  
- bone tools.



Year 2004 Trench/Locus B2208 Excavator SZP

DESCRIPTION of PROGRESS of EXCAVATION [date each entry and identify associated pottery pail(s)]:

BM R14 354.37  
HI (1.795) 356.165

2 July 04: (cont)

[Object # 1] - [B2208.15]  
stone hand tool

location: SE corner 50 cm from [B1507]  
- see diagram p. 17  
elevation: (1.115) 355.05

[Object # 2] - [B2208.15]  
stone quern?

location: SE corner  
elevation: (1.03) 355.135

[Object # 3] - [B2208.15]  
whetstone?

location: north of doorway in [B1507]  
elevation: (1.125) 355.04

[Object # 4] - [B2208.15]  
whetstone

location: north of doorway in [B1507]  
elevation: (1.116) 355.005

[Object # 5] - [B2208.15]  
- stone hand tool

location: SE of hearth  
elevation: (1.113) 355.035

[Object # 6] - [B2208.15]  
- stone lid

location: beneath pithos base  
elevation: (1.093) 355.072

Year 2004 Trench/Locus B2208 Excavator SZP

DESCRIPTION of PROGRESS of EXCAVATION [date each entry and identify associated pottery pail(s)]:

2 July 04:

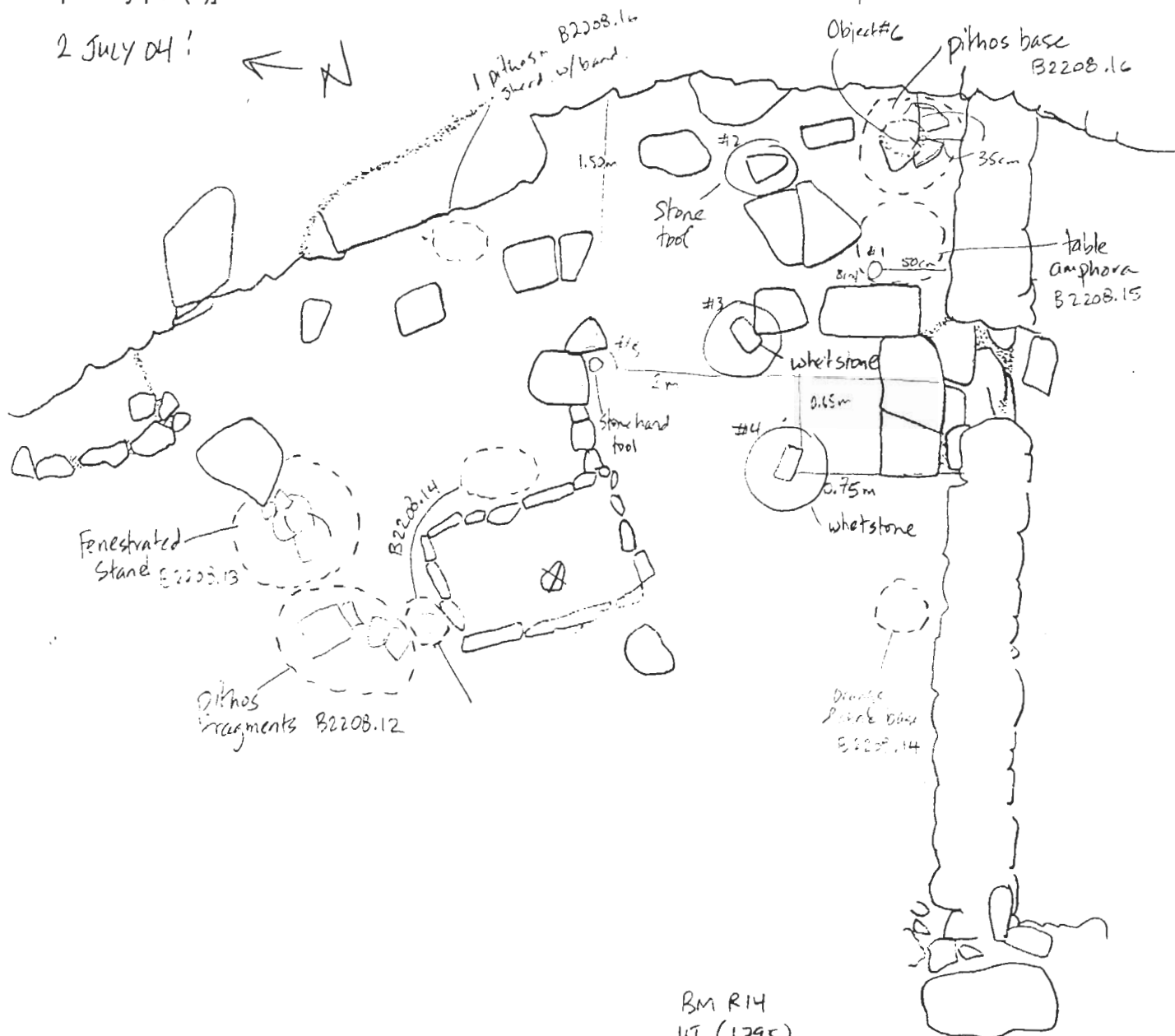

\* Concentration of burnt bone along north side of B1507

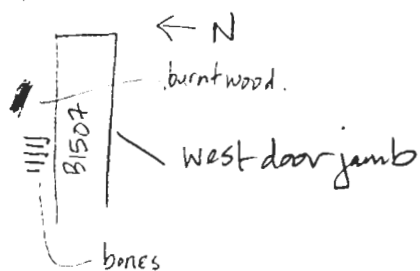

B2208.13 - Bone + intensive  
B2208.15 - Bone +  
- Intensive S.S.

BM R14  
HI (1.795)

- Object #1 (1.115)  
B2208.15
- Object #2 (1.103)  
B2208.15
- Object #3 (1.125)  
B2208.15
- Object #4 (1.116)  
B2208.15
- Object #5 (1.113)  
B2208.15
- Object #6 (1.093)  
B2208.15

Year 2004 Trench/Locus B2208 Excavator SZP

DESCRIPTION of PROGRESS of EXCAVATION [date each entry and identify associated pottery find(s)]:

2 JULY 04:

← N

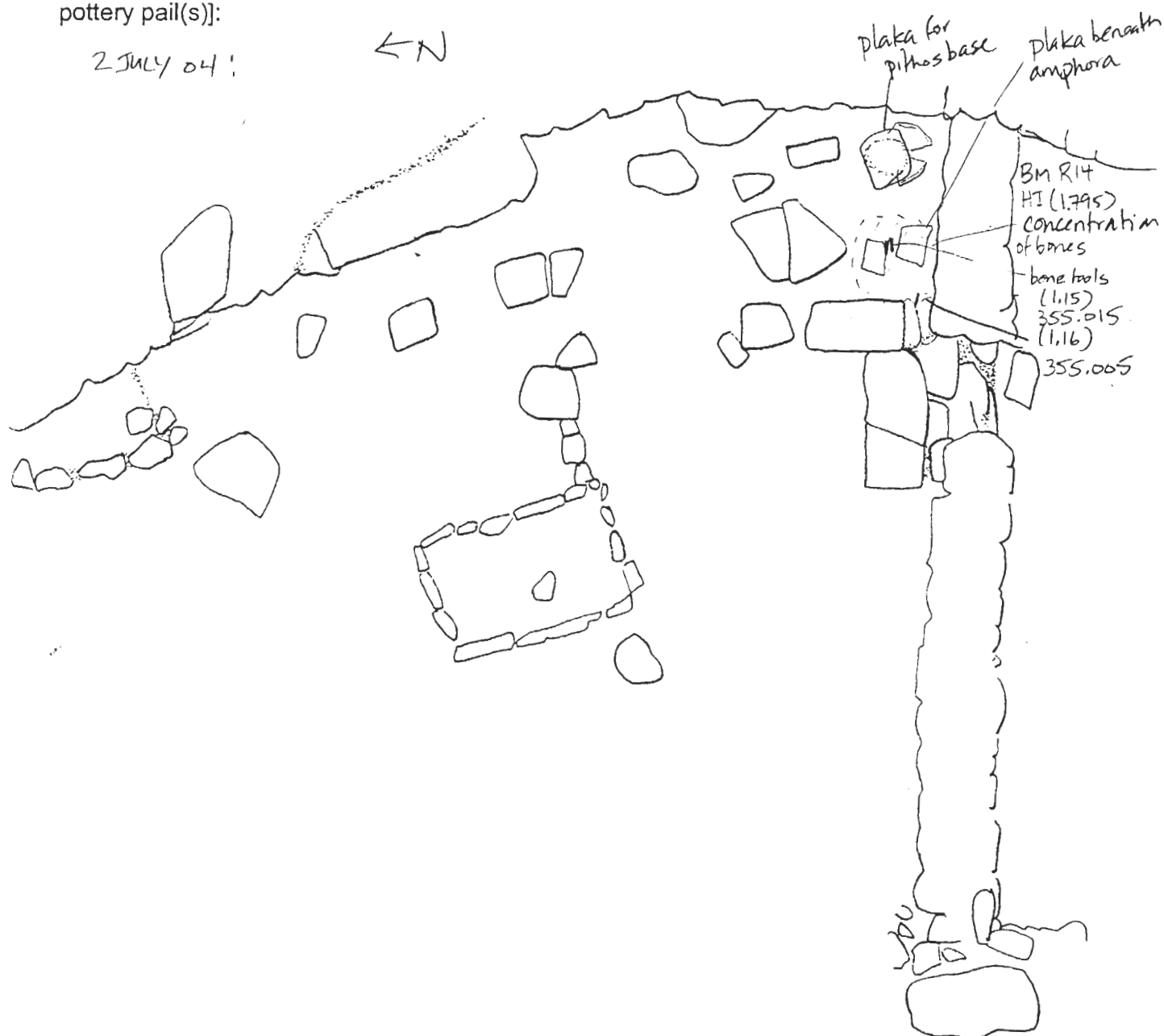

Year 2004 Trench/Locus B2209 Excavator SZD

Elevations

Benchmark used:  
Reading on  
Benchmark:  
H.I.:

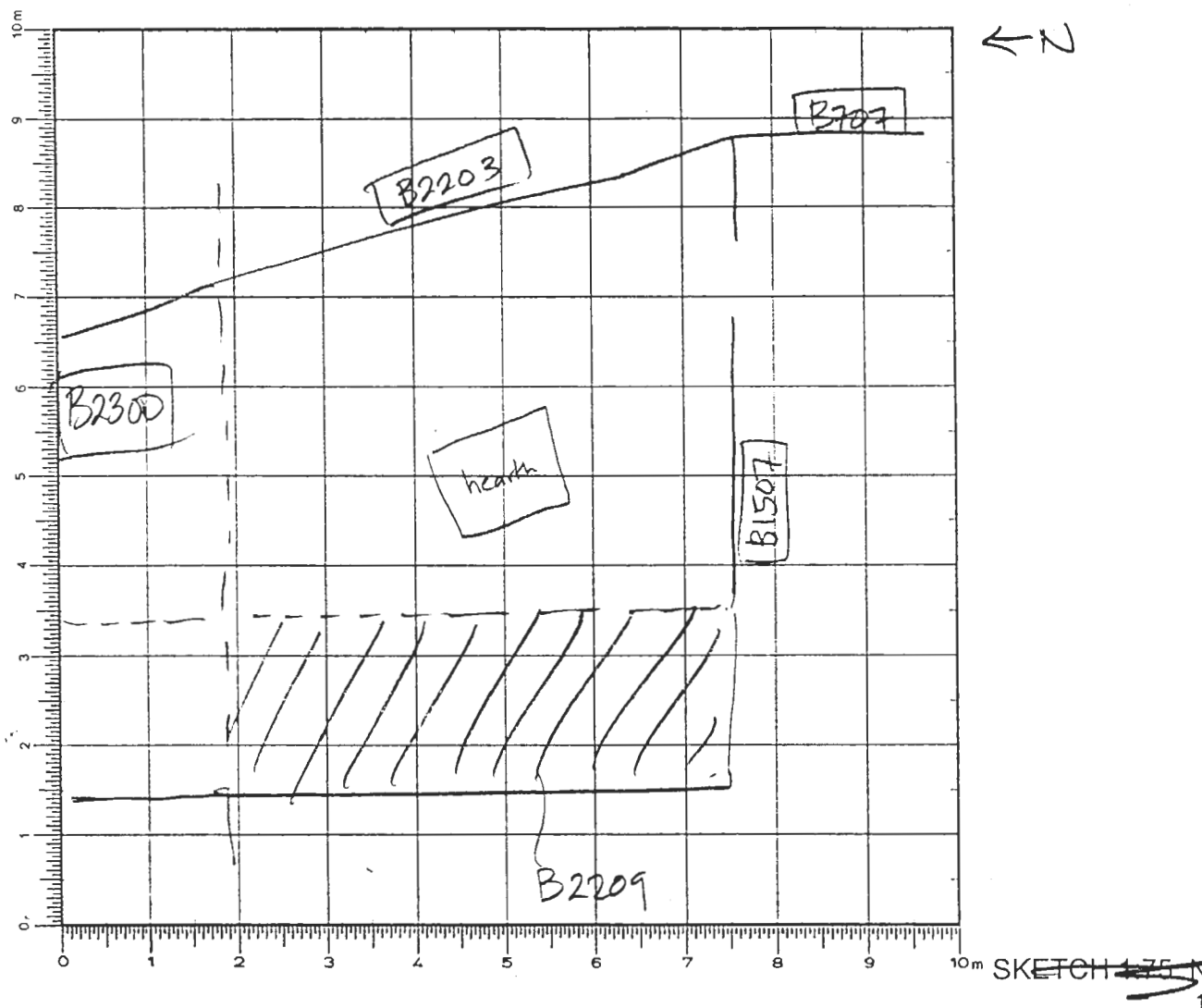

DEFINITION/DESCRIPTION of LOCUS (explain why you changed locus numbers):

Today's date: 28 June 04 Locus above: B2206

Locus parameters:

Verbal description: This locus is the area atop and west of extrapolated N-S wall continuing from N (B2305). The matrix is comprised of tumble, loose soil → consistent with slope wash. — Some stones are flat which may be part of wall.

Locus Interpretative Comments (What do you think this is? DATE your comments, continue on additional pages if necessary):

Wall area — not part of interior space.

577

## OBJECTS

[illegible]

ADDITIONAL COLLECTED MATERIAL

[illegible]

Year 2004 Trench/Locus B2209 Excavator SZP

DESCRIPTION of PROGRESS of EXCAVATION [date each entry and identify associated pottery pail(s)]:

28 JUNE 04: - pass taken in area west of extrapolated wall B2305  
in hopes of further definition

- change in locus number because rubble ~~beginning~~ beginning to appear from last locus.

100%  
screening

Pottery pail is B2209.1 - bone found.

- pass completed but no real clarification although the wall does continue

- 2nd pass - B2209.2 - bone found

- standard soil sample taken

100%  
screening

- Object #1 - B2209.2

- Spider wheel

Location: 20cm W of B2305; 1.90m from B1507  
elevation: bottom of locus

- excavation of B2209.2 reveals rubble and many displaced bones  
- pass not completed over wall area though

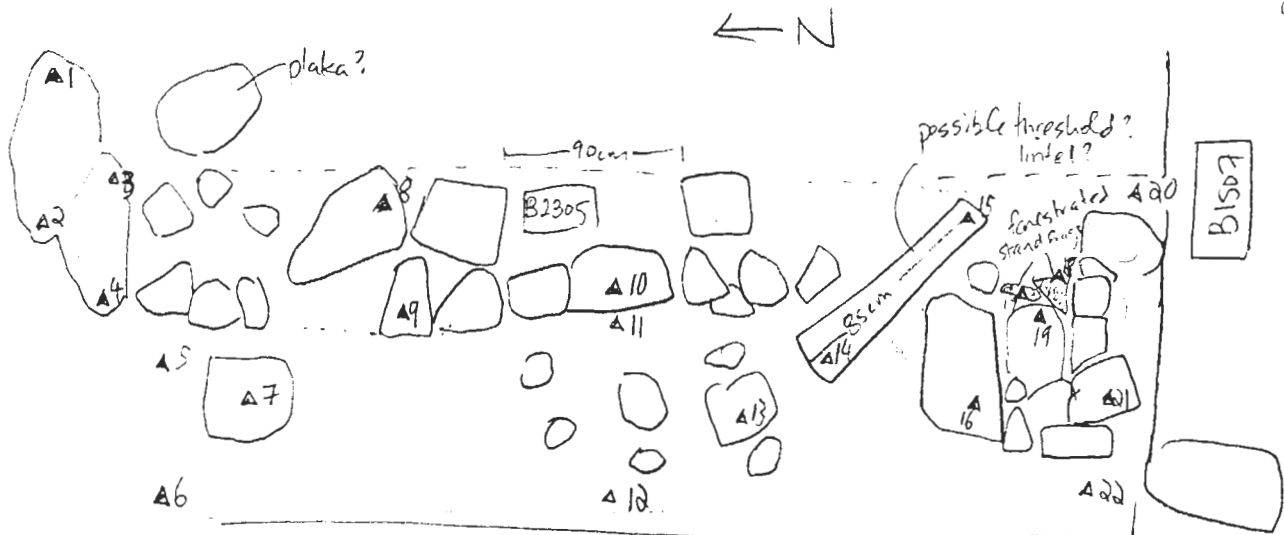

30 JUNE 04: END ELEVATIONS FOR B2209.2

BM R12 (353.82)

HI: (2.11) 355.93

1 (0.803) 355.127	7 (1.00) 354.93	13 (1.13) 354.8	19 (1.135) 354.715
2 (1.04) 354.89	8 (0.835) 355.095	14 (1.145) 354.785	20 (1.065) 354.865
3 (0.91) 355.02	9 (1.04) 354.89	15 (1.03) 354.9	21 (1.19) 354.74
4 (1.015) 354.915	10 (0.94) 354.99	16 (1.06) 354.87	22 (1.21) 354.72
5 (1.19) 354.74	11 (1.255) 354.675	17 (1.115) 354.815	
6 (1.195) 354.735	12 (1.235) 354.695	18 (1.10) 354.83	

Year 2004 Trench/Locus B2209 Excavator S2P

DESCRIPTION of PROGRESS of EXCAVATION [date each entry and identify associated pottery find(s)]:

30 June 04: continued second pass - over wall area to help define wall B2305 and possibly find a door. - pottery find is B2209.3

! bone found.

! wall faces found but area in the South is not very well preserved.

[Object #1] - B2209.3

- spindle wheel

location 1.30m from B1507;

2.70m from W door jamb of B1507

elevation.

1 ~~Jan~~ July 04: cleanup of entire trench. - this find B2209.4  
100% screening associated with cleanup over wall B2305  
! bone found.

! not much clarification - still no entrance way.

! many wall stones displaced westward.

Year 2004 Trench/Locus B2210 Excavator SZP**Elevations**

Benchmark used:

Reading on

Benchmark:

H.I.:

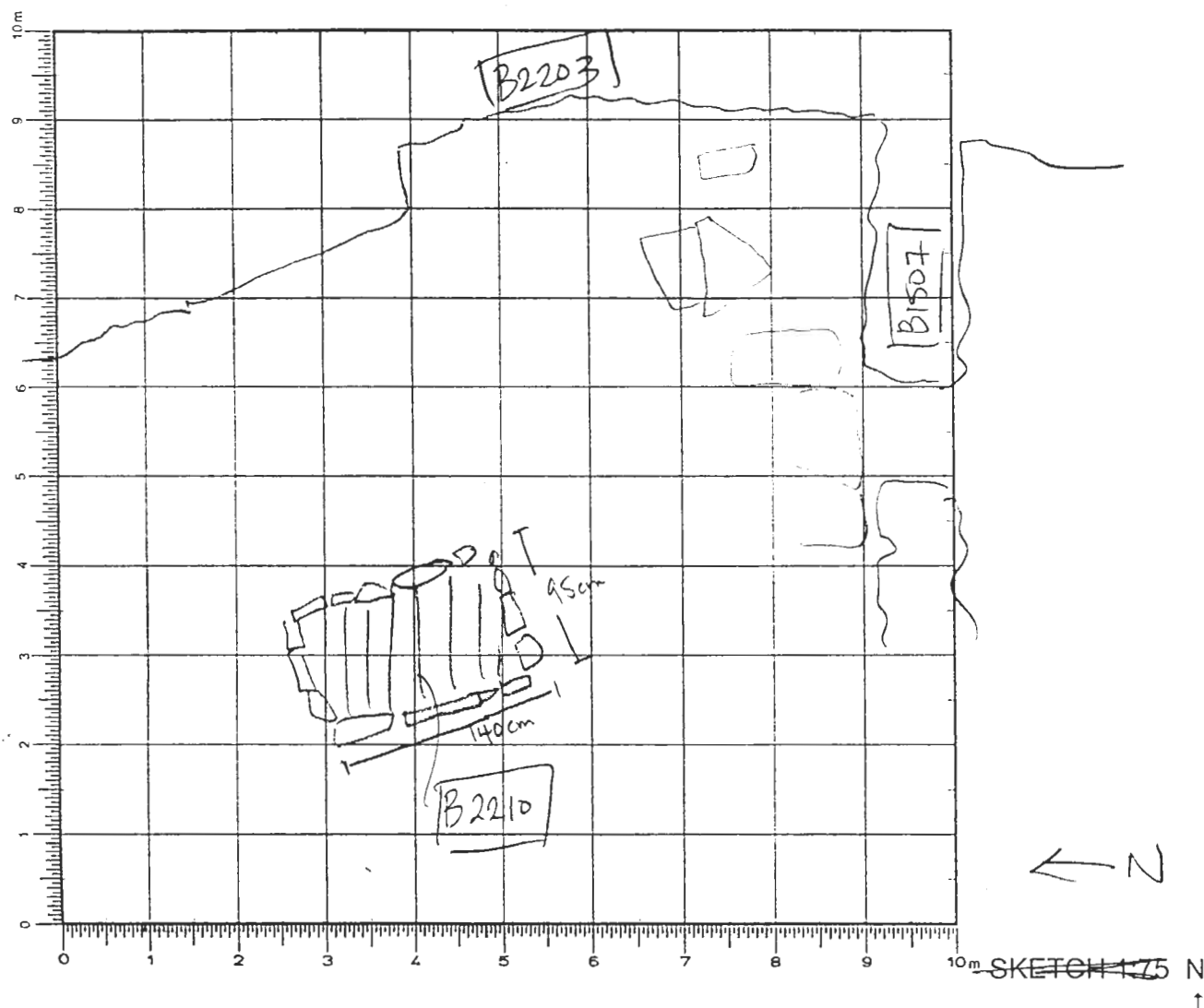
DEFINITION/DESCRIPTION of LOCUS (explain **why** you changed locus numbers):Today's date: 28 June 04 Locus above: B2205

Locus parameters:

Verbal description: This is the hearth from B2200 - made of several small rectangular stones (single course) in a rectangular shape that is roughly parallel with wall B2203 - it is filled with soil but ~~has~~ has very little tumble in it.

Locus Interpretative Comments (What do you think this is? DATE your comments, continue on additional pages if necessary):

hearth





Year 2004 Trench/Locus B2210 Excavator SZP

DESCRIPTION of PROGRESS of EXCAVATION [date each entry and identify associated pottery find(s)]:

28 JUNE 04: Locus number for built feature - central hearth of B2200

Object # 1 - B2210.1

- bronze nail

location: S hearth area

elevation: (3.04) 355.87

Bm R14  
HT (3.74)

\* no pottery collected - as this will not be excavated until floor surface of entire room uncovered

30 JUNE 04: excavating hearth contents - pottery find is B2210.2

~~bone band~~ ~~hearth~~  
~~Object # 1 - B2210.2~~

~~location: S hearth interior~~

~~elevation:~~

~~stone quern~~

- : all of hearth contents taken for soil samples (intensives)
- : Some tumble (small stones) - soil is dark red-brown
- : some ashy areas
- : Surprisingly little preserved in terms of large finds
- : burnt pottery found
- : total (10) intensive soil samples taken