

Gloria Park (GRP)

22. June 2002

Final Report, Trenches A300, A500, A700, A1000 and architectural notes

A300

Trench A 300 was excavated from 04. June 2002 – 20. June 2002 by Gloria Park with trench assistant Kristal and workmen Tassos and Stelios.

Trench A300 represents an architecturally-defined interior space bounded by four walls (A301 to the east, A302 to the south, A303 to the west, and A305 to the north). The north wall acts as a retaining wall below the terrace on which the adjacent trenches A400, A300, A500, A700, and A1000 lie.

The lowest stratum excavated (locus A311) revealed bedrock at the northern extent of the trench. This stratum consisted of a fill that was rich in carbon and bone, and several stone tools were found (a millstone, quern, and small stone tool). Since we believe to have located the clay floor of the room, this stratum may represent the underpacking of the floor, in which these items were dumped. Supporting this is the relatively well-preserved state of the floor above, suggesting that the finds are not slipped out habitation debris from a stratum above the floor. Because the carbon and finds were concentrated in the eastern edge of the trench, however, (the quern and stone mill were found in line with wall A301, north of the last preserved block of the wall) it is possible that the finds had slipped below the floor level when the northern extent of wall A301 was destroyed, making the finds contemporary with or later than the preserved floor. In any case, the stratigraphy along the eastern edge may be more complex because of the destruction of A300.

Above this fill (locus A309.1), is the clay floor. Pail A309.2 should have been excavated with A311, since it represents the highest layer of the floor underpacking, and probably A309.1 was excavated with some of this underpacking.

With A309.2 was revealed several small (c. 0.20-0.30 m. wide) stones that rest directly on top of wall A305 (this feature also continues into trench A400). The accumulation of the stones at the wall suggests either building material or slipped-out rock (tumble?). That these stones may not be architectural is suggested by the fact that they first appear well below the floor line, and it is unlikely that such a drastic change of building material would appear below the floor, in essence weakening the ability of wall A305 to function as a terrace wall where strength would be needed most—below the floor line. I therefore interpret the line of stones as washed-out stones that post-dates the destruction of the upper courses of A305. In this case, however, I realize that it must be necessary to not consider the floor above as a real floor (at least at the northern end), and this is a problem that I cannot resolve at this moment.

Above this stratum a layer of hard-packed, clay-like soil that appears burned in patches (A309.1) that is identified as the floor of this room. In elevation it is located at the bottom of the first course of walls A301, A302, and A303, which further suggests that this is the (original) floor. We left most of this floor unexcavated except for at the northern end of the trench, and a small (c. 0.05 m. deep) pass in the SW corner (A312) intended to give our botanist more evidence, since a grape seed was produced from intensive soil sampling from the stratum just above the floor (A308). Another grape seed and olive wood were found in A312.

A308 represents the stratum above the floor, which also resembled a hard-packed clay surface that may have in fact been the (unrecognized at time of excavation) upper extent of the floor, later floor, or perhaps fallen roofing material. The top of A308 also had patches of burning, especially along the western wall A303. The pottery from this stratum is archaic (EO). A small metal fragment was found in the sieve. We are probably in habitation debris mixed with fallen clay roofing material.

With this stratum should be combined both A307 and A306, which also represent similar clay-like deposits with patches of burning. Locus A306

Above the roofing material lay topsoil (A304).

A500

Trench A500 was excavated from 06. June 2002 – 11. June 2002 by Gloria Park with trench assistant Kristal and workmen Tassos and Kostas.

This space seems to be an exterior space just outside wall A303 to the west. To the south lies high craggy bedrock that dips down to form small, shelf-like areas that were excavated as separate loci. The northern extent of the trench is bounded by the continuation of wall A305 (with a thin strip north of this to expose more of the north face of the wall).

The northern extent of the trench provided the deepest stratigraphy, but yielded little beneath the topsoil (A508, A506, and A505). The topsoil from the northern part of the trench contained many fragments of butchered bone, pithoi, a loom weight, and terracotta tripod feet. It is notable that the most interesting stratum in terms of sheer number of finds is the topsoil.

In one “shelf” formed by the bedrock (A504), a localized deposit of blackened soil and bone, and may be associated with the topsoil finds. The pottery from this trench can be almost consistently dated to the archaic period. The identification of this space as exterior rests on a lack of architectural definition (excluding the northern terrace wall), though the bedrock may have been built up with stone as A502 is (see architectural notes). There is no evidence of this, however, and the tumble found in the topsoil may likely have fallen from the upper courses of wall A303. This space may therefore have been used as a dump or exterior cooking space, probably contemporary with use of the room excavated in trench A300.

Year 02 Trench/Locus A 301 Excavator LRP

trench parameters: 5.75 (west boundary) x 2.85 (south boundary) x
 5.10 (east boundary) x 5.10 (north boundary)
 (edge of terrace) (north wall)

Elevations

Benchmark used: R.6

Reading on

Benchmark: 0*

H.I.: 0.936 top elevation

$$① HI - 485 - 1 = .445$$

$$② HI - 1115 = -.18$$

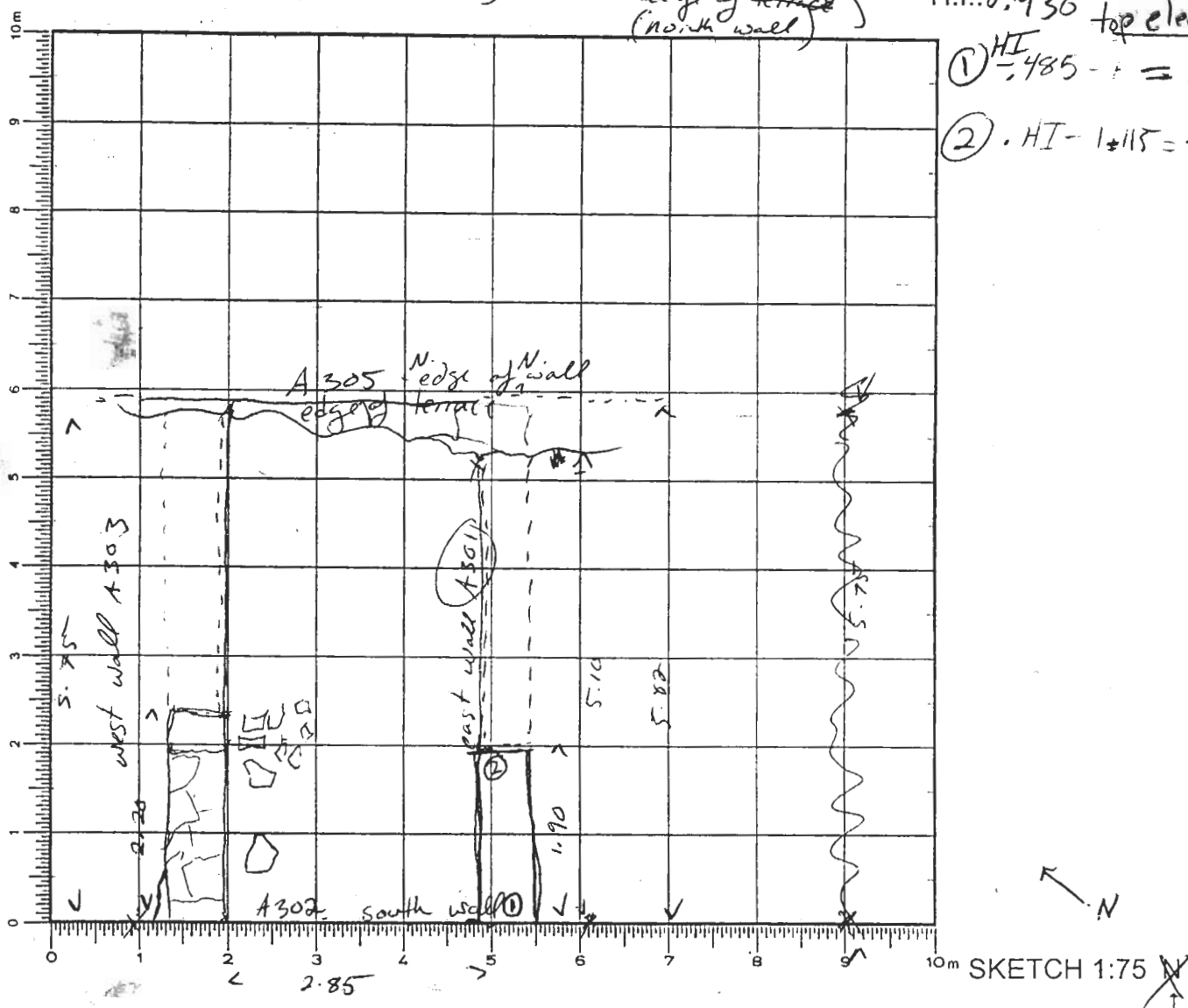

DEFINITION/DESCRIPTION of LOCUS (explain why you changed locus numbers):

Today's date: 04 June 2002 Locus above: none

South end:

middle:

north end

Locus parameters: $l = c. 1.90m$, $w = c. 0.400 - 0.500m$, $h =$

Verbal description: east wall of trench. At present, 7 courses visible, best preserved at south end, where it abuts the south wall (A302). Width of wall $c. 0.400 - 0.500m$. Length at present $c. 1.90m$. Height of each course $c. 0.070 - 0.150m$ in height. Length of roughly rectangular blocks $c. 0.200 - 0.300m$.

18. June '02 - trench extended towards the south with locus A310.

Locus Interpretative Comments (What do you think this is? DATE your comments, continue on additional pages if necessary):

10. June '02

An architecturally-defined room.

Year 02 Trench/Locus A302 Excavator GRP

Elevations

Benchmark used: RL

Reading on

Benchmark: 0H.I.: 0.930

top elevations

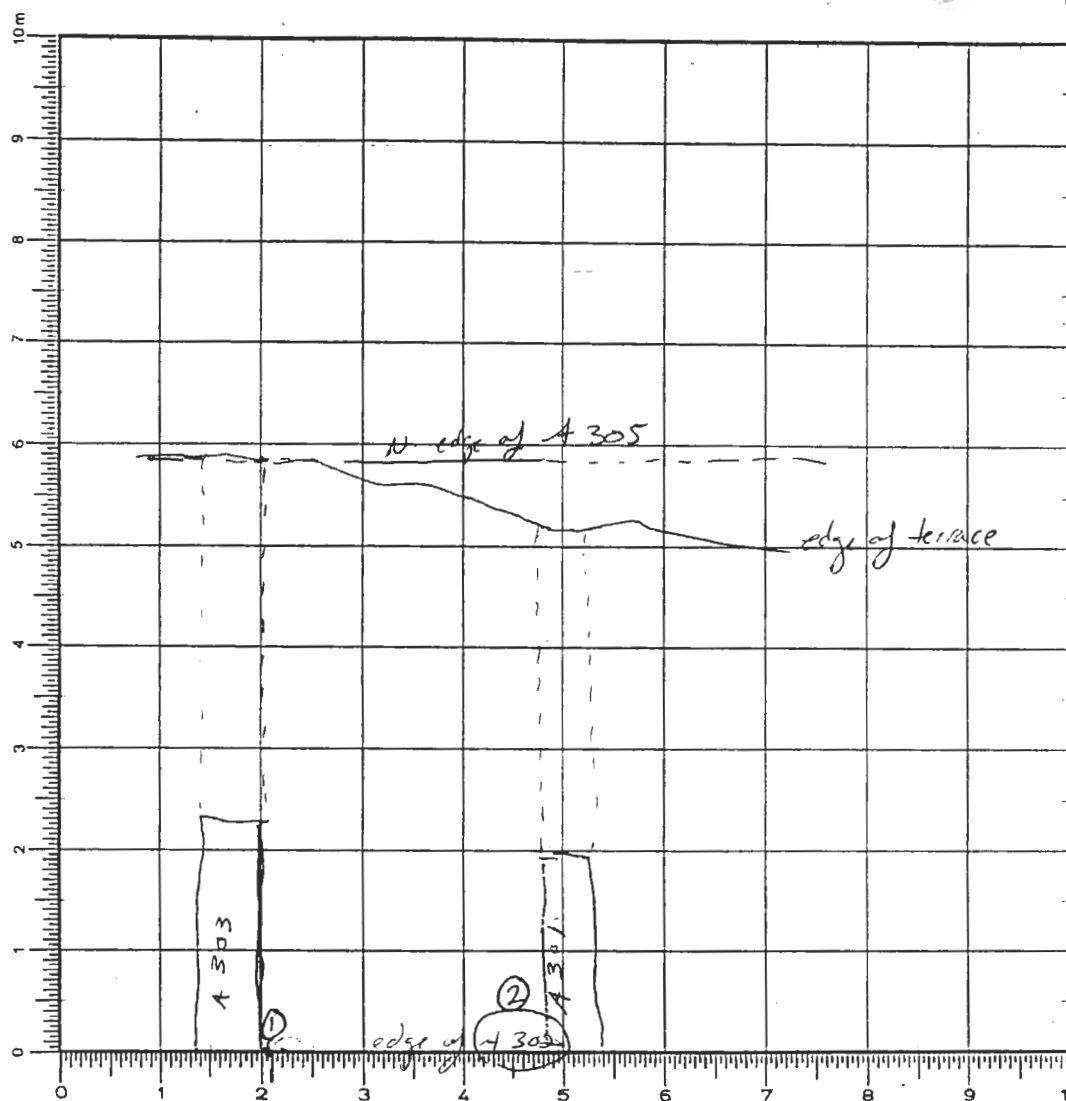
① $H.I. - 0.235 = .695$ ② $H.I. - 0.119 = .811$ 

SKETCH 1:75

DEFINITION/DESCRIPTION of LOCUS (explain why you changed locus numbers):

Today's date: 04 June 2004 Locus above: none

Locus parameters:

Verbal description:

South wall of trench. Roughly 5 courses high at present. Blocks less well-dressed than A301, perhaps partially of bedrock. Wall terminates at west end of trench where A303 abuts, and A302 meets bedrock. Blocks vary in width c. 0.40 - 0.65 height c. 0.20, except for ^{large} portion of bedrock that project through the wall at the east end.

Locus Interpretative Comments (What do you think this is? DATE your comments, continue on additional pages if necessary):

10. June '02 Retaining wall consisting of ^{somewhat} regular, cut stones packed in between the faces of craggy bedrock to form a uniform wall

Year 02 Trench/Locus A303 Excavator GR8**Elevations**Benchmark used: R6

Reading on

Benchmark: 0H.I.: 0.930

① benchmark = 0.

② HI - 1.550 = 0.380

SKETCH 1:75

DEFINITION/DESCRIPTION of LOCUS (explain why you changed locus numbers):

Today's date: 04 June 2002 Locus above: none

Locus parameters:

Verbal description: West wall of trench. Abuts bedrock at the west end of the south wall. Courses not yet well-defined. Blocks vary greatly in size, $\text{length} = c. 0.20 - 0.45 \text{ m}$, $\text{height} = c. 0.15 - 0.30 \text{ m}$. Length of wall $c. 2.20 \text{ m}$. At the bottom, wall, as is A301, is better preserved towards the south. width of wall $c. 0.65 \text{ m}$.

Locus Interpretative Comments (What do you think this is? DATE your comments, continue on additional pages if necessary):

10 June '02 Wall with a threshold and pivot-hole preserved leading to the west. Wall consists of bedrock and cut stone (much like A302).

Year 02 Trench/Locus A304 Excavator GRP**Elevations**Benchmark used: RL

Reading on

Benchmark: 0H.I.: 0.930

top elevations

① HI - 1.85 = - .920

② HI - 1.537 = - .607

③ HI - 1.695 = - .765

④ HI - 1.925 = - .995

bottom elevations

① - .698

② - .699

③ - .816

④ - .902

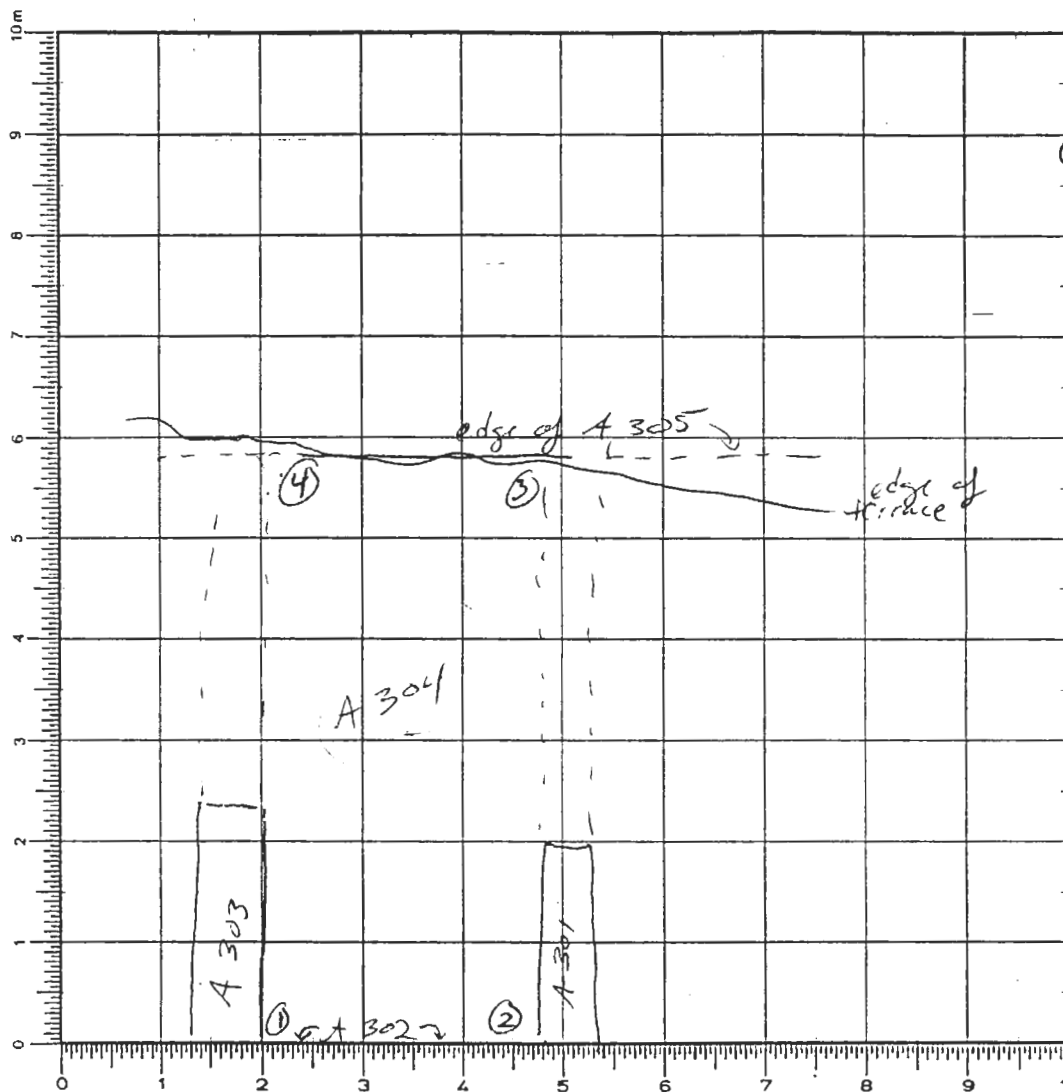

DEFINITION/DESCRIPTION of LOCUS (explain why you changed locus numbers):

Today's date: 04 June 2002 Locus above: noneLocus parameters: defined by A301, A302 + A303 + edge of trenchVerbal description: clearing of brush + modern surface. one bag of surface pottery.

06 June 2002 - elevations taken after clearing of surface brush. - After evaluating the elevations, I realize that elev. ① is a mistake, as it cannot be over 30 cm lower than ② (they are relatively even).

Locus Interpretative Comments (What do you think this is? DATE your comments, continue on additional pages if necessary):

10. June '02 Surface finds from the room.

Year 02

Excavator

[illegible]

OBJECTS

[illegible]

ADDITIONAL COLLECTED MATERIAL

[illegible]

Year 02 Trench/Locus A305 Excavator GRP**Elevations**Benchmark used: RL

Reading on

Benchmark: 0H.I.: 0.930

Top Elevations

$$\textcircled{1} H1 - 2.308 = -1.378$$

$$\textcircled{2} H1 - 2.055 = -1.125$$

(Highest preserved point near the west end of the wall)

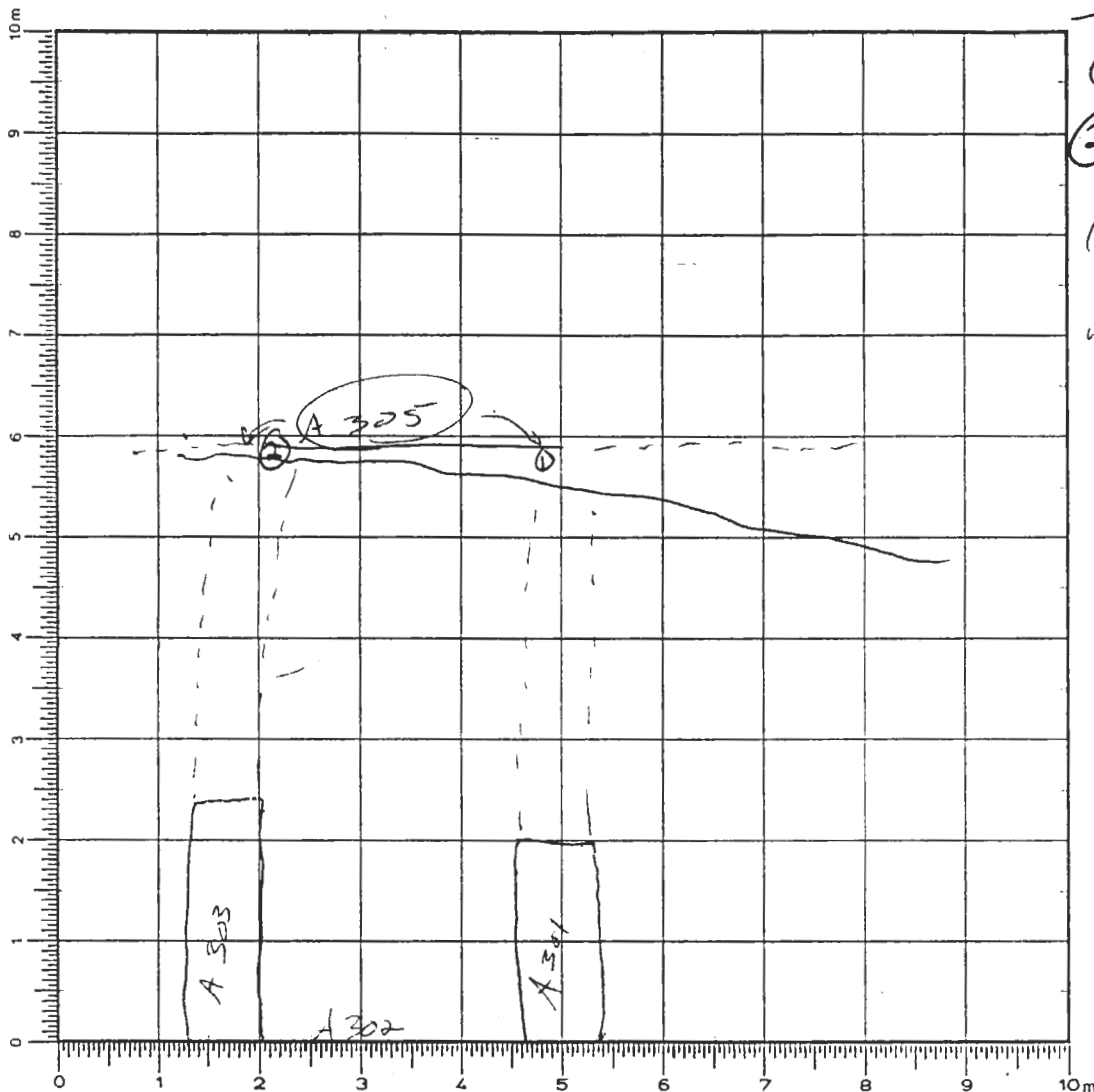

DEFINITION/DESCRIPTION of LOCUS (explain why you changed locus numbers):

Today's date: 04 June 2002 Locus above: surface ~~being~~ none

Locus parameters:

Verbal description: ^{face} N. edge of N. wall of our trench. Only one course visible, very large blocks c. 5.82 m from N. face of S. wall (A302).

21. June - wall A305 extends east from the edge of trench A400 to the western edge of A1000. This is a large terrace wall that served as an architectural wall for at least the space that A300 represents, and may be an exterior terrace wall to the west, for trenches A500, A700, A1000.

Locus Interpretative Comments (What do you think this is? DATE your comments, continue on additional pages if necessary):

10. June '02 Northern terrace wall that may have acted as the northern wall of the room - not preserved to the height of the 1st courses of the 3 other walls defining the room.

Year 02 Trench/Locus A305 Excavator GRP

DESCRIPTION of PROGRESS of EXCAVATION [date each entry and identify associated pottery find(s)]:

17. June '02

An overview of wall A305 from A400. Eastern extent of trench is not yet visible. North face exposed through trench A400. In this section of the wall, the rocks on the exposed bottom part of seem large chunks of bedrock c. .60+ in width and c. .70+ in width. on top are smaller stones c. .40+ in length and width. Roughly two courses of larger stones are visible while 2 or 3 courses of smaller stones are visible on top. In the section of trench A300 the larger base stones continue (trench not excavated enough yet to expose the top face. In trench A500 the wall continues with large stones - now for the first time the southern face is exposed and we are able to measure width of wall: c. 1.0m wide toward the eastern end of the trench, tapering down to c. 0.75m at the western end of the trench. At the tapering point (c. in middle of A500) the character of stone changes, and smaller stones (c. .35 - .45 in width) make up the top face, whereas in the eastern extent of the trench, the larger stones extended the whole width of the wall, now the wall seems made up of more or less two faces. The wall continues to A700, width c. 0.45, through A1000, and seems to terminate as the western edge of the trench begins to slope down with the bedrock, but this will become more clear when we finish trench A1000.

20. June '02 - A305 does in fact terminate at the western edge of A1000.

Year 02

Trench/Locus

A306

Excavator

60K P

V

OBJECTS

[illegible]

ADDITIONAL COLLECTED MATERIAL

3

Year 02 Trench/Locus A306 Excavator GRP

DESCRIPTION of PROGRESS of EXCAVATION [date each entry and identify associated pottery pail(s)]:

We end the pail A306.01 because it is almost time to quit. We get as far as ~~the end of~~ about $2\frac{1}{2}$ m. from A302.

05 June 2002 - We continue digging the locus A306, starting a new pail, A306.02, and dig past a line of (tumble?) blocks that lie in a line ~~transverse~~ transverse to our trench (see sketch). We clean the dirt around some of the tumble that clearly rests on dirt and not the hard surface, without removing the stones. Decided that we remove the line of tumble, and we see that it extends further to the north wall.

We take off the top soil of the rest of the trench (towards A305) and ~~clean off~~ uncover more of A301. The wall A301 now reaches c. 2.85 m. from wall A302, when we find that the same kind of packed dirt (yellowish) covers part of the wall. We finish uncovering topsoil of the northern area, now locus A307.

~~Wall A302 will be the main wall of all the structures in this area.~~
Wall A303 now extends c. 4.62 m from A302.

Because the packed dirt covers end of the wall, it cannot be the floor.

Now that A307 has been excavated, I realize that the second pail - north of the debris line, should have been a separate locus.

20 June 02 - ~~yes, this area north of the debris line seems to represent a deep cut point, though an analysis of this area and its northern stratigraphy can't be determined until the northern area (at least part of it) has been excavated.~~

no
this
seems
to
represent
the same
stratum

Year 02 Trench/Locus A307 Excavator GRP**Elevations**Benchmark used: R6

Reading on

Benchmark:

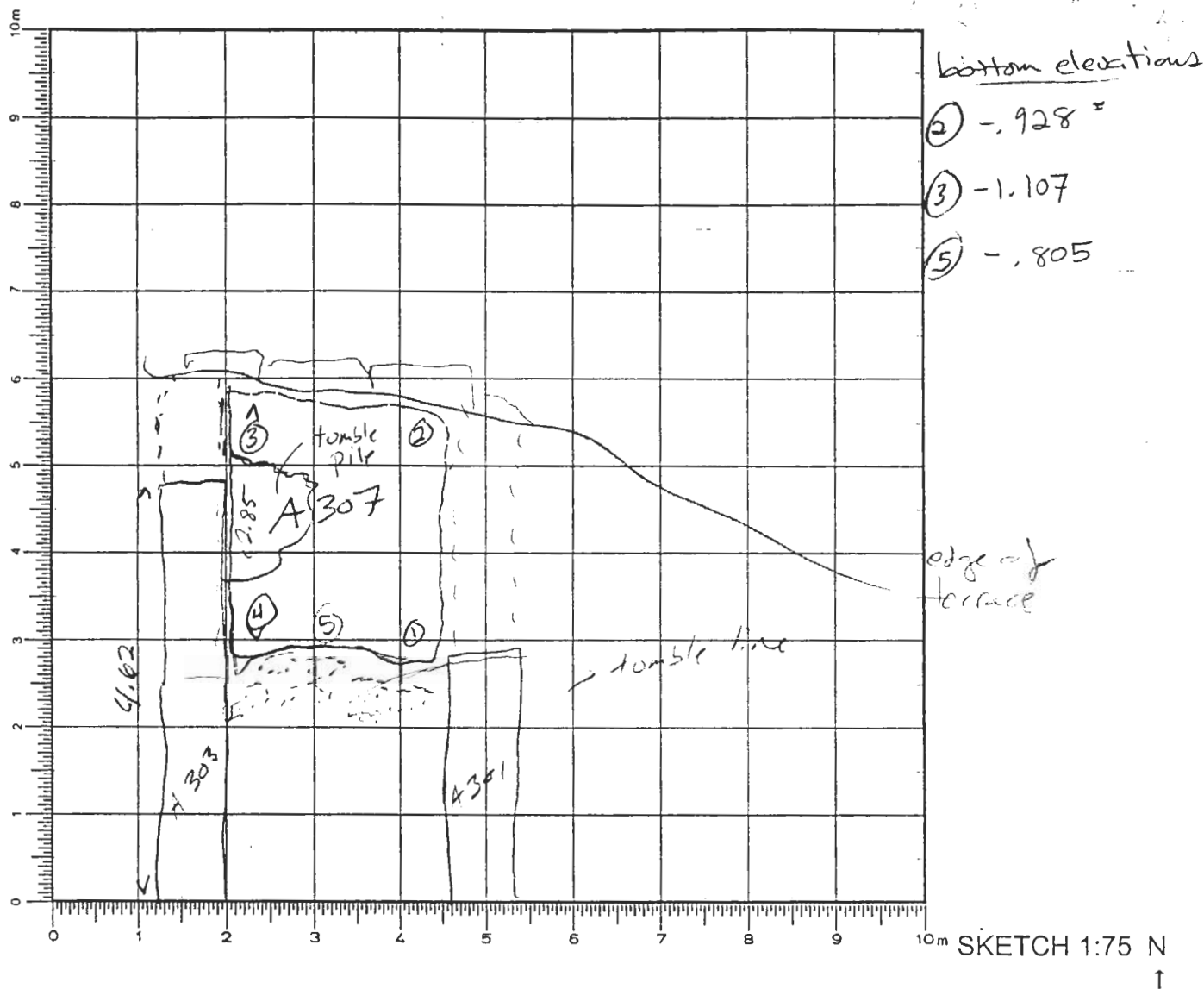
H.I.: 0.898

DEFINITION/DESCRIPTION of LOCUS (explain why you changed locus numbers):

Today's date: 31 Jun 2002 Locus above: A306Locus parameters: north of the tumble line (now excavated & rocks thrown)
bounded by the terrace edge

Verbal description:

a further clearing of topsoil to the north of the tumble line, clearing away the yellow packed soil in this area. We decided to clear the packed floor since the layer of topsoil remaining from A306 was minimal. We find the hard-packed dirt to be a thin (c. 0.02) contiguous layer underneath which is a crumbly, clay-like stratum which we remove in this pass. continued...

Locus Interpretative Comments (What do you think this is? DATE your comments, continue on additional pages if necessary):

10. Jun '02 A deposit of clay-like dirt with tumble and burned patches. - from a roof collapse? This locus represents the top clearing of this surface (continued in A308)

Year 02

Trench/Locus

A 307

Excavator

6KV

✓ A 307.01	1.19	36	EO + (PG, LG)
------------	------	----	---------------

OBJECTS

[illegible]

ADDITIONAL COLLECTED MATERIAL

✓	A 307.01					✓ Standard
✓	A 307.01			✓		
✓	A 307.01		✓			

Year 02 Trench/Locus A 307 Excavator GRP

DESCRIPTION of PROGRESS of EXCAVATION [date each entry and identify associated pottery pail(s)]:

Now that A 307 has been removed, I see that the hard parched surface still lies beneath. We should get a rather large surface of this stuff, which we should be able to remove as one locus, A 308. We also find more carbon, this time localized in a small patch along A 303, c. 3 m. from A 302. We remove some tumble adjacent to A 301, & still leave the triangular tumble adjacent to A 303.

Year 02 Trench/Locus A308 Excavator GKR

[illegible]

OBJECTS

[illegible]

ADDITIONAL COLLECTED MATERIAL

Locus/Pottery Pail Number	Bones	Shell	Carbon	Pumice	Soil Sample	Other (specify)
✓ A 306.01					SW corner -	intensive
✓ A 308.01					SE corner -	intensive
✓ A 306.01					W. wall -	intensive
✓ A 308.01	✓ 1/4 in					
✓ A 306.01						✓ from 7 anchors 1/3
A 306.02	✓ (2)					from 2
A 308.02			✓	✓		
A 306.02		✓				
A 306.02						pebbles

Year 02 Trench/Locus A308.01 Excavator GRP

DESCRIPTION of PROGRESS of EXCAVATION [date each entry and identify associated pottery pail(s)]:

totally clear yet. As we start excavating about 1-1/2 m., we find in the ^{1/4 in.} sieve a piece of iron?, some bone, and an area of concentrated clay-like earth clumps with lots of red and blackened clay. We take another soil sample + label it West wall soil - intensive sample.

06 June - we continue the pass in a second pail, A308.02. We bring up the same clumped clay and some small stones as with A308.01.

We still sift all the dirt in a 1/4-in. sieve, and find more bone + carbon. Along the west wall we uncover a patch of blacker soil, similar to that which we encountered earlier but I don't change loci since the entire area contains patches of darker-colored soil. About 3.4 m. ^{from the S. wall} a straight line of small stones appears and continues to the east but is not clear. On the east side (shown on locus sheet 309). We could be down at the leveling floor of the terrace. At the terrace

edge the soil becomes much looser than up towards the south wall, which further leads to the suggestion that we are at terrace fill levels, especially past the small stone line.

We decide to leave this trench for a while and begin a new one next to it. When we begin again, we will divide the trench.

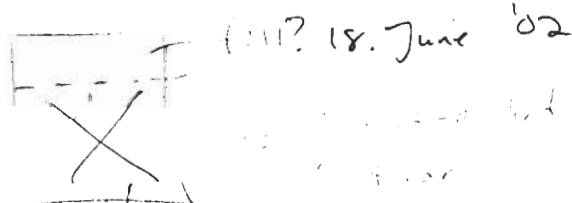

20. June '02 floor left unexcavated at N. end, except for small sample taken for intensive study (A312)

Elevations

Benchmark used: *KB*
Reading on
Benchmark:
H.I.: *0.984*

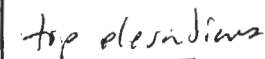

① 1787 $\frac{3}{2}$

0.803

② 1980 - -0.996

③ $1994 = -1.01$

bottom elevations

(*) 1.375-2452
(iron piece)

①
②
③
④

see p. 2

Today's date: 18 June '02 Locus above: A 308

Locus parameters: we cut an arbitrary line transverse to the trench \approx 2.285 m. south of the north face of the north wall

Verbal description:

We revisit this trench & cut through the flood(?) and section:

off, starting with a southern section bounded by the N. face of the N.

wall and ~~the~~ an arbitrary line c. 2.285 from the N. face of the N. wall.

We begin digging from the southern edge and start sifting with intensive soil samplers. The earth is clumpy with lots of small rocks (c. 5).

And we immediately come down to some stone, but also to a reddish deposit.

Locus Interpretative Comments (What do you think this is? DATE your comments, continue on additional pages if necessary):

19. June '82 - we seem to be coming down to bedrock - probably the

locus represents the slip point of the floor - the line of string probably indicates where upper-level towers were doomed to sink through the floor as it slipped and to cause - this locus is the floor

[illegible]

OBJECTS

[illegible]

ADDITIONAL COLLECTED MATERIAL

[illegible]

Year 02 Trench/Locus 309.1 Excavator OKP

DESCRIPTION of PROGRESS of EXCAVATION [date each entry and identify associated pottery pail(s)]:

20. June '02 a copper alloy? We find an iron piece and record its elevations as object # 2. We stop about midway for the day, and the reddish earth below our pass becomes more apparent as we sweep.

19. June '02 - we begin pail A 309.2 & finish the pass begun by A 309.1. We leave a small bank at the eastern edge, though the southerly part of it was removed before I realized what the workmen were doing.

~~Our 2nd pass of this area is A 309.3. No noticeable change in soil.~~

bottom of
A 309.2

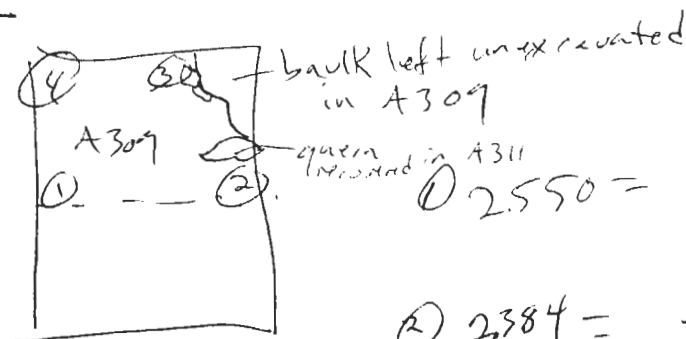

- H1 - 1.445
- ① 2.550 = -1.105
- ② 2.384 = -.939
- ③ 2.613 = -1.168
- ④ 2.832 = -1.387

22. June '02

Pail 309.1 is the floor, while 309.2 is the beginning of the underpacking, which should probably have been excavated as 311, of which it is a part.

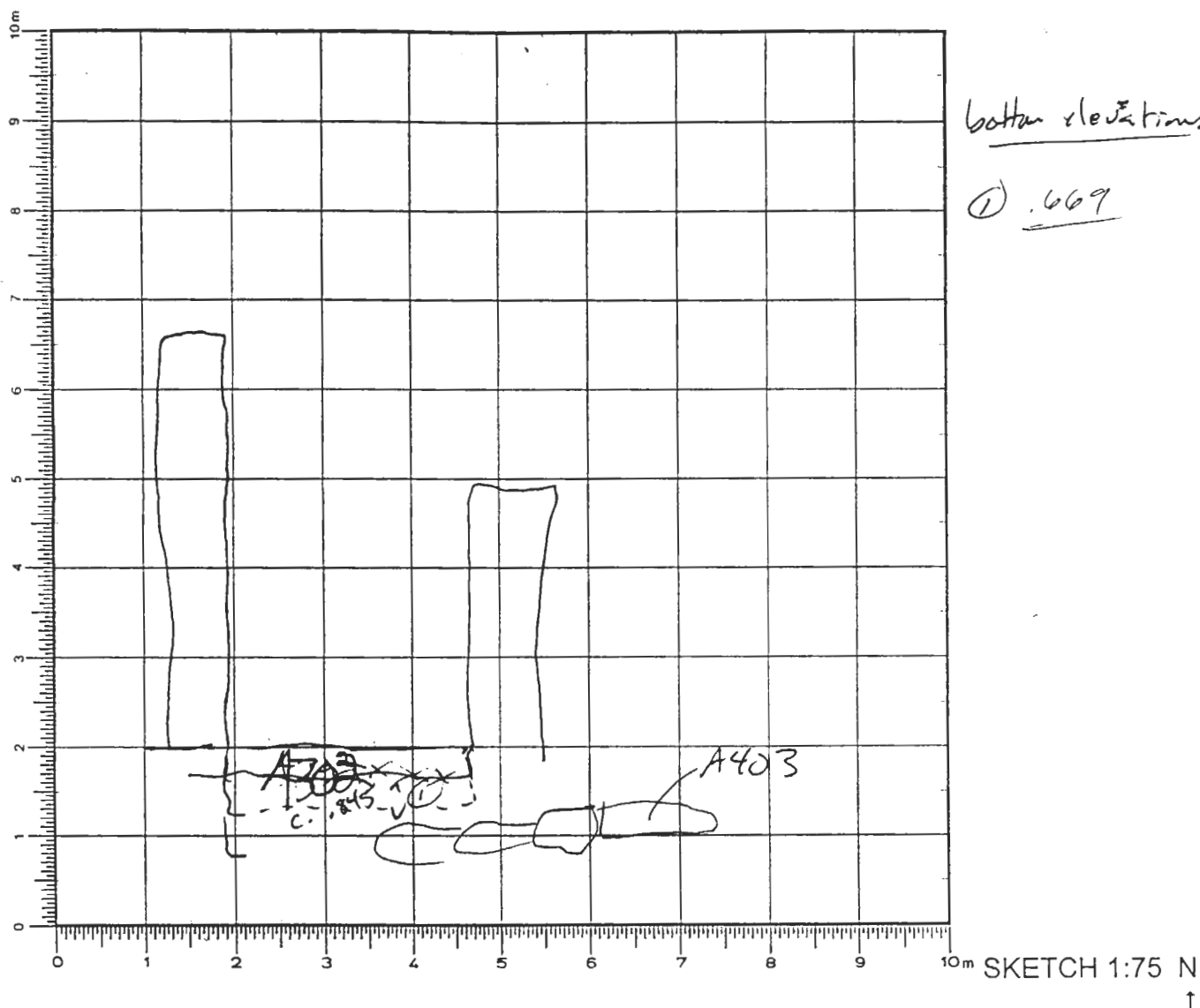
Year 02 Trench/Locus A310 Excavator GRP**Elevations**Benchmark used: R6
Reading on
Benchmark:
H.I.:DEFINITION/DESCRIPTION of LOCUS (explain **why** you changed locus numbers):Today's date: 18 June '02 Locus above: none

Locus parameters:

area south of wall A302 (south wall)

Verbal description:

We extend our trench to the south - c. 2 m and clean the bedrock above wall A302. As we clean a line of stone, we begin to think ~~we~~ we have an extension of wall A403 from ^{trench} A400 to the east. The wall is made up of one existing course of stone c. 15-60 cm in length and c. 45 cm in height.

Locus Interpretative Comments (What do you think this is? DATE your comments, continue on additional pages if necessary):

Upper terrace wall above the room A300

Year 02 Trench/Locus A311 Excavator GRP

Elevations

Benchmark used: RL

Reading on

Benchmark: 0H.I.: 1.088

Bottom Elevations

see p.3

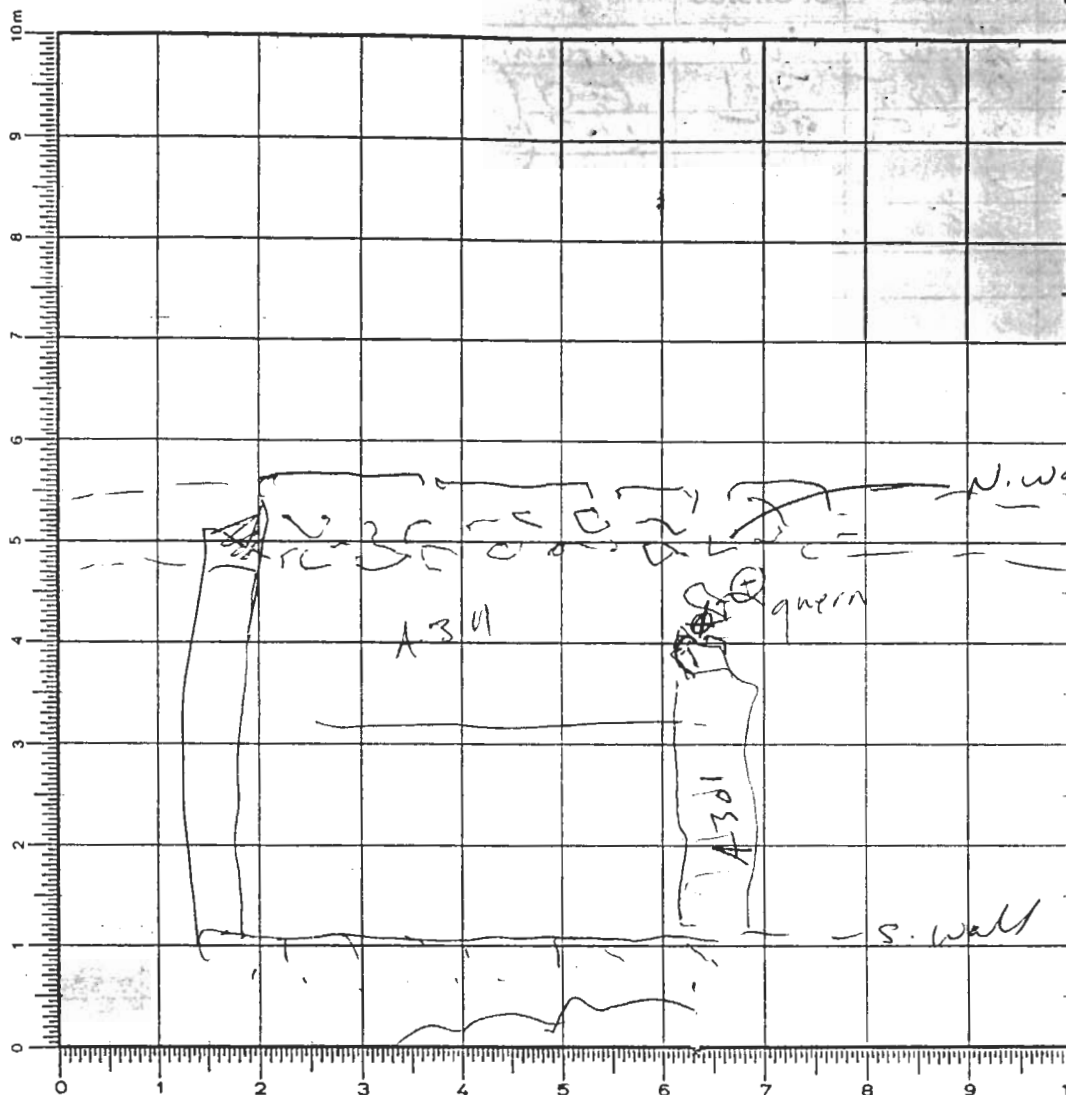

millstone
(A311.1, lodged in
wall?) 1928 =

⊕ sl -0.84
2272 =
-1.184

DEFINITION/DESCRIPTION of LOCUS (explain why you changed locus numbers):

Today's date: 19 June '02 Locus above: A309

Locus parameters:

same as A309

Verbal description:

pass beneath A309 - some bedrock appears, but

I change locus since the soil seems to be a reddish-orange
color now - perhaps the same kind of soil we
noticed directly on top of the bedrock in trenches 4500

A700 + A1000. We ~~do not~~ since this pass ^{until we hit bedrock} ~~because of the finds~~
from the last pass

Locus Interpretative Comments (What do you think this is? DATE your comments, continue on additional pages if necessary):

Year 02 Trench/Locus A311 Excavator GRP

DESCRIPTION of PROGRESS of EXCAVATION [date each entry and identify associated pottery pail(s)]:

The soil is a dark brown, but at about 1 m. from western here we hit the orange deposit we noted at the bottom of the last pass. It does not seem to be the ~~same~~, thin, mud-line soil ^{just a layer} in other trenches, ~~but~~ but could be the same, only a deeper deposit of it. We are finding a good amount of bone and pottery. We also remove several larger (c. 30 length, .05 height & width) tumble (?) stones we remove the line of stones (see drawing) at the south end of the locus. We hit bedrock with this pass ~~to~~ at the south end and reach the S. face of the N. wall and proceed to uncover the top of it. The N. wall. the character of the N. wall is similar to A400, in that about the large foundation stones rest smaller (c. 30-40 cm) stones. We now take down the bulk since A400 is finished and there is no risk of contaminating their stratigraphy - while clearing and examining the end of A301, we find a millstone ~~at~~ in the ~~pass~~ soil that accumulated in the wall. c. 50 m N we find a stone quern at the same elevation. Just below the quern is a small stone tool (polisher?).

20. June 02 - today we finish the pass begun with A311.2, now A311.3. Also in line with A301 (wall) ^{eastern} we find a patch of c. 15 m. We decide to take an intensive soil sample between the end of A301 and A305 (N. wall), since our objects yesterday also came from this area.

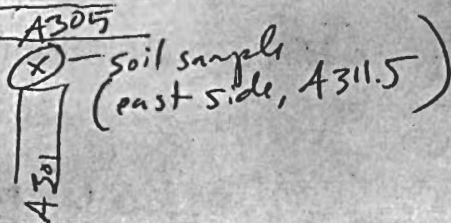

Year 02 Trench/Locus A311 Excavator GRP

DESCRIPTION of PROGRESS of EXCAVATION [date each entry and identify associated pottery pile(s)]:

20 June 02 (cont) - ~~Worked~~ again in line with A301, just S. of the north wall, we come to heavy carbon deposit. We take intensive soil samples (east side #2).

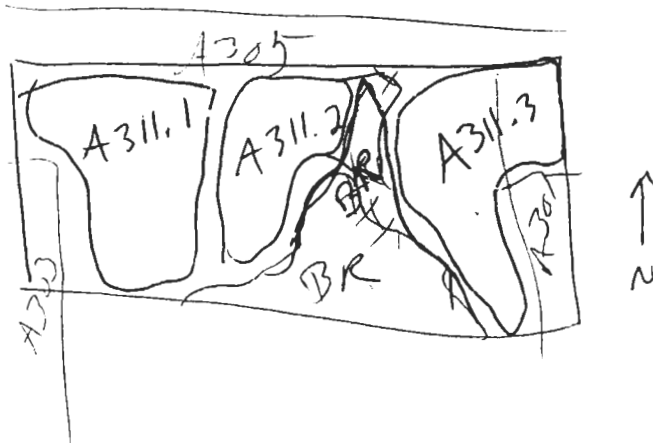

int. soil sample

H1 8949

Bottom Elevations

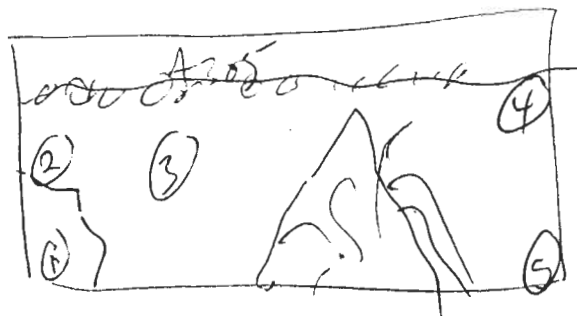

- ① 2045 = -1.096
- ② 2378 = -1.427
- ③ 2414 = -1.465
- ④ 2335 = -1.386
- ⑤ 1990 = -1.041

finish
We ~~start~~ the trench A301 as bedrock appears.

Benchmark used: R6
Reading on
Benchmark:
H.I.: 2949

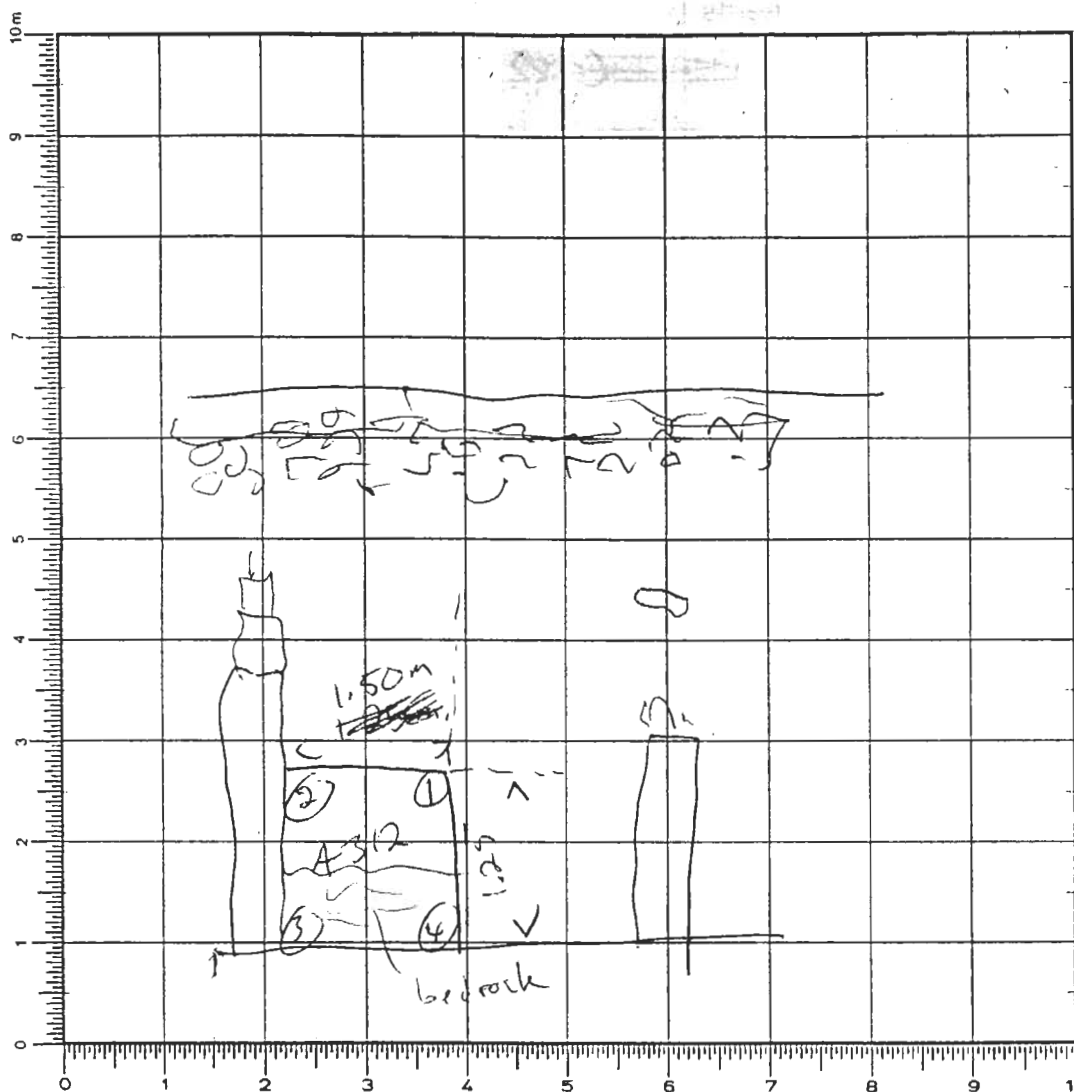

bottom elevations

$$\textcircled{1} \begin{array}{r} 1.842 = \\ - 0.893 \\ \hline \end{array}$$
$$\textcircled{2} \quad |.82| =$$

$$-0.872$$
$$\textcircled{3} 1.754 =$$

$$-0.805$$

④ 1773 -
- 0.824

SKETCH 1:75 N

Locus above:

19. Juni '02

Locus parameters:

RS: The SW corner of the trench

Verbal description:

We start to excavate a discreet section of the southern part of the trench - we save all the soil for the water sieve. Soil is very black. we hit bedrock at the southern half and stop taking soil for the water sieve. We dig c. 0.05 m down. Instead, we sift the soil from the southern part of the square.

Locus Interpretative Comments (What do you think this is? DATE your comments, continue on additional pages if necessary):

Year

Trench/Locus

A312

Excavator

WRP

Locus/Pottery
Pail Number

Weight of Sherds

Number
of Sherds

Chronology & Comments

Abiz

0635

44

~~(S) (P) (G)~~

A312.1

0.130

6

NDY E O

[illegible]Object
Number

Associated
Pottery Pail

Identification
(material/form)

Location

Elevation

Catalogue
Number

[illegible]

Locus/Pottery
Pail Number

Bones

Shell

Carbon

Pumice

Soil Sample

Other
(specify)

A3|2.1

A300 final plan

#1-0.957

