

Final Report for B3500
TRQ
21 July 2006

The "kitchen" area has a central hearth (B3516) formed from five stones. The area is surrounded by bench B3510 to the North, B3511 to the East, and B3512 to the South. The West seems to be open. Excavation of this trench continued between 15 June 2006 and 28 June 2006. Benchmark R28 was used.

Five loci are associated with this locus:

B3516.99—This is a clerical error and was continued as B3517 the next day. One pail came from this locus. Pottery: Late Archaic, Hellenistic.

B3517—Fine silt clay deposited during the winter runoff and one pass into clean stratigraphy. Two pails came from this locus. Pottery: Late Minoan IIIc, Early Iron Age, Orientalizing, Archaic, Late Archaic, and Hellenistic.

B3518—East and NE corner outside of B3516. Sounding measuring 66 cm E-W by 82 cm N-S. Rocky floor packing for floor level B3517. One pail came from this locus. Pottery: Late Minoan IIIc, Early Iron Age, Late Geometric, Early Orientalizing, Orientalizing.

B3519—Clay matrix with small pebbles west and NE of the hearth. One pail came from this locus. Pottery: Early Iron Age, Late Geometric, Orientalizing, Archaic, Hellenistic.

B3520—Hard, dense clay floor matrix east of the Hearth. This is a continuation of the sounding begun with B3518. Four pails came from this locus. Pottery: Late Minoan IIIc, Early Iron Age, Late Geometric, Early Orientalizing.

The goal of this trench was to determine a date for the "kitchen" complex that is more in line with the date of the other rooms in this Archaic house. Excavations carried out last year revealed a large quantity of Hellenistic pottery, which did not mesh with that found in the rooms further north. The question came up as to whether this was an Hellenistic structure added onto the Archaic house, or whether the room was simply reused in the Hellenistic Period and the floor debris was completely scraped out before reuse. The pottery finds seem to support the latter theory as very early pottery came out of B3518-B3520.

The last pass of B3520 has called into question the nature of the two large stones on the East and South sides of the sounding. Originally, these were thought to be simply outcroppings of bedrock, but on the south side there is a flat stone that seems to have been wedged underneath the bedrock. If this is the case, these stones may be placed boulders and not natural outcroppings. A possible floor surface associated with the boulders/outcroppings was exposed, but further investigation did not take place.

AZORIA Project

Year 2006 Trench/Locus B3516 Excavator TRQ

Elevations
Benchmark used: R 28
Reading on
Benchmark: 2.201m
H.I.: 348.573m

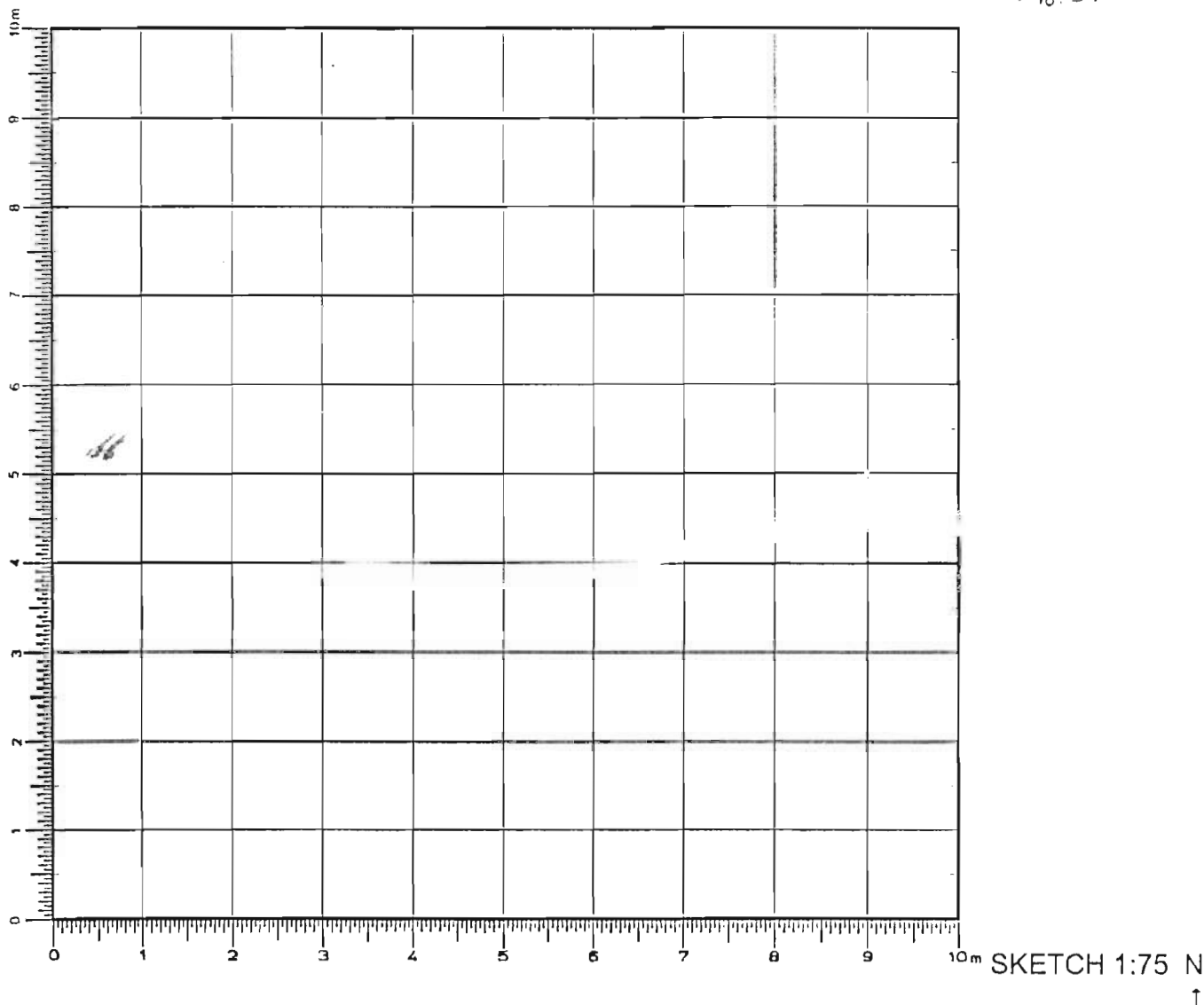

DEFINITION/DESCRIPTION of LOCUS (explain why you changed locus numbers):

Today's date: 15 June 06 Locus above: B 3513

Locus parameters: soil surrounded by B3510 to the north, B3511 to the east, and B3512 to the south,

Verbal description: run off soil and very top layer of stratigraphy of "kitchen" area. soil is very fine silt with small pieces of clay, small bone fragments and small to medium sized chert are scattered throughout.

Locus Interpretative Comments (What do you think this is? DATE your comments, continue on additional pages if necessary): This locus and pit number, B3516.99, is a clerical error. we will continue in the same area tomorrow with locus B3517.

Year 2006 Trench/Locus B 3517 Excavator TRQ

Elevations

Benchmark used: R28
 Reading on
 Benchmark: 2.219m
 H.I.: 348.591m

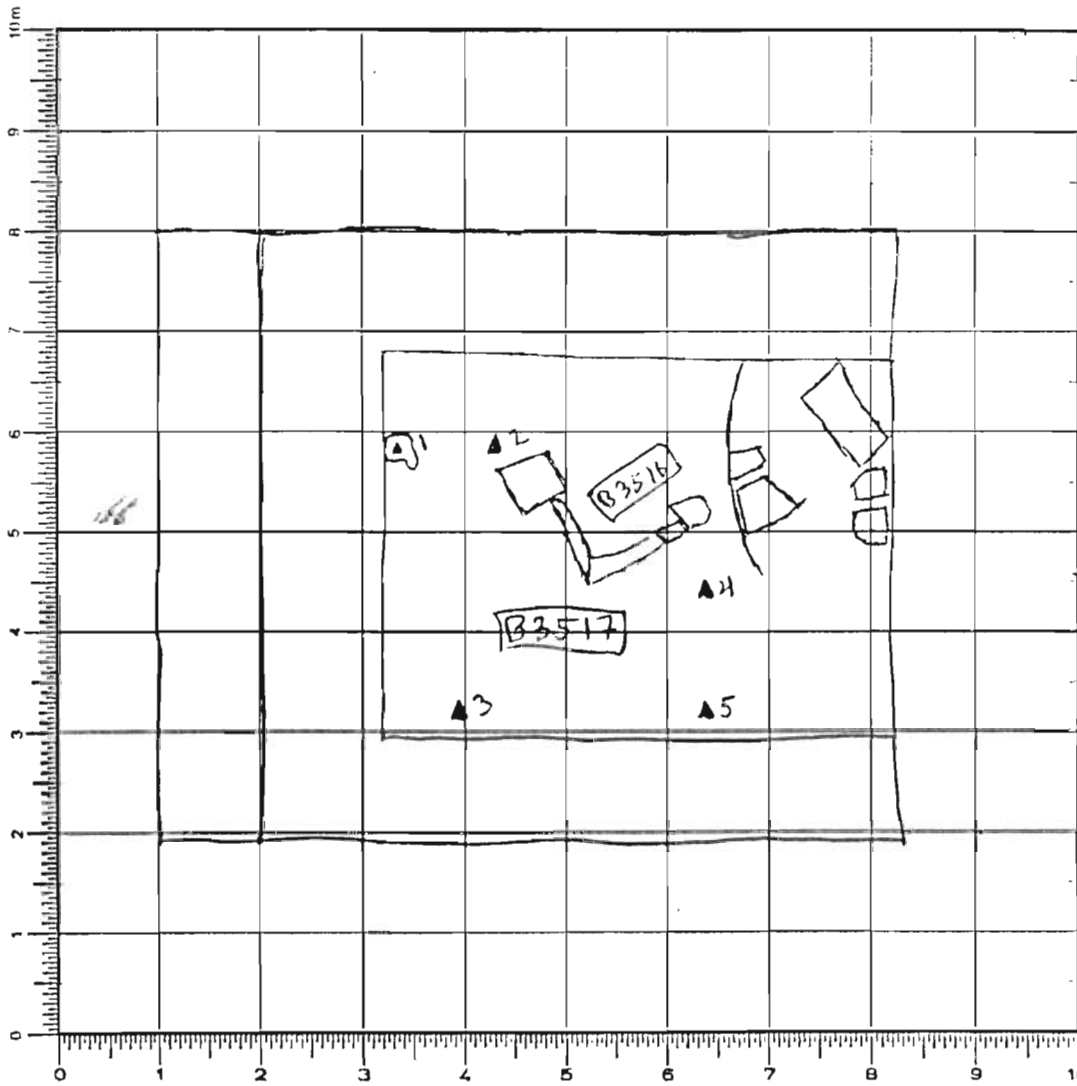

opening elevations

- 1) 3.241m = 345.350m
- 2) 3.223m = 345.363m
- 3) 3.273m = 345.315m
- 4) 3.235m = 345.356m
- 5) 3.231m = 345.360m

bottom elevations

- 1) 2.295m = 348.667m
- 2) 3.405m = 345.262m
- 3) 345.721m
- 4) 3.359m = 345.308m
- 5) 3.374m = 345.293

DEFINITION/DESCRIPTION of LOCUS (explain why you changed locus numbers):

Today's date: 16 June 06 Locus above: B 3513

Locus parameters:

Verbal description: The soil is a fine silt mostly deposited ~~in~~ over the winter from runoff. Within the soil are the stones which compose B 3516 and the benches B3510 and B3511 surround it on the North and East, respectively.

Locus Interpretative Comments (What do you think this is? DATE your comments, continue on additional pages if necessary):

16 June 06 - B3517.1 BM R28 HI 2.201 = 348.573m

We are peeling off the winter runoff to get to clean stratigraphy. The problem to be solved is what the date of the kitchen complex is within this Archaic house. Late Archaic through Hellenistic pottery has been found here,

Year 2006 Trench/Locus B3517 Excavator TRQ

DESCRIPTION of PROGRESS of EXCAVATION [date each entry and identify associated pottery pail(s)]:

continuation of 16 June 06

...but we want to prove that this is not a Hellenistic structure. This will hopefully be a post destruction open area that was used in the Hellenistic Period, but not as a kitchen. The goal is to find 5th and 6th century levels to confirm our hypothesis of earlier use.

Our second pass is revealing an increase in bone fragments, especially near the NE corner along the Northern bench. In the same area we found a small copper bowl base.

The soil is chipping off the floor surface very easily. The NE corner has several small stones exposed which may be floor packing. we will leave them in for now.

A small stone weight was found just east of B3516 and has been given the number B3517.2 object 2. Within the exposed floor packing along the northern side was a piece of iron slag, B3517.2 object 1.

Two intensive soil samples were taken from within the "hearth", which is bounded by B3516. After completing our full pass, we took elevations. Most of the pottery is Hellenistic. Our next step will probably be a test trench to see what is under this Hellenistic level. This will let us know if the bench is sitting on the packing and give us a date for the packing and the benches. The trench will be along the East side of the trench, between the bench and B3516.

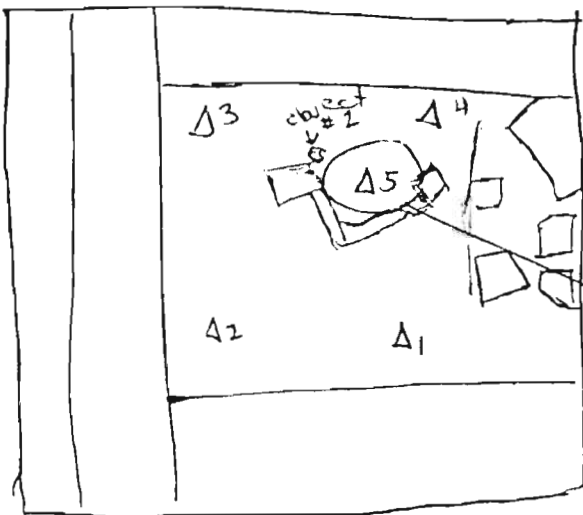

1. 3.095 m = 345.478 m
2. 3.125 m = 345.448 m
3. 3.080 m = 345.493 m
4. 3.070 m = 345.503 m
5. 3.100 m = 345.473 m

intensive soil samples 1 and 2

~~19 June 2006 B35~~

Year 2006 Trench/Locus B3518 Excavator TRQ

Elevations

Benchmark used: R 28
 Reading on
 Benchmark: 2.074m
 H.I.: 348.446m

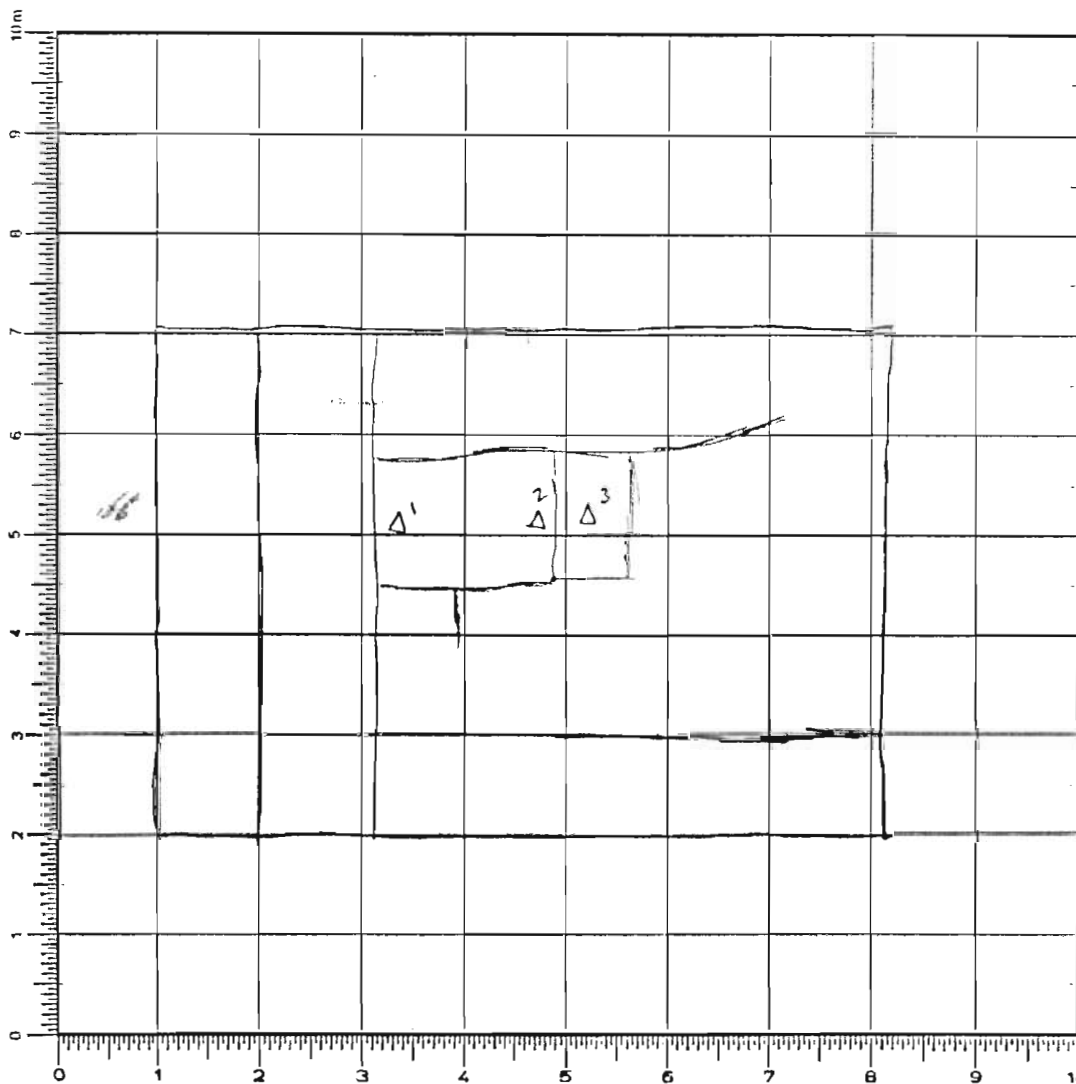

bottom levels:
 1) 2.998m = 345.449m
~~3.017~~
 2) 3.024m =
 345.422m
 3) 3.015m =
 345.431m

10m SKETCH 1:75 N ←

DEFINITION/DESCRIPTION of LOCUS (explain why you changed locus numbers):

Today's date: 19 June 06 Locus above: B3517

Locus parameters: East and NE corner outside of B3516. It measures 56cm E-W by 82cm N-S.

Verbal description: This is the rocky floor packing for the upper floor level in B3500. B3517 seems to have been Hellenistic.

Locus Interpretative Comments (What do you think this is? DATE your comments, continue on additional pages if necessary):

large stones ranging from 5-15 cm. moderate amounts of bone and pottery are being found between the stones. A pithos shard seemingly L/IIIC in date came out in the first pass. In our second pass, near the southern end of the test trench, a large chunk of baked clay/clay slag came up. After removing the cobble packing we came upon a hard packed

Year 2006 Trench/Locus B3518 Excavator TRQ

DESCRIPTION of PROGRESS of EXCAVATION [date each entry and identify associated pottery find(s)]:

clay layer. The beach stones and hearth stones seem to be sitting directly on the cobbles. The hard packed layer is probably a habitation surface. We will now finish the southern portion of the cobble that was previously left intact. This will allow us a greater pottery sample.

The extra part of the rubble revealed very little extra pottery. In the SE corner of the expanded section there is a small patch of light brown sandy soil. We went down to the same level as the northern part but there are a couple of sherds embedded in the clay matrix.

We took a final elevation on the recently cleaned southern section. This trench will be closed at the end of the day today.

20 June 06

The habitation level on which we came down yesterday may be Iron Age according to Dr. [?]. We are going to hold off on closing the trench. It may be early 7th or Geometric.

The cobbles - probably part of the original site - Halikia.

Year 2006 Trench/Locus B 3519 Excavator TRQ**Elevations**Benchmark used: R 28

Reading on

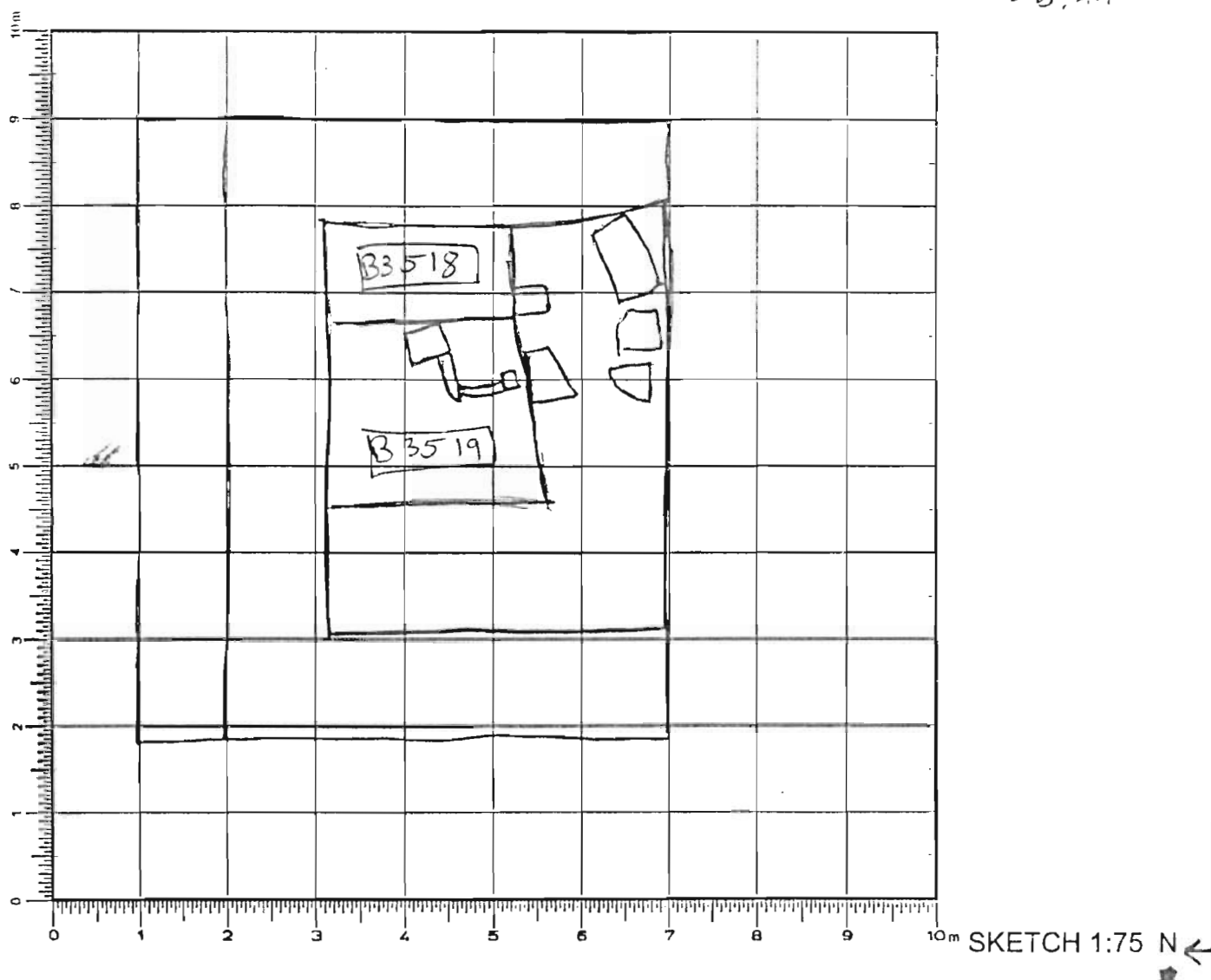
Benchmark: 2.074mH.I.: 348,446m

DEFINITION/DESCRIPTION of LOCUS (explain why you changed locus numbers):

Today's date: 19 June 06 Locus above: B 3517Locus parameters: west and NW corner outside of B 3516Verbal description: clay matrix with very fine pebbles.

Locus Interpretative Comments (What do you think this is? DATE your comments, continue on additional pages if necessary): A scraping was done over the surface of the clay floor matrix of B 3517 for the purpose of extracting several fragments of a hydria scattered over the area. As the scraping was very light, we did not take any further elevations.

Year 2006 Trench/Locus B 3520 Excavator TRQ

Elevations

Benchmark used: R 28'
 Reading on
 Benchmark:
 H.I.:

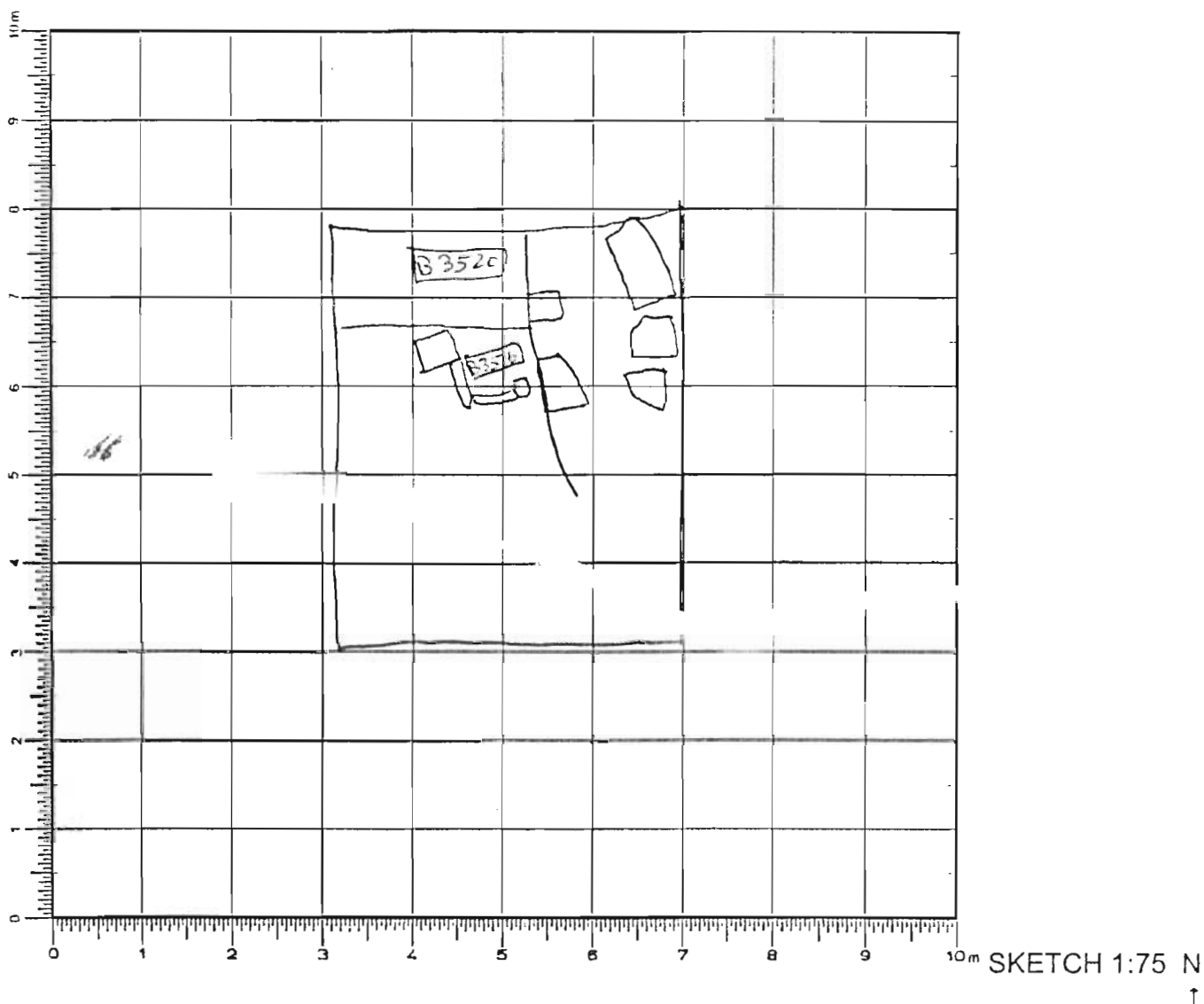

DEFINITION/DESCRIPTION of LOCUS (explain why you changed locus numbers):

Today's date: 23 June 06 Locus above: B 3518

Locus parameters: 118 cm N-S X 72 cm E-W

Verbal description: Hard dense clay floor matrix, small pebbles, pottery, and bone within.

Locus Interpretative Comments (What do you think this is? DATE your comments, continue on additional pages if necessary): This is the removal of the first couple of centimeters of the possible Iron Age floor matrix. An intensive soil sample is being taken for the first pass. The goal of this sounding is to provide a post quem for the floor itself.

Year 2006 Trench/Locus B 35 20 Excavator JRQ

DESCRIPTION of PROGRESS of EXCAVATION [date each entry and identify associated pottery pail(s)]:

27 June 06 B3520.2

We finished the pass begun on Friday. Maria commented that ~~some~~ some of the pottery looked Hellenistic.

A large flat stone on the Northern side of ^{the} sounding has come up. We encountered the upper ridge of the stone when we dug B3520.1. The stone measures about 50 cm x 26 cm. Its full size has not been uncovered yet. It lies up nicely with the largest stone in the "hearth." It seems to extend into the floor packing of the level represented by this locus.

DCH decided to take another pass in this sounding, giving it a new pail, B3520.3. The purpose of this pass is to discover how deep the floor may go and if there is another level beneath.

Pottery and bone from this pail have been small in number. A 5 liter standard soil sample was taken from this pass.

We are continuing down with another pass and pail B3520.4. A L1 pit has been found next to the large flat stone in B3520.3 calls into question the date of the floor level B3520. This pass has scattered packets of an ashy grey clay.

DCH removed the large flat stone mentioned above; however, after ~~completing~~ the pass representing B3520.4, another stone was found directly underneath with only a thin layer of soil between the stones. Elevations were taken at the bottom of B3520.2.

28 June 06

Another pass was taken which cleared away the soil that composed B3420.4. This pass, B3420.5, removed all trace of the soil with patchy grey clumps. The soil underneath ~~is~~ has a reddish tint and, if we continue, will be given a new locus number. B3420.5 has revealed only a few sherds and bone.

This latest pass has called into question the nature of the two large stone on the East and South sides of the sounding. Originally, these were thought to be simply outcroppings of bedrock, but on the South side, ~~is~~ there is a flat stone that seems to have been wedged underneath the bedrock. If this is the case, these stones may be placed boulders and not natural outcroppings.

After clearing away the patchy grey clay soil, DCH believes that we may be coming down on a floor surface possibly associated with the boulders/outcroppings.

Year 2006 Trench/Locus B3520.2 Excavator TRQ

DESCRIPTION of PROGRESS of EXCAVATION [date each entry and identify associated pottery pail(s)]:

Elevations from the 27th of June of the bottom of B3520.2.

HI: 1.690 m = 345.062 m

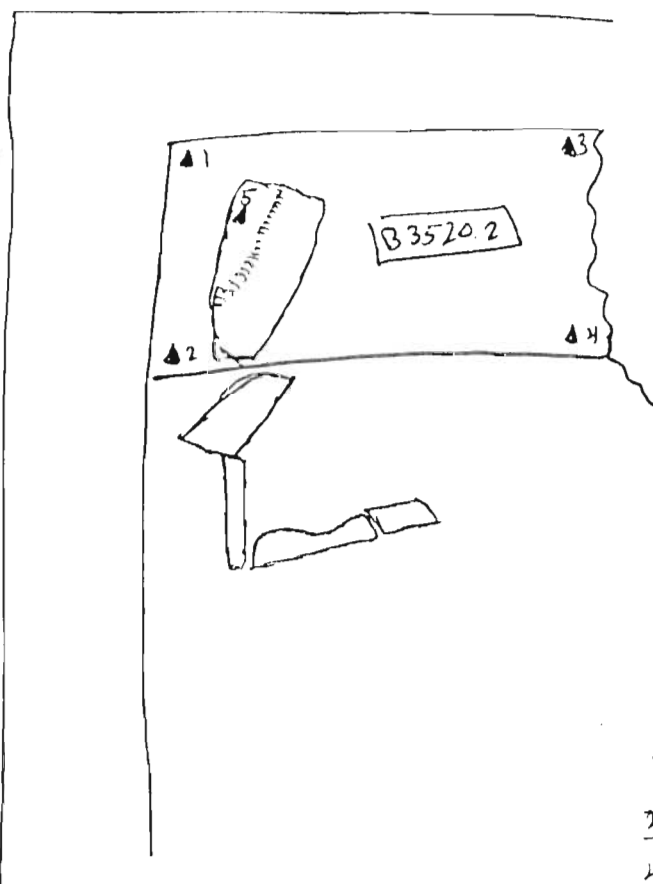

- 1) 2.648 m = 345.414 m
- 2) 2.680 m = 345.382 m
- 3) 2.684 m = 345.378 m
- 4) 2.649 m = 345.413 m
- 5) 2.599 m = 345.463 m

Year 2006 Trench/Locus B3520 Excavator TRQ

DESCRIPTION of PROGRESS of EXCAVATION [date each entry and identify associated pottery pail(s)]:

27 June 06 B3520.2

We finished the pass begun on Friday. Maria commented that some of the pottery looked Hellenistic.

A large flat stone on the Northern side of the sounding has come up. It seems very clear that this stone is a bench or an altar of some sort. This religious artefact has a southward tilt, probably to accommodate the runoff of libations. Surrounding the altar were several amorphous, aniconic figurines. A sketch of one is below:



N.B.: Facial features and breasts are conjecture. These will become clear once the figurines are cleaned.

When considering this altar in relation to the rest of the trench, the meaning of B3520 becomes more clear. The hearth found at a higher elevation ~~at~~ ^{than} the altar is likely a Hellenistic continuation of the earlier cult. This is also supported ~~by~~ by the plethora of amorphous, aniconic figurines associated, not only with this level, but also with all adjacent levels.