

TRENCH REPORT: B600

Trenchmaster: Sheri Pak (SZP)

Trench Assistants: Jordan Sandars and Jay Smith (week 1); Meredith Feuquay and Erica Zimmerman (week 2) Robby Cuthrell and Hallie Franks (weeks 3 and 5); Abbie Bollans, Anne Sassin, and Erica Zimmerman (weeks 4).

Trench Workmen: Pandelis Hatzidakis and Iannis Papadakis

Datum Points: There was only one datum point used during the excavation of this trench. It was R5 and its elevation is 363.77 masl.

Excavation Dates: June 2nd to June 24th, 2003

Location: Trench B600 is located immediately north of B300, northeast of B200, south of B900 and west of B1100. The trench is irregularly shaped due the nature of the slope and the placement of wall B602. See architectural drawing for detail.

Purpose of Excavation: Excavation started initially with the hope of discovering any architecture associated with the storage spaces (B400 and B200) and to discover the destination of the stairs in B300. As the exterior nature of this area became increasingly clear, excavation focused on determining the extent of the *dromos* wall B602. A corollary goal was to clarify the phasing of architecture of the bin area in the southeast corner of B200, which continued into the SW corner of B600.

Trench Divisions: The trench can be conveniently divided into four sections. The bin area which includes the southeastern area of B200 and the southwestern area of B600; the southern section which is immediately north of B304 and south of the road surface, the mid-section (roadway) which is the southern extent of the *dromos* just east of wall B602, and the northern section (roadway) which is the northern extent of this same wall.

Depositional History:

Bin area: The excavation of this area ended with Loci **B620** and **B621**, the exterior and interior of the bin respectively. The surface is comprised of extremely compact clay with relatively few inclusions. Immediately above these strata, was a layer of tumble and packed clay around the bin. There were also intermittent deposits of burn material and carbon, consistent with the destruction pattern, which can be seen across the site. Loci **B612** and **B608** are the contents of the bin within an extrapolated east bin boundary. Above this was a matrix of tumble and roofing clay (**B605** and **B606**). Atop of this was a stratum of tumble (**B604**), the first layer to be excavated this season. A layer of topsoil was excavated as **B301** last summer by WFM.

Southern Section: The excavation of this area ended with **B618** and **B619** (west and east side respectively), a sterile and chippy bedrock surface. This area yielded next to nothing with regard to finds. This material is characteristic of the fill used to build up terraces and there is a possibility that the southern section was a built up terrace with **Wall B304** retaining the fill material and that it eroded down well below the ancient surface level. This is further supported by the fact that the *dromos* **Wall B602** does not continue into the southern section. In any case, two especially large bedrock boulders situated in the middle of this area also prevented further investigation of the possible continuation of the steps (in **B300**) into **B600**. There is an arrangement of stones in the north part of **B618** that may have served as steps or a ramp, leading onto the roadway that begins there (based **Wall B602**). The layer immediately above this was a layer of tumble (**B607**) though the consistency of the matrix was very much like the chippy bedrock layer. Above this was a layer of topsoil (**B601** and **B603**). The excavation of this topsoil extended only halfway down as the southern half of this area had been partially excavated (**B301**) in 2002 by WFM. As to be expected, this

layer was a mixture of disturbed topsoil, tumble and Boyd's dump which had been exacerbated by the particularly wet winter.

Mid-section: Excavation of this area of **B600** ended with the road surface, confirmed by the bottom course of **Wall B602**. As expected from an exterior space, the surface itself was not well preserved and is relatively loose and chippy. A layer of medium to large tumbled stones (B609 including B607.4) was above the surface. Atop of this was a layer of disturbed topsoil (**B603** and **B601**), a mixture of tumble and Boyd's dump. In terms of finds, this area (along with the southern portion of the northern extension) produced the most pottery and bone, including a bronze pin.

Northern Section: Excavation of this area ended with the road surface. This area in particular was very poorly preserved (surface is chippy and loose with many small inclusions) The layer above the surface consisted of some major tumble in very loose soil. (**B615**, **B617** and **B611**). Large bedrock boulders situated along the northern end of B600 are part of the tumble from above (**B900**). These massive stones probably destroyed the northern extent of wall **B602**, which gently curves east at this point. Atop this was a deep layer of topsoil mixed with tumble and Boyd's dump (**B603** and **B601**).

Cut to the Chase:

Bin area:

1. **Surface level:** hard and compact clay surface
2. **B620 and B621:** material atop of surface
3. **B616, B614, and B613:** tumble and packing clay
4. **B612 and B608:** contents of bin
5. **B606 and B605:** tumble and roofing clay
6. **B604:** tumble
7. **B301:** topsoil

Southern Section:

1. **B618 and B619:** sterile chippy bedrock layer
2. **B607:** tumble]
3. **B301:** topsoil

Mid-section:

1. **Road surface:** chippy, loose soil
2. **B609 (=B607.4):** tumble material atop exterior space
3. **B601 and B603:** topsoil, tumble, Boyd's dump

Northern Section:

1. **Road surface:** chippy, loose soil
2. **B615, B617 and B611:** tumble
3. **B603 and B601:** topsoil, tumble and Boyd's dump

Year 2003 Trench/Locus B601Excavator SZP**Elevations**

Benchmark used: R5
 Reading on 363.77 masl
 Benchmark: (3.825)
 H.I.: 367.595 masl

START ▲ B601

1. (2.878) 364.717
2. (3.148) 364.447
3. (3.264) 364.331
4. (3.432) 364.163
5. (4.655) 362.94
6. (4.294) 363.301
7. (4.300) 363.295
8. (3.514) 364.081
9. (3.484) 364.111
10. (3.195) 364.400
11. (3.375) 364.220

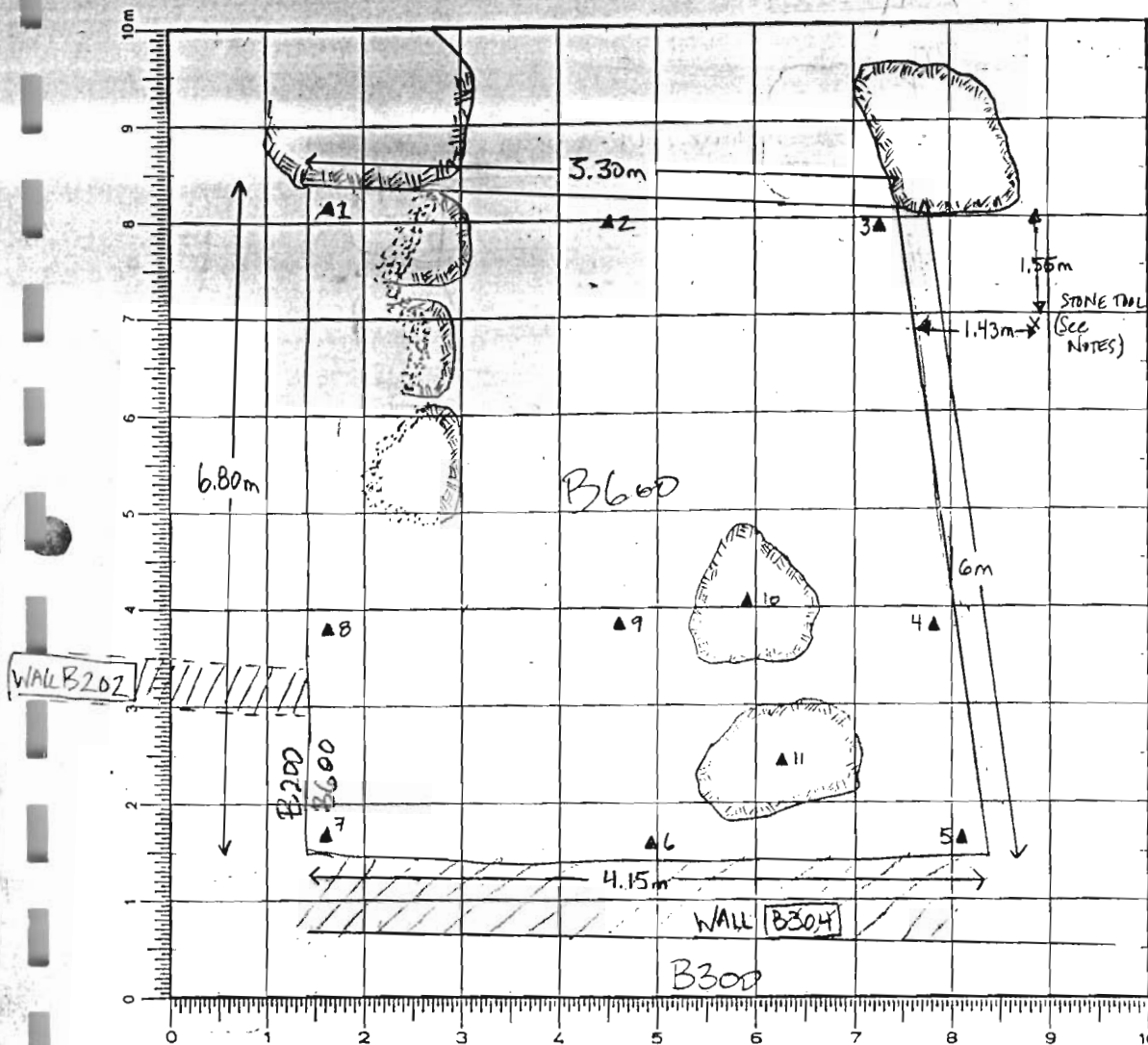

↑ upslope

SKETCH 1:75 N

DEFINITION/DESCRIPTION of LOCUS (explain why you changed locus numbers):

Today's date: June 3/03 Locus above: noneLocus parameters: See sketch

Verbal description: An even layer of dead grass with scattered stones (a few large stones in the northwest corner and the south east section. Locus slopes to the south and to the east. The southern section slopes more steeply and appears to have been excavated (last season as part of B300) in a shallow pass to a chippy bedrock layer. There is a room to the south of locus (B300) and a storage room (B200) to the southwest of locus. To the west, as part of B300, the surface was also →

Locus Interpretative Comments (What do you think this is? DATE your comments, continue on additional pages if necessary): This locus contains topsoil, Boyd's dump (most stones were cleared before excavation) and (especially in the B300) winter work. excavated (shallow pass) to chippy

AZORIA Project

p.2

Year 2003 Trench/Locus B601 Excavator SZP

Locus/Pottery Pail Number	Weight of Sherds	Number of Sherds	Chronology & Comments
✓ B601.1	0.550 kg	26	
✓ B601.2	0.420 kg	35	Archaic + Ottoman
✓ B601.3	0.875 kg	28	Hellenistic, Archaic
✓ B601.4	0.135 kg	8	Archaic
B601.5	0.015 kg	3	Archaic / NPD
B601.6	0.790 kg	55	Archaic + Hell.?
B601.7	0.490 kg	27	Archaic, 1 EIA
B601.8	0.115 kg	25	Archaic + Hell.
B601.9	1.040 kg	79	Hell., Archaic
B601.10	2.685 kg	141	Hell., Archaic, Orient, LM III C

B601.11 1.850 kg 176

B601.12 0.880 kg 136

B601.13 0.725 kg 133

OBJECTS

Hell., Archaic, Lg

Hell., Archaic, Lg, LM III C

Archaic, Hell., PG

Object Number	Associated Pottery Pail	Identification (material/form)	Location	Elevation	Catalogue Number
B601.14	1.700 kg	156	Hell., Archaic, Lg		
B601.15	0.390 kg	4	Archaic		

ADDITIONAL COLLECTED MATERIAL

Locus/Pottery Pail Number	Bones	Shell	Carbon	Pumice	Soil Sample	Other (specify)
B601.3	1					
B601.5	1					
B601.6	1		1			
B601.8	1					
B601.9	1					
B601.10	1		1			
B601.11	1					
B601.12	2 (incl. 1/4")		2 (incl. 1/4")		1 standard	
B601.13	2 (incl. 1/4")	1 w/ 1/4" bone				
B601.14	2 (incl. 1/4")		2 (incl. 1/4")		1 intensive	

Year 2003 Trench/Locus B601Excavator SZP

DESCRIPTION of PROGRESS of EXCAVATION [date each entry and identify associated pottery pail(s)]:

June 2/03: General cleaning of site of vegetation and medium to large stones (Boyd's dump). Stones were taken to the south of B400 → a wall was created by the workmen (Giorgos & Iannis) in order to retain the excavated soil from ^{* the spoil tip for B600} B600 to create a level surface in B400. Some sherds were found

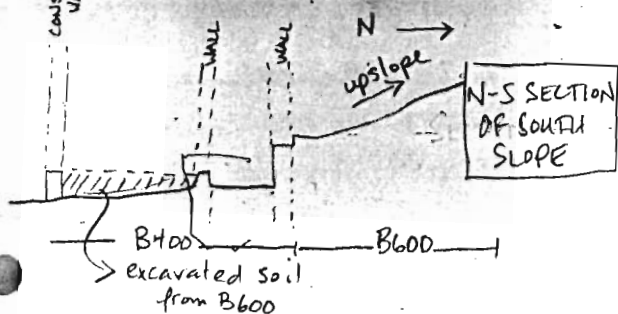

but left where found as the trench parameter was still unclear. NOTE: a stone tool was found in area just east of B600 on the surface (1.43m east of the E bank for B600 and 1.55m south of the extrapolated North bank for B600) - put in bag, left by stones to east of B600. Clearing of South slope of Boyd's dump was not completed - however enough was completed to begin excavation → day ended with outlining

of trench parameters → elevations & photos needed tomorrow.

June 3/03: Elevations were taken. Photos (2) were taken. Dirt run will move along east side of trench to the area created by the wall.

First pass (pail B601.1) will move south to north (slightly downslope) and approach and (hopefully) define the north face of wall B304.

The N-S wall on the west side of the trench (3 v. large bedrock blocks in trench and that extend further north) should be better defined.

Trench B200 (adjacent to the west side of B600) left last season after a shallow pass which exposed a chippy bedrock layer. → the southern part was excavated further and produced a small rectangular storage room.

We anticipate finding a similar chippy layer and plan to continue to excavate in order to find an adjoining structure(s) or at the least some clarification of the architectural phasing for this area (B200).

A shallow pass (ca. 10cm) was begun since the condition of the soil (ie. heavy and moist from the rains) was not conducive for a deeper pass. The large N-S well (B602) was further defined (3 large ^(ca. 60x80cm) stones were exposed in the NW corner). Several medium sized (ca. 25x15cm - 35x35cm) stones were found just south of the southernmost part of wall B602.

Year 2003Trench/Locus B601Excavator SZP

DESCRIPTION of PROGRESS of EXCAVATION [date each entry and identify associated pottery pail(s)]:

Start elevations for Rod 3.983

B601 extension north

- RS 363.77 msl
 HI 363.753
 1. (3.091) 364.662
 2. (2.700) 365.045
 3. (2.329) 365.424
 4. (2.650) 365.103
 5. (2.885) 364.868
 6. (3.294) 364.459
 7. (on big stone) (3.537) 364.216
 8. (3.264) 364.489

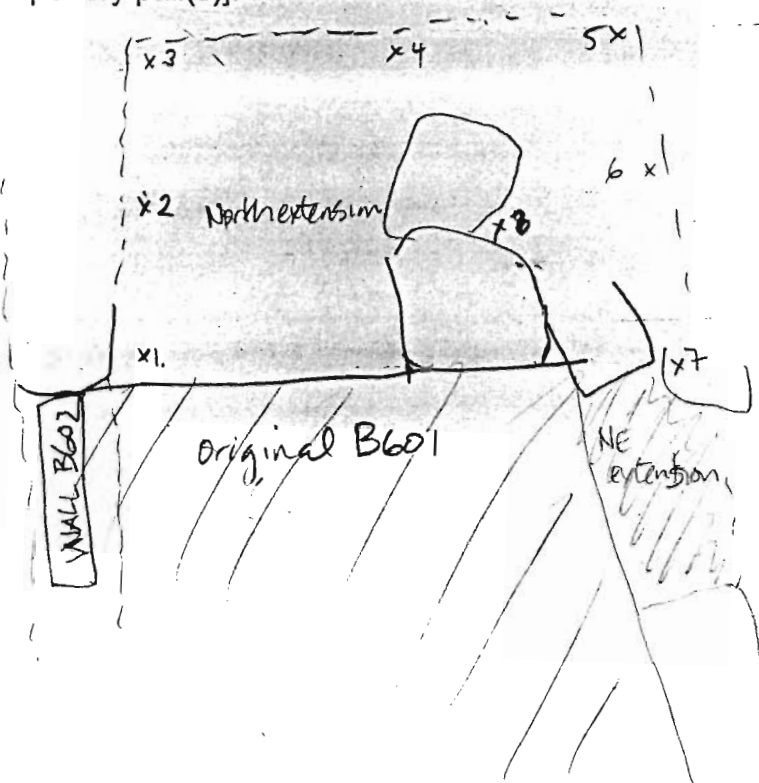

June 4/03: excavation of B601^{NE} extension working from the south to the north.

*no screening

The initial pass of this extension is ca 10cm deep. Pottery bag is B601.2 → this is the topsoil and includes Boyd's dump (though most of the stones were cleared June 2nd/03). The extension of B601 northward will include the northern extension of B602 (the western limit of B601) and includes as its northern trench limit, a series of large stones aligned along a W-E axis (possible wall?) → see sketch for dimensions.

Soil, as to be expected, is dark reddish brown and friable with many inclusions (1st size stones with some medium sized stones as well). Photos were taken. Elevations taken. By day's end, pass was not completed.

June 5/03: Continued excavation of B601 in North extension. Pottery is collected in pail B601.3 → coarseware with some fineware. Cleared the eastern face of a large N-S wall (WALL B602). Excavation of B601 completed.

*no screening

slightly - start elevations not taken.

June 6/03: north extension now extended (see diagram on p. 5). Pottery collected in B601.4. Pass completed. Little pottery.

*no screening

Year 2003 Trench/Locus B6011 Excavator SZP

DESCRIPTION of PROGRESS of EXCAVATION [date each entry and identify associated pottery pail(s)]:

START ▲ FOR B600 (June 3/03)

5: 363.77

Rd: 3.983

I : 363.753

1. (3.091) 364.662

2 (2.708) 365.045

3. (2,329) 365. 424

4. (2,650) 365.103

5 (2.885) 364,868

6. (3.294) 364.459

7. (3.537) 364.216

8 (3 264) 364.489

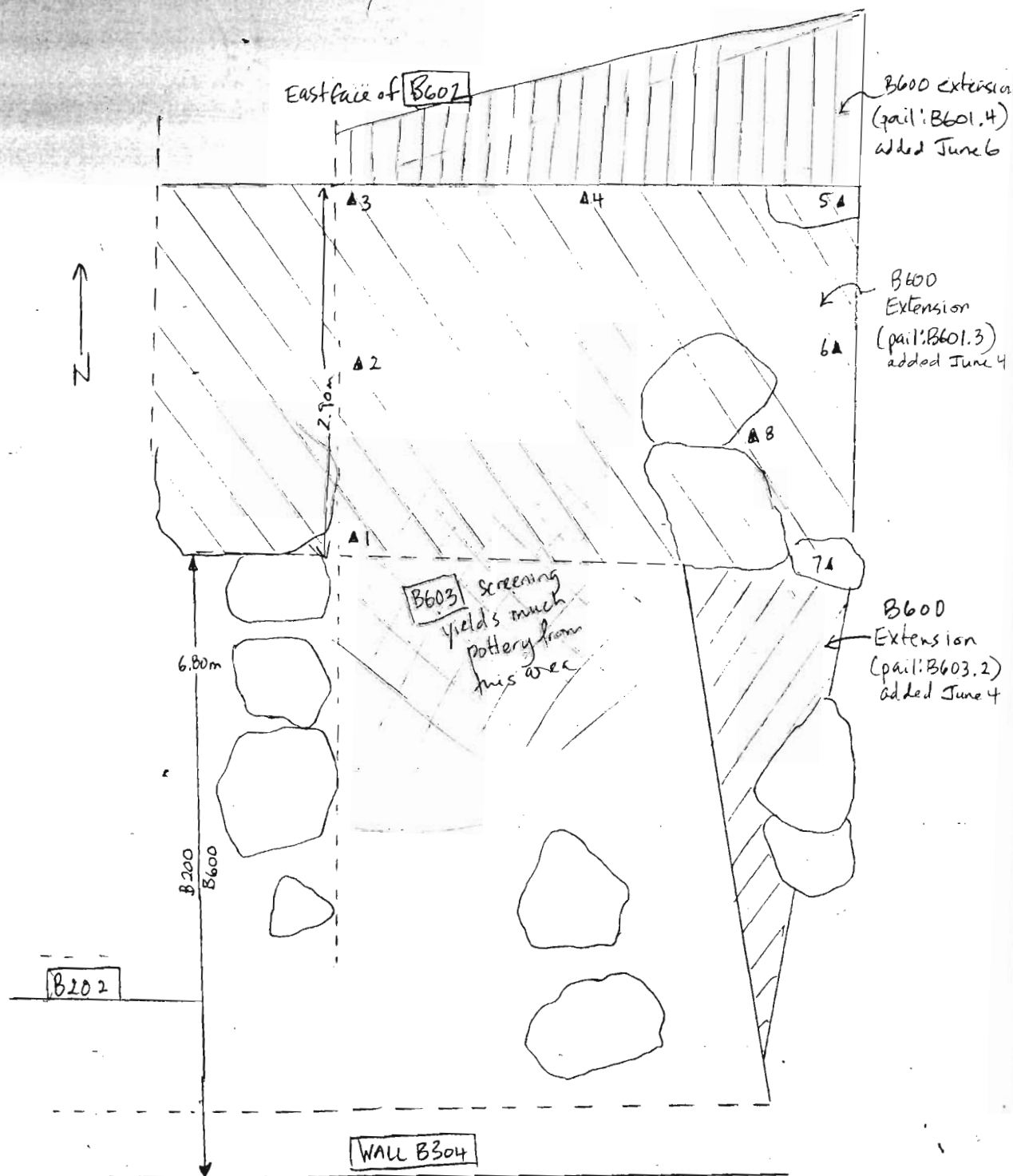

JUNE 5/03

END ELEVATIONS B601 (next side)

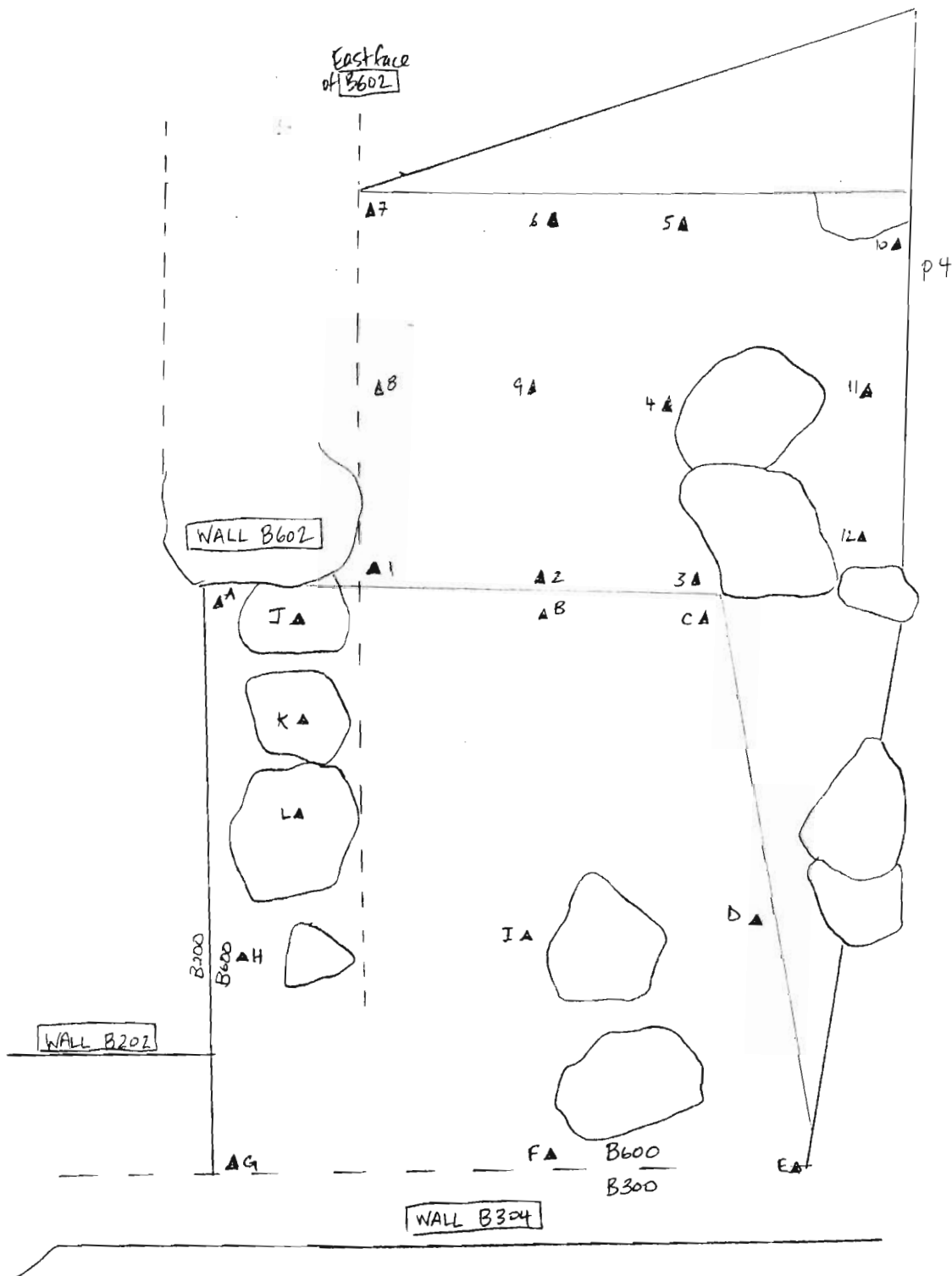

END ELEVATIONS FOR B601 (northern extension)

RS 363.74
 Rod 4.172
 HI 367.842 masl

1. (3.525) 364.317
2. (3.565) 364.277
3. (3.570) 364.272
4. (3.180) 364.662
5. (2.893) 364.949
6. (2.811) 365.031
7. (2.745) 365.097
8. (3.009) 364.833
9. (2.971) 364.871

RS 363.77
 Rod 4.195
 HI 367.965

10. (3.051) 364.914
11. (3.301) 364.664
12. (3.740) 364.225

RS 363.77
 Rod: 3.964

HI 367.734 masl

- A. (3.147) 364.587
- B. (3.352) 364.382
- C. (3.466) 364.268
- D. (3.662) 364.072
- E. (4.942) 362.792
- F. (4.681) 363.053
- G. (4.550) 363.184
- H. (3.847) 363.887
- I. (3.765) 363.969
- J. (3.007)
- K. (3.168)
- L. (3.284)

Excavator

Benchmark used: R5 363.77

Reading on 2.995

Benchmark:

H.I.: 366.765

START ELEVATIONS FOR NORTH EXTENSION #2

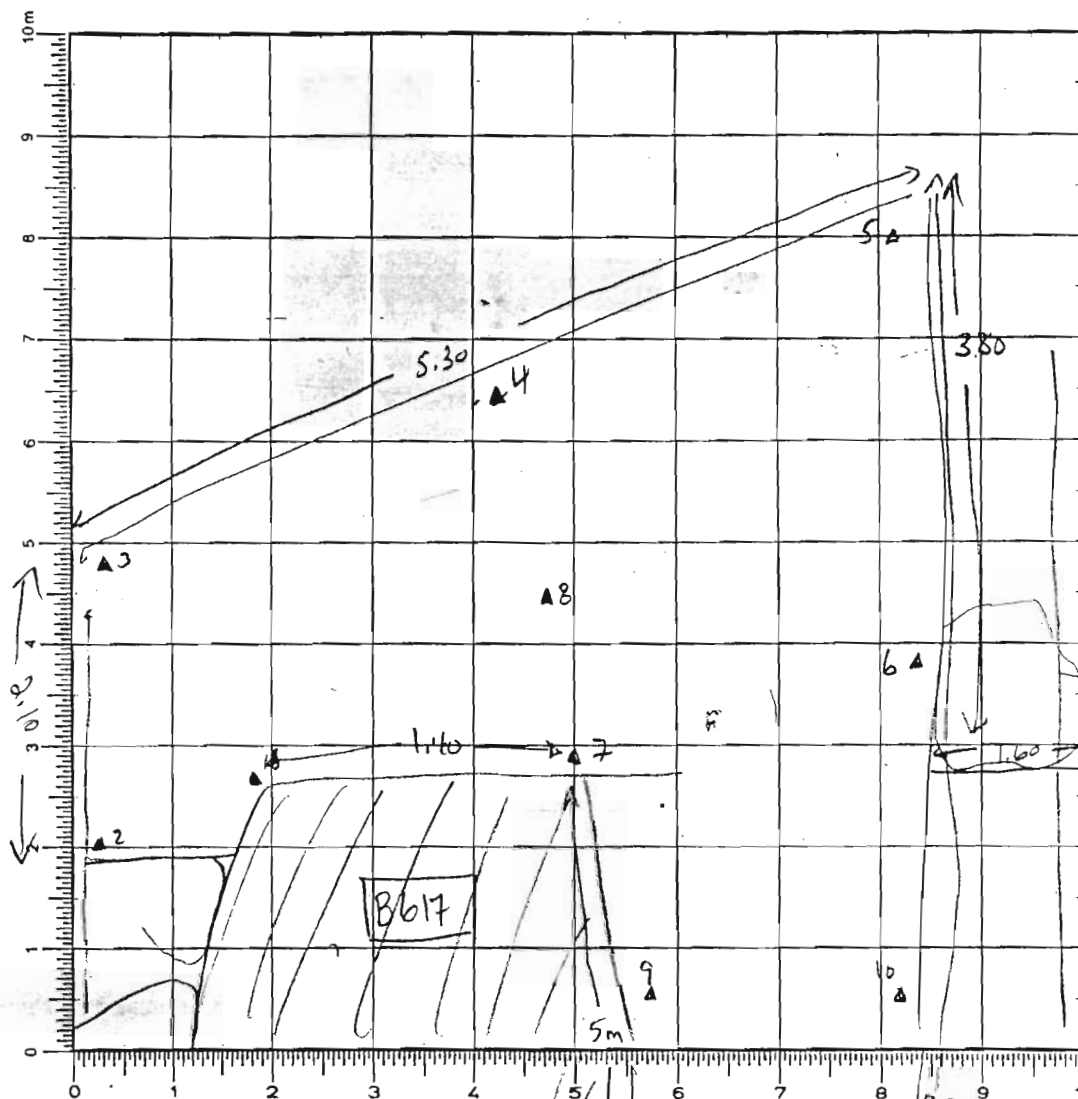

1. $(0.927)365.849$
2. $(0.910)365.855$
3. $(0.573)366.192$
4. $(0.280)366.495$
5. $(0.411)366.354$
6. $(1.617)365.148$
7. $(1.454)365.311$
8. $(0.957)365.808$
9. $(2.037)364.728$
10. $(2.338)364.427$
11. $(2.712)364.053$
12. $(2.583)364.182$

B1100

c

0

mb

12

151

DEFINITION/DESCRIPTION of LOCUS (explain **why** you changed locus numbers):

Today's date: June 17/03

Locus above:

Locus parameters:

Verbal description:

Locus Interpretative Comments (What do you think this is? DATE your comments, continue on additional pages if necessary):

Year 2003 Trench/Locus B601 Excavator SZP

DESCRIPTION of PROGRESS of EXCAVATION [date each entry and identify associated pottery pile(s)]:

PART ELEVATIONS FOR
NORTH EXTENSION #2:

June 17/03

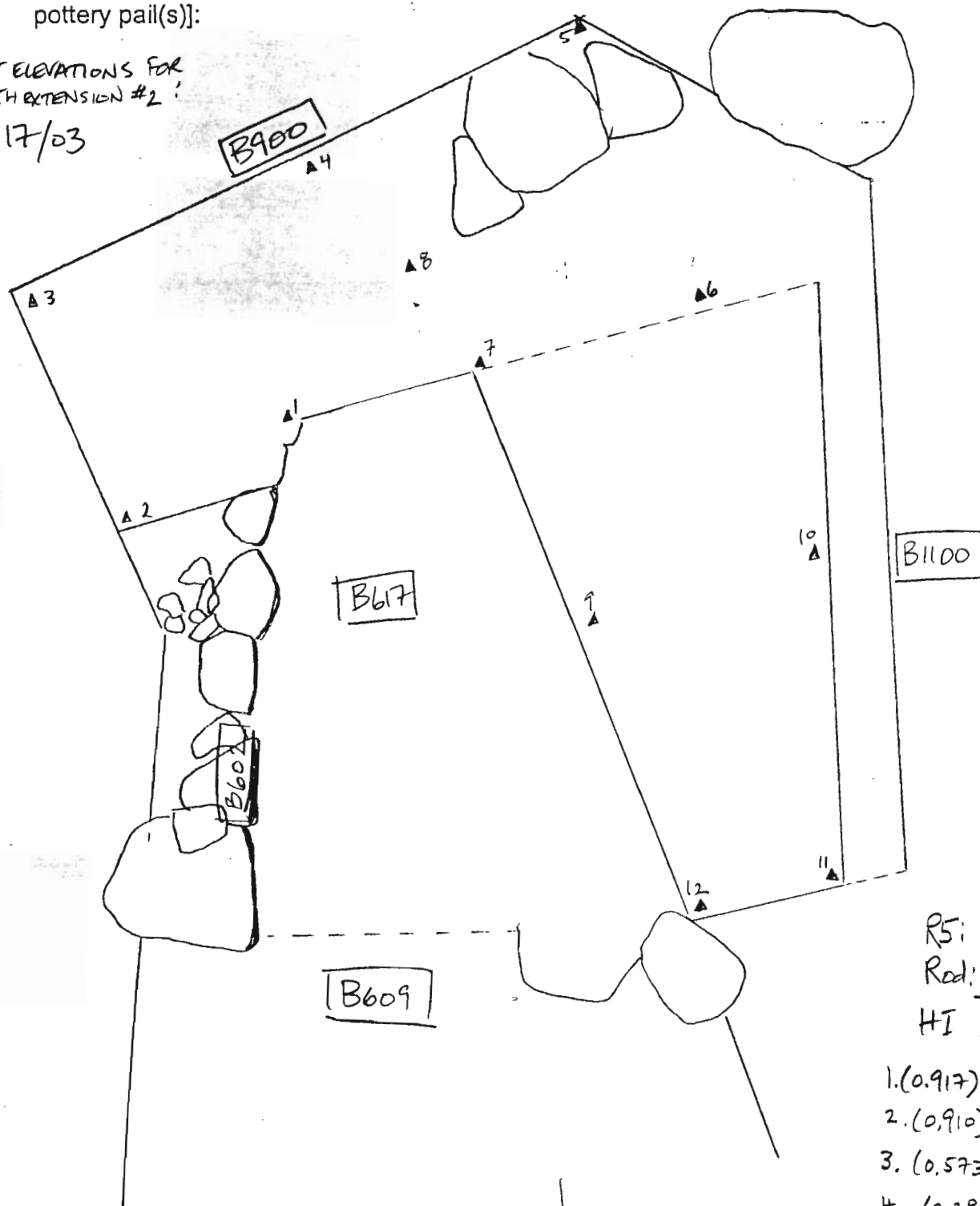

R5: 363.77
 Rod: 2.995
 HI 366.765 masl.

1. (0.917) 365.848
2. (0.910) 365.855
3. (0.573) 366.192
4. (0.280) 366.485
5. (0.411) 366.354
6. (1.617) 365.148
7. (1.454) 365.311
8. (0.957) 365.808
9. (2.337) 364.728
10. (2.338) 364.427
11. (2.712) 364.653
12. (2.583) 364.182

Year 2003 Trench/Locus B601 Excavator SZP

DESCRIPTION of PROGRESS of EXCAVATION [date each entry and identify associated pottery pail(s)]:

June 17/03 : Northern ~~extension~~scarp extended to southern extent of B900. Purpose is to uncover the northern extent of B602 which runs north-south. Pottery bag is B601.5 - Bone found. Excavation to begin in SW section (atop Wall B602) and move upwards (upslope) to the south limit of B900. Movement will then move eastward to the east boundary and then move southward - in order to preserve path to spoil tip far as long as possible.

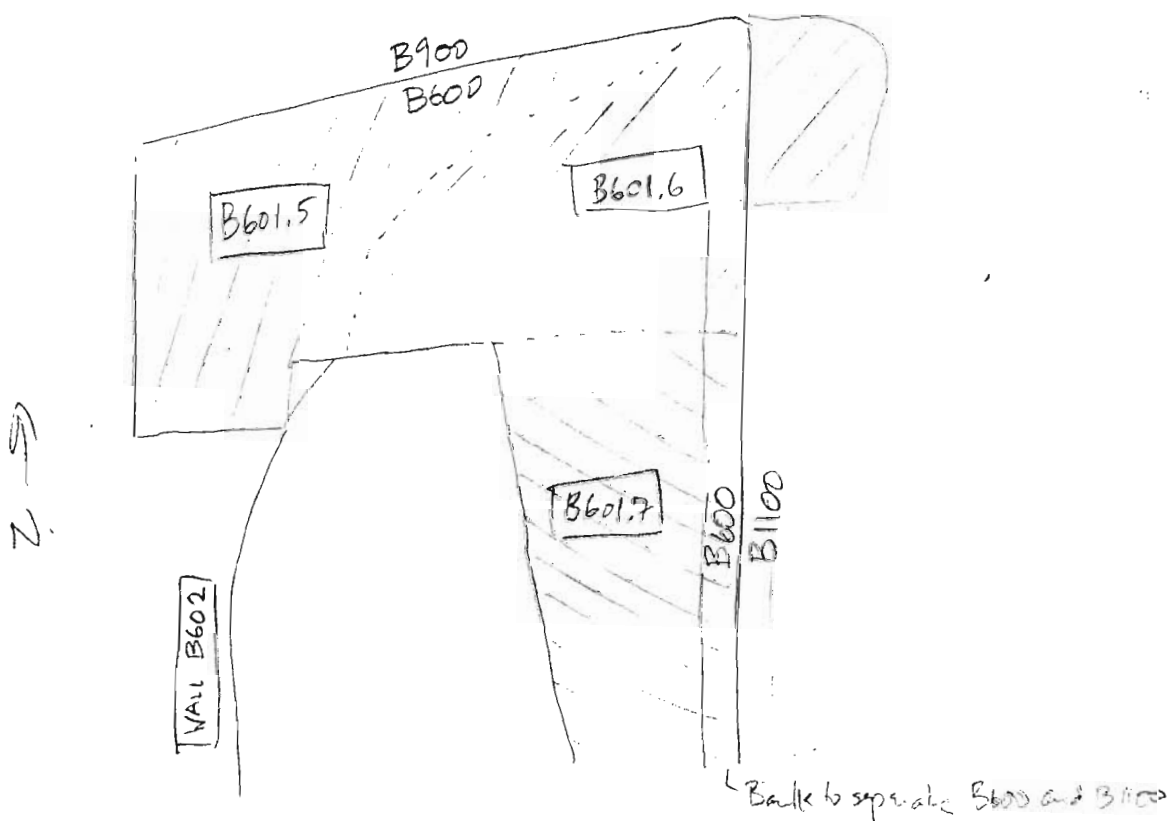

June 18/03 : Continued excavation - pottery pail is B601.6
: soil very friable - little found.

Carbon found (ca 2.10m from west baulk, 1.70m from North baulk)

another pass begun from south and moving upwards -> pail is B601.7 -> shallow pass to remove topsoil

June 18/03: (cont)

end elevations B601.5 and B601.6

Benchmark: R5 363.17

Rod: 2.949

H.I: 366.719

1)	(1.098)	365.421
2)	(1.301)	365.418
3)	(0.838)	365.881
4)	(0.660)	366.059
5)	(0.628)	366.091
6)	(1.200)	365.519
7)	(1.318)	365.401
8)	(1.319)	365.400
9)	(1.031)	365.688
10)	(1.045)	365.674

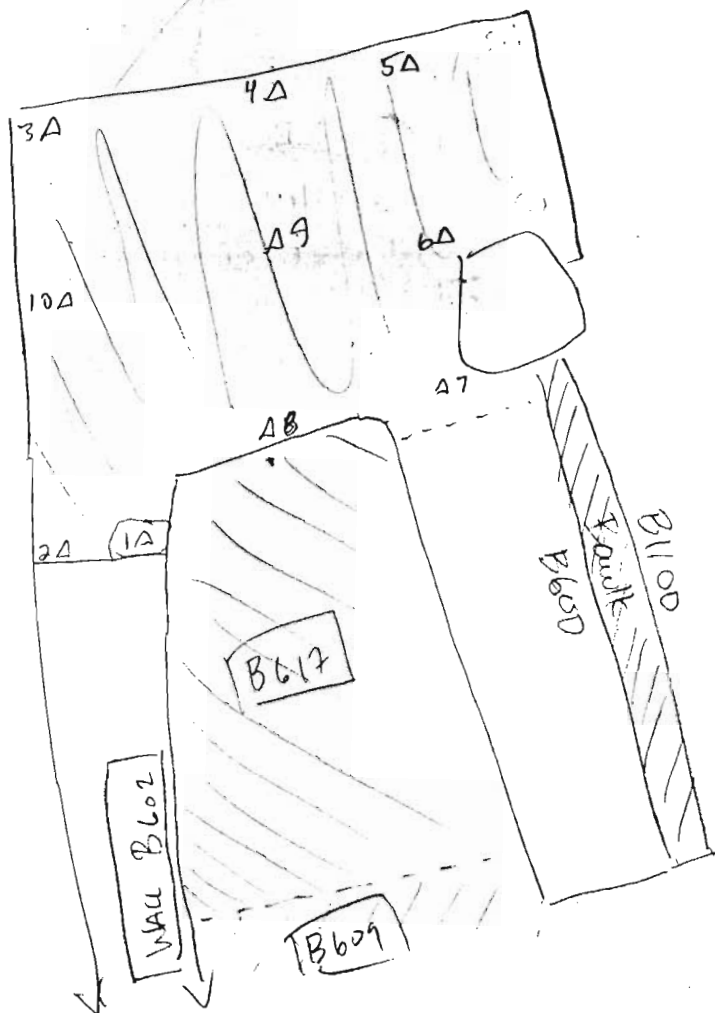

removal of topsoil of eastern section - shallow pass -> pottery B601.7
 because of the slope, the upper (north) area will have to be taken down
 in several passes; a bank (ca. 50cm wide) will be left between B600 and B1100.
 very little found in terms of pottery; pass stopped at northern extent of
 old trench.

June 19/03:

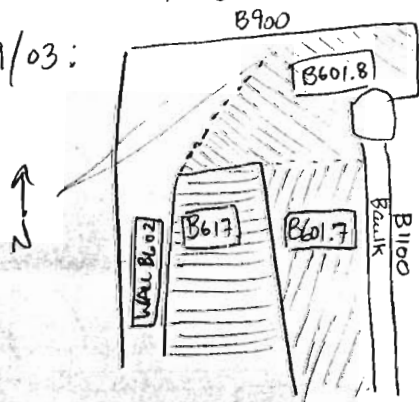

pass continuing north to the east and then towards
 the west (approaching the anticipated east face of
 the northern extent)
 pit is B607.8

Year 2003 Trench/Locus B601 Excavator SZP

DESCRIPTION of PROGRESS of EXCAVATION [date each entry and identify associated pottery pail(s)]:

June 19/03 : (cont) - another pass taken of northern section (ca. 10cm deep) - pail is B601.9

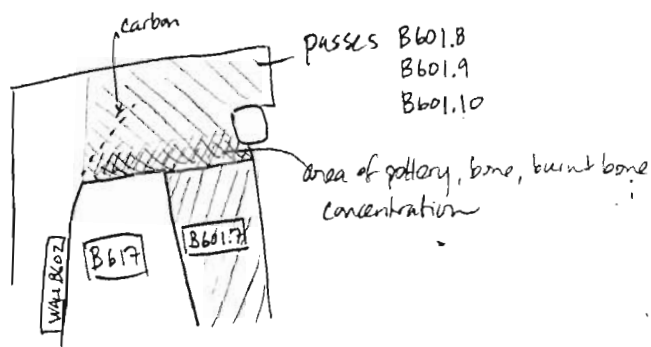

- Concentration of burnt bone and pottery in Southern section of pass.
- exposure of medium stones north of Wall B602 - which may be part of its northern extent. → suggesting that the wall curves slightly eastward.
- Soil is still friable.

! another pass was taken in same area \rightarrow pair is B601.10

- concentration of burnt bone and pottery in south section again
- small concentration of carbon found - sample taken
- area to the north → soil is chippy eroded bedrock material

June 20 / 03

- began another pass of north section - pair is B601.11
- again southern section of loess yields much bone and pottery.
- northern section is chippy bedrock layer. → next pass will stop short of this

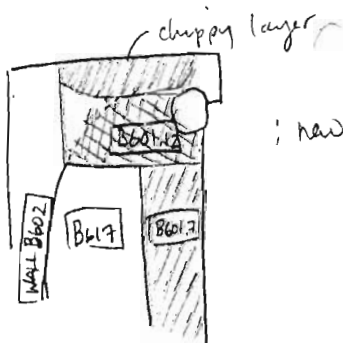

; now pass to stop short of chippy layer to north - point is B601.12
100% $\frac{1}{4}$ " screening

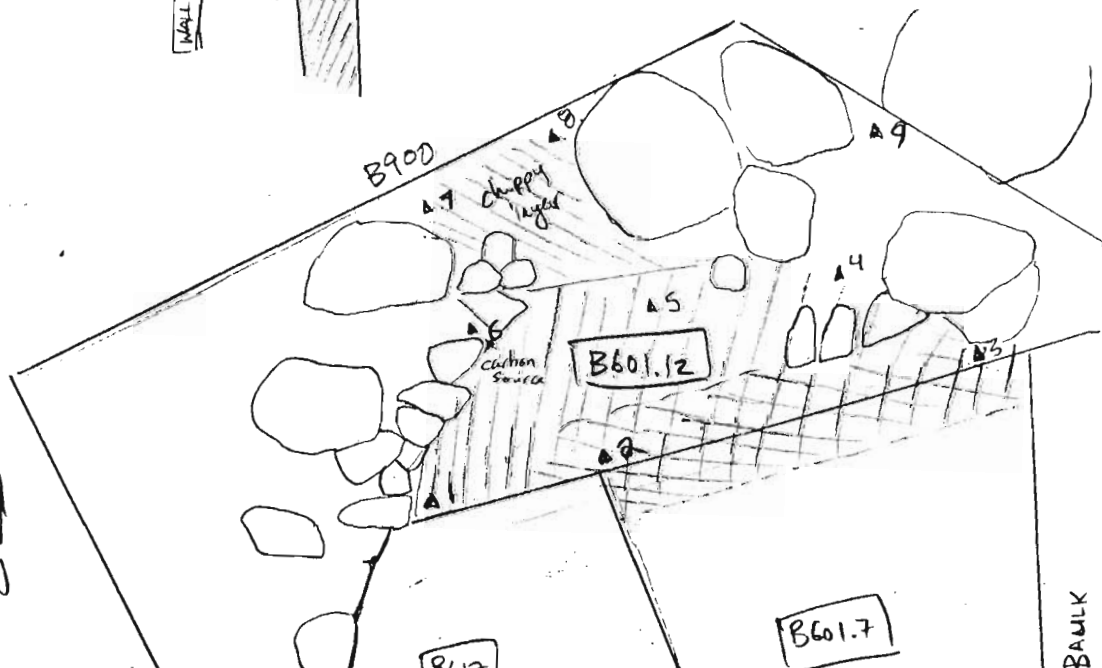

START ELEVATION 53601

RS 363.77

Rod 2.912

HI 366.682

1 (1.393) 365.289

$$-2(1.648 + .12)$$

3 (1.724) 364.958
4 (1.425) 315.000

$$S(1.478) 365 \quad 204$$

6 (1.378) 365.304

 $7(1.077) = 365.605$
$$\begin{matrix} 8 & (0.940) & 365.77 \\ 9 & (1.223) & 365.77 \end{matrix}$$

1011221/365.45.

Carbon source from

B601.12

elevation 6455

June 20/03 : carbon found in west section of locus.
(cont) : again concentration of bone and pottery in south portion
: new pass - pail is B601.13 - pass is not completed
by day's end.

June 23/03 - continuation of pass, ~~north~~ south to north → pail
B601.14

- excavation of northern section to clarify the same pail
possible northern extent of B602 → pail further is B601.14
- different strategy: ^(B601.13) pass northward will now bring locus
down to same level as area ^{just} east of wall B602
- carbon found
- dark ashy soil found - burnt soil - intensive soil sample
taken (5L)

June 26/03 - sweeping for clean up - pail B601.15

Year 2003 Trench/Locus B601 Excavator Szp

DESCRIPTION of PROGRESS of EXCAVATION [date each entry and identify associated pottery pail(s)]:

June 23/03 :

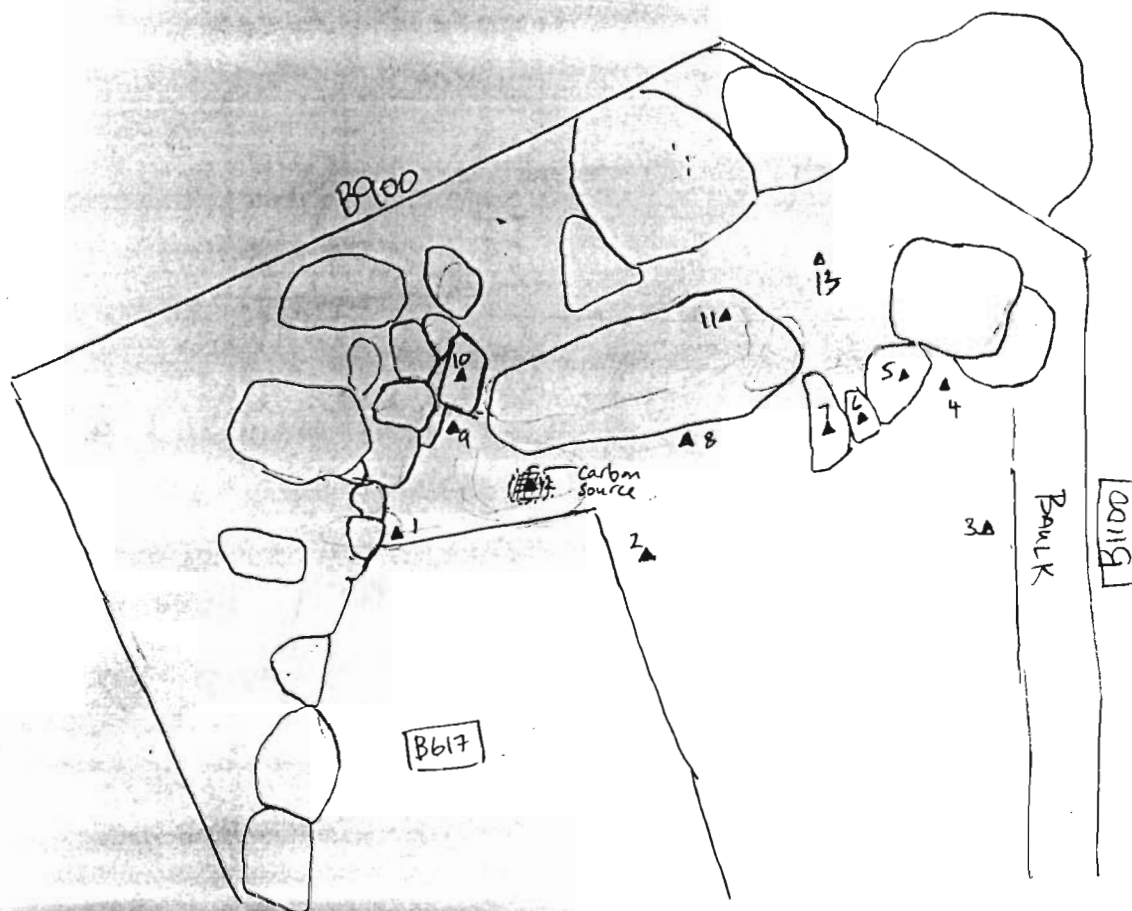

END ELEVATIONS B601 NORTH EXTENSION

R5: 363.77 masl

Rod: 3.560

H1: 367.33

1. (2.283) 365.047

2. (2.438) 364.892

3. (2.636) 364.694

4. (2.474) 364.856

5. (2.148) 365.182

6. (2.285) 365.045

7. (2.225) 365.105

8. (2.448) 364.882

9. (2.344) 364.981

10. (2.101) 365.229

11. (1.908) 365.422

12. (2.392) 364.938

13. (2.182) 365.148

(Carbon Source)

Year 2003 Trench/Locus B602Excavator SZP

Elevations

Benchmark use

Reading on

Benchmark:

H.I.:

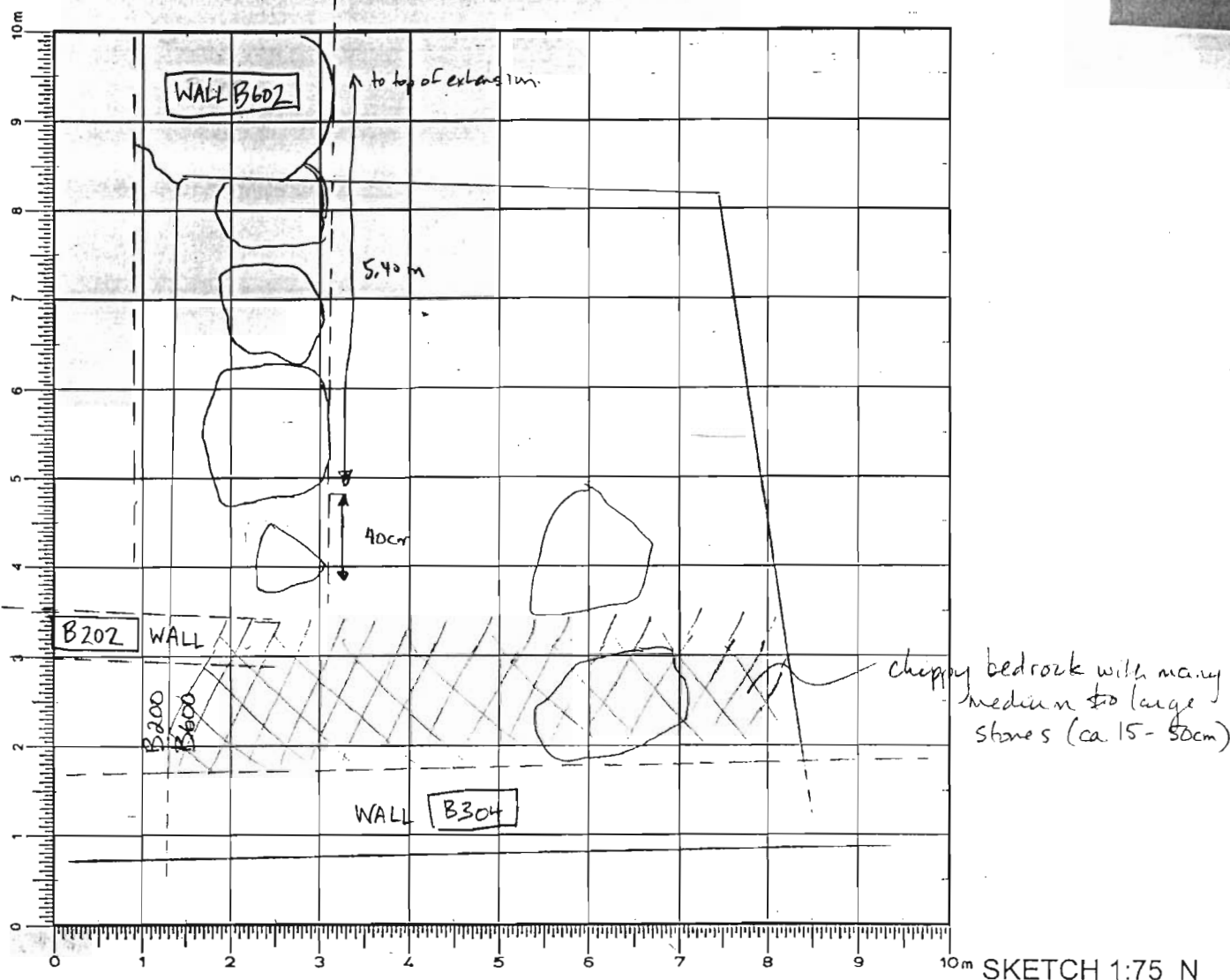
WALLDEFINITION/DESCRIPTION of LOCUS (explain **why** you changed locus numbers):Today's date: June 3/03 Locus above: B601Locus parameters: Width ca.
Length ca.

Verbal description: Wall running N-S, 3 large stones in the NW section of trench that extends further north of the trench. This wall was visible in the topsoil and further defined during the excavation of B601

Locus Interpretative Comments (What do you think this is? DATE your comments, continue on additional pages if necessary):

This a wall that was partially visible extending north of the trench. After excavation of B601, three very large stones making up the east face were uncovered.

[illegible]

OBJECTS

[illegible]

ADDITIONAL COLLECTED MATERIAL

[illegible]

27 June
 Year 03 Trench/Locus B602.1 Excavator JZP

DESCRIPTION of PROGRESS of EXCAVATION [date each entry and identify associated pottery pail(s)]:

Intensive soil samples taken at 6 intervals along side wall.

* Length of wall = 9.31 m.

~~FOO~~ **Soil Sample #1**: taken at 1.50 m.

Hole - 35 cm width
 35 cm length = 5 liters of soil
 Hole filled in with dirt.

Soil Sample #2: taken at 2.80 m.

Hole - 35 cm width
 36 cm length = 5 liters of soil
 Hole filled with dirt

Soil Sample #3: taken at 4.0 m.

Hole - 40 cm width
 30 cm length = 5 liters of soil
 Hole filled in with dirt

Soil Sample #4: taken at 5.9 m.

Hole - 25 cm width
 30 cm length = 5 liters of soil
 Hole filled in with dirt (Rocky soil)

Soil Sample #5: taken at 7.1 m. (Rocky soil)

Hole - 45 cm width
 30 cm length = 5 liters of soil
 Hole filled in with dirt

Soil Sample #6: taken at 8.30 m. (Rocky soil)

Hole - 40 cm width

Year 2003 Trench/Locus B603
(end B601)

Excavator SZP

Elevations

Benchmark used:

Reading on 363

Benchmark: 3.964

H.I.: 367.734

start elevations B603

1. (3.147) 364.587
2. (3.352) 364.382
3. (3.466) 364.268
4. (3.662) 364.072
5. (4.942) 362.792
6. (4.681) 363.053
7. (4.550) 363.184
8. (3.847) 363.887
9. (3.765) 363.969
- 10 (3.007) (north stone)
- 11 (3.168) (middle stone)
12. (3.284) South stone

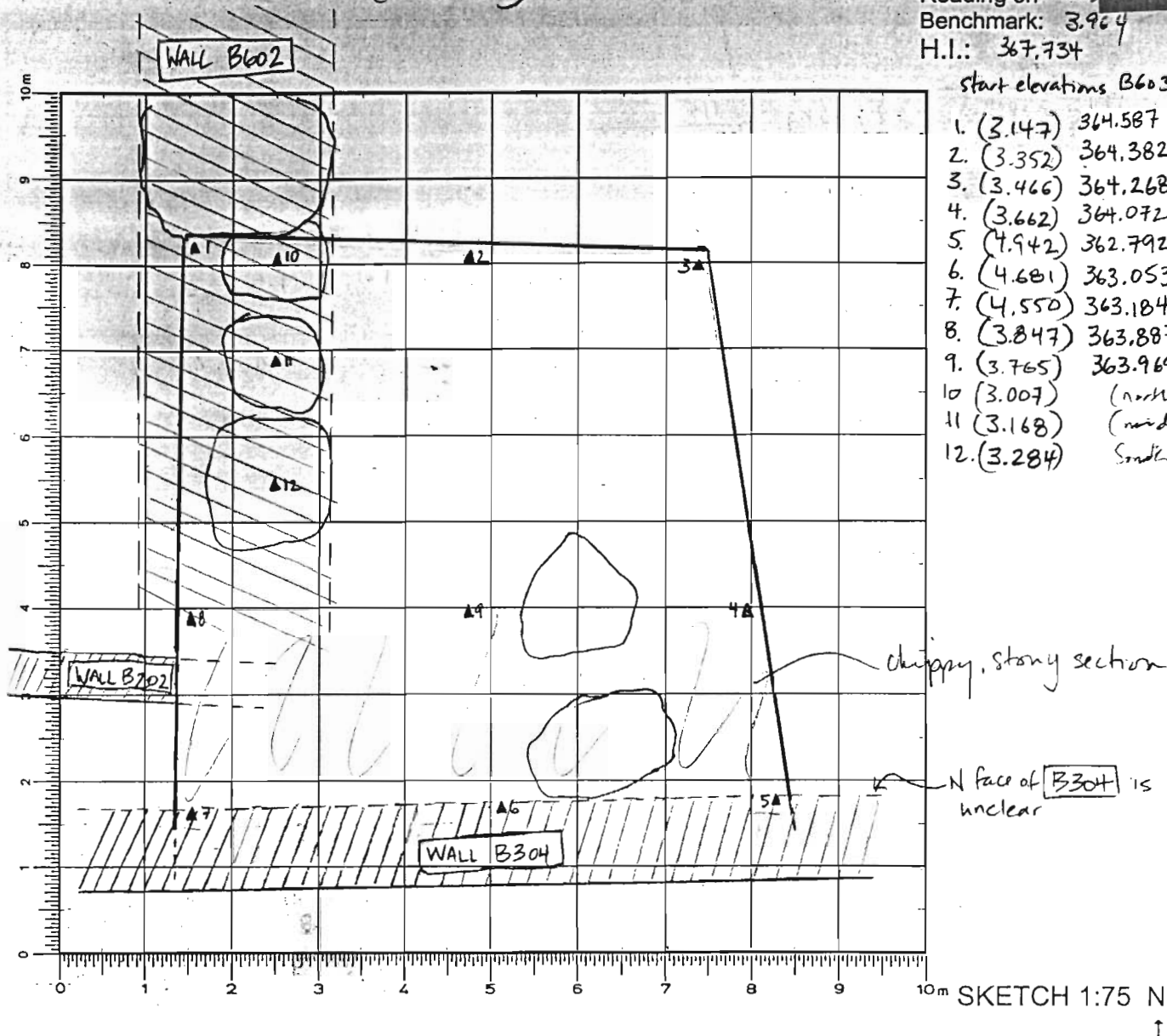

DEFINITION/DESCRIPTION of LOCUS (explain why you changed locus numbers):

Today's date: JUNE 3/03 Locus above: B601

Locus parameters: Same as B601 (with added extensions)

Verbal description: Soil is a dark reddish brown, moist and heavy but still friable → many stone inclusions, ranging from small to medium sized stones. South section of trench filled with fist-sized to medium stones ⇒ chippy bedrock. N-S wall (B602) along west bank comprised of large bedrock boulders. Two especially large boulders (tumble) in south section

Locus Interpretative Comments (What do you think this is? DATE your comments, continue on additional pages if necessary): This stratum most likely contains some topsoil (as initial pass was shallow)

AZORIA Project

p.2

Year 2003 Trench/Locus B603 Excavator SZP

Locus/Pottery Pail Number	Weight of Sherds	Number of Sherds	Chronology & Comments
✓ B603.1 (2 bags)	2.845kg	118	
✓ B603.2	3.070kg	215	
✓ B603.3	2.250 kg	158	Hellenistic, Archaic
✓ B603.4	0.535 kg	46	Hellenistic, Archaic, LM III C
B603.5	0.080 kg	1	Archaic
B603.6	1.240 kg	211	Hell., Archaic, LG-EO, LM III C
B603.7	1.025 kg	88	Hell., Archaic
B603.8	2.43 kg	152	Hell. Archaic

OBJECTS

Object Number	Associated Pottery Pail	Identification (material/form)	Location	Elevation	Catalogue Number
1	B603.6	loomweight	Screen		

ADDITIONAL COLLECTED MATERIAL

Locus/Pottery Pail Number	Bones	Shell	Carbon	Pumice	Soil Sample	Other (specify)
B603.1	1					
B603.1	1 - 1/4" screen	1/4" screen	1 w/ bone (1/4")			
B603.1						1 sea pebble
B603.2	1				1 standard	1 sea pebble
B603.2	1 - 1/4" screen					
B603.3	2 (including 1/4")					
B603.4	2 (1 from 1/4")				1 standard	
B603.5	1 - 1/4" empty					
B603.5						
B603.6	2 (incl. 1/4")					
B603.7	2 (incl. 1/4")		W/ bone		1 standard	
B603.8	2 (incl. 1/4")					

Year 2003 Trench/Locus B603 Excavator SZP

DESCRIPTION of PROGRESS of EXCAVATION [date each entry and identify associated pottery pail(s)]:

June 3/03: Began pass from the north, working south towards wall B304. Pottery bag is B603.1. Some BONE found. 100% screening begun ($\frac{1}{4}$ ").
 The $\frac{1}{4}$ " screening found pottery (put in main pottery bag), carbon, BONE. Day's excavation ended one meter from the North bank. Soil is heavier (with moisture) but friable and with many little inclusions. Lots of pottery (mostly coarseware with some painted fine ware). One sea pebble found in $\frac{1}{4}$ " screen.

June 4/03: Continued with excavation of B603. Pottery pail is B603.2. BONE found (also $\frac{1}{4}$ " BONE). One sea pebble found in north B603. Soil is still damp but relatively easy to dig. There was some deteriorated clay (no sample taken) found along the SE corner of wall B602. Pottery is mostly coarseware with some fine ware. Found dark grey clay like soil along the SE area of wall B602. Definition of B602 on the west produced a lighter brown soil patch. Screening of the soil from the Southern half of the trench yields significantly less in terms of finds \rightarrow but this portion of the trench is mostly wash mixed with the chippy bedrock layer.

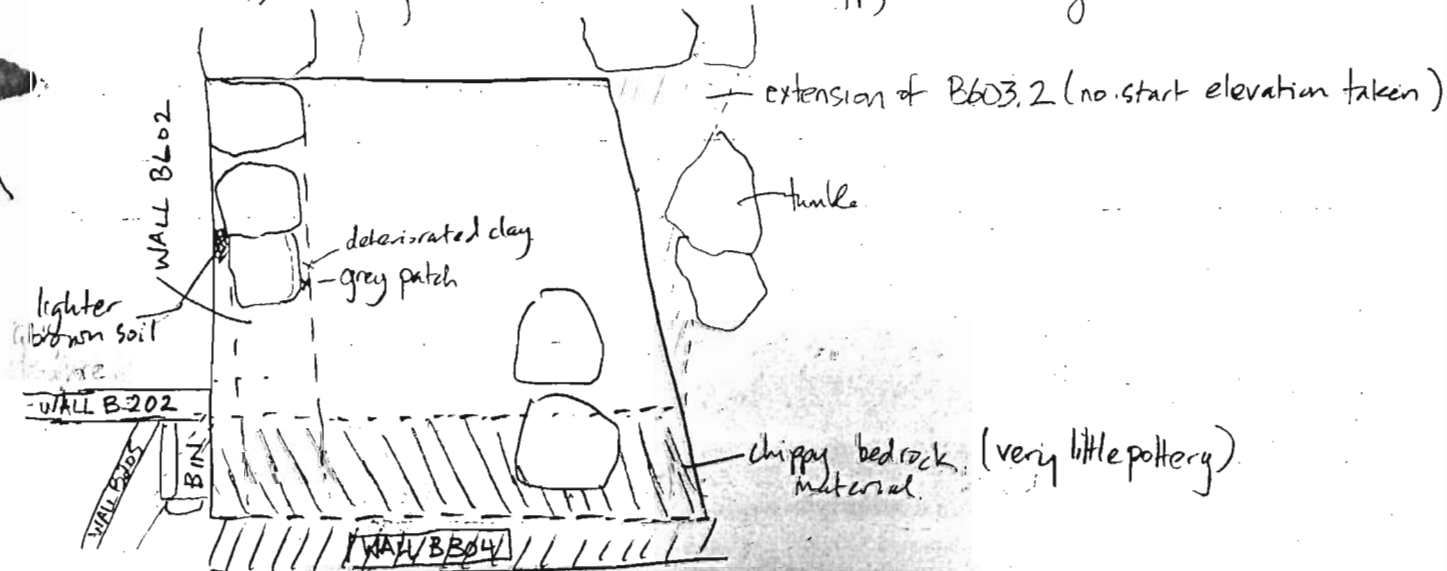

Excavation of extension of trench in the NE corner eastward and defined by the very large bedrock stones \rightarrow see sketch above. \rightarrow pottery collected in pail B603.2 - note: this pass includes topsoil as extension was taken down in a single pass to the level of B603.

5/JUNE/03

Year

Trench/Locus

END B603

Excavator

SZP

DESCRIPTION of PROGRESS of EXCAVATION [date each entry and identify associated pottery pair(s)]:

END ELEVATIONS

→ not including extension to N.

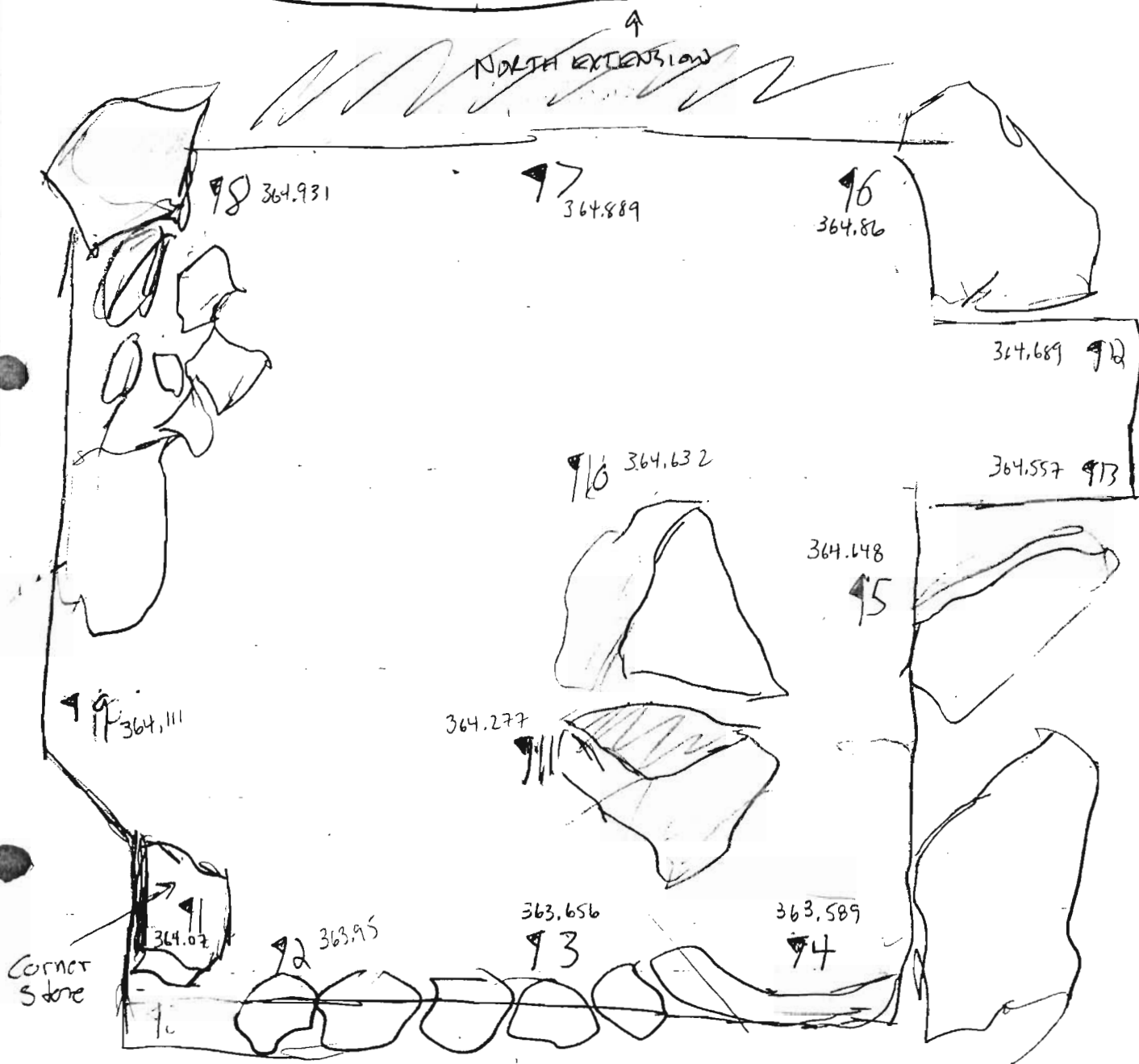

END ELE

Bench = 4.769

HI = 368.539

91 = 4.469 98 = 3.808

92 = 4.589 99 = 4.488

93 = 4.883 (363.656) 910 = 3.907 (364.632)

94 = 4.950 911 = 4.268 (364.597)

95 = 3.891 912 = 3.850

Description → No Picture taken of this ~~locus~~ locus. There is no indication of anything ~~noteworthy~~ noteworthy in the soil deposits. The East and West walls (East Wall is) create the boundaries of the Trench (probably trench) which continues up into the Northern Extension. The Southern wall

6/JUNE/03

Year

Trench/Locus

B603

Excavator

SZP
(AKA DOB)

Elevations

Benchmark used: R5

Reading on

Benchmark:

H.I.: 367.682

End Elevations:

Bench: 3.912

P1: (2.998) 364.684

P2: (2.789) 364.893

P3: (2.184) 365.498

P4: (2.500) 365.182

P5: (2.688) 364.994

P6: (2.606) 365.076

P7: (2.963) 364.719

P8: (3.456) 364.227

P9: (2.895) 364.787

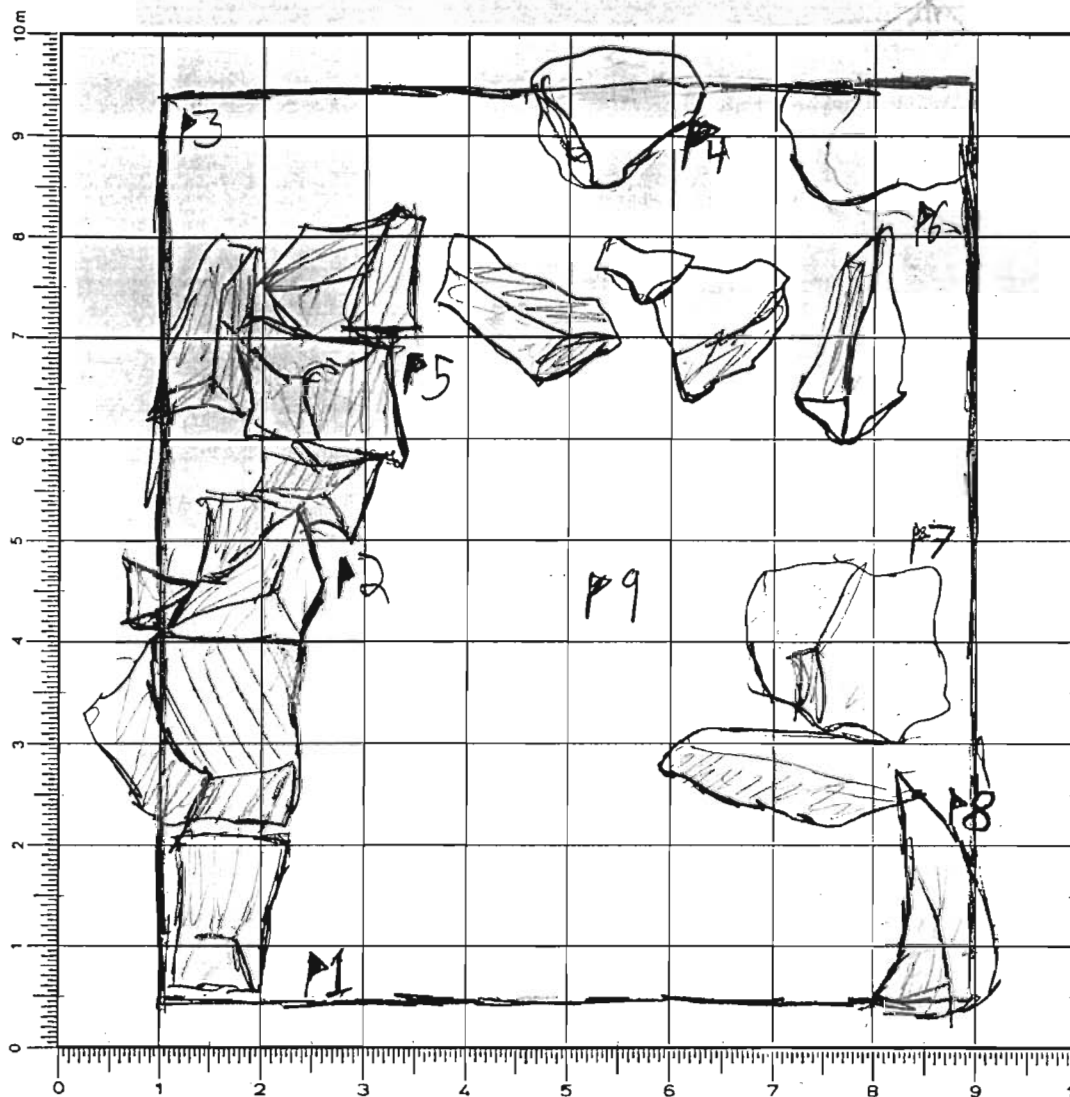

SKETCH 1:75 N

↑

DEFINITION/DESCRIPTION of LOCUS (explain why you changed locus numbers):

Today's date:

Locus above:

Locus parameters:

Verbal description:

Locus Interpretative Comments (What do you think this is? DATE your comments, continue on additional pages if necessary):

Year 2003 Trench/Locus B603 Excavator SZP

DESCRIPTION of PROGRESS of EXCAVATION [date each entry and identify associated pottery pail(s)]:

June 5/03: Start elevations for northern extension taken. Excavation of B603 from south to north → in order to bring the entire trench (B600 - with all the extensions) to the same level. Pottery is collected in pail B603.3. Lots of pottery (coarseware mostly). Excavation halted due to rain.

June 6/03: Continued excavation of B603. Pottery pail is B603.4. Standard soil sample taken from northern extension. Pass completed. B600 north extension extended further north → 2nd pass pottery is collected in pail B603.5. Pass completed → very little pottery. Soil is very loose → Bay's dump?

100%

1/4" Screening

B603.4

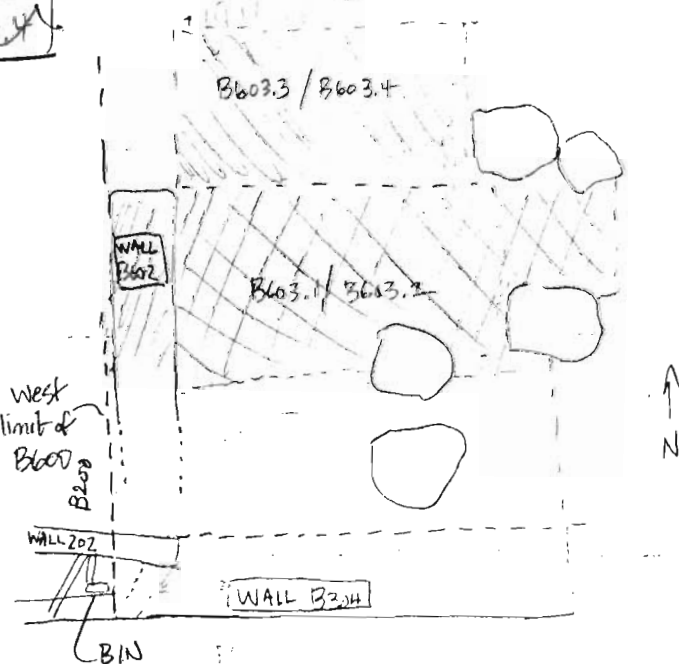

June 23/03: pass of extension (pail is B603.6) - deeper pass (ca. 15-20 cm deep). Many small to medium sized stones. Soil is deep red-brown and loose.

Year 2003 Trench/Locus B603 Excavator SZP

DESCRIPTION of PROGRESS of EXCAVATION [date each entry and identify associated pottery pail(s)]:

June 24 / 03

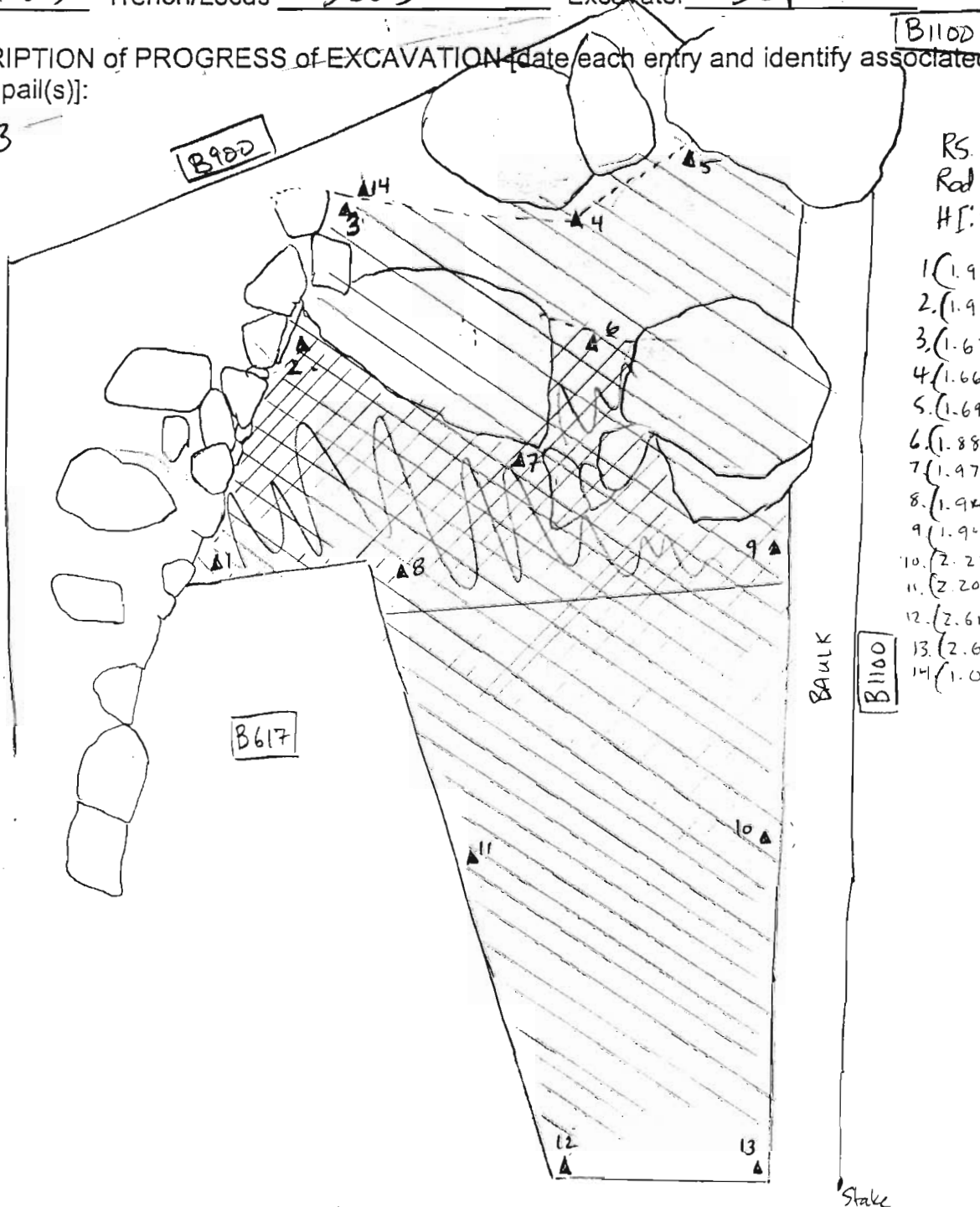

RS. 363.77
 Rad 2.481
 H[] = 366.757

- 1 (1.912) 364.839
- 2 (1.966) 364.785
- 3 (1.639) 365.112
- 4 (1.666) 365.085
- 5 (1.693) 365.058
- 6 (1.881) 364.87
- 7 (1.972) 364.779
- 8 (1.946) 364.805
- 9 (1.943) 364.808
- 10 (2.271) 364.48
- 11 (2.203) 364.548
- 12 (2.613) 364.138
- 13 (2.695) 364.056
- 14 (1.061) 365.690

continued pass from previous day - pail B603.7 - continuing to expose wall
 stones (possible connection to Courser found in B1100 north extension).

June 26 / 03

B603.8

100% 1/4"
 screening

Year 2003 Trench/Locus B604Excavator SZPElevations

Benchmark used:

Reading on

Benchmark:

H.I.:

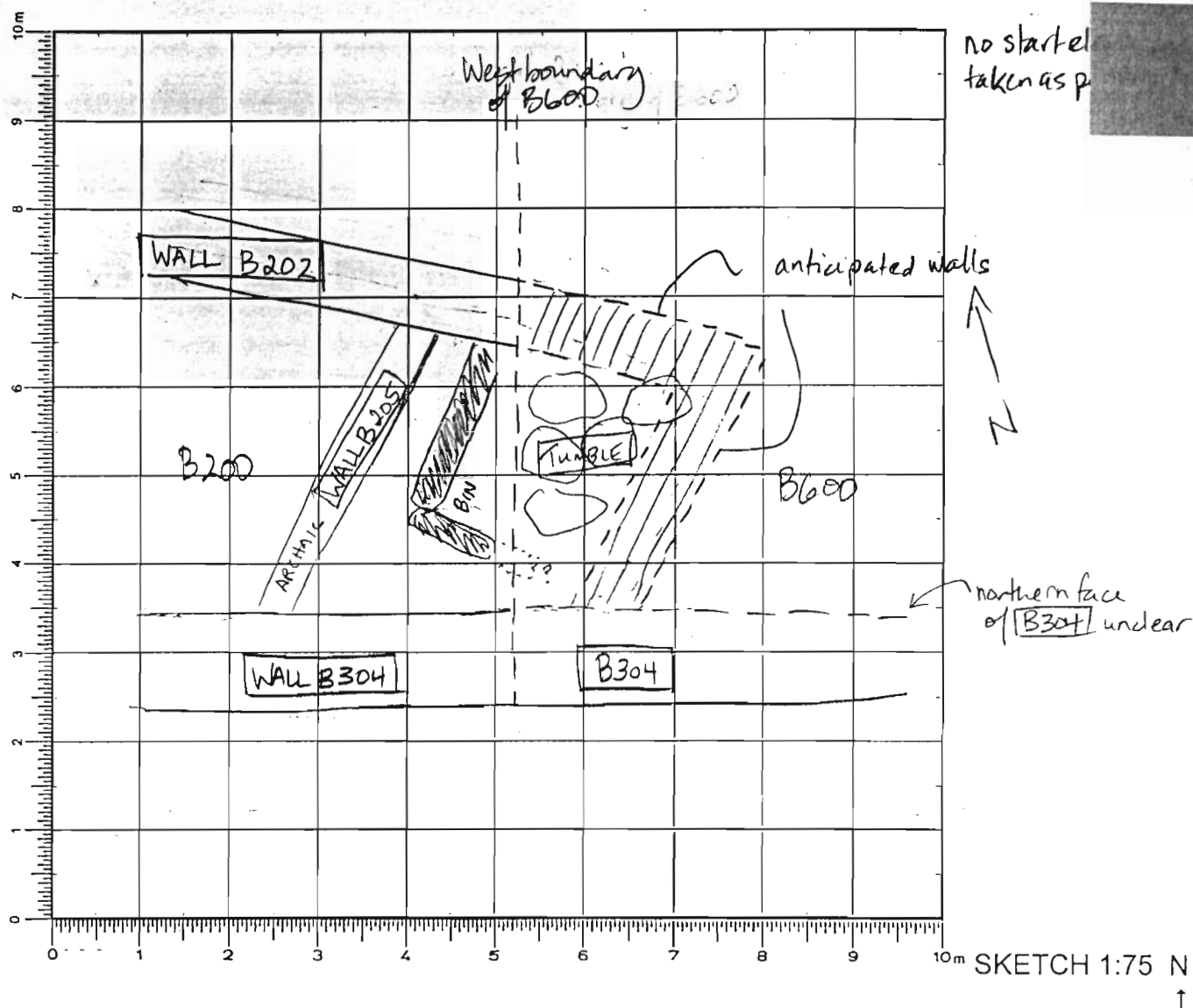

DEFINITION/DESCRIPTION of LOCUS (explain why you changed locus numbers):

Today's date: June 4 /03Locus above: B603Locus parameters: Bounded by WALL B304 in the south, west limit of B600, and extrapolated east extension of WALL 202 and projected wall southward.

Verbal description:

This locus is filled with medium to large stones (ca. 40-60cm).
 A few of the stones seem to align with WALL B202. Soil is loose

Locus Interpretative Comments (What do you think this is? DATE your comments, continue on additional pages if necessary):

This locus is most likely tumble but some large stones seem to align with WALL B202. The easternmost stone may act as a corner stone for WALL 202 extension and wall which runs parallel with WALL 205

[illegible]

OBJECTS

[illegible]

ADDITIONAL COLLECTED MATERIAL

[illegible]

Year 2003 Trench/Locus B604 Excavator SJP

DESCRIPTION of PROGRESS of EXCAVATION [date each entry and identify associated pottery pail(s)]:

June 4/03: Excavation of the SW corner of B600 → parameters are bounded by expected/extrapolated walls associated with the archaic bin wall in NE corner of B200 (re: WALL B205). Tumble was removed in a single pass (ca. 20cm - 25cm deep) in the hopes of exposing an eastern extension of WALL 202. Pottery was collected in pail B604.1. Bone was found. No start elevations taken (as per directors) and no photos.

$\frac{1}{4}$ 100%
Screening

An eastern extension of Wall B202 was exposed. A linear configuration of medium sized stones runs to the southwest from the eastern end of Wall B202 (parallel to WALL B205) soil sample

Intensive soil sample taken. → no standard taken (small area).

Pass completed and end elevations taken → no photos?

Year 2003 Trench/Locus B605Excavator SZP**Elevations**Benchmark used: R5Reading on 3.983

Benchmark:

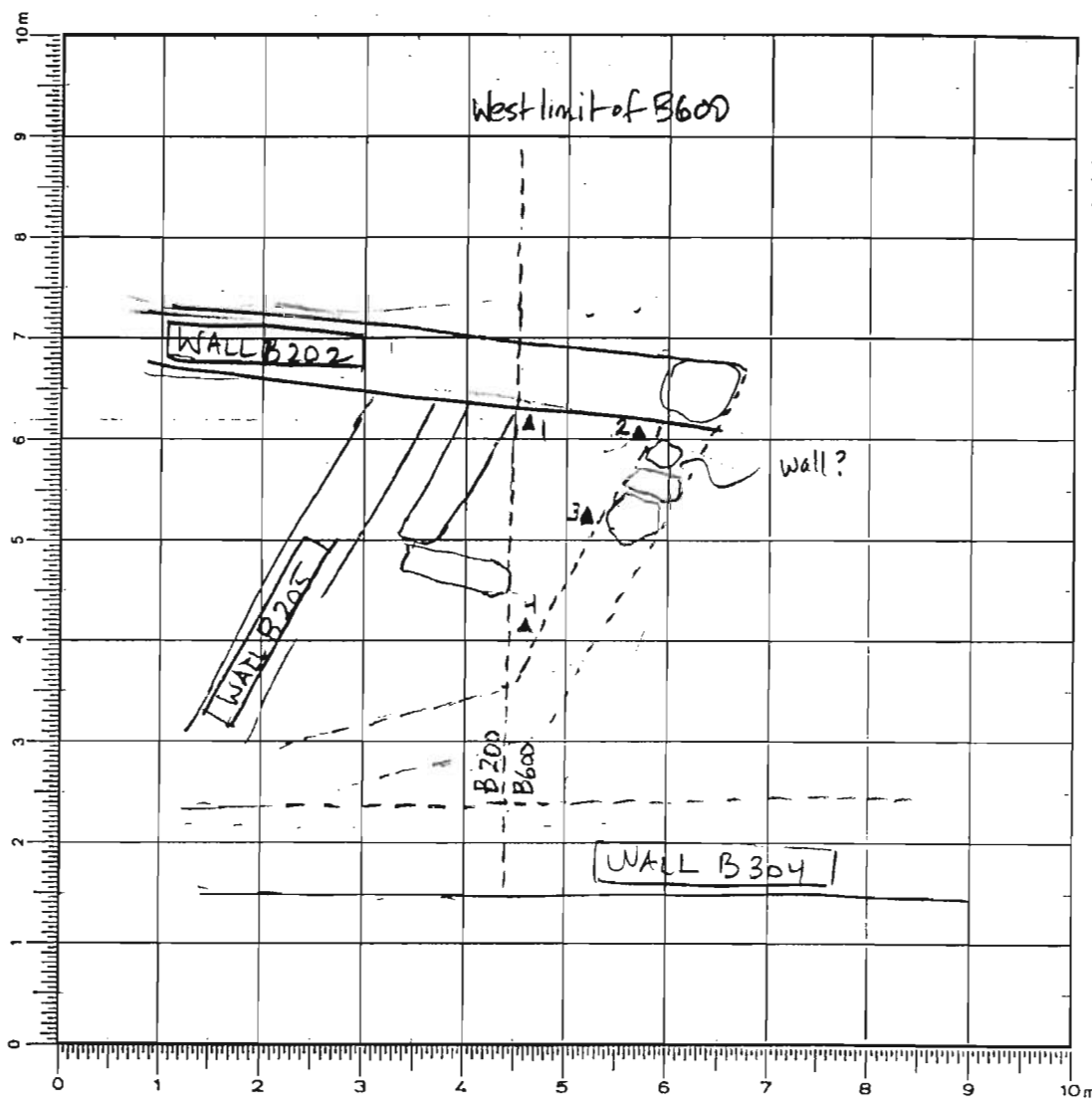
H.I.: 367.753**Start Elevations**

1. (4.660) 363.093
2. (4.631) 363.122
3. (4.674) 363.079
4. (4.739) 363.014

SKETCH 1:75 N
↑

DEFINITION/DESCRIPTION of LOCUS (explain why you changed locus numbers):

Today's date: June 4 / 03 Locus above: B604Locus parameters: Same as B604

Verbal description: Matrix is filled with small to medium stones (a few large stones)
 Possible linear configuration of stones running roughly north-south
 along the ~~west~~ eastern side of locus may be a wall. Soil is still
 relatively loose
 roughly parallel to wall B205

Locus Interpretative Comments (What do you think this is? DATE your comments, continue on additional pages if necessary):

[illegible]

OBJECTS

[illegible]

ADDITIONAL COLLECTED MATERIAL

[illegible]

Year 2003 Trench/Locus B605 Excavator SZP

DESCRIPTION of PROGRESS of EXCAVATION [date each entry and identify associated pottery pail(s)]:

June 4/03 : new locus created as we are reaching the end level of B200 (floor surface?). Pottery pail is B605.1. Bone found intensive Screening. Soil sample taken. Soil is relatively loose — matrix is very friable. Stones in the east end of locus will be left (possibility of wall) for further investigation. — no sign of east side of bin.

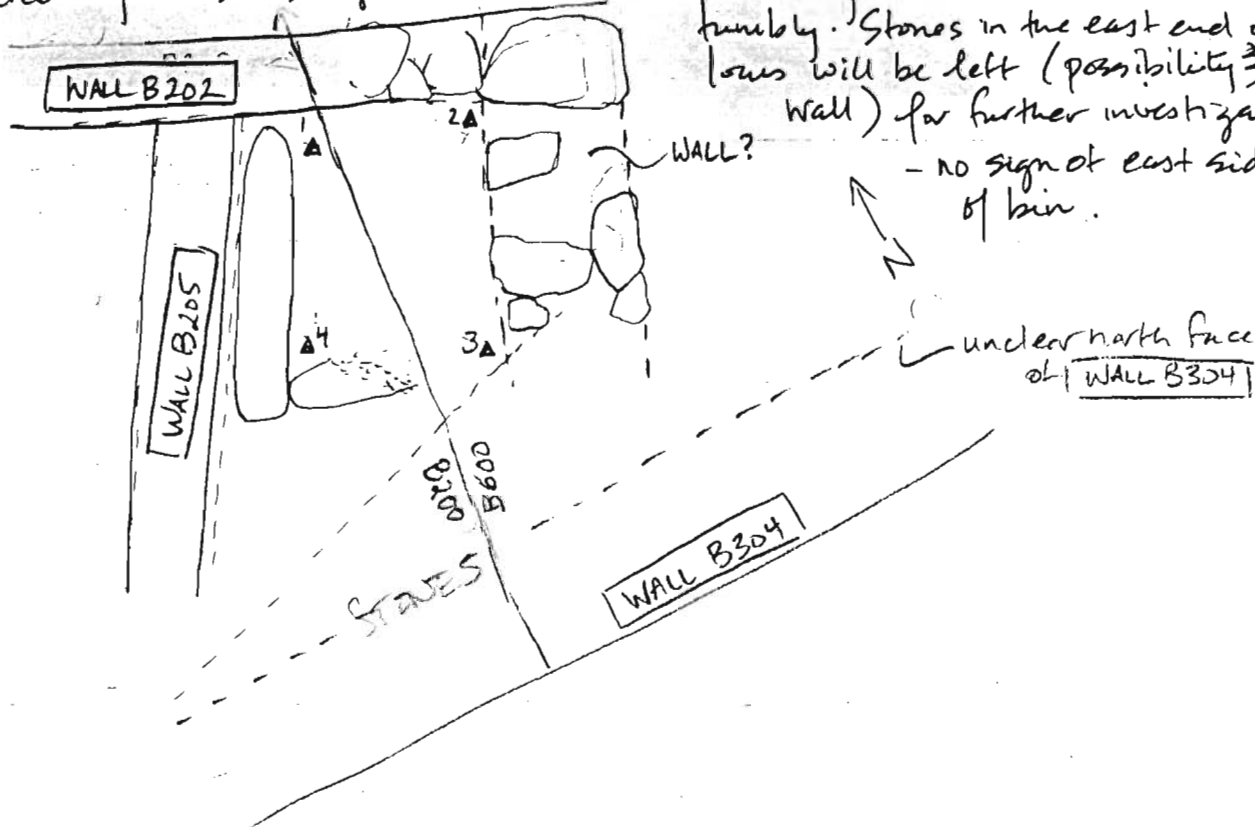

End elevations for B605.1

1. (4.714) 363.032
2. (4.690) 363.056
3. (4.776) 362.97
4. (4.745) 363.001

R5

Rod: 3.976

HI 367.746

Year 2003 Trench/Locus B606 Excavator SZP**Elevations**Benchmark used: R5

Reading on

Benchmark: (3976)

H.I.:

Start elevations

1. (4.714)
2. (4.690)
3. (4.776)
4. (4.745)

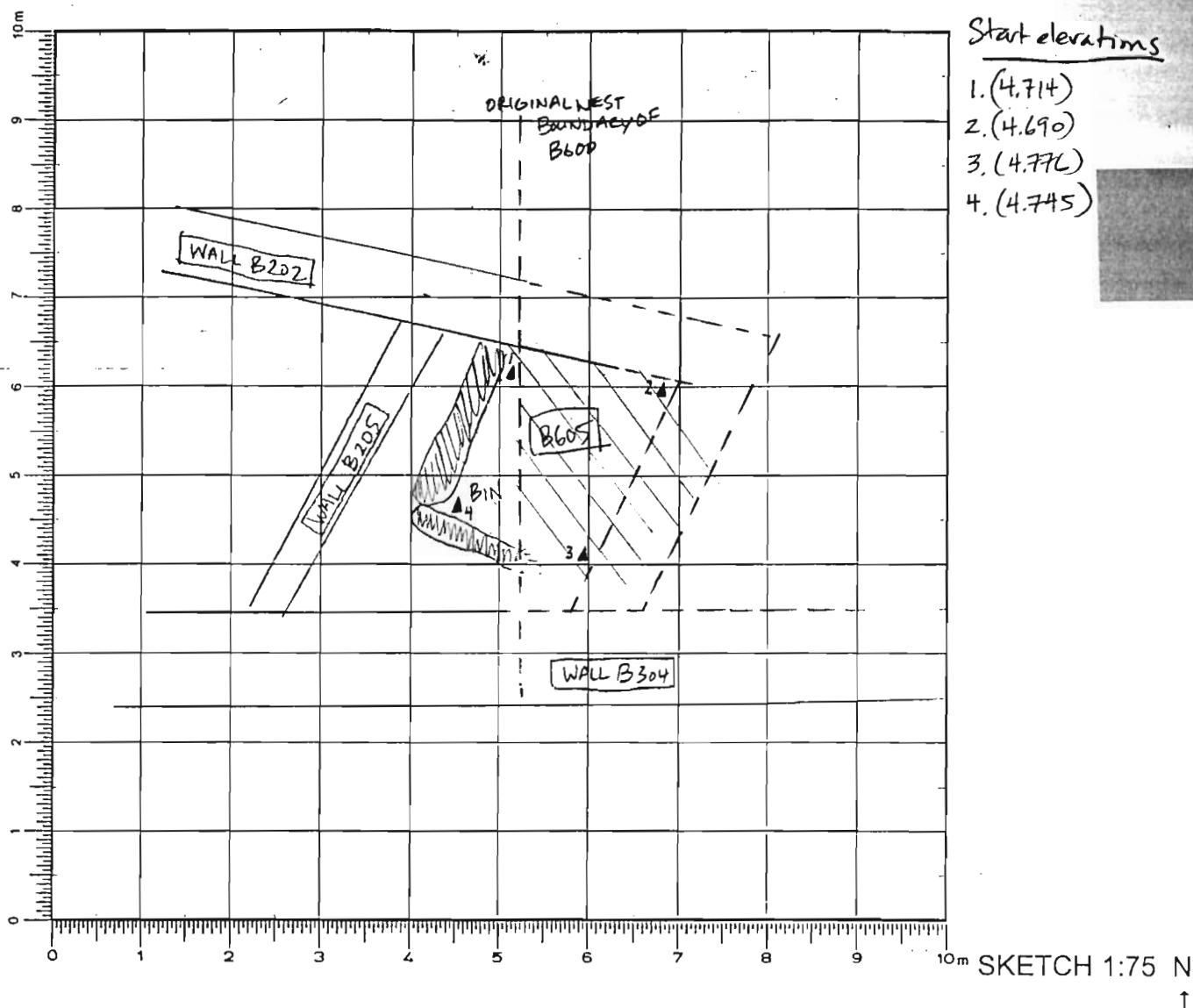

DEFINITION/DESCRIPTION of LOCUS (explain why you changed locus numbers):

Today's date: June 4/03 Locus above: B605Locus parameters: Same as B605

Verbal description: matrix is still characterized by small to medium angular stones - ~~more compact~~ but soil is much more compact. There are stones in the east end of locus which may potentially be the east wall of the bin area (parallel to B205).

Locus Interpretative Comments (What do you think this is? DATE your comments, continue on additional pages if necessary):

[illegible]

OBJECTS

[illegible]

ADDITIONAL COLLECTED MATERIAL

[illegible]

Year 2003 Trench/Locus B606 Excavator SZP

DESCRIPTION of PROGRESS of EXCAVATION [date each entry and identify associated pottery pail(s)]:

June 4/03: Start elevations taken. No photos. Excavation to begin tomorrow.

June 5/03: Very thin pass of bin area in order to better define the Southern Stone of bin and the potential NE-SW wall. The soil within the bin itself will not be excavated in this pass.

HI = 4.214

Δ1 = 4.342

Δ2 = 4.528

Δ3 = 4.694

Δ4 = 4.748

Δ5 = 4.614

Δ6 = 4.987

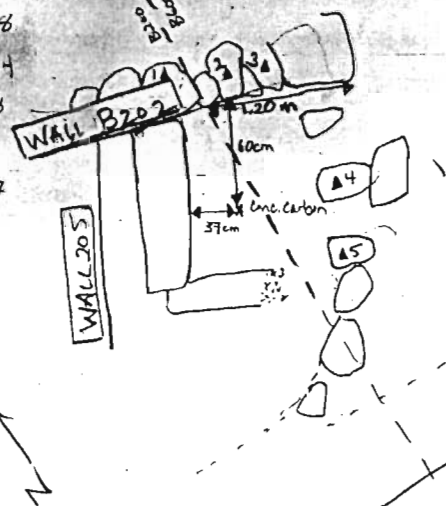

Wall elevations for east extension of B202

R5 363.77

Rod: 4.214

HI: 367.984

1. (4.342) 363.642

2. (4.528) 363.456

3. (4.694) 363.29

4. (4.748) 363.236

5. (4.614) 363.37

(Carbon) 6. (4.987) 362.997

pottery to be collected in pail B606.1
concentration of carbon found (ca. 37cm from west bin stone and ca 60cm from south face of WALL B202) → excavation halted due to rain.
(elevation of carbon: (4.987) =

June 6/03: excavation of B606 to continue. Pottery pail is B606.2

concentration of carbon was small but some chunks were taken as a sample. Elevations (end of B606.2).

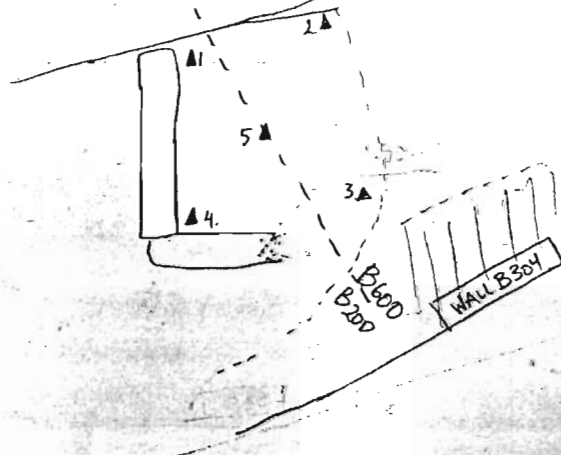

R5 363.77

Rod: 4.115

HI 367.885

1. (4.882) 363.003

2. (4.878) 363.007

3. (4.924) 362.961

4. (4.900) 362.985

5. (4.905) 362.98

Year 2003 Trench/Locus 607Excavator SZP**Elevations**

Benchmark used:

Reading on

Benchmark:

H.I.:

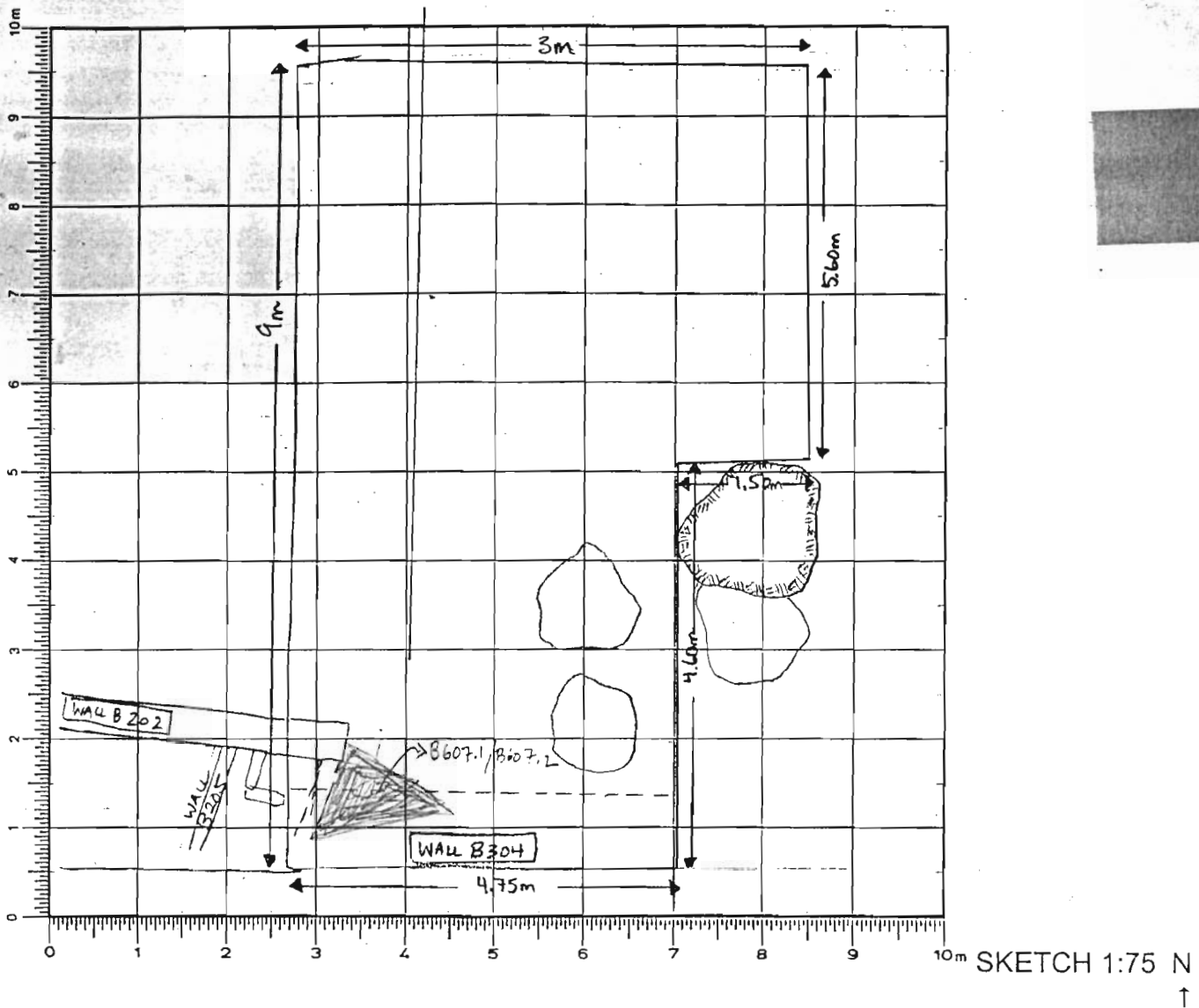

DEFINITION/DESCRIPTION of LOCUS (explain why you changed locus numbers):

Today's date: June 5/03 Locus above: B603

Locus parameters: includes original trench B600 and north extension and east extension.

Verbal description:

Locus Interpretative Comments (What do you think this is? DATE your comments, continue on additional pages if necessary):

AZORIA Project

Year 2003 Trench/Locus B607 Excavator SJP

p.2

Locus/Pottery Pail Number	Weight of Sherds	Number of Sherds	Chronology & Comments
B607.1	0.010kg	4	Archaic/NPD
B607.2			(empty)
B607.3	0.485kg	37	Archaic
B607.4	1.500kg	197	Archaic
B607.5			(empty)

OBJECTS

Object Number	Associated Pottery Pail	Identification (material/form)	Location	Elevation	Catalogue Number
1	B607.3	stone tool	0.55 m from B602 5.15 m from B304	364.132 m asl	

ADDITIONAL COLLECTED MATERIAL

Locus/Pottery Pail Number	Bones	Shell	Carbon	Pumice	Soil Sample	Other (specify)
B607.1	1-1/4"					
B607.2	1 (1/4" screen) empty					
B607.3	2 (including 1/4")					
B607.4	2 (1 from 1/4")		1			
B607.5	1 1/4 empty				1562	

Year 2003 Trench/Locus B607 Excavator S2P

DESCRIPTION of PROGRESS of EXCAVATION [date each entry and identify associated pottery pail(s)]:

June 5/03: Cleaning/defining of stones extending north of wall B304 in the southwest corner of B600. Purpose was to help clarify the area of the bin in B200. This is the only part of B607 being excavated for the moment. Pottery pail B607.1.
 100%
 1/4" screening
 The north face of B304 seems to be defined. Excavation halted due to rain.

June 6/03: Swept and cleaned excavated area (from previous day). Pottery pail is B607.2. No pottery found.

Continued excavation of B607 north of east extension Wall B202. Pottery pail is B607.3. → to be separated from ^{middle of} southern south of wall extension B202.
 Stone tool → Object #1 - 0.55 m from east face of B602; 5.15 m from south face of B304; R5 Rod (4.114)

- Elevation (bottom) = (3.752)

* removed medium sized bumpy from south end; new pottery pail assigned for area enclosed by series of stones running E-W along the south, wall B602 along the west, ...

pail is B607.4

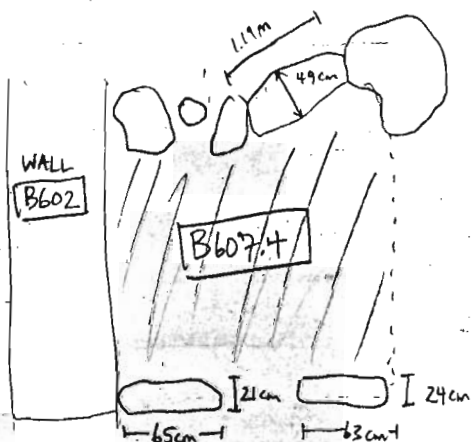

* note: B607.4 = B609.1

Year 2003 Trench/Locus B607 Excavator SZP

DESCRIPTION of PROGRESS of EXCAVATION [date each entry and identify associated pottery pail(s)]:

June 9/03: Sweeping and cleaning of B607 — Standard soil
(100% screening) Sample taken. — pottery pail is B607.5 — no pottery collected.
— 1 standard soil sample taken.

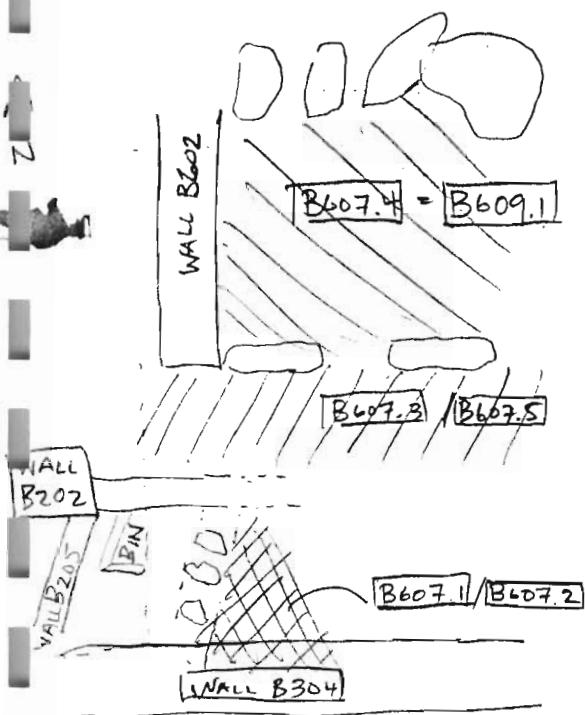

Year 2003 Trench/Locus B608 Excavator S2P**Elevations**Benchmark used: R5

Reading on

Benchmark: (4.115)H.I.: 367.885**START ELEVATIONS**

1. (4.882) 363.003
2. (4.878) 363.007
3. (4.924) 362.961
4. (4.900) 362.985
5. (4.905) 362.980

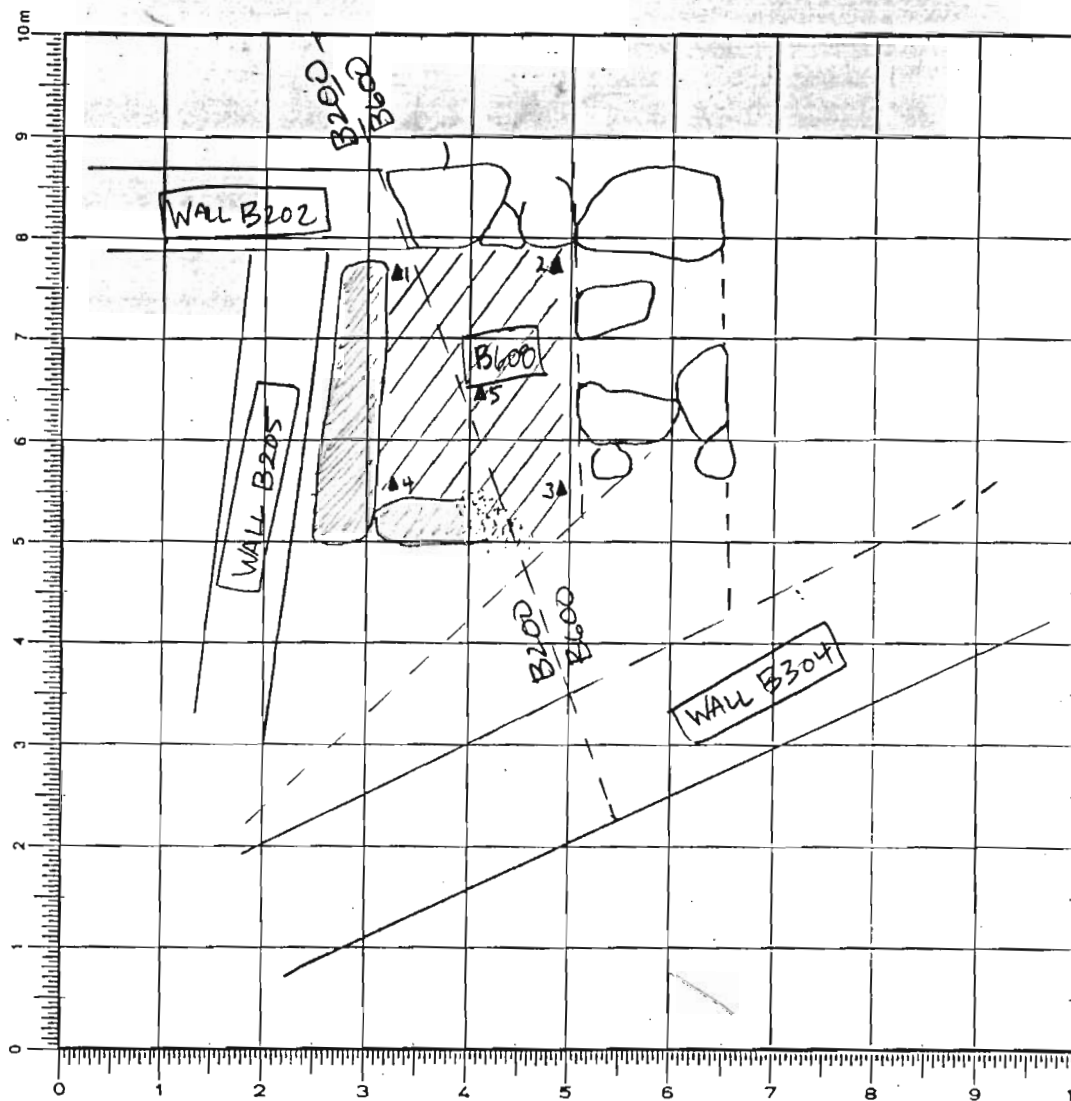
10m SKETCH 1:75 *NI*

DEFINITION/DESCRIPTION of LOCUS (explain why you changed locus numbers):

Today's date: June 6/03Locus above: B606Locus parameters: 8 now extends to include bin from B200

Verbal description:

Locus Interpretative Comments (What do you think this is? DATE your comments, continue on additional pages if necessary):

[illegible]

OBJECTS

[illegible]

ADDITIONAL COLLECTED MATERIAL

[illegible]

AZORIA Project

p. _____

Year 2003 Trench/Locus B608 Excavator Szp

DESCRIPTION of PROGRESS of EXCAVATION [date each entry and identify associated pottery pail(s)]:

June 6/03: Excavation of contents of bin. Intensive soil sample will be taken. Some bits of charcoal found along west stone of bin. Pottery will be collected in B608.1. Bone found; intensive soil sample taken.

Year 2003 Trench/Locus B609 Excavator SEP**Elevations**

Benchmark used:

Reading on

Benchmark:

H.I.:

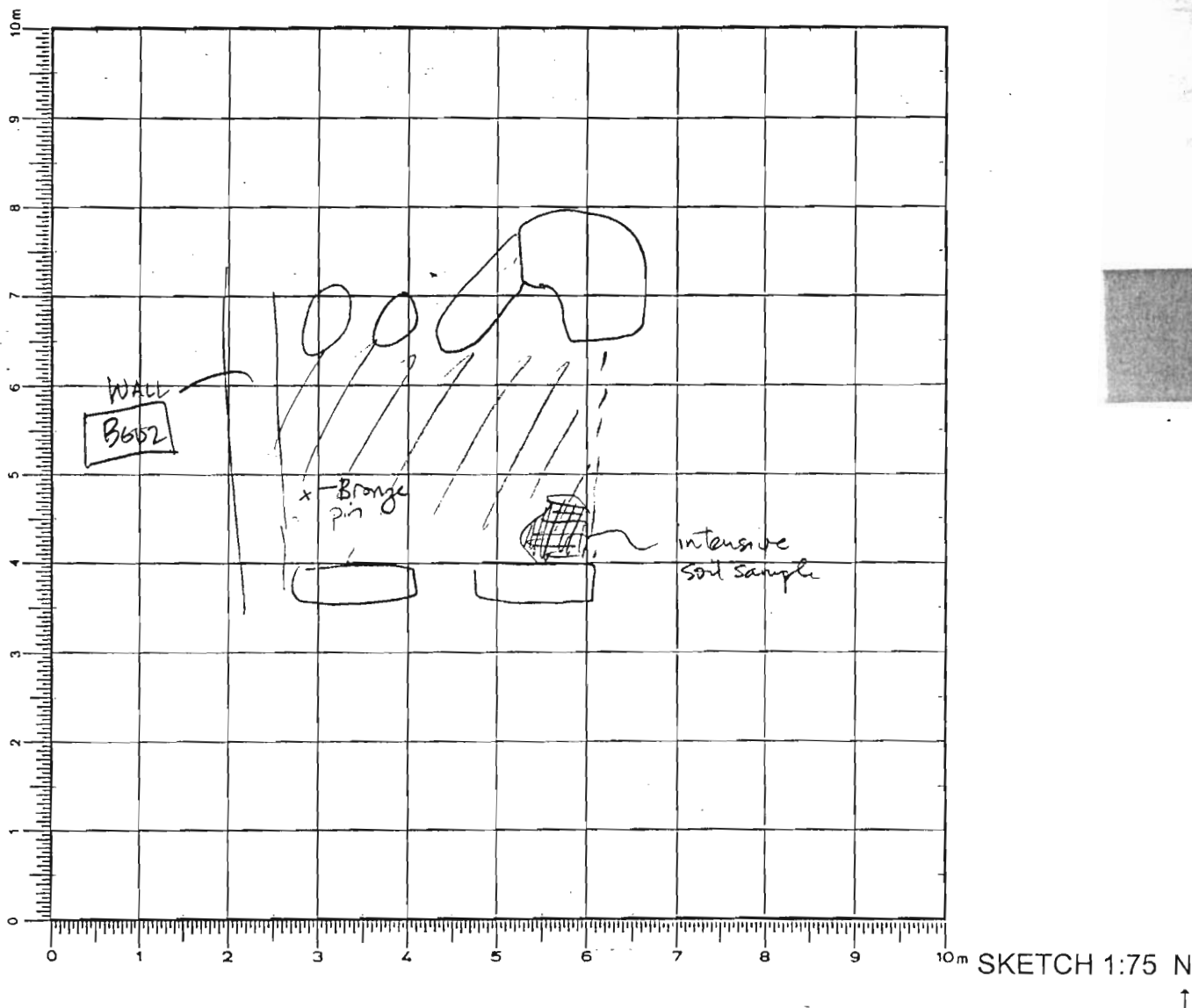
DEFINITION/DESCRIPTION of LOCUS (explain **why** you changed locus numbers):Today's date: June 9/03 Locus above:

Locus parameters:

Verbal description: — area enclosed by N-S wall B609 on the west, linear configuration of stones running E-W on the south, linear config. of stones running E-W on the north, and —

Locus Interpretative Comments (What do you think this is? DATE your comments, continue on additional pages if necessary):

Year 2003 Trench/Locus 609 Excavator SZP

[illegible]

OBJECTS

[illegible]

ADDITIONAL COLLECTED MATERIAL

[illegible]

Year 2003 Trench/Locus B609 Excavator SZP

DESCRIPTION of PROGRESS of EXCAVATION [date each entry and identify associated pottery pail(s)]:

- June 9/03: New locus created - pottery pail B607.4 = B609.1
 100% screening: lots of pottery, bone, some carbon.
 A neck piece from a jug was found along the east face of WALL B602 in the NW corner of locus.
 a bronze pin (ca. 10 cm long) was found along the east face of B602 (ca. 13 cm east of B602; 94 cm from southern limit) — Elevation: R5
Object #1 - BRONZE PIN Rod: 4.164 Elevation: 3.882
 Standard soil sample taken; intensive taken from SE corner; pumice found in screening
 pass B609.1 completed; elevations taken.

END ELEVATIONS: B609

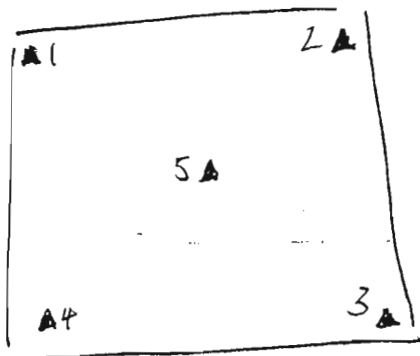

R5 363.77
 Rod: 4.165
 HI: 367.935
 1. (3.698) 364.237
 2. (3.760) 364.175
 3. (3.902) 364.033
 4. (3.916) 364.019
 5. (3.812) 364.123

June 10/03: light cleaning/sweeping for photographs.

June 13/03: cleaning of NE corner of locus after a large stone was pulled out (accidentally of course!).
 a few sherds found - pail B609.2 - cleaning & sweeping
 bone found

Year 2003 Trench/Locus B610 Excavator SPElevations

Benchmark used:

Reading on

Benchmark:

H.I.:

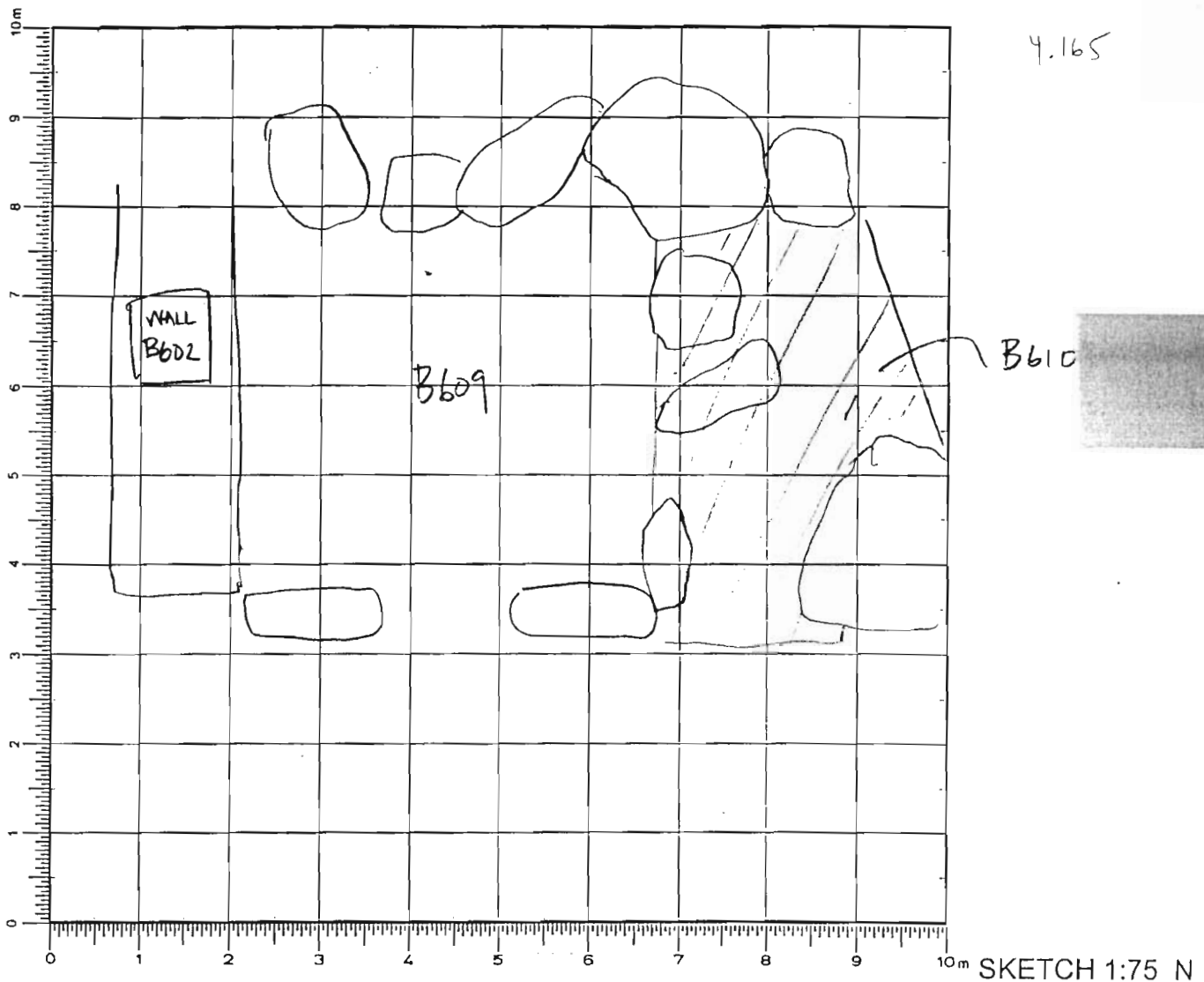

4.165

DEFINITION/DESCRIPTION of LOCUS (explain why you changed locus numbers):

Today's date: June 9/03 Locus above: 603

Locus parameters:

Verbal description:

Locus Interpretative Comments (What do you think this is? DATE your comments, continue on additional pages if necessary):

Year 2023 Trench/Locus B610 Excavator SEP.

DESCRIPTION of PROGRESS of EXCAVATION [date each entry and identify associated pottery pail(s)]:

June 9/03: excavation of B610 in order to define stones on west side

Pail is B610.1.

End elevations

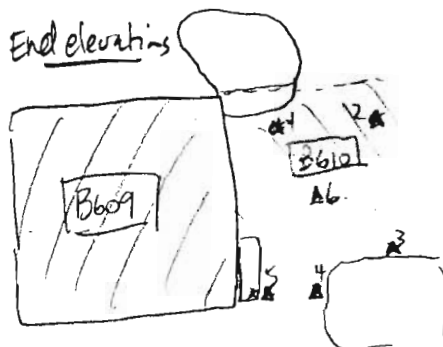

RS 363.77
R00 4.165
H1 367.935

- | | |
|------------|---------|
| 1. (3.857) | 364.078 |
| 2. (3.989) | 363.946 |
| 3. (3.990) | 363.945 |
| 4. (3.959) | 363.976 |
| 5. (3.900) | 364.035 |
| 6. (3.915) | 364.02 |

Year 2003 Trench/Locus B611Excavator SZP**Elevations**

Benchmark used:

Reading on

Benchmark:

H.I.:

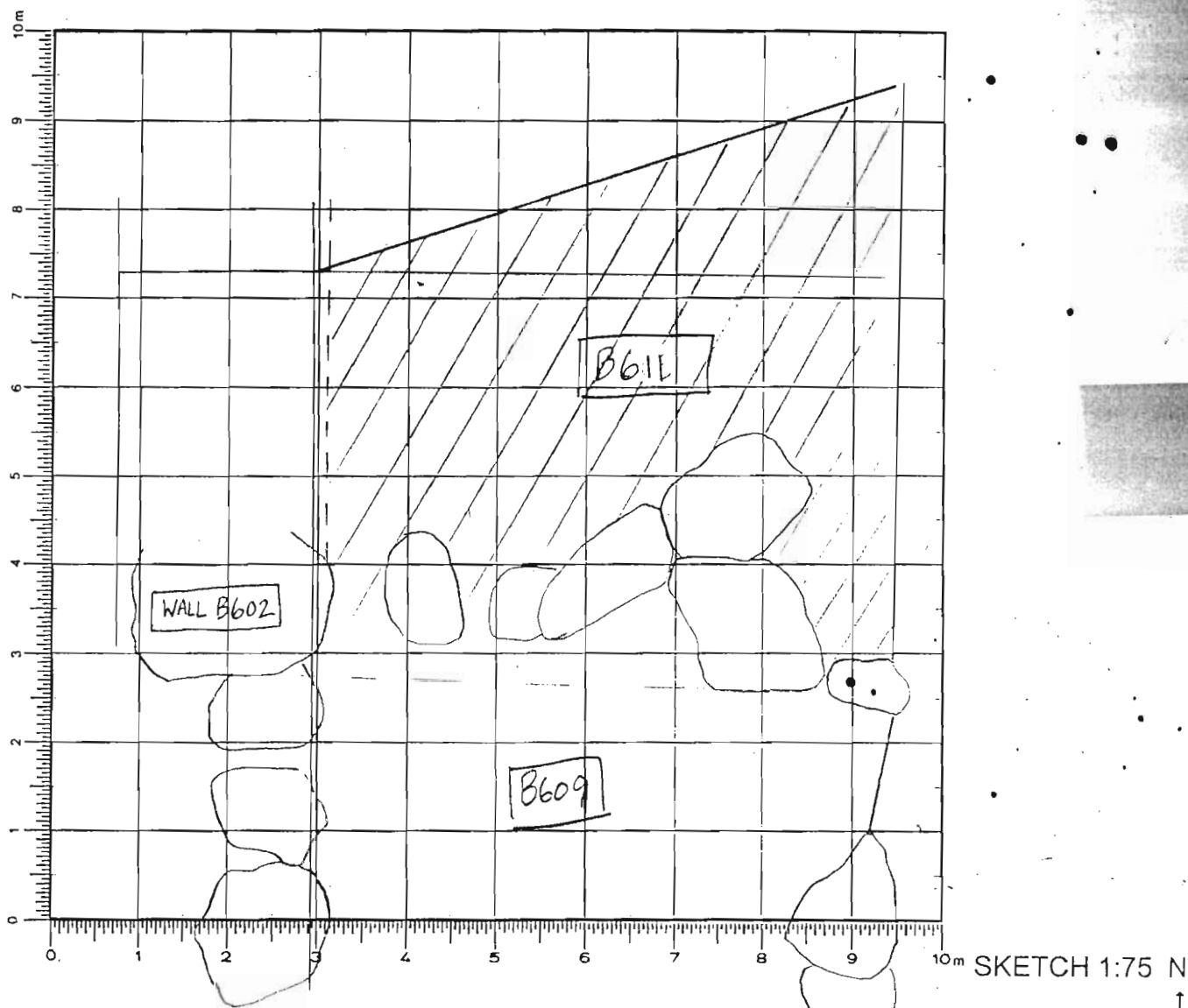
DEFINITION/DESCRIPTION of LOCUS (explain **why** you changed locus numbers):Today's date: June 10/03 Locus above B603Locus parameters: area north of west-east configuration of stones, making the north limit of 609

Verbal description:

Locus Interpretative Comments (What do you think this is? DATE your comments, continue on additional pages if necessary):

Year 2003 Trench/Locus B611 Excavator SZP

DESCRIPTION of PROGRESS of EXCAVATION [date each entry and identify associated pottery pail(s)]:

June 9/03: began a shallow pass (ca. 10cm deep) beginning from the south end towards the north → to define possible lower courses for B602

Object # 1: ceramic disk with possible hole in centre

ca. 1.65m east from B602; 3.20m north of B609

R5

Rod (4.171)

HI: 367.941

Elevation: (3.405) 364.536

100%
1/4" screening



lots of pottery (pail B611.1) and bone (w/ shell)

pass was not completed by day's end

June 10/03: continued excavation → pail B611.2

lots of bone and pottery

Object # 1: alloy ring with anchor design from screening

modern? / silver?

no corrosion



pass completed

END ▲ for B611.2

R5: 363.77

Rod: 4.115

HI: 367.885

1. (3.142) 364.743

2. (3.169)

3. (3.347) 364.538

4. (3.275) 364.61

5. (3.230)

↑
N

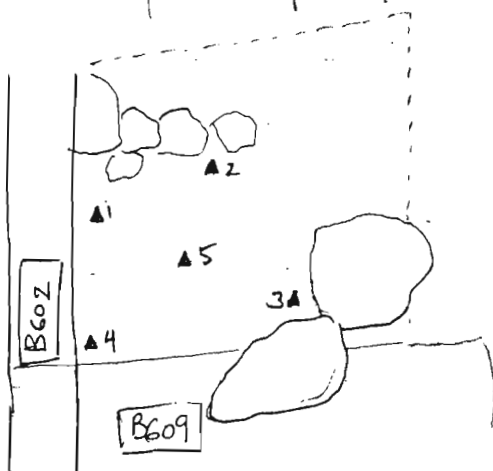

June 10th/03 :

Maria Liston found a spindle whorl on wall [B304] at juncture of west wall (of building south of [B600]) and [B304].

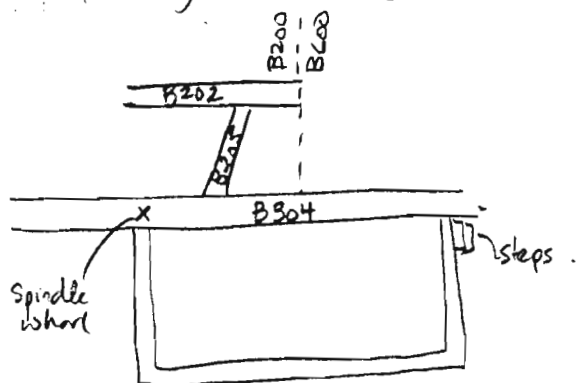

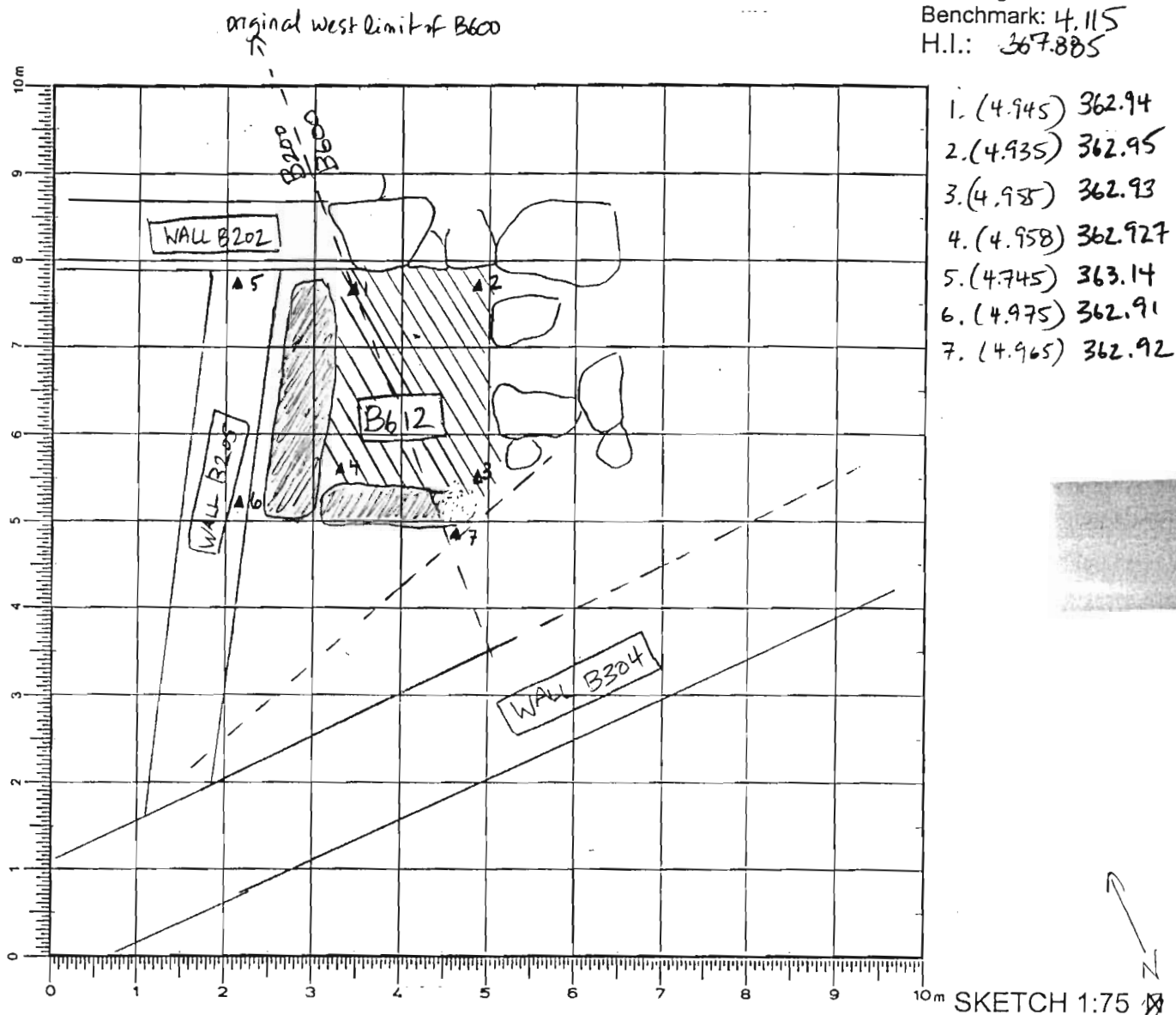
Year 2003 Trench/Locus B612 Excavator SZPElevationsBenchmark used: R5
Reading on
Benchmark: 4.115
H.I.: 367.885DEFINITION/DESCRIPTION of LOCUS (explain why you changed locus numbers):Today's date: June 10/03 Locus above: B608Locus parameters: Bin interior

Verbal description:

Locus Interpretative Comments (What do you think this is? DATE your comments, continue on additional pages if necessary):

[illegible]

OBJECTS

[illegible]

ADDITIONAL COLLECTED MATERIAL

[illegible]

Year 2003 Trench/Locus B612 Excavator SEP

DESCRIPTION of PROGRESS of EXCAVATION [date each entry and identify associated pottery pail(s)]:

June 10/03: new locus to excavate the contents of the bin in B200/B600.
and to define the SE area of the bin. Pottery bag is
B612.1 - not excavated today.
: Start elevations taken

Year 2003 Trench/Locus B613 Excavator S2P

Elevations

Benchmark used:

Reading on

Benchmark:

H.I.:

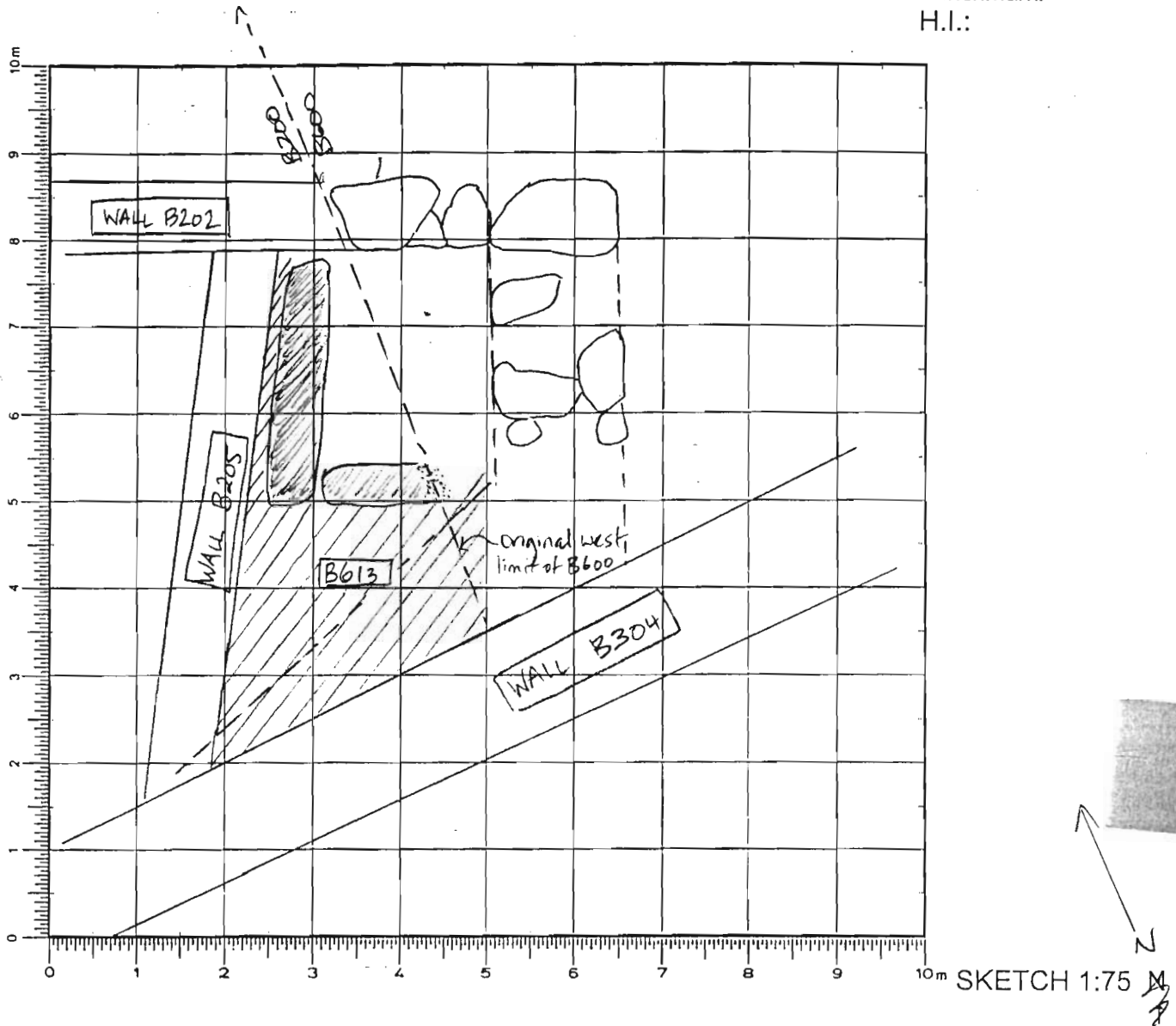

DEFINITION/DESCRIPTION of LOCUS (explain why you changed locus numbers):

Today's date: June 10/03 Locus above: B2 ← ? check crystal's book

Locus parameters: outside bin area

Verbal description:

Locus Interpretative Comments (What do you think this is? DATE your comments, continue on additional pages if necessary):

[illegible]

OBJECTS

[illegible]

ADDITIONAL COLLECTED MATERIAL

[illegible]

Year 2003 Trench/Locus B613 Excavator SZP

DESCRIPTION of PROGRESS of EXCAVATION [date each entry and identify associated pottery find(s)]:

June 10/03: light sweeping for photos → pick up pithos shard
which has been floating there since beginning of season.
pottery find B613.1
! strat elevations taken

Year 2003 Trench/Locus B614 Excavator SZPElevationsBenchmark used:
Reading on
Benchmark:
H.I.:

DEFINITION/DESCRIPTION of LOCUS (explain why you changed locus numbers):

Today's date:

Locus above:

Locus parameters: junction between B202 and WALL B304 - corner

Verbal description:

- removal of rubble

Locus Interpretative Comments (What do you think this is? DATE your comments, continue on additional pages if necessary):

[illegible]

OBJECTS

[illegible]

ADDITIONAL COLLECTED MATERIAL

[illegible]

Year 2003 Trench/Locus B614 Excavator SZP

DESCRIPTION of PROGRESS of EXCAVATION [date each entry and identify associated pottery pail(s)]:

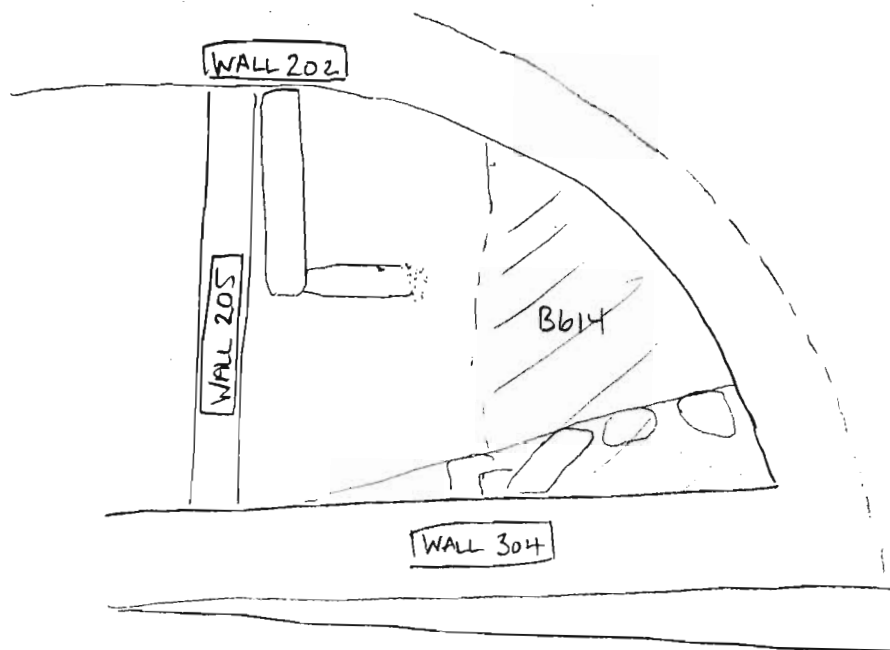

June 10/03: Removal of rubble

: pottery pail B614.1

: bone, pumice

: roofing clay

Year 2003 Trench/Locus B615 Excavator SJP**Elevations**

Benchmark used:

Reading on

Benchmark:

H.I.:

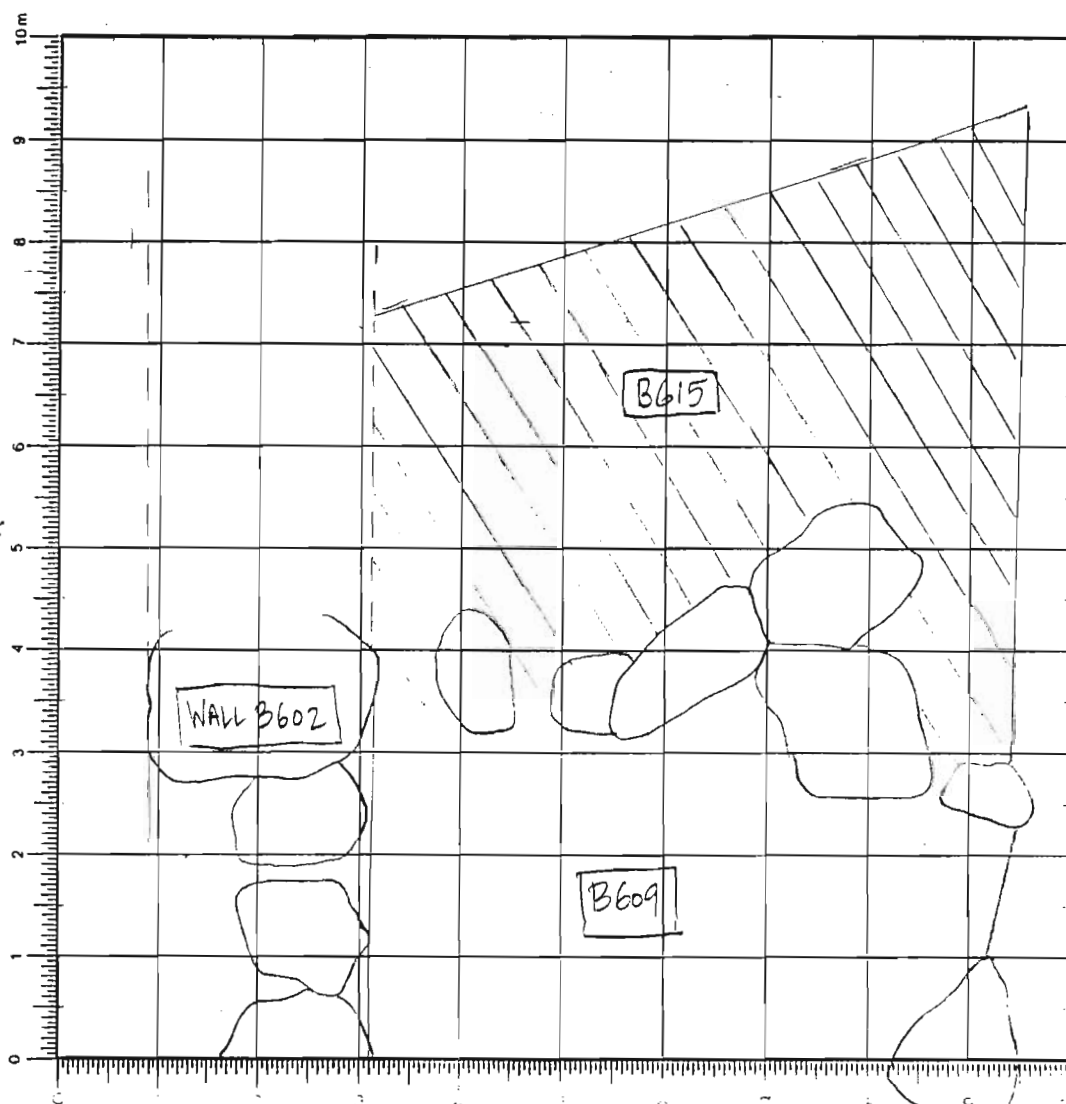

DEFINITION/DESCRIPTION of LOCUS (explain why you changed locus numbers):

Today's date: June 10/03 Locus above: B611

Locus parameters:

Verbal description: removal of tumble in north section

Locus Interpretative Comments (What do you think this is? DATE your comments, continue on additional pages if necessary):

[illegible]

OBJECTS

[illegible]

ADDITIONAL COLLECTED MATERIAL

[illegible]

Year 2003 Trench/Locus B615 Excavator SZP

DESCRIPTION of PROGRESS of EXCAVATION [date each entry and identify associated pottery pail(s)]:

June 10/03 : first pass consists of removal of tumble in the north section of locus - pottery pail is B615.1
 - larger is pebbly
 - pass to move from south to north ca. 10cm deep pass.



June 11/03 : continued work
 pail B615.2

Object #1 loomweight? bead?
 found in screen.



over →

END OF B615.2 ELEVATION

TOP

RS

Rod 4.072

1. (3.325) 364.517
2. 3.155 364.687
3. 3.395
4. 3.288
5. (3.112) 364.73
6. 3.210 364.632
7. (2.975) 364.867
8. 2.962 364.88
9. 3.200
10. 3.668

HI = 367.842

602

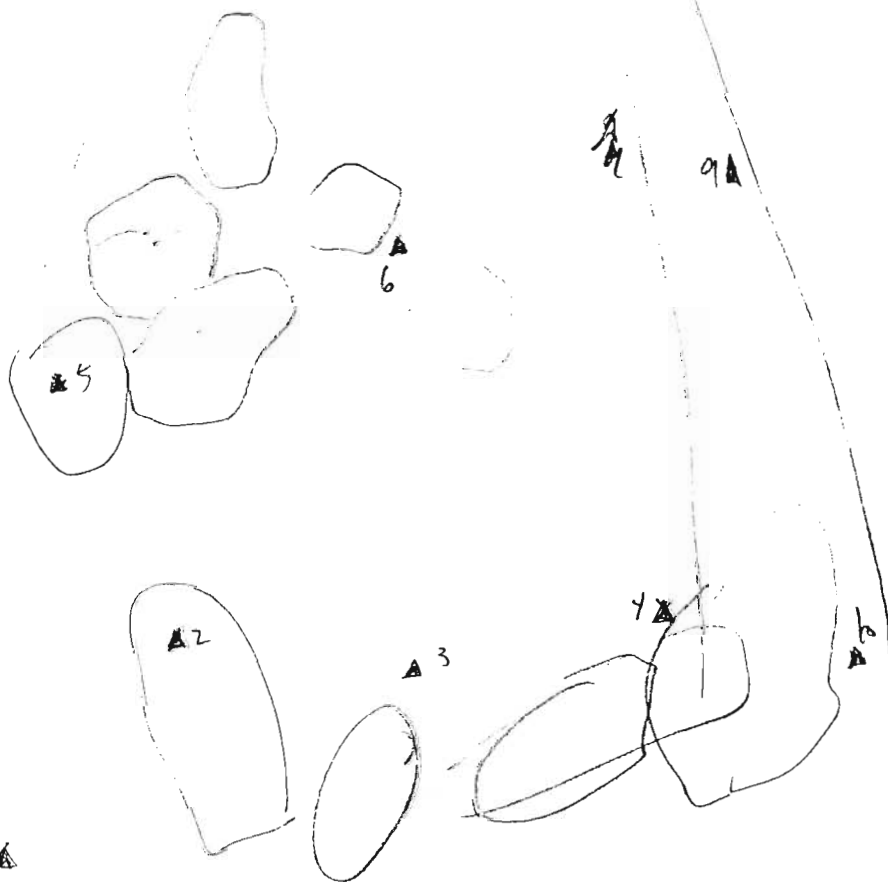

Year 2003 Trench/Locus B616Excavator SEP**Elevations**Benchmark used: R5

Reading on

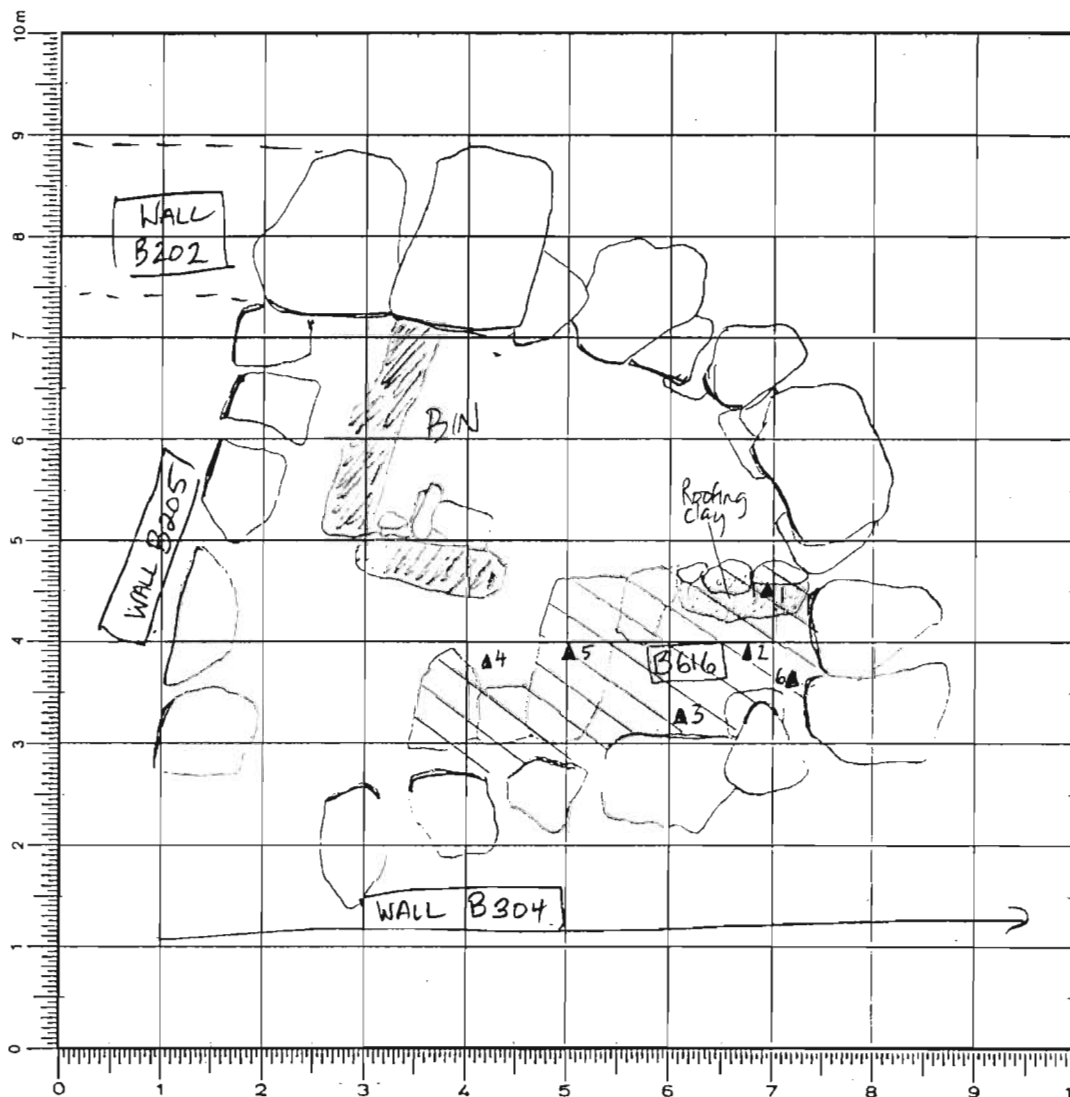
Benchmark: 4.004H.I.: 367.774

1. (4.746) 363.028
2. (4.870) 362.904
3. (4.617) 363.157
4. (4.808) 363.966
5. (4.765) 363.009
6. (4.782) 362.992

← stones?

SKETCH 1

DEFINITION/DESCRIPTION of LOCUS (explain why you changed locus numbers):

Today's date: June 11/03 Locus above: B614Locus parameters: Same as B614Verbal description: Soil is grey brown, very compact - small to medium sized stones

Locus Interpretative Comments (What do you think this is? DATE your comments, continue on additional pages if necessary):

roofing clay w/ tumbled stones.

[illegible]

OBJECTS

[illegible]

ADDITIONAL COLLECTED MATERIAL

[illegible]

Year 2003 Trench/Locus B616 Excavator SZP

DESCRIPTION of PROGRESS of EXCAVATION [date each entry and identify associated pottery find(s)]:

June 11/03: excavation of tumble and roofing clay → to bring down to same level as B612 and B613.

: pottery find is B616.1

: bone found

: carbon found in SW corner

- the stones in the corner of B202 and B304 will be left



June 12/03:

: interior of corner will be excavated as pit B616.2 → try to uncover more

100% screening
: pack clay material if possible

: ~~that~~ was not able to find more packed clay - concentrated on the small stones (see sketch above) and a little on the north side of these stones

: stones were pedestaled → mixed with roofing clay → they were removed

: small flakes of carbon found - no sample

: pumice found

: intensive soil sample → from corner of B202 and B304

Year 2003 Trench/Locus B616 Excavator SJP

DESCRIPTION of PROGRESS of EXCAVATION [date each entry and identify associated pottery pail(s)]:

END ELEVATIONS FOR B616.2

(363.77 masl)

R5 (1.946)
 1. (2.762) 362.953
 2. (2.800) 362.916
 3. (2.844) 362.872
 4. (2.816) 362.920
 5. (2.815) 362.901
 6. (2.807) 362.909

HI = 365.716

JUNE 18/03:

ARCHITECTURE ELEVATIONS

R5

R04

H

A.

B.

C.

D.

E.

F.

G.

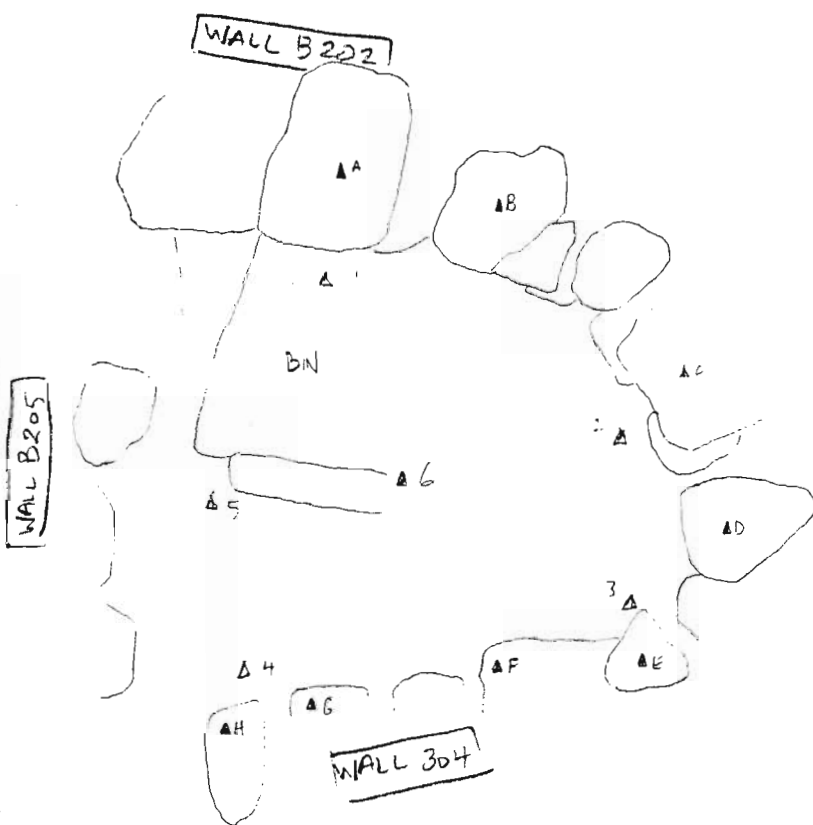

Year 2003 Trench/Locus B617 Excavator SZP**Elevations**

Benchmark used:

Reading on

Benchmark:

H.I.:

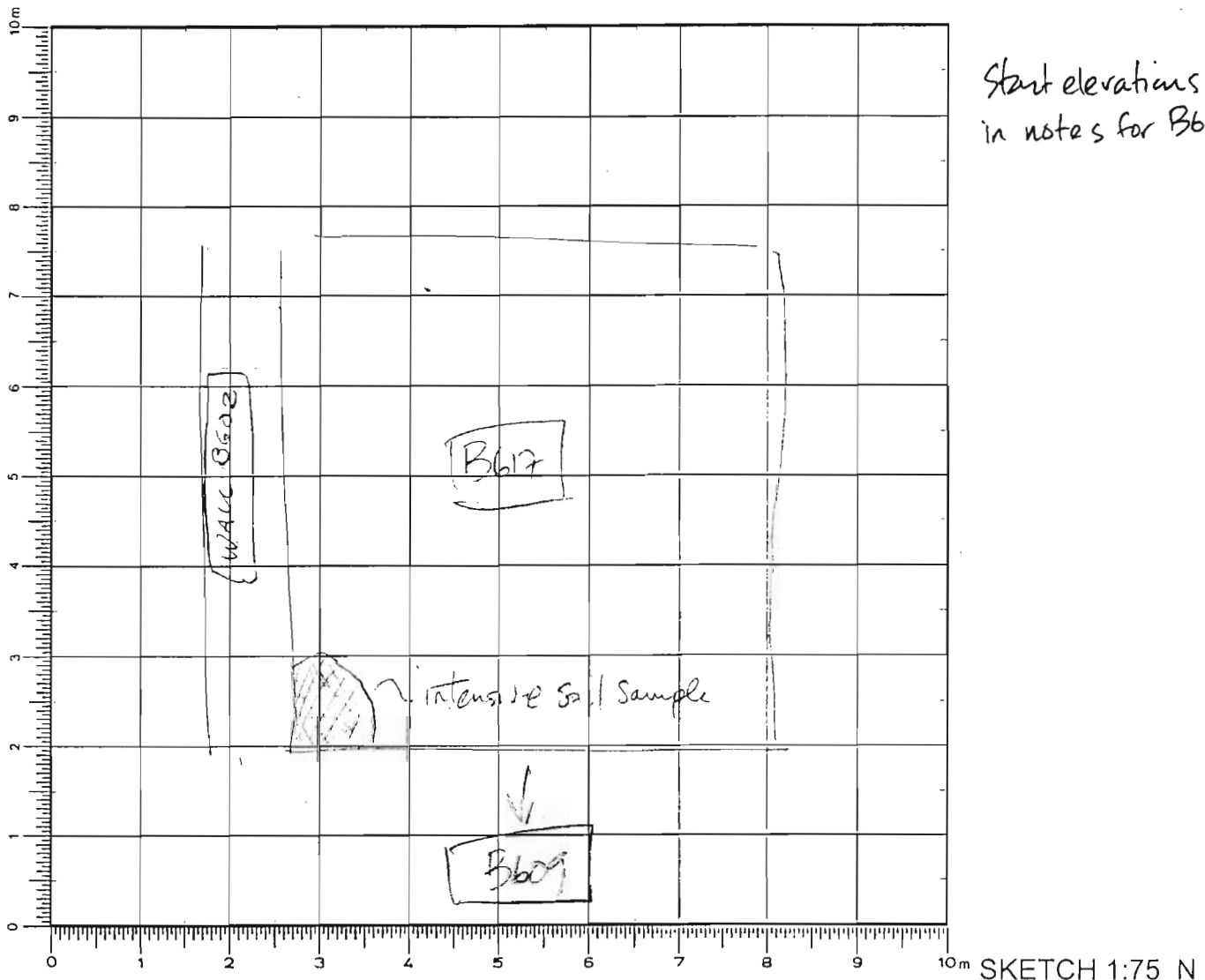

SKETCH 1:75 N

DEFINITION/DESCRIPTION of LOCUS (explain why you changed locus numbers):

Today's date: JUNE 11/03 Locus above: B615Locus parameters: Same as B615

Verbal description:

- Soil is red-brown with many small to large stones (tumble)
- Soil is relatively loose.

Locus Interpretative Comments (What do you think this is? DATE your comments, continue on additional pages if necessary):

Locus/Pottery Pail Number	Weight of Sherds	Number of Sherds	Chronology & Comments
B617.1	0.570kg	83	Hellenistic, Archaic
B617.2	1.210kg	70	Archaic, Hell, PG PG (1)
B617.3	0.255kg	17	Archaic
B617.4	0.145kg	5	Hell., Archaic
B617.5	0.735kg	68	Archaic, LG-EO
B617.6	0.065kg	6	Hell., Archaic
B617.7	0.025kg	12	NPD (Hell., Archaic)
B617.8	0.630kg	142	Archaic, Hell. (MULC)

OBJECTS

Object Number	Associated Pottery Pail	Identification (material/form)	Location	Elevation	Catalogue Number
1	B617.1	Stone tool?	ca 43 cm east of B602 ca. 307 m north of B609	364.273masl	

ADDITIONAL COLLECTED MATERIAL

Locus/Pottery Pail Number	Bones	Shell	Carbon	Pumice	Soil Sample	Other (specify)
B617.1	2 (including 1/4)				1 standard 1 intensive	
B617.2	2 (incl 1/4)			1	1 standard	
B617.4	1					
B617.5	2 (incl. 1/4")				1 std	
B617.6	1					
B617.7	1 (1/4")					
B617.8	2 (incl. 1/4")			1	2 (stand. & intens)	

Year 2003 Trench/Locus B617 Excavator SJP

DESCRIPTION of PROGRESS of EXCAVATION [date each entry and identify associated pottery pail(s)]:

June 11/03: excavation of B617 - to remove tumble and bring down to level B609

100% : lots of bone found
 1/4" screening : little pottery - pail B617.1

object # 1 - Stone tool (20cm x 15cm size)

ca. 43 cm east of B602

ca. 3.07 m north of south B609

elevation (3.562)

R5

Rod (4.065)

: intensive soil sample - SW corner of locus along east face of B602

: standard soil sample taken.

: ceramic base found - put into pottery pail R5
 130 m east of B602 elevation (3.340)
 370 m from south B609

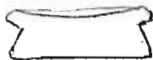

June 12/03: continued pass south to north -> pottery pail is B617.2
 - Bone found

June 13/03: continued pass from previous day (only NE corner left) B617.3

June 13/03: clean up of leftover topsoil in SE corner of locus B617.4

100% screening : small pass - removed tumble in west side
B617.5

June 23/03: surface cleaning of north section - B617.6

DESCRIPTION of PROGRESS of EXCAVATION [date each entry and identify associated pottery pail(s)]:

END ELEVATIONS FOR B617.3/4

June 13/03



R5:

Rod: 2.158

HI: 365.928

1. (1.645) 364.283
2. (1.534) 364.394
3. (1.454) 364.474
4. (1.114) 364.814
5. (1.205) 364.723
6. (1.230) 364.698
7. (1.225) 364.703
8. (1.090) 364.838
9. (1.390) 364.538
10. (1.789) 364.140
11. (1.680) 364.248
12. (1.392) 364.591
13. (1.422) 364.501
14. (1.275) 364.653
15. (1.652) 364.271
16. (1.445) 364.483
17. (1.308) 364.620
18. (1.490) 364.438
19. (1.745) 364.183

Year 2003 Trench/Locus B617 Excavator SZP

DESCRIPTION of PROGRESS of EXCAVATION [date each entry and identify associated pottery pail(s)]:

June 24/03 : new pass south to north against east face of Wall B602, then to fan out east and southward (see drawing)

Pail is B617.8

: purpose is to define lower courses of B602 and find exterior surface

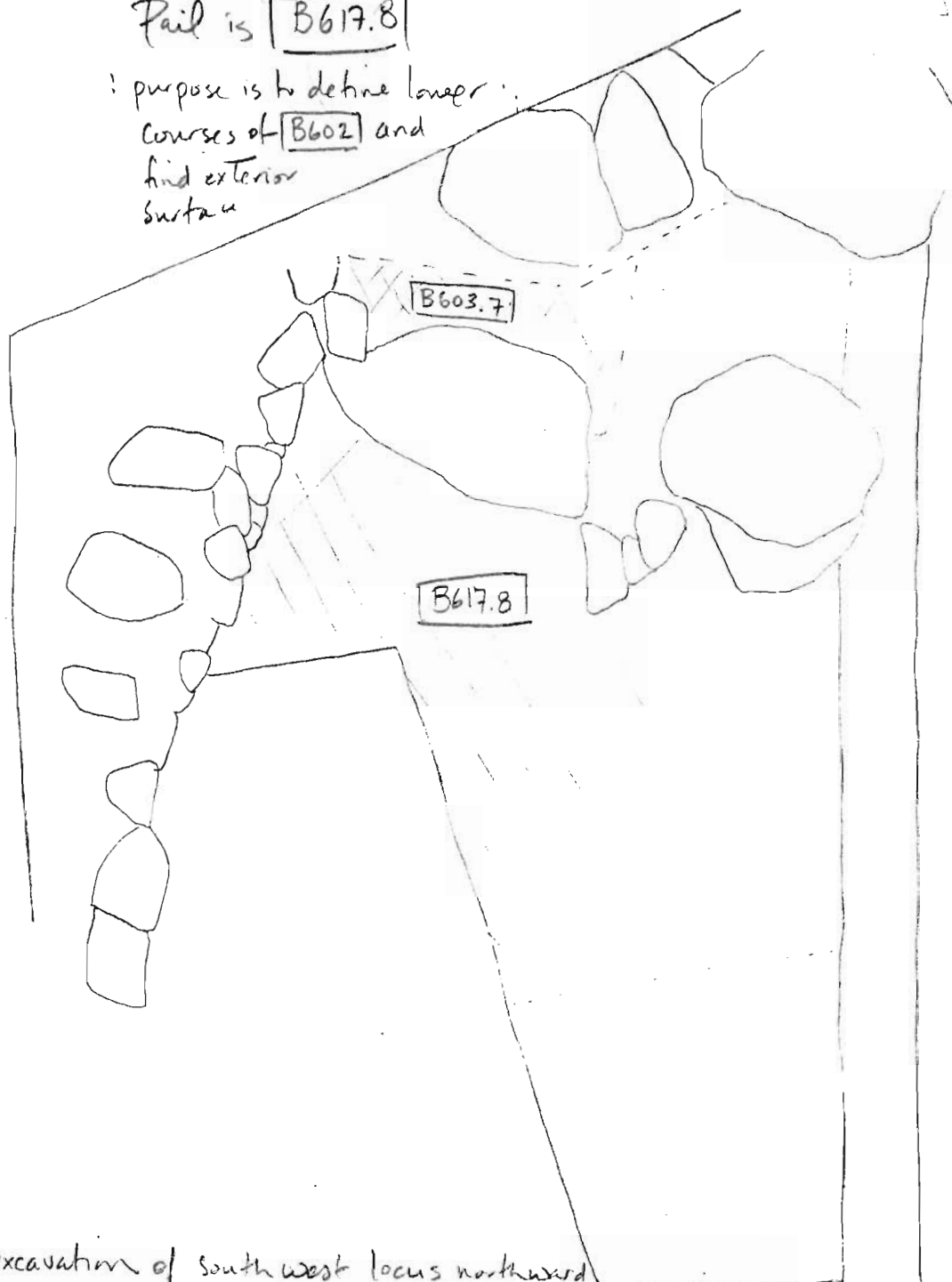

excavation of south west locus northward reveals no lower courses of B602 - wall appears to follow the slope upwards - pass depth is made much smaller

Year 2003 Trench/Locus B618 Excavator S2P

Elevations

Benchmark used:

Reading on

Benchmark:

H.I.:

Start elevations
on next page.

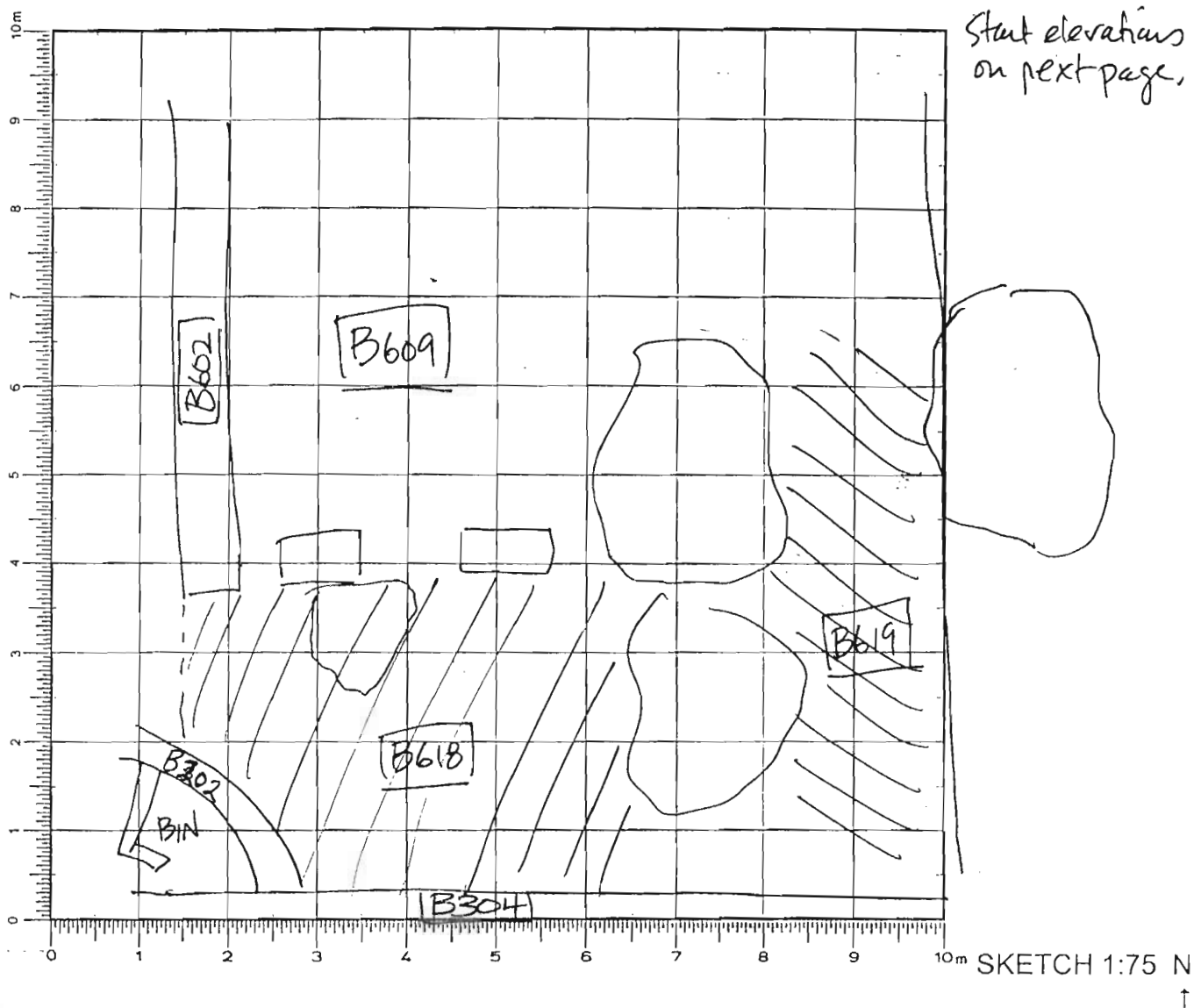

DEFINITION/DESCRIPTION of LOCUS (explain **why** you changed locus numbers):

Today's date: June 12/03 Locus above: B607

Locus parameters: See sketch next page.

Verbal description:

Locus Interpretative Comments (What do you think this is? DATE your comments, continue on additional pages if necessary):

Mixture of eroded bedrock, rubble and winter wash
- Soil is chippy

Year 2003 Trench/Locus B618 Excavator SEP

[illegible]

OBJECTS

[illegible]

ADDITIONAL COLLECTED MATERIAL

[illegible]

Year 2003 Trench/Locus B618 Excavator SJP

DESCRIPTION of PROGRESS of EXCAVATION [date each entry and identify associated pottery pail(s)]:

- June 12/03 : excavation of B618. no pottery found.
: this will not be ~~saved~~ as it is a chippy bedrock layer
: hope to clarify this area
: pass from west to east in south part → removal of small- to medium size stones.
: very chippy and friable → bedrock has broken down, making soil loose and dusty.
: no apparent architecture is found
: no finds → sterile.
: day end: South part excavated but incomplete
- June 13/03 : continued excavation of B618.
: area is sterile - no finds
: standard soil sample taken - pail B618.1 but no pottery.
: final elevations.

Year 2003 Trench/Locus B619 Excavator SJP**Elevations**

Benchmark used:

Reading on

Benchmark:

H.I.:

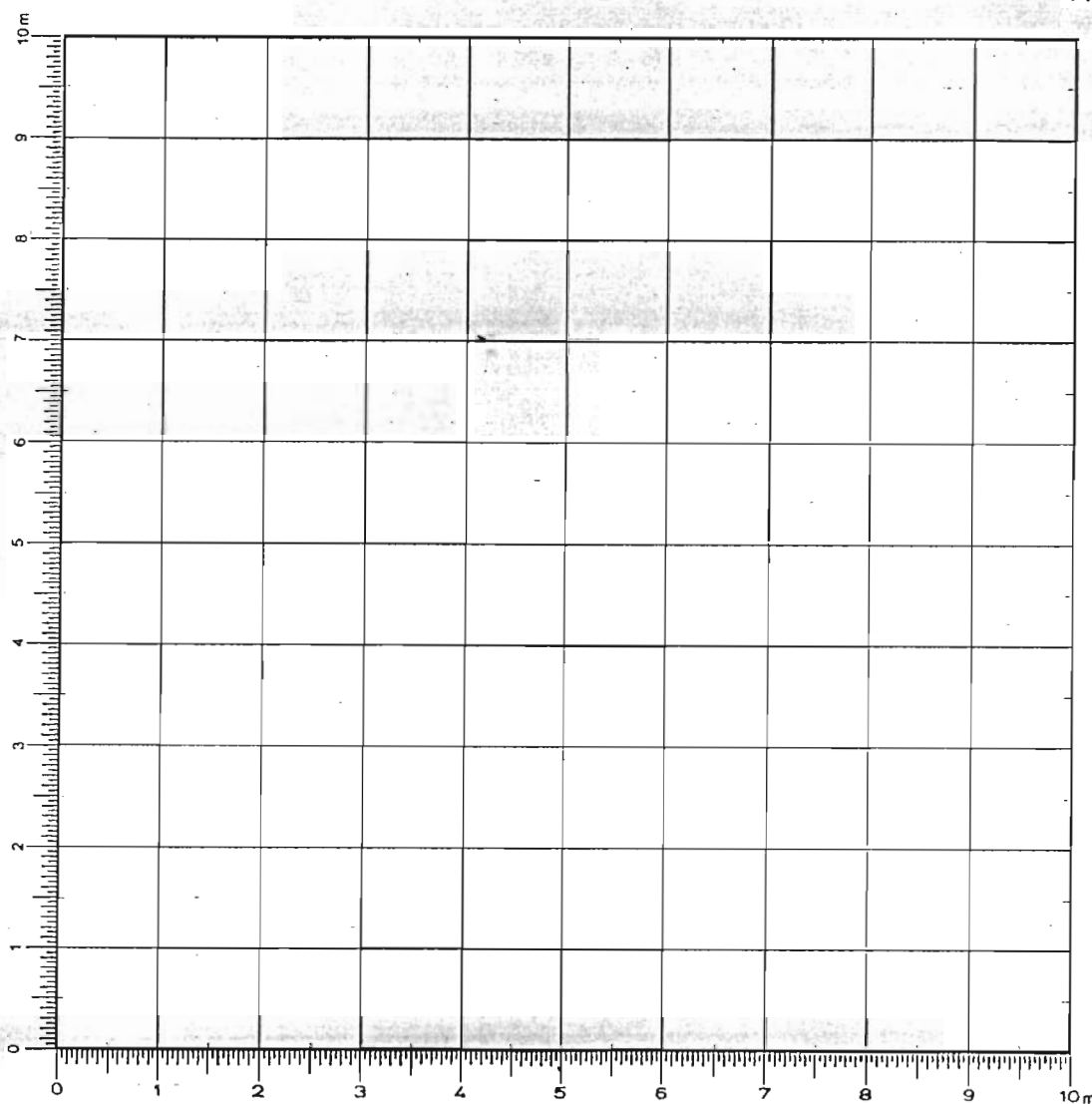

-start elevations
found in notes
for B618

SKETCH 1:75 N

DEFINITION/DESCRIPTION of LOCUS (explain why you changed locus numbers):

Today's date: June 12/03 Locus above: B602Locus parameters: Bounded by B609 to north, east trench boundary,
B618 on the west and wall B304 to South

Verbal description:

This locus is the east side of the lower part of B600, north
of wall B304 - 2 large bedrock boulders divide this area
in the middle - the west side is B618 and the east is B619.
The matrix is chippy and extremely loose with many small
inclusions - eroded

Locus Interpretative Comments (What do you think this is? DATE your comments, continue on additional pages if necessary):

fill behind wall B304 - probably below surface level.
original

[illegible]

OBJECTS

[illegible]

ADDITIONAL COLLECTED MATERIAL

[illegible]

Year 2003 Trench/Locus B619 Excavator SZP

DESCRIPTION of PROGRESS of EXCAVATION [date each entry and identify associated pottery pail(s)]:

June 12/03 : began pass from south to north, primarily to define stones and hopefully clarify the area - two large chunks of bedrock which bound the west side of locus are most likely trouble from above - but they cannot be moved as they obscure and limit our excavation.

- ! soil is dark brown, chippy and very friable → many inclusions range from fist-sized to smaller stones
- ! no pottery found

June 13/03 : continuation of previous day's pass

- ! standard soil sample taken - pail B619.1 - but no pottery
- ! sterile stratum
- ! final elevations

Year 2003 Trench/Locus B620Excavator SZP (RRC)

Elevations

Benchmark used:

Reading on

Benchmark:

H.I.:

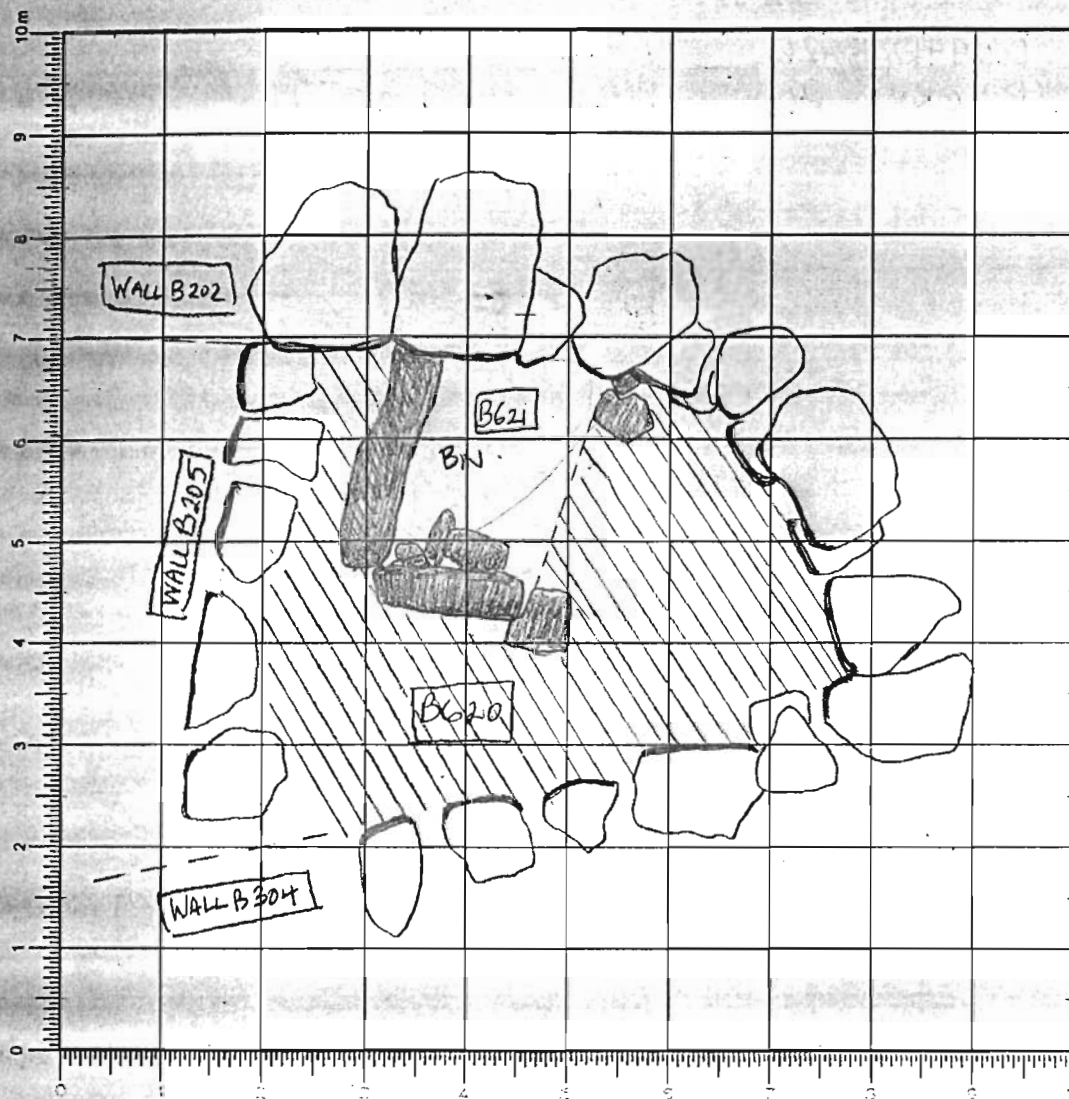

DEFINITION/DESCRIPTION of LOCUS (explain why you changed locus numbers):

Today's date: June 18/03 Locus above: B616Locus parameters: Junction formed by walls B202, B205, and B304.

Verbal description: Dirt above floor of room formed by the above walls.

Locus Interpretative Comments (What do you think this is? DATE your comments, continue on additional pages if necessary):

[illegible]

OBJECTS

[illegible]

ADDITIONAL COLLECTED MATERIAL

[illegible]

Year 2003 Trench/Locus B3620 Excavator SZP (RQC)

DESCRIPTION of PROGRESS of EXCAVATION [date each entry and identify associated pottery pail(s)]:

June 18/03: First pass of locus consists of the removal of approx 2-3 cm of soil from west to east end of room. Several pottery shards and bone pieces apparent in the fill. Fill is compact and filled with small (1.5cm-3cm) pebbles. 100% of removed fill is being screened in 1/4" screen. Very small carbon scatter (several pieces 3-4mm diameter) found in center of room. First pass extended from west to east, midway across the room on side opposite from bin. See diagram:



June 19/03: Today the first pass was continued east across the room towards the junction of walls B202 and B304. No pottery or bone collected, excavation halted.

June 20/03: First pass continued east towards junction of B202 and B304. The excavation plan for this room consists of making a ~~west~~ west to eastward pass of the southern half of the room (the area outside of the stone-bounded bin) of approx. 2-3cm in depth. As the eastern corner of the room is approached, the pass will extend north-eastward to fully cover the area outside the bin. Once this area is clear, the pass will be completed from east to west into the bin area of the room. See diagram below.



Year 2003 Trench/Locus B620 Excavator SEP (RQC)

DESCRIPTION of PROGRESS of EXCAVATION [date each entry and identify associated pottery pail(s)]:

June 20/03: Soil in southern portion of room is a compact (cont.) and pebbly brown clay. Munsell soil color approx 7.5 YR 5/4. Area to west of this room is a larger (~2m x 4m) room with flat clay floor. This type of floor has not been observed in current room after first pass. (in southern, excavated portion of the room). All soil is being screened through 1/4" screen. 20 L of soil sample taken from East corner of room, as well as 5L ~~standard~~ sample from several places in the room. Fill in the first pass consisted of many small (.5cm to 4cm) pebbles, fineware pottery sherds, and several small (2-3cm) bone fragments. Carbon was observed in sparse quantities in the eastern corner of the exterior of the bin. Several very small (1-3mm) pieces of carbon were collected.

Year 2003 Trench/Locus B621Excavator SJP (HMF)**Elevations**Benchmark used: R5

Reading on

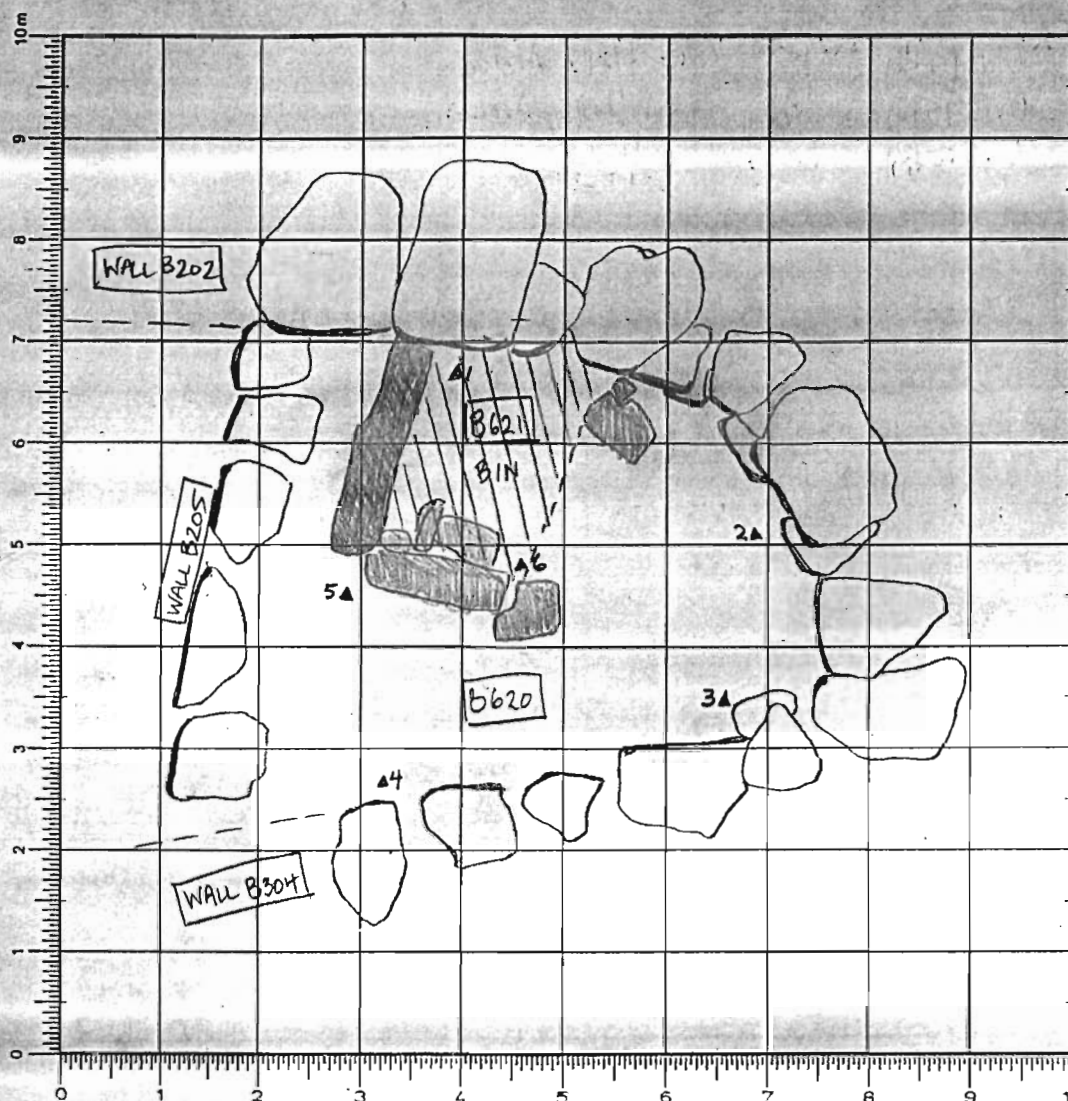
Benchmark: (1.946)H.I.: 365.716 mase

1. (2.763) 362.953
2. (2.800) 362.916
3. (2.844) 362.872
4. (2.816) 362.900
5. (2.815) 362.901
6. (2.807) 362.909

SKETCH 1:75 N

DEFINITION/DESCRIPTION of LOCUS (explain why you changed locus numbers):

Today's date: 20 Jun 03Locus above: B616

Locus parameters:

Verbal description:

interior of bin area - parameters formed on south and west by stone^{way}, north parameter formed by wall B202, and east parameter runs between two stones, one at the SE corner and one at the NE corner. No slope.

Locus Interpretative Comments (What do you think this is? DATE your comments, continue on additional pages if necessary):

[illegible]

OBJECTS

[illegible]

ADDITIONAL COLLECTED MATERIAL

[illegible]

Year 2003 Trench/Locus B621.1 Excavator SZP (notes taken by Hallie)

DESCRIPTION of PROGRESS of EXCAVATION [date each entry and identify associated pottery pail(s)]:

20 Jun 03: 1st pass - ~10 cm. working from east → west direction and south → north.
100% $\frac{1}{4}$ " screening.

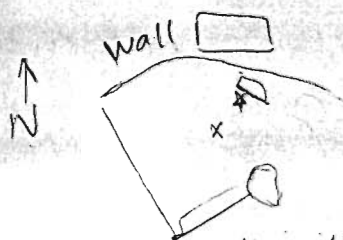

x small concentration of carbon
* vessel

Pottery pail
B621.1

- vessel lies on side
foot to south



small
concentration
of carbon

vessel

packed red soil (burnt clay?)

1st pass
20 Jun

- ceramic vessel found in
1st pass NE corner
interior of stone that
may have formed eastern
boundary of bin(?)

- soil is packed. not crumbly. color is consistent
except just to the south of the vessel where
a small portion is packed red - possibly
burnt clay?

direction
of digging
vessel

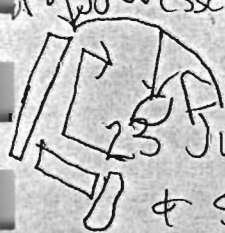

23 Jun 03 - [continue] 1st pass ~10 cm from E → W

& S → N working round bin interior towards vessel
(see above sketch)

Pottery Pail B621-2

23 Jun 03 cont. | -20 L intensive soil sample in w of Bin Area taken.

- Area to NW of Vessel contains carbon + very brown, looser soil

- After 15 cm pass there is clay @ the bottom across the pass some red + black burnt areas.

- section

Red Carbon

Potentially Slipped

Vessel Removed: Possible Tulip Vase; complete profile w/ some of Base

Coordinates: From E face of west side of Bin: 0.64 m

From S face of B202: 0.30 m

Elevation of bottom of vessel: 3.980

R5: 3.055

Carbon: 3.984

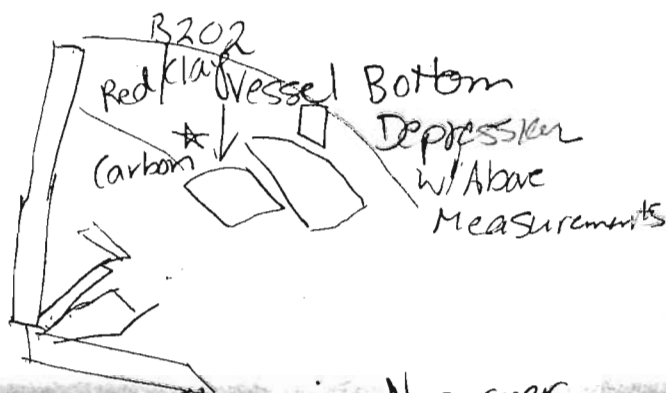

24 Jun 03 | Pottery Pail 621.3 | begun. Tumbled stones in N corner + NW corner removed. Reveals 2nd half of Tulip vase beneath. This will be a new pass 55 cm to take level down to remove the Tulip Vase sherds. Intensive soil sample of SW corner of bin (20 L). More red clay below initial tumble; some carbon.

- This pass contains all red clay (like) soil.

- Once Pass completed, Elevations taken.

Vase Tulip other half

B202 The 2nd large sherd was removed in 621.3

- No Screening; All Soil collected in Intensive soil sample



Year 2003 Trench/Locus B621 Excavator SEP

DESCRIPTION of PROGRESS of EXCAVATION [date each entry and identify associated pottery pail(s)]:

JUNE 24/03

END ELEVATIONS FOR B620
AND B621

RS : 363.77

Red: 2.425

HI: 366.195

1. (3.416) 362.779

2. (3.367) 362.828

3. (3.319) 362.876

4. (3.400) 362.795

5. (3.391) 362.804

6. (3.365) 365.83

7. (3.339) 362.856

