

FINAL REPORT FOR A2700

MSE

11 July 2004

A2700 is located west of both trench A1900 and wall A602 (only in the northern half of trench), south of wall A608, and north of A2000 (bounded by wall A1905). The measurements of the excavated area are ~8 m. x 2.75 (N) -1.25 m. (S).

The workman for this trench was Vangelis Phiorakis. The trench assistants were Miles Brown and Stacie Petersen, and the trench supervisor was Melissa Eaby. Excavations were conducted from 28 June - 2 July 2004. The benchmark used was R17 (+364.18 m.).

The strata were topsoil/slopewash (A2701) and wall tumble/eroded zone mixed with clay (A2702). The topsoil/slopewash pails, as well as the tumble passes, contained a mixture of LM IIIC, Archaic, and Hellenistic pottery. Little bone was found, though three stone tools (A2701.2, A2702.3,4), a spindle whorl (A2701.2), a pierced stone (A2702.1), and a clay bead (A2702.3) were found.

This trench was originally opened to look for an additional kitchen in the A600 area, though no evidence of another room was found. It was then expanded to look for an access route into A1900, which was also not found. This area appears to have been exterior space - no clear surface was found, and the area appears washed out/eroded as well. The northern part of the trench may originally have been paved, due to the presence of plaka-like stones. One feature, possibly a step or bench (A2703) was revealed, built up against the bedrock. This may have been used to provide access to the andreion complex by leading to the stairs (A1921), though the space between these two on the bedrock is rather large for this to have been the access route. In addition, two rectangular cuttings were found in the bedrock with topsoil removal; these may have been used to support pillar bases for the porch (southwest room of A1900) of the andreion complex. They do not, however, serve to clarify the question of access into the andreion complex.

Year 2004 Trench/Locus A2701 Excavator MSE

Elevations

Benchmark used: R17
 Reading on 3.500
 Benchmark:
 H.I.: 367.680m

← N

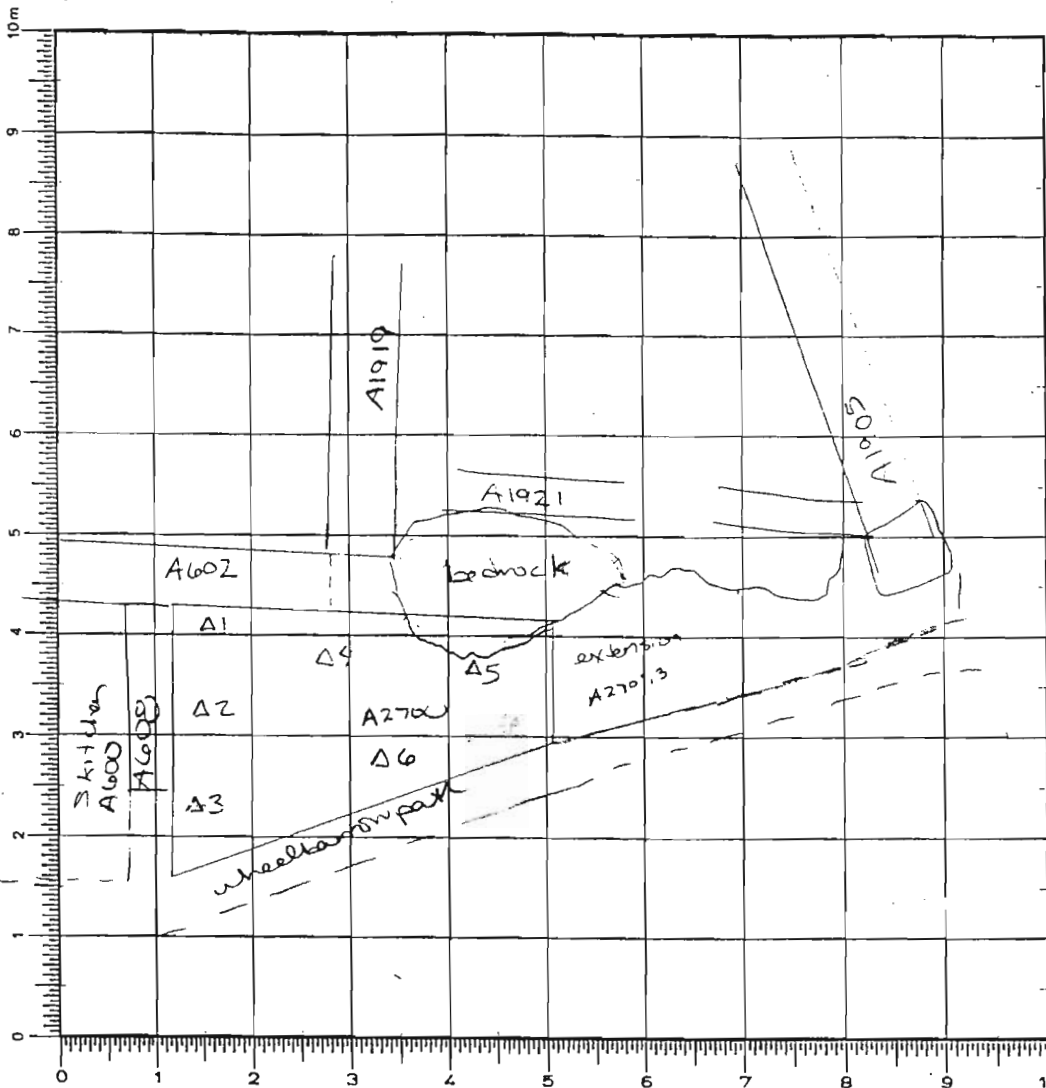

opening

- Δ1 - 2.920 → 364.760m
- Δ2 - 3.060 → 364.620m
- Δ3 - 3.121 → 364.559m
- Δ4 - 3.064 → 364.616m
- Δ5 - 3.100 → 364.580m
- Δ6 - 3.115 → 364.565m

after A2701.2

- Δ1 - 2.935 → 364.745m
- Δ2 - 3.262 → 364.418m
- Δ3 - 3.329 → 364.351m
- Δ4 - 3.285 → 364.475m
- Δ5 - 3.203 → 364.477m
- Δ6 - 3.254 → 364.426m

10m SKETCH 1:75

DEFINITION/DESCRIPTION of LOCUS (explain why you changed locus numbers):

Today's date: 28 June 04 Locus above: _____

Locus parameters: S ∩ A600, W ∩ A1900

Verbal description: v. ~~low~~ light brown soil full of small rocks, roots

Locus Interpretative Comments (What do you think this is? DATE your comments, continue on additional pages if necessary):

topsoil / slopewash / spill from A1900 excavation

Year 2004 Trench/Locus A2701 Excavator MSE

DESCRIPTION of PROGRESS of EXCAVATION [date each entry and identify associated pottery pail(s)]:

28 June 04

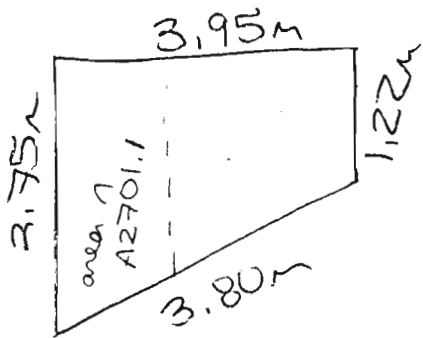

- trench is bounded on north by wall ~~A608~~ to east by wall A602 (north end) and bedrock which (south end) support stair A1921

- area left to west at edge of terrace for wheelbarrow path

north end of trench is higher than south end b/c south end was covered w/ plastic for backfill dirt after the first season

- 1st pass to remove dirt from north end (soil is mostly washed down from excavations in A1900 this season and last season)

A2701.1 - few sherds found in this pass

begin pass across trench A2701.2 - screening 100% b/c it is assumed that much bone will be found, washed down the hill, on the basis of excavation w/

~~A1900~~ A1900 - coming down on wall tumble at north end of trench - 1/2 a spindle wheel in 1/4" screen (obj. #1)

- complete pass across trench

- not a lot of bone found

- hammerstone (obj #2) found 1/4" screen

July 04 extend trench ~~2.5m~~ ^{4.1} to south (~~A2701.2~~)

(up to line of A1905)

(2 zones) A2701.3

v. little bone found

- found piece of plaster for cistern on top of wall

- removing topsoil + wash/spill from A1900

Year 2004 Trench/Locus A2701
~~A2702~~ Excavator MSE

DESCRIPTION of PROGRESS of EXCAVATION [date each entry and identify associated pottery pail(s)]:

2 roughly rectangular cuttings (apparent) observed in section
 of bedrock revealed in this pass

(see sketch A2702 p. 6)

- these could have been used for wooden ^(post) beams to support
 the roof over the ^{open} porch of A1900
 [SW room]

~~many~~ many pithos sherds found in pass

□ cuttings N ~ 26x27
 S ~ ~~10~~ 20x17 cm

Year 2004 Trench/Locus A2702 Excavator MSE

Elevations
 Benchmark used:
 Reading on
 Benchmark:
 H.I.:

E 2

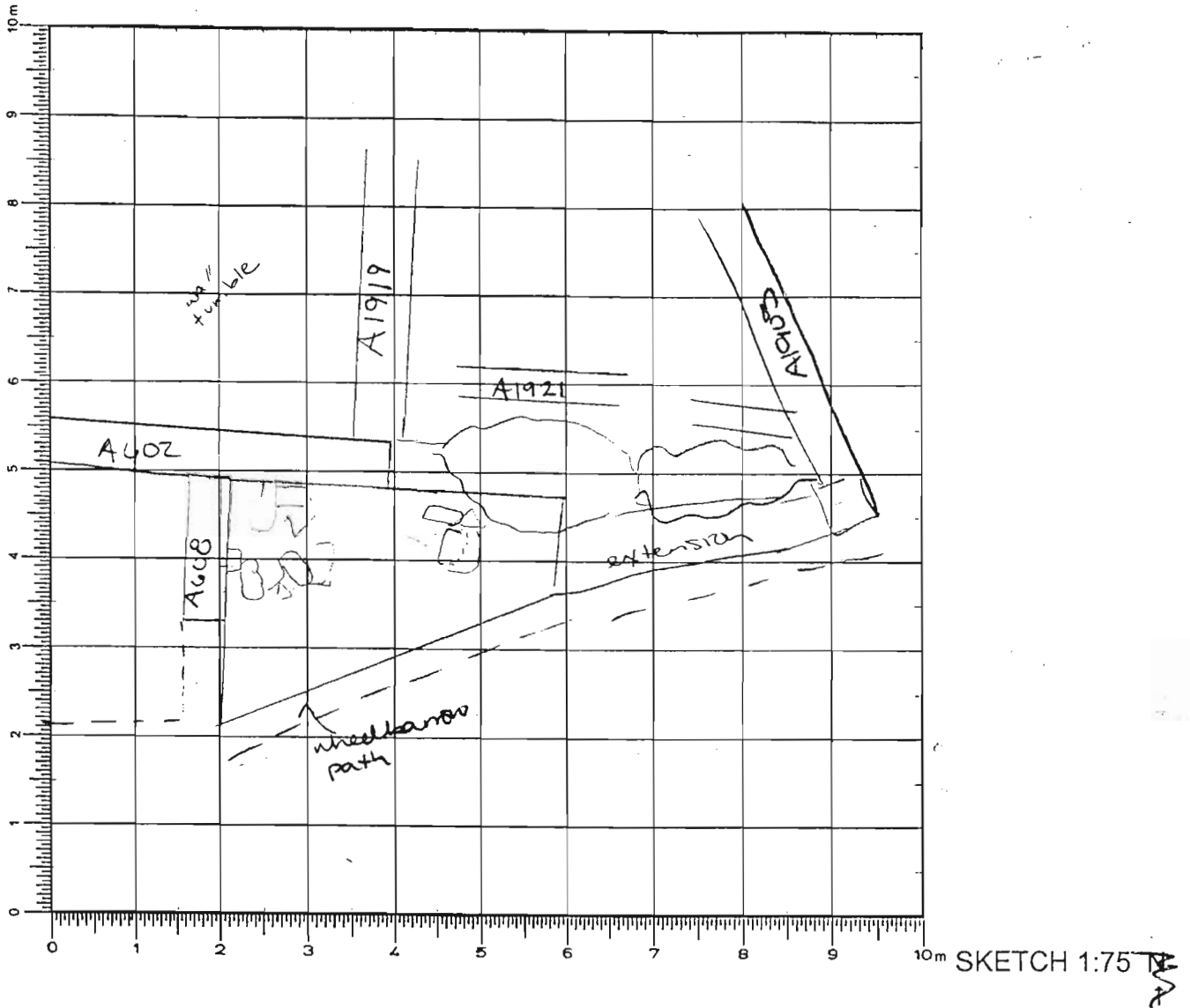

DEFINITION/DESCRIPTION of LOCUS (explain why you changed locus numbers):

Today's date: 29 June 04 Locus above: A2701

Locus parameters: S of A608, west of A1900

Verbal description: ^{sof*} loose soil, medium brown w/ many small stones + some medium sized

changed parts b/c larger stones beginning to appear + more stones fewer roots

Locus Interpretative Comments (What do you think this is? DATE your comments, continue on additional pages if necessary): wall tumble/slopewash

Locus/Pottery Pail Number	Weight of Sherds	Number of Sherds	Chronology & Comments
A2702.1	2.300	318	III C, A, H
A2702.2	0.085	23	III C, A, H
A2702.3	0.085	11	III C, A, H
A2702.4	1.975	233	III C, A, H
A2702.5	1.665	57	A
A2702.6	0.775	70	A, H
A2702.7	1.100	62	III C, A, H

OBJECTS

Object Number	Associated Pottery Pail	Identification (material/form)	Location	Elevation	Catalogue Number
1	A2702.1	stone bead?	w side ~ middle	---	
2	A2702.2	stone quern?	NE corner fumble	---	
3	A2702.4	clay bead	1/4" screen	---	
4	A2702.4	stone tool?	1/4" screen		

ADDITIONAL COLLECTED MATERIAL

Locus/Pottery Pail Number	Bones	Shell	Carbon	Pumice	Soil Sample	Other (specify)
A2702.1	✓				Standard	pebbles
A2702.2	✓					pebble
A2702.3	✓	✓				
A2702.4	✓	✓				pebbles
A2702.5	✓			✓		pebble
A2702.6	✓					
A2702.7	✓			✓		

Year 2004 Trench/Locus A2702 Excavator MSE

DESCRIPTION of PROGRESS of EXCAVATION [date each entry and identify associated pottery pail(s)]:

- 29 June 04 begin pass from north end of trench A2702.1
- screen 100% of soil
 - still not finding v. much pottery + bone
 - removing tumble from NE corner in two pass
 - soil is extremely rocky (full of ~ 5-10 cm sized stones)
 - exposing south face of A608 ↳ see NE + E
 - tumble ~~is~~ appears to be concentrated in NE area of trench
 - uncover stones, possible plakas in center of east side of trench
 - obj #1 - pierced stone obj ○ - see stones w/ drilled hole
 - wall A602 appears to continue to large bedrock outcrop

← N

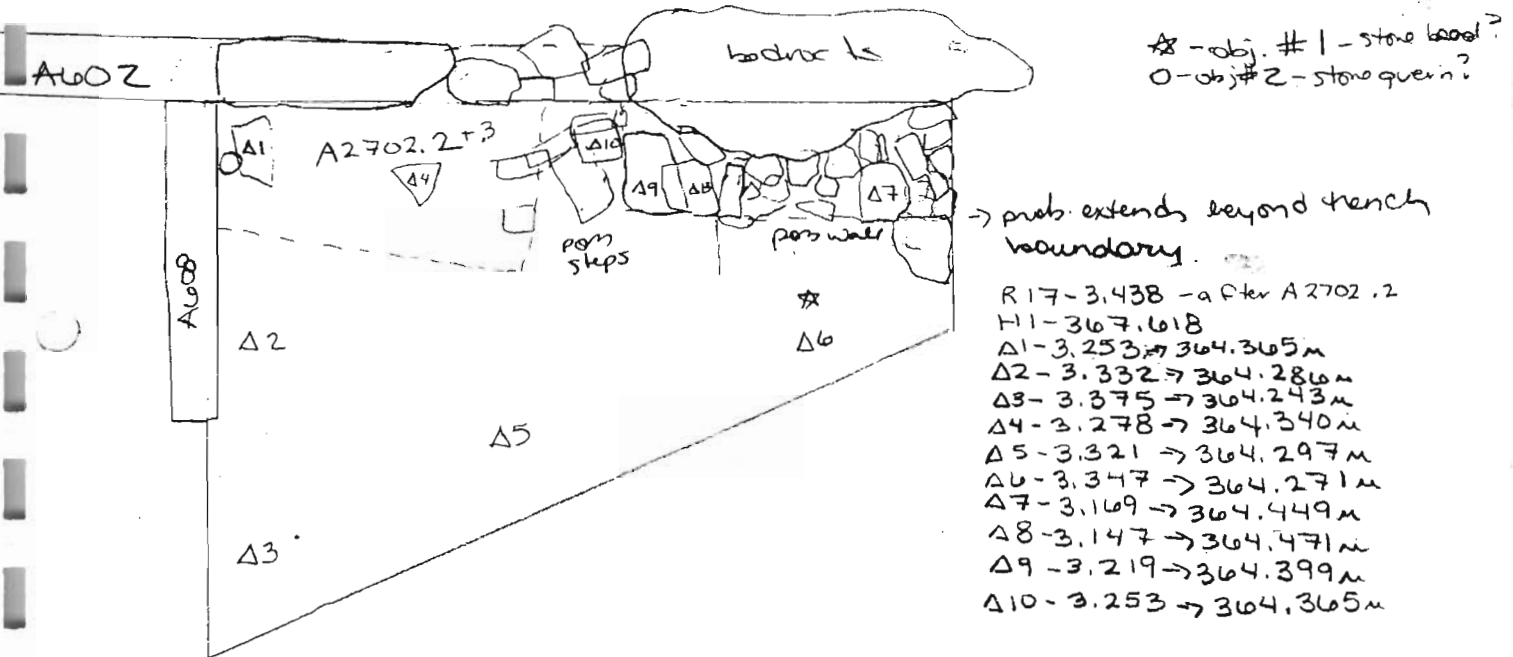

uncovering possible wall / lower stair built up against bedrock (south section consists of primarily small field stones + 1 or two medium; north part contains primarily plakas)

- or possible a wall lining the bedrock + steps ~~to the north~~
- half an olive pit found in pass dental east
- more tumble ~~uncovered~~ ^{uncovered} in northeast + ~~part~~ part

Year 2004 Trench/Locus A2702 Excavator MSE

DESCRIPTION of PROGRESS of EXCAVATION [date each entry and identify associated pottery pail(s)]:

remove tumble in northeast + central east area of trench as new pass A2702.2 b/c higher + same tumble currently not visible in rest of trench

- a few small patches of clay visible ^{throughout} in trench, though mainly the soil is still soft w/ many stones

in tumble area - more clay patches revealed below
tumble stones

- soil of this pass is still unusually packed w/ small stones → no identifiable feature but many small stones in tumble

- obj #2 - possible ^{stone} quern → flat worked stone w/ rounded edges



possible step in SE side appears to be built on top of a low section of the bedrock outcrop

- ~~2-4~~ 2-4 courses of A608 now visible in south pass

coming down on reddish soil in NE corner by wall A608

- not complete pass before end of day (one small section of tumble left)

30 June 04 - complete pass in NE section - A2702.3

- not really find anything in passes → perhaps this area is extra pass

[pass step 157 or 195 cm long
= 45 cm width from bedrock]

Δ1 + Δ4 - pass planks (area may have been paved extra space leading to lower stair of anchera complex (A1900))

- soil is almost like floor-packing → perhaps the surface was washed out / eroded away

- only a few shreds + bones

Year 2004 Trench/Locus A2702 Excavator MSE

DESCRIPTION of PROGRESS of EXCAVATION [date each entry and identify associated pottery pail(s)]:

- begin another pass ⁱⁿ west half of trench **A2702.4**
- (in east half surface appears to be lost w/ only a couple flakes + possible stair remaining)
- west half - closer to edge of terrace - still contains loose soil (slopewash)
 - taking one more pass in this area to confirm that observed in east half w/ last pass
 - screen 100% (clay bead found in screen obs #3)
(pos. stone tool obs #4 also in screen)
 - soil in west - still tumble / slopewash
 - not much bone found in this pass
 - plaster found in pass - ^{put} from ^{Helix} cistern on top of bedrock
 - feature in front of bedrock still looks like stairs or a wall

take another pass in north east quarter of trench, removing v. rocky hard soil **A2702.5**

- large patch of clay uncovered in NE corner, preserved by fallen stones from A608
- the rest of this area is pretty washed out → removed of tumble did not reveal a clear surface
- scattered patches of clay observed elsewhere in trench
- apparent bottom of A608 reached in this pass
- no clear surface found

July 04 take first tumble pass in extended zone (below **A2701.3**)

A2702.6

- access to western room of A1900, not clarified in this area → no evidence of stairs cut into bedrock, (which is rather tall), making it somewhat difficult to access the stair A1921 directly from bottom of terrace
- step in north half of A2700 only really promising location currently (or there were wooden stairs on bedrock)

Year 2004 Trench/Locus A2702 Excavator MSE

DESCRIPTION of PROGRESS of EXCAVATION [date each entry and identify associated pottery pail(s)]:

← N

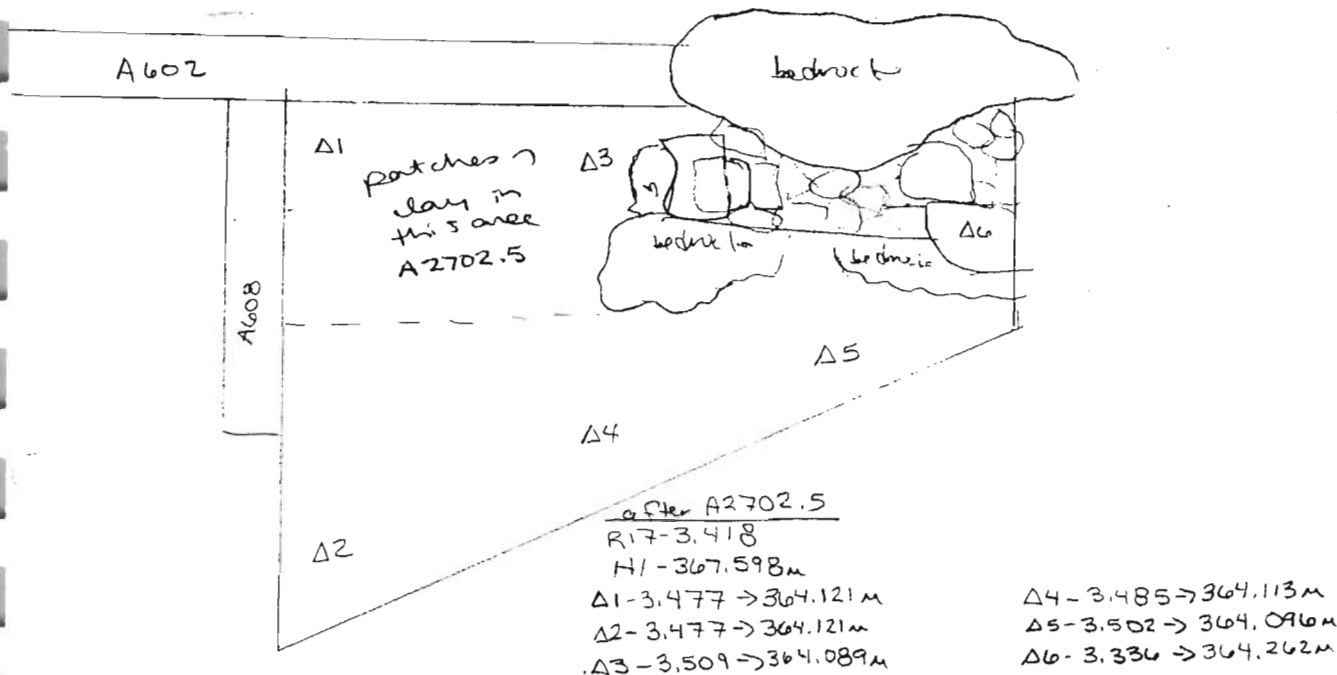

v. little bone found (~~in pass~~) in pass
 - also only little pottery
 exposing more bedrock as pass continues
 - no surface yet exposed + continuation of feature observed in north half of trench not yet found

+ support for the identification of cuttings for posts is the ~~presence~~ in elevation's closeness

2 July 04 take another pass in expanded area A2702.7
 more stones of step (feature built against bedrock) exposed w/ this pass

[244 → 2.7m (up to bedrock) (including bedrock) - current length of feature]
 a few small stones were accidentally removed from feature in space beside bedrock outcrop (see plan)
 (14x11, 13x16 → typical size of stones in feature)

Year 2004 Trench/Locus A2702 Excavator MSE

DESCRIPTION of PROGRESS of EXCAVATION [date each entry and identify associated pottery pail(s)]:

R17-3.408
N1-367.588m

opening [$\Delta 1 - 2.867 \rightarrow 364.721m$
 $\Delta 2 - 2.727 \rightarrow 364.861m$

after A2701.3 [$\Delta 1 - 3.039 \rightarrow 364.549m$
 $\Delta 2 - 3.005 \rightarrow 364.585m$

cuttings [$\Delta 3 - 2.799 \rightarrow 364.789m$
 $\Delta 4 - 2.795 \rightarrow 364.793m$

after A2702.6 [$\Delta 1 - 3.199 \rightarrow 364.389m$
 $\Delta 2 - 3.204 \rightarrow 364.384m$

after A2702.7 R17-3.985 N1-368.165 [$\Delta 1 - 3.953 \rightarrow 364.212m$ $\Delta 8 - 2.957 \rightarrow 365.208m$
 $\Delta 2 - 3.915 \rightarrow 364.250m$ $\Delta 9 - 2.905 \rightarrow 365.260m$
 $\Delta 5 - 3.646 \rightarrow 364.519m$
 $\Delta 6 - 3.703 \rightarrow 364.462m$
 $\Delta 7 - 3.749 \rightarrow 364.416m$

- at south end of trench stones A10-364.952m previously uncovered in area b/w 2 pieces of bedrock \rightarrow these appear to have been intentionally placed (possibly as step in to stop runoff / stabilize upper step) - feature?

- more plaster found from cistern
- soil is loose + has many small stones (light brown) \rightarrow except at A2703 where there is clay

- bedrock slopes down extensively \rightarrow prob not access in center of trench

(cf. room stair A2000)

- large piece of pumice found
- little bone found

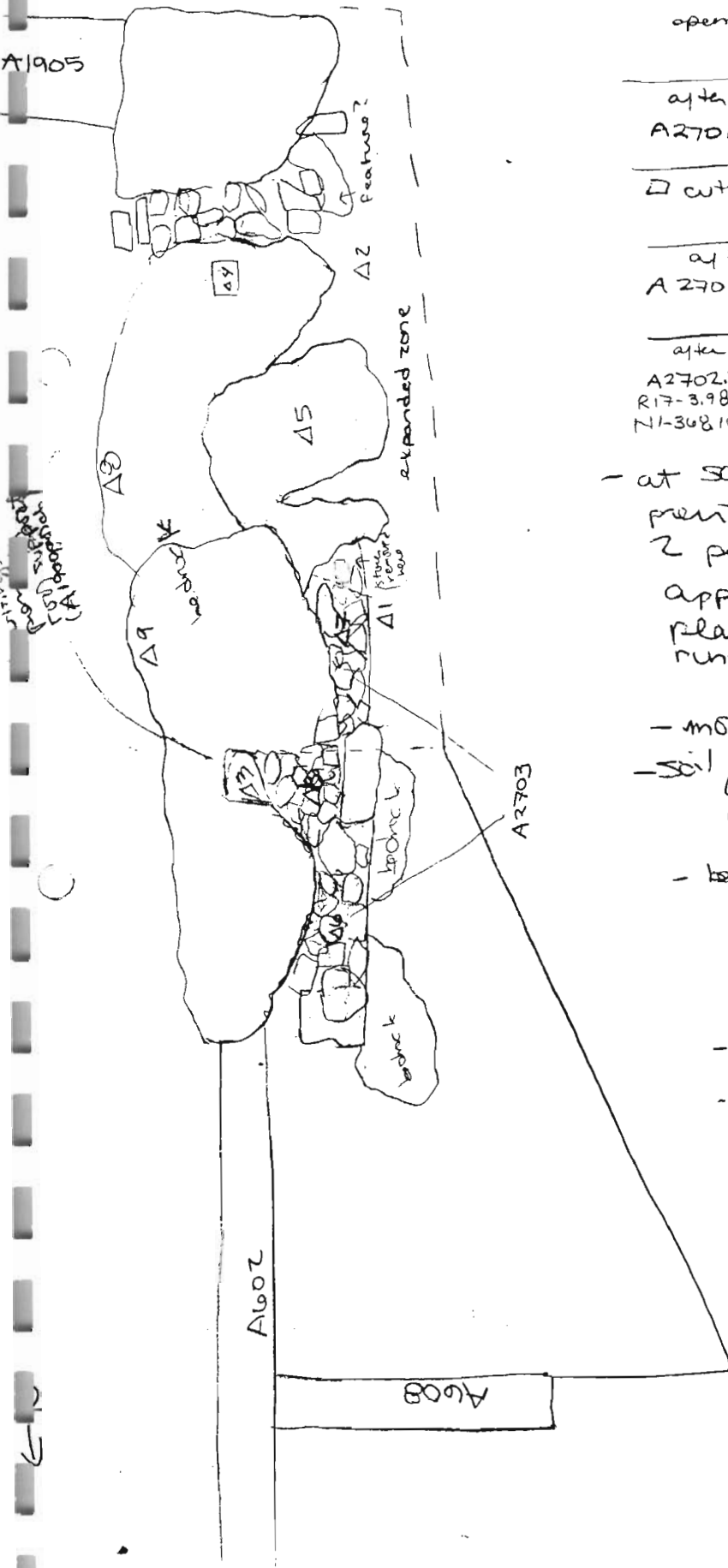

Year 2004 Trench/Locus A2703 Excavator MJE

Elevations

Benchmark used:

Reading on

Benchmark:

H.I.:

← N

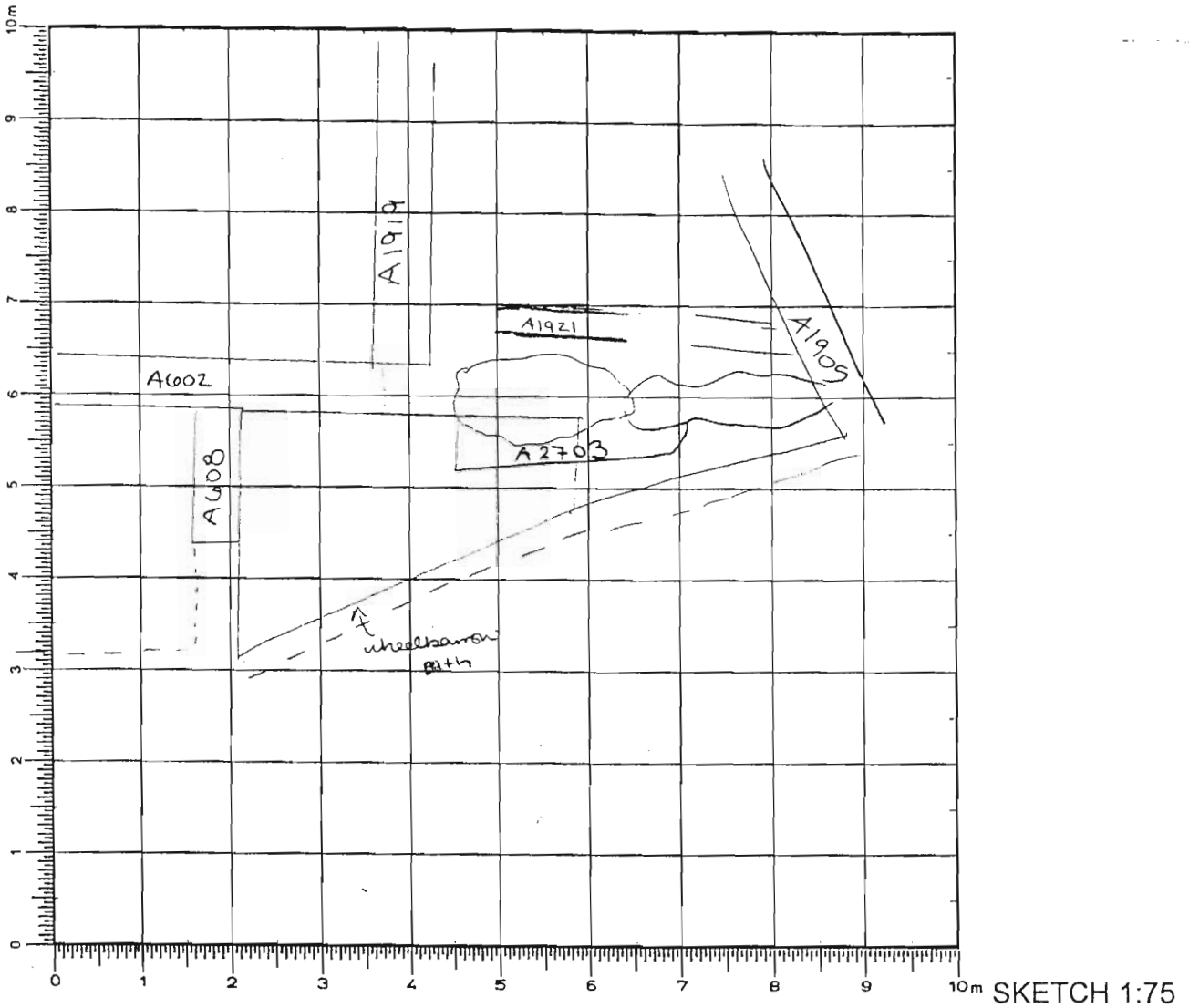

SKETCH 1:75

DEFINITION/DESCRIPTION of LOCUS (explain why you changed locus numbers):

Today's date: 2 July 04 Locus above: _____

Locus parameters: west side of trench, abuts bedrock (in middle section)

Verbal description: runs N-S, composed primarily of small, irregular shaped field stones (average 14x11cm, 13x16cm) abuts bedrock + sits on it as well

Locus Interpretative Comments (What do you think this is? DATE your comments, continue on additional pages if necessary): steps / bench

Year 2004 Trench/Locus A2703 Excavator MSE

DESCRIPTION of PROGRESS of EXCAVATION [date each entry and identify associated pottery find(s)]:

- 2 July 04 length 2.71M
 av. width $\hat{=}$ 0.35M
 feature appears to be either lower stair up to bedrock (which
 supports A1921 stair into porch \rightarrow andriron complex)
 or possibly a bench (of walkway from kitchen)
 - feature does not appear to continue further to south
 see A2702 ~~is~~ p. 6 for sketch + elevations
 (p. 2, 5, 6)
-