

Parameters:

B 3600 is located on the western slope, directly north of B 3200, and west of D 300. The dimensions are roughly 7.5 x 5.6 x 8.8 x 1.0 x 2.6 x .9 x 4.1 x 1.6 meters, in an irregular shape (see locus sheets for diagram), and was excavated between the dates of the 6th of July and the 14th of July.

Benchmark: R Gypsy 2 : 345.826 m

Staff:

The trench supervisor is Gypsy Price. The trench assistants are Alyssa Egger, Lauren Hunley, Jeff Smith, and Costas Chalikias. The workmen were Nikolis Spiliarotis and Manolis Maniadakis.

Progress of Excavation:

Trench B 3600 was conducted in 4 different loci. **B 3601** represents the topsoil. Pails **B 3601.1-2** cover the first pass through the main body of the trench (about 7.2 meters north to south and 3-4 meters east to west) which was uncovered first. **B 3601.3-4** indicates the expansion taken to the north and to the south to remove the bulk directly west of B 3207 (from B 3200). **B 3601.5** denotes the expansion to the west along the border of the original pails. No objects or bone are found, however large amounts of pottery – mostly coarse ware – are collected. A linear accumulation is uncovered consisting of three stones that appears to have been a wall running roughly north to south, perhaps in line with previously excavated B 3206. This linear accumulation is later denoted **B 3604**.

B 6202 denotes the thin layer of rocky eroded slope-wash that covers the entire exposed area. Pails **B 3206.1-2** are taken through the main body of the trench extending north from B 3200 about 7.2 meters, and concentrated in the area to the west of the linear accumulation (**B3604**) previously exposed. The area above B 3604 appears to be eroded pre-bedrock, and is therefore neglected in light of limited time for excavation. Pail **B3602.2** renders 10 objects, including stone tools, pumice, loom weights, and stone weights (objects # 1-10). Several smooth stone “work platforms” and the top to a fenestrated stand also emerge. Many of the objects are discovered within close proximity to the “work platforms”, nestled in a small area between them and B 3604. Surprisingly, underneath this single pass across the slope-wash, roofing clay emerges to the west of B 3604. Pails **B 3602.2-10** pass underneath the area directly across from B 3207, in attempts to define the western edge of the wall, which appears to have been lost. **B 3602.11-12** account for the slope-wash removed from underneath the western extension (**B3601.5**).

B 3603 denotes the rocky roofing clay layer that lay beneath the slope-wash. Pails **B 3603.1-2**, and **B 3603.6-8** are taken across the trench in attempts to define architecture and gain some sense of a floor surface.* One object, a stone tool, is found in **B 3603.2** (object #1). Objects #2-6 are found in **B3203.6**, all of which are stone querns. Objects # 7-11 are found in **B 3603.8**, and include pumice, a ceramic spindle whorl, and stone tools.

* Pails **B 3603.3-5** were never assigned due to a mix up in pail numbers

Several pithos scatters are also uncovered throughout these pails. The first of which is removed with pail **B 3603.9**, the dirt underneath which is cleared as **B 3603.10**. Pails **B 3603.11** and **B 3603.14** are taken under the western expansion, where the floor surface dives due to erosion. Pails **B 3603.12-13**, and **B 3603.15** are taken in the main body of the trench, previously defined. Objects #12-17 are found within this pail, including two pieces of iron (one of which is a hook), pumice, ceramic spindle whorls, and a shell. **B 3603.16** was taken to clear the clay and tumble from around B 3604 in an effort to define the wall more accurately. Within this pail two objects (# 18-19) are found: a stone weight and a large piece of pumice. Pails **B 3603.17-18** are conducted in order to clean the floor surface and search for the floor in the western extension (respectively). Another stone quern (object # 20) is pulled from **B 3603.17**.

With the poorly preserved floor surface defined, the pottery scatters are removed from the ground. **B 3603.19** consists of a shattered stand to the north. **B 3603.20** refers to the small scatter of pithos sherds from around the stand. Within this locus a fine stone weight is found (object #21). The fineware from around this pail is denoted as **B 3603.27**. **B 3603.21** denotes the fenestrated stand from the southern half of the trench, and the fineware from around this pail is represented as **B 3603.28**. Pails **B 3603.22-24** contain the large pithos scatter directly south of the fenestrated stand. The fineware pulled from around this scatter is denoted as **B 3603.31**. The small scatter to the west of the fenestrated stand was gathered as **B 3603.29**. Pails **B 3603.25-26** and **B 3603.30** contain the largest scatter to the south of the previous pithos scatter. The fineware collected from the removal of this pail is denoted as **B 3603.32**, and contains the top to a legathos. The remaining pails were taken to gather surface pottery from the northernmost section of the trench, in which the floor surface has been lost. **B 3603.33** contains fine and coarseware while **B 3603.34** contains a coarseware base and a single object, a stone tool object # 22).

B 3604, as previously discussed, was given to the wall that runs roughly north to south through the middle of B 3600.

Discussion and Conclusions:

The proximity of the ancient habitation surfaces to the surface in this trench rendered much of the floor surface heavily eroded. Therefore, the definition of the floor was lost, as was much of the architectural context. Fortunately, an array of well preserved pottery was recovered fairly easily, including a number of pithoi and black glazed fineware incised with decorations. No definitive evidence has surfaced from soil samples, however, the presence of the stands and the pithoi suggest that this area was used more for public use than for private utilization.

* Scatter elevations and locations are marked on the photographs included within the notebook.

Year 2005 Trench/Locus ~~B3600~~ B3601 Excavator GCP

Elevations

Benchmark used: RG1

Reading on

Benchmark: 345.824

H.I.:

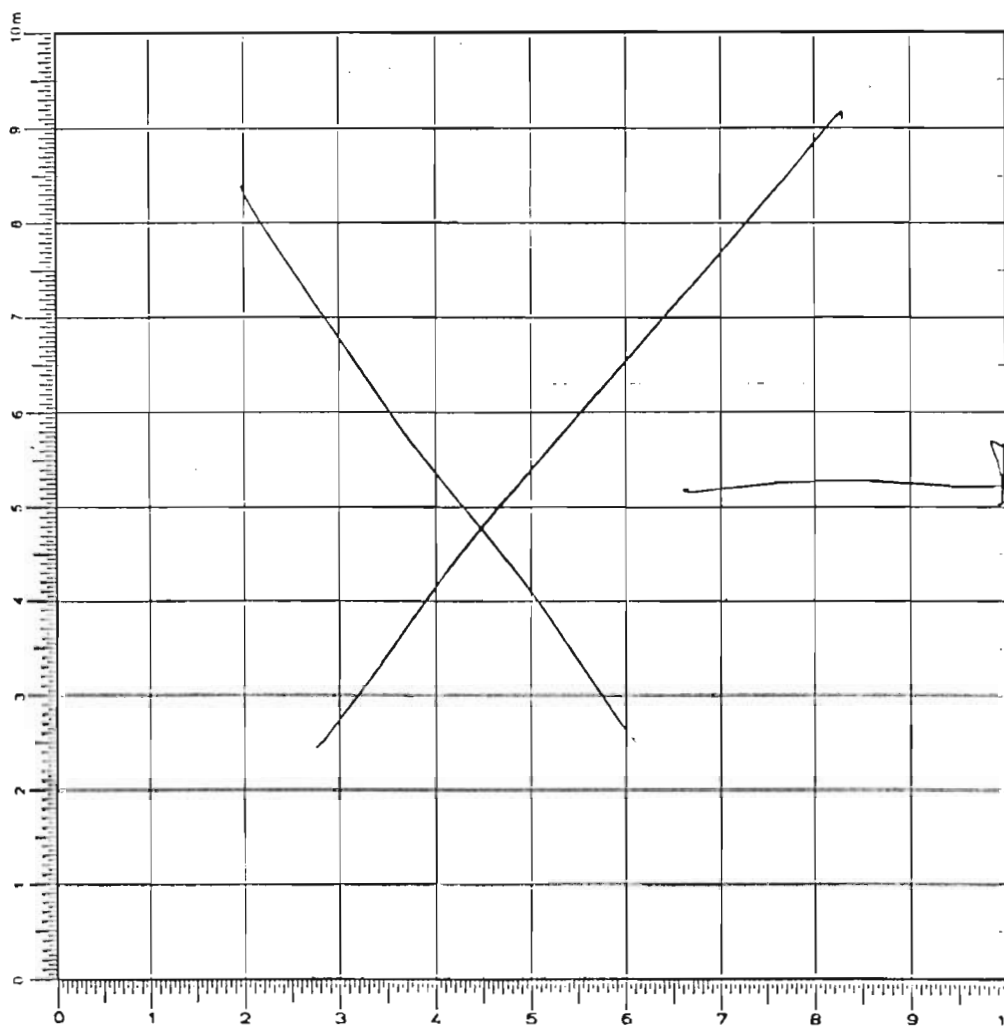

see
Page 3

SKETCH 1:75 N

1

DEFINITION/DESCRIPTION of LOCUS (explain why you changed locus numbers):

Today's date: 6th July 05 Locus above: None

Locus parameters: 7.4 x 4.6 x 7.15 x 3.3m (see picture)

Verbal description: topsoil - loose, rocky, red brown soil filled w/roots;
north of B3200 (though connected). Western slope

Locus Interpretative Comments (What do you think this is? DATE your comments, continue on additional pages if necessary):

Topsoil

[illegible][illegible][illegible]

Year 2005 Trench/Locus B 3601 Excavator GCP

DESCRIPTION of PROGRESS of EXCAVATION [date each entry and identify associated pottery pair(s)]:

6th July

[B 3601.1] in conjunction with [B 3601.2] covers the first pass taken over the new trench (too much pottery to all fit in one bag so put into 2). Run of the mill topsoil - loose, rocky, full of roots, red/brown soil. Pottery, but no bone is collected, including pithoi pieces. No objects. Seems to be bedrock material to the NE corner behind linear accumulation running NW-SE.

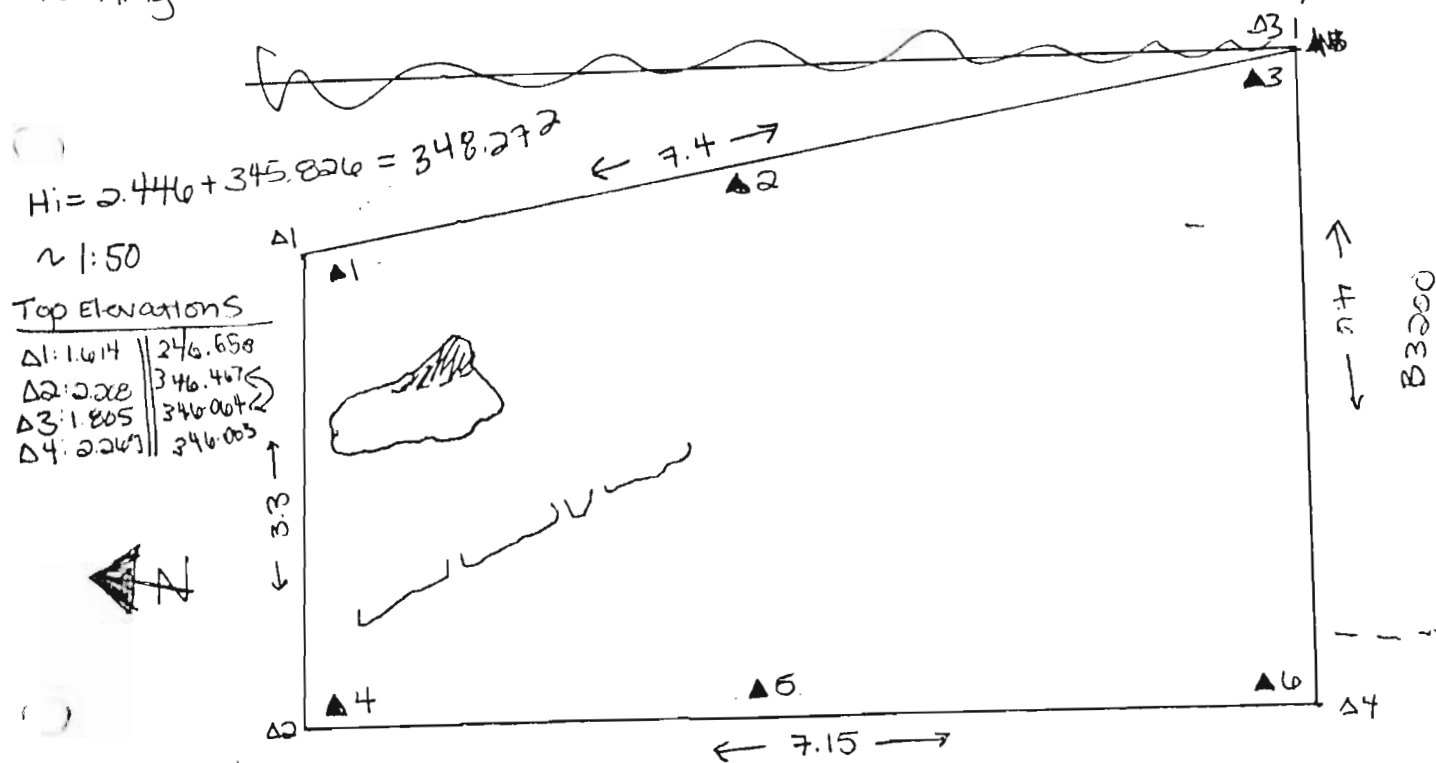

7th July expansion to the north, is ultimately to the west.

[B 3601.3] Pottery, coarseware mostly, is pulled up. No bone.
See next page for larger pic.

div + whole
of excav

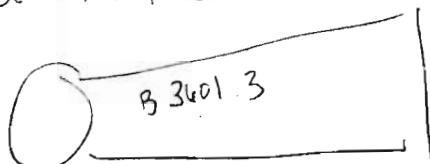

AZORIA Project

p. 4

Year 2005 Trench/Locus B 3601 Excavator GCP

DESCRIPTION of PROGRESS of EXCAVATION [date each entry and identify associated pottery pail(s)]:

7th July expansion west - pottery, coarseware - no bone

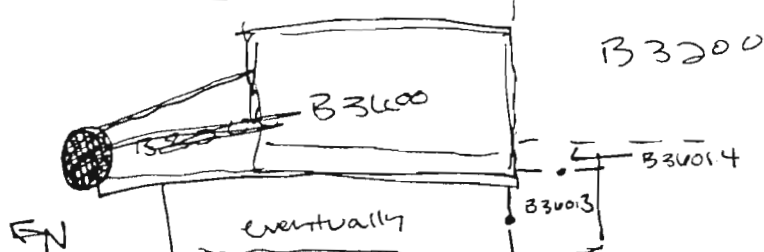

8th July B 3601.4 scrape removal left to protect B 3200 yesterday. Small pass. Very little pottery, no bone.

X H: 2.411
A1 ~~2.405~~ 2.405
A2 ~~2.391~~ 2.391
A3 2.404
A4 ~~2.401~~ 2.401

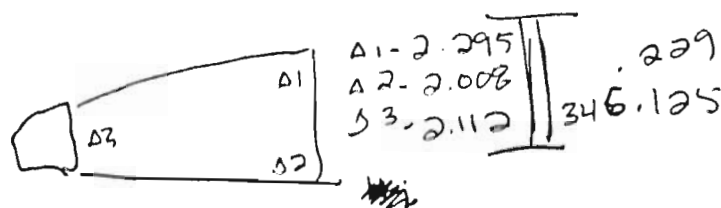
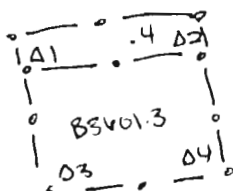

8th July B 3601.5 the "eventually" from above. Topsoil removal. No bone. Mostly coarseware.

Year 2005 Trench/Locus B 3602 Excavator GCP**Elevations**

Benchmark used: RG1
 Reading on
 Benchmark: 345.826
 H.I.:

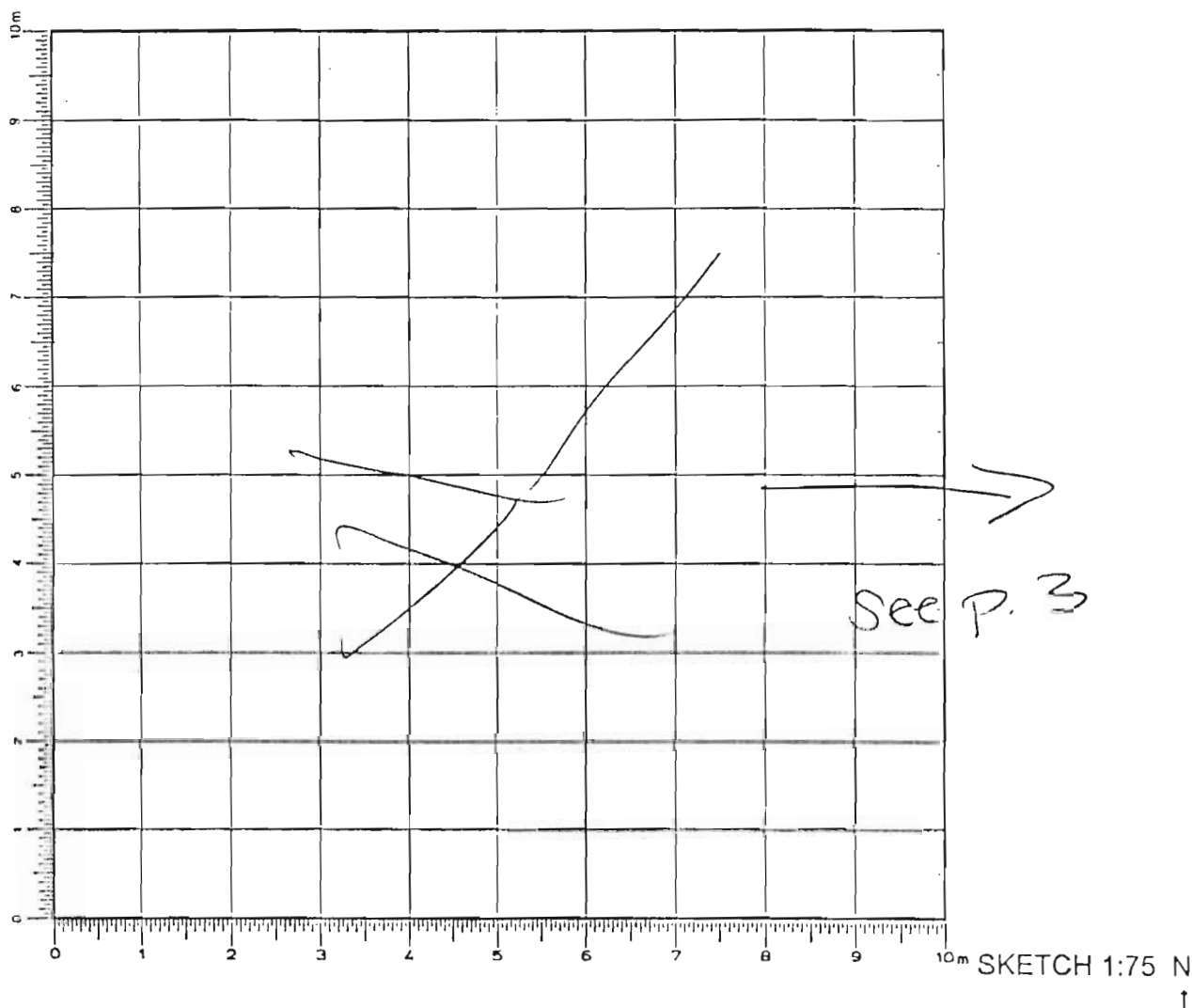

DEFINITION/DESCRIPTION of LOCUS (explain why you changed locus numbers):

Today's date: 6th July 05 Locus above: B 3601Locus parameters: 7.4 x 4.6 x 7.15 x 3.3 m

Verbal description: slopedash - loose rocky red/brown soil; north of
B 3200, west slope

Locus Interpretative Comments (What do you think this is? DATE your comments, continue on additional pages if necessary):

Eroded slopedash from terraces above.

Year 2005

Trench/Locus

B 3602

Excavator GCD

Locus/Pottery Pail Number	Weight of Sherds	Number of Sherds	Chronology & Comments
B 3602.1			
B 3602.2			
B 3602.3			
B 3602.4	.194	20	LA
B 3602.5	.26	9	Hell, LA, A? (only coarse)
B 3602.6	.111	7	LA?
B 3602.7	.16	1	LA (only coarse)
B 3602.8	.135	12	Ave, LMIEC?
B 3602.9	.36	3	LA
B 3602.10	.901	27	LA
B 3602.11			
B 3602.12			

OBJECTS

Object Number	Associated Pottery Pail	Identification (material/form)	Location	Elevation	Catalogue Number
1	B36022	pumice	within wall		
2	Σ	stone tool	Σ (see		
3	Σ	stone weight	Σ (pic.)		
4	Σ	pumice	Σ	345.758	
5	Σ	loom weight	Σ		
6	Σ	loom weight	Σ ceramic		
7	Σ	pumice	Σ		
8	Σ	stone weight	Σ		
9	Σ	stone tool - hammer?	Σ	345.79	
10	Σ	stone tool weight		345.821	

ADDITIONAL COLLECTED MATERIAL

ADDITIONAL COLLECTED MATERIAL

[illegible]

Year 2005 Trench/Locus B3602 Excavator GCP

DESCRIPTION of PROGRESS of EXCAVATION [date each entry and identify associated

pottery pail(s)]:

6 July B3602.1 taken through slopewash-loose rocky, red/brown soil mostly void of roots. Only pottery, no bone, only through 1.2m from S to N.

7th JulyB3602.2 Continuation of pass through slopewash. Concentration is

on the western half, below the linear accumulation thought to be a wall.

Traces of a clay are found along the western edge, though are above

Pithoi scatters (small scatters). A pithoi (base?) is found (round

object in diagram), the linear accumulation extends

to the south. Bone & pottery are found, including a portion of

a lamp. 3 objects emerge in quick succession from the

'same area: pumice (1), stone

tool (2), stone weight

(3). Measurements

are taken, see

diagram. A

flat, roundish

- N
 ② - hammer - stone
 ① - loom weight M
 X - pumice
 O - stone bol
 ③ - stone weight
 ④ - tool #10
 ⑤ - stone weight
 ⑥ - stone weight

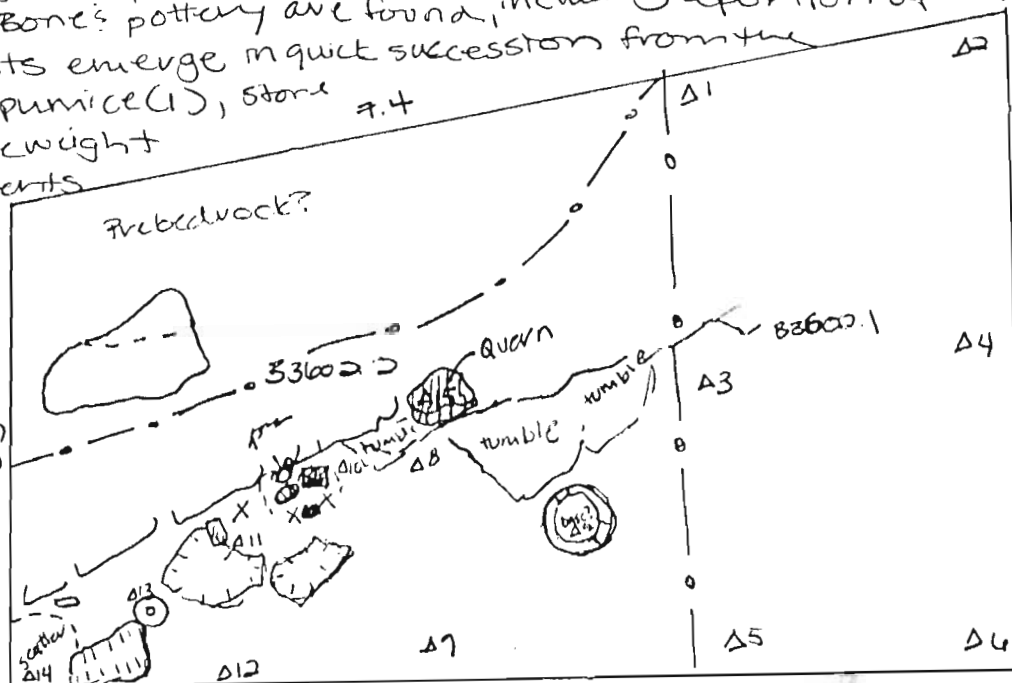

Quern.

Stone emerges within (on top of the wall, smoothed on the exposed surface. More objects emerge! 4 - pumice, 5 - loom weight, 6 - loom weight (both ceramic). All from same area. More pumice - 7, Object 8 found in the NW corner - stone "donut" weight, hand w/ nicely rounded hole. And another! 9 - stone tool, hammer? 10 - stone tool: small, ~10cm long, ~3cm thick, rounded smooth edges, long

A1-2.211	346.011	12-2.431	345.791
A2-2.082	346.14	13-2.401	345.821
3-2.392	345.83	14-2.309	345.913
4-2.409	345.813	15-2.322	345.9
5-2.455	345.767		
6-2.400	345.822		
7-2.413	345.809		
8-2.449	345.773		
9-2.449	345.773		
10-2.464	345.758		
11-2.432	345.79		

this pass
 pottery split
 into 2 bags (2 passes)
 labeled B3602.2 & B3602.3
 all objects under B3602.2

$$H = 2.396 + 345.824 = 348.222$$

Year 2005 Trench/Locus B 3602 Excavator GCP

DESCRIPTION of PROGRESS of EXCAVATION [date each entry and identify associated pottery pail(s)]:

8th July B3602.3 Pass through slopewash under B3601.4; South part of B3601.3. Little pottery, mostly coarse.

B3602.4 Another pass taken to bring the bank down to define the Western portion of B3207; the possible doorway leading into B3600 from B3200.

Bottom Δs of .4

Δ1	Δ2
Δ3	Δ4
Hi = 2.409	348.235
Δ1: 2.574	345.441
Δ2: 2.568	345.467
Δ3: 2.480	345.755
Δ4: 2.550	345.685

B3602.5 more bank removal.

B3602.6 Again, more slopewash; modern terrace wall removal.

B3602.7 - pottery, still no bone

B3602.8 - pottery, no bone. Bank removal.

B3602.9 - " "

B3602.10 - " " one stone continuation of B3207.

Bottom Δs for .6

Δ1 2.783	345.452
Δ2 2.899	345.336
Δ3 2.766	345.469
Δ4 2.904	345.331

(same corners as the left)

11 July B3602.11 Pass through slopewash in extension west. to bring surface down to previously excavated level. Area swept for pictures.

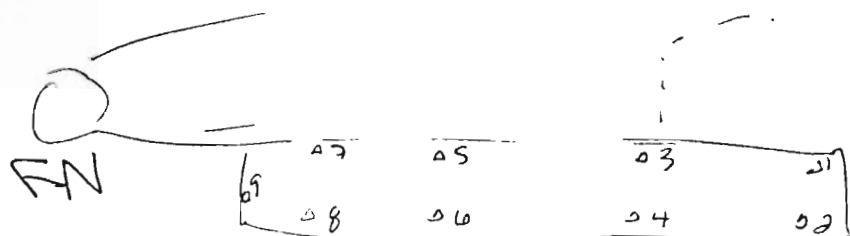

No bone but lots of coarse ware is found, including pithoi fragments. Two bags were needed to contain all the pottery. Thus, 2 pail #s used, the second being B3602.12

Δ1 2.343	345.752
2 2.359	345.736
3 2.349	345.746
4 2.422	345.673
5 2.355	345.740
6 2.389	345.706
7 2.289	345.806
8 2.240	345.835
9 2.191	345.904
Hi = 2.269	→ 348.095

Year 2005 Trench/Locus B 3003 Excavator GPPElevations

Benchmark used: RC1
 Reading on
 Benchmark: 345.826
 H.I.:



□: "work platform"

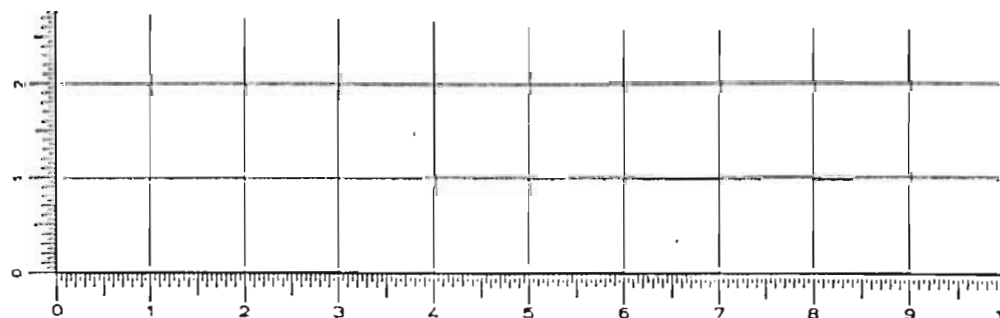
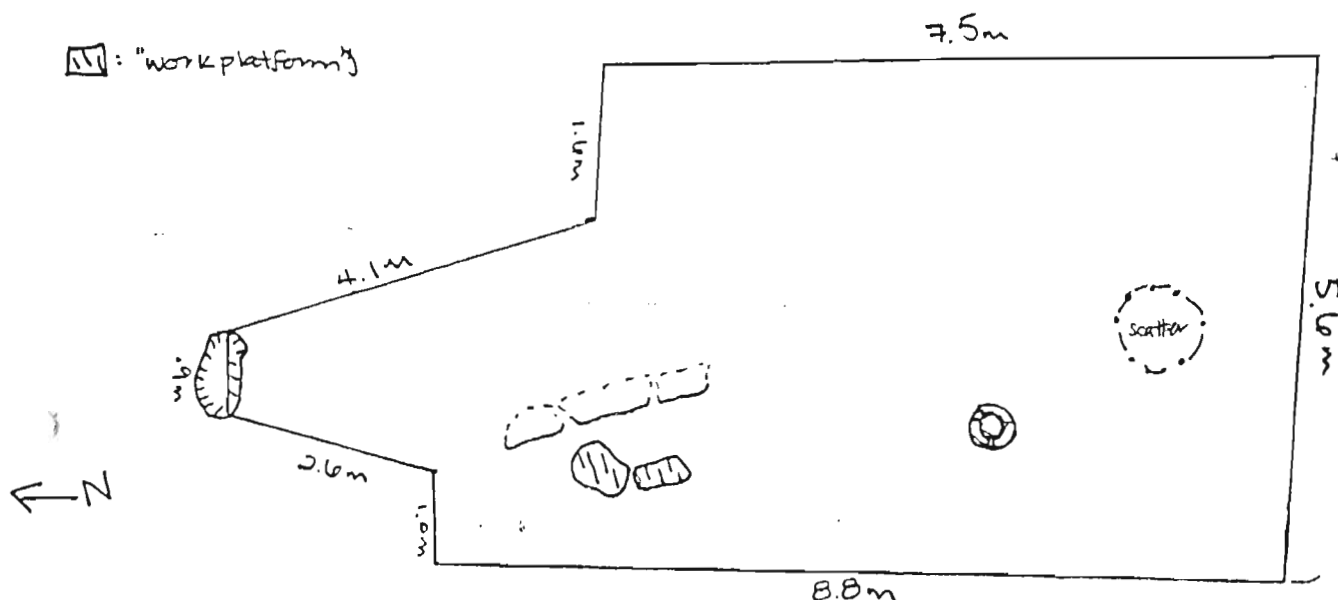

SKETCH 1:75 N

DEFINITION/DESCRIPTION of LOCUS (explain why you changed locus numbers):

Today's date: 7th July 05 Locus above: B 3002Locus parameters: (see above) 7.5 x 5.6 x 8.8 x 1.0 x 2.4 x .9 x 4.1 x 1.6 mVerbal description: Roofing clay & rocky mixture: north of B 3000; western slope

Locus Interpretative Comments (What do you think this is? DATE your comments, continue on additional pages if necessary):

Extreme disturbance
Slopewash & roofing clay mixture - due to proximity
to the surface

AZORIA Project

p.2

Year 2005 Trench/Locus B 3603 Excavator GCP

Locus/Pottery Pail Number	Weight of Sherds	Number of Sherds	Chronology & Comments
B 3603.1			
B 3603.2			
B 3603.3			
B 3603.4			
B 3603.5			
Same S. 6			
pass C. 7			
. 8			
pithoi . 9			
ant under . 10			
. 11			
Same S. 12			
pass C. 13			

→ next page OBJECTS

Object Number	Associated Pottery Pail	Identification (material/form)	Location	Elevation	Catalogue Number
B 3603.2	1	stone tool			
B 3603.6	2				
{	3				
{	4				
{	5				
I	6				
7	B 3603.8	pumice	{ D 4 }		
8	{	stone tool			
9	I	stone tool			

~~20 objects, see progression sheet~~
ADDITIONAL COLLECTED MATERIAL

Locus/Pottery Pail Number	Bones	Shell	Carbon	Pumice	Soil Sample	Other (specify)
B 3603.1	1 std					
B 3603.3	2 (std)				3 int	
B 3603.6	1 1/4"				3 int	
B 3603.8	1 1/4"				2 int	
B 3603.10	1 1/4"					
B 3603.11	1 1/4"					
B 3603.12	1 1/4"				1 int	
B 3603.14	1 1/4"					
B 3603.15	1 1/4", 1 std					
B 3603.16	1 1/4", 1 std					
.17	1 1/4"					
.18	1 1/4"					
.22	1 1/4"					
.25	1 1/4"					

Year _____ Trench/Locus _____ Excavator _____

Elevations

Benchmark used:

Reading on

Benchmark:

H.I.:

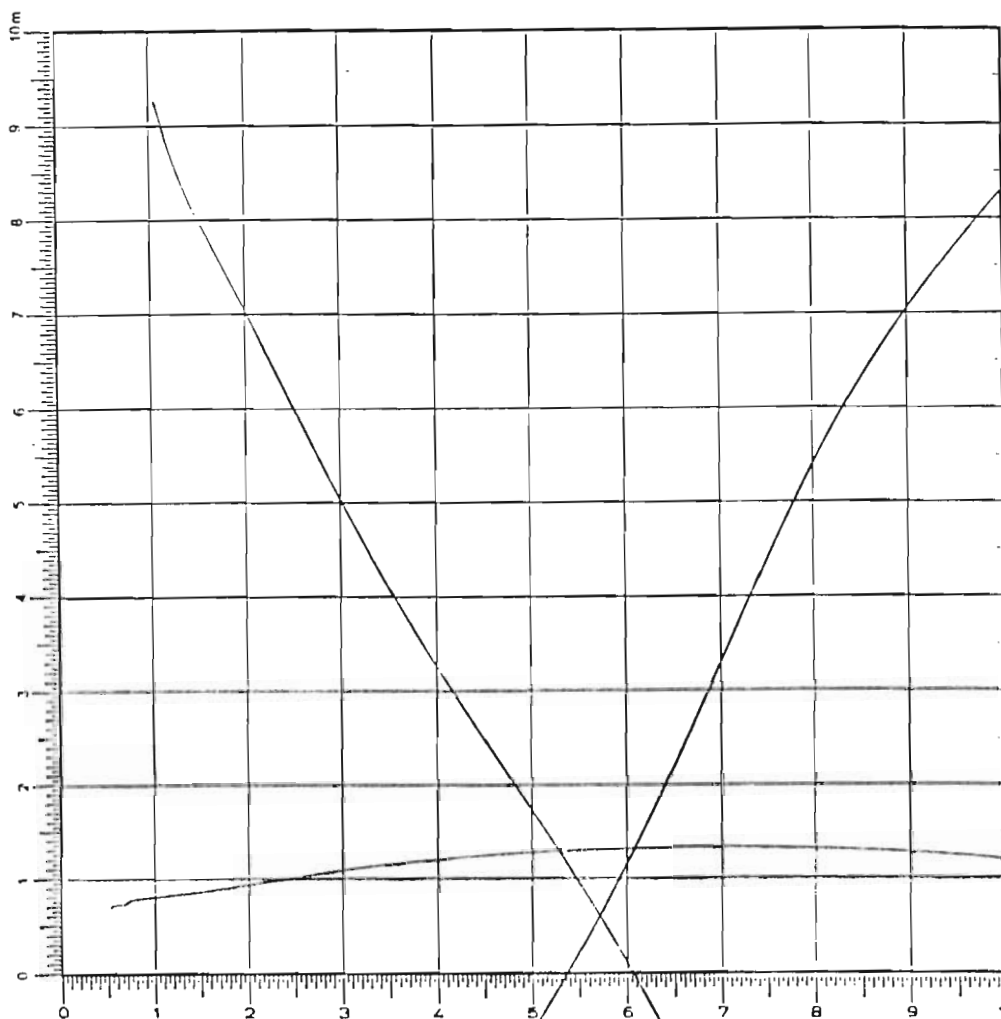

SKETCH 1:75 N

DEFINITION/DESCRIPTION of LOCUS (explain **why** you changed locus numbers):

Today's date:

Locus above:

Locus parameters:

Verbal description:

Locus Interpretative Comments (What do you think this is? DATE your comments, continue on additional pages if necessary):

AZORIA Project

p.2

Year 2005 Trench/Locus B 3603 Excavator GCP

OBJECTS

Locus/Pottery Pail Number	Weight of Sherds	Number of Sherds	Chronology & Comments
Object #	Pail	ID	Elevation
10	.8	pumice	345.886
11	.8	ceramic spindle whorl	345.996
12	.15	iron hook	345.636
13		pumice	.646
14		iron	.636
15		ceramic spindle whorl	.631
16		" "	.641
17		shell	.686
18	.16	pumice	.681
19	.16	stone weight	
20	.17	GIVEN	.526

OBJECTS

Object Number	Associated Pottery Pail	Identification (material/form)	Location	Elevation	Catalogue Number
21	.20	stone weight	p 7	345.766	
22	.34	stone weight	p 8	345.566	

Pottery Pails

Locus/Pottery Pail Number	Bone Weight	#	Carbon Chronology	Pumice Sample	Other (specify)	Weight
.14						
.15						
.16						
.17						
.18						
.20						
.21						
.22						
.23						
.24						
.25						
.26						
.27						
.28						

AZORIA Project

p.1

Year _____ Trench/Locus _____ Excavator _____

Elevations

Benchmark used:

Reading on

Benchmark:

H.I.:

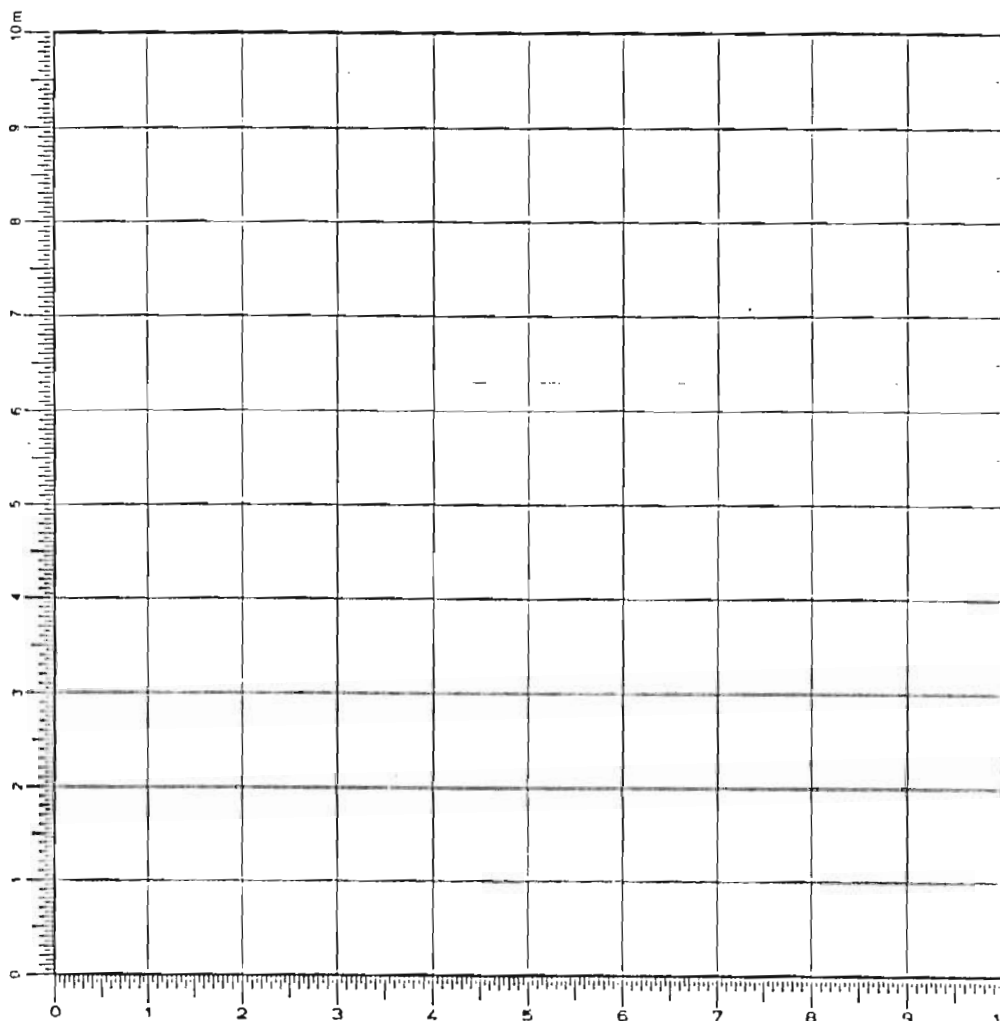

SKETCH 1:75 N

↑

DEFINITION/DESCRIPTION of LOCUS (explain why you changed locus numbers):

Today's date:

Locus above:

Locus parameters:

Verbal description:

Locus Interpretative Comments (What do you think this is? DATE your comments, continue on additional pages if necessary):

AZORIA Project

p.2

Year 2005 Trench/Locus B3603 Excavator GCP

Locus/Pottery Pail Number	Weight of Sherds	Number of Sherds	Chronology & Comments
.14			
.15			
.16			
.17			
.18			
.19			
.20			
.21			
.22			
.23			
.24			
.25			

↓

03/12/2018

Object Number	Associated Pottery	Pail Identification (material/form)	Location	Elevation	Catalogue Number
26					
27					
28					
29					
30	45.65	142			
31					
32					
33					
34					

ADDITIONAL COLLECTED MATERIAL

[illegible]

Italkias

AZORIA Project

p. 3

Year 2005 Trench/Locus B3603 Excavator GCP

DESCRIPTION of PROGRESS of EXCAVATION [date each entry and identify associated pottery pile(s)]:

7th July 05

B3603.1 Small pass taken through the rocky clay in search of a floor surface. The pottery scatters; architecture suggest that we may be near a surface. Soil appears clay ridden, though not densely packed. Some rubble remains along the "wall" line, where less dirt resides in the matrix. Excavation is conducted to the west of the "wall" line only, with the assumption that to the east lies bedrock. More pottery scatter emerges. Pass halted in the name of expansion. Pottery sealed. No bone.



11th July "wall" cleanup by Peggy B3603.2 Possible stone tool found within wall tumble. (obj # 1 for locus)

~~B3603.4~~
B3603.6 Full pass taken through the trench, west of the "wall". All clay is sieved. Lots of 7. See back of page for drawing: 45 of stone tools. 5 stone tools (overns) pulled - obj 2-6 in locus. 1 bag not enough for pottery → 2 pails B3603.7 as well. Burning found just north of fluted stand (set back →) Int soil sample taken.

40 3 samples taken in all (see back) →

Year 2005 Trench/Locus B 3603 Excavator GCP

DESCRIPTION of PROGRESS of EXCAVATION [date each entry and identify associated pottery pail(s)]:

□: "work platform"

■: boulder

X: pumice

⊗: spindle whorl (11)

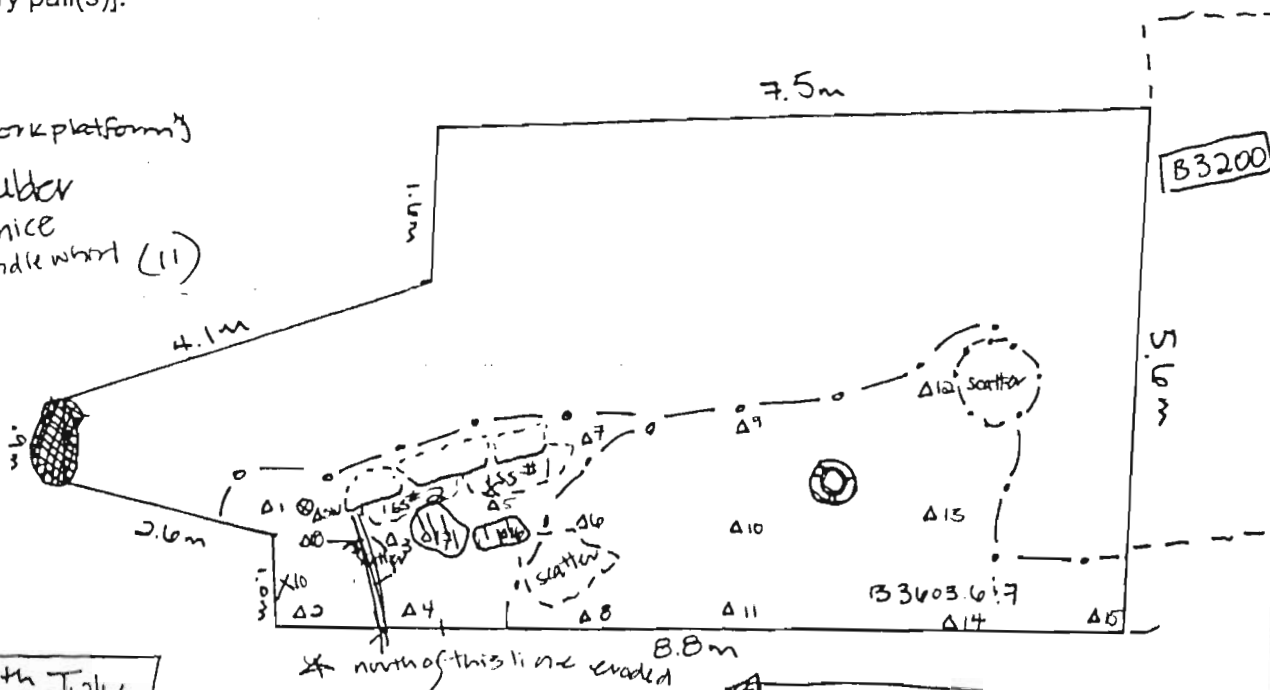

12th July

B3603.8 - continuation of pass through dense roofing clay, sieving all & taking intensive soil samples. Pumice (obj 7 in locus) is found (see X), in close proximity to 2 stone tools (obj. 8 & 9) that lay to the north. Large amounts of fine ware continue to emerge (coarseware). Another pumice (obj. #10) chunk is found to the west. The further north we move, the less defined the clay becomes. Less clay is observed, & more loose fine dirt emerges.

Perhaps a compromise in preservation due to proximity to the surface. Another obj. #11, found - ceramic spindle whorl. Area swept for pictures, & pithoi removed.

B3603.9 pithoi scatter (small to north) removed

B3603.10 dirt under pithoi & pottery separate. Pass to protect fine ware; mainly eroded loose dirt, yet all sieved.

B3603.11

B3603.12

See next page

Hi - 2.32	7348.146
Bottom AS	
12.15	345.996
22.26	764
32.38	716
42.43	786
52.36	746
62.40	764
72.38	686
82.46	726
92.42	646
102.50	676
112.47	726
122.42	716
132.43	676
142.47	694
152.45	936
162.21	926
172.22	936
182.21	876
ASN: 2.27	

Year 2005 Trench/Locus B3603 Excavator GCP

DESCRIPTION of PROGRESS of EXCAVATION [date each entry and identify associated pottery pail(s)]:

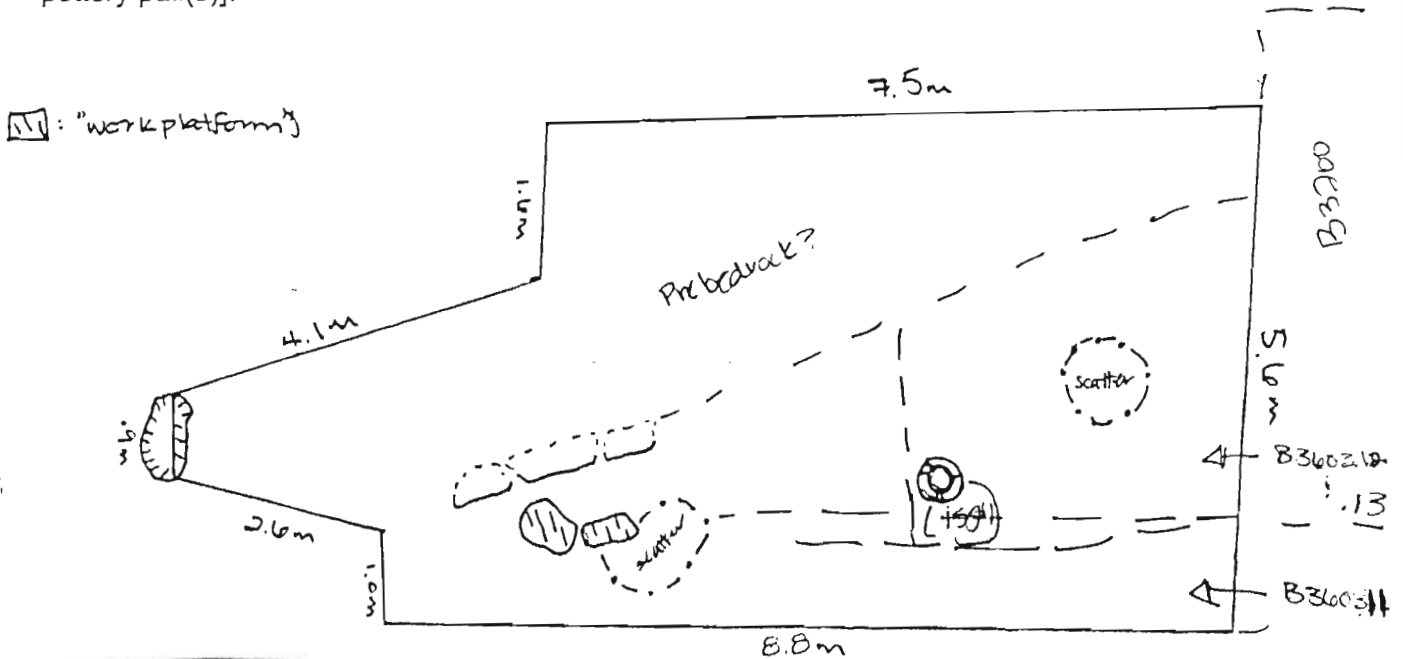

12 July (cont...)

~~B3603~~ B3603.12

Nikoli's eastern half of active portion of trench. Roofing clay: tumble - All sixed, southernmost scatter extends, including a full handle intact - Fish mouth part found

B3603.11 Niko = western half of active portion of the trench; roofing clay: extend loose dirt; all sixed

* Nikoli's area needed 2 pairs (2 pottery bags) to hold all the pottery, given B3603.13 as well for same area. An intensive soil sample is take just west of the stand to collect red-burnt soil.

13 July

B3603.14

continuation of Nikoli's pass through excavated slope wash to the west (clay mixture)

the west (clay mixture)



[Handwritten signature]

Year 2005 Trench/Locus B3603 Excavator GCP

DESCRIPTION of PROGRESS of EXCAVATION [date each entry and identify associated pottery pail(s)]:

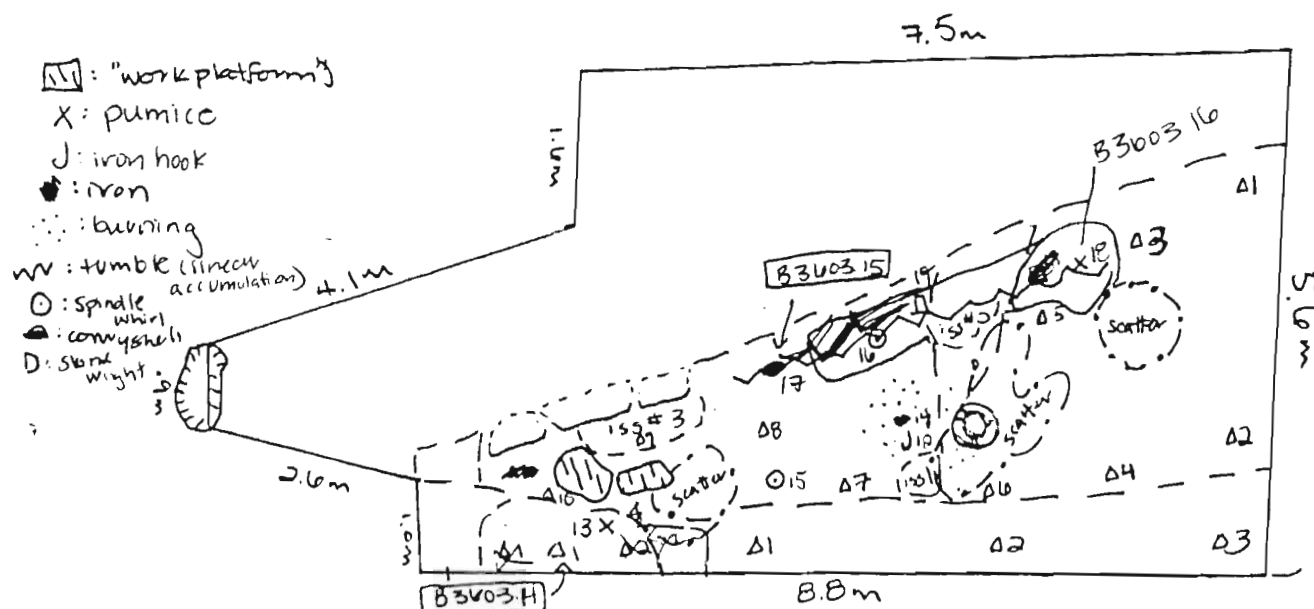

13 July

B3603.14

Continuation of B3603.11 from the 12^m; pumice (see X) found (obj #13)

B3603.15

Continuation of B3603.12 & 13; iron "hook" found (obj #12 in locus) in burned dirt to the north of the fenestrated stand (round object in drawing). Intensive soil sample taken (see diagram). Another piece of iron is found around the stand (to the north) object #14. A spindle whorl (ceramic) (obj #15) is found. Another spindle whorl (obj 16). A conch shell (obj 17) is also found. Small amount of bone found.



Bottom Δ5

H1=2.33

OBJECTS

B3603.14

B3603.14

12: 2.52	.630
13: 2.51	.640
14: 2.52	.636
15: 2.525	.631
16: 2.515	.641
17: 2.47	.680

Δ1 2.53

Δ2 2.57

Δ3 2.56

Δ4 2.57

Δ5 2.56

Δ6 2.56

Δ7 2.56

Δ8 2.56

Δ9 2.56

Δ10 2.56

Δ11 2.56

Δ12 2.56

Δ13 2.56

Δ14 2.56

Δ15 2.56

Δ16 2.56

Δ17 2.56

B3603.16 clearing of tumble just north of southernmost scatter (around jagged line above in diagram). A large hunk of pumice (obj 18). Small amount of bone found around (west) of the wall. Tumble cleared from along a linear accumulation, revealing a number of flat stones arranged linearly protruding from the line of the original wall. Stone weight (obj 19) see above diagram.

Δ1 Δ2 Δ3

Δ1
2
3

Δ1

H1=2.33

Year 2005 Trench/Locus B 3603 Excavator GCP

DESCRIPTION of PROGRESS of EXCAVATION [date each entry and identify associated pottery pail(s)]:

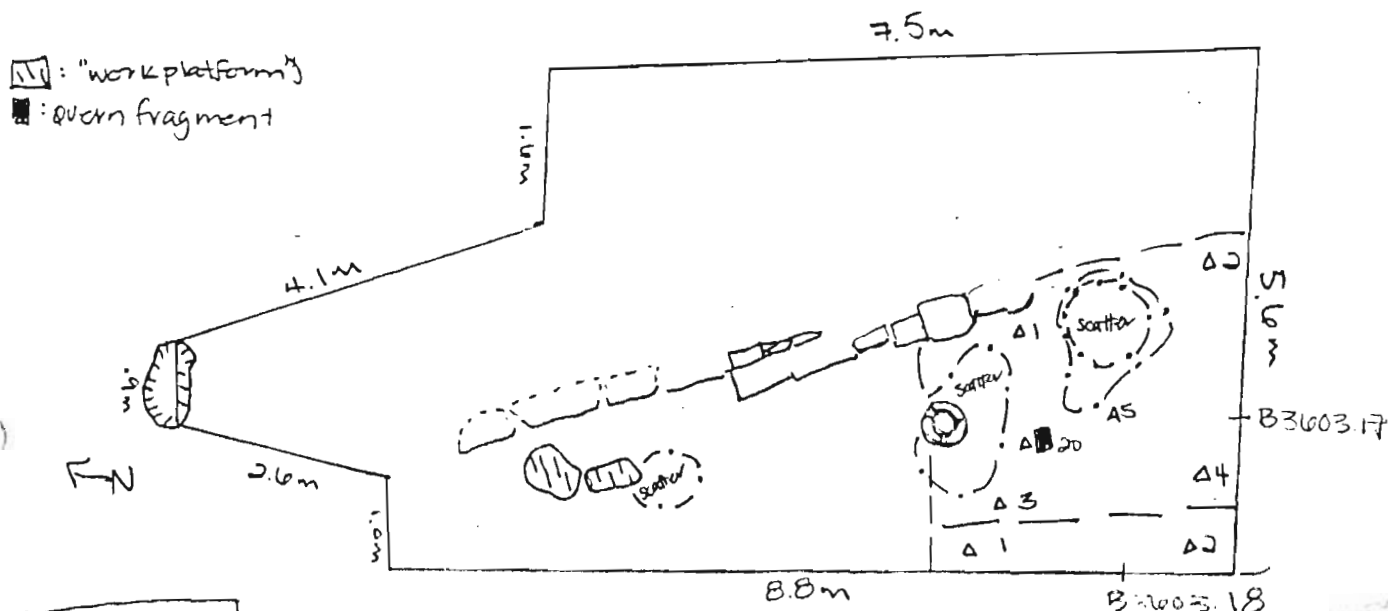

13 July (cont.)

[B 3603.17] following what we hope to be the floor, exposing remaining pit holes. All clay is screened. A possible quern fragment is found (obj 20). No bone emerges, but moderate pottery (recuse fine) does.

[B 3603.18] Quick pass west to search for floor. Coarse ware, no bone.

Bottom Δ5

B 3603.18	345.500
Δ1: 2.70	
Δ2: 2.72	.480
B 3603.17	.580
Δ1: 2.62	
Δ2: 2.55	.450
Δ3: 2.71	.490
Δ4: 2.70	.500
Δ5: 2.57	.630
Δ6: 2.68	.550

H: 2.38

14th July

Removal of pottery!

[B 3603.19] Stand pulled up

Δ1: 2.49	.716
Δ2: 2.505	.701
Δ3: 2.48	.724

[B 3603.21] Stand (ferrostrat)

Top Δ: 2.39	.816
bottom: 2.60	.600

[B 3603.22] (north half)

[B 3603.23] (south half)

Δ1: 2.55 | 345.451
Δ2: 2.61 | .590
Δ3: 2.52 | .480

Int sample (#1)

[B 3603.20] p.m. (north side)

Δ1: 2.44	345.740
Δ2: 2.46	.740

AST:

Int sample
soil (#1)
sample taken
obj # 21 - stone
weight
1 std bone bag

[B 3603.31] just pottery from vessel

Hi: 2.38

B3603.26

Handled pitno; (south scatter)

$\Delta 1: 2.57$
 $\Delta 2: 2.28$
 $\Delta 3: 2.59$
 $\Delta 4: 2.45$

Screened dirt

$\Delta 2: 2.64$

$\Delta 1: 2.67$

B3603.25

B3603.30



B3603.209

West of South scatter (small scatter)

$\Delta 1: 2.63$
 $\Delta 2: 2.595$

Screened dirt

B3603.27 Fineware around north scatter

B3603.28 Fineware around fenestrated stand

B3603.32 Fineware from large (south) pitno; # top of a legathos

B3603.33

pottery

B3603.34

Base # 22 stone to (to the north)

AST: 2.64

DESCRIPTION of PROGRESS of EXCAVATION [date each entry and identify associated pottery pail(s)]:

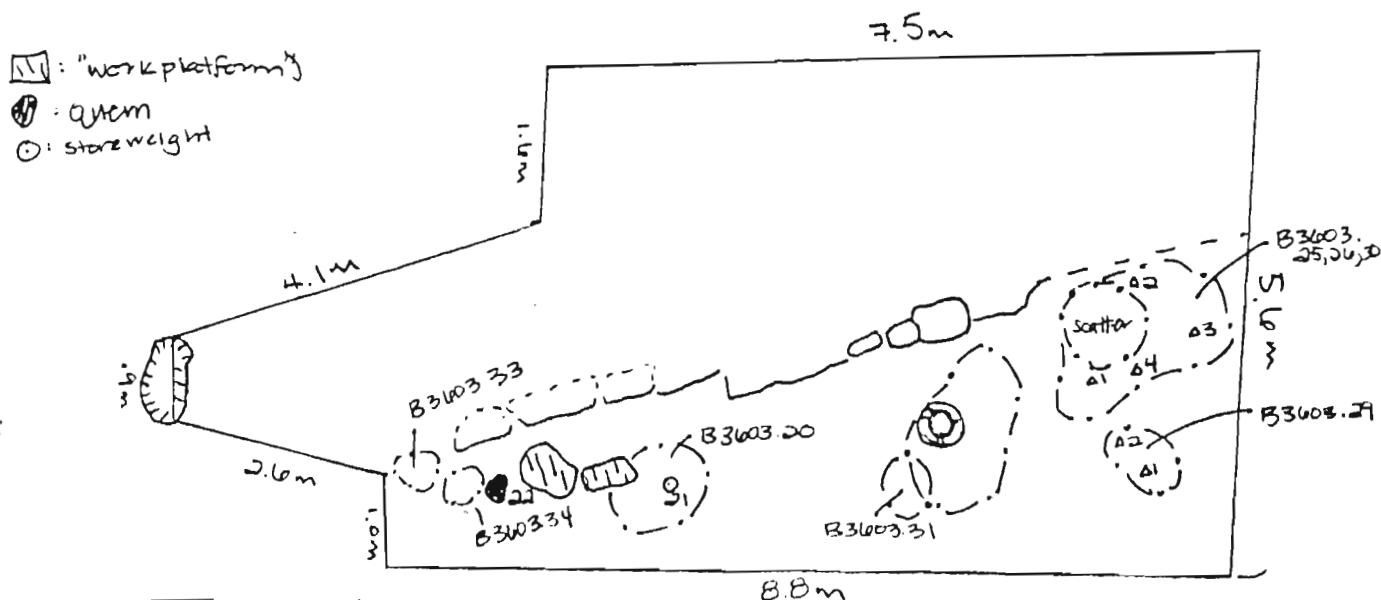

14th July continued...

B3603.25, .26, .30 Handled pithoi removal (southern most scatter); all clay/dirt sieved; taken in 3 clavas (thus 3 faults) due to number of sherds; legathos top found amongst broken sherds, sent w/ other fine ware pottery other than pithoi pulled from the area → fine ware scatter. As B3603.32

Bottom As
from center: $2.675 \mid 345.531$
of area

scatter Δs

$\Delta 1: 0.57$	345.636
$\Delta 2: 2.08$	345.926
$\Delta 3: 2.57$	345.666
$\Delta 4: 2.45$	345.756

B3603.21 Fineware removed from around B3603.20

B3603.28 Fine wire removed from around fenestrated stand [B3603.21]

[B300329] Small scatter to the west of [B3003.25, 26, 30]; all clay dirt
screened. Scatter AS || 2455710

B3603.31 (see previous page)

Scatter ΔS
 $\Delta 12.03$
 $\Delta 22.595$ || 345.576
 345.611

B3603.32 (See B3603.25 etc); finewave: 1/2 length fragment from
circa of [B3603.25, 26, 27, 28, 29, 30]

cerca of [B3603.23, 3603.33]
[B3603.33] Pottery (on surface) pulled (fine? coarse), see diagram

B3603.34 coarseware base & stone tool (obj # 22) from exposed surface to the north.

$\Delta ST: 2.64 \parallel 345.566$

Year 2005 Trench/Locus B3604 Excavator GCPElevationsBenchmark used: RGypsy 1

Reading on

Benchmark: 345.804

H.I.:

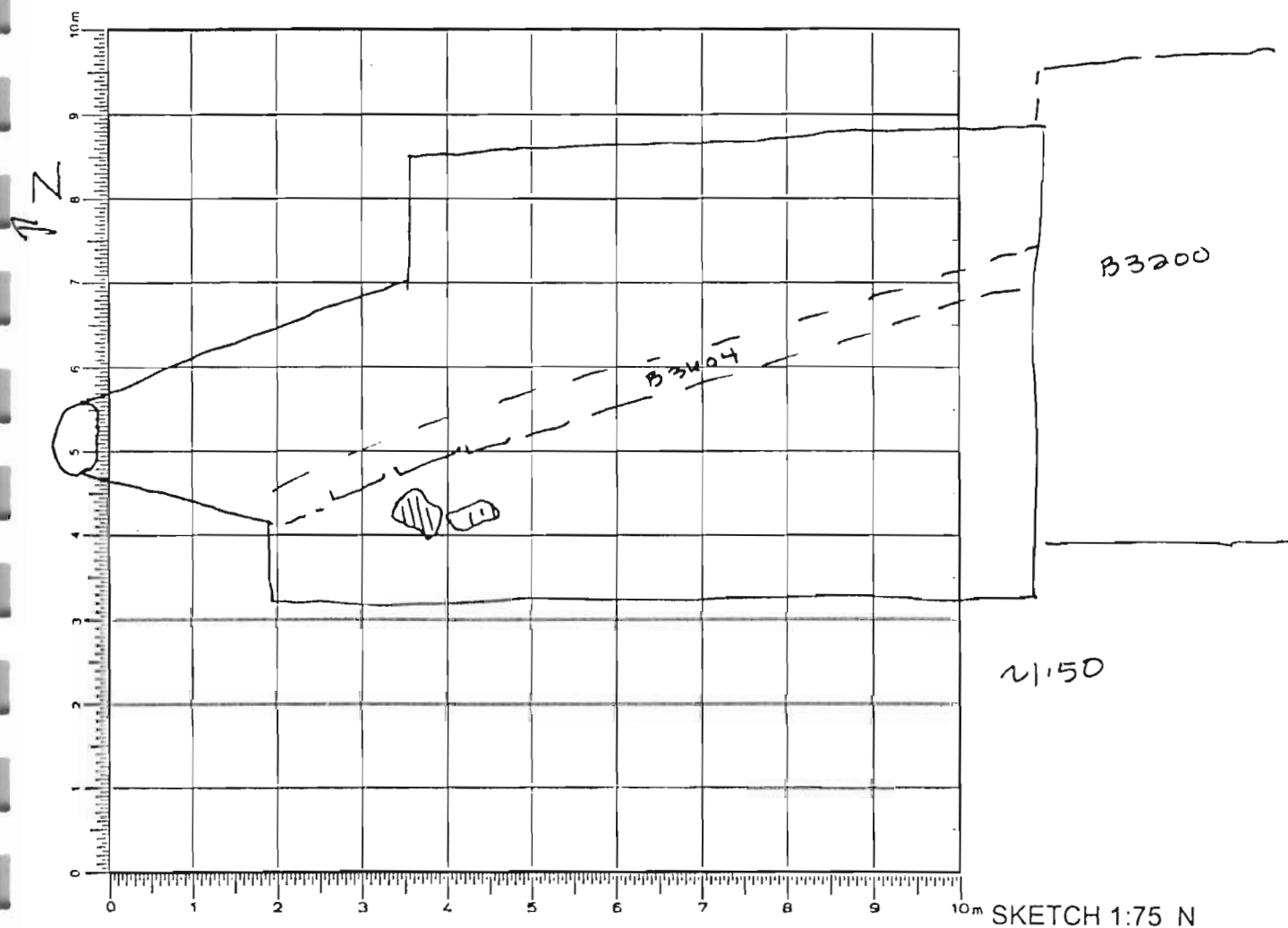

DEFINITION/DESCRIPTION of LOCUS (explain why you changed locus numbers):

Today's date: 14th July Locus above: B3602Locus parameters: ~8.4 m longVerbal description: wall (highly damaged) running N-S

Locus Interpretative Comments (What do you think this is? DATE your comments, continue on additional pages if necessary):

140 E. 9
 140 E. 5
 140 E. 4
 140 E. 3
 140 E. 2
 140 E. 1
 2/11/05
 RCF

② →

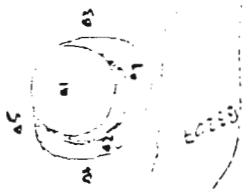

③ ←



101 E 1
 101 E 2
 101 E 3
 101 E 4
 101 E 5
 101 E 6
 101 E 7
 101 E 8
 101 E 9
 101 E 10
 101 E 11
 101 E 12
 101 E 13
 101 E 14
 101 E 15
 101 E 16
 101 E 17
 101 E 18
 101 E 19
 101 E 20
 101 E 21
 101 E 22
 101 E 23
 101 E 24
 101 E 25
 101 E 26
 101 E 27
 101 E 28
 101 E 29
 101 E 30
 101 E 31
 101 E 32
 101 E 33
 101 E 34
 101 E 35
 101 E 36
 101 E 37
 101 E 38
 101 E 39
 101 E 40
 101 E 41
 101 E 42
 101 E 43
 101 E 44
 101 E 45
 101 E 46
 101 E 47
 101 E 48
 101 E 49
 101 E 50
 101 E 51
 101 E 52
 101 E 53
 101 E 54
 101 E 55
 101 E 56
 101 E 57
 101 E 58
 101 E 59
 101 E 60
 101 E 61
 101 E 62
 101 E 63
 101 E 64
 101 E 65
 101 E 66
 101 E 67
 101 E 68
 101 E 69
 101 E 70
 101 E 71
 101 E 72
 101 E 73
 101 E 74
 101 E 75
 101 E 76
 101 E 77
 101 E 78
 101 E 79
 101 E 80
 101 E 81
 101 E 82
 101 E 83
 101 E 84
 101 E 85
 101 E 86
 101 E 87
 101 E 88
 101 E 89
 101 E 90
 101 E 91
 101 E 92
 101 E 93
 101 E 94
 101 E 95
 101 E 96
 101 E 97
 101 E 98
 101 E 99
 101 E 100

1. 2.001
 2. 2.001
 3. 2.001
 4. 2.001
 5. 2.001
 6. 2.001

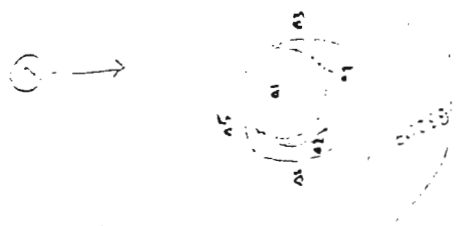

1. 2.001
 2. 2.001
 3. 2.001
 4. 2.001
 5. 2.001
 6. 2.001



1. 2.001
 2. 2.001
 3. 2.001
 4. 2.001
 5. 2.001
 6. 2.001

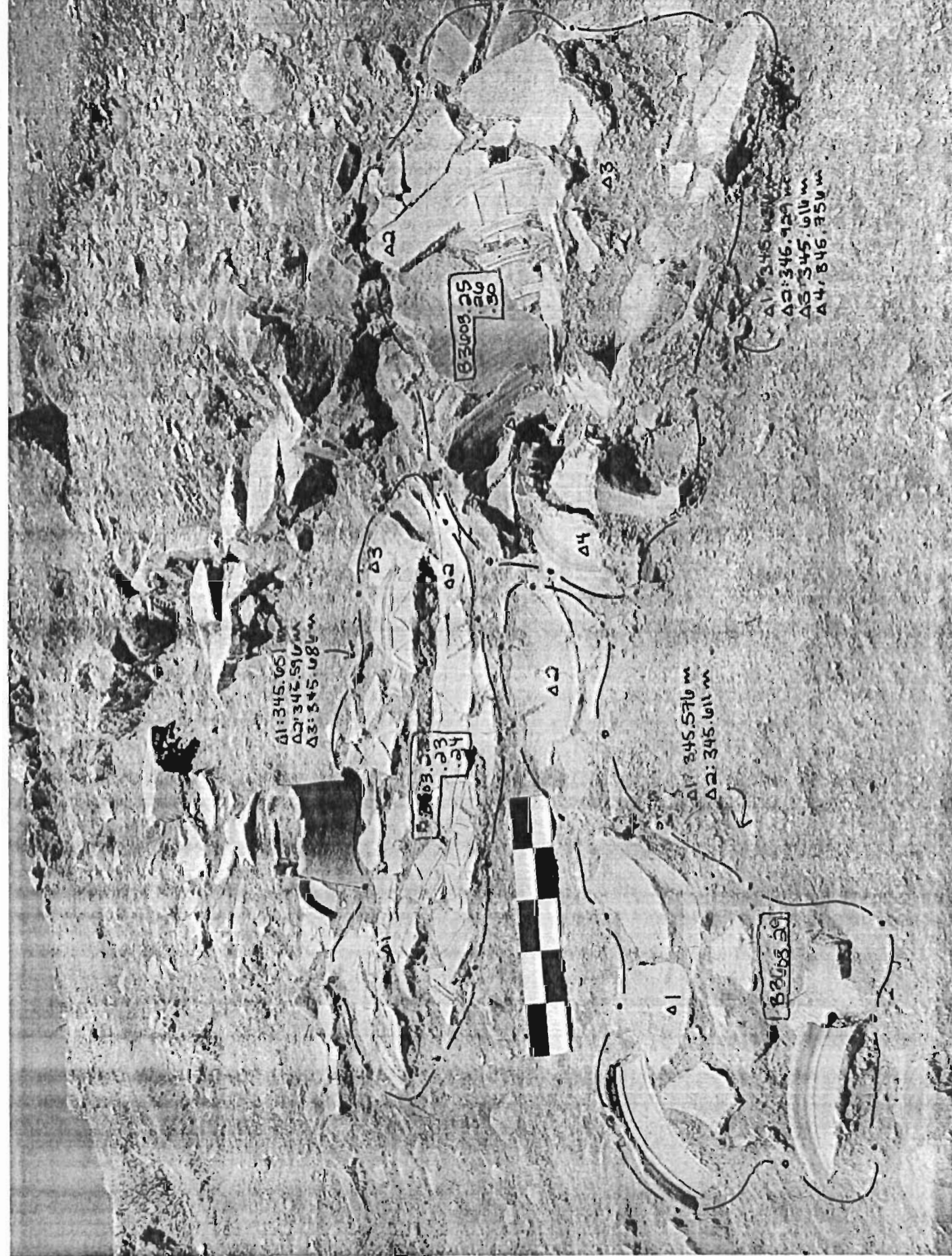

B3600
GCP
0005

27





B3600
GCP 2005