

FINAL REPORT FOR A600

MSE

27 July 2002

A600 is located on the second terrace down from the summit of the main hill of Azoria; it is directly below (i.e., west of) A800. The trench is bounded on the east by terrace wall A602, on the west by the edge of the terrace, on the north by cross-wall A607, and on the south by cross-wall A608. Its size at the start of excavation was ~6.6 m. in length (later expanded to 7.6 m to include walls A607 and 608), 4.95 m. on the south side, and 3.18 m. on the north side.

Excavations were conducted from 7 June-12 June (then stopped for the digging of A800) and continued from 5 July-16 July 2002. The workmen for this trench were Vangelis Phiorakis, Stelios Koutsakis, Michalis Sobanakis, and Manolis Maniadakis (only for 2-3 days). The trench assistants were Sara Swingler and Sandra Krebs, and the trench supervisor was Melissa Eaby. Two benchmarks were used R3, with an elevation of +364.24 m., and R4, with an elevation of +365.74 m.

Upon surface collection (A600.1) and removal of topsoil (A601 and 603), the exposure of cross-wall A604 divided the trench into two rooms, which were then excavated separately. Room 1, the north room, is bounded by terrace wall A602, cross-walls A607 and 604, and west wall A609, and it measures 2.9 m. x 1.85 m. Upon the discovery of A609 with topsoil removal, the area west of that wall was left unexcavated for this season, though another room may exist in this area. Room 2, the southern and larger room, is bounded by terrace wall A602 and cross-walls A608 and 604. A fourth wall was not found, though it may exist under the wheelbarrow path or was lost down the slope of the hill [A604, in fact, extends at least to the wheelbarrow path and possibly beyond]. Room 2 measures ~3.2 m. x 3.4 m.

Room 1 was not excavated below its extremely well-preserved floor-packing, which was revealed with the final pass taken, A612.3. For the most part, this floor, assuming that the floor has been reached, was relatively clean. Some animal bones were recovered, though in a significantly smaller quantity than found in room 2, and a possible stone quern was found in the floor near wall A609. A concentration of Archaic sherds (primarily from cookpots) was recovered in the northwest corner of the room in this final pass [there was also a concentration of pottery found with A611.1 in the same area]. It is uncertain whether or not these vessels were intentionally placed/stored in this area or were brought there from erosional activity in the room. Also associated with this floor-packing level is a possible oven/hearth (~0.8 x 0.95 m.) located in the northeast corner of the room (A613); this feature contained looser and much more orange/red soil than the rest of the room and appears to be framed by several stones. Two fragments of iron slag were found just outside this feature on the floor. Many cookpot fragments were also found in this corner. Located beside the hearth/oven and along wall A602 is a small bench (0.95 x 0.6 m) (A614) of a single course of stones in roughly 2-3 rows, which appears to rest on the floor. The doorway into this room was not determined for certain, but its location was most likely in A609, possibly in the corner where it abuts A604 or roughly in the middle of the wall.

exact relationship of the A600 rooms with these other areas has yet to be determined, though their placement directly below the “shrine” of A800, may indicate a connection between the two areas. The two rooms of A600 could have originally functioned as kitchens/work areas for the shrine and any possible complex associated with it, at least for some part of the Archaic period. All levels from room 1 clearly date to the Archaic period, and room 2 is likely contemporary, though the pottery from room 2 has not yet been read to confirm this.

AZORIA Project

Year 2002 Trench/Locus ~~1000~~ A100 Excavator MSE

Elevations

Benchmark used: rock at edge of locus
Reading on Benchmark: 1.488
H.I.: 365.728

opening reading

- 1 - 0.060
- 2 - 0.743
- 3 - 1.180
- 4 - 1.335

~~opening elevation~~
~~1 - 365.668~~
~~2 - 364.985~~
~~3 - 364.548~~
~~4 - 364.393~~

opening elevation

- 1 - 365.668
- 2 - 364.985
- 3 - 364.548
- 4 - 364.393

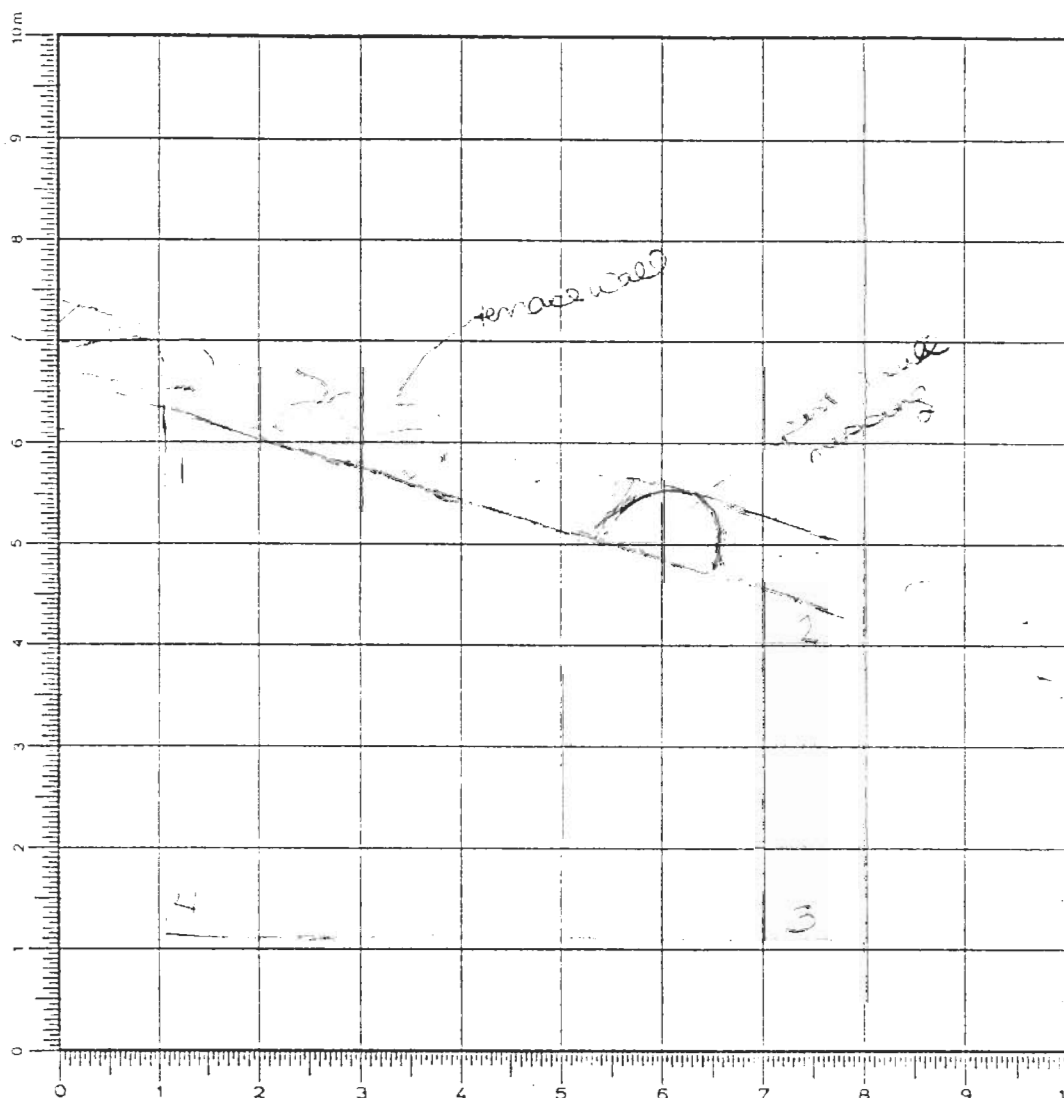

SKETCH 1:75

DEFINITION/DESCRIPTION of LOCUS (explain why you changed locus numbers):

Today's date: 7 June 02 Locus above:

Locus parameters: west trench A100 (on 2nd terrace)
(trench length = 6.6m, 4.95m (on east side), 3.18m (on west side))
Verbal description: surface cleaning

(A102) terrace wall forms east boundary of locus
edge of terrace forms west boundary

Locus Interpretative Comments (What do you think this is? DATE your comments, continue on additional pages if necessary):

modern accumulation

Year 2002 Trench/Locus A600 Excavator MSE

[illegible]

OBJECTS

[illegible]

ADDITIONAL COLLECTED MATERIAL

[illegible]

Year 2002 Trench/Locus A600 Excavator MSE

DESCRIPTION of PROGRESS of EXCAVATION [date each entry and identify associated pottery find(s)]:

7 June 02 removed weeds + brush from area; cleared surface

[A600.1] - Archaic

ancient terrace wall (A602) with modern additions forms east boundary of trench

- benchmark for trench is large rock in middle of west end of terrace - R3 (+364.24m)

- workers for this trench are
Mandis Mariadakis (over 2-3 days)

Stelios

Mikalas (micro)

- Vangelis

Year 2002 Trench/Locus A601 Excavator MSE

Elevations

Benchmark used: B3

Reading on

Benchmark:

H.I.:

1.488

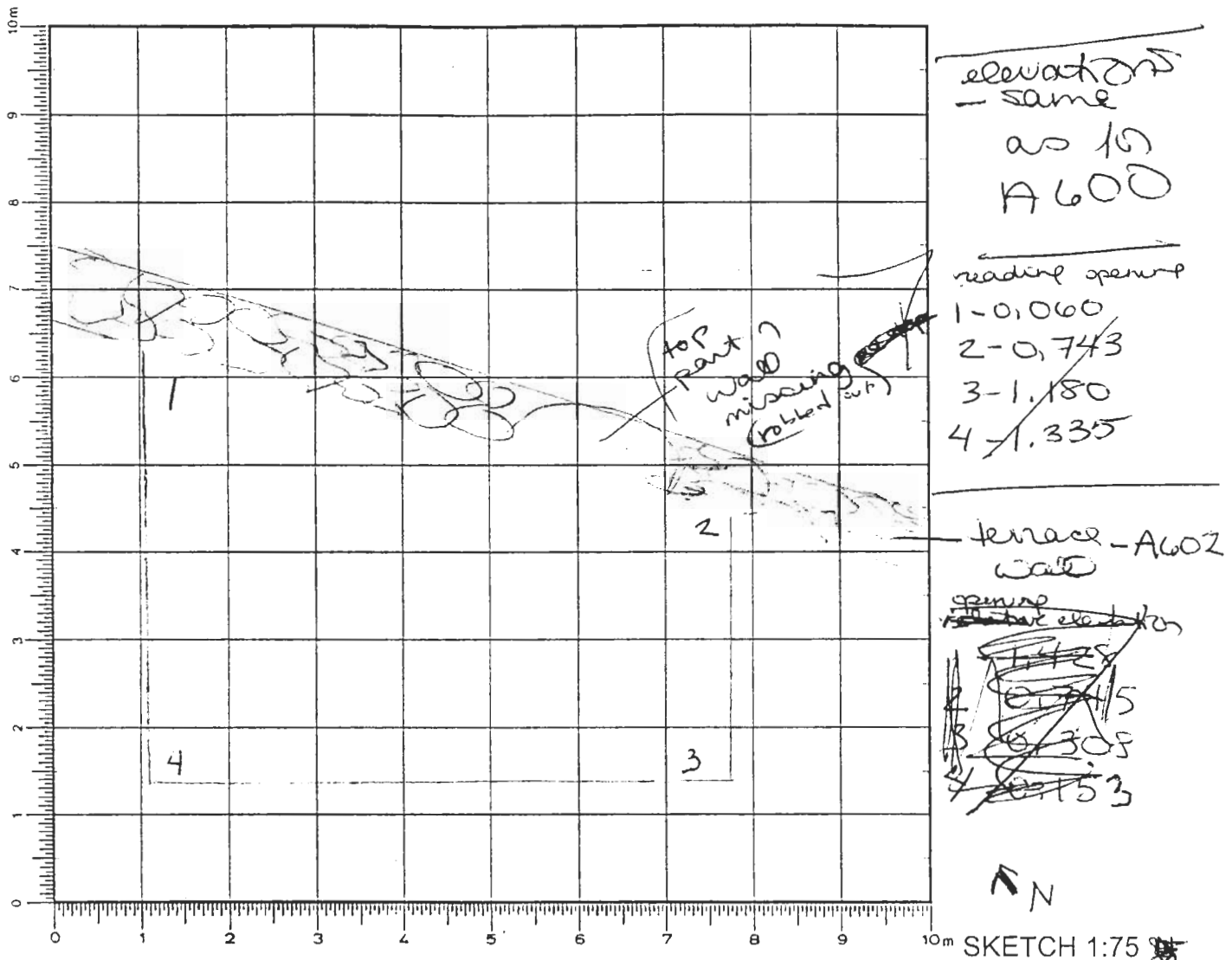

DEFINITION/DESCRIPTION of LOCUS (explain why you changed locus numbers):

Today's date: 7 June 02 Locus above: A600Locus parameters: (see A600) - south of A602Verbal description: topsoil - loose brown soil w/ many small
removal rocks, roots, grass

Locus Interpretative Comments (What do you think this is? DATE your comments, continue on additional pages if necessary):

~~modern accumulation~~~~modern accumulation~~~~modern accumulation~~

[illegible]

OBJECTS

[illegible]

ADDITIONAL COLLECTED MATERIAL

[illegible]

Year 2002 Trench/Locus A601 Excavator MSE

DESCRIPTION of PROGRESS of EXCAVATION [date each entry and identify associated pottery find(s)]:

7 June 02 - began removal of topsoil (A601.1) - archaic

- 10 June 02 - continuation of 1st pass - A601.2 - archaic
- finished removing topsoil with this pass (coming down on wall tumble)
 - terrace wall (A602) extends beyond trench to north and south along terrace
 - one fragment of burnt clay, possibly roofing material found in pass
 - small amount of bone found in pass
-

AZORIA Project

0.9

Year 2002

Trench/Locus A602

Excavator MSE

Elevations

Benchmark used: ~~_____~~

Reading on

Benchmark: ~~_____~~

H.I.: ~~_____~~

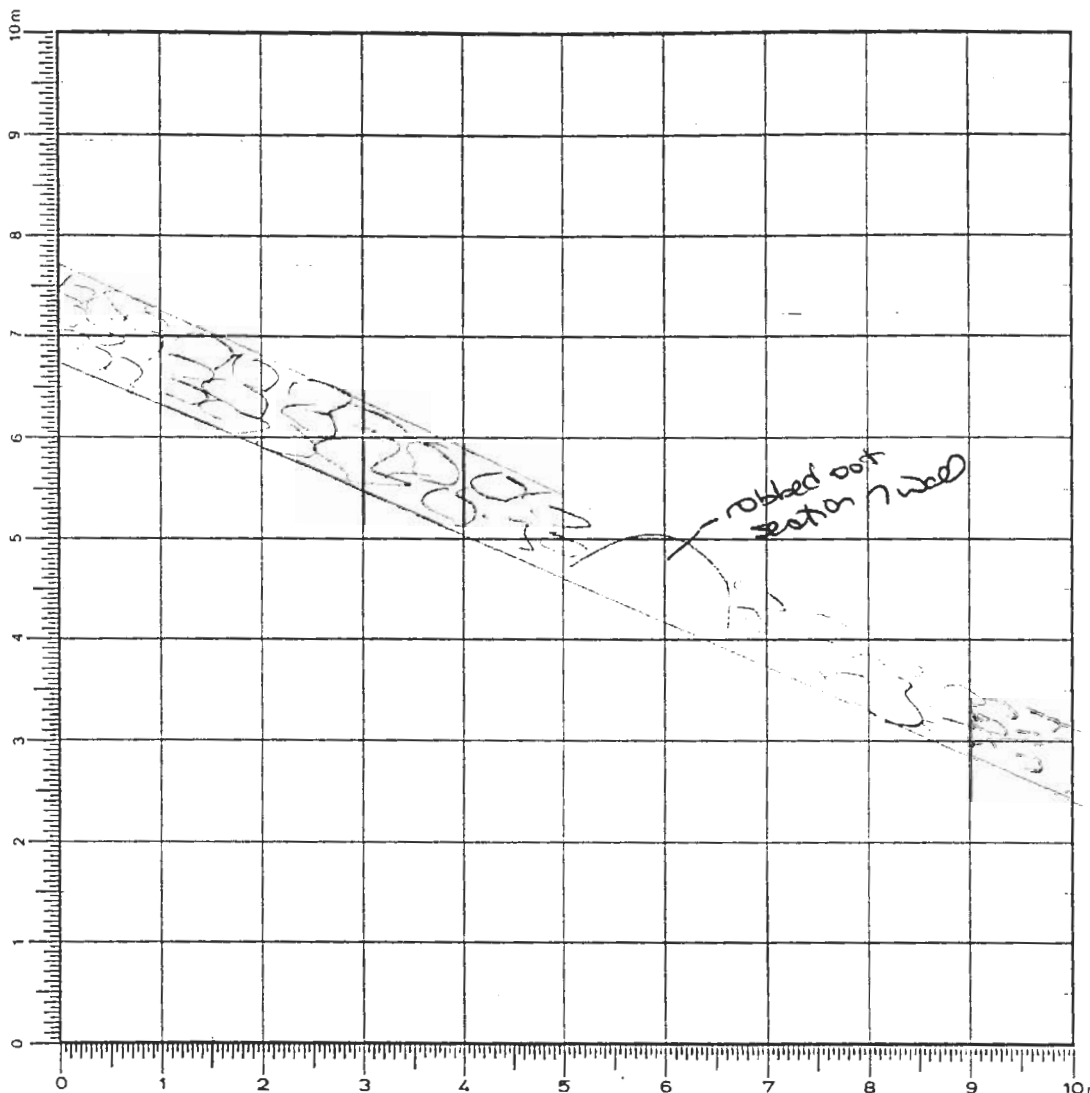

N

SKETCH 1:75

DEFINITION/DESCRIPTION of LOCUS (explain why you changed locus numbers):

Today's date: 11 June 02 Locus above: _____

Locus parameters: terrace wall on ~~west~~ ^{east} edge of trench, running ~~_____~~

Verbal description: modern terrace wall composed of medium-sized stones (average - $0.4 \times 0.2m$) - no mortar - roughly rectangular
 → placed ^{top of} on ancient terrace wall - whose construction includes much larger blocks ($1.0 \times 0.7m$) → mortar in ancient blocky
 [- wall extends beyond boundaries of trench] [almost cyclopean masonry]

Locus Interpretative Comments (What do you think this is? DATE your comments, continue on additional pages if necessary):

11 June 02 terrace wall; also used as back wall of house/kitchen

Year 2002 Trench/Locus A602 Excavator MSE

DESCRIPTION of PROGRESS of EXCAVATION [date each entry and identify associated pottery find(s)]:

11 June 02 - some of the larger blocks of wall visible before digging began

- one section of the wall top was previously robbed out/missing, but stones are visible below

A603, 605, 606 reveal more of lower courses of wall - only front face visible

estimated measurements of wall (for trench)

- length ≈ 7.6 m.; width ≈ 0.65 m

- stones on top of wall at southern end may be from Bayl's excavations

12 June 02 - wall now forms west border of A800

3 July 02 - removal of modern additions to wall with A817

8 July 02 - base of wall not yet reached

- at north ~~west~~ ^{east} edge of trench / end of wall, the wall appears to curve somewhat to west into trench of SZP (A1500)

- ? if this is the same wall as back wall of A1200 excavated by PAV (A1202)

- 4-5 ancient courses now visible for A602 (large)

Year 2002 Trench/Locus A603 Excavator MSE

Elevations

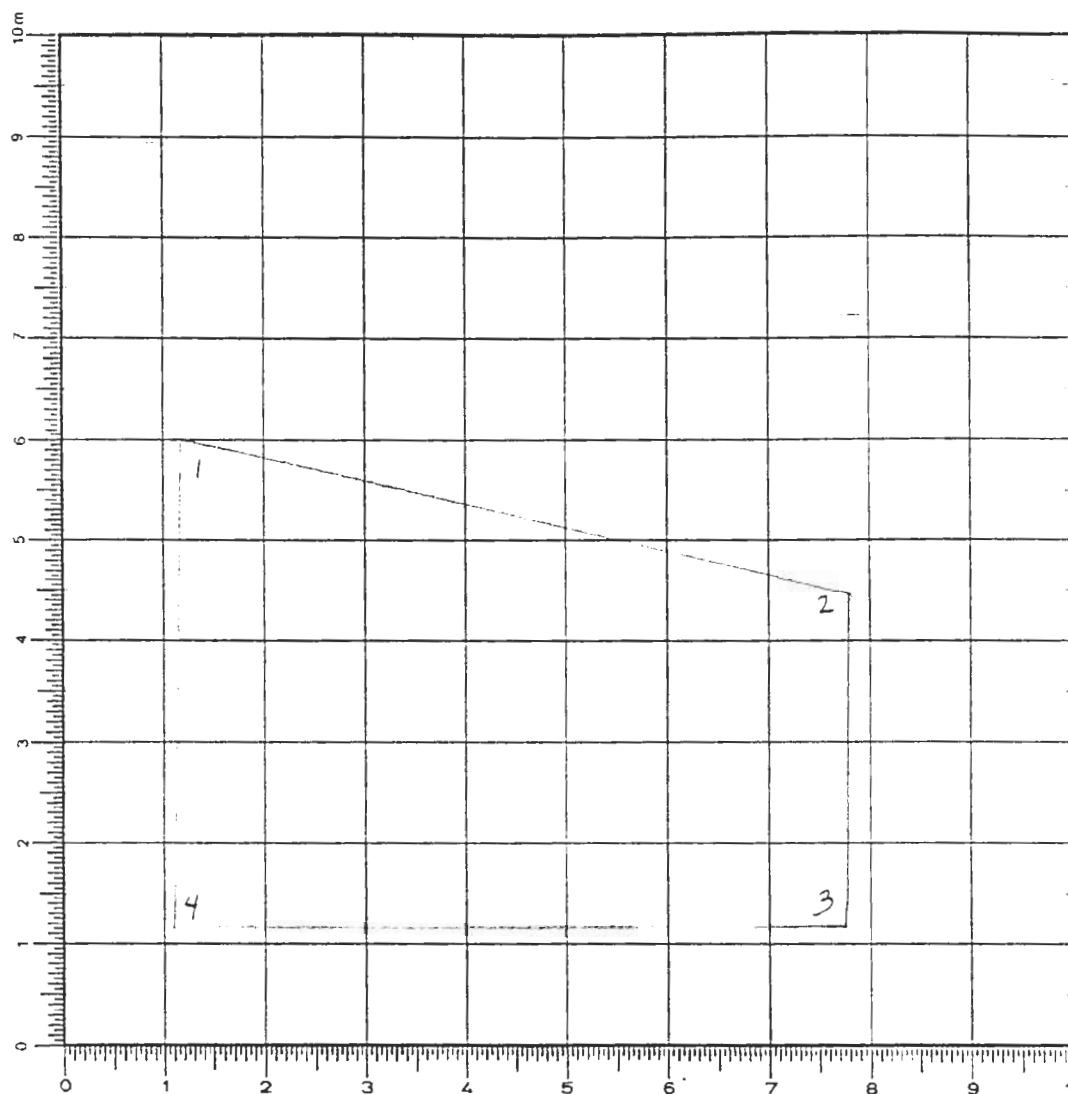
Benchmark used: R3
Reading on
Benchmark: 1.433
H.I.: -365.673

opening
1 - 0.033
2 0.698
3 - 1.193
4 - 1.333

~~1 - 0.033~~
~~2 - 0.698~~
~~3 - 1.193~~
~~4 - 1.333~~

opening
1 - 365.640
2 - 364.975
3 - 364.480
4 - 364.340

↑ N

SKETCH 1:75

DEFINITION/DESCRIPTION of LOCUS (explain why you changed locus numbers):

Today's date: 11 June 02 Locus above: A601Locus parameters: 6.6m - length; 4.95m (E-W); 3.15m (N-S)
same as A602Verbal description: loose brown/orange soil w/ many small rocks +
some weeds still present (extinct vegetation)
(removed primarily from end of trench by wall)18 June 02 - should be combined w/ A601 - still really topsoil

Locus Interpretative Comments (What do you think this is? DATE your comments, continue on additional pages if necessary):

[illegible]

OBJECTS

[illegible]

ADDITIONAL COLLECTED MATERIAL

[illegible]

Year 2022 Trench/Locus A603 Excavator MSE

DESCRIPTION of PROGRESS of EXCAVATION [date each entry and identify associated pottery pit(s)]:

- 11 June cleaned down to wall tumble (ancient wall line now more clearly revealed)
- cross wall ~~appearing~~ - abuts terrace wall; basically dividing trench in half [A604]
 - [A603.1] - pit assoc w/ (Archaic) pass

18 June - should be combined w/ A604 because really still topsoil

Year 2002 Trench/Locus A604 Excavator MSE

Elevations

Benchmark used:

Reading on

Benchmark:

H.I.:

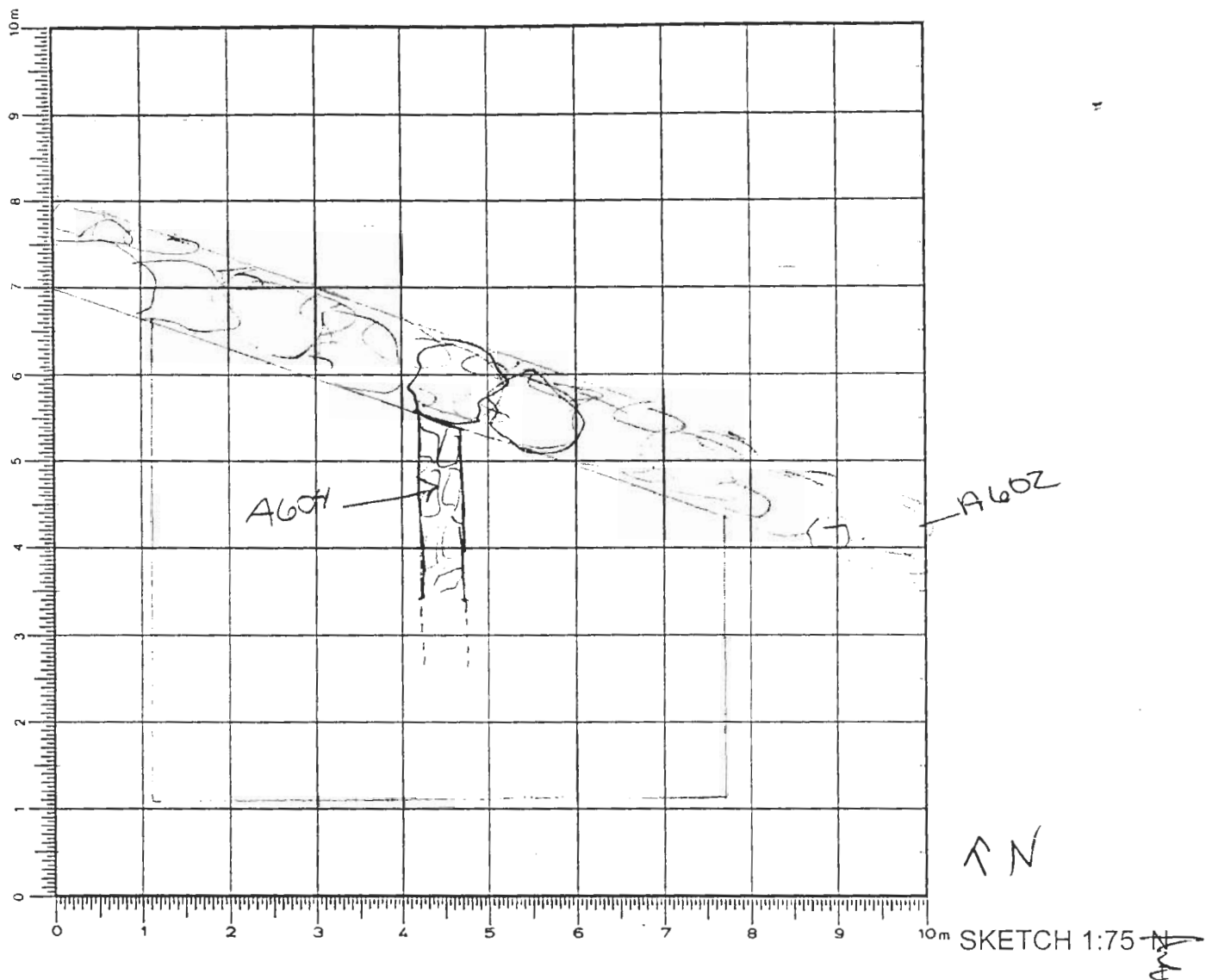

DEFINITION/DESCRIPTION of LOCUS (explain **why** you changed locus numbers):

Today's date: June 11, 2002 Locus above: ~~A603~~

Locus parameters: cross wall in middle of trench, abut to ^{ancient part} ~~house~~ wall

Verbal description: 0.5m-width; ^{3.4m} ~~2.0m~~ length - thin wall
composed of small + medium irregular shaped stones w/
mortar; both faces visible ^{mostly} ~~roughly~~ rectangular stones
[range of stones 0.3x0.2; 0.2x0.1m] (abut A602)

Locus Interpretative Comments (What do you think this is? DATE your comments, continue on additional pages if necessary): wall of house - (interior) - b/c thin - 11 June 02

Year 2002

Trench/Locus **A604**

Excavator^{mse}

DESCRIPTION of PROGRESS of EXCAVATION [date each entry and identify associated pottery pail(s)]:

- 11 June 02 - wall first appeared with AlO₃ (which exposed tunnel) and was further revealed with AlO₅ + AlO₆

2-3 courses revealed thus far

- ? wall incomplete at west end or y missing stones
- wall abuts terrace wall A602 (joined with same mortar as in that wall)
- wall is well-preserved

- 10 July 02 - 5th courses now exposed near A602
- extension wall found to west (extends beyond A609) for southern room
 - base of wall not yet reached b/c stopped excavation
 - wall divides the two rooms (kitchens)

- wall may extend beyond edge of excavated area for ~~1st~~ ⁺ ~~joining~~ undisturbed 4th wall of room (A615)
- possible doorway in wall near edge of area excavated w/ A615, A616

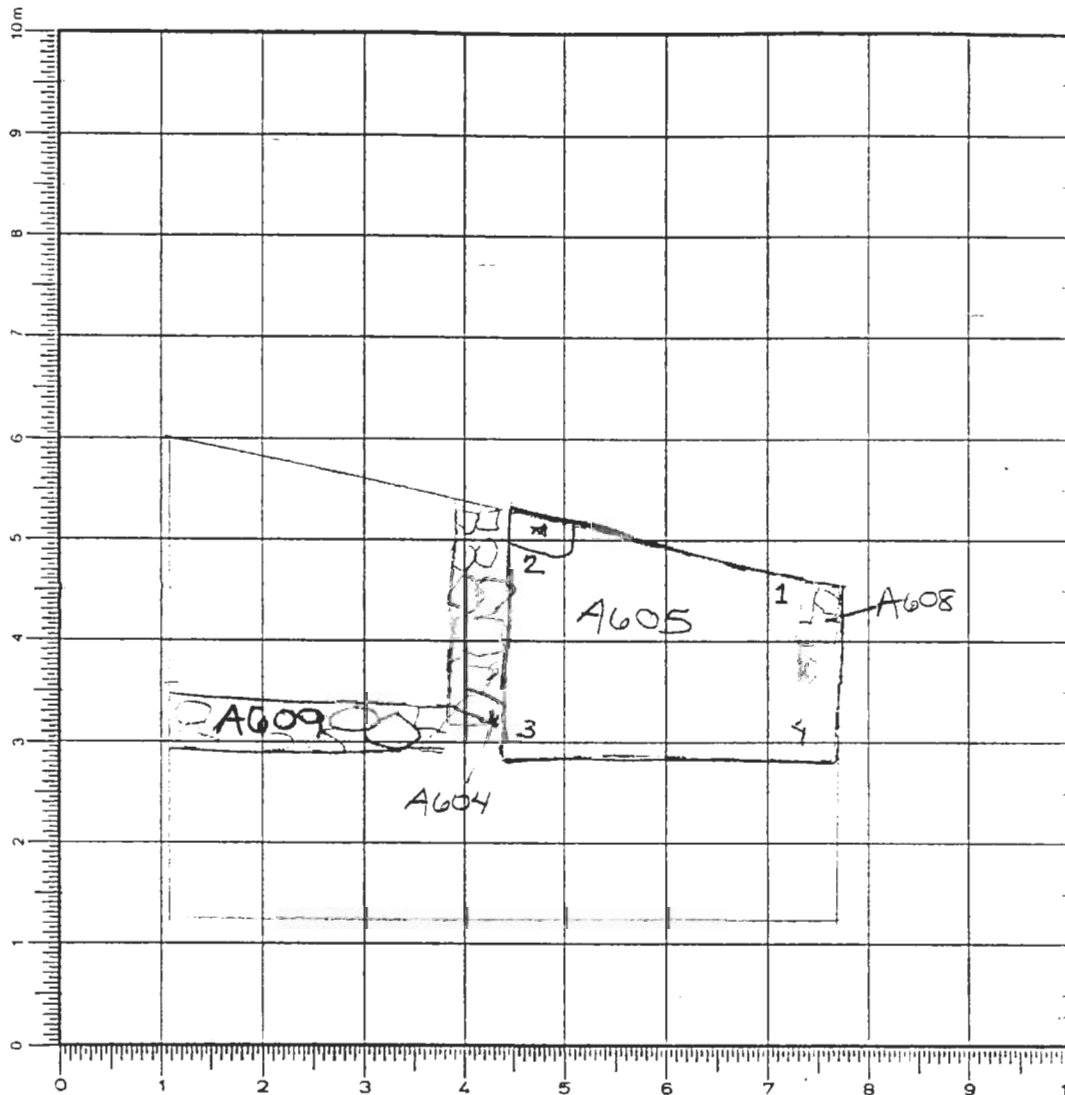
Year 2002 Trench/Locus A605 Excavator MSEElevations R3
Benchmark used: 0
Reading on
Benchmark: 3.52
H.I.: 365.188

→ large stone
(?) bench or
tumble

clearing elevations	
BH - 1.328	- 365.568
1 - 0.902	364.666
2 - 0.905	364.666
3 - 0.942	364.62
4 - 1.050	364.51

1 - 0.902
2 - 0.905
3 - 0.942
4 - 1.050

SKETCH 1:75

DEFINITION/DESCRIPTION of LOCUS (explain why you changed locus numbers):

Today's date: 11 June 02 Locus above: A603Locus parameters: roughly east of end of A609 new [box] 3.2m x 1.7m cross wall measurements areaVerbal description: removal of wall + tumble; loose brown/orange soil full of many large, medium + small rocks
stopped removal roughly in line w/ A609 (also at edge of sloped part of trench - where meet level flat area)Locus Interpretative Comments (What do you think this is? DATE your comments, continue on additional pages if necessary): (wall tumble from house + terrace wall)

[illegible]

OBJECTS

[illegible]

ADDITONAL COLLECTED MATERIAL

[illegible]

Year 2002 Trench/Locus A605 Excavator MSE

DESCRIPTION of PROGRESS of EXCAVATION [date each entry and identify associated pottery pail(s)]:

- 11 June
 - ~~remains~~ wall tumble; ^{section} wall (A608) emerges at far SE end of trench (abuts terrace wall)
 - no evidence (yet) of continuation of A609 ~~into~~ into A605
 - stopped locus (1/2 across trench) where wall tumble ended
 - coming down on ~~red~~ (red) collapse w/ clay + more rocks
 not as clean as in A606 → change locus
 → ^{NE} ~~corner~~ corner of locus contains large rectangular stone
 (? if bench or just wall tumble)

A605.1 - pail assoc. w/ level (nd / anchor)

Year 2002 Trench/Locus A606 Excavator MSE

DESCRIPTION of PROGRESS of EXCAVATION [date each entry and identify associated pottery pair(s)]:

- 11 June - ~~pass~~ removed wall tumble on slope from N terrace wall 75%
 - screened ~~pass~~ soil from pass A609
 → revealed another ~~pass~~ wall at bottom of slope of locus ~~pass~~
 (// to terrace wall) - ~~pass~~ divides trench in half essential

→ coming down on orange red clay, still w/ some rock tumble → well preserved from collapse of red house → so change locus

- [found piece of modern brown glass in cleaning up]
 - pos. fell in with sweeping → from terrace wall

A606.1 - pot. assoc. w/ (Nd)

- part of wall revealed on ~~western~~ northern edge (~~at edge of trench~~) - A607

- cyclopean terrace wall becoming more clearly revealed with pass A607

~~Excavated the trench in A602~~

Year 2002 Trench/Locus A607 Excavator m3EElevations

Benchmark used:

Reading on

Benchmark:

H.I.:

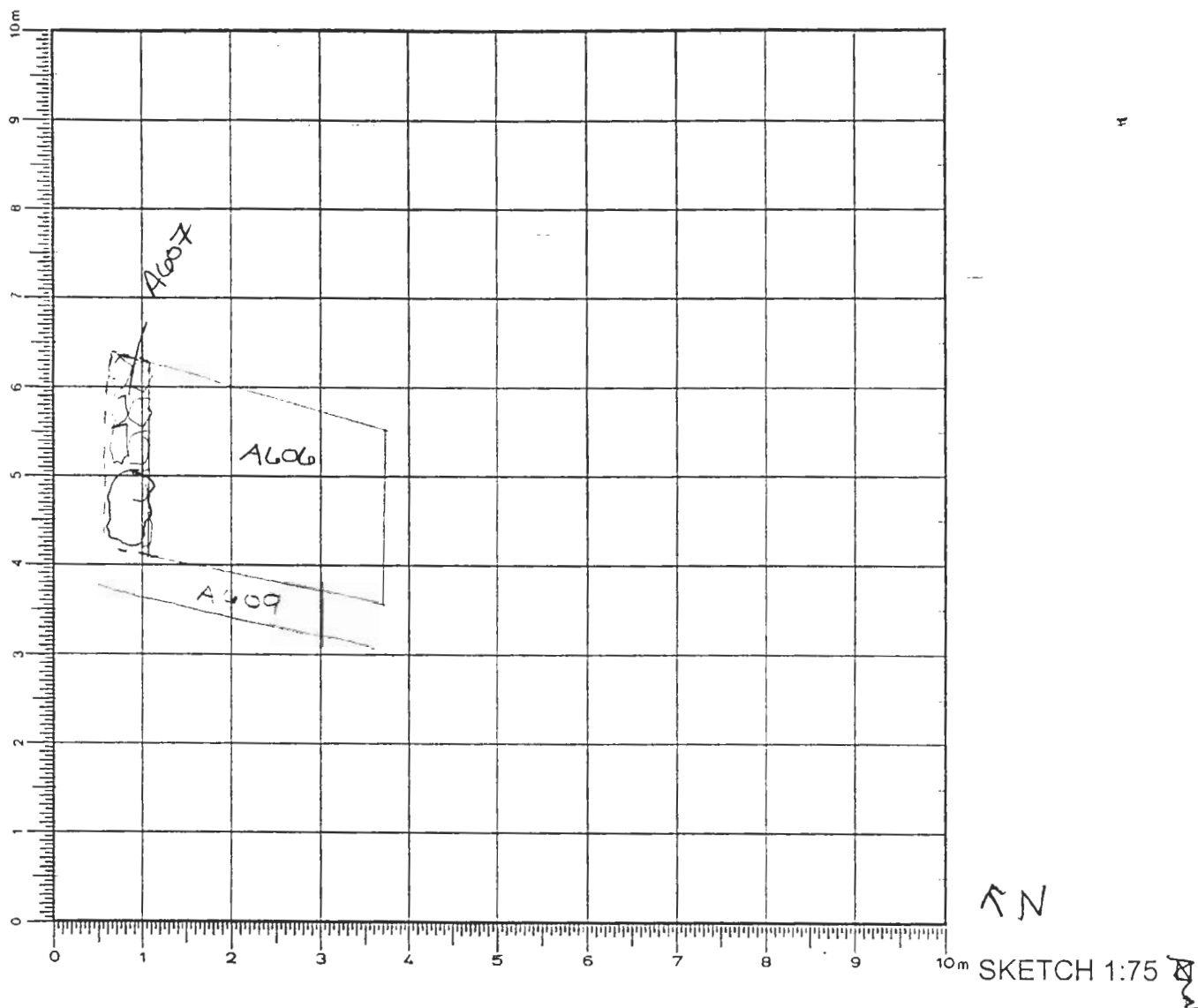

DEFINITION/DESCRIPTION of LOCUS (explain why you changed locus numbers):

Today's date: 11 June 02

Locus above: _____

Locus parameters: even wall at ^{North} edge of trench, (beside A606)
about A607 + A609

Verbal description:

large stone comprises much of ^{West} end of wall; remaining
stone roughly rectangular (small-medium sized) - built w/
(6 av. 0.35 x 0.2m)for wall
length - 2.4m
width - 0.55

large boulders (1.3 x 0.65m)

~~both faces visible~~
both faces visible for west end of wall

Locus Interpretative Comments (What do you think this is? DATE your comments, continue on additional pages if necessary): wall of house/room

Year 2002 Trench/Locus A607 Excavator MSE

DESCRIPTION of PROGRESS of EXCAVATION [date each entry and identify associated pottery find(s)]:

11 June 02 - wall becoming visible w/ A606 excavation, but much of wall is still under bank, just beyond the edge of the trench (one face currently partially visible) -
 → to be further exposed later
~~in trench~~

5 July 02 more fully exposed w/ A610e1 - end of wall composed of one large Cyprian boulder
 - also about A609? → ~~same as A609~~
 - wall is well-preserved
 - 6 courses preserved near A602
 estimated measurements - 2.4m ~~long~~ x 0.55m.

- base of wall not yet reached b/c ended excavation

Year 2002 Trench/Locus A608 Excavator MSEElevations

Benchmark used:

Reading on

Benchmark:

H.I.:

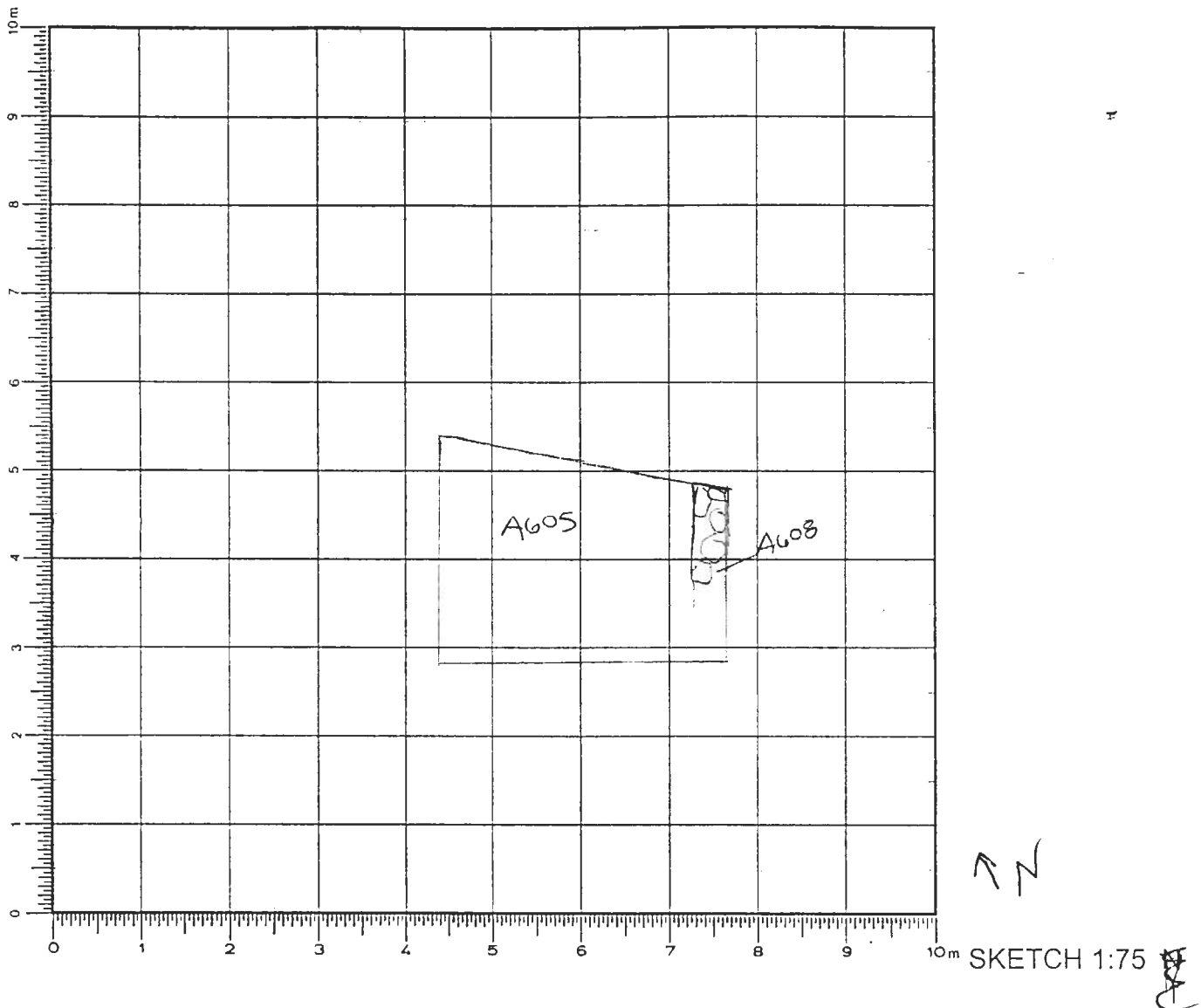
DEFINITION/DESCRIPTION of LOCUS (explain **why** you changed locus numbers):Today's date: 11 June 02 Locus above: Locus parameters: wall at ^{South} ~~edge~~ of trench; beside A605Verbal description: ~~ancient~~ wall, composed of ^(rough, irregular) irregularly shaped + sized stones (medium + small) joined w/ mortar

— preserved length ~~2.10m~~ ^{2.10m}; 0.55m width
 range of stone sizes (0.45 x 0.25; 0.15 x 0.2m)
 (same construction as A604)

Locus Interpretative Comments (What do you think this is? DATE your comments, continue on additional pages if necessary): wall of house/room

Year 2002 Trench/Locus A608 Excavator MSE

11/5/02 DESCRIPTION of PROGRESS of EXCAVATION [date each entry and identify associated pottery find(s)]:

- wall extends slightly beyond ~~east~~^{southern} edge of trench; 2 courses visible by tenace wall
- joined to tenace wall w/ mortar as is A604
- further excavation may reveal an extension of the wall to ~~west~~^{west} (little preserved)
- ^{wall 1st} revealed w/ excavation of A605

10 July, extension of wall to ~~west~~^{west} somewhat revealed w/ A605 passes

- 3 courses visible by A602

- only one face visible currently
- base of wall not yet reached b/c ended excavation

- area to S of wall remains unexcavated

- no extension to west edge of trench found yet

Year 2002 Trench/Locus A609 Excavator MSEElevations

Benchmark used:

Reading on

Benchmark:

H.I.:

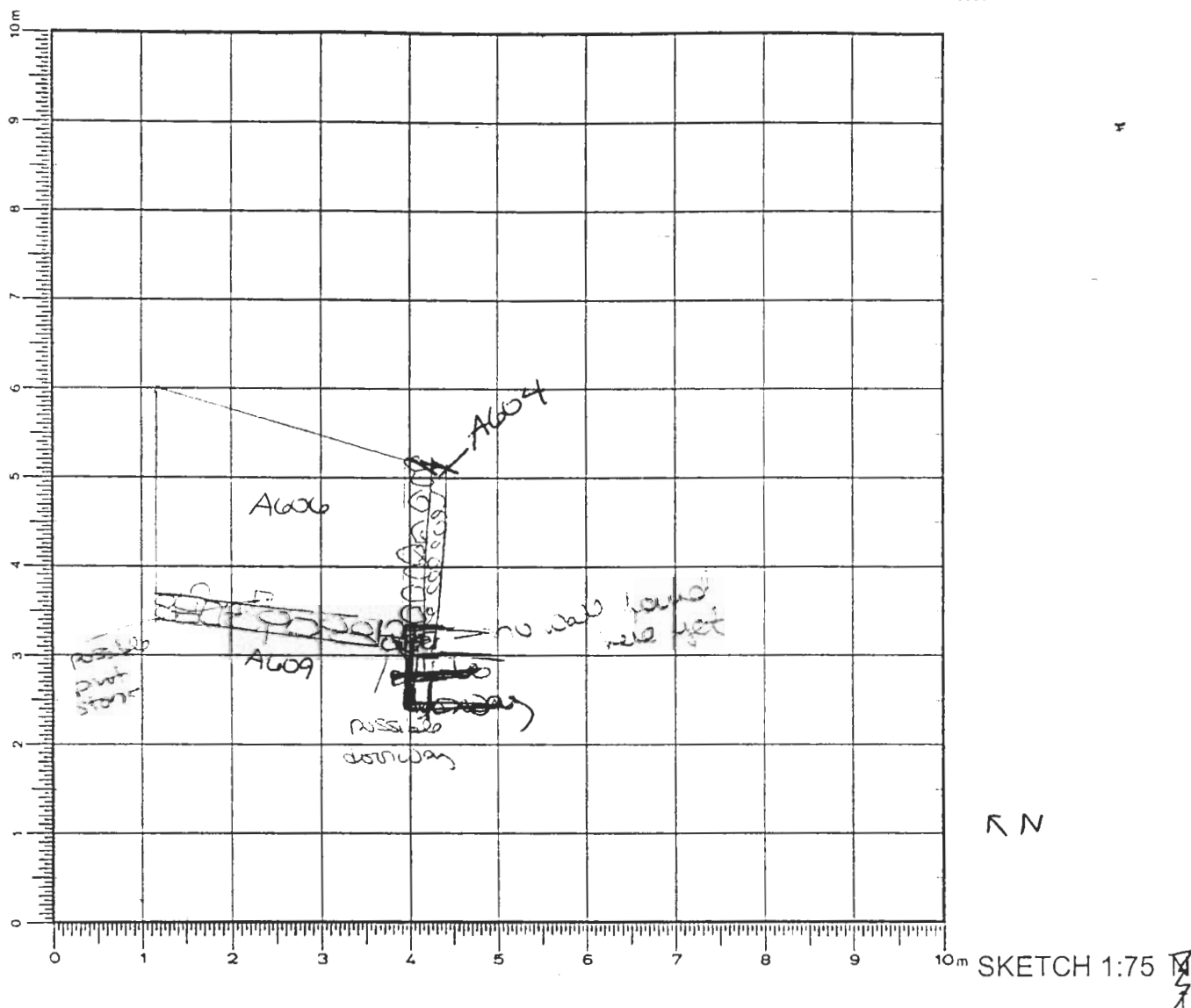

DEFINITION/DESCRIPTION of LOCUS (explain why you changed locus numbers):

Today's date: 11 June 02

Locus above: _____

Locus parameters: - wall in middle of trench (~~as shown~~) ^{border to A606}
parallel to A602Verbal description: composed of irregular shaped, rough rectangular stones
joined w/ mortar? (original) - medium + small- ~~about A607~~ (range of
stone (0.4 x 0.3; 0.3 x 0.2 - 1a example])

~~2.98 x 0.8m~~
 2.98 / 3.5m x 0.8m { ~~about A606~~ } about ~~A609~~
 - approx measurement wall

Locus Interpretative Comments (What do you think this is? DATE your comments, continue on additional pages if necessary): wall of house/room

Year 2002 Trench/Locus A609 Excavator MSE

DESCRIPTION of PROGRESS of EXCAVATION [date each entry and identify associated pottery find(s)]:

- 11 June 02 top course of wall revealed with excavation of A606
 - both faces of wall will likely be visible with further excavation
 - some of stones from west face may have been lost down the slope
 - possible doorway in corner b/w A609 + A604
 - no stones found there
 - construction of wall + size of stones - similar to that of A604 + 608

5 July 02 - no doorway visible in wall yet
 - more stones uncovered w/ A611.1 pass
 both ~~faces~~ visible (wall seems to lean ~~outward~~
 slightly and is somewhat curved in the center,
 likely the result of earthquake/erosional damage)

- 8 July 02 - doorway to room was most likely in this wall, either in corner by A604 or closer to A607 (possible pivot stone found in second course protruding from wall)
 - most of 3 courses visible on inside of room; only one on outside
 - wall does not extend into A606 room

Year 2002 Trench/Locus A607 Excavator MSEElevations

Benchmark used:

Reading on

Benchmark:

H.I.:

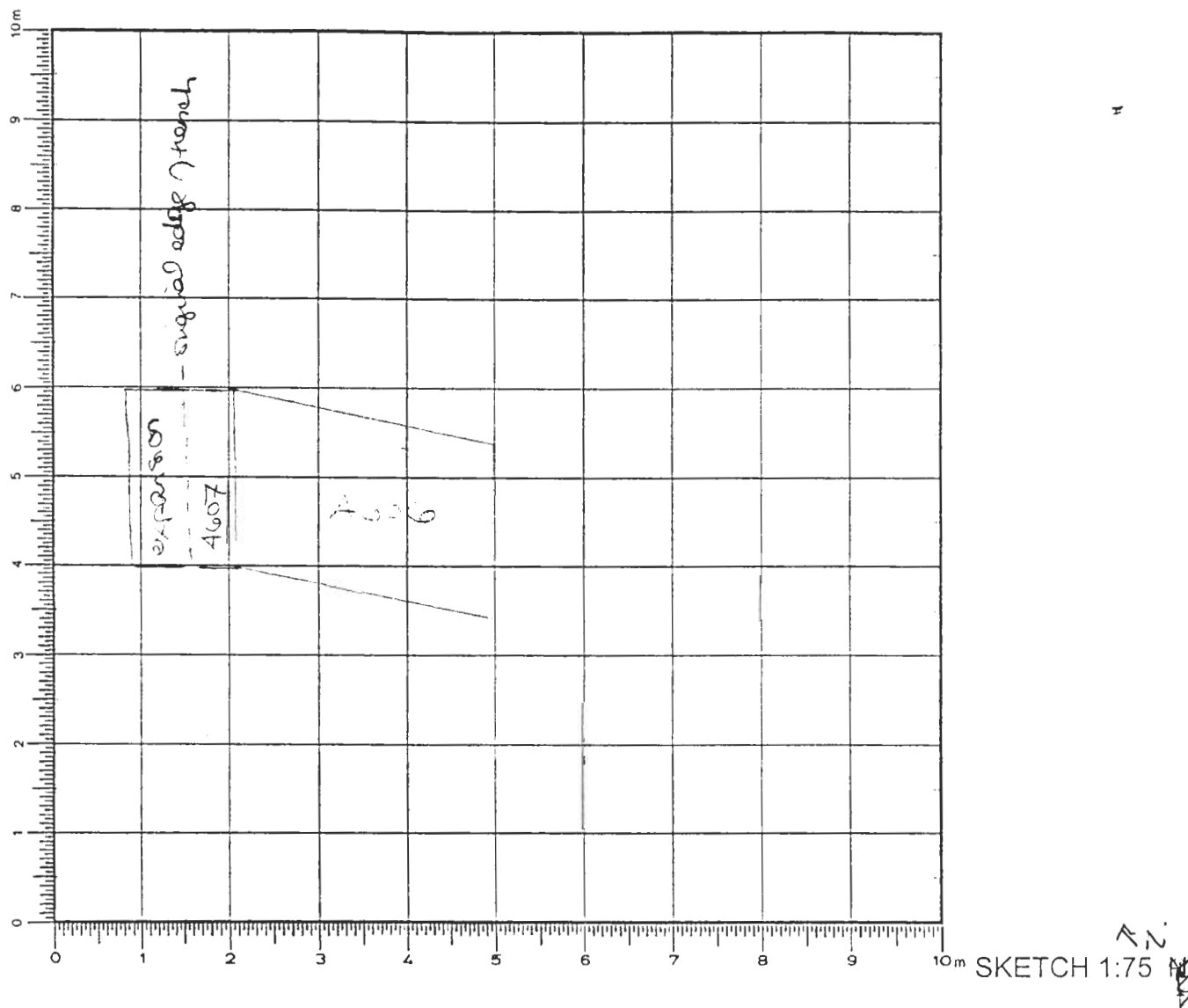

DEFINITION/DESCRIPTION of LOCUS (explain why you changed locus numbers):

Today's date: 5 July 02

Locus above: _____

Locus parameters: Expand trench to 15th by 2 1/2 m to clarify location of A607
(- joining area cleared by JCP-A1500) + extend of A602Verbal description: removal of topsoil - loose brown soil full of roots + small rocks
along w/ removal of wall timbers to define wall→ A607 revealed clearly (1 about A602)Locus Interpretative Comments (What do you think this is? DATE your comments, continue on additional pages if necessary): modern
- surface accumulation[A607 is crosswall of A602]

[illegible]

OBJECTS

[illegible]

ADDITIONAL COLLECTED MATERIAL

[illegible]

Year 2002 Trench/Locus A611 Excavator MSEElevations

Benchmark used: R4
 Reading on
 Benchmark: 2.545
 H.I.: 368.285

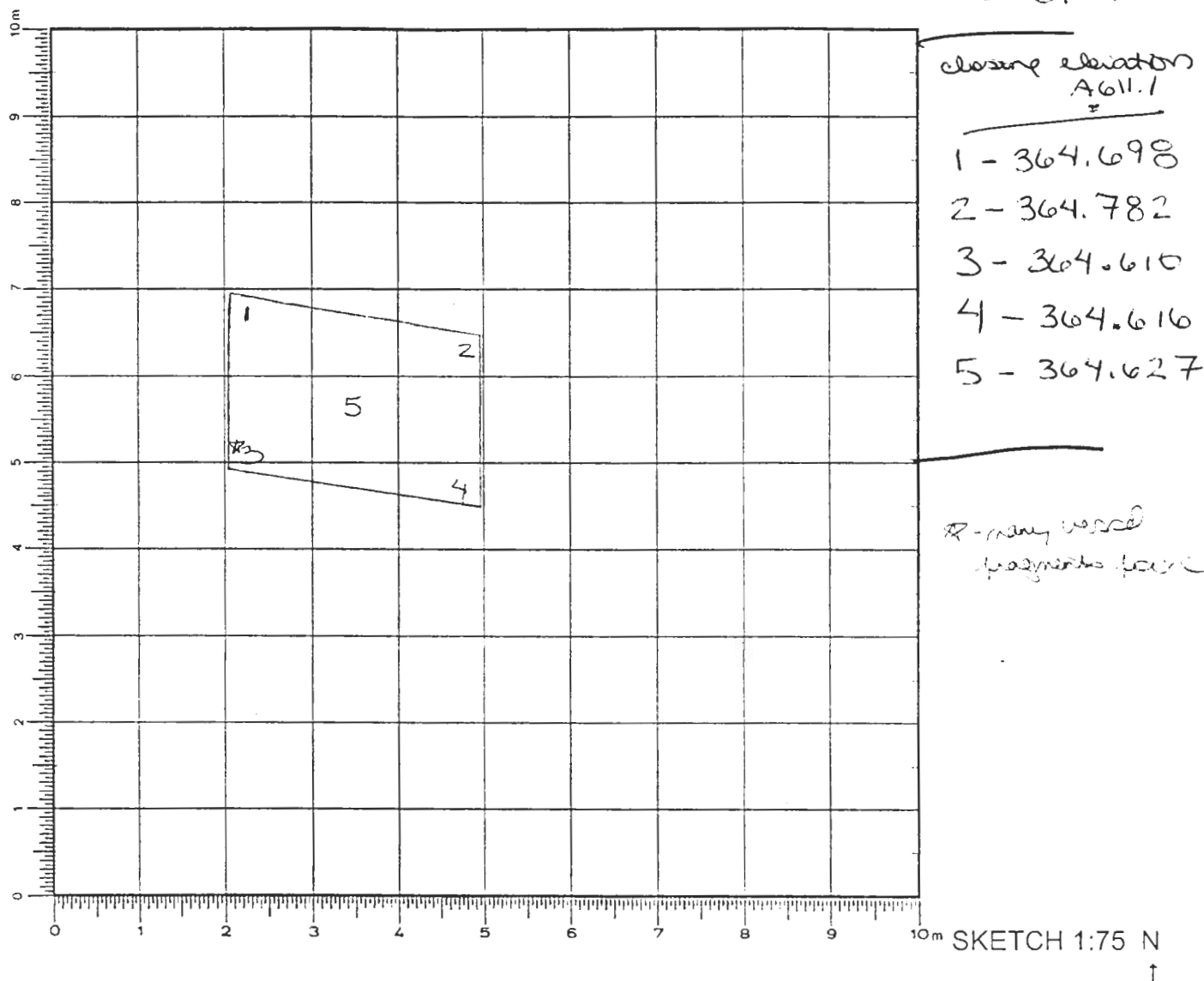

DEFINITION/DESCRIPTION of LOCUS (explain why you changed locus numbers):

Today's date: 5 July 02 Locus above: A601Locus parameters: South of A607, North of A604, West of A609, East of A602

Verbal description: wall tumble with clay ceiling debris - loose light brown/orange soil
 (many large + medium sized rocks), large patches of clay

Locus Interpretative Comments (What do you think this is? DATE your comments, continue on additional pages if necessary): wall tumble w/ ceiling debris (for room)

Year 2002 Trench/Locus A611 Excavator MSE

DESCRIPTION of PROGRESS of EXCAVATION [date each entry and identify associated pottery pail(s)]:

- 5 July 02 A611 removal of wall tumble + ceiling debris, coming down on less tumble + mostly roofing clay
 A607 + A609 defined more clearly on pass
- several frag. of vessel found in ~~SW~~^{NW} corner of room up against wall

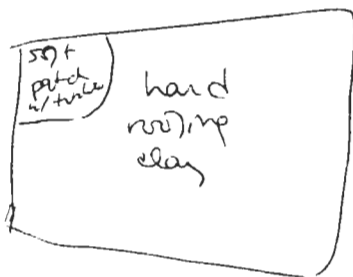

⇒ change paths b/c coming down on ~~primarily~~^{on} clay - ceiling debris + tumble removed (except in NW corner where soil is soft + still contains tumble)

Year 2002 Trench/Locus A612 Excavator MSE**Elevations**

Benchmark used: R3
 Reading on: 1.642
 Benchmark: 1.642
 H.I.: 365.882

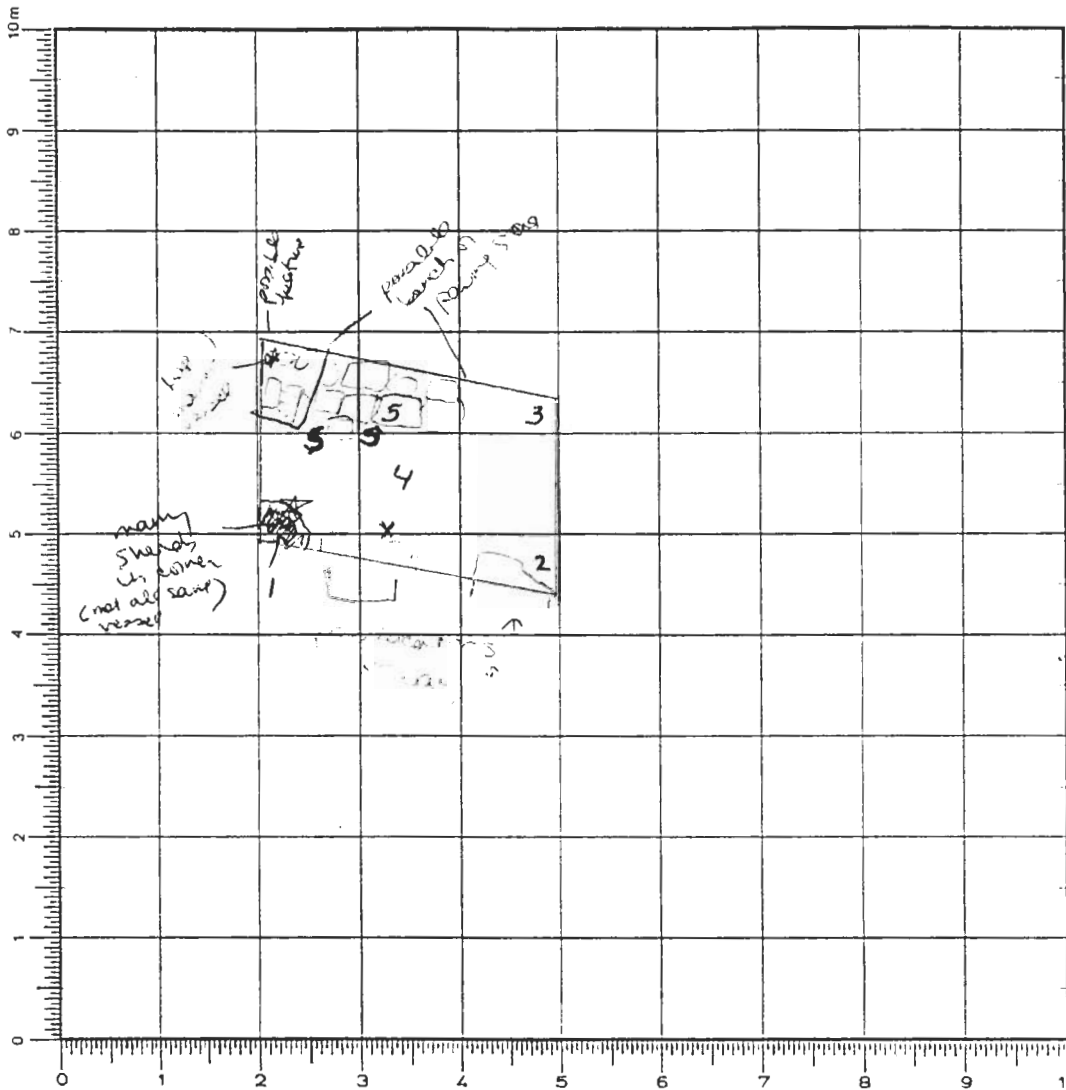

bottom A612.2

- 1 - 364.560
- 2 - 364.562
- 3 - 364.640
- 4 - 364.584
- 5 - 364.674
- (on paving bench stone)

bottom A612.3

- 1 - 364.498
- 2 - 364.528
- 3 - 364.613
- 4 - 364.526
- 5 -

St. Mary's Church

X possible quarry

5 - not clay

SKETCH 1:75

DEFINITION/DESCRIPTION of LOCUS (explain why you changed locus numbers):

Today's date: 5 July 02 Locus above: A611Locus parameters: (same as A611)Verbal description: hard packed light orange ceiling clay

(changed loci from A611 bc wall tunnel removed + soil is harder packed)

Locus Interpretative Comments (What do you think this is? DATE your comments, continue on additional pages if necessary):

robbing clay collapse in room

Year 2002 Trench/Locus A612Excavator MJE

DESCRIPTION of PROGRESS of EXCAVATION [date each entry and identify associated pottery pail(s)]:

- 5 July 02 - began pass across room in ceiling debris A612.1
- screened 100% 1 pass
 - standard soil sample + intensive #1 (NW corner + intensive #2 (middle-east-on paving stone) room)
 - paving stones found along wall A602 in middle (2 rows) → possible bench
 - one paving stone found in SW corner by possible doorway
 - coming down on well-preserved floor in most of room except NE corner where is loose + tumbled still present; in this corner 3 stones extend from A607 → possible hearth or disturbed patch beside bench

- 8 July 02 - finish first pass across room A612.2
- concentration of sherds found in NW corner as with A611.1 (?) 4 stones there or washed into corner
 - ? of floor now found throughout room or if another layer of ceiling debris
 - by middle of A609 - top of stone tool (possible quern) emerging
 - second pass A612.3 to search for floor + define stones of bench
 - standard soil sample + intensive #1 (SW corner); #2 (SE corner); #3 (middle of room); #4 (NW corner)
 - many sherds from small vessels, including many fragments from cookpots (burnt)
 - many sherds from fragments of smashed vessel also found in NE corner (A613)
 - iron slag found near bench + possible hearth
 - bone + pumice also found in pass
- 16 July 02 removed possible quern / stone tool [A612.4]

cookpot fragments found w/ A612.1-3

Year 2002 Trench/Locus A613 Excavator MSEElevationsBenchmark used: R3

Reading on

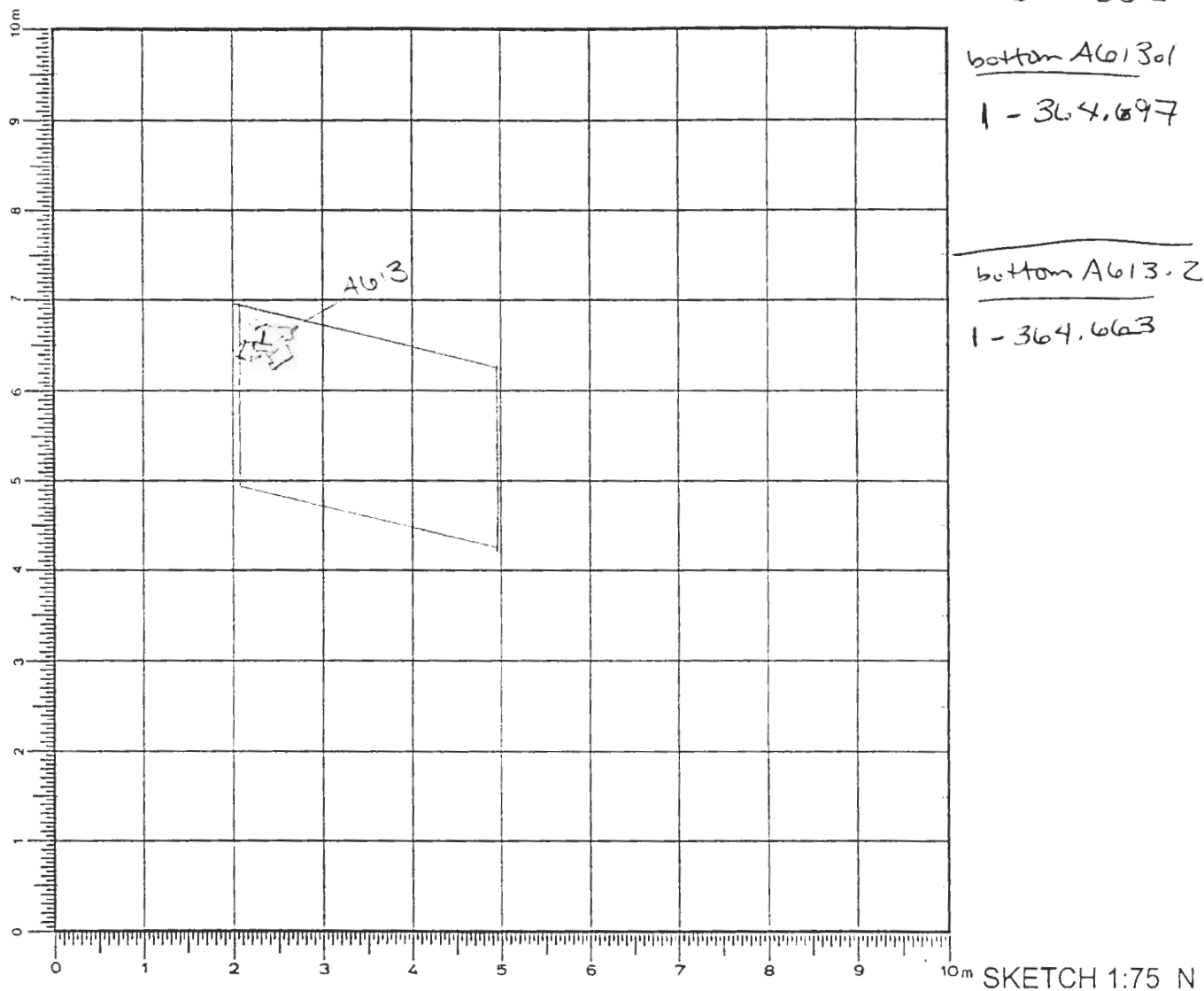
Benchmark: 1.042H.I.: 365.882

DEFINITION/DESCRIPTION of LOCUS (explain why you changed locus numbers):

Today's date: 8 July 02Locus above: A611Locus parameters: NE ~~corner~~ corner of room (A611) - (0.8 x 0.95m) (beside bench A614)Verbal description: soil is redder / more orange + looser than that of rest of room* (clearing around stone in attempt to define possible feature)Locus Interpretative Comments (What do you think this is? DATE your comments, continue on additional pages if necessary): - possible hearth / oven

Year 2002 Trench/Locus A613 Excavator MSE

DESCRIPTION of PROGRESS of EXCAVATION [date each entry and identify associated pottery pail(s)]:

8 July 02 cleaned around stones & possible feature in NE corner of trench; soil removed as intensive sample

A613.1 - fragments of pottery found smashed behind rock in very corner of area

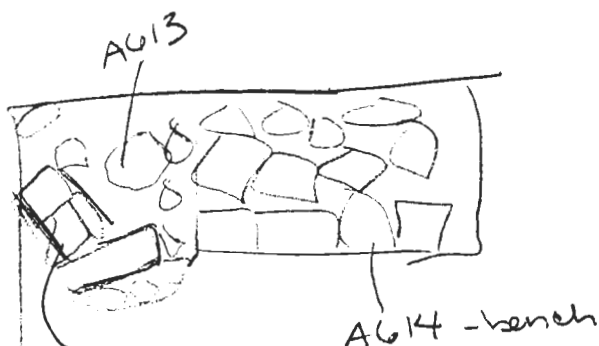

- late anthracite cookpot frag found

this line of stones here seems to fit with other examples of hearths + ovens found in the area in size, shape & arrangement

A613.2 - more cleaning to define feature + removal of rocks not part of feature (possible hearth/oven)
all soil taken as intensive sample

- no carbon found in room or feature thus far
though cookpot fragments + 2 fragments of iron slag found in room v. A612

- more frag. of LA cookpot

- line of roughly rectangular stones seem to frame area of distinct soil

Year 2002 Trench/Locus A614 Excavator MSEElevations

Benchmark used:

Reading on

Benchmark:

H.I.:

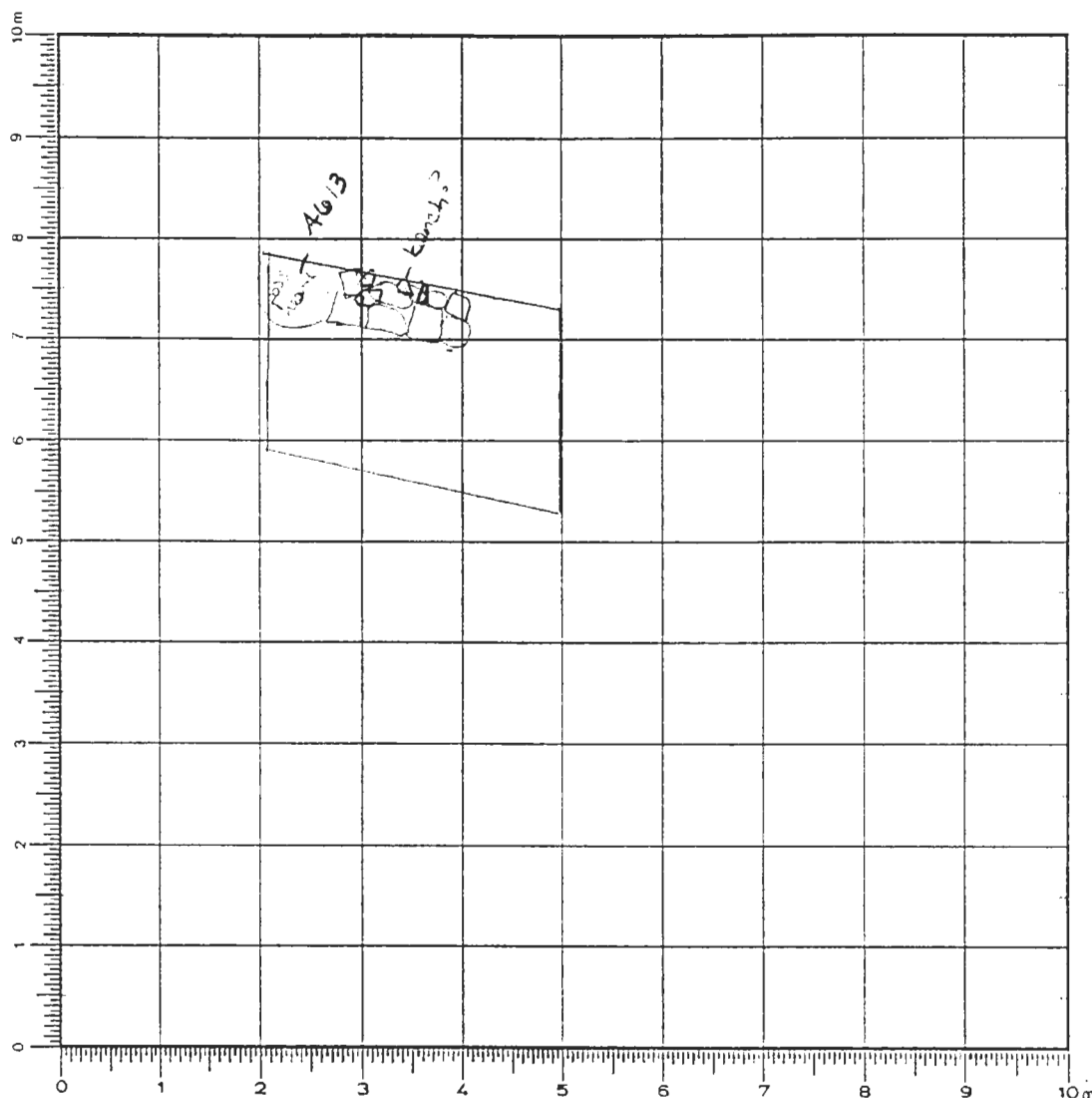

SKETCH 1:75

DEFINITION/DESCRIPTION of LOCUS (explain why you changed locus numbers):

Today's date: 8 July 02 Locus above: A612

Locus parameters: 'bench' along middle of wall A602 (beside 'hearth' A613)

Verbal description: comprised of 2 rows of stone (like pavers) - (medium size stones)

(0.95 x 0.6 m) → (dimensions of bench)

Locus Interpretative Comments (What do you think this is? DATE your comments, continue on additional pages if necessary):

bench beside hearth/oven (for food etc preparation / vessel storage)

Year 2002 Trench/Locus A614 Excavator MSE

DESCRIPTION of PROGRESS of EXCAVATION [date each entry and identify associated pottery pail(s)]:

- 8 July 02 - one course of 'bench' preserved thus far consisting of essentially of 2 rows of stone (the outer row of 4 stones; the inner ^{several} smaller stones) ~~not a straight line~~
- The outer stones form a straight line for the outer face, while the inner stones are smaller + more scattered
- a 3rd row may have been present originally but was removed during course of excavation
 - bench appears to rest on floor + abut the wall A602
-

Elevations

Reading on

Benchmark: 1.617

H.I.: 365,857

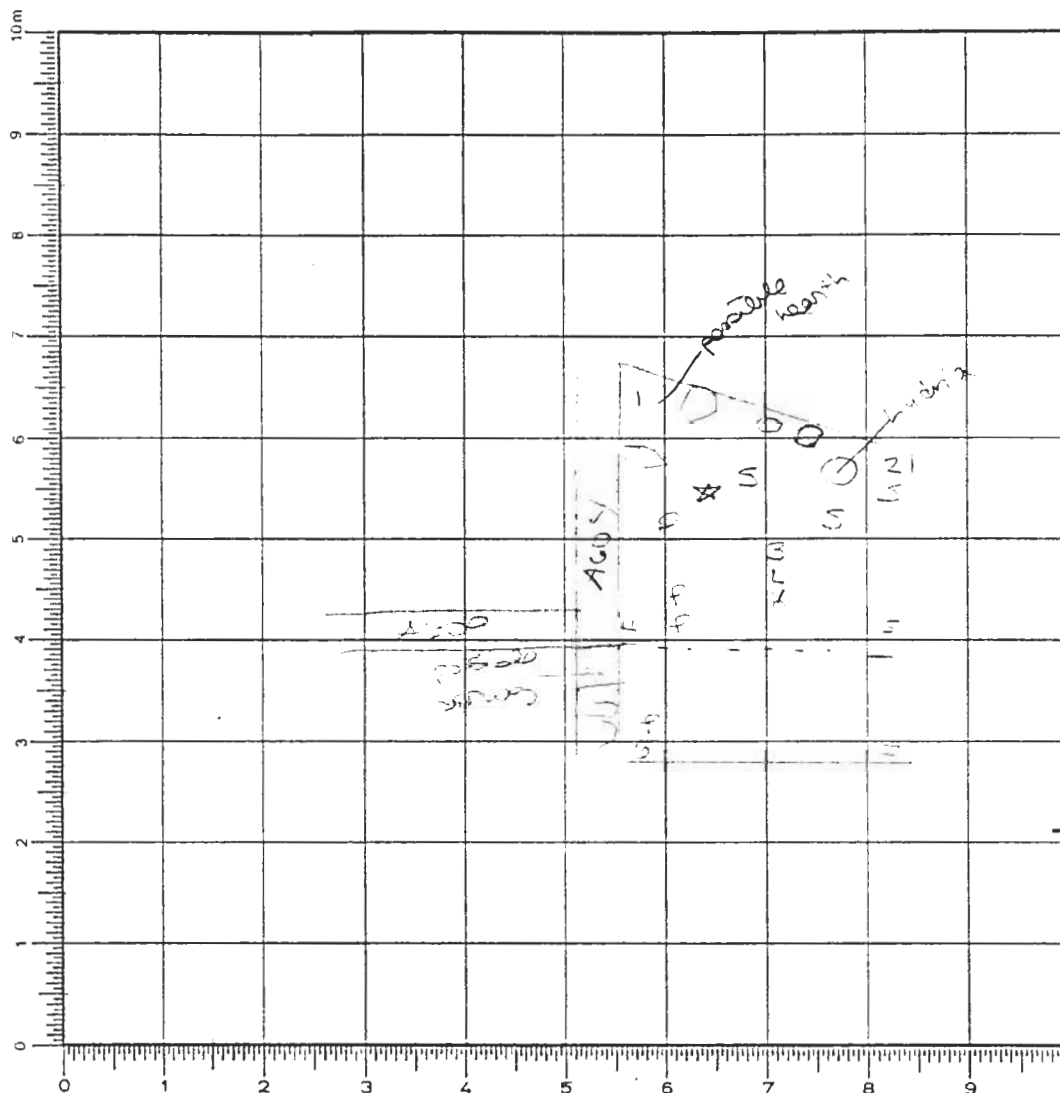

closing A615.3

- 1 - 364,528
- 2 - 364,472
- 3 - 364,395
- 4 - 364,307
- 5 - 364,316
- 6 - 364,301
- 7 - 364,291

clearing AG15.6-7

- 1-364.475
- 2-364.406
- 3-364.226
- 4-364.211
- 5-364.163
- 6-364.066
- 7-364.085

- * binned clay
- O smashed vessel
- L - lead clay
- P - p. this frag
- K - iron knife
- S - stone tool

10m SKETCH 1:75

Today's date: 9 July 02 Locus above: AL05 + some γ AL03

Locus parameters: west γ A602, south γ A604, north γ A608

Verbal description: wall tumble w/ some roofing clay (same as A611)
loose light brown soil w/ many small \rightarrow large rocks
and patches of harder packed orange clay

Locus Interpretative Comments (What do you think this is? DATE your comments, continue on additional pages if necessary):

- possible kitchen

Year 2002 Trench/Locus A615 Excavator MSE

[illegible]

OBJECTS

	Object Number	Associated Pottery Pail	Identification (material/form)	Location	Elevation	Catalogue Number
not a tool	1	AG15.1	stone tool?	middle trench		
	2	AG15.1	vessel fragment	against wall AG02		
green # w/ AG16	3	AG15.6	hydria	near AG02		
	4	AG15.6	iron slag	middle 7 room		
	5	AG15.6	lead item	middle 7 room	364.460	
	6	AG15.6	glass bead	Stew		
	7	AG15.6	iron knife	middle 7 room		

ADDITIONAL COLLECTED MATERIAL

[illegible]

Year 2007 Trench/Locus A615 Excavator MJE

DESCRIPTION of PROGRESS of EXCAVATION [date each entry and identify associated pottery pail(s)]:

7 July 02 - begin removal of remaining tumble; (pass extends beyond approx line of A609 to a 1/2 m from edge of terrace) in attempt to find ~~west~~ wall of room + clarify side walls

A615.1

- ~~west~~ end of pass does not contain the tumble found in the ~~west~~ half towards A602
- many frag. of thin-walled vessel (possibly ^{cooking} pot) found already smashed against ^{middle} wall A602
- exposed more wall tumble near A602 including some large rocks
- some bone found in pass

A615.2

- second pass - removal of tumble from ^{east} end of trench coming down on more tumble → then clearing debris
- removed stone from NW corner - not a feature
- some burnt clay found roughly in middle of trench (sample taken)
- extend pass to ~~west~~ end to look for more roofing debris / roofing clay
- pass revealed that A604 extends south beyond limits of A609
- extent of A608 not found (either remains at lower level or washed down slope)

10 July 02 - completion of second pass at ~~west~~ end of trench

A615.3

- some extension of A608 uncovered to length in inner face of A609
- also more stone / extension of A604 uncovered

A615.4

- begin another pass in wall-tumble / roofing clay → full is deeper than in room ^(A612) beside; more damage to floor may also have occurred in this room than in the other ^{from erosion}
- roofing clay much heavier & higher by wall A602

Year 2002 Trench/Locus A615Excavator MSF

DESCRIPTION of PROGRESS of EXCAVATION [date each entry and identify associated pottery pail(s)]:

[A617]

- 10 July
A615.4 - ~~N corner~~ ^E corner - large patch of ~~bedrock? / burnt clay~~ ^{bedrock? / burnt clay} ~~collected~~
~~a soil sample with other soil in corner~~
 - large "cup" base found smashed up against wall - small sample taken from within as carbon sample
 - much shell found from this pass scattered throughout room + a lot of bone (full bag)
 - much vessel also found in roofing clay near wall

- 11 July 02 - another pass at ~~west~~ ^{east} end of trench, screened 100%
 [A615.5] [b/c still higher than rest of trench]

- in clearing lower wall A602 found vessel smashed against + partially under wall (due to shrapnel + mud, - to be added to base recovered w/ A615.4)

- [A615.6] - another pass in terrible + messy debris - north end
 intensive soil sample taken from around / slightly in pit #1

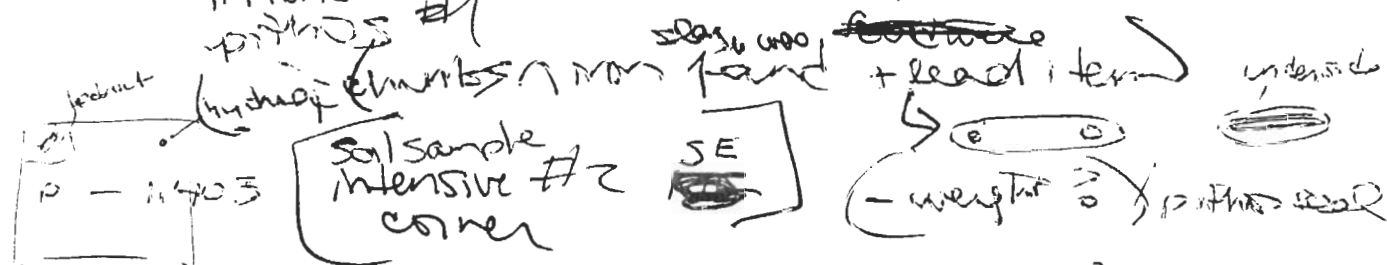

- very much bone + shell throughout
 (1 1/2 bag)
 - fence head, iron knife also found (small piece of bone)
 - into clay, ceiling / habitation debris, though
 tunnels still present
 - cleared around hydrant + pit #1 map
 - pos hearth over a cone of bedrock coming out
 - carbonized seed / white pit found in street
 [full bag (room) of bone + 1/2 (street) + shell line before]
 - several stone tools remain in situ (mortar, hammerstone, grinding stone)

Year 2007 Trench/Locus A615 Excavator MSE

DESCRIPTION of PROGRESS of EXCAVATION [date each entry and identify associated pottery pail(s)]:

- 11 Aug 07 - one final pass in ~~east~~^{west} end of trench to search for extent of cross-walls
- A615, 7 - more pottery frag. found
- possible doorway in this area for A604

[615.6 - gold bead found in residue sorting]

- lead item is possible fishing weight

Year 2002 Trench/Locus A616 Excavator MSEElevations

Benchmark used: R3
 Reading on
 Benchmark: 1.637
 H.I.: 365.877

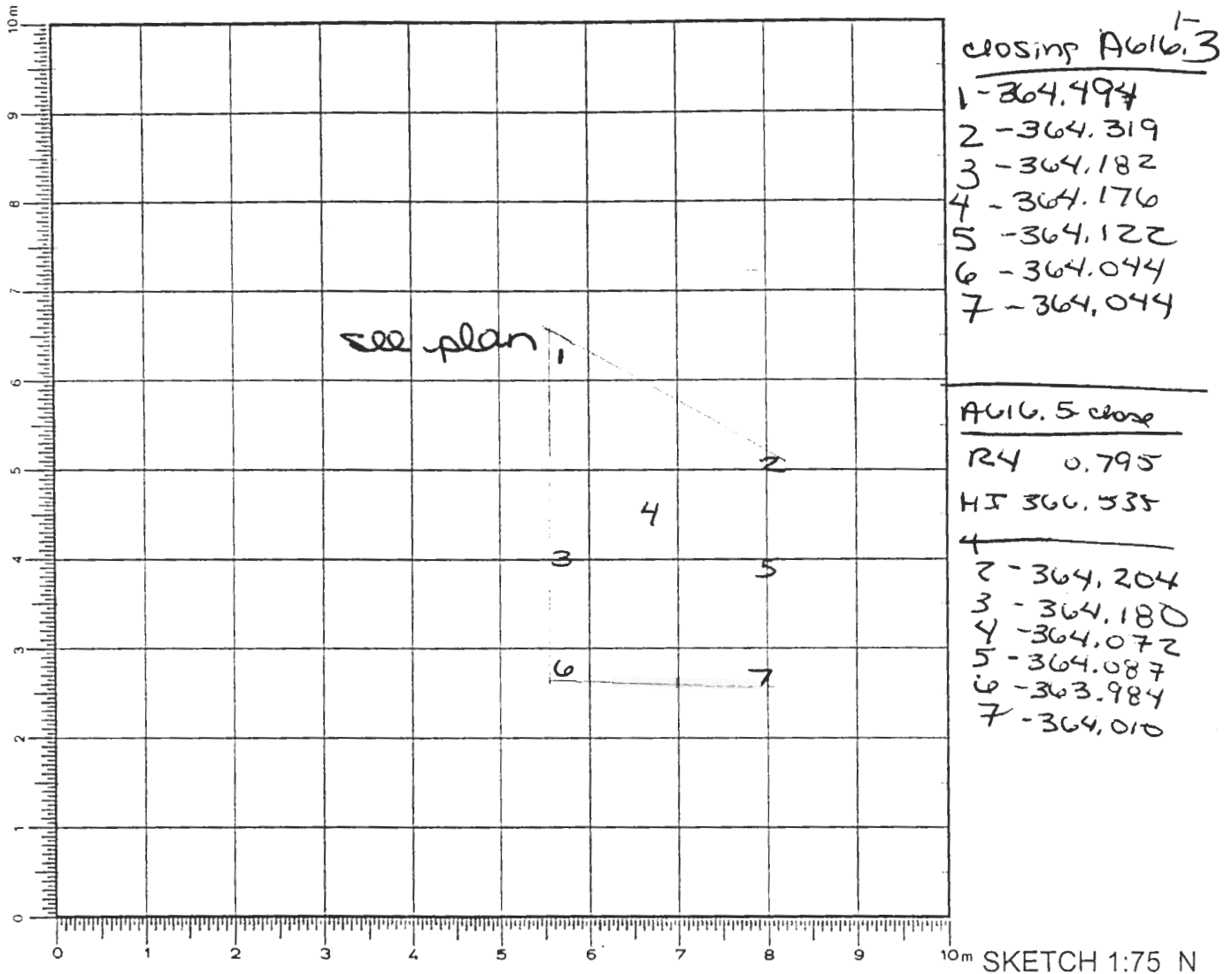

DEFINITION/DESCRIPTION of LOCUS (explain why you changed locus numbers):

Today's date: 12 July 02 Locus above: A615

Locus parameters: (same as A615)

Verbal description: primarily roofing clay w/ habitation debris
(some tumble still left)
-essentially the same as A615 but changed loci b/c
coming down on floor + attempted to isolate
habitation debris

Locus Interpretative Comments (What do you think this is? DATE your comments, continue on additional pages if necessary): habitation debris / dump in kitchen

Year 2002 Trench/Locus A616 Excavator MJE

DESCRIPTION of PROGRESS of EXCAVATION [date each entry and identify associated pottery pail(s)]:

12 July 02 - begin pass at west end of room only

A616.1

15 July 02 - pass over main area of room, searching for floor A616.2 - began w/ removal of pithos base
 - removal of numerous objects (pithos fragments, pumice, tenacetta object (⊙-shaped like stamp seal almost), agrimi horn, stone tools (mortar + hammer stone))

- four soil samples taken

#1 around pithos

#3 near pumice (center of south side)

#2 - middle of room

#4 SE corner

much bone + shell found throughout → concentration of both (1 1/2 bag) (1/2 bag) especially heavy roughly in center of room

- still no carbon deposits found in this room or in north room

- bedrock seems to be appearing in parts of the trench

- uncertain if level is that of floor or is still roofing clay

15 July 02 - A616.3 completion of pass from 15 July → only SE corner remained

- removed soil from around hydra

- ~~soil~~ hydra removed with soil inside

- soil sample taken from below hydra

- bones found throughout seem to come from many different animals, fish, etc

Year 2002 Trench/Locus A616 Excavator MSE

DESCRIPTION of PROGRESS of EXCAVATION [date each entry and identify associated pottery find(s)]:

16 Jul 02 - A616.4 - small pass across area to remove remaining roofing clay + level out floor (except west end)

- 1 standard soil sample taken
- small carbon found near back wall

A616.5 - ^{separate} pass at west end of area to remove remaining pitthos fragments

- Stopped excavation due to end of season

- throughout A615 + A616 (west end of trench excavated separately in attempt to eliminate confusion due to erosion down slope of terrace) - ~~more~~ timber in this area + deeper deposition

- much shell remains visible on floor

Ziron nails/rivets found from water stove inside hydra - A616.3

Year 2002 Trench/Locus A617 Excavator MSEElevationsBenchmark used: R3

Reading on

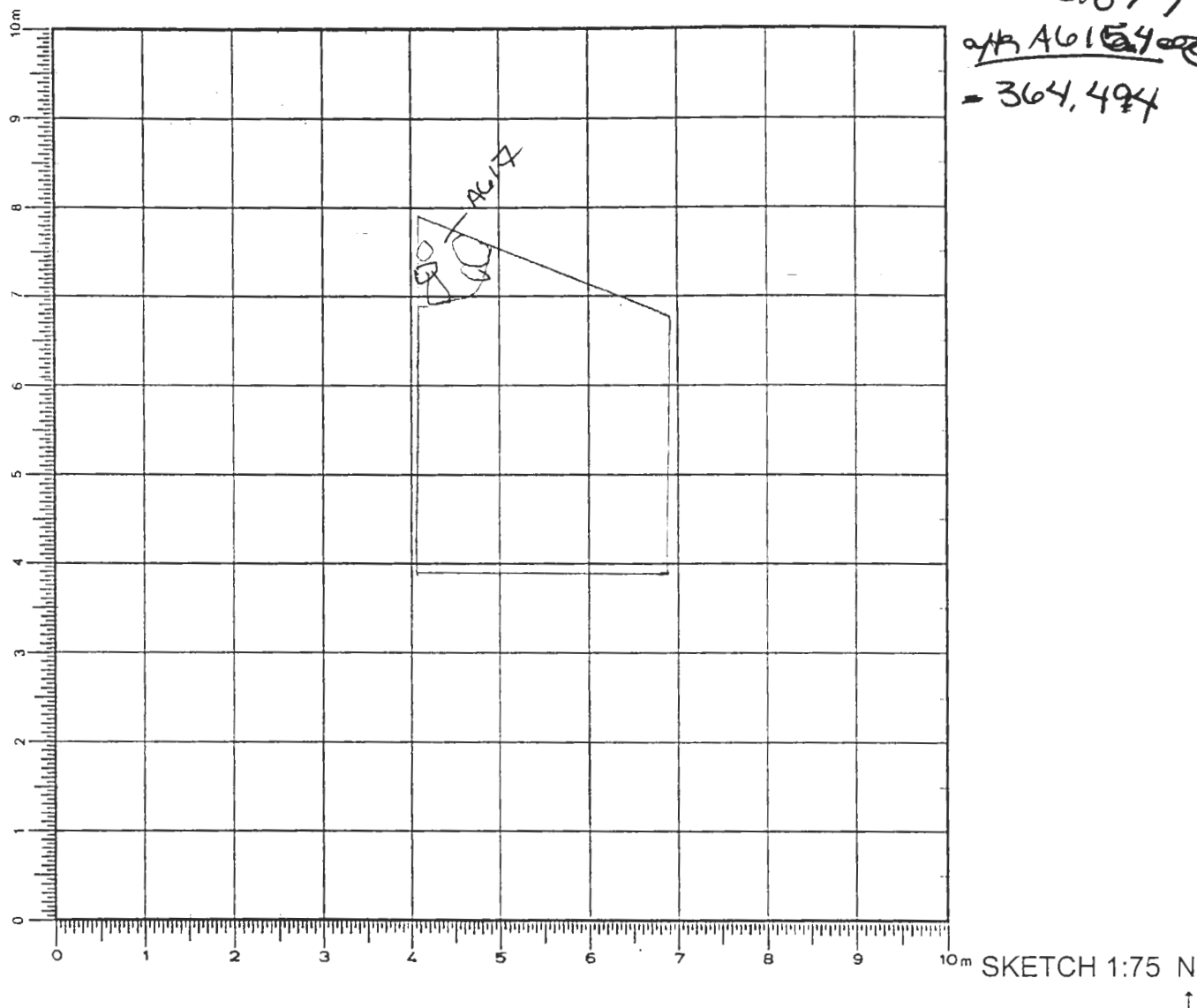
Benchmark: 1.637H.I.: 365.877at A615.400
= 364.494

DEFINITION/DESCRIPTION of LOCUS (explain why you changed locus numbers):

Today's date: 16 July 02 Locus above: (A615.4)Locus parameters: NE corner of A615

Verbal description: ^{large} stones seem to surround area of very red soil
 with many small stones (seems like ^{pre-pre-}bedrock)
 - soil is much higher in this area of room than in rest



Locus Interpretative Comments (What do you think this is? DATE your comments, continue on additional pages if necessary): possible hearth/oven

Year 2002 Trench/Locus A617 Excavator MSE

DESCRIPTION of PROGRESS of EXCAVATION [date each entry and identify associated pottery pair(s)]:

- 16 July area unexcavated after A615.4; soil so very red but seems like the type often found directly above pre-bedrock
- it is unclear whether this corner of trench contained a hearth / oven or has suffered greatly from erosion (or both)
 - left unexcavated due to end of season

