

Final Trench Report: B1900

Trenchmaster: Emily Anderson (ESKA)

Trench Workmen: A. Dantes (entire season), G. Souriadakis (entire season), G. Kaminakis (weeks 6 and 7)

Trench Assistants: Rachael Christopherson and Anne Sassin (weeks 1, 3, 5, 7), William Stevenson and Christine McCann (weeks 2, 4, 6)

Datum Points: R17, elevation: 364.18; R16, elevation: 361.06

Excavation Dates: 1-7 June, 2004; 11 June, 2004

Location: Directly north of **B100** and **B400** on the western slope of the South Acropolis

Excavation was begun in this area in order to understand how this space, which spans the contours of the South Acropolis as it rounds from its southern to western slope, related to the possible domestic areas of **B100** and **B400** (both excavated in 2002) and further to investigate this as a potential area of transition between this terrace and that of **A1900** and **A2000** directly east and above **B1900**.

We began excavation with wall **B142** (the north wall of **B100**) exposed and defining the southern boundary of our trench in the western portion of the trench, and an exposed segment of paved floor **B146**, visible in the SW segment of the trench, serving as a clear guide to our floor level. In the east, the large bedrock outcropping (directly south of **A2000**) served to define our southern boundary. The eastern line of the trench extended approximately 2.50m north from the large bedrock outcropping to the line of a large boulder, the southern face of which marked the northern boundary of the trench in its eastern portion. The trench extended approximately 8.50m westward (down slope) to the western limit of **B1900**.

In the western portion of the trench the paved floor surface (**B146**) was reached with the pass associated with pail **B1903.11**. The floor was found to slope up in the east, the stones uneven. This displacement was likely the result of earthquake activity, as evidence of fallen stones is abundant across the site and the bordering wall **B142** is likewise noticeably disturbed. No habitation debris was found that would indicate a surviving occupational level on the paved floor, yet the matrix in the pass, that was directly atop the floor plakas (**B146**), was markedly finer and darker, while still a loose and somewhat gravelly wash. It is worth noting that the project's architect, Rodney Fitzsimmons (RDF), while cleaning **B146** for drawing, encountered an area of burnt matrix in a depression formed on the paved floor where the stones had apparently buckled (pails **B1903.12-13**). In the east, **B146** met a large stone, apparently a continuation of wall **B131** (from **B100** to the south) thus defining the eastern edge of the paved floor. On the north, wall **B1904**, the top of which was exposed with our first cleaning pass, formed the northern boundary for the room with paved floor **B146**. Locus **B1905** represents the area within the trench located directly north of wall **B1904**. This locus was created in order to differentiate the spaces on the north side of the wall so to facilitate stratigraphic distinction as we proceeded down to the floor.

Locus **B1903** extended throughout the parameters of the trench. The higher pail numbers (**B1903.7-10**) were characterized by fist-sized and larger tumble within gravelly

wash. The lower pail numbers (pails **B1903.1-.6**) contained a smaller proportion of tumble, and some tumble of smaller stones, yet within the same loose and gravelly wash.

Locus **B1906** was isolated to the portion of the trench east of the large stone of wall **B131** that served as the eastern wall of the room with paved floor **B146**. This locus consisted entirely of tumble, some of which was quite large and represented obvious stones slipped from walls **B149** and **B1904**, within fill.

Locus **B1902** and the higher portion of **B1903** (pails **B1903.1-.6**) represented the zone of ancient slope wash. This wash was loose and gravelly containing some tumble from above on the slope and likely from wall **B149**. Locus **B1901** represents the modern surface, also consisting of loose gravelly slope wash and some tumble. The highest course of wall **B149** was uncovered in this initial locus, defining the eastern boundary for the space of **B1900**.

Every locus in this trench contained a wide date range for found pottery, extending from LMIIC through Hellenistic and including pails **B1903.11-.13** that represent excavation directly atop the paved floor. Clearly this slope has suffered a great deal of erosion and any firm depositional context has been lost.

Concluding remarks:

It appears that the room bound by wall **B142** in the south, wall **B1904** in the north, the large stone of wall **B131** in the east, and having as a floor paved surface **B146**, was added in a later stage of the Archaic period than that of the original phase of **B100**. It is likely that the construction of this paved room was contemporary with the installation of wall **B131** through **B100**. Further, a large fallen boulder situated at the SE corner of this paved room may have been incorporated into the room's construction, perhaps even defining the line of the eastern wall. The fact that no clear occupational debris was found atop paved floor **B146** is likely due to both the location of the room at the bottom of a steep slope (thus greatly disturbed by slope erosion) and possibly to the continual cleaning that a paved surface would likely have received preventing noticeable deposition.

The area east of wall **B131**, treated as locus **B1906** after wall **B131** was uncovered, likely was exterior space used prior to the construction of the paved room, perhaps during the earlier phase of the Archaic period associated with the construction of **B100**. A small hearth and bin (**A2502** and **A2503**), uncovered during the excavation of **A2500** (directly to the north of **B1900**), share this exterior space, and further point to some sort of work area having been located here.

Stratigraphical Summary:

- Modern surface, slope wash, gravelly containing some tumble: **B1900, B1905.1**
- Ancient slope wash, loose, gravelly, containing some tumble: **B1902, B1903.2-.6**
- Tumble, fist-sized and larger, within slope wash: **B1903.7-.10; B1906.1-5**
- Finer dark matrix, somewhat gravelly and loose, from directly atop paved floor **B146**: **B1903.11, B1903.12-.13**
- heavy large wall tumble: **B1906.6-.9**

Elevations

Reading on Benchmark: (3.418)

H.I.: 367.60

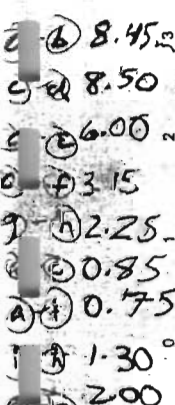

Today's date: 01 June 2004 Locus above: topsoil

Locus parameters: BETWEEN bedrock outcropping (on south side) and another line of rock on the north. The west end runs up to — and the south is $2\frac{1}{2}$ up the slope (E-W)

Verbal description:

Verbal description:
1. Lead disturbed matrix, slope wash. This has been used as a path way up until this morning and the soil is very loose; color = light brown. The locus slopes sharply, falling from the east down to the west. The large outcropping of bed rock on the south serves to define the southern boundary of the locus until it curves to south; a small patch, at least partially atop the back wall of B400, is also included in this locus. The eastern top of the locus is also interrupted by several large rocks extending out from the large bed rock outcropping; a small area, \approx 70m wide, is created between the outcropping and these rocks.

Locus Interpretative Comments (What do you think this is? DATE your comments, continue on additional pages if necessary):

323.28

* 2 pictures taken by Peggy @ start of first pass

[illegible]

OBJECTS

[illegible]

ADDITONAL COLLECTED MATERIAL

[illegible]

Year 2004 Trench/Locus B1901Excavator ESKA

DESCRIPTION of PROGRESS of EXCAVATION [date each entry and identify associated pottery pail(s)]:

01 June 2004

We began by laying out the trench's boundaries, measuring, and taking elevations. This locus, B1901, is presently limited to the upper portion of the trench, at the top of the slope (falling from east to west). On the south, a wall running north from B1400 may continue NE through this portion of the trench. A small portion of our locus extends over stones associated with the wall. In our first pass we used small picks and moved eastward up the slope; we did not yet have workmen with us. The matrix from this pass was obviously wash from the slope containing a small amount of rather abused pottery.

As we continued down in the first pass, some large rocks were exposed. The purpose the second pass will be to determine if these represent the continuation of the spine wall wrapping around the bedrock outcropping from the south, and if so, in what direction they continue. The first pass was completed with a sweeping of the area in order to clean it for the next pass. Elevations for the close of the first pass

R17
Reading (2.002) \triangle^b (2.614) 363.57
H.I.: 366.18 \triangle^b (2.952) 363.23
 \triangle^b (2.982) 363.20
 \triangle^b (2.914) 363.24

Tassos and Georgios arrived to begin the second pass. Our effort was to uncover the stones we could see were associated with the spine wall and to go deeper in order to see where it continued and in order to see how much remained. Tassos went further east than we had originally planned (we were going to hold off in that direction until we found the wall as it was probably full behind it). This worked out well as we were able to trace out the boundaries of the wall a bit more.

After we had more or less considered the pass complete, Donald decided we should go deeper in an area between obvious ~~stones~~ stones of the wall where a space seemed to have dropped out - the idea was to see if we could find the linking area further down.

We ended this pass by sweeping the area down (and cleaning all the matrix that had fallen down into the lower area of the trench).

using small picks
@ end of pass 2
Elevations
R17 (364.18)
Reading (1.834)
HI 366.01
4
 \triangle 363.23 \triangle^b 5 (undiscovered)
 \triangle^b 363.03 \triangle^b 16 (2.784)
 \triangle 362.88 7 (2.979)
 \triangle 362.72 8 (3.134)
 \triangle 363.10 9 (3.292)
 \triangle 362.71 10 (2.708)
11 (3.302)

↑ these elevations seem questionable - it may be time to review reading the stadia rod.

AZORIA Project

Year 2004 Trench/Locus B1902

Excavator ESKA

Elevations

Benchmark used: *R17*

Reading on

Benchmark: *see following pages*
H.I.:

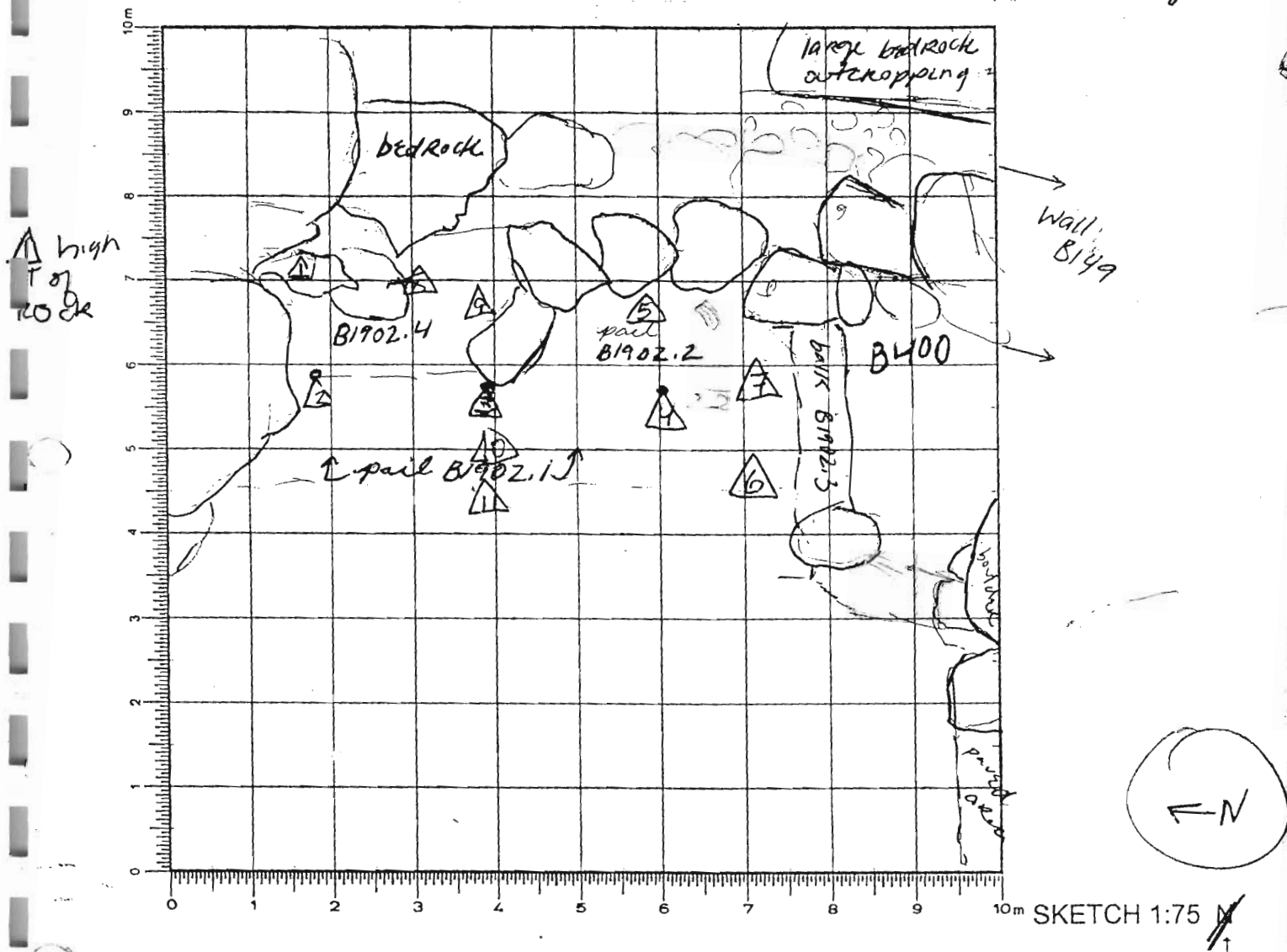

DEFINITION/DESCRIPTION of LOCUS (explain **why** you changed locus numbers):

Today's date: 1 Jun 04 - Locus above: B1901
2 June 04

Locus parameters: directly below (west of) B1901, lower on the slope

Verbal description:

disturbed slope wash; as we worked down we came upon ancient slope wash containing numerous pitthos sherds - some higher up came out, while the majority remained (some exposed). The northern boundary was figured from our projected W-E wall line, which, in this area, runs just south of the large rock on the north. On the south, the line of the balk b/w B400 and our trench, defines another boundary. The ~~eastern~~ boundary, naturally, is the wall we are working towards.

In the WEST, we began just ~~near~~ EAST of the western end of the balk

Locus Interpretative Comments (What do you think this is? DATE your comments, continue on additional pages if necessary):

We believe we have reached the northern continuation of the spine wall as it follows the topography of the hill around the large bedrock outcropping.

* standard soil sample taken 1 Jun.

Year 2004 Trench/Locus B1902 Excavator ESKA

DESCRIPTION of PROGRESS of EXCAVATION [date each entry and identify associated pottery pair(s)]:

1 June 04

We switched down to this locus in order to see if we could work toward the wall and thus establish its line from which to cont.

Tassios and Georgios worked towards our projected wall line, while Anne and Rachel cleaned behind them.

B1902.1 represents the beginning of this pass. Some pithos sherds, probably ancient slope wash, are beginning to be uncovered below.

2 June 2004

We are beginning today by finishing yesterday's pass - B1902.2 is a continuation of B1902.1. Some of the pithos sherds are present here, obviously representing a higher area of the wash on the slope.

We will bring the bulk (b/w our trench and B400) down to the level of the pithos sherds in another pass. Also, a portion of the matrix, still west of our projected wall line but that was not removed yesterday, will have another pass number in case it represents something different than B1902.1/B1902.2.

- We're taking another SL standard soil sample from B1902.2 and the pair north of it (B1902.4) in addition to the one taken yesterday in B1902.1 in order to get a more complete idea of this area's soil.

- Bulk measure $\approx 1.10m$ in length and ranges from $0.45m$ in width.

- B1902.2 also includes the portion directly ~~sub~~ west of B which was begun in B1902.1 yesterday but needed to come down a few more centimeters to be @ the 'pithos level' (i.e. level that pithos sherds exposed).

- B1902.2 has exposed more of the pithos sherds that will be brought up in the next pass in the area (and in a new locus). Thus far, there are isolated to the southern half of this area.

Year 2004 Trench/Locus B1902 Excavator ESKA

DESCRIPTION of PROGRESS of EXCAVATION [date each entry and identify associated pottery pail(s)]:

25 June 04 cont

- after finishing some sweeping in the area of B1902.2, we removed the balk between B1902.2 and B400 - we called this B1902.3. Several more of the pithos sherds, like those exposed during removal of B1902.2 and B1902.1, were found here.

*(and some collected in B1902.2)

Tassos and Georgios have returned to remove B1902.4 in the area ^{north} ~~west~~ of B1902.2 and still ^{west} ~~south~~ of the projected spine wall line. This pass will take us up (east) to a patch of bedrock, where we suspect the line of the wall UNCOVERED runs to.

Tassos has come up against the patch of bedrock, ~~where~~ which sticks out beyond the wall line - part of this appears to also be smaller rocks that have simply washed down.

Peggy and Donald have decided that we'll remove ~~more~~ smaller ^{in the continuing effort to find the 'face' of this wall} ~~stones~~.

- Meanwhile, Anne and Michael are cleaning the top of the wall for Rod to come SEE.

Closing Elevation for
B1902

364.18 ~~4R17~~ ^{used} \rightarrow (1.892)
Reading ~~(1.846)~~

HI: 366.07

additional elev's for close B1902

using
R17 \rightarrow 364.18

Reading (1.818)

HI: 366.00

10 (7.552) \rightarrow 362.448

11 (3.820) \rightarrow 362.18

12 (3.440) \rightarrow 362.63

~~13~~

1 (3.042) \rightarrow 363.03

2 (3.488) 362.58

3 (3.486) 362.58

4 (3.614) 362.46

5 (3.468) 362.60

6 (3.756) 362.314

7 (3.582) 362.49

8 (3.262) 362.81

Year 2004 Trench/Locus B1903 Excavator ESKA

Elevations

Benchmark used: R17
 Reading on
 Benchmark: (see following
 pages)
 H.I.:

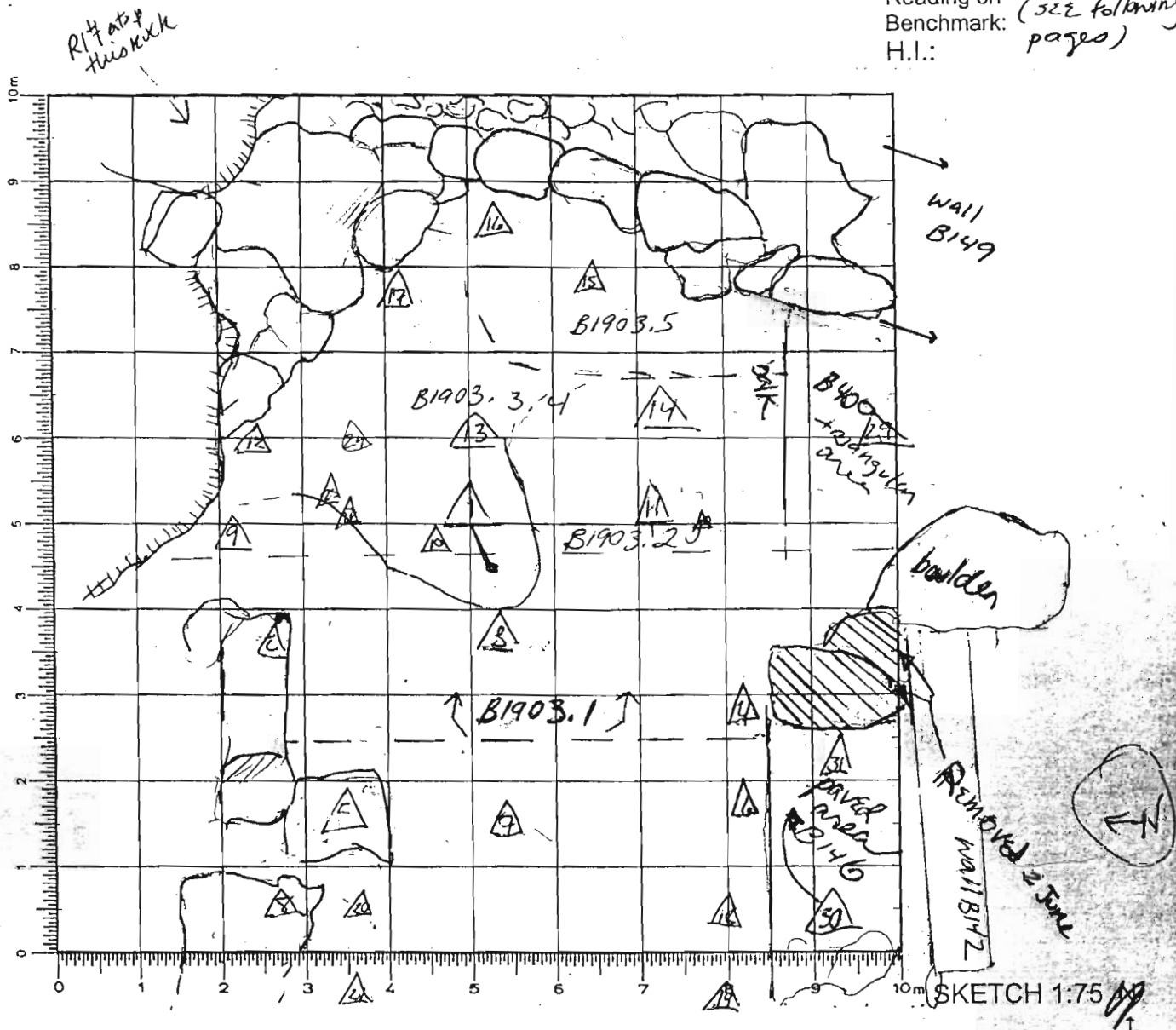

DEFINITION/DESCRIPTION of LOCUS (explain why you changed locus numbers):

Today's date: 2 June 04 Locus above:

Locus parameters: WEST OF B1902.1 ON slope; following the present back (EAST SIDE) of the paved room (not thought to actually be a continuing cross wall, though) north. OUR WESTERN boundary was defined. On the north, the line of the projected wall
 Verbal description: and 15-20cm beyond was the northern boundary. On the south, the line of the bulk continued as our boundary

This locus began to clear modern WASH from the lower (western) part of the trench, bringing it down to the level of ancient WASH reached above in B1902. It continued, working east, to take out the wash (including that containing the pithos sherd) up to the wall. Locus predominated by tumbled in the wash that defined this slope

Locus Interpretative Comments (What do you think this is? DATE your comments, continue on additional pages if necessary):

Locus/Pottery Pail Number	Weight of Sherds	Number of Sherds	Chronology & Comments
B1903.1	2.91 kg	64	Archaic, LMTIC
B1903.2	8.995 kg	59	LMTIC, Late Geometric, Archaic, Hellenistic
B1903.3	11.545 kg	58	Archaic, LMTIC
B1903.4	6.225 kg	47	Orientalizing ^(7th) , Archaic ^(6th) , Hellenistic
B1903.5	6.055 kg	59	Archaic
B1903.6	6.74 kg	61	Archaic, Orientalizing
B1903.7	1.67 kg	77	Archaic, LMTIC
B1903.8	1.225 kg	49	Archaic, Late Geometric
B1903.9	4.69 kg	50	Archaic ^(6th) , Late Geometric, LMTIC
B1903.10	2.30 kg	190	Hellenistic, Archaic, Late Geometric
B1903.11	0.365 kg	60	Archaic, Hellenistic, LMTIC
B1903.12	0.042 kg	24	Archaic, Hellenistic?
B1903.13	0.015 kg	12	Archaic

from road & drainage

OBJECTS

Object Number	Associated Pottery Pail	Identification (material/form)	Location	Elevation	Catalogue Number

ADDITIONAL COLLECTED MATERIAL

Locus/Pottery Pail Number	Bones	Shell	Carbon	Pumice	Soil Sample	Other (specify)
B1903.1	✓					
B1903.2	✓					
B1903.5	✓					
B1903.7	✓					
B1903.8	✓					
B1903.9	✓					
B1903.10	Reg. 1/4"					
B1903.11	1/4" scum					
B1903.12						

* from atop paved
* paved floor - burnt area

Year 2004 Trench/Locus B1903 Excavator ESKA

DESCRIPTION of PROGRESS of EXCAVATION [date each entry and identify associated pottery pair(s)]:

2 June 04

We are opening this locus with a cleaning pass.

Simply to remove the modern wash, from the line that runs along the back of the paved area - a possible wall. B1903.1 Part of the objective of this pass will also be to see if this possible wall continues through B1900. The northern boundary ~~with~~ runs along w/ the trench's, about 15-20cm beyond the line of stones that we think may represent a wall - this pass may make this somewhat clearer.

- We're using small pick s. ^(The material from this pass is likely the same as that from B1901)

Overall, w/ this pass, we need to clear off the modern wash, some of which is a part of our old dump from 2003, to see how this continues w/ the ancient wash above on the slope uncovered w/ B1902.1 and B1902.2

- We have included in this path the stones resting on the corner of the trench and the "paved area" (see sketch). They were removed and any sherds that came up were included in B1903.1

- Since @ this point we are merely cleaning off the wash from atop the probable northern wall, we are including any sherds and bones found on the immediate northern side of it in B1903.1 also; at all later points these two areas will be divided.

- no evidence for the continuation of the "cross wall" that appeared to have run behind the paved area has been found. It now seems likely that the paved room extended back towards the spine wall, with its southern wall (B149) extending back beneath the boulder that seems to have fallen atop it - we'll see.

- after bringing the pass a bit further east (up the slope) we are sweeping for a photo

- we will need to set up the level to take elevations from a lower point

(in fact, with the five meter stick, we were able to take some from R17 (see next page))

* photo taken by Peggy @ close of B1903.1

Year 04 Trench/Locus B1903 Excavator ESKA

DESCRIPTION of PROGRESS of EXCAVATION [date each entry and identify associated pottery pail(s)]:

the elevations listed to the right represent what lies below the slope wash (including our own dump contamination from 2003).

elevations from close
of B1903.1
364.84 R17 reading (1.818)
H.I. 366.00

361.91 ← 1 (4.094)
361.76 ← 2 (4.244)
361.62 ← 3 (4.376)
361.52 ← 4 (4.480)
361.54 ← 5 (4.464)
361.41 ← 6 (4.588)
361.25 ← 7 (4.750)
361.432 ← 8 (4.568)

B1903 will now continue east, thus overlying part of the area which had contained B1902. By bringing B1903 up through this the like wash will be better kept together.

B1903.2 - begins:

- WE ARE NOW CONTINUING up the slope (~~west~~^{east}) into the matrix containing the pithos sherds. We are using green bags, and have had to begin a new pail #, B1903.3, with ~~up~~ a new bag for the sherds. - A third also needed, B1903.4

This pass is going deeper into the areas covered by B1902.1, B1902.2, and B1902.4

- Foreman Manolis has commented that the matrix ~~above~~ they are removing is significantly less compact than that below.

The pithos sherds, previously seemingly confined to the southern half, are now coming up across (north-south) the trench in this area.

- Foreman Manolis, using small pick and Kazma^(sp), has worked somewhat further ~~west~~ east, removing matrix from below the rock upon which R17 is located. The pass has also gone deeper on this (the north side) now.

Like thinks he sees a turn in the apparent spine wall continuation on an ~~additional~~ wall connected to it at the bedrock portion in the NE corner, running E-W. We'll see

one soil sample for B1903 from B1903.12 through out

Year 2004 Trench/Locus: B1903 Excavator FSKA

DESCRIPTION of PROGRESS of EXCAVATION [date each entry and identify associated pottery pail(s)]:

3 June 04

we are beginning by sweeping down the trench ^{using small picks} because we did not yesterday afternoon; it is just the assistants for now.

B1903.5 to simplify the completion of the pass containing B1903.2, 3, 4 from yesterday. Due to the large number of sized pithos sherds, several pails have been necessary.

After the possible turn of the wall (or a different wall wall together) that foreman Maris found @ the end of yesterday afternoon, this pass and the subsequent one, will hopefully help to clarify whether or not this is a wall, and if so, how it relates to the continuation of the spinewall (running north or northeast) and the east-west wall in our trench.

- we have had to add another pail for these pithos sherds: B1903.6

- elevations for the close of this pass, which continued from yesterday's B1903.2, 3, 4 and today's B1903.5, 6

core: Benchmark R17, 364.18

Reading (1.856)

H.I.: 366.02

9 (3.878) 362.14	12 (3.738) 362.28	15 (3.656) 362.36
10 (3.918) 362.10	13 (3.782) 362.24	16 (3.658) 362.36
11 (3.936) 362.08	14 (3.782) 362.24	17 (3.701) 362.32

- Tassos and Georgios have arrived. We have begun a run pass with B1903.7. This is directly below B1903.2-6. We are working east again to the parameters set by the continuation of the spinewall and this possible east-west extension. As this new possible wall does not (as of yet at least) appear to line up with the east-west wall we can trace further west (this more western wall also seems to continue back eastward on a line further north south) this pass should hopefully let us see their relation.

- some more - far fewer, though, of the pithos sherds have come up with this pass.

Year 2004 Trench/Locus B1903 Excavator ESKA

DESCRIPTION of PROGRESS of EXCAVATION [date each entry and identify associated pottery pail(s)]:

— 3 June 04 cont.

Now we are moving back in B1903.7, moving back and towards the north east corner. More and more fist-sized and slightly larger rocks are coming up - we did not see nearly as many in the beginning of the pass (further west) ~~than~~ ~~now~~ during the passes above this one (B1903.2-6).

— a lower course of the spine wall is appearing in line and as expected, the wall as exposed w/ this pass now stands 1.05 - 1.10 m high

— Elevations for the close of B1903.7 were taken @ the same points used for the close of B1903.2-6 are:

Benchmark: R17, 364.18

Reading (2.212)

HI: 366.39

9 (4.328) 362.06

10 (4.448) 361.94

11 (4.498) 361.89

12 (4.299) 362.11

13 (4.388) 362.00

14 (4.429) 361.96

15 (4.281) 362.11

16 (4.207) 362.18

17 (4.138) 362.25

↳ below bit of bedroom

— We are starting a new pass with B1903.8. This is directly beneath B1903.7, again working within the parameters of the spine wall and the possible E-W wall that Mamulis found (in the NE corner). With this pass we are bringing it down to the level of the adjacent area of B400 (thus eliminating the 'balk' (see sketch))

— The 'fist-sized and larger' gravel (fill?) is coming up in this pass, as well.

— Stand. soil sample taken

Year 2004 Trench/Locus ~~B1903~~ B1903 Excavator ESKA

DESCRIPTION of PROGRESS of EXCAVATION [date each entry and identify associated pottery pair(s)]:

4 June 04

We're starting w/ the closing elevations for B1903.8; we are also taking elevations further down slope (west) of this pass as a lot of cleaning has taken place here since the last were taken

R17, 364.18

reading (1.618)

HI: 365.80

some elevations taken from same spots that ones were taken for earlier levels (note same numbers)

1 (4.028) → 361.77

2 (4.054) → 361.75

3 (4.281) → 361.52

4 (4.289) → 361.51

5 (4.271) → 361.53

6 (4.328) → 361.47

7 (4.492) → 361.31

8 (4.347) → 361.45

9 (3.821) → 361.98

10 (4.022) → 361.78

11 (4.120) → 361.68

12 (3.766) → 362.034

13 (3.971) → 361.83

14 (4.090) → 361.71

15 (3.871) → 361.93

16 (3.635) → 362.17

17 (3.456) → 362.34

18 (4.638) → 361.162

19 (4.802) → ~~361.00~~ 361.00

20 (4.559) → 361.24

21 (4.778) → 361.02

from atop rock tumble

~~22 (3.848)~~ not a stone from wall

22 (3.828) → 361.97

23 (3.848) → 361.95

24 (3.856) → 361.94

25 (3.933) → 361.87

26 (3.873) → 361.93

27 (3.567) → 362.23

28 (3.747) → 362.05

knowing slight

We began this morning, after taking elevations: by cleaning through the trench, especially cleaning the wall tumble in order to garner a bit better definition. At this point, we are dividing B1900 into two loci, one to the south and one to the north of the wall. Our first pass today will continue in B1903 into B1903.9. We are removing tumble from down slope up, conscious of the fact that at the western (down slope) end we are very close to the floor surface of the adjacent exposed paved area.

Year 2004 Trench/Locus B1903 Excavator ESKA

DESCRIPTION of PROGRESS of EXCAVATION [date each entry and identify associated pottery pail(s)]:

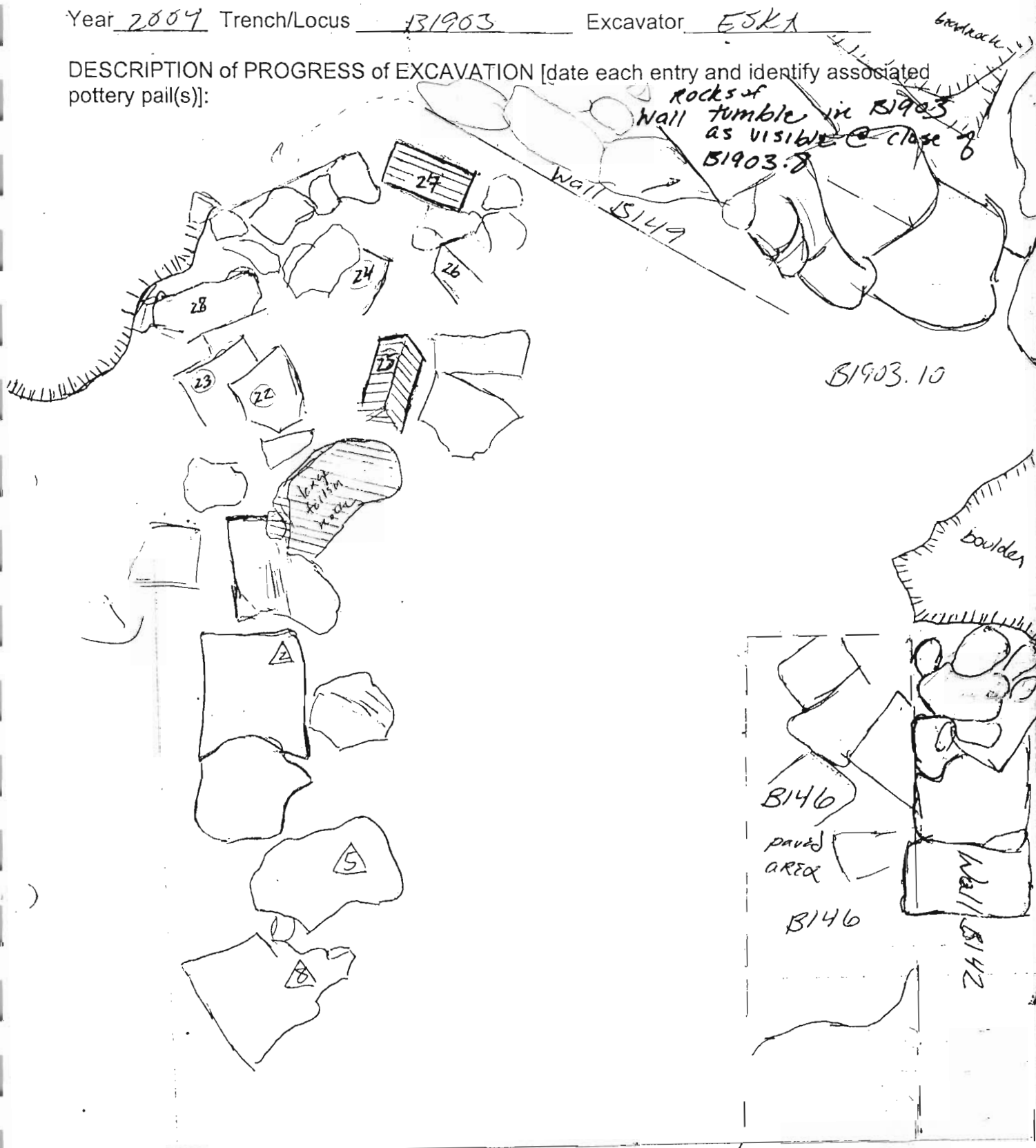

Tassos has removed 25, 27

(This portion folded side left)

- with this pass (pail B1903.9) the matrix is still loose and obviously Ailen in about the tumble we are removing
- Tassos has arrived (Georgios is out today) and is continuing the pass back east (up slope)

Year 2004 Trench/Locus B1903. Excavator ESKA

DESCRIPTION of PROGRESS of EXCAVATION [date each entry and identify associated pottery find(s)]:

4 June 04, cont...

- as Tassas is moving further up slope in B1903.9, he is coming up with some large pithos sherds. The ~~a~~ matrix here is still loose, but the slope of the paved floor should be or could be ~~approaching~~ the level we are working at now. These sherds are more ~~than~~ likely the same as we found above, though.
- after running them by Peggy, a number of the stones Tassas wanted to take out came at - he knows.
- Anne and Rachel are ~~moving~~ going through and cleaning the stones ~~on~~ the wall so that we can have some better definition in this area.
- we are taking a standard soil sample with what we dug of B1903 today in order to keep the representation for the locus complete
- we are expanding the pass on the southern side of the wall (B1903.9) to include the triangular area of B400 previously excavated by Joe (the area that had been to the south of the 'balk')

Benchmark R17 Reading (2088) i. HI.

Elevations from triangular area ~~to~~ ^{at} (4.528)

→ for Monday: finish pass → triangular area west (NW) of wall B149 and take elevations for close of pass

7 June 04

- we are beginning by finishing the pass we ended w/ on Friday heading into the triangular area west of B149
- @ this point we are screening our 5 zumbilia for wall tumble. ∴ this pail B1903.10 is simply the completion of the same pass represented by B1903.9
- the matrix appears the same as it was further north and west in this pass. We continue to have many fist-sized rocks, although perhaps a bit fewer of the ones that are slightly larger.
- the matrix is very soft now as we are moving ~~into~~ through the triangular area

Year 2004 Trench/Locus B1903 Excavator ESKA

DESCRIPTION of PROGRESS of EXCAVATION [date each entry and identify associated pottery pail(s)]:

7 June 04, cont. HI: ~~365.98~~ *365.98, *366.00 (1.80) * (1.816)
 benchmark R17, 364.18 reading ~~364.18~~

elevations for close of B1903.9 and B1903.10

21 (4.982) 361.00	4 (4.55) 361.43	*14 (4.45) 361.55
109 (4.970) 361.01	3 (4.565) 361.42	*29
20	*10 (4.457) 361.54	*15 (4.192) 361.81
18	*9 (4.01) 361.99	*16 (4.113) 361.89
7 (4.823) 361.16	*11 (4.437) 361.56	*17 (4.125) 361.88
	*12 (3.98) 362.02	30 (4.950) 361.03
6 (4.785) 361.20	*13 (4.355) 361.65	31 (4.790) 361.19
		*29 (4.425) 361.56

- we are screening 100%

- While screening B1903.10, chunks of the plaster from the cistern on the hilltop were showing up - this indicates that we are turning up slope wash. However, it is important to note that the triangular area has been exposed.

- We are starting a new pass to clean up contamination at the bottom of the slope. It is about a meter wide using the edge of the paved area on the south and wall B1904 on the north as our parameters. This pass is bringing us down directly atop the paved level.

- Since this pass really represents the same wash we took off w/ the surface level, we are calling it B1901.3. *Peggy took photos

- we have begun another pass moving upslope (East) from the small scarp we made w/ B1901.3 through the wall tumble, going down to the level of the paved level. The matrix has become markedly darker @ the paved level.

- this pass is being treated as part of the same locus (B1903) as previous passes, although we are now coming down on the floor.

Year 2004 Trench/Locus B1903 Excavator ESKA

DESCRIPTION of PROGRESS of EXCAVATION [date each entry and identify associated pottery pair(s)]:

7 June 04 cont.

This pass will continue back until we reach the line of the boulders and large rock beside it

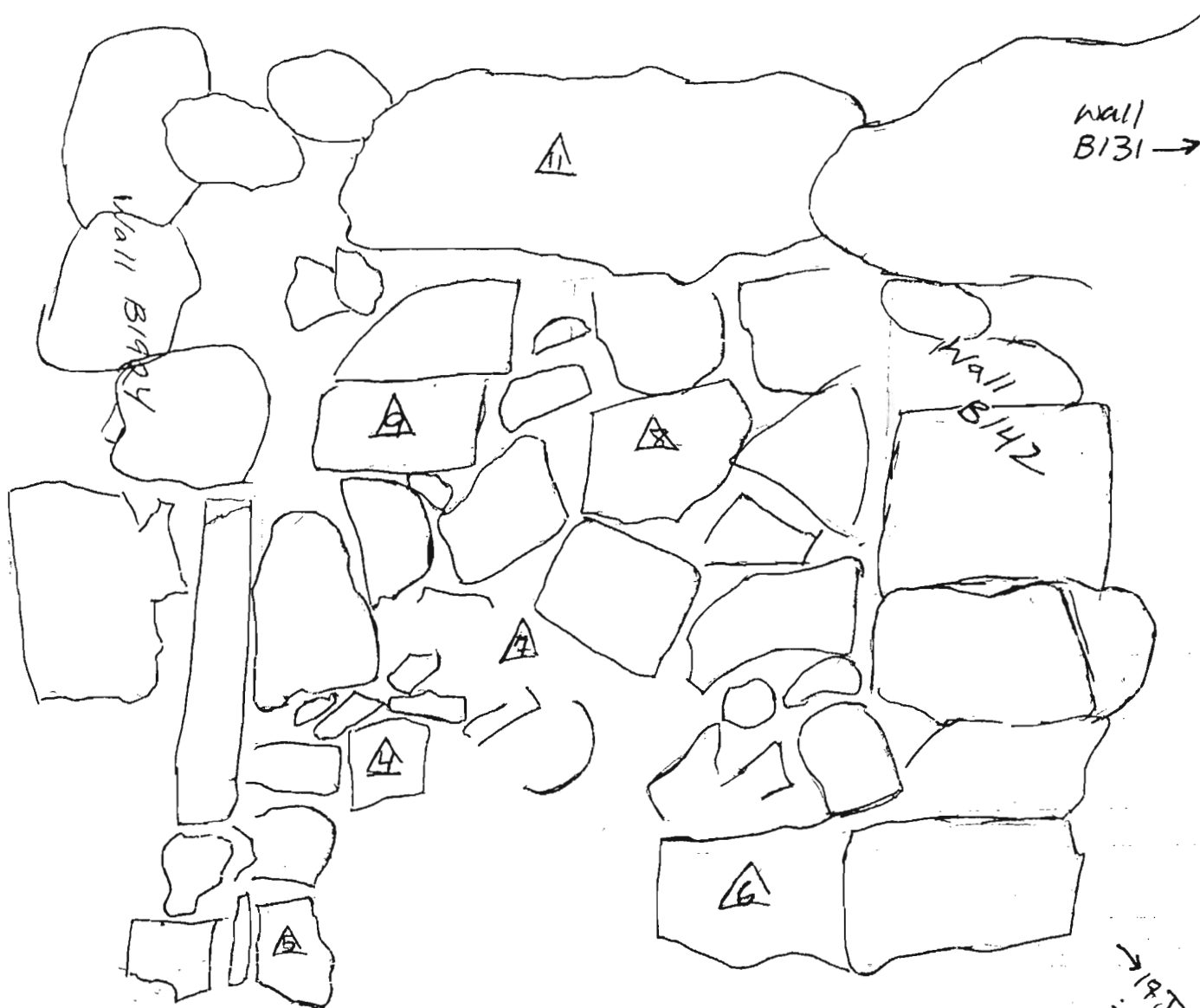

→ 19 June 04
 During excavation of Red
 tamarisk (B1903.12)
 the dirt was excavated
 by the dirt raised area
 (c. 1.5m x 1.5m)
 - intensive sketch
 - 15.8.1903.12
 - 10.8.2004.12

Elevations from close of B1903.11

R16 (1.415) HI: 362.48

1 (1.70) 360.77

2 (1.74) 360.72

3 (1.648) 360.83

4 (1.521) 360.96

5 (1.680) 360.80

6 (1.528) 360.95

7 (1.565) 360.92

8 (1.355) 361.13

9 (1.42) 361.06

11 (0.779) 361.50

Year 2004 Trench/Locus B1904 Excavator ESKAElevations

Benchmark used:

Reading on

Benchmark:

H.I.:

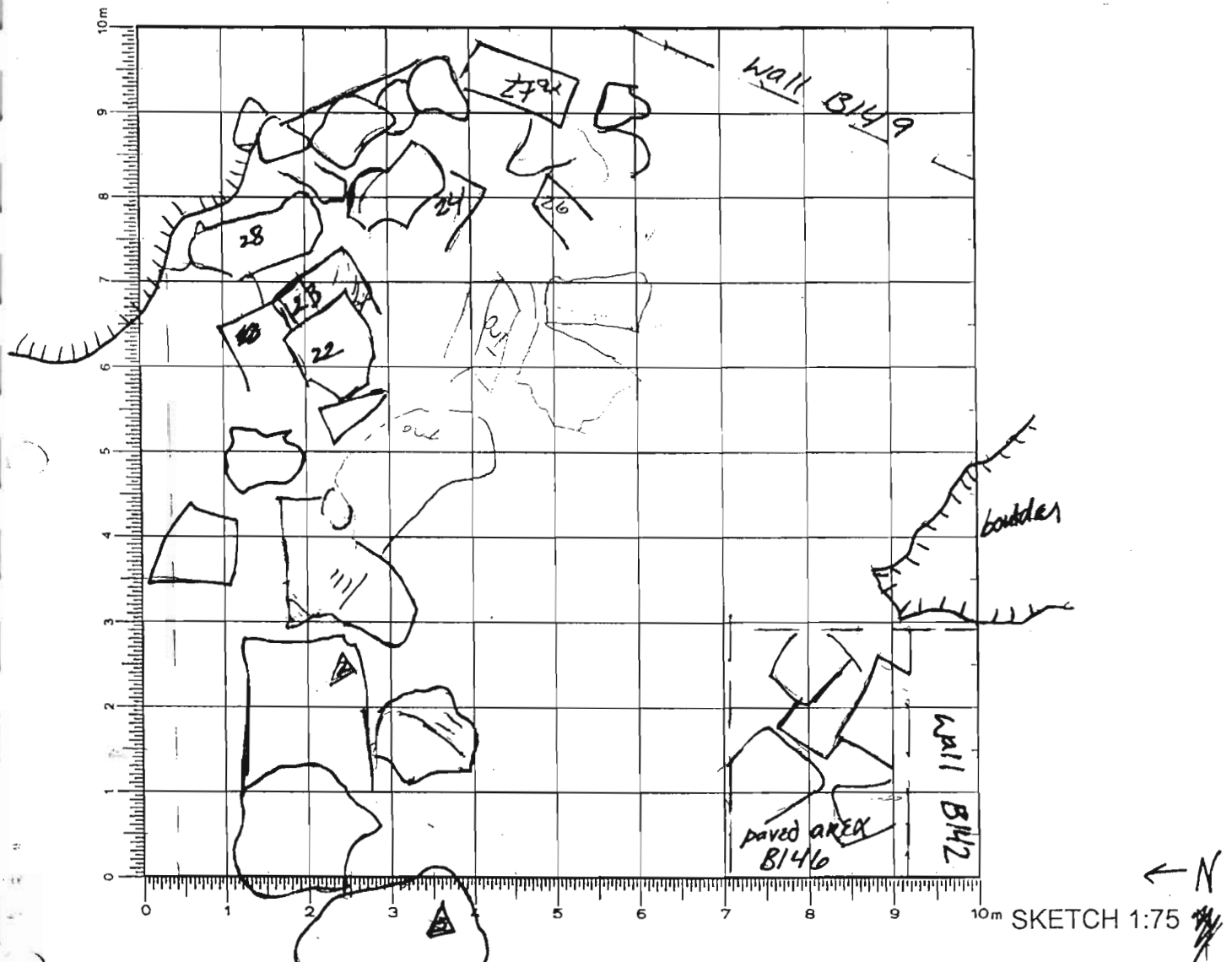
DEFINITION/DESCRIPTION of LOCUS (explain why you changed locus numbers):Today's date: 4 June 04

Locus above:

Locus parameters:

Verbal description:

East-west wall running along the northern side of the trench. At this point the areas north of and south of this wall will be considered different loci as they represent different spaces.

Locus Interpretative Comments (What do you think this is? DATE your comments, continue on additional pages if necessary):

[illegible]

OBJECTS

[illegible]

ADDITIONAL COLLECTED MATERIAL

[illegible]

Year 2004 Trench/Locus B1905 Excavator ESKA

Elevations

Benchmark used:

Reading on

Benchmark:

H.I.:

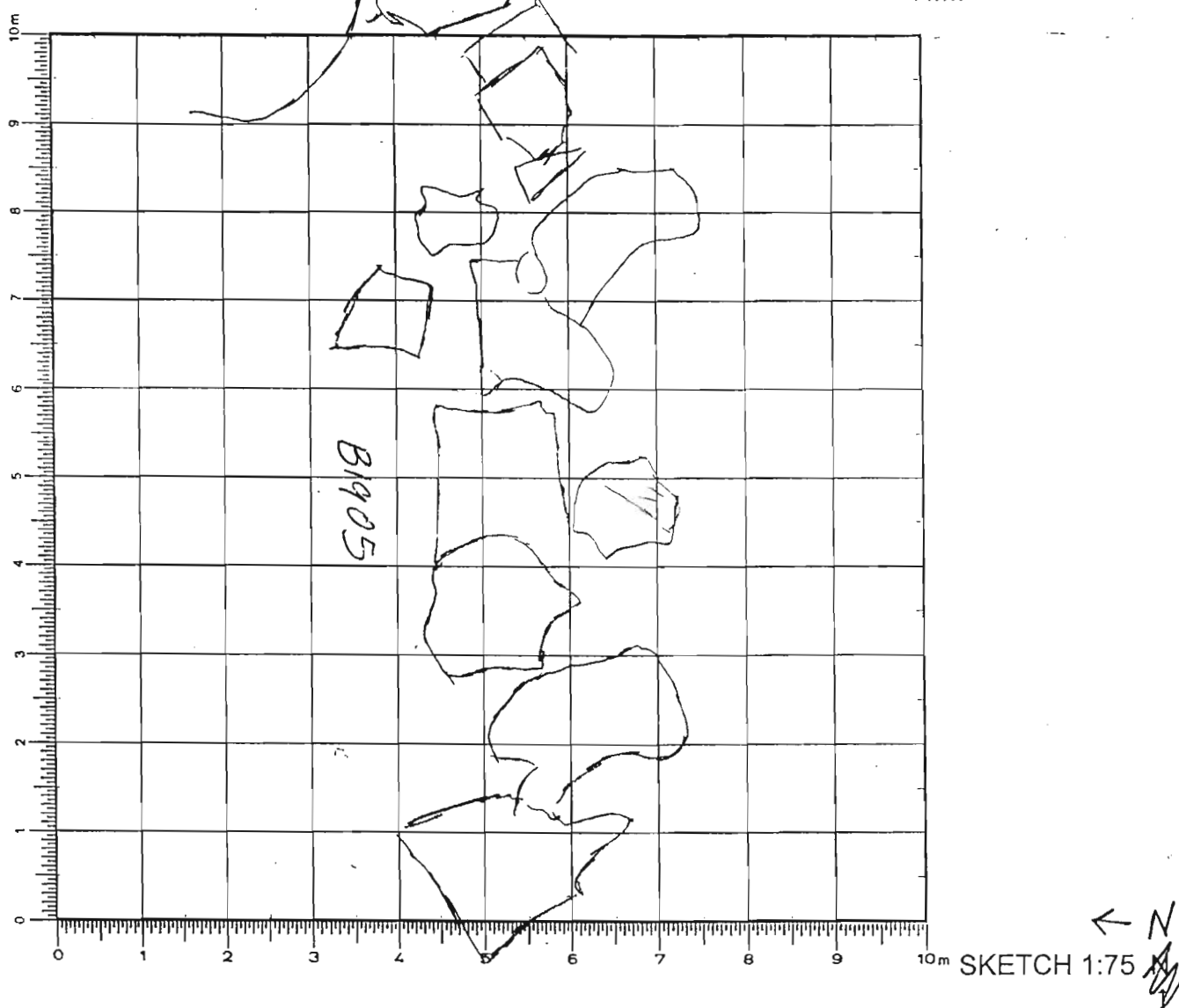

DEFINITION/DESCRIPTION of LOCUS (explain why you changed locus numbers):

Today's date:

Locus above:

Locus parameters: *to the north of wall B1904*

Verbal description:

Our first pass here is simply to clear off enough to find the northern face of B1904. We have cleaned in this area several times as it was considered part of the previous locus here (B1903).

Locus Interpretative Comments (What do you think this is? DATE your comments, continue on additional pages if necessary):

** A new locus in a trench A was begun 9 June 04 and includes the area of this locus, ∴ B1905.1 (the surface pass) = A .1*

Year 2004 Trench/Locus B1906 Excavator ESA Elevations

Benchmark used:

Reading on

Benchmark:

H.I.:

Sketch by 171 x

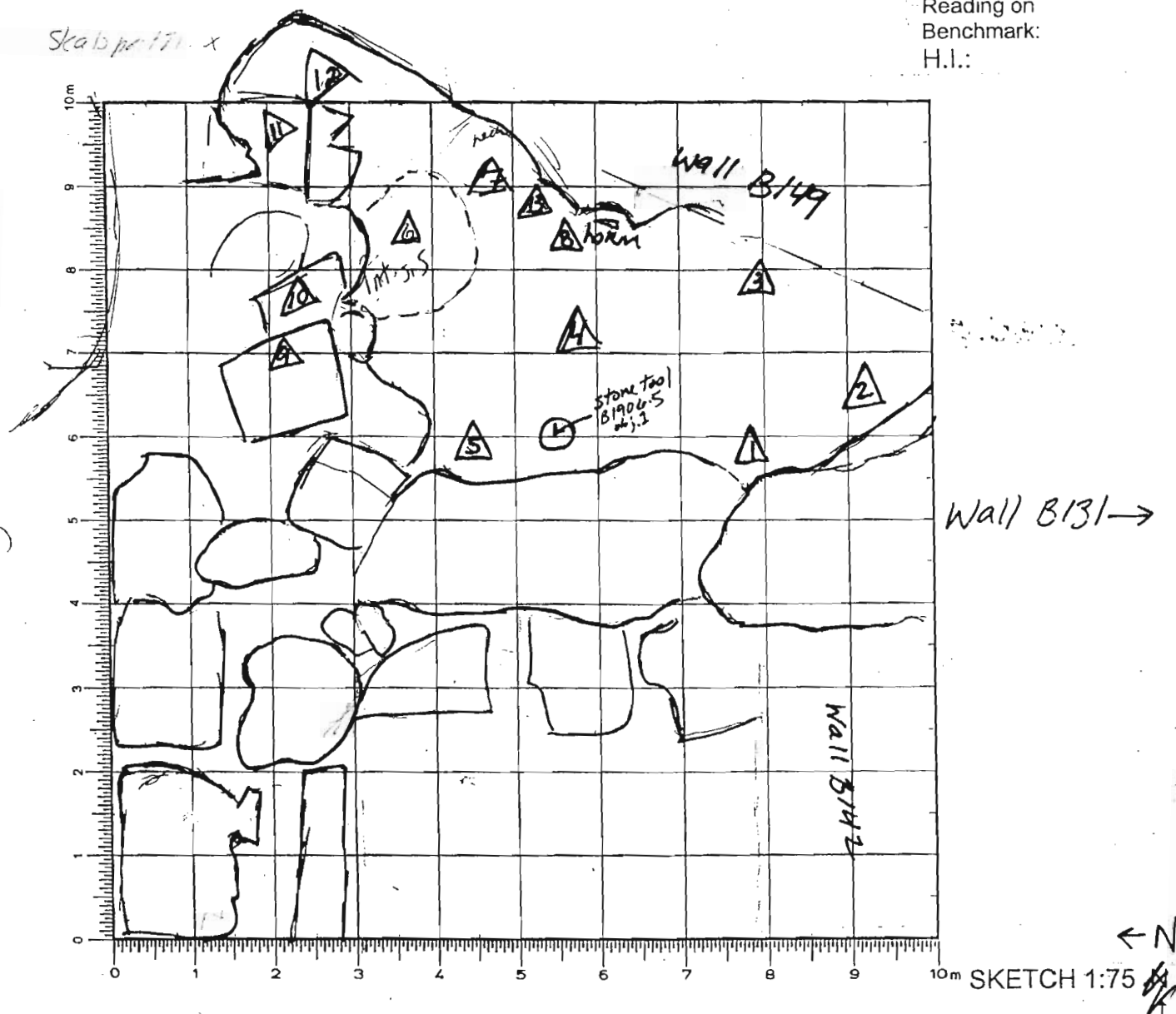

DEFINITION/DESCRIPTION of LOCUS (explain why you changed locus numbers):

Today's date: 7 June

Locus above:

Locus parameters: East (up slope) of B1903.11 - behind the large rock and boulders

Verbal description:

Locus Interpretative Comments (What do you think this is? DATE your comments, continue on additional pages if necessary):

AZORIA Project

p.2

Year 2004 Trench/Locus B1906 Excavator ESKA

Locus/Pottery Pail Number	Weight of Sherds	Number of Sherds	Chronology & Comments
B1906.1	2.90 kg	320	LM IIC, Late Geometric, Orientalizing, Archaic
B1906.2	2.950 kg	310	Protogeometric, Late Geometric, Early Orientalizing
B1906.3	1.645 kg	120	Archaic, Late Geometric, LM IIC
B1906.4	0.500 kg	69	Late Geometric, Archaic, Hellenistic
B1906.5	1.550 kg	102	Archaic, Hellenistic? (late 3rd)
B1906.6	0.288 kg	19	LM IIC, Archaic, Hellenistic
B1906.7	0.533 kg	123	Archaic, Orientalizing, LM IIC
B1906.8	20.01 kg	1	Early Iron Age - Archaic
B1906.9	0.778	49	LM IIC, Early Iron Age, Archaic

OBJECTS

Object Number	Associated Pottery Pail	Identification (material/form)	Location	Elevation	Catalogue Number
B1906.5		stone tool	Western 1/2 B1906		

ADDITIONAL COLLECTED MATERIAL

Locus/Pottery Pail Number	Bones	Shell	Carbon	Pumice	Soil Sample	Other (specify)
B1906.1	normal 1/4" screen				Standard	
B1906.2	normal 1/4" screen		✓		intensive	
B1906.3						
B1906.4			✓			
B1906.5	✓ 1/4" screen					
B1906.6	✓ 1/4" screen					
B1906.7	✓ 1/4" screen					
B1906.9	2.1 kg					
B1906.8	✓ 1/4" screen					

concentration of bone + shell

Year 2004 Trench/Locus B1906 Excavator ESKA

DESCRIPTION of PROGRESS of EXCAVATION [date each entry and identify associated pottery pile(s)]:

7 June 04

- B1906.1 is our first pass in the new locus East (upslope) behind the large rock and boulder in the middle of B1900
- One objective of this pass is to see if the pavers continue back, beyond the large rock (which we are presently treating as a northern continuation of wall B131).
 - We are screening 100% of this pass as it is unclear whether or not we are coming up ~~at~~ the floor, whether this is still all loose tumble, a combo etc.
 - Tassos is working back into the 'triangular area' west of wall B149 first. The assistants working the screen say that significantly more large pieces of bone are coming up now from this area.
 - some large stones (double-trip)
 - We have come down upon bedrock in the triangular area. We are now moving north, through the tumble, to see if we can see the face of wall B1904. Some of the large rocks of the tumble are being taken out.
 - There is no evidence for wall B142 running into the spine wall (B149) at the southern side of the triangular area (from beneath the boulder). It is likely that there was in fact a doorway in this area as earlier speculated.

8 June 04

- We are beginning today by finishing yesterday's pass with a new pile. This pass is moving back through the tumble in an effort to gain better resolution on the wall (B1904). Tassos is removing any stones that are clearly tumbled and no longer associated with the wall. This is pile B1906.2
- still screening 100%, the matrix is very gravelly w/ some larger stones

Year 2004 Trench/Locus B1906 Excavator ESKA

DESCRIPTION of PROGRESS of EXCAVATION [date each entry and identify associated pottery pail(s)]:

8 June 04

- Tassos just found several teeth in the NW area of the trench. As a number of bones have also come up, we are taking an intensive soil sample from the area where this was uncovered
- Tassos has just found a horn from against the spine wall (B149) - see sketch for location, this is possibly associated w/ the teeth and bones
- the upper part (in locus 1906 behind the large stone) of wall B1904 is looking less convincingly like a wall. However, we need to reassess via clearance tool
- a modern nail turned up in the screen - either a product of slope wash (mixed context) or has fallen in.
- a substantial piece of jar neck came up against the spine wall, a bit further north than the horn was discovered
- a lot of loam is coming up in this pass, in the area running out about 2m from the NW corner where wall B1904 appears to meet the spine wall B149
- we have come down upon bedrock again but also much soft fill
 - it is looking more and more like the pavements did not continue back to the spine wall (they may have been a later addition, in fact, more contemporaneous w/ the other paved room associated w/ B100).
- Elevations for the close of B1906.1 and .2 are:

361.064 R16 (1.475) = reading HI: 362.54

1 (1.185) 361.36

5 (1.284) 361.26

2 (1.12) 361.42

6 (1.13) 361.41

3 (1.017) 361.52

7 (1.152) 361.39

4 (1.11) 361.43

8 (1.20) 361.34

B1906.3

- We are taking another pass which is significantly higher up than B1906.1 and .2. We are still working through the tumble trying to find the trajectory of the eastern part of wall B1904.
- more teeth were found w/ jaw in the same area as some were in the last pass (intensive soil sample was taken B1906.2)

Year 2004 Trench/Locus B1906 Excavator ESKA

DESCRIPTION of PROGRESS of EXCAVATION [date each entry and identify associated

pottery pail(s)]:

June 4 cont. - the screeners are reporting that little is coming up with the screen.

- we have switched to a new pail as we have appeared to have come against the wall - since we are picking up quite a lot, and some of the stones of the stripped wall are quite high, a new pail was in order.

- we seem to be defining where the wall B1904 continues

Elevations for close of B1906.4 from some of same points of previous pass
R16: 361.06 reading (1.459) * (1.375) HI: 362.52, * 362.435

1 (1.1433) 361.39

2 (1.136) 361.38

3 (0.998) 361.53

4 (1.100) 361.42

5 (1.265) 361.26

6 (1.117) 361.40

*7 (1.043) 361.39

8 (1.175) 361.35

*9 (0.525) 361.91

*10 (0.508) 361.93

*11 (0.608) 361.83

*12 (1.027) 361.41

13 (1.138) 361.38

(sliv for pot. too)

Our next pass is to the north of B1904 (wall) below ~~these~~
B1906:1-3. This pass, beginning w/pail B1906.5, is
Moving back from the large rock being treated as part of wall
B131, through to the spine wall. On the north, we seem
to have found the tumble of the continuation of wall B1904,
this is acting as our northern boundary for this pass. While
there ~~are~~ is still some uncertainty about this eastern portion
of B1904, we will not treat it in this pass for fear that we
will lose what we have of the wall

- we have cut this pass short. It has become
apparent that all we have behind wall B131 is fill.