

Initially cleared as part of eastern half of trench *A2100*, trench *A2200* measures 9m in the SW by 8m on either side by 7.5m on the NW and extends north from Boyd's stone dump on the north side of the hill to the lower spine wall. Clearing of the horta and topsoil was done on 2 June 03 by GRP with two pails of surface collection of artifacts. Excavation began on 4 June 03 with two students (Rob Cuthrell and Hallie Franks) and two workmen (Matina Solidakis and Pandalis). Before excavation was completed, two other students (Anne Sassin and Abbie Bollans) and two other workmen (Manolis Maniadakis and Georgos Kanitakis) helped as well. The trench consists of three main parts: an upper bedrock area (A2201, A2203, A2204), a room with a wall (A2202, A2205), and a foundational area (A2206, A2207).

Depositionally, locus A2207 very likely predated the other loci in this trench, as it includes two medium-sized worked square stones of about 30cm inset between two large bedrock boulders in the eastern part of A2206. The prevailing interpretation is that **A2207** is a foundational area built on the eroded slope of A2206. The latter locus covers almost the entire northern half of the trench, as few architectural features were found in the badly-eroded locus **A2206**. However, based on the foundation stones discovered in A2207, it is reasonable to assume that more of the bedrock in **A2206** was reinforced to carry the weight of a floor surface. A portion of a floor surface was excavated as locus **A2205**, about 1.2m north of Boyd's north stone dump. Very little of the floor remains—only about half a meter is preserved south of the eroded locus A2206. It is likely, however, that the entire floor continued northward at least to the foundational stones of A2207. Whether or not there was a second, lower floor at the bottom of the north slope is unclear. Floor A2205 produced two pails of Archaic pottery, as well as bone, shell, carbon, and sea pebbles. An agrimi horn was found in situ on the bottom of the floor. Contemporary with floor A2205 is south wall **A2202**, also badly eroded. The wall is preserved to only a couple courses of medium-sized, roughly-worked stones which, in most areas of the trench, provide an appearance of tumble more than purposefully-built wall. Also contemporary with floor A2205 and wall A2202 is locus **A2203**, an outside area with significant artifact deposition. This locus is NE of wall A2202 and produced three pails of Archaic and Hellenistic pottery, including one spindle whorl. A2203 does appear to be outside the limit of wall A2202 but at the same stratigraphic level as floor A2205.

Remaining loci from this trench were primarily clearing passes. Locus **A2204** was begun as a clearing pass for the outside area to the NW of wall A2202 and produced only a few sherds of pottery of Archaic date. Locus **A2201** covers the excavation beneath surface clearing. In the southern half of the trench, A2201 consisted mostly of eroded bedrock pieces and small tumble, some of which possibly came from Boyd's northern stone dump. Over time, this small stone and eroded bedrock completely covered the remaining courses of wall A2202 and floor A2205.

The trench was closed on 13 June 03. After excavation of this trench was complete, locus **A2208** was defined on 4 July 03 for the wall/roadway area at the northern limit of this trench. From later excavations in trenches *A2100* and *A1700*, it appears that a road circled the hill in this area, possibly defined by the spine wall that forms the approximate northern, downslope boundary of these trenches. There are no pottery pails associated with A2208, as this locus was not named during excavation. The final section, completed on 11 July 03, does not include this locus.

Based on the excavation of trench *A2200*, it appears this was a habitation area built into the slope of the hillside. Much erosion has occurred in this area, as the floor surface of A2205 extended only about one meter before we lost it to the slope. This

Trench A2200

2003

Kristina Killgrove

room was likely built on a buttress or foundation based on the remains of worked stone in A2207. Because of erosion, however, no other remains of a foundation or room were located in this trench. In the northern, downhill portion of the trench there appear to be the remains of a spine wall that runs around the hill past A2100 and A1700. Unfortunately, because so little of this room is preserved, it is difficult to understand how this area communicated with A2100. The best-preserved portions of A2200 are in the NE and therefore not directly adjacent to A2100. It is therefore unclear whether the room built on a foundation in A2200 structurally connected to A2100 in the west or stood alone next door, accessed by the northern road below or potential as yet unexcavated points to the east.

A2200 Phase Section is being on

4.9.4/88

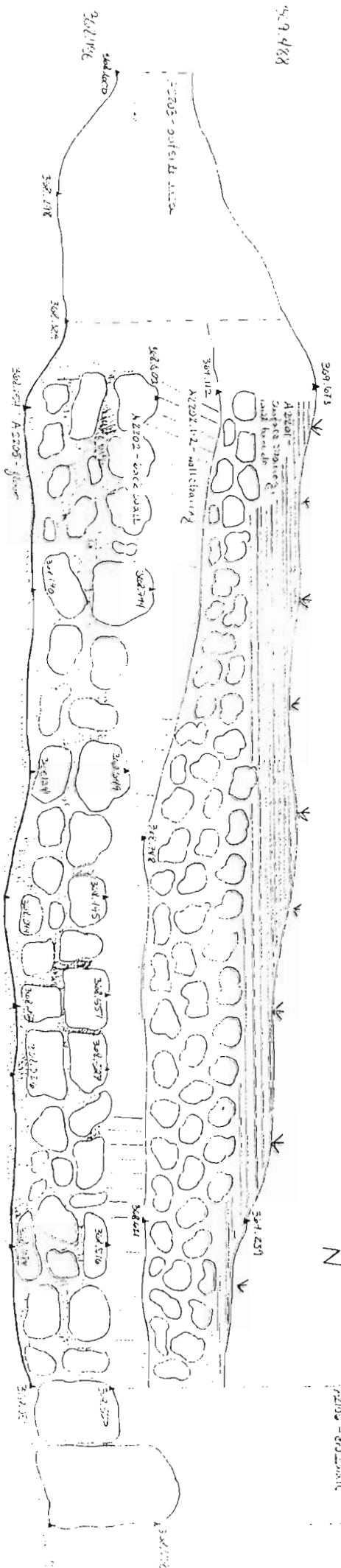

3.6.7/88

3.6.7/88

1m

2m

3m

4m

5m

6m

7m

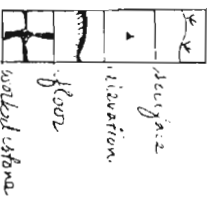

370.488
369.488
368.488
367.488
366.488
365.488
364.488
363.488

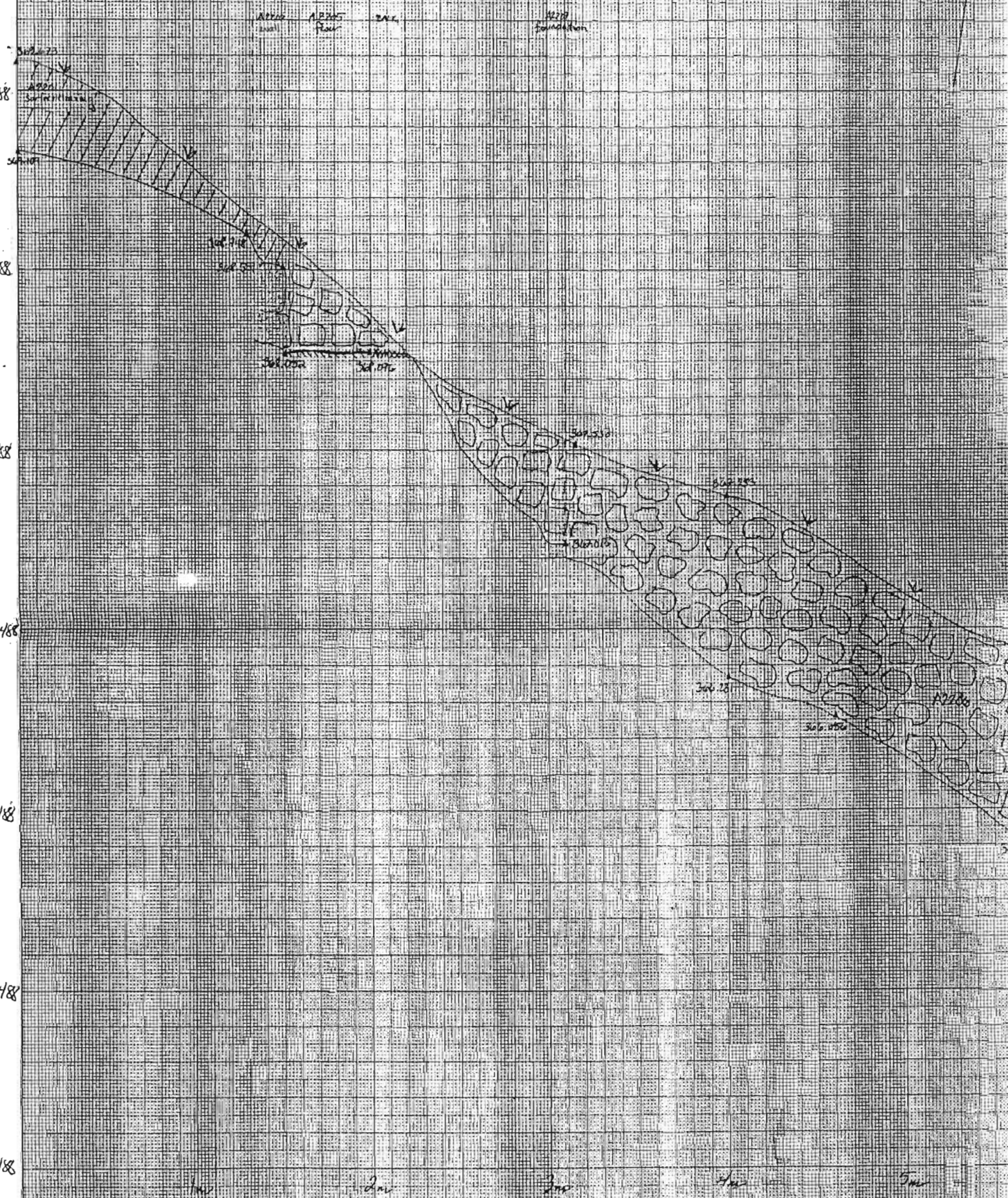

7X



- Key
- surface
 - trench
 - sand trench
 - washed stone
 - floor
 - bulk (concentrated)
 - estimated elevation
 - measured elevation
 - water definition

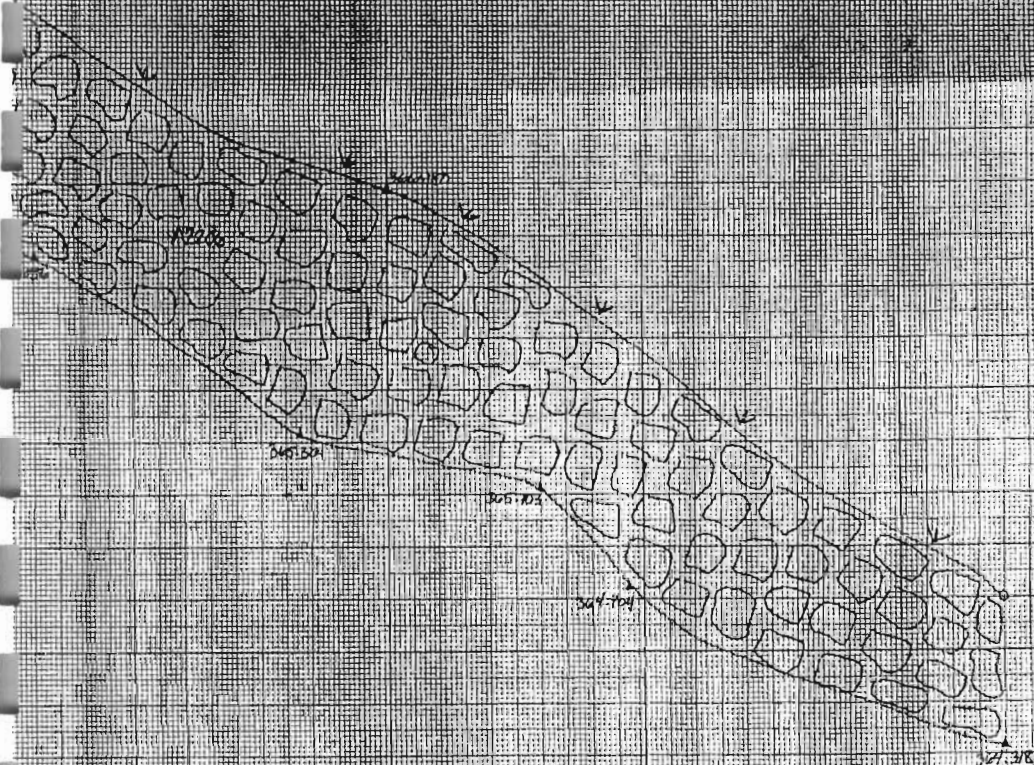

5m

5m

5m

5m

5m

200

Year 2003 Trench/Locus A2201 Excavator KK

Elevations

Benchmark used: R8
 Reading on 366.488
 Benchmark: 8.051/3.303
 H.I.: 2.059/6. 3.303

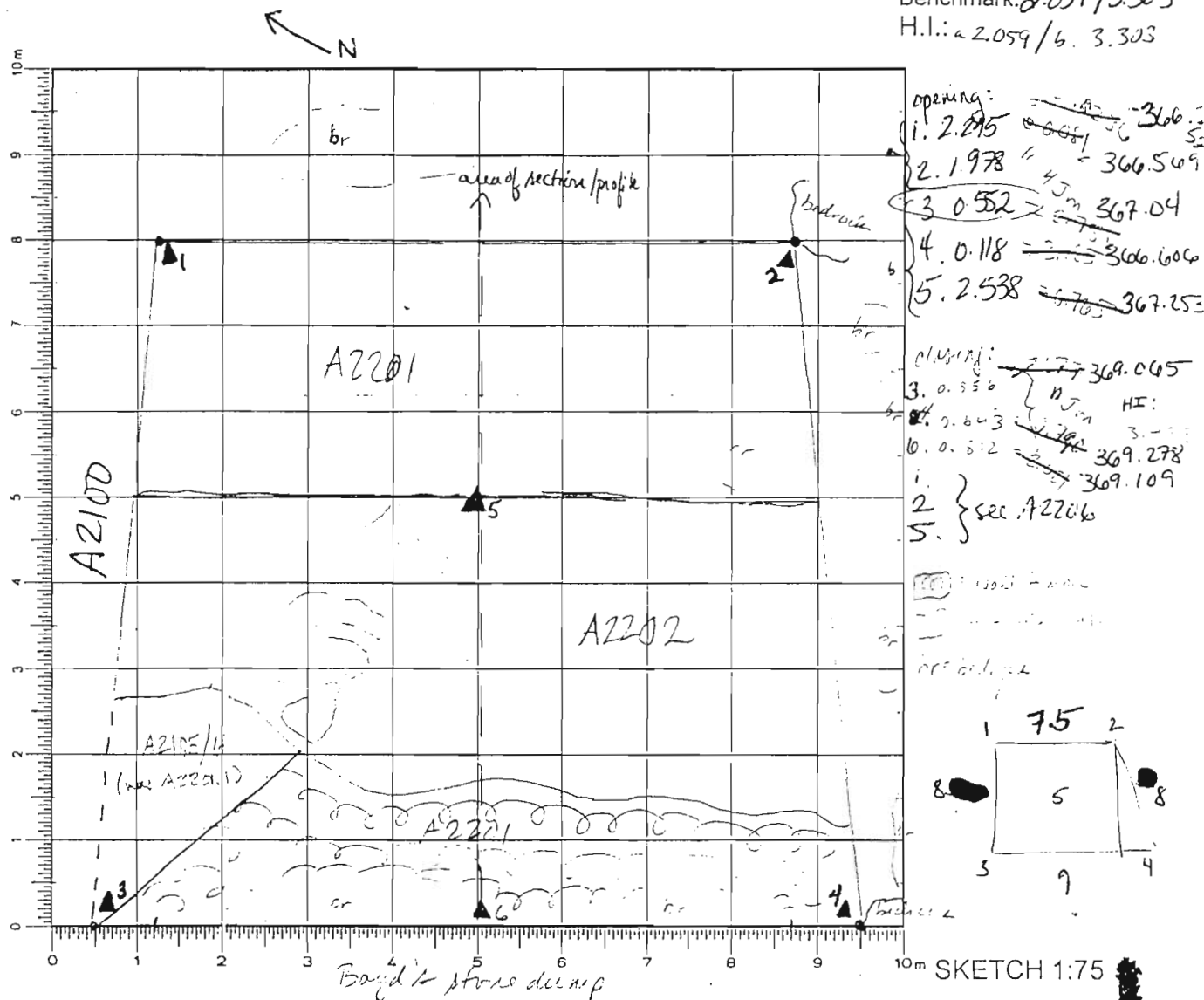

DEFINITION/DESCRIPTION of LOCUS (explain why you changed locus numbers):

Today's date: 4 Jun 03 Locus above:Locus parameters: East of A2100 (was half of GP's trench), abutting Boyd's stone dump in SW.Verbal description: A2200 is to the E of A2100 and extends from Boyd's stone dump downhill to possibly an old path outside a stone wall. Trench is defined as 9m (SW) by 8m by 7.5m by 8m (approximately).

Locus Interpretative Comments (What do you think this is? DATE your comments, continue on additional pages if necessary):

Wall (possibly under Boyd's dump) with trouble down slope (4%).

Year 2003 Trench/Locus A2201 Excavator KK

Locus/Pottery Pail Number	Weight of Sherds <small>FW CW</small>	Number of Sherds <small>FW CW</small>	Chronology & Comments
^{2 6/4} A2201.1	425g / 1.175 kg	62 / 49	Hellenistic, Archaic, Early Archaic, imported black clay (BF?) ^{pottery w/ stand}
^{4 5/5} A2201.2	310g / 600g	32 / 23	Hellenistic (tile) Archaic (pottery)
^{4 6/6} A2201.3	150g / 580g	33 / 46	Archaic / pithos, pits, black glaze
A2201.4			

OBJECTS

Object Number	Associated Pottery Pail	Identification (material/form)	Location	Elevation	Catalogue Number

ADDITIONAL COLLECTED MATERIAL

Locus/Pottery Pail Number	Bones	Shell	Carbon	Pumice	Soil Sample	Other (specify)
A2201.1	✓				✓ 5L	
A2201.2	✓		✓			
A2201.3		✓				

workmen: Matina, Pandalis, Manoli (weight lifter),
George

Year 2003 Trench/Locus A2201 Excavator KK

DESCRIPTION of PROGRESS of EXCAVATION [date each entry and identify associated pottery pair(s)]:

4 Jun 03

Inherited GP's eastern half of A2100. Renamed as separate trench, A2200. GP dehorified all of A2100 on 2 Jun then cleared and removed some of the topsoil. GP had 2 pails and surface finds. See her records for A2101 from 2 Jun for more info. Started first pass this morning (Latina, Pondali, Hallie + Rob) after taking initial elevations (corners + center of trench). Bone and pottery coming up, though not in large quantities. Possible beginning of wall in SW quadrant where 6 or so rocks appear as linear tumble. Excavated possibly ^{western} 1/3 of trench on first pass. Plan to make 2nd pass tomorrow downslope from today to see if GP's rock wall continues to NE.

5 Jun 03

Started a new pass this morning (A2201.2) moving from E to W. Some pottery coming up already. Closing elev. for pass 1 = 3 (0.633), 4 (0.633) with RoB (3.246). Beginning second pass of upper section of trench, adjacent to Boyd's wall. Defining rocks (presumably from tumble) to be removed later, in hopes of finding the remains of the wall.

6 Jun 03

(A2201.3) Finishing second pass across upslope to define probable wall tumble. More pottery ~~coming up~~ coming up. ~~Started third pass slightly lower but overlapping second pass to isolate tumble (A2201.4)~~ In third pass ~~(A2201.4)~~ are removing some rocks to define wall face. New locus started for ^{back} wall (A2202), seeing if new crosswall comes up.

9 Jun 03

Surface clearing of lower (downslope) part of trench, beneath steelbarrow path. Mostly dirt from wheelbarrow spill, all loose dirt collected by Abbie + Lane. Will start excavating tomorrow, probably as separate locus.

10 Jun 03

GP started excavating the SW corner of A2201 as a crosswall in her trench at A2105/A2106. See map on p. 1 for location. See her notes for further info.

~~Extra profile (11 Jun 03)~~

~~Extra profile~~

~~Extra profile~~

2003

A 2201

KK

p. 4

11 Jun 03

Took elevations and measurements for final section drawing of upper half of trench (loci A 2201-A 2205). If stuff comes out of A 2202 (lower half of trench), will profile it separately.

Year 2003 Trench/Locus A2202 Excavator KKElevations

Benchmark used: A2200R8
 Reading on 366.488
 Benchmark: 3.052 0
 H.I.: 3.052

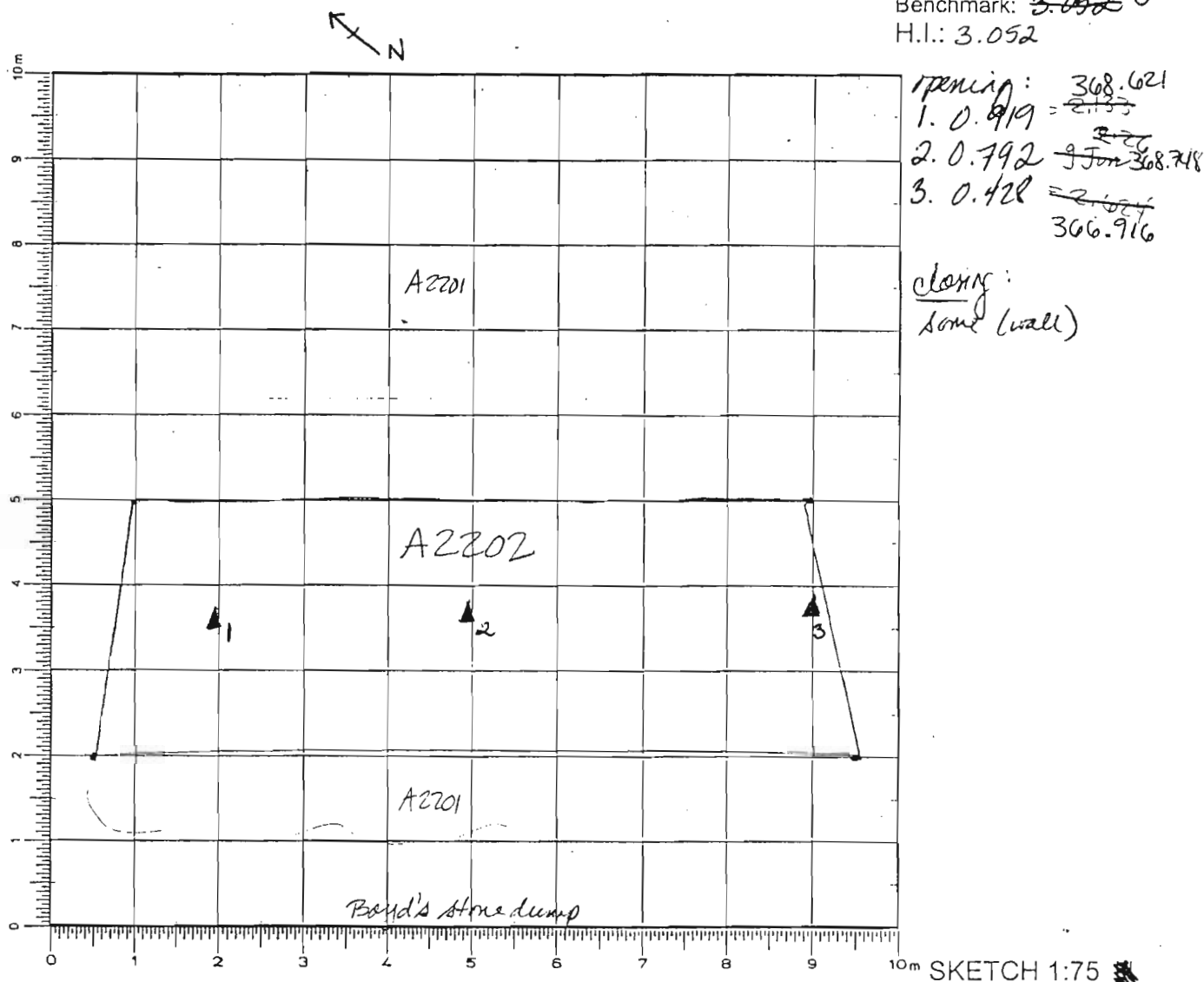

DEFINITION/DESCRIPTION of LOCUS (explain why you changed locus numbers):

Today's date: 10 Jun 03 Locus above: Locus parameters: wall in trench A2200, about 1.5 m downslope of Boyd's wallVerbal description: Probable back wall of structure that runs vaguely east to west across nearly entire width of trench (9m).

Locus Interpretative Comments (What do you think this is? DATE your comments, continue on additional pages if necessary):

SE NW
near wall of a structure with a couple crosswalls coming up on either side. Some nice flat-top stones seem to mark corners of walls.

Year 2003 Trench/Locus A2202 Excavator KK

DESCRIPTION of PROGRESS of EXCAVATION [date each entry and identify associated pottery pair(s)]:

6 Jun 03

Decided the wall tumble was defined enough for a new locus, A2202. Working on defining the back wall (that abuts Bryd's wall) and finding possible cross walls near border with A2100. Screened 5 2m² bits of dirt and took a standard soil sample. Monotiscame across some roofing material on SE side of wall (change in soil - more crumbly, slightly different color; included some in standard soil sample). Will probably start a new locus once roofing material is hit.

9 Jun 03

attempting to define crosswall by removing stones. Patterly, carbon in matrix of stones. All large stones removed, really no crosswall found. Will ~~then~~ remove this large contiguous with A2205, the new roof/floor material for when we finish leveling this stratum to the level of A2205. So higher stuff appears to be just rock tumble and eroding bedrock, not a crosswall.

11 July 03 - Final section from E to W across wall to show wall face and floor surface. See elevations on A2205, p. 3.

Year 2003 Trench/Locus A2203 Excavator KK

Elevations

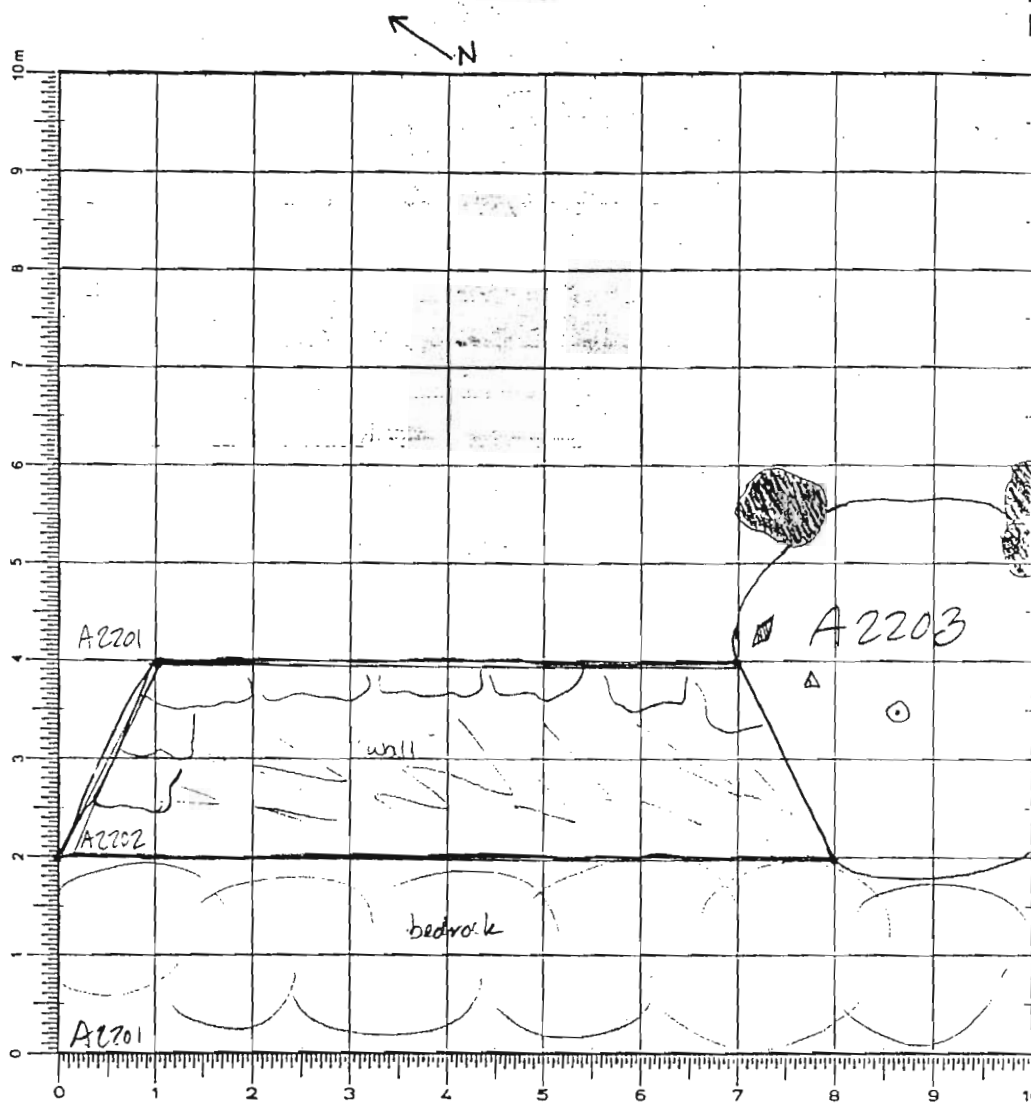
 Benchmark used: 28
 Reading on 1800
 Benchmark: 0.4
 H.I.: 3.970

 opening: none taken
 or closing of A2201
 closing:
 $\Delta 2.45 \text{ g Jun}$
 $= 368.313$

 ○ = obj. 1, spindle wheel
 ◻ = obj. 2, worked stone

DEFINITION/DESCRIPTION of LOCUS (explain why you changed locus numbers):

 Today's date: 9 Jun 03 Locus above: A2201

 Locus parameters: SE quadrant with no wall tumble, from tumble E to large bedrock boulders.

 Verbal description: Included in first pass of A2201. Appears to be outside of wall tumble, so are digging second pass as a separate locus. Also dug two more passes to level it with bottom of wall A2202.

 Locus Interpretative Comments (What do you think this is? DATE your comments, continue on additional pages if necessary): 9 Jun - Probably on outside area. Some pottery, bone, a spindle wheel and maybe worked stone.

Year 2003 Trench/Locus A 2203 Excavator KK

Locus/Pottery Pail Number	Weight of Sherds <small>FW CW</small>	Number of Sherds <small>FW CW</small>	Chronology & Comments
R ⁶ / ₁ A 2203.1	25g/350g	7/8	Archaic
R ⁶ / ₁ A 2203.2	110g/900g	10/4	Archaic (pithos, krater, cup), Hellenistic? amph.
R ⁶ / ₁ A 2203.3	65g/100g	6/9	Archaic, Hellenistic

OBJECTS

Object Number	Associated Pottery Pail	Identification (material/form)	Location	Elevation	Catalogue Number
1	A 2203.1	spindle wheel	see map	not taken	03-1012
2	A 2203.3	worked stone	see map	not taken	

ADDITIONAL COLLECTED MATERIAL

Locus/Pottery Pail Number	Bones	Shell	Carbon	Pumice	Soil Sample	Other (specify)
A 2203.1	✓					
A 2203.2	✓				✓ 5L Handled	

workmen: Mafino, Manolis, Georgos

Year 2003 Trench/Locus A2203 Excavator KK

DESCRIPTION of PROGRESS of EXCAVATION [date each entry and identify associated pottery pail(s)]:

9 Jun 03 - Began a new locus in SE quadrant of trench that appears to be outside of wall tumble. Some pottery and bone coming up. Will dig at least one pass in this locus to see what comes up. No elevations taken. Refer to opening/closing elevations of A2201.1. Object 1 (spindle wheel) found in middle of locus - see map. Elevation not taken because object was removed. (Couldn't get in situ elevation.) Started a new pass (A2203.2) in locus because bottom isn't yet at same level as A2202/5 and because some artifacts are coming up. More pottery and some interesting bone (smooth, possibly burnt or burnished). Started a new pass (A2203.3) to make locus level with base of wall and define possible cross-wall. Found odd piece of stone - possibly worked? Took standard soil sample from 2203.2. Managed to shoot in one elevation - closing elevation from middle of locus.

Year 2003 Trench/Locus A2204 Excavator KKElevations

Benchmark used: A2202 R8
 Reading on 300.488
 Benchmark: 300.488
 H.I.: not taken

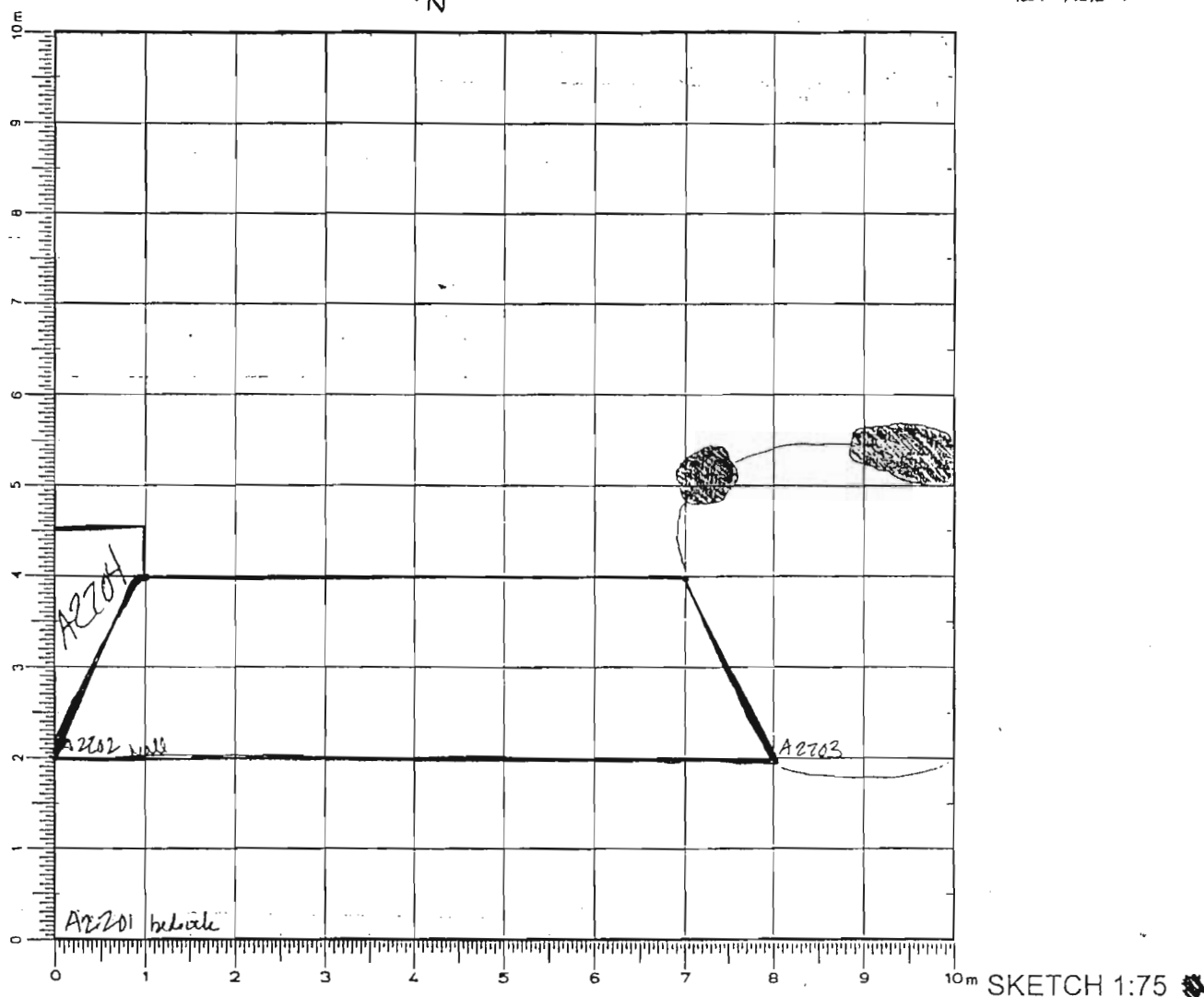

DEFINITION/DESCRIPTION of LOCUS (explain why you changed locus numbers):

Today's date: 9 Jun 03 Locus above: A2201Locus parameters: NW quadrant of trench, next to A2100.

Verbal description: Clean up + some excavation of section of trench near A2100, between trench line and bedrock/wall. Let students (Axxe + Abbi) dig a bit. Some pottery found. Rest will probably be dug at a later date, possibly alongside A2100.

Locus Interpretative Comments (What do you think this is? DATE your comments, continue on additional pages if necessary): Space in between walls.

Year 2003 Trench/Locus A2205 Excavator KK

Elevations

Benchmark used: 368.103
 Reading on
 Benchmark: 368.488
 H.I.: 3.970

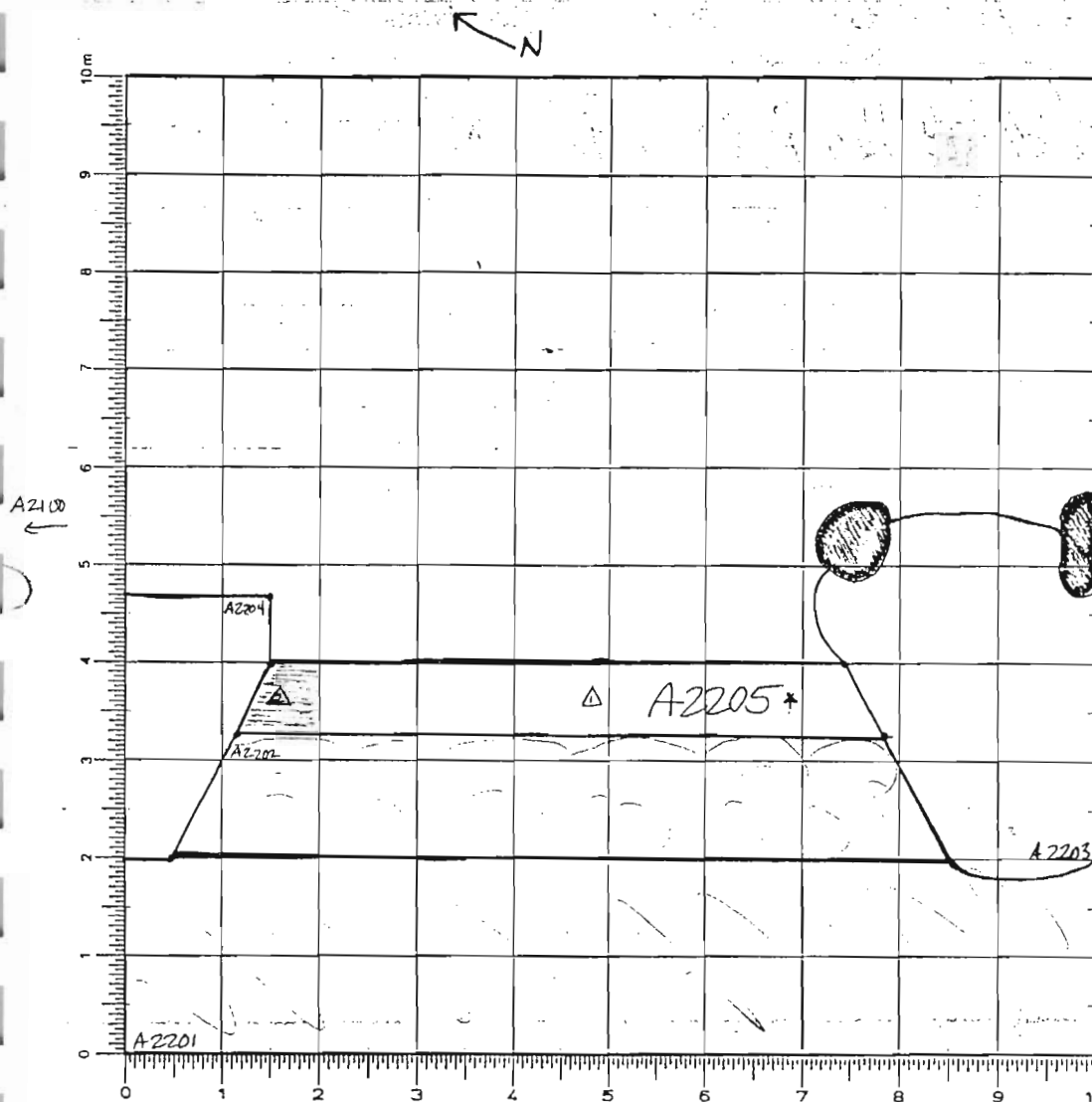

opening: 368.103
 $\Delta 2.355 = 1.615$
 $\Delta 2.408 = 1.562$
368.050

Closing: 368.081
 $\Delta 1.588 = 3.181$
 $\Delta 1.605 = 1.562$
368.054
 see agrimeter elev. below

= area of interest 5L soil sample

* = agrimeter
 elevation: 1.795
 10 Jun 03 R.B. 3285

DEFINITION/DESCRIPTION of LOCUS (explain why you changed locus numbers):

Today's date: 9 Jun 03 Locus above: A2202

Locus parameters: Subdivision of wall A2202 into rocks (wall) and soil (roof/floor) on downslope half.

Verbal description:

Downslope of the rock wall (A2202) we came across clayey soil and crumbly soil with small inclusions of pebbles and shale. Because of the change in soil color and texture, this area was given a new locus.

Locus Interpretative Comments (What do you think this is? DATE your comments, continue on additional pages if necessary):

Either roof or floor of room described by wall A2202. It maybe roof and floor - while NW area has lighter soil, SE area has darker, wetter soil with more carbon inclusions.

[illegible]

OBJECTS

[illegible]

ADDITIONAL COLLECTED MATERIAL

[illegible]

Workmen: Matina, Georgios

DESCRIPTION of PROGRESS of EXCAVATION [date each entry and identify associated pottery pail(s)]:

Took two opening elevations of A2205, the area of roof/floor material. Made one pass from bottom of A2202 (now renamed to be included into locus A2205) across wall face. Screened 100% in this area. Some pottery found in excavation; bone and shell found in $\frac{1}{4}$ " screen. Took two soil samples - one standard 5L sample from 2205 and one intensive sample from NE area of locus, also of 5L. Tomorrow will finish pass to SW (old A2202) and then move downslope or start another shallow pass across 2205. Intensive sample was from the corner of the roof/floor area.

10 Jun 02
Finishing up first pass of 2205 as per 2205.2. Removing tumbled/flaked rocks.
Came across a large agave horn in situ beneath the wall tumbled ^{with some associated debris} (but not in A 27.2). - Also
defining its photoglyphs + Lynn is removing to put in different bag. Also
pottery and bone fragments coming up. Taking elevation after horn removal.
Lynn removed horn into separate bone bag. Finishing part of 2205, 100%
screen, then pictures + moving to bottom of trench. Three bags of bone-
1 as excavated, 1 for the agave horn, 1 from 1/4" screen. Also found some
pottery ^{sea stones} and one punice stone from 2205.2. Pass finished and photographs
taken. Profiles to be produced tomorrow. Possible future excavation of floor/roof.

final measurements/elevations (E-W section of A2200)

$R_{OB} = 3.849$

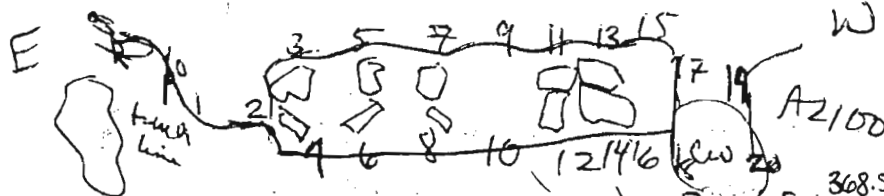

468 10 12 14 16 18 20
 0 $1.737 = \frac{368.60}{2.112}$ 365 7 $1.688 = \frac{368.649}{2.104}$ 520 13 $1.810 = \frac{368.577}{2.039}$ 19 $1.569 = \frac{368.7168}{2.460}$
 65 $2.039 = \frac{368.298}{1.810}$ 365 8 $2.213 = \frac{368.124}{1.663}$ 522 14 $2.311 = \frac{368.026}{1.598}$ 20 $2.145 = \frac{368.1704}{1.704}$
 130 $2.008 = \frac{368.389}{1.837}$ 433 9 $1.842 = \frac{368.495}{2.004}$ 614 15 $1.821 = \frac{368.516}{2.022}$ 368.1192
 169 $2.008 = \frac{368.802}{1.837}$ 433 10 $2.293 = \frac{368.044}{1.605}$ 614 16 $2.283 = \frac{368.054}{1.605}$
 169 $3.150 = \frac{368.151}{1.162}$ 484 11 $1.786 = \frac{368.551}{2.063}$ 687 17 $1.787 = \frac{368.550}{2.062}$
 174 $2.183 = \frac{368.794}{1.692}$ 484 12 $2.245 = \frac{368.052}{1.634}$ 687 18 $2.248 = \frac{368.089}{1.634}$
 268 $1.543 = \frac{368.170}{2.387}$ 107 1.662

Elevations

Benchmark used: A200
Reading on
Benchmark: 366.488
H.I.: 3.285 / 3.181

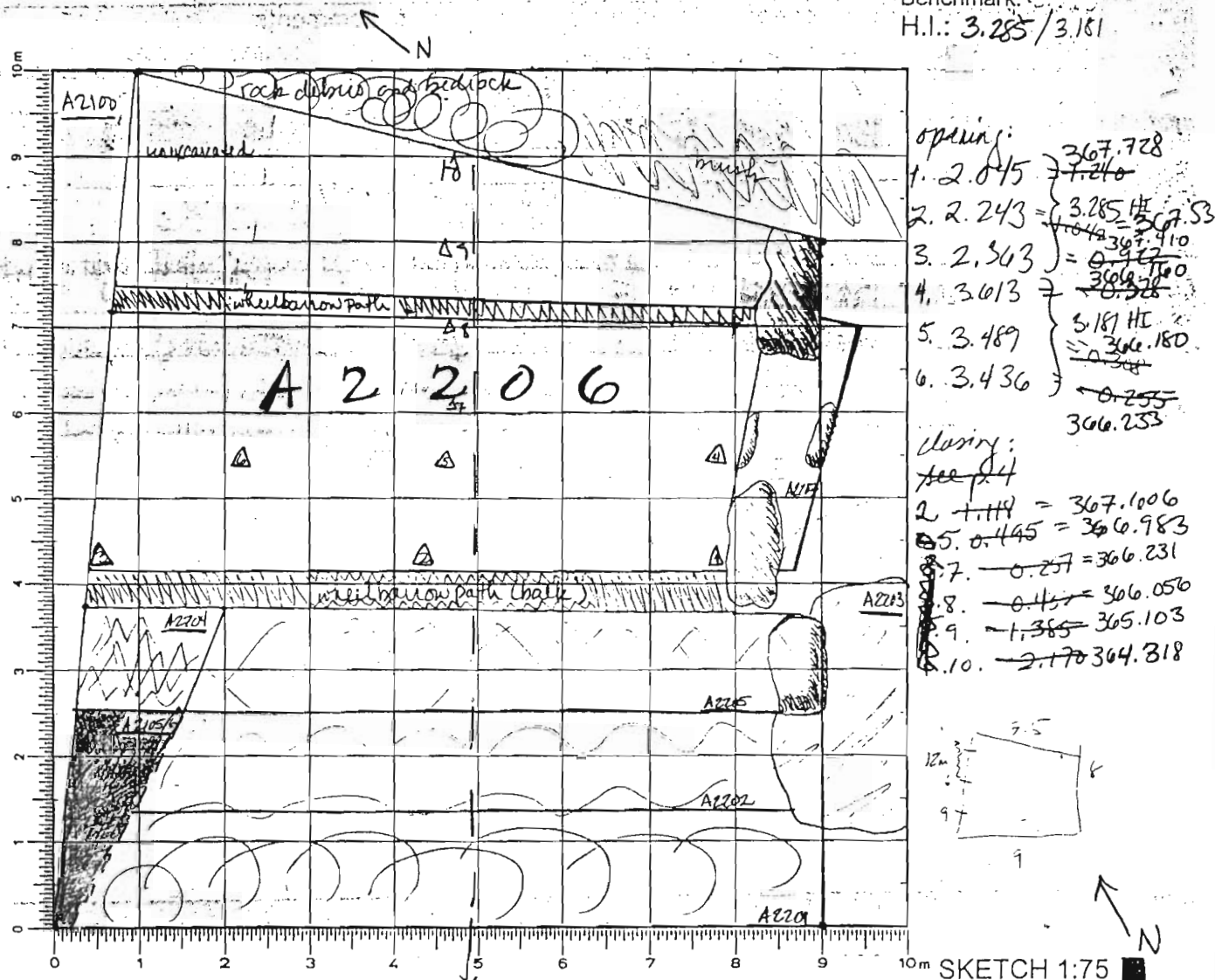

Today's date: 10 Jun 03

Locus above:

AZZOY

Locus parameters: lower half of t-axis, below equilibrium path (downslope of A2205).

Verbal description: Locus changed from opening one (A2201) because of slope and for ease of recording. First pass begun this morning, so new elevations were taken at top and middle of locus. For lower elevations, see A2201.

Locus Interpretative Comments (What do you think this is? DATE your comments, continue on additional pages if necessary): *Reddish-brown soil on sand duneslope near base of some bedrock boulders.*

pages if necessary): Possible wall coming up mid dowllope near base of some bedrock boulders.
Pottery, bone coming up.

Year 2003 Trench/Locus A2206 Excavator KK

	Locus/Pottery Pail Number	Weight of Sherds <i>FW/CW</i>	Number of Sherds <i>FW/CW</i>	Chronology & Comments
R $\frac{1}{10}$	A2206.1	110g/320g	27/16	Archaic, LAMIC
R $\frac{1}{11}$	A2206.2	30g/600g	28/14	
R $\frac{1}{11}$	A2206.3	320g/550g	40/16	
R $\frac{1}{12}$	A2206.4	485g/920g	78/19	Hellenistic (file), ^{orientalizing} Archaic (pithos, bowl, cook pot, amphora)
R $\frac{1}{12}$	A2206.5	410g/430g	40/17	Archaic (pithos, cook pot, cups), ^{orientalizing} Bell (juglet, file), LG (pithos)
R $\frac{1}{12}$	A2206.6	535g/975g	38/17	Archaic (pithos, amphora, cups), LG (cup)
R $\frac{1}{12}$	A2206.7	225g/400g	27/9	Archaic (pithos, amph), LG/ETA (pithos), Orientalizing, LAMIC
R $\frac{1}{13}$	A2206.8	40g/365g	6/13	Archaic (mortar, cook pot, burned amphora)
R $\frac{1}{13}$	A2206.9	130g/840g	40/19	Archaic (pithos, cook pot, amphora), Bell (juglet), ^{orientalizing}
R $\frac{1}{13}$	A2206.10	10g/20g	4/4	Archaic (cup, etc.)

OBJECTS

Object Number	Associated Pottery Pail	Identification (material/form)	Location	Elevation	Catalogue Number

ADDITIONAL COLLECTED MATERIAL

Locus/Pottery Pail Number	Bones	Shell	Carbon	Pumice	Soil Sample	Other (specify)
A2206.1	✓					
A2206.2	✓					
A2206.3	✓					
A2206.4	✓					
A2206.5	✓					
A2206.6	✓					
A2206.7	✓					
A2206.8	✓					
A2206.9	✓					
A2206.10	✓					

workmen: Marina, Poudalis, Georgos, ^{Stefanos}, Manolis

Year 2003 Trench/Locus A 2206 Excavator KK

DESCRIPTION of PROGRESS of EXCAVATION [date each entry and identify associated pottery pail(s)]:

10 Jun 03

Started first pass of A2206. Some pottery and bone coming up. Areas of reddish clayey loam with flecks of charcoal, but still in root/pebble matrix. Will start with kazmas soon to move rest of topsoil and dirt spill from upper loci in trench. Will take out area between wheelbarrow paths with kazmas. No soil sample taken from 2206.1 because it's largely topsoil and root matrix.

11 Jun 03

Started second pail (A2206.2) of first pass. Lots more dirt to remove. Will get kazmas guys later. Some pottery, bone turned up in second pass - most from terrace/wheelbarrow path cut near bottom of trench. Are working down slope to expose spine wall. No architecture found in this locus except for probable foundation segment. See A2207 for measurements, etc. on that segment. Started a new pass (A2206.3) from upper area of excavation (A2206.1 and 2) to wheelbarrow path because a new pass seemed like a good idea. Some pottery and bone coming up; workmen are convinced there's a wall down there. I'm not so sure.

12 Jun 03

Started a new pass & pail (A2206.4) this morning to define pseudo-wall near wheelbarrow path. Hoping for more Daedalic heads today. Linear collection of rocks is looking more convincingly like a wall. Lots of pottery and bone in this pass. Started a new pass with the kazma to bring area down to level of wheelbarrow path. Likely to start excavating lower down the slope after lunch. Started excavating downslope of wheelbarrow path with kazmas (pail A2206.6). Found some nice jaws with teeth still in them, but not in situ in last pass (A2206.5) of "floor" surface. Pottery coming up in new pass as well. Whilellmotis is finishing pass A2206.6 and defining his "wall". Matina + Giorgos + Stellas are using a kazma to finish out the trench with pass A2206.7, which is also producing a ton of pottery and bone but no architecture.

Year 2003 Lous 2206

Excavator KK

P. 4

12 Jun 03

Section of 2206 (lower half of trench A2206)

$$\begin{array}{r} 3.469 \\ - 3.141 \\ \hline .308 \end{array} \quad \begin{array}{r} 2.285 \\ - 2.059 \\ \hline .226 \end{array}$$

rock pile

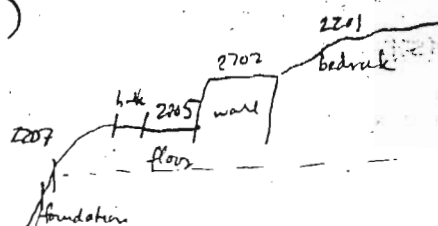

12 Jun 03

clearing elev. (from between 2 wheelbarrow bunks)

- ✓ 1. 2.208 = ~~1.118~~ 367.606
- ✓ 2. 2.831 = ~~6.445~~ 366.983
- ✓ 3. 3.583 = ~~0.057~~ 366.231
- ✓ 4. 3.758 = ~~0.422~~ 366.056
- 5. 4.402 = ~~1.176~~

107
6. 2.026 = ~~1.300~~ 368.54

HI: 
3.326

A2206.1-6

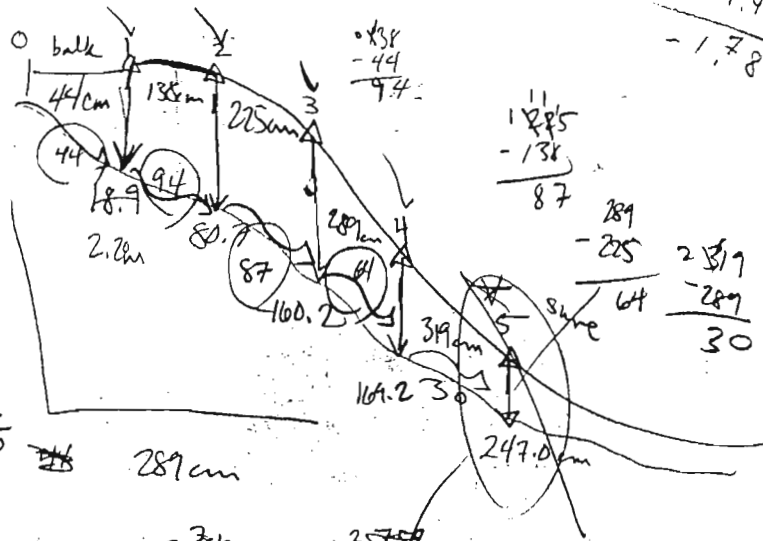

$$\begin{array}{r} 3.326 \\ - 2.208 \\ \hline 1.118 \end{array}$$

$$\begin{array}{r} 28.826 \\ - 2.831 \\ \hline 0.495 \end{array}$$

$$\begin{array}{r} 28.826 \\ - 3.583 \\ \hline .743 \end{array}$$

$$\begin{array}{r} 3.383 \\ - 3.326 \\ \hline .057 \end{array}$$

$$\begin{array}{r} 3.758 \\ - 3.326 \\ \hline .432 \end{array}$$

$$\begin{array}{r} 118.5 \\ - 138 \\ \hline 87 \end{array} \quad \begin{array}{r} 289 \\ - 289 \\ \hline 0 \end{array} \quad \begin{array}{r} 289 \\ - 289 \\ \hline 0 \end{array}$$

$$\begin{array}{r} 1285 \\ 98 \\ \hline 319 \end{array}$$

$$\begin{array}{r} 1649 \\ 78 \\ \hline 247 \end{array}$$

Year 2003 Trench/Locus A2206 Excavator KK

DESCRIPTION of PROGRESS of EXCAVATION [date each entry and identify associated pottery pail(s)]:

13 Jun 03

Finishing up passes from yesterday (A2206.6 is now A2206.9 and A2206.7 is A2206.8). Still lots of pottery, bone coming up. Measurements taken of portion of spine wall at bottom of trench. No new locus started per MSM. Should finish passes, profiles today and close trench.
 closing elev. for lower half of 2206

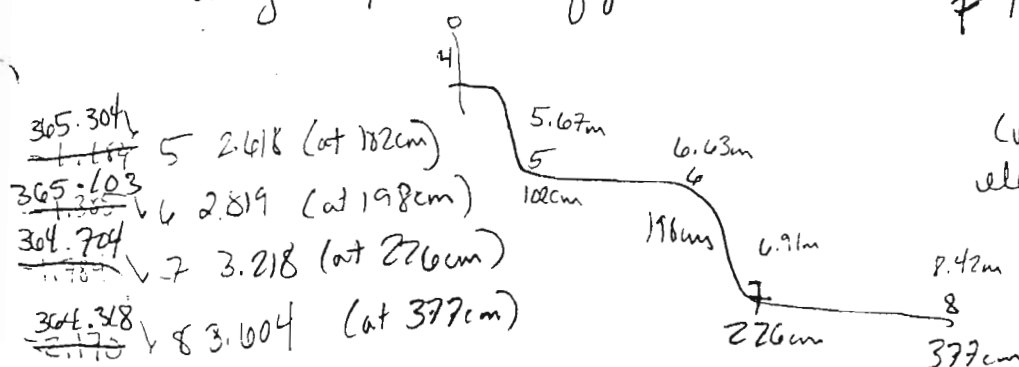

11 July 03

Final profile of A2206 (vertical) drawn from these elevations and those from A2201-5.

HI: 1.434

Spine wall drawing:

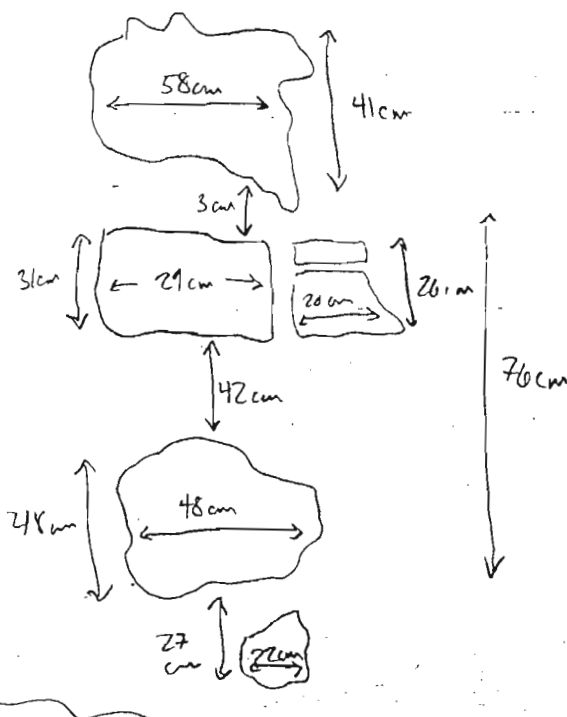

Finished passes, cleaning pass. Cleared trench for photography, which will happen after lunch. Moved to new trench, B900. Will finish section by Monday with closing elevations from today.

16 Jun 03

Daedalic head pulled out of pottery loading and catalogued (A2206.1). Two other coarse wares (?) pulled out and catalogued as well (A2206.1).

21 June 03

Shell-decorated pottery pulled from A2206.7 for cataloguing.

Year 2003 Trench/Locus A2207 Excavator KK

Elevations

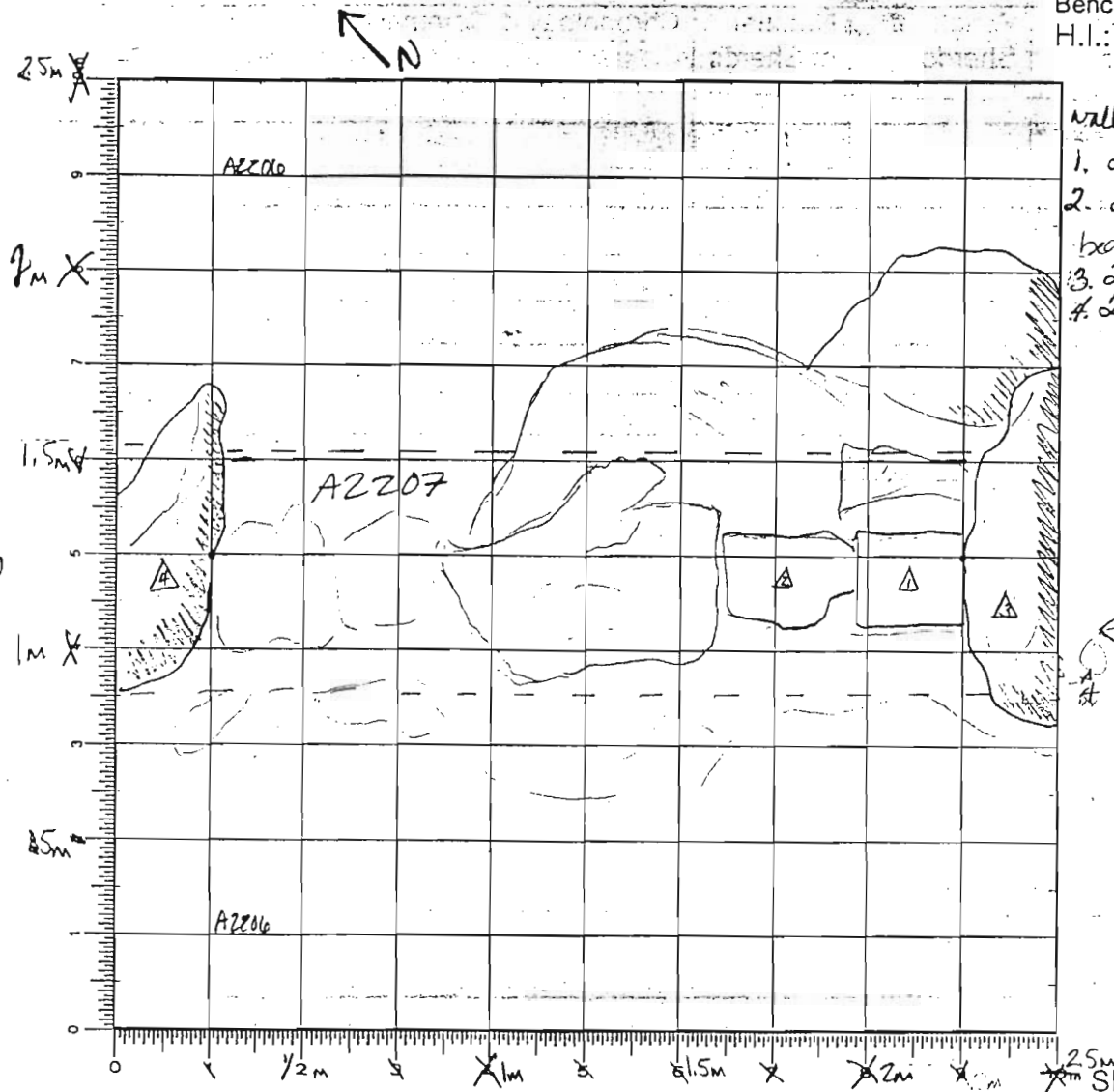
Benchmark used: R8Reading on
Benchmark: 346.48H.I.: 3.324

Wall:
 1. 2.802 = 367.010
 2. 2.835 = 366.977
 Bedrock:
 3. 2.405 = 367.407
 4. 2.596 = 367.216

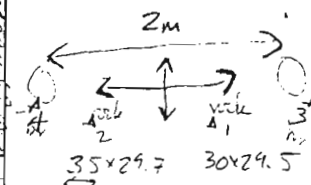

DEFINITION/DESCRIPTION of LOCUS (explain why you changed locus numbers):

Today's date: 11 Jun 03Locus above: A2206Locus parameters: Foundation wall consisting of two stones between large bedrock boulders in the eastern part of the trench.

Verbal description:

Two stones located in between two large bedrock boulders, approximately parallel to line of A2202 and A2205. No other foundation stones located - probably have tumbled out. "Wall" is about 65 cm wide (between the bedrock boulders) and about 29.5 cm thick.

Locus Interpretative Comments (What do you think this is? DATE your comments, continue on additional pages if necessary):

Foundation wall for building that used to consist of A2202 and A2205 (11 Jun 03). We were digging between sections of bedrock of A2206 when we came down on part of a wall. Observed & defined it, then changed loci. No soil sample was taken.

Excavator KK

7/11

OBJECTS

ADDITIONAL COLLECTED MATERIAL

[illegible]

Year 2003 Trench/Locus A2208 Excavator KK**Elevations**Benchmark used: A2100

Reading on

Benchmark:

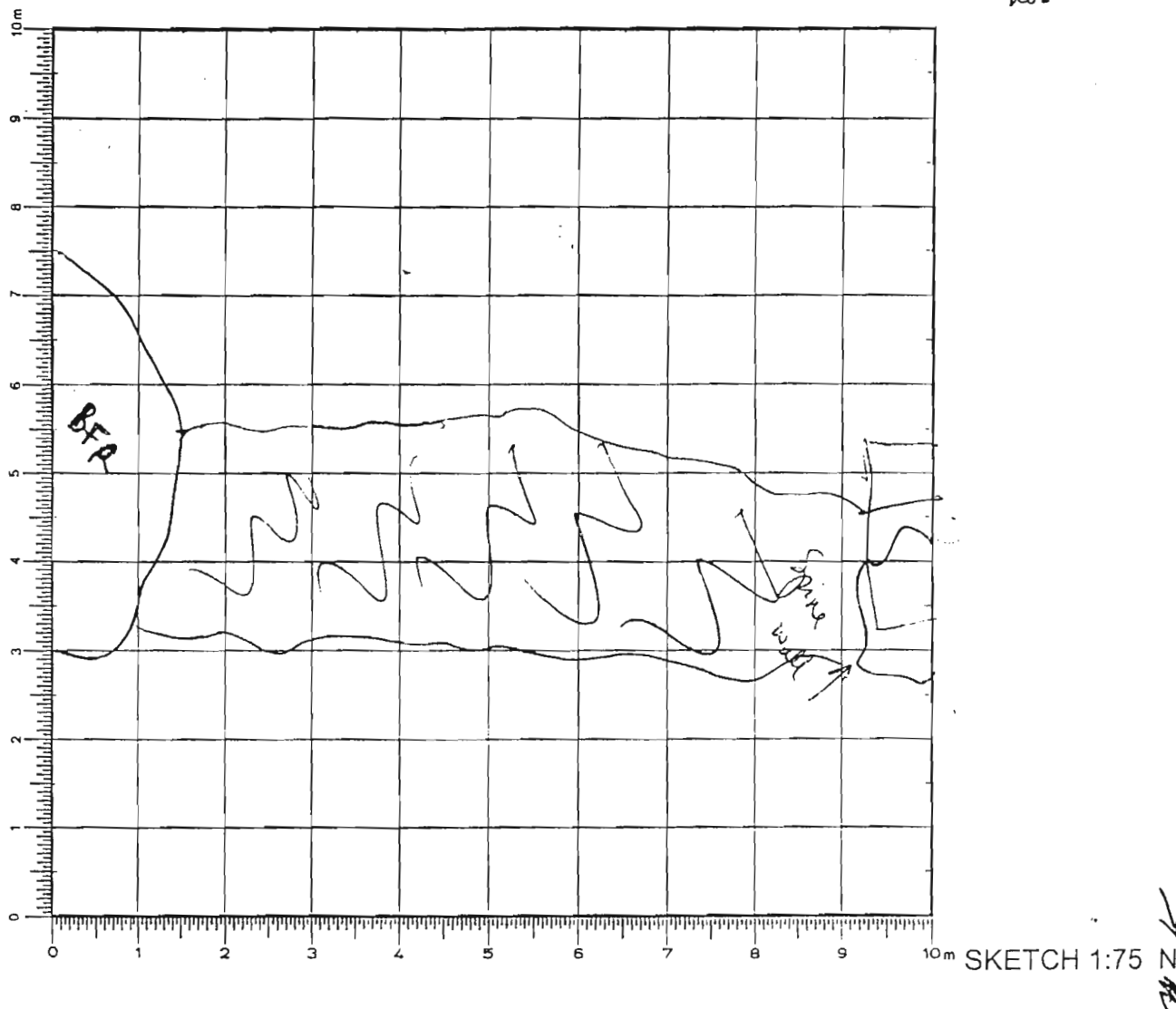
H.I.: not taken

DEFINITION/DESCRIPTION of LOCUS (explain why you changed locus numbers):

Today's date: 4 July 03Locus above: A2206Locus parameters: at bottom of trench A2200 (northwest).Verbal description: Roadway in lower part of trench bounded by some worked stones apparently. See architect's drawing.Locus Interpretative Comments (What do you think this is? DATE your comments, continue on additional pages if necessary): Roadway (?)

[illegible][illegible][illegible]

Year 2003 Trench/Locus A2208 Excavator KK

DESCRIPTION of PROGRESS of EXCAVATION [date each entry and identify associated pottery pail(s)]:

4 July 03

Rod asked for a new locus for roadway in lower portion of trench outside of spine wall. After excavation and closing of trench this locus was assigned because of further investigation into spine wall/road area that was beneath A2200, A2100, and A1700.