

## B800 Final Report

Trench Master: Nichole M. Doub

Workmen: Tasos Dantes and Nikolis Spiliarotis

Trench Assistants: Krista Judge, Deanna Mellican, Alexander Parker, Kate Waring, and Anne Marie Zeller.

### Trench Outline:

Trench B800 is located on the SW slope consisting of a 2.65 x 3.53m area in addition to an ~6.5 x 2m extension to the west and south. In this trench is a 5m extent of wall bedding. After the discovery of the east face of wall-B707 in neighboring trench B700, trench B800 was opened in order to explore the possibility of finding a structure to the east of and associated with B707. Benchmark-R9 (355.625) was used throughout excavation.

### Loci Descriptions:

- B803  
This locus consists of unconsolidated rocky soil and the first signs of pre-bedrock containing little in the way of artifacts. The locus is confined to the west by wall-B804. The rocky bedding that comprises the remains of wall-B804 continues below the level of this locus, though there were no excavations below this elevation.
- B802  
Locus made up of unconsolidated soil rich in artifacts. Seems to be leveling fill for a surface that has eroded away or an area that served as a dump for an upper terrace.
- B801  
Topsoil beneath modern surface.
- B805 & B806  
Contamination zone located under modern terrace wall-B701.
- B807  
Locus consists of low content fill in front of the bedding for wall-B804.

### Synopsis:

The area to the east of wall-B704 seems to be leveling fill for a surface associated with B804 which eroded down the hillside. The fill is a rich deposit containing bone, Iron Age ceramics, and objects including stone tools, spindle whorls and an iron nail. What remains of B804 is bedding for what at one time was a substantial wall made up of large stones some of which can be seen in the remaining bedding. I believe that the rocks that were once a part of B804 were removed and used to construct the modern terrace wall-B701 as they would have been very conveniently source.

The region to the west of wall B804 and under wall-B701 (after its removal) is largely contaminated via erosion against the modern wall. Beneath this level of contamination, however, is another area of fill associated with wall-B707, which contained large quantities of Iron Age ceramics.

1:20

↑  
ε  
↓

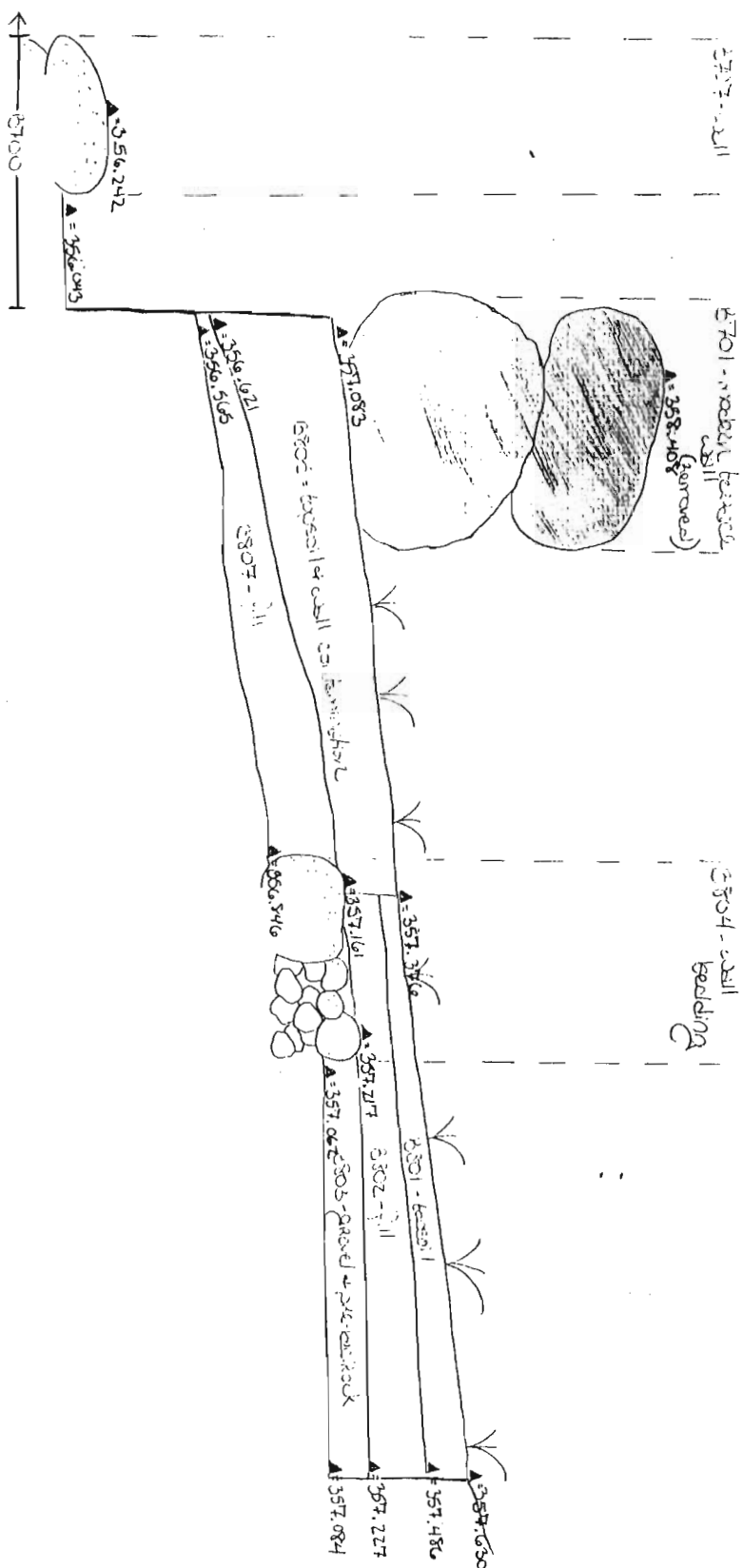

B1200

← N-S →

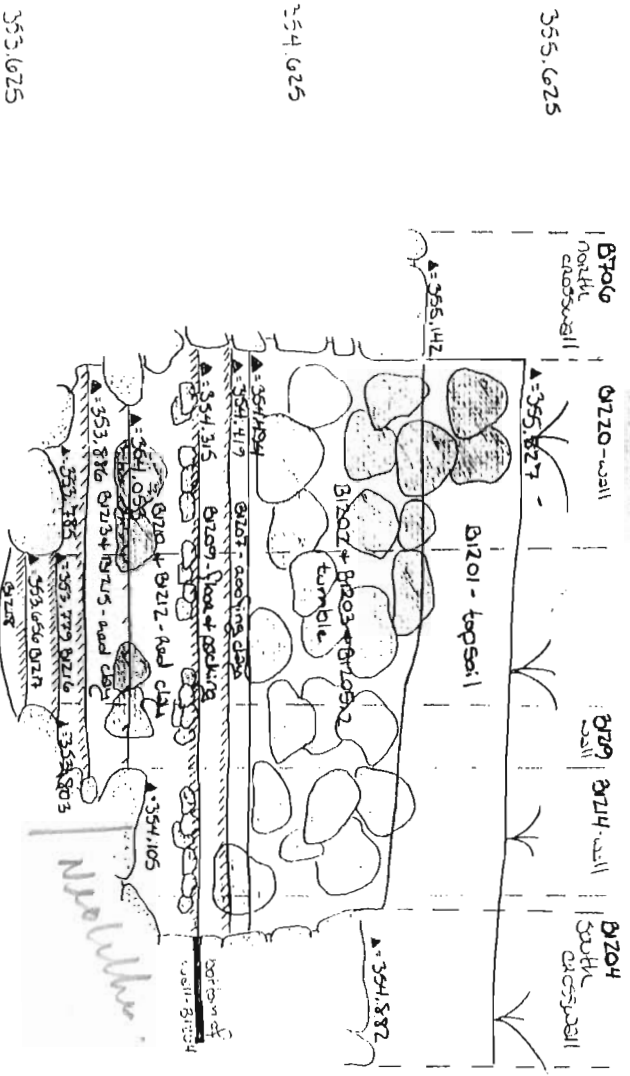

355.625

354.625

353.625

B1200

←W-E→

355.625

B1211 - West Terrace Wall

354.625

353.625

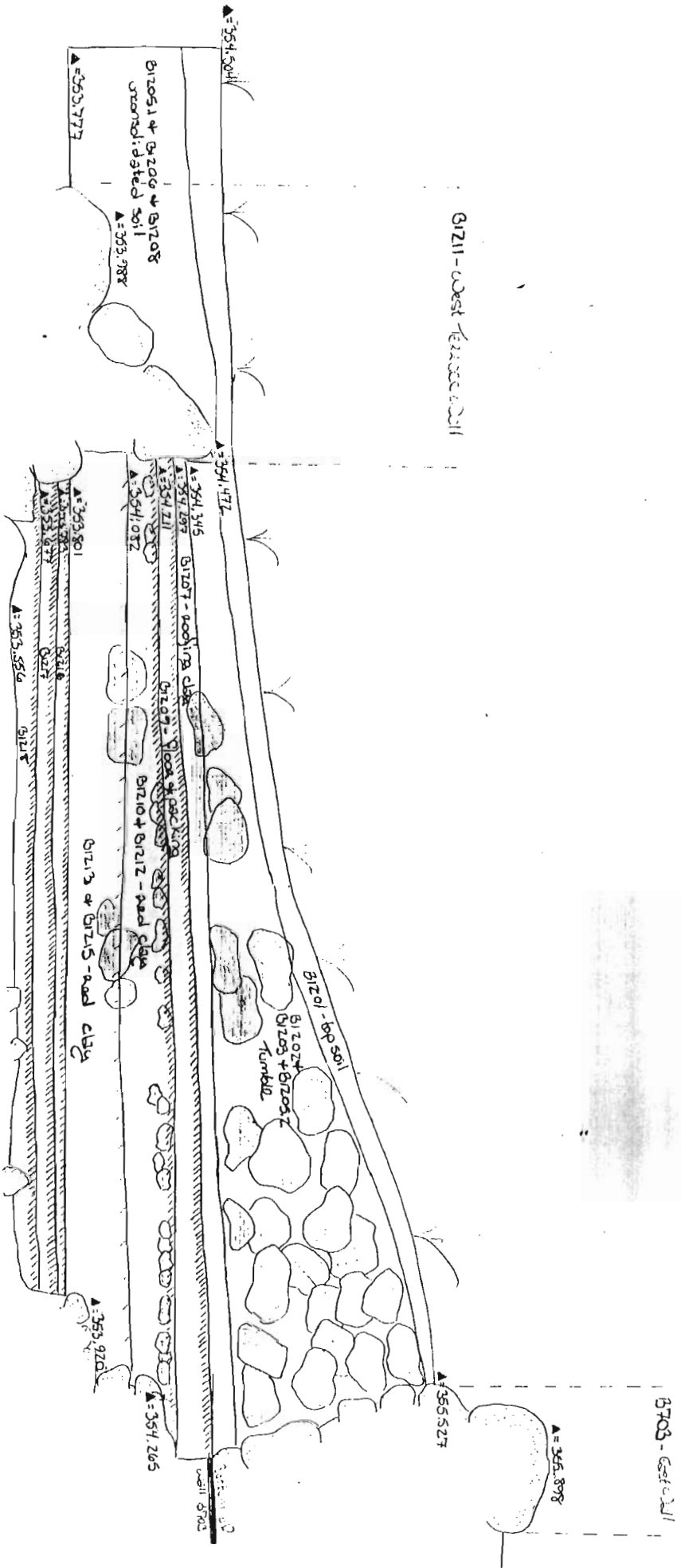
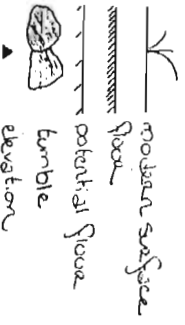

# B1200 running section

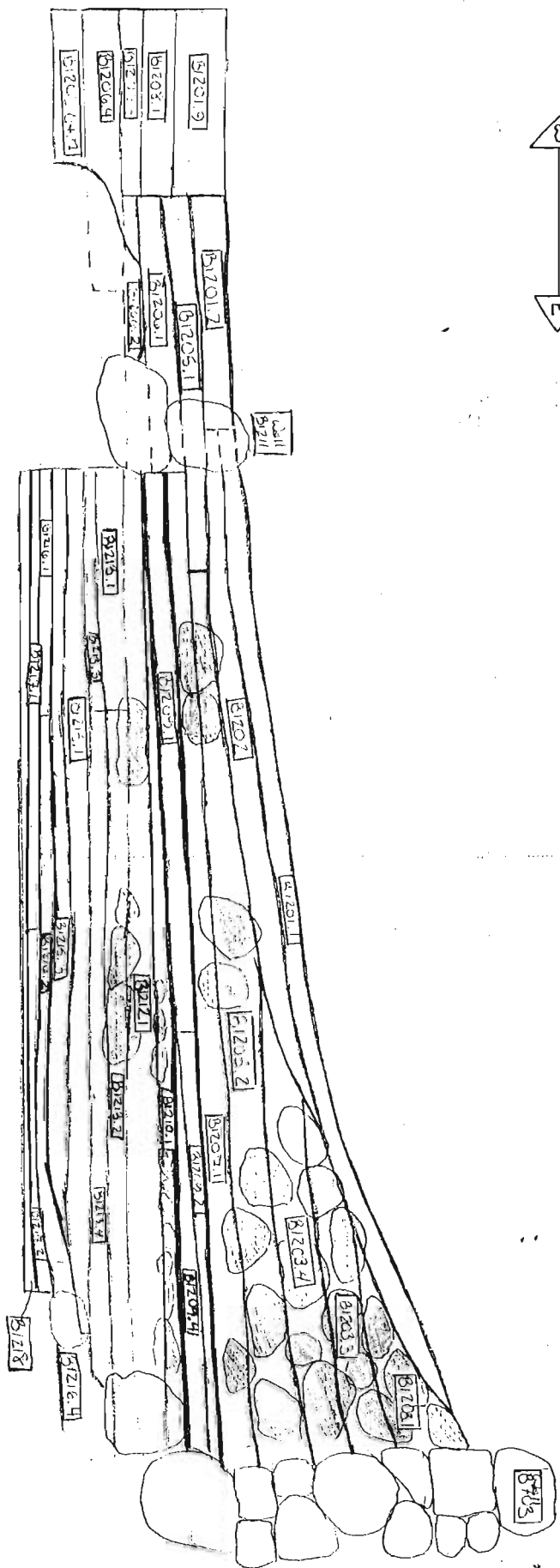

B1200 average section

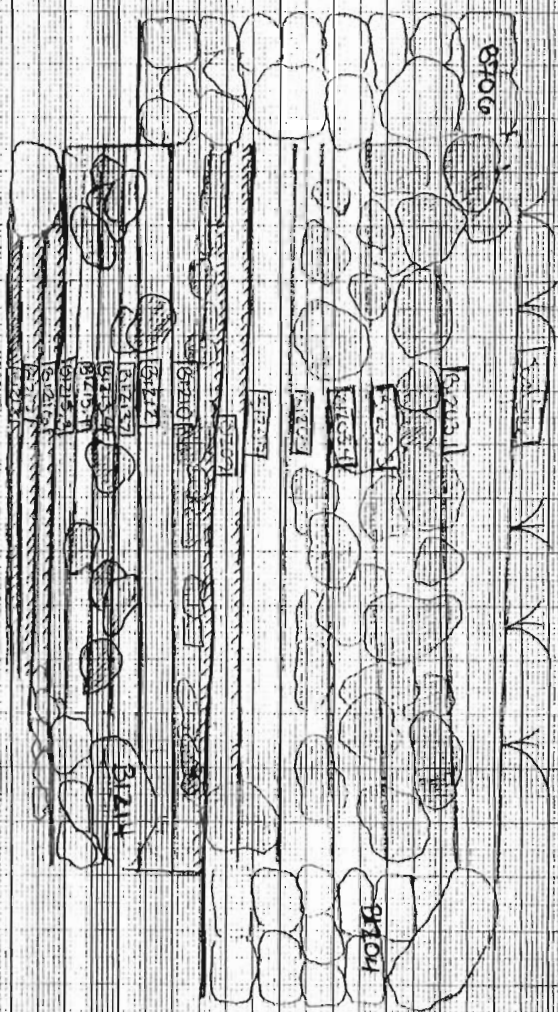

Year 03 Trench/Locus B800 Excavator JMD

# Elevations

Benchmark used: 29  
 Reading on 355.625  
 Benchmark:  
 H.I.: 3.337

1 - 1.283 = 2.054  
 2 - 1.882 = 1.955  
 3 - 1.597 = 1.740  
 4 - 1.586 = 1.751  
 5 - 1.453 = 1.884

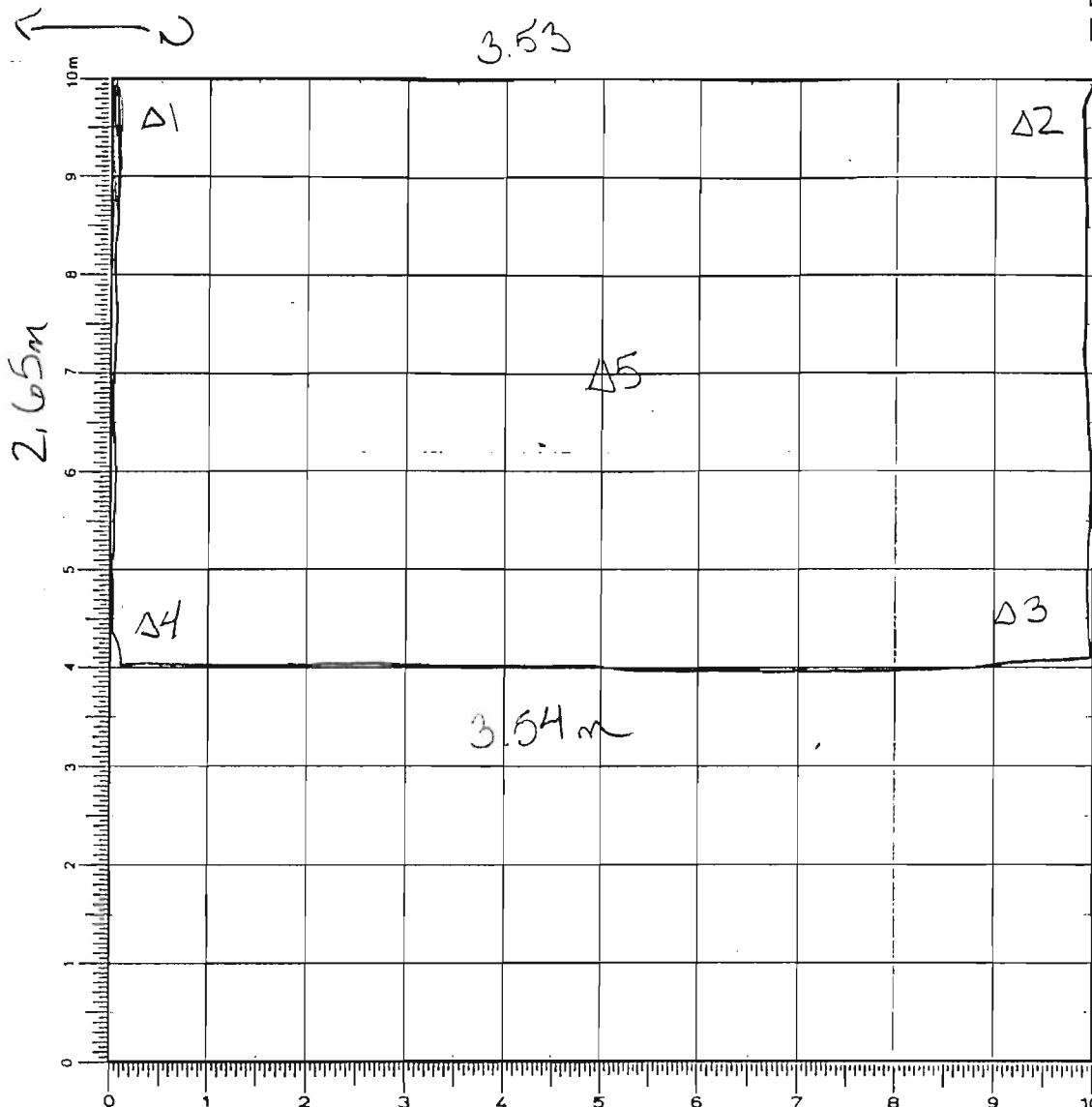

SKETCH 1:75

DEFINITION/DESCRIPTION of LOCUS (explain **why** you changed locus numbers):

Today's date: 6 Jun 03 Locus above:

Locus parameters:

Verbal description:

Locus Interpretative Comments (What do you think this is? DATE your comments, continue on additional pages if necessary):

Year 03

## Trench/Locus

3500

Excavator NMD

[illegible]

## OBJECTS

[illegible]

ADDITIONAL COLLECTED MATERIAL

[illegible]



Year 03 Trench/Locus 3801 Excavator MD

# Elevations

Benchmark used:

Reading on

Benchmark:

H.I.: 3.908

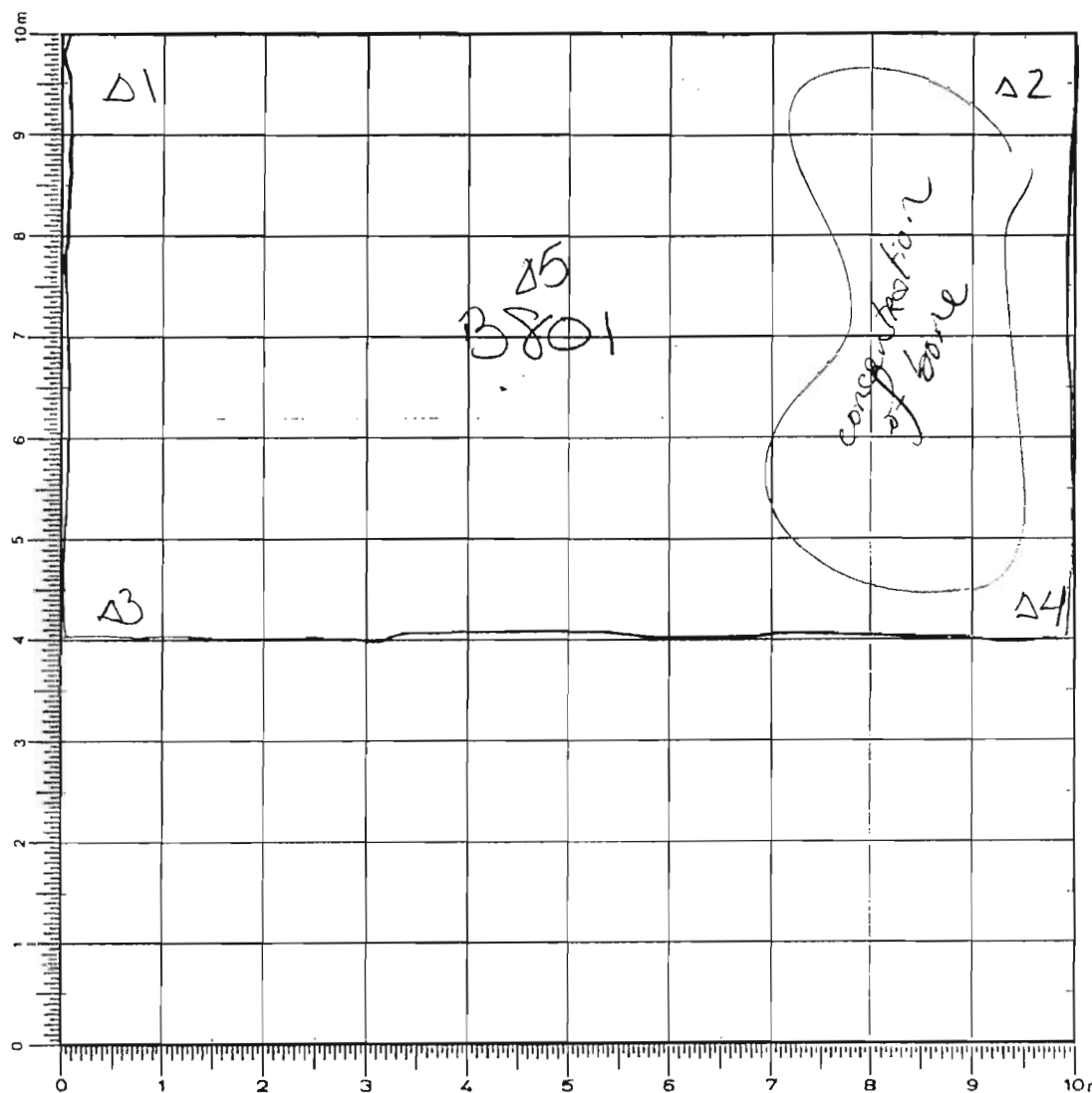

bottom of 3801	1	1.447 = 1.86
	2	1.593 = 1.95
	3	1.644 = 1.96
	4	1.657 = 1.95
	5	1.585 = 1.72

SKETCH 1:75 N

DEFINITION/DESCRIPTION of LOCUS (explain **why** you changed locus numbers):

Today's date: 6 Jun 03 Locus above: ~~3801~~

Locus parameters:

Verbal description:

top soil

Locus Interpretative Comments (What do you think this is? DATE your comments, continue on additional pages if necessary):

Excavator UMD

[illegible]

## OBJECTS

[illegible]

ADDITIONAL COLLECTED MATERIAL

[illegible]

Year 03 Trench/Locus B801 Excavator JMD

DESCRIPTION of PROGRESS of EXCAVATION [date each entry and identify associated pottery pail(s)]:

6 Jun 03

B801.1 - pass across trench through top soil.

Soil is a dull brown and very gravelly  
concentration of bone along the south edge  
of the trench.

- . pottery
- . bone.

Year 03 Trench/Locus B-802 Excavator NMO

# Elevations

Benchmark used:

Reading on

Benchmark:

H.I.: 3.350

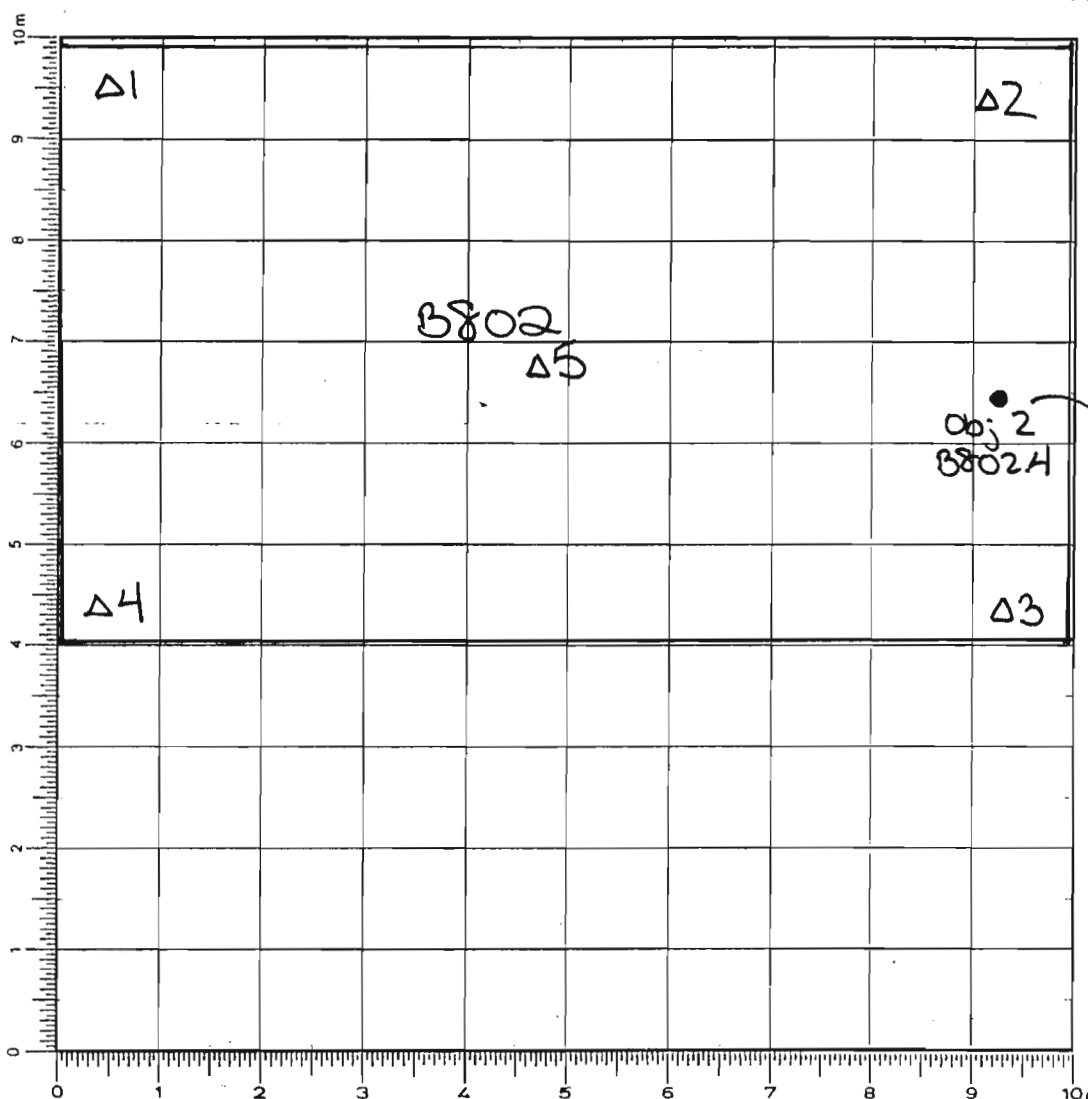

- 1 - 1.748 = 1.602
  - 2 - 1.693 = 1.657
  - 3 - 1.754 = 1.596
  - 4 - 1.806 = 1.544
  - 5 - 1.776 = 1.574
- bottom of B802

HI - 3.331  
Δ - 1.688

SKETCH 1:75 ~~N~~

DEFINITION/DESCRIPTION of LOCUS (explain why you changed locus numbers):

Today's date: 6 Jun 03 Locus above: B801

Locus parameters: ~ 2.5 x 3.5 m

Verbal description:

no discernable architectural features.

dull brown gravelly soil

Locus Interpretative Comments (What do you think this is? DATE your comments, continue on additional pages if necessary):



DESCRIPTION of PROGRESS of EXCAVATION [date each entry and identify associated pottery pail(s)]:

6 Jun 03 cont...

B802.1 - 1st pass across locus

soil is damp from previous days rain, workable but hard to describe.

Found in screen:

- .bone
- .pottery
- .sea stone
- .stone tool
- .pumice.

7 Jun 03

B802.2 - continuation of the 1st pass in the east half of the trench.

lots of pottery including pithos shreds. large quantities of bone in both trench & 1/4" screen

Found in screen:

- .bone & pottery
- .2 stone tools
- .spindle wheel.

B802.3 - continuation of pottery being collected from the 1st pass.

B802.4 - 2nd pass across locus.

consistency and content of this pass seem similar to the previous pass  $\therefore$  no change in locus.

soil is fairly loose, dull brown, and little gravelly.

Found in screen:

- .spindle wheel
- .iron slag
- .iron ~~frag~~ (nail?)
- .bone
- .pottery

Year 03 Trench/Locus B-802 Excavator NMD

DESCRIPTION of PROGRESS of EXCAVATION [date each entry and identify associated pottery pail(s)]:

9 Jun cont...

Rocks beginning to appear, particularly along the west edge of the trench (0.5 m proximity to modern wall B701). This may suggest the beginning of tumble or fill for the terrace wall. The small size of the stones do not suggest any architectural features.

There is also a reddish color in the soil extending outwards from the SE corner.

The changing color of the soil and the appearance of larger rocks in the next layer signal a new locus.

10 Jun 03

Pail B802.6 - pottery & bone from 1/4" screen left over from 9 Jun.

Year 03 Trench/Locus B803 Excavator JMD

# **Elevations**

Benchmark used:

Reading on

Benchmark:

H.I.: 3.351

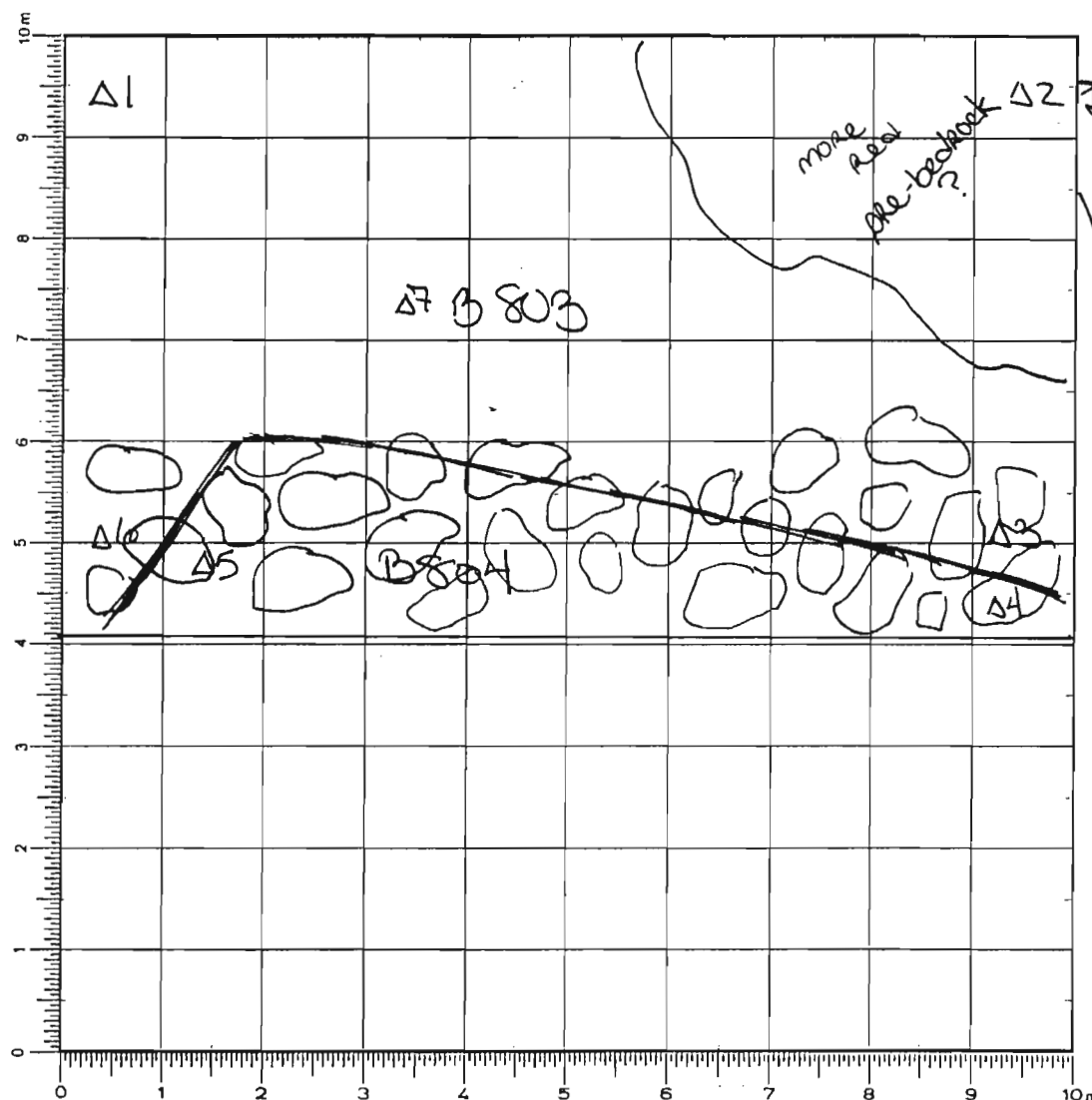

- 1 - 1.883
- 2 - 1.894
- 3 - 1.938
- 4 - 1.788
- 5 - 1.809
- 6 - 1.935
- 7 - 1.897

SKETCH 1:75

DEFINITION/DESCRIPTION of LOCUS (explain **why** you changed locus numbers):

Today's date: 10 Jun 03 Locus above: B802

Locus parameters: ~ 2.5 x 3.5 m

Verbal description:

Changed locus due to noticable upcoming change in soil color and consistency. Tumble in the lower western side extending about halfway into the trench. Redish soil is creeping outward from the SE corner about 1.5m towards the center of the trench. No discernable architectural features.

Locus Interpretative Comments (What do you think this is? DATE your comments, continue on additional pages if necessary):





Year 03 Trench/Locus B803 Excavator NMD

DESCRIPTION of PROGRESS of EXCAVATION [date each entry and identify associated pottery pail(s)]:

10 Jun 03

Soil has taken on a more reddish color which is most distinctive in the SE corner. very gravelly

less pottery and bone are being pulled out as compared to B802 both in the trench & the 1/4" screen.

One face (east) of a wall has appeared out of the rocks along the western edge of the trench.

The soil in the SE corner has become markedly redder and extremely rocky/gravelly. This is probably a region of pre-bedrock.

~~Bedrock is beginning to creep into the trench at the corner.~~

11 Jun 03

Before excavations can continue in B800, the modern terrace wall - B701 needs to be removed so that the extent of wall - B804 can be excavated.

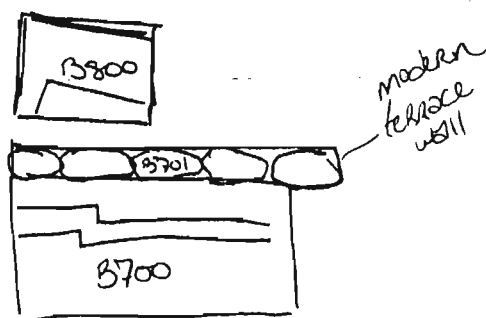

Benchmark used:

Reading on

Benchmark:

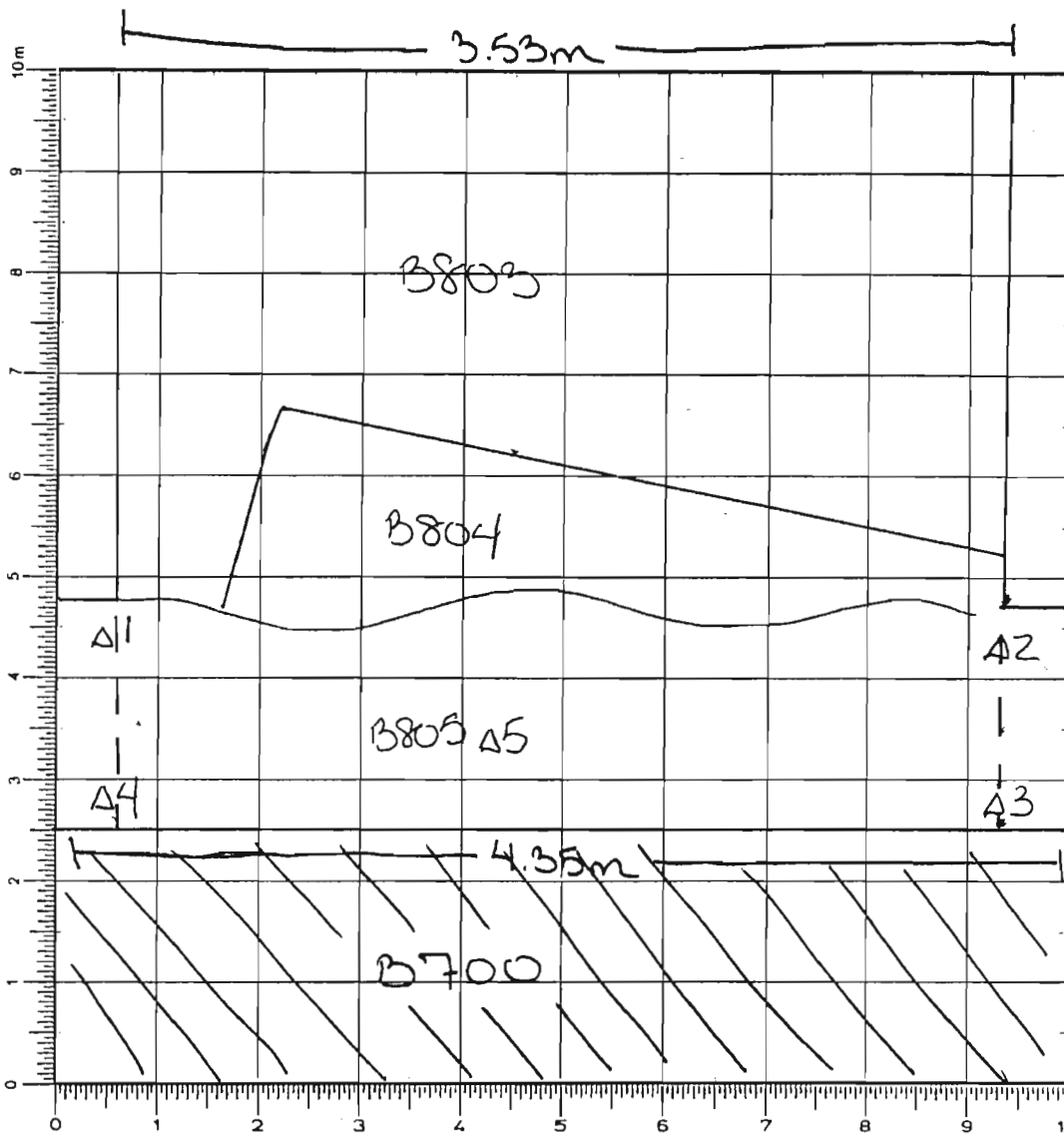
H.I.: 3.393

1 - 1.691 = 1.702  
 2 - 1.674 = 1.719  
 3 - 1.838 = 1.555  
 4 - 1.935 = 1.458  
 5 - 1.808 = 1.585

DEFINITION/DESCRIPTION of LOCUS (explain why you changed locus numbers):

Today's date: 11 Jun 03 Locus above: B805Locus parameters: located west of B804 & east of B700 ~4.3 x 2m

Verbal description:

B805 consists of the bulk which extends B800 to the edge of B700. It was originally located under B701 and was exposed when the wall was removed.

Locus Interpretative Comments (What do you think this is? DATE your comments, continue on additional pages if necessary):

Year \_\_\_\_\_ Trench/Locus \_\_\_\_\_ Excavator \_\_\_\_\_

## OBJECTS

ADDITIONAL COLLECTED MATERIAL

[illegible]

Year 03 Trench/Locus B805 Excavator MD

DESCRIPTION of PROGRESS of EXCAVATION [date each entry and identify associated pottery find(s)]:

11 Jun 03 cont...

B805 is the balk separating the rest of B800 from B700 and was exposed after the removal of modern wall - B701. This locus is largely contaminated on its surface due to the intrusion ~~caused~~ of the modern wall, previously on top of it.

Some pottery and little bone is being found in the first two passes.

As the balk is being cleared away, more of B804 is being exposed. While the second face of the wall has not yet been found, the present thickness of B804 might suggest that it is a retaining wall.

The north and south ends of B805 were extended ~ 3m than B806 in order to prevent contamination from outside the trench from falling in due to the crumbling consistency of the surface soil.



Year 03

Trench/Locus

3806

Excavator NMD[illegible]

## OBJECTS

[illegible]

ADDITIONAL COLLECTED MATERIAL

[illegible]

Year 03 Trench/Locus B700 - B800 Excavator JMD

DESCRIPTION of PROGRESS of EXCAVATION [date each entry and identify associated pottery pail(s)]:

12 Jun 03 "for my sanity"

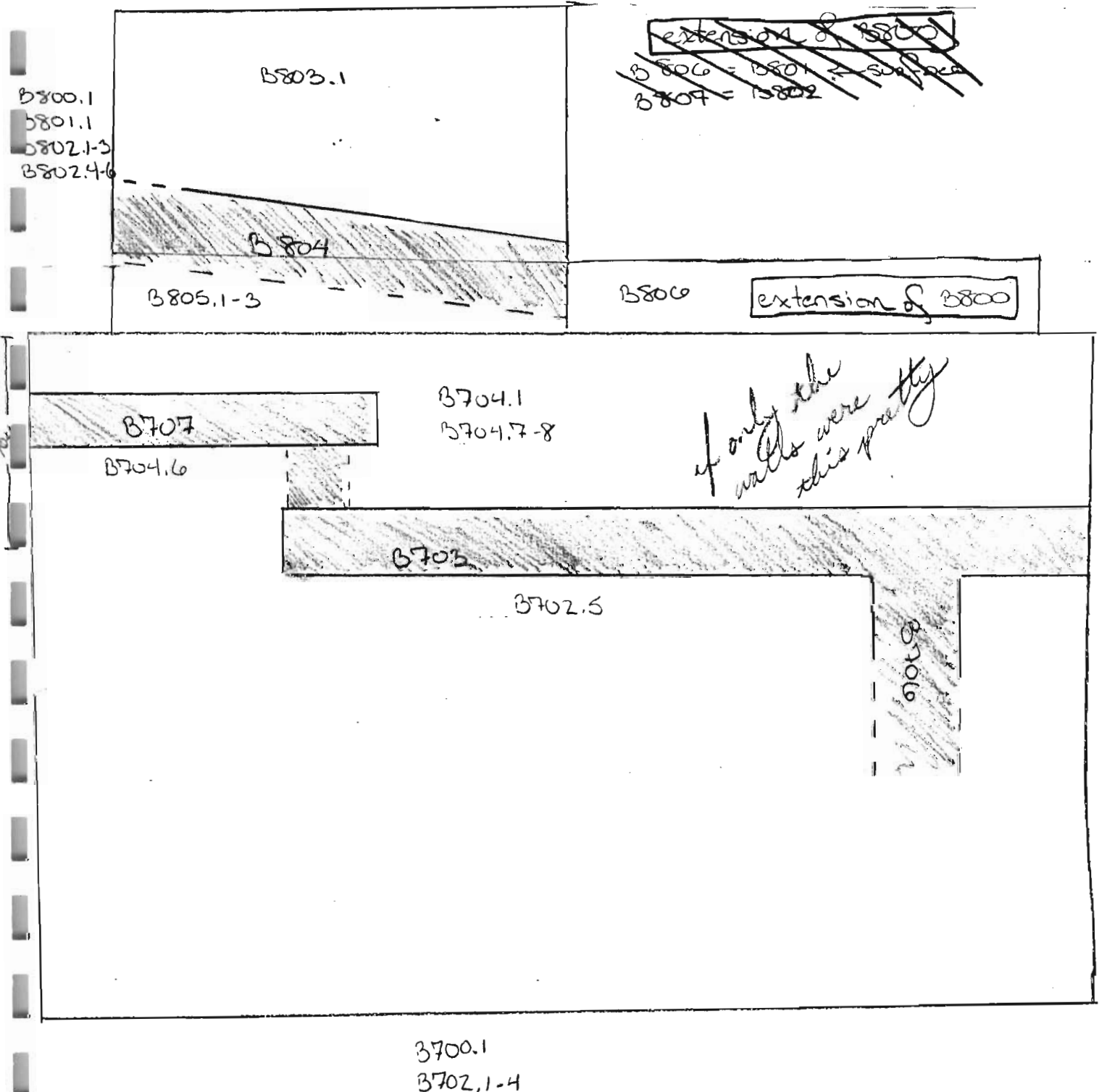



Year 03 Trench/Locus B806 Excavator NMD

DESCRIPTION of PROGRESS of EXCAVATION [date each entry and identify associated pottery find(s)]:

12 Jun 03

Trench B800 was extended to the south to continue along the same path as B805 in order to preserve the architectural wall-B804, to where it is believed to meet the neighboring bedrock, and to define the space/room which extends into B700 (see p3 diagram).

B805 + B806 seem to have the same consistency since both areas were previously under B701.

Pat B806.2 - second pass across locus

more pottery being found in B806 than in neighboring B805.

the top of wall-B804 is starting to show through at the bottom of B806.2.

Year 03 Trench/Locus B807 Excavator MD

## Elevations

Benchmark used:

## Reading on

Benchmark:

H.I.: 3.564

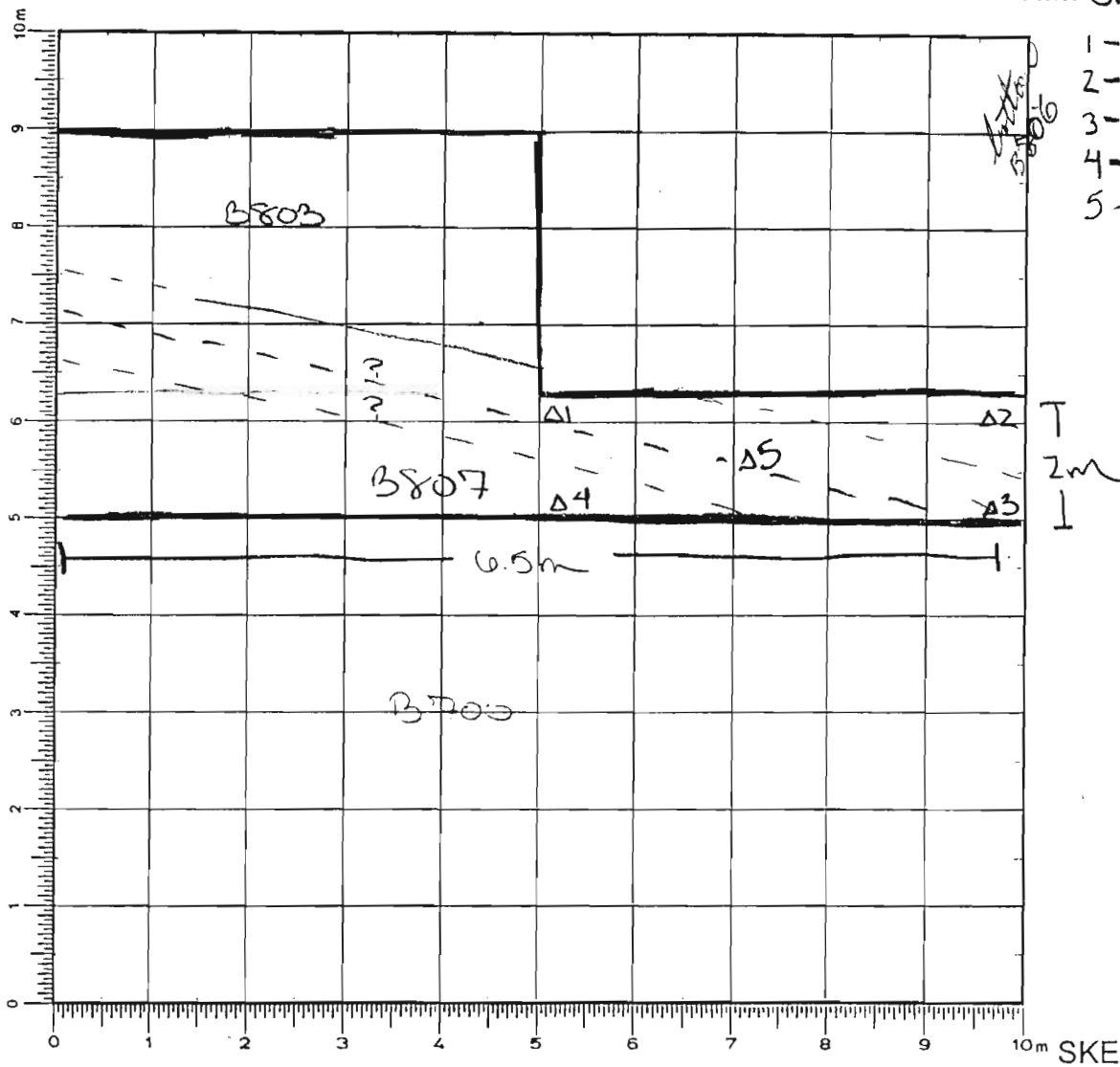

- 1 - 2.089
- 2 - 2.267
- 3 - 2.502
- 4 - 2.633
- 5 - 2.244

T  
2m  
1

SKETCH 1:75

DEFINITION/DESCRIPTION of LOCUS (explain **why** you changed locus numbers):

Today's date: 13 Jun 03      Locus above: 3805 + 3806

Locus parameters:  $\sim 2 \times 6.5 \text{ m}$  confined to the east by B804

Verbal description:

gaschly; loose soil

Locus Interpretative Comments (What do you think this is? DATE your comments, continue on additional pages if necessary):



Year 03 Trench/Locus B807 Excavator DM

DESCRIPTION of PROGRESS of EXCAVATION [date each entry and identify associated pottery find(s)]:

13 Jun 03

B807.1 pass taken across the locus in order to define the west face of wall-B804.

Some tumble in front of the wall as well as slipped stones were removed, but still no face is visible.

Large quantities of bone and especially pottery are coming out of this pass.

Moving further into the rock accumulation in front of B804, the face is still undetermined. One large stone at the northernmost end of the visible wall looks as though it is a remnant of the bottom course ~~and~~ and the rest of the wall has eroded and slipped out of place.

Perhaps the crumbly, gravelly material which composes the visible area of the wall is actually the packing which would have supported the first course. In which case, it would not be unlikely to suggest that the stones used in making the modern terrace wall-B701 may have come from this ancient wall.

Year 03 Trench/Locus B807 Excavator UMD

DESCRIPTION of PROGRESS of EXCAVATION [date each entry and identify associated pottery pile(s)]:

16 Jun 03

Pail B807 2 - Finishing pass across B807 in southern most corner of the locus.  
slightly reddish soil in this area

The wall here seems to disappear towards the southern end and larger stones ~~are visible~~ are visible in the scarp. May indicate that the wall is located further east and outside the present parameters of the trench. Although, if this is the wall, this is the only course preserved as only dirt appears to be beneath these stones.

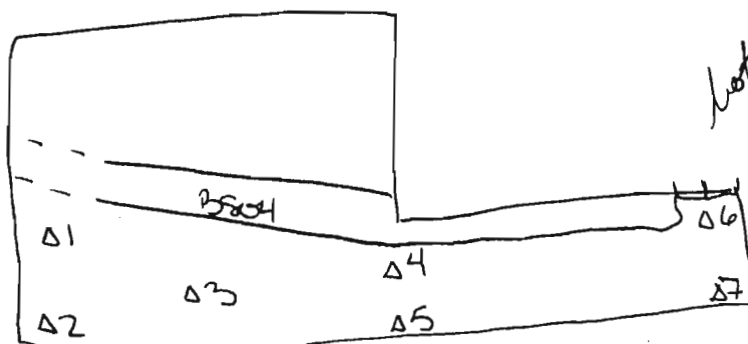

bottom  
B807

HI:	3.605
1-	2.358
2-	2.674
3-	2.619
4-	2.630
5-	2.694
6-	2.560
7-	2.625