

Year 2004 Trench/Locus B2300 Excavator ESKA
B2301

Elevations

Benchmark used: R14
 Reading on
 Benchmark: (3.811)
 H.I.: 358.18

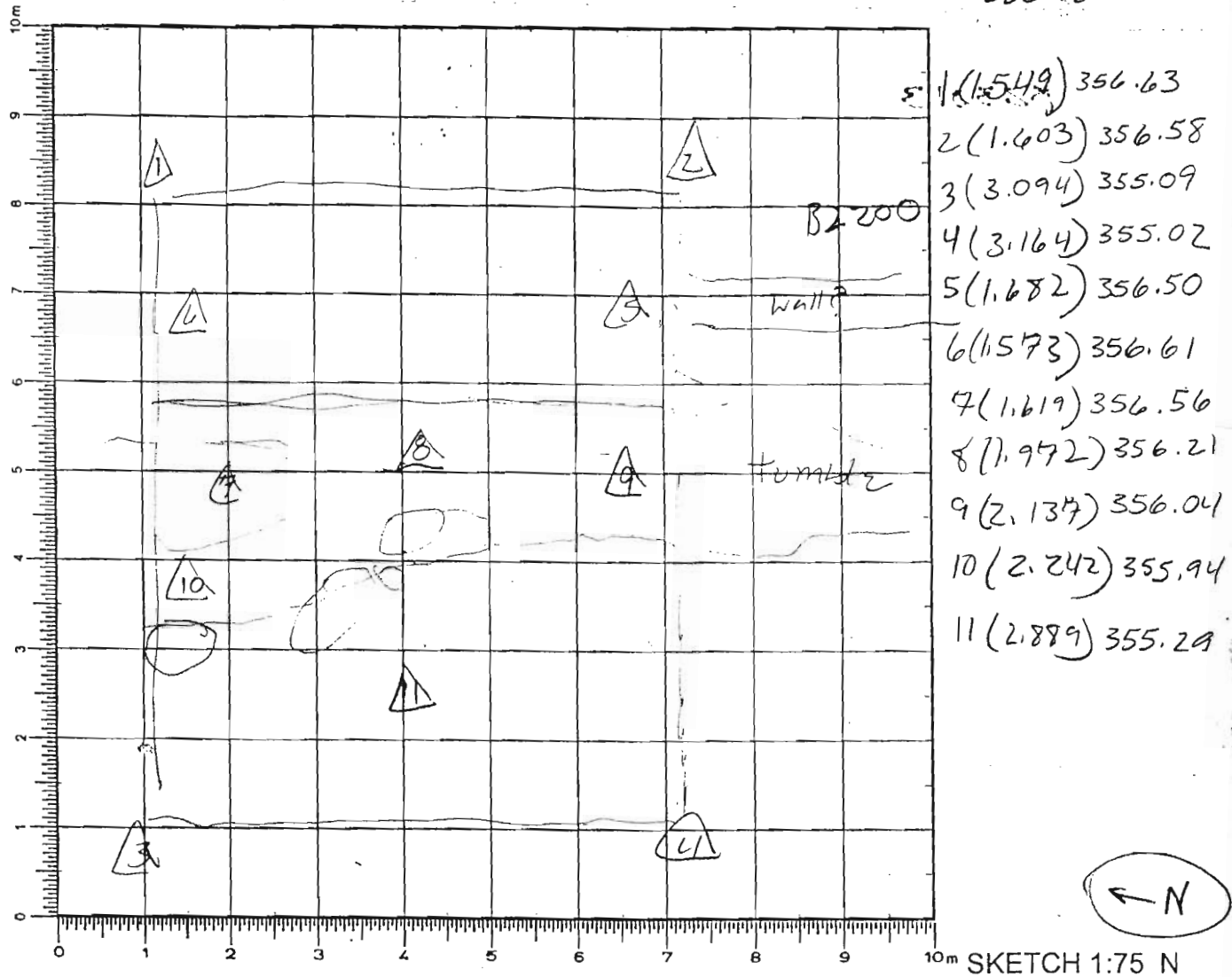

DEFINITION/DESCRIPTION of LOCUS (explain **why** you changed locus numbers):

Today's date:

3.35 Locus above:

Locus parameters:

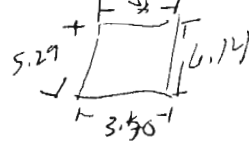

Verbal description:

Locus Interpretative Comments (What do you think this is? DATE your comments, continue on additional pages if necessary):

Locus/Pottery Pail Number	Weight of Sherds	Number of Sherds	Chronology & Comments
B B2301.1	3.51kg	261	Archaic, Hellenistic, LMTIC
B2301.2	8.05kg	428	LMTIC, Archaic, Hellenistic, Late Geometric ^{Orientaliz.}
B2301.3	0.226kg	21	LMTIC, Archaic, Hellenistic
B2301.4	11.405kg	201	Archaic
B2301.5	6.957kg	230	LMTIC? Archaic,
B2301.6	0.12kg	30	LMTIC, Archaic, Hellenistic?, Late Geometric
B2301.7	0.51kg	22	Archaic, LMTIC, Hell?
B2301.8	0.210kg	6	Archaic
B2301.9	0.005kg	1	Archaic

28 June
from
atop
wall →

OBJECTS

Object Number	Associated Pottery Pail	Identification (material/form)	Location	Elevation	Catalogue Number
<u>1</u>	B2301.2	stone tool	area smooth flat. stone concret.		

ADDITIONAL COLLECTED MATERIAL

Locus/Pottery Pail Number	Bones	Shell	Carbon	Pumice	Soil Sample	Other (specify)
B2301.1	✓ regular			1		
B2301.2	✓ regular		✓	✓	2 standard intensive	✓ fired clay, pebbles
B2301.3	✓ regular				standand	
B2301.4	reg					
B2301.5	reg, 1/4"		✓			2. pebbles
B2301.6	reg					
B2301.7	reg					

Year 2004 Trench/Locus B2301 Excavator ESKA

DESCRIPTION of PROGRESS of EXCAVATION [date each entry and identify associated pottery pile(s)]:

17 June 04

We are beginning by clearing off the surface rubble.
We are not collecting from this cleaning.

~~17~~

18 June 04

- We are beginning our first pass through the whole trench w/ B2301.1. Tassos will be using the kasma.
→ Change of plans. Tassos and Georgios are working on the old dump this morning, so we are beginning the pass ourselves, from the west (bottom of slope) working east, with skalistirid.

We are leaving a ≈ 40 cm path between us and the B2200 to avoid contamination. We will go back and take this down carefully after.

About $\frac{1}{4}$ of the way up, we have encountered a large accumulation of ~~stone~~ ^{stone}, likely part of the modern terrace wall visible just to our north.

→ 22 June 04:

* SEE elevations for close of this pass. Although we did not change loci after this pass we should have as our surface cleaning and pass B2301.1

represent the modern surface wash and are thus distinct from the following pass (B2301.2) in ancient wash.

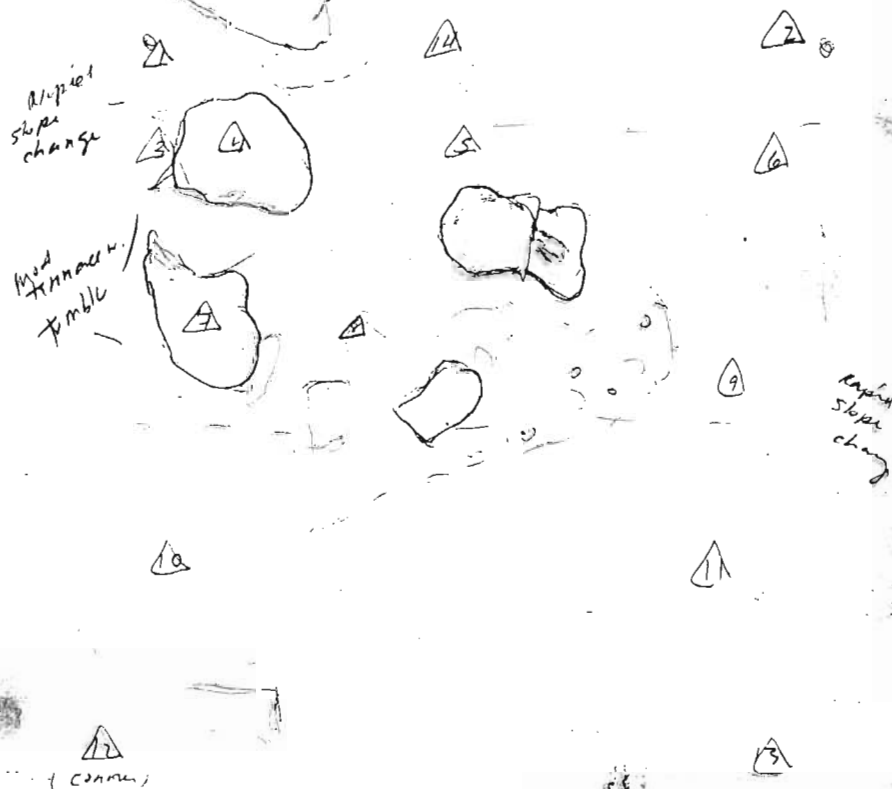

Year 2004 Trench/Locus ~~B2301~~ B2301 Excavator ESKA

DESCRIPTION of PROGRESS of EXCAVATION [date each entry and identify associated pottery find(s)]:

21 June 04

This morning we will begin by taking elevations for the close of B2301.1

354.37 R14 Reading (3.67) HI: 358.04

1 (1.50) 356.54

5 (1.923) 356.12

9 (2.441) 355.60

2 (1.605) 356.44

6 (2.08) 355.96

10 (2.72) 355.32

3 (1.76) 356.28

7 (2.12) 355.92

11 (2.742) 355.30

12 (3.065) 354.98

4 (1.475) 356.59

8 (2.295) 355.75

13 (3.045) 355.00

14 (1.56) 352.52

Our first pass will be aimed at removing the tumble of the terrace wall (modern) running through our trench. Manolis and Christos are coming over from Sheri's to help us. With Kama Manolis is removing the stones, while Will, Georgios, and Chris Shorzi and what (burrow) the stone matrix. I'm doing this, too!

In the southern mid area of the tumble some fired clay was found (see B2301.2) and collected as 'other'.

- We are going quite deep in this pass, at points even 50cm, as we are removing large stones.

- This pass is going quite deep, so I am having Manolis keep a couple of stones in for now until Peggy + Donald okay them. ← it seems that this could be a band in the wall from Sheri's

- a pebble was found in the 1/4" screen.

- yes, we are screening our 5 2mbilid for tumble as we are now treating the stones we have found running quite deep (in some parts 2 courses may be exposed) - we need to take another pass to clarify this

- a concentration of small smooth flat stones, some clearly cut through, has turned up in the NE corner of the trench, well isolated

elev. @ (1.44) 356.037

@ (1.76) 356.28

Year 2004 Trench/Locus B2301 Excavator ESKA

DESCRIPTION of PROGRESS of EXCAVATION [date each entry and identify associated pottery pail(s)]:

R14 3.69

unnecessary

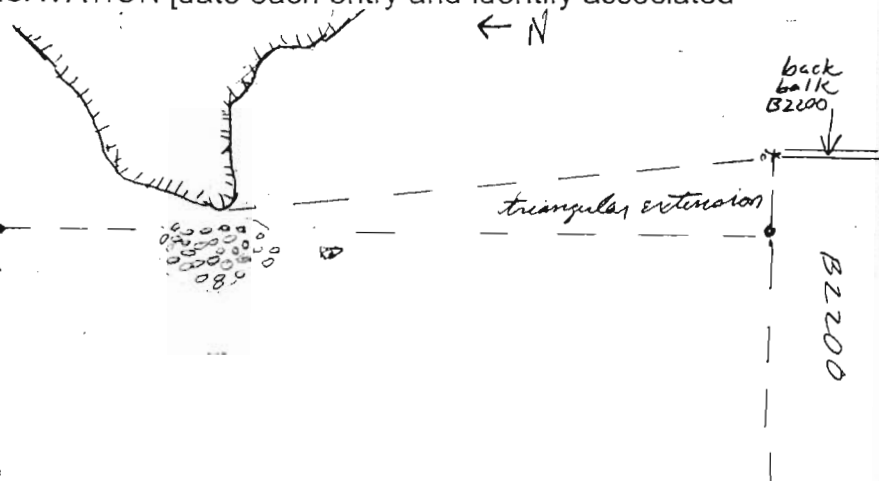

elevation from top of tripod foot with depressed decoration - we had taken elevations b/c we thought this might be more than just a nice stone

- stone tool (obj. #1) was found in the same area as the concentration of smooth flat stones (see sketch)
- we are putting Will in to dig up along the southern edge of the trench while Manolis works in the NE corner, all part of our continuing effort to bring our trench
- as Manolis is working in the NE corner, he went a bit deeper than ~~was~~ expected. He noticed the soil having a redder color and finer grain, so we took an intensive soil sample.
- A standard soil sample is also being taken with this pass
- we have found two pieces of pumice in this pass, one as soil was removed from the wall area running through the middle of the trench and another from removed soil from the top
- Tassos has returned and is bringing back the eastern back line of our trench through a ~~pass~~ small triangular pass running from the bottom point of large rock touching upon our NE corner over southward to where Shrek's scarp meets our trench (see sketch). Since this area, although cleared & cleaned in our initial cleaning pass in the general area of the trench, had not yet been dug and rested higher than the area we are currently working on, we are giving it another pass #, B2301.3, for this triangular extension.
- The area of the triangular extension, once it was brought down to the level that pass B2301.2 began with, is being included in this pass

Year 2004 Trench/Locus BZ301 Excavator ESKA

DESCRIPTION of PROGRESS of EXCAVATION [date each entry and identify associated pottery pail(s)]:

21 June 04, cont. ..

- We are continuing deeper, bringing down any remnants of the balk between our trench and Sheri's (B2200). As we are moving down the ~~ent~~ matrix on the upper southern edge is becoming markedly redder - Sheri encountered the same at this elevation as she moved into sterile ~~so~~ matrix.
- small pieces of carbon have come up throughout this pass, none in large concentrations. We have collected some of these small pieces.
- as we find in the NE corner, the matrix as we are bringing the SE corner down to the same level is change to a redder color.
- a large rock, obviously out of line (in front-west) our wall was removed by Manolis (upon consultation with Peggy).
- We are now officially considering the linear accumulation of stones running across the middle (N-S) to east of middle of our trench a wall (seemingly a continuation of the back wall in Sheri's B2200, ~~the~~ idd as B2203. We are as of yet unable to define the precise transition of the wall from her trench to ours, but it certainly curves at the point it comes into B2300.

22 June 04

This morning we are beginning by carrying out two simultaneous passes - one working from the bottom (west) of the trench eastward in order to bring it down to the level of the neighboring B2200 to the north. At this pass 25 beginning with pail B2301.4.

At the same time, we are moving into the tumble in the middle of the southern boundary of our trench. We are slowly (as slowly as Manolis will go) moving east looking for the ^{line of} continuation of the back wall from B2200. This pass begins with B2301.5

Year 2004 Trench/Locus BZ301 Excavator ESKA

DESCRIPTION of PROGRESS of EXCAVATION [date each entry and identify associated pottery find(s)]:

22 June 04, cont...



- Tassos has just noted that in an isolated area of the ^{2nd} 2/5 portion of the trench (moving eastward) and along our northern border w/ BZ200, the soil became more black & contained pieces of carbon. A standard soil sample was taken (BZ301.5)
- While we were cautious moving through the tumble to see whether or not there was a cross wall there, it is now clear that there was not and there are all being removed
- BZ301.6 is a pail opened for Chris while she is cleaning the top of what we are treating as our back wall so that we can determine how it continues.
- As Manolis removed the tumble from the border of BZ300 and BZ200, some of the stones were quite large and their removal took us in some places a bit deeper than the contiguous surface of BZ200. As we were at that time coming down on a burnt layer we have been careful to go no deeper. ^{probably found in this}
- soil sample (standard) BZ301.5 (and BZ202.13) both represent concentrations of carbon found at this level (see closing elevations)
- We are now removing several large stones from the front of (we assume) our west of our back wall face.
- More stones, including the large one (⊗ sketch) have just been removed

Year 2004 Trench/Locus B2301 Excavator ESKA

DESCRIPTION of PROGRESS of EXCAVATION [date each entry and identify associated pottery pail(s)]:

22 June 04 cont ---

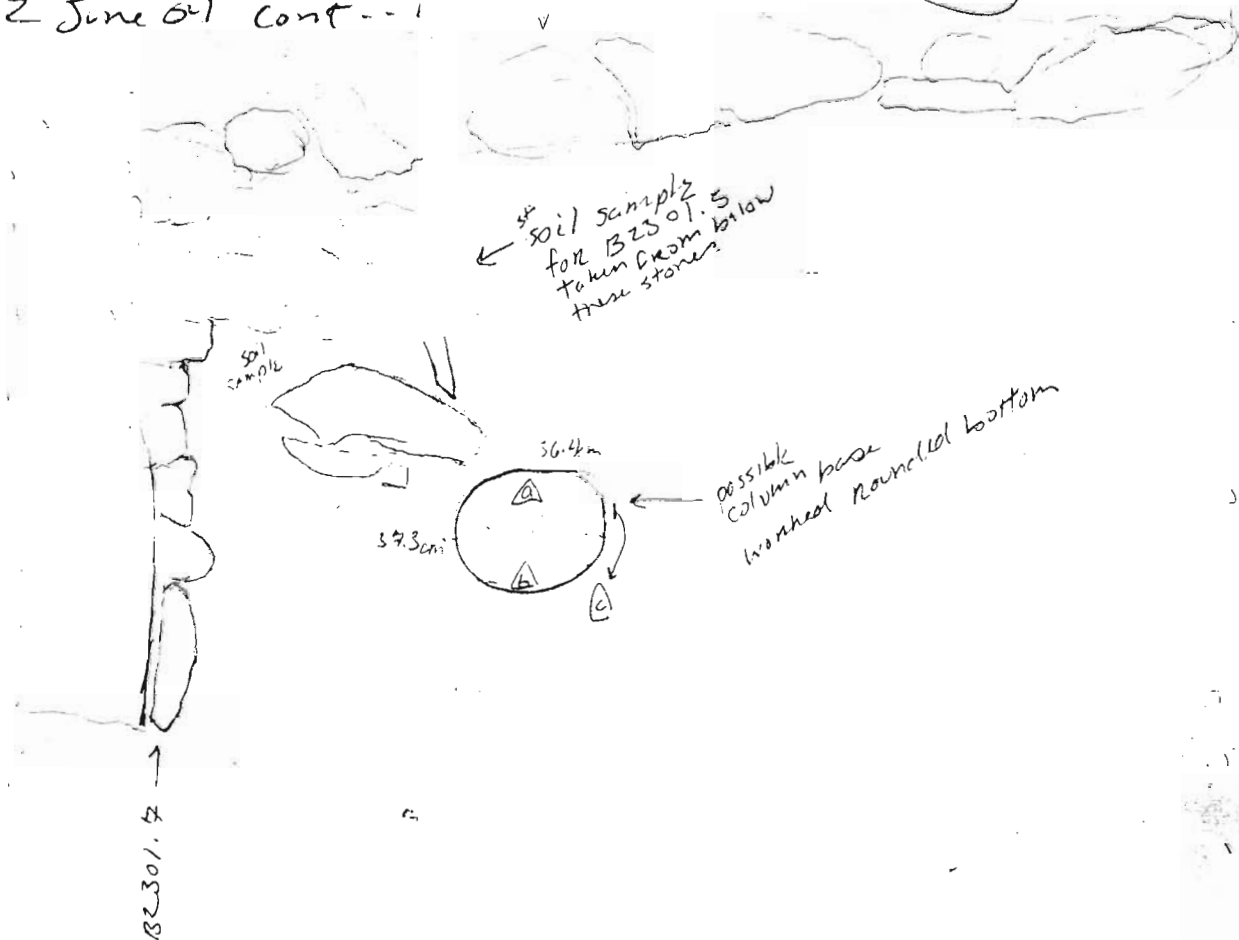

- elevations for column base:

this stone, although never taken out, ~~was~~ slightly disturbed as it was pried up a bit until the rounded bottom began to be visible and we realized it was worked

354.37 ← R14 (3.76) reading HI: 358.13

elevation from top across A (2.708) → 355.422 A (2.805) → 355.325

and from the point

where the ~~matrix~~ southern side curves into the matrix

A (2.927) → 355.203

some pieces of this may be in N

- a large pot is coming up in the corner west of where we ~~B2301.5~~ are trying to define the trajectory of the wall (see sketch). As we were completing pail/pails B2301.4 in this corner behind the pot, the soil became markedly darker (see standard soil sample B2301.4b)
- associated with pail B2301.5 is a standard soil sample taken as we encountered a blackened area of matrix while removing slipped/tumbled stones west of wall B2300 (see sketch)

Year 2004 Trench/Locus ~~B2300~~ B2301 Excavator ESR A

DESCRIPTION of PROGRESS of EXCAVATION [date each entry and identify associated pottery pail(s)]:

22 June 04, cont. . .

- we are taking yet another soil sample from the area directly beneath the wall tumble at the ~~the~~ NE corner of B2300, just west of Wall B2203
- We have now taken two soil samples from B2301.5 as the soil became blacker with tumble removal moving deeper.
- From approx the middle (N-S) of our trench, ~~from the~~ while removing some remnant tumble just west of Wall B2203, we came upon another area of very blackened soil, including an area that produced some sizable chunks of carbon. An intensive soil sample was taken. A small white pebble was found here (see "other").
- Since this blackened matrix seemed to extend across this area, the trench just west of Wall B2203, we began to discreen all of the matrix from this area.
- Considering the pithas scatter, the possible column base, and this darkened layer of matrix, we could be coming down on a floor - it could however, just be a burnt layer.
- Tassos has worked on the portion of likely wall running into B2203 along the northern side of our trench. A new pail, B2301.7, was opened for the removal of slipped and tumbled stones from this area.
- Through cleaning in this area a narrow bench/platform has become visible set into the NE corner in front of the large rock running against our northern border. A smaller stone, positioned against (just south of) this large rock, and at the western end of the feature (bench/platform) may be a built element as it appears to be set into underlying bedrock.
- The darkened matrix found at a lower level beneath the tumble running ~~the~~ south of this platform extends atop this feature, thus implying that it is indeed a built feature upon which the burnt layer has fallen.

Year 2004 Trench/Locus B2301 Excavator ESKA

DESCRIPTION of PROGRESS of EXCAVATION [date each entry and identify associated pottery pail(s)]:

22 June 04, cont.

- As we appear to be coming down upon a floor, we will switch to other loci with the next pass (prior to going any deeper). The Hatched matrix from the B2301.8 (and the second from B2301.4 that came from just west of wall B2203) represent material that is associated with the floor - thus potentially the pottery/lone brought up as he came upon the floor primarily should be considered associated with the floor's loci, B2302. ← N

23 June 04

Elevations from close of B2301.4, 5

34.37 R14 reading (3.70) H.I. = 358.09

1 (3.09) 354.98	8 (2.915) 355.16
2 (3.08) 354.99	9 (2.782) 355.29
3 (3.085) 354.99	10 (2.765) 355.31
4 (2.85) 355.22	11 (2.725) 355.34
5 (2.925) 355.15	12 (2.605) 355.47
6 (2.80) 355.27	13 (2.76) 355.31
7 (2.84) 355.23	14 (2.827) 355.24
	15 (2.816) 355.25

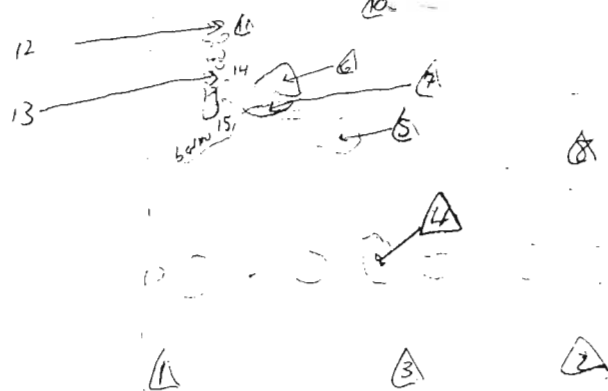
cradler
117 curve

- pail B2301.8 contains loose sherds from the pithos scatter in the NE corner formed by wall B2203 (on the east) and B2304 (on the north)

B2301.9 - wall cleaning @ late date (see next pg.)

Year 2004 Trench/Locus B2301 Excavator ESKA

DESCRIPTION of PROGRESS of EXCAVATION [date each entry and identify associated pottery pail(s)]:

28 June 04

- We are opening a new pail, B2301.9, at this date for a stone removed from atop wall B2203 at the far southern point of it in B2300.

Year 2004 Trench/Locus B2302 Excavator ESKA
 (B2302)

Elevations

Benchmark used:
 Reading on
 Benchmark:
 H.I.:

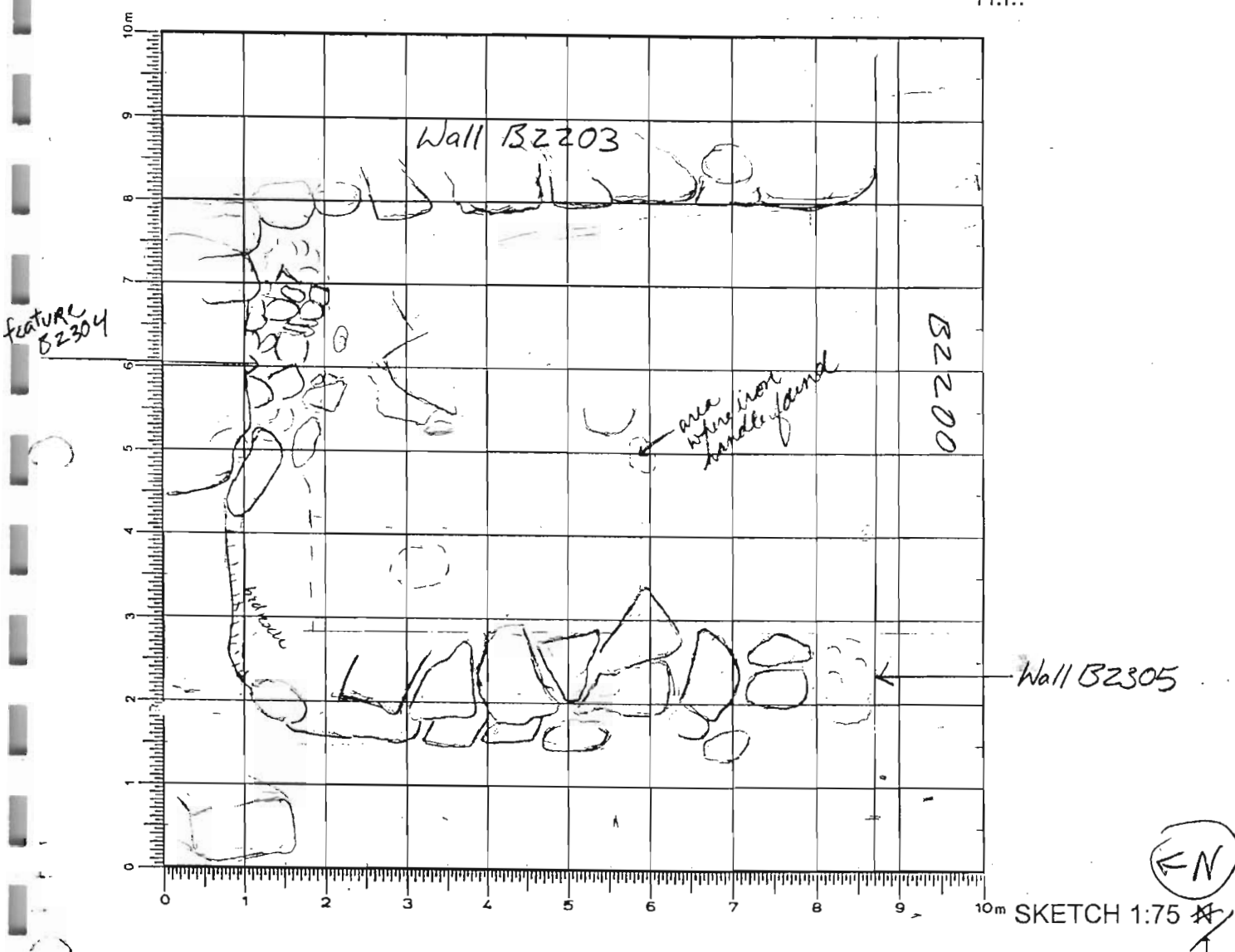

DEFINITION/DESCRIPTION of LOCUS (explain why you changed locus numbers):

Today's date: 22 June 04 Locus above: B2301

Locus parameters: West of wall B2203, east of wall B2305, north of B2200

Verbal description:

Locus Interpretative Comments (What do you think this is? DATE your comments, continue on additional pages if necessary):

Year 2004 Trench/Locus B2302 Excavator ESKA

Locus/Pottery Pail Number	Weight of Sherds	Number of Sherds	Chronology & Comments
B2302.1	0.490 kg	110	Archaic
B2302.2	1.2 0.06 kg	496 35	Geometric - late Geometric, late Geometric, Archaic, th
B2302.3	0.145 kg	1	Archaic
B2302.4	0.80 kg	4	LM III C, Archaic
B2302.5	5.735 kg	204	Archaic
B2302.6	2 ⁵⁴ kg	52	Archaic

OBJECTS

Object Number	Associated Pottery Pail	Identification (material/form)	Location	Elevation	Catalogue Number
1	B2302.1	iron handle			

ADDITIONAL COLLECTED MATERIAL

Locus/Pottery Pail Number	Bones	Shell	Carbon	Pumice	Soil Sample	Other (specify)
B2302.1	2 ^{reg} _{1/4" sc}			1	4 intensive	
B2302.2	2 ^{reg} _{1/4" sc}		2 (long, box)	2 burnt norm	14 intensive	2 sea problems
B2302.3	1 Regular					
B2302.4						

from pit →

Year 2004 Trench/Locus B2302 Excavator ESKA

DESCRIPTION of PROGRESS of EXCAVATION [date each entry and identify associated pottery pair(s)]:

23 June 04

This locus represents the floor that we began to see yesterday with the close of ~~B2301~~ B2301.5. We believe this to be the beginning of the floor which rises in this the ~~the~~ northern portion of what we see as a room or space extending through B2200.

We must consider the fact that a bronze ~~the~~ stand has just come up in B2200 which may be a shared space with B2300.

Our first pass will be shallow, and will begin behind our western wall (probable) B2305 eastward towards wall B2203.

- In order to avoid missing and/or removing anything unintentionally, we are moving VERY slowly with this pass. Tassos is picking through about a square foot of matrix before we store and clean/sweep.

- An iron? handle has come up in this pass. We did NOT see it which Tassos came upon it, however we are stopping and sweeping after each ~~to~~ square foot that Tassos removes and the handle was found in the small pile he created immediately after its removal. Thus, we will be able to get quite an accurate elevation and position due to its controlled removal.

^{354.34} R14 → Reading (3.71) H.I: 358.08
elevation (2.97) 355.11

- 24 June 04

- We are continuing our pass through B2302 with B2302.2

Year 2004 Trench/Locus B2302 Excavator ESKA

DESCRIPTION of PROGRESS of EXCAVATION [date each entry and identify associated pottery pail(s)]:

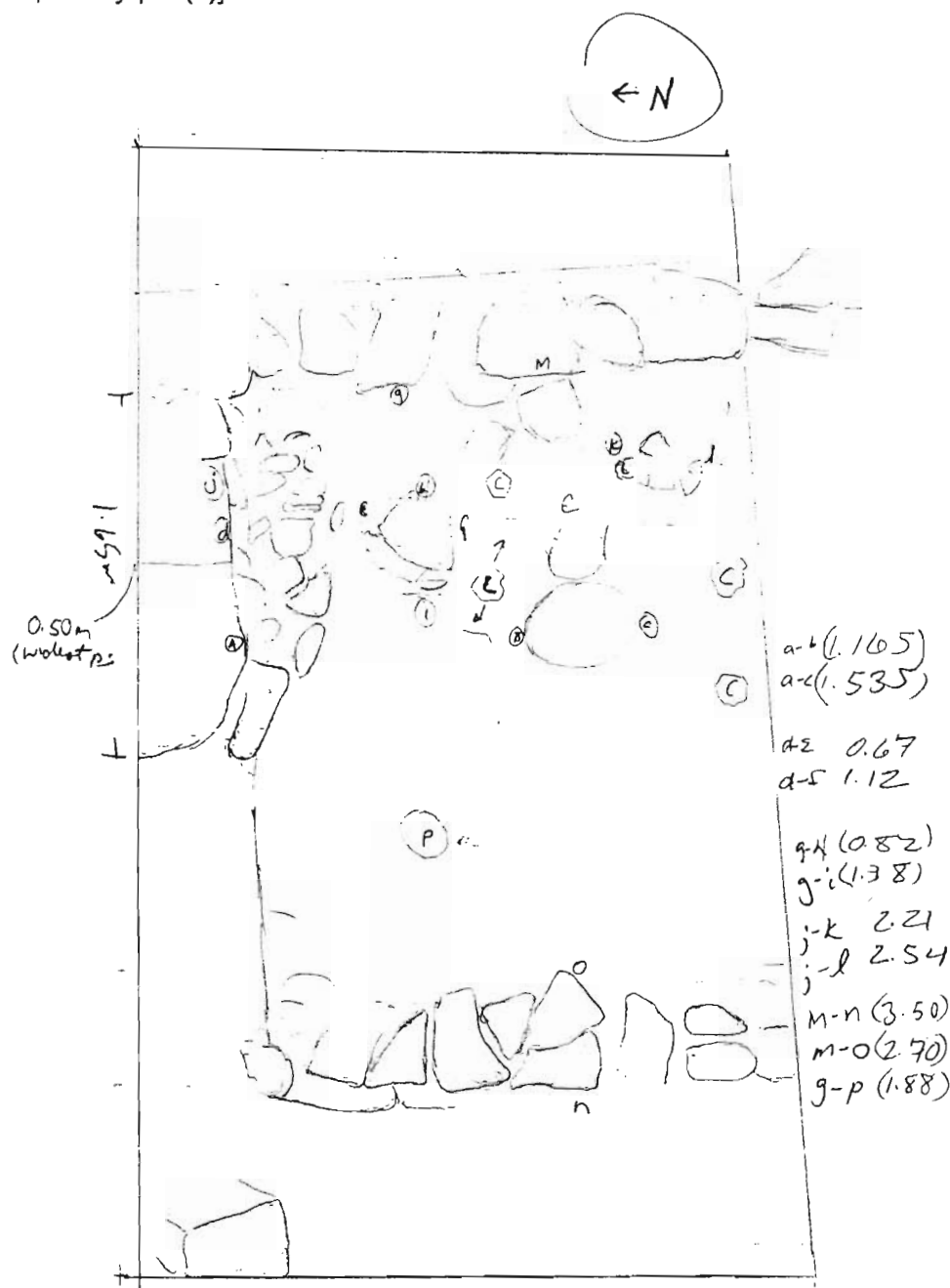

- We have taken intensive soil samples with this pass as we have continued based on any color/texture change. In doing so we have noticed consistently the blackened and reddened burnt matrix - the same as we did with our final pass in B2301.5. See sketch for the location of these samples.

- A small circular ~~stone~~ stone ~~has~~ has been cleaned and pedestaled just east of wall B2305 and south of the bedrock that seems to form the northern/western corner of this wall.

Year 2004 Trench/Locus B2302 Excavator ESKA

DESCRIPTION of PROGRESS of EXCAVATION [date each entry and identify associated pottery/pail(s)]:

24 June 04, cont.

- We have opened a new pail for a loose sherd that came out during sweeping from the small scatter on the southern side of the trench ≈ 0.30 m ~~to~~ west of wall B2203 and approximately 1.0 m east of the column base. This pail is B2302.3
- There is possibly a built feature around (or in the immediate area of) it as one large stone directly to its west and two others (one directly to its east and another directly to its south) have become visible with this pass.

stones
area
col. base



- As Tassas cleaned around the small pot scatter (B2302.3) some bone came from within the pot - this was loose and \therefore collected (see B2302.3 BONE)
- An intensive soil sample was taken from the matrix removed around the pot (not within) this was labelled as intensive soil sample for B2302.2 as it was from around the pot.
- Cleaning of the stones directly SE of the column base has revealed a grouping that may be a built feature. An intensive soil sample was taken from this small ring of rocks. The matrix looked burnt and blackish red
- a significant amount of carbon has been collected from the small area just south of the large pithos scatter and north of the stone sitting directly east of the column base

Year 2004 Trench/Locus B2302 Excavator ESKA

DESCRIPTION of PROGRESS of EXCAVATION [date each entry and identify associated pottery pail(s)]:

- As the SE corner was cleared we noticed a significant amount of carbon in the blackened / reddened matrix and took an intensive soil sample from the area.
- In this SE corner, a line of stones running N-S up into the bedrock (running E-W at this point from wall B2203 in the east)
- Pandelis in Sheri's trench has now uncovered two stones that appear to close off this area on the southern side. We will now treat this as a feature, a bin/bench, with its own locus # B2306

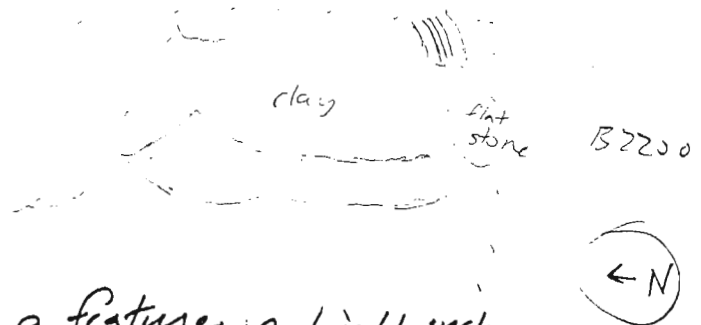

- We are taking another intensive soil sample from the area just east of the last (which was from directly south of the large pithos scatter) as the burnt matrix filled with carbon ~~and~~ extends east in the direction of the wall B2203 onto the bedrock located there
- A small piece of burnt pumice was found while removing matrix from atop the bedrock that extends ~~from~~ westward from wall B2203



- The matrix moving around to the directly NE of the large pithos scatter is continuing to be very blackened. We are taking another intensive soil sample from this area.
- A pithos sherd from the large pithos scatter just was removed during sweeping as it was loose and precarious. It was located east of the main scatter behind a fallen rock. This sherd was given pail # B2302.4

Year 2004 Trench/Locus B2302 Excavator ESKA

DESCRIPTION of PROGRESS of EXCAVATION [date each entry and identify associated pottery pail(s)]:

24 June 04

sherd removed from large pithos scatter

removed 24 June 04
linear
stratification
on site
facing
south

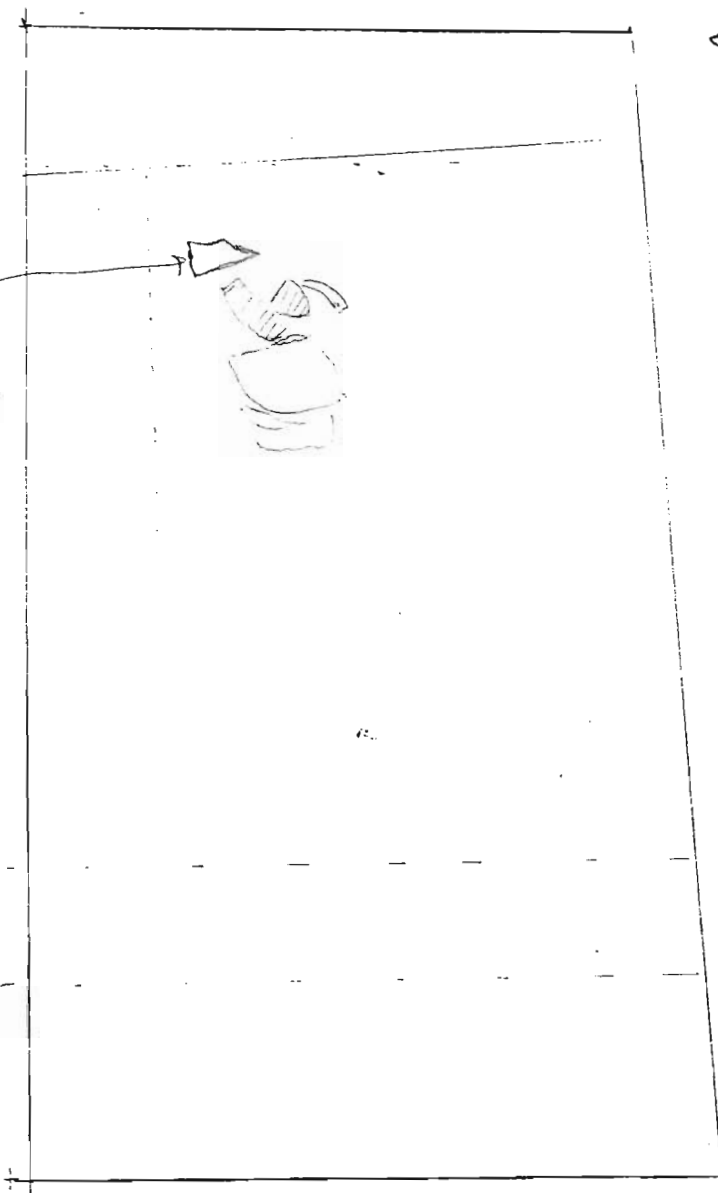

Year 2004 Trench/Locus BZ302 Excavator ESKA

DESCRIPTION of PROGRESS of EXCAVATION [date each entry and identify associated pottery pail(s)]:

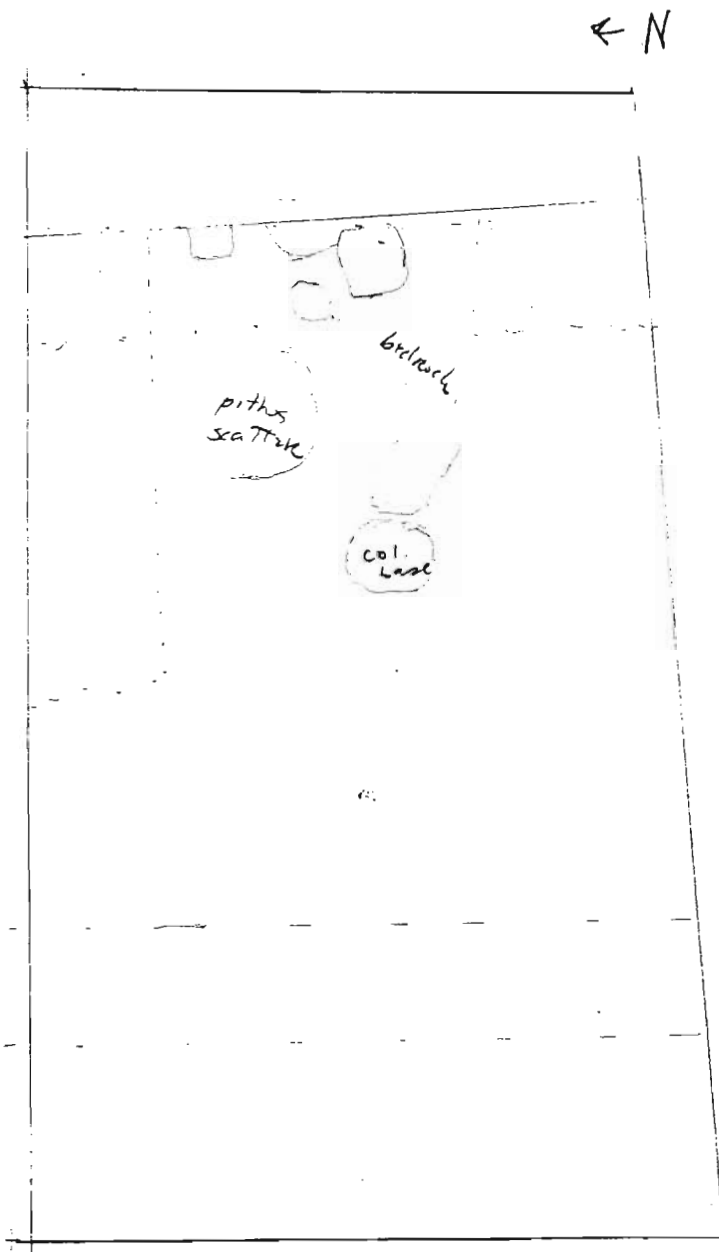

- a couple other shards from the large pithos ^{scatter} ~~shards~~ (from the eastern side) came loose while removing fallen stones from atop it - these were included in pail BZ302.4
- a ~~sea~~ pebble had come up from the small area between the large pithos scatter and the wall to its north

Year 2004 Trench/Locus B2302 Excavator ESKA

DESCRIPTION of PROGRESS of EXCAVATION [date each entry and identify associated pottery pail(s)]:

24 June 04

Intensive Soil Samples Taken for B2302

"c" = carbon in soil

← N

← N

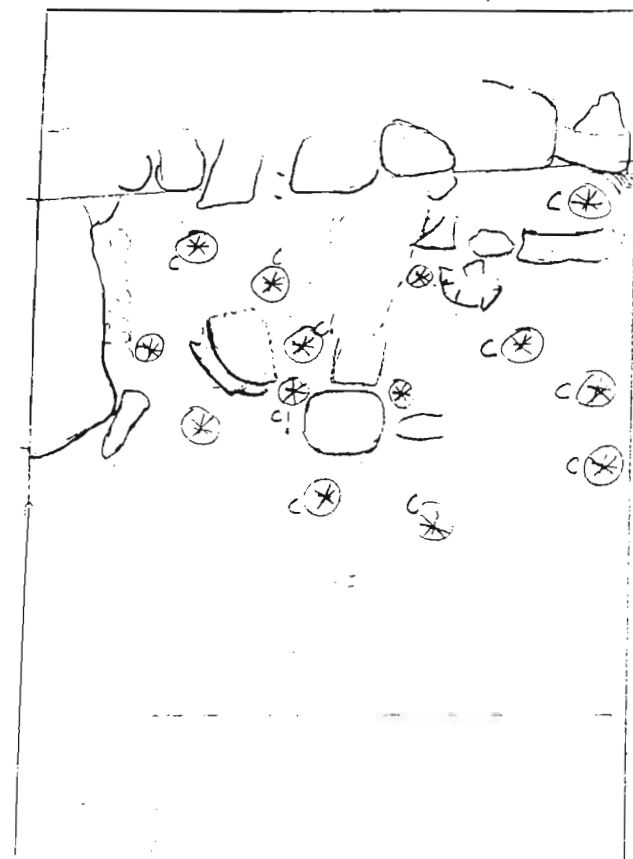

Year 2004 Trench/Locus B2302 Excavator ESKA

DESCRIPTION of PROGRESS of EXCAVATION [date each entry and identify associated pottery pail(s)]:

25 June 04

354.37

RI4 (4.55), HI: 358.92

Elevations for close B2302.2

(lowest edge)
 19 (3.73) 355.19
 20 (3.66) 355.26
 21 (3.70) 355.22
 22 (3.65) 355.27
 23 (3.69) 355.23
 24 (3.62) 355.30
 25 (3.64) 355.28
 26 (3.62) 355.30
 27 (3.76) 355.16
 28 (3.42) 355.50
 29 (3.54) 355.38
 30 (3.04) 355.88
 31 (3.12) 355.80
 32 (2.83) 356.09
 33 (2.95) 356.17
 34 (2.87) 356.05

(pt. from
 surface)
 31
 30
 29
 28
 27
 26
 25
 24
 23
 22
 21
 20
 19
 18
 17
 16
 15
 14
 13
 12
 11
 10
 9
 8
 7
 6
 5
 4
 3
 2
 1

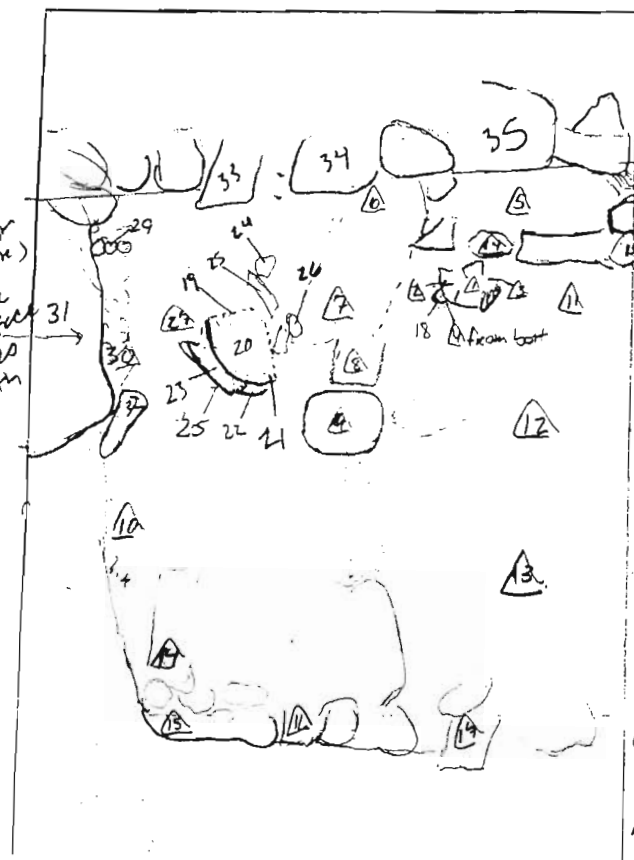

POT SCATTER

1 (3.75) 355.17

2 (3.70) 355.22

3 (3.75) 355.17

4 (3.79) 355.13

from bott

18 (3.71) handle 355.21

bin

5 (3.71) 355.21

14 (3.68) 355.24

15 (3.63) 355.29

6

7

8

col base: 9

10

11 (3.76) 355.16

12 (3.79) 355.13

13 (3.83) 355.09

14 (3.69) 355.23

15 (3.89) 355.03

16 (3.88) 355.04

17 (4.06) 354.86

- After the completion of
 2302.2 we are taking
 elevations and measurements.

- Tassos is helping Sheki, Will
 is with him.



B2302.6
 first to be
 removed,
 matrix below
 collected

← N

sheep down for
 photos

Year 2004 Trench/Locus B2302 Excavator ESKA

DESCRIPTION of PROGRESS of EXCAVATION [date each entry and identify associated pottery pail(s)]:

25 June 04, cont. . .

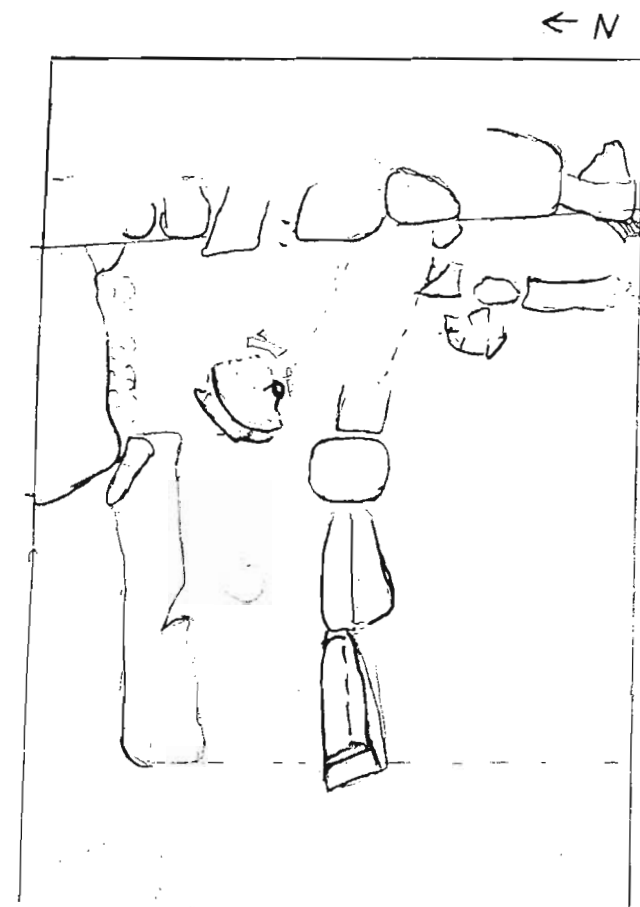

- At this point I am dividing the spaces north and south of the line of bedrock, stones and the column base that run E-W through our trench into 2 separate loci: North = B2307, South = B2308

With pass B2307.1 ~~B2307.1~~ we are slowly moving through the northern portion of the trench north of the column base and south of B2304 and the bedrock forming a corner with wall B2305 that is adjacent to and west of B2304.

~~Prior to this~~ Prior to this pass we will begin removing the pithos scatter in the NE corner formed by B2304 and wall B2203. - This will be in pail B2302.5 as it was found in the last locus.

- We will first remove the central area which is a large portion of the body with a handle base, the exterior of the wall facing up. The matrix resting below these sherds, as it may represent some of the contents of the vessel, will be collected for intensive soil sample B2302.6 "from within pithos scatter"

- The matrix from beneath the top level of sherds removed (and within the contours of the remaining ones) does appear to be darker and finer

Year 2004 Trench/Locus B2302 Excavator ESKA

DESCRIPTION of PROGRESS of EXCAVATION [date each entry and identify associated pottery pail(s)]:

25 June 04 cont.

- The intensive soil sample taken from within the pithos scatter is being brought down in two bags ^{100% brought down}
- A finer group of sherds has come up from within the matrix & within the pithos scatter } B2302.6
- A third intensive soil sample is being taken from the outer ring of the pithos scatter - as the pithos was thoroughly smashed, this matrix could still represent some of the contents of the vessel
- a small sheep or goat bone came up from w/ in the ring of the pithos scatter
- a significant amount of burnt black/red matrix has come up as the southern portion of the outer ring of the pithos scatter has been removed. This is the same area where two intensive soil samples were taken yesterday due to markedly burnt matrix being come upon.
- What appears to be a piece of the pithos scatter - perhaps the base, has been exposed with the removal of the higher sherds, yet will not be removed itself until the next pass, B2307.1
- This was instead included in this pail. It was not in fact a fragment from the pithos, but from the finer group of sherds found while removing the pithos scatter (see B2302.6)

Elevations

Reading on

Benchmark:

H.I.:

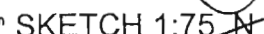

Today's date: 23 June 04 Locus above: B2301

Locus parameters: *Nest of wall B2203 and B2302; continuing south into B2200*

Verbal description:

B2305 Appears to be the west wall of the area of B2302 - B2303 represents the area west of this wall within the boundaries of B2300

Locus Interpretative Comments (What do you think this is? DATE your comments, continue on additional pages if necessary):

[illegible]

OBJECTS

[illegible]

ADDITIONAL COLLECTED MATERIAL

[illegible]

Year 2007 Trench/Locus B2303 Excavator ESKA

DESCRIPTION of PROGRESS of EXCAVATION [date each entry and identify associated pottery pail(s)]:

23 June 04

We are beginning a new pass with a new locus at the bottom (west) end of our trench. The matrix here appears to be markedly different from the compact clay matrix we were finding further east. We will still screen everything at this point as we believe we have hit floor level further east. Yet we expect a great deal of contamination. ← N

↑ B2303.1 ↓

- a ssa problem has just come up with in this pass
- since the matrix here is so rough and rocky, we have decided not to continue screening
- a line of stones, running through both our trench and B2200, could potentially be a western wall for this area, set further east than the west wall in B1500 and B700.
- This line of stones is acting as our eastern boundary for this pass.
- in the NW corner we are extending this pass further east as we are atop bedrock and thus are not encountering the compacted clay of B2302.

Year 2004 Trench/Locus B2303 Excavator ESKA

DESCRIPTION of PROGRESS of EXCAVATION [date each entry and identify associated pottery pile(s)]:

23 June 04

- a significant amount of bone has come up in this small pass including a small concentration of pig bones just west of the large rock along the mid north side.



- Pail B2303.2 is a pail opened below the extension of pass B2303.1 ^{along} the northern border east up to the large rock in its mid-see sketch. We switched pails because we were going.

354.34-214 (3.72) HI: 358.09

Elevations for close of B2303.1 and 2

1 (3.19) 354.90

2 (3.16) 354.93

3 (3.17) 354.92

4 (2.49) 355.10

5 (2.86) 355.23

6 (3.14) 354.95

7 (3.13) 354.96

8 (3.14) 354.95

9 (3.10) 354.99

10 (2.85) 355.24

- We are taking another pass in B2303, only through the area west of wall B2305 and not to the area north of the wall where it appears to have a corner turning east into the bedrock. This is pail B2303.3

Year 2004 Trench/Locus B2303 Excavator ESLA

DESCRIPTION of PROGRESS of EXCAVATION [date each entry and identify associated pottery pail(s)]:

23 June 04, cont...

- we are taking a standard soil sample ~~is being taken~~
with this pass

- Wall B2305 has become cleaner with the completion

of B2303.3

- It appears that B2305 bends at its northern
limit in B2300 turning eastward into the
bedrock

Year 2004 Trench/Locus B2304 Excavator ESK A Elevations

Benchmark used:
Reading on
Benchmark:
H.I.:

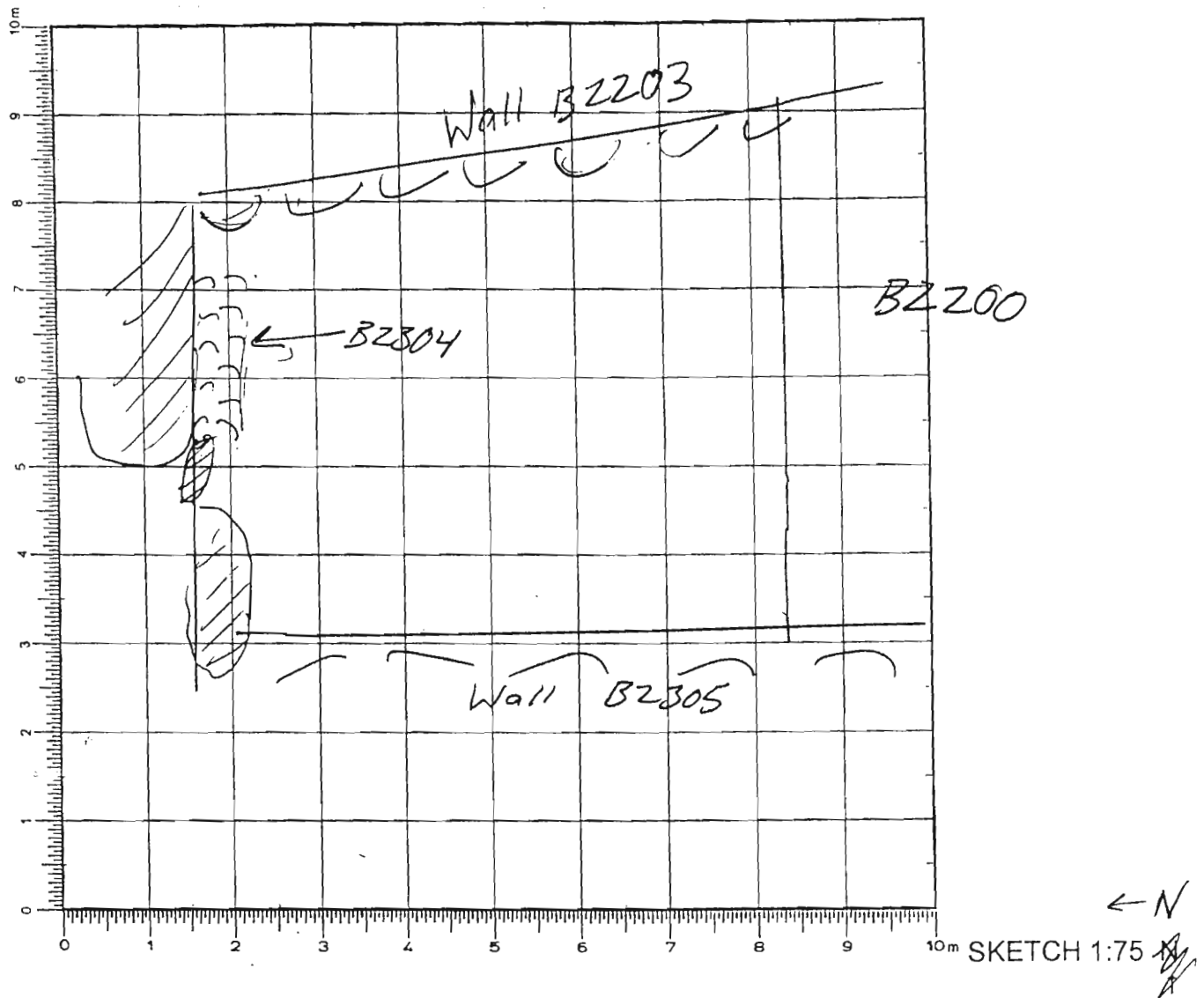

DEFINITION/DESCRIPTION of LOCUS (explain why you changed locus numbers):

Today's date: 22 June 04 Locus above: B2301.7

Locus parameters: along northern boundary of B2300 just west of Wall B2203

Verbal description:

Found within pass B2301.7

This appears to be a small platform/bench

Locus Interpretative Comments (What do you think this is? DATE your comments, continue on additional pages if necessary):

Year

Trench/Locus

Excavator

[illegible]

OBJECTS

[illegible]

ADDITONAL COLLECTED MATERIAL

[illegible]

Year 2004 Trench/Locus B2305 Excavator ESKA

Elevations

Benchmark used:

Reading on

Benchmark:

H.I.:

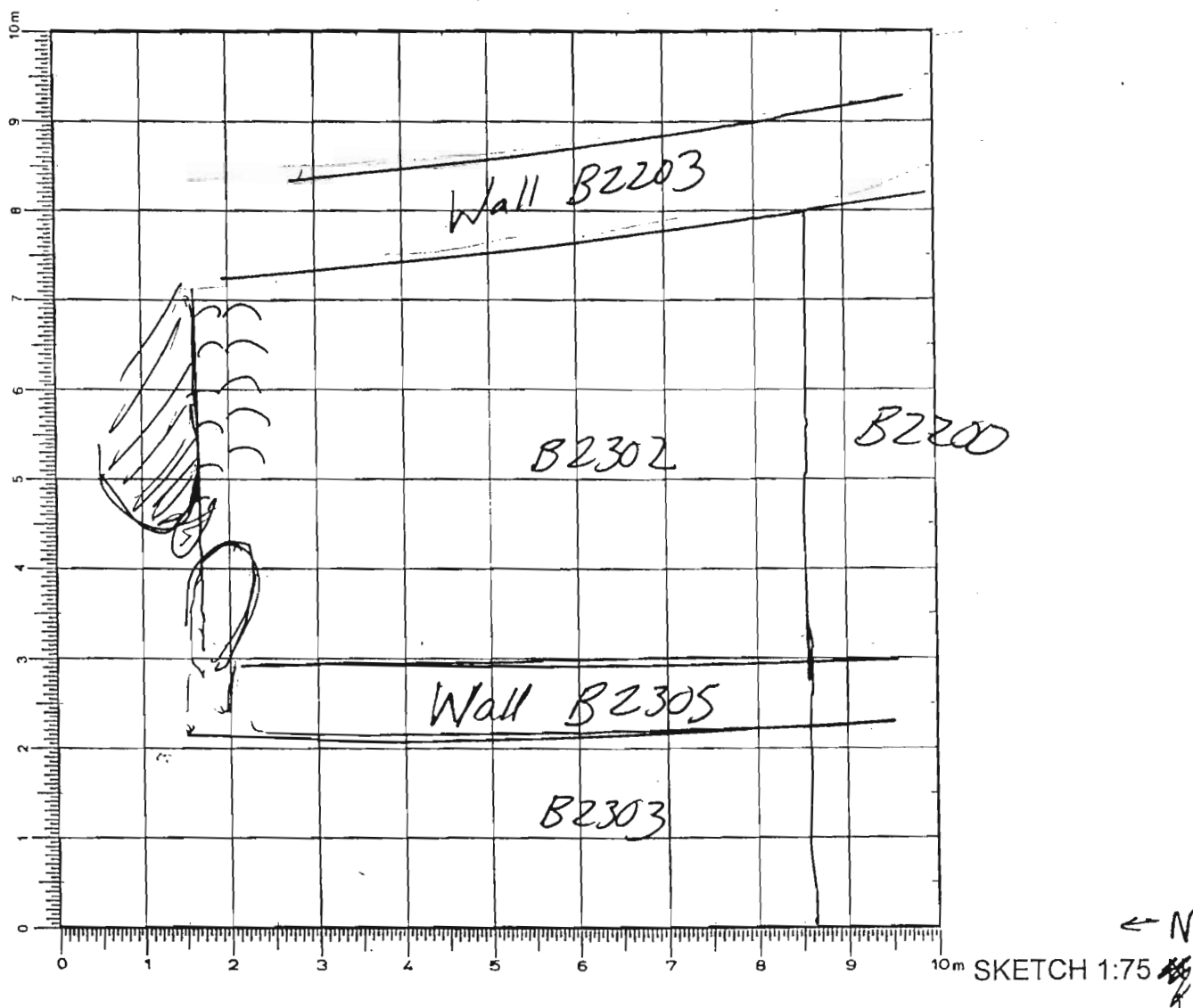

DEFINITION/DESCRIPTION of LOCUS (explain why you changed locus numbers):

Today's date: 23 June 04 Locus above: B2301.4Locus parameters: Western portion of B2300, ~ 1.2m east of the ~~middle~~ western boundary. Turns corner and runs eastward before reachingVerbal description: northern wall of B2300 and continues south into B2206Western wall of the area of B2302

Locus Interpretative Comments (What do you think this is? DATE your comments, continue on additional pages if necessary):

p.2

()

doi:10.1371/journal.pone.0142002.g002

[illegible]

Year 2004 Trench/Locus B2305 Excavator ESKA

DESCRIPTION of PROGRESS of EXCAVATION [date each entry and identify associated pottery pail(s)]:

23 June 04

The stones of this wall - the highest - were exposed during pass B2301.4. The wall however was defined with B2303.1-3

- 25 June 04

Pail B2305.1 was opened for cleaning of the wall following the removal of some tumbled stones from atop it

Year 2004 Trench/Locus B2306 Excavator ESKAElevations

Benchmark used:

Reading on

Benchmark:

H.I.:

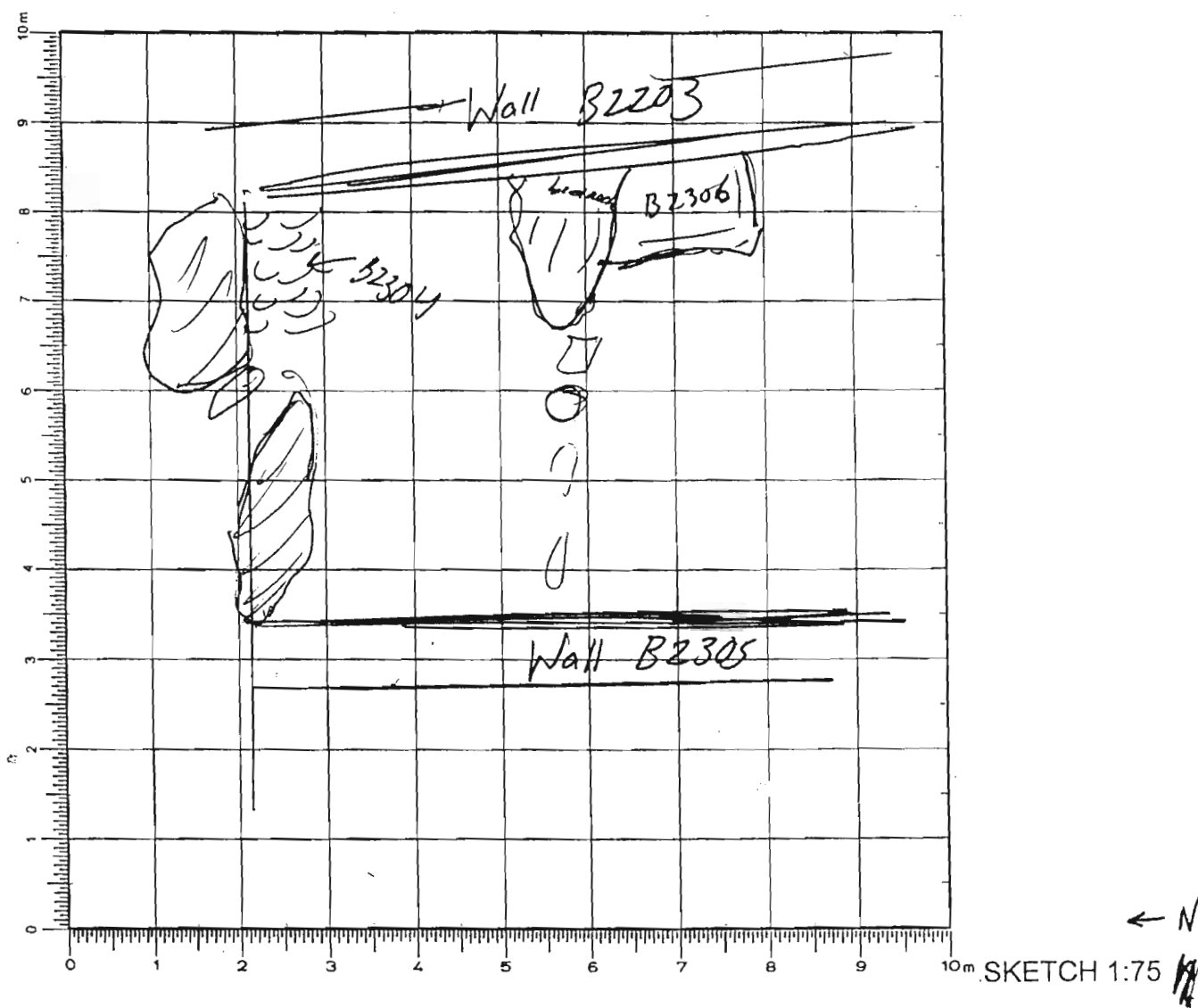

DEFINITION/DESCRIPTION of LOCUS (explain why you changed locus numbers):

Today's date: 25 June 04 Locus above: B2302Locus parameters: SE corner of trench B2300, southern portion
partially within trench B2200

Verbal description:

This appears to be a small platform enclosed by two perpendicular lines of stones on the west and south, ~~and~~ by bedrock on the north, and wall B2203 on the east. A clay surface makes up the area amidst

Locus Interpretative Comments (What do you think this is? DATE your comments, continue on additional pages if necessary):

Year 2004 Trench/Locus B2306 Excavator ESKA

DESCRIPTION of PROGRESS of EXCAVATION [date each entry and identify associated pottery pail(s)]:

24 June 04

- The small bench in the SE corner of TRENCH B2300 was discovered during pass B2302.2 ← N

17.5cm

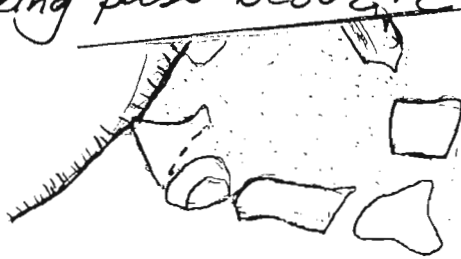

- The interior seems to be surfaced w/ clay.

- On the north the protrusion of bedrock (which stretches westward from wall B2203) is used as ~~a~~ a wall. On the west and south a line of stones encloses the space.

- On the east wall B2203 forms the wall of the bench.

~~ESKA~~

Year 2004 Trench/Locus B2306 Excavator ESKA

DESCRIPTION of PROGRESS of EXCAVATION [date each entry and identify associated pottery pail(s)]:

28 June 04

- pail B2306.1 is being opened for the removal of the large pithos sherd ^{354.77} R14(3.646), H.I. 358.02
 poised just above the level of the bench and set against wall B2203. This is to be considered separately from the level of the bench (see elevation #3)

355.46 - 1 (2.557)

355.29 - 2 (2.733)

355.22 - 3 (2.802)

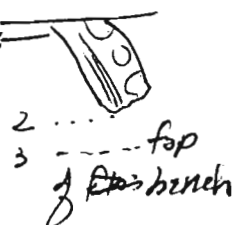

- We are not screening the soil from this pail as there is only $\approx 1/8$ of a zembili full

- a very shallow pass essentially just scraping the clay surface (2-3cm deep) through the matrix at the top most level of the bench will have pail # B2306.2
- All of the matrix from this will be collected as an intensive soil sample. The sherds we find in this pass will simply be removed + collected.
- as the matrix is being removed it consists of both a creamy color and the blackened/reddish burnt matrix
- This soil sample, B2306.2, is coming down in ~~the~~ ^{three} bags ① + ② + ③

Year 2004 Trench/Locus B2307 Excavator ESKA

Elevations

Benchmark used:

Reading on

Benchmark:

H.I.:

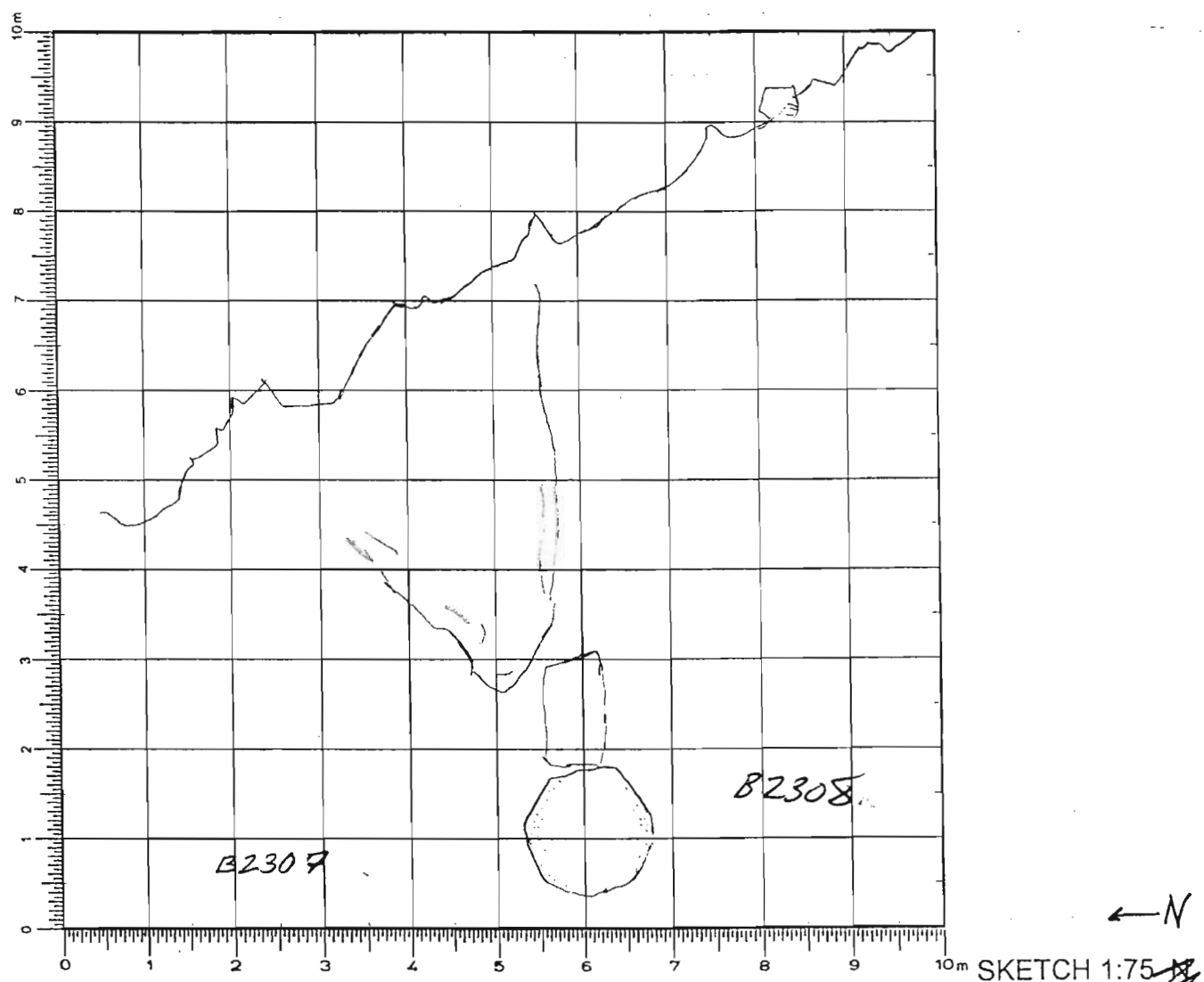

DEFINITION/DESCRIPTION of LOCUS (explain why you changed locus numbers):

Today's date: 25 June 04 Locus above: B2302

Locus parameters: west of wall B2203, north of B2304 (and the bedrock adjacent and west of B2304) east of wall B2305, and north of the line of stones running E-W through the center of B2302.

Verbal description:

Locus Interpretative Comments (What do you think this is? DATE your comments, continue on additional pages if necessary):

Year 2004 Trench/Locus BZ307 Excavator ESKA

DESCRIPTION of PROGRESS of EXCAVATION [date each entry and identify associated pottery pail(s)]:

25 June 04

← N

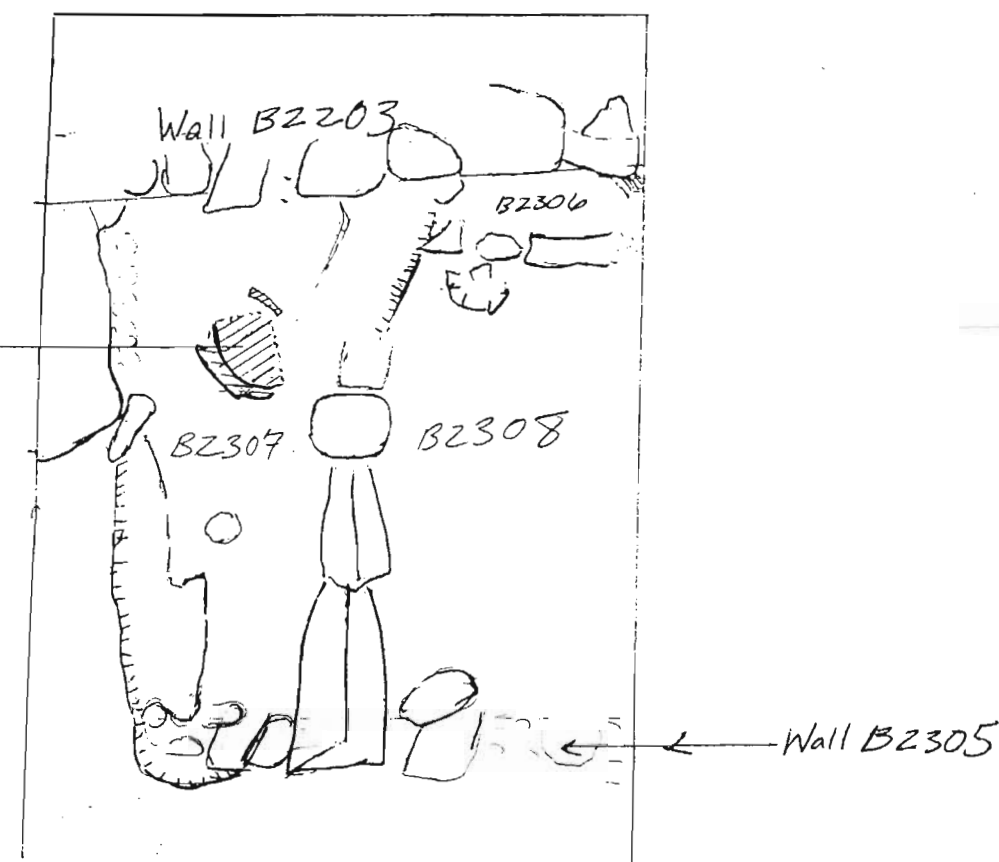

— This pass was begun in the NW corner, just north of BZ305. However, we were unable to find the floor with any clarity here (perhaps due to downslope erosion and/or to the presence of wall B2305 directly to its west which may have increased the level of wash confusion in this area as material was caught). We then returned to the area further east where the pithos scatter had just been removed and used the level of the deepest sherds uncovered in pass BZ302.5 to guide us to the floor's level, which we found, with the expert help of Peggy, 4 cm below. The layer overlying the floor was quite darkened clay including some pebbles. Also, there was a marked amount of reddish-orange discoloration in the matrix, likely the result of bedrock erosion in this vicinity.

Year 2001 Trench/Locus B2307 Excavator ESKA

DESCRIPTION of PROGRESS of EXCAVATION [date each entry and identify associated pottery pair(s)]:

28 June 04

- We are beginning by completing the pass we had begun Friday afternoon (B2307.1) with B2307.2
- We are coming down through the same burnt layer (blackish and red - the red probably from eroded bedrock). This pass is about 4-5cm deep. The matrix is quite gravelly, especially as we work into the NE corner against wall B2203 where some of the stones are fist-sized
- Some of the limestone bedrock has been knocked with this and ~~has~~ its white color
- Intensive soil samples from this pass represent one from the line of ~~pass~~ if stretched N-S) from the end of the bedrock. The second, a very gravelly matrix, came from just against (and west of) wall B2203
- In some areas the gravelly packing below the floor has been exposed as we are atop bedrock and the floor difficult to find

Year 2004 Trench/Locus B2308 Excavator ESKA**Elevations**

Benchmark used:

Reading on

Benchmark:

H.I.:

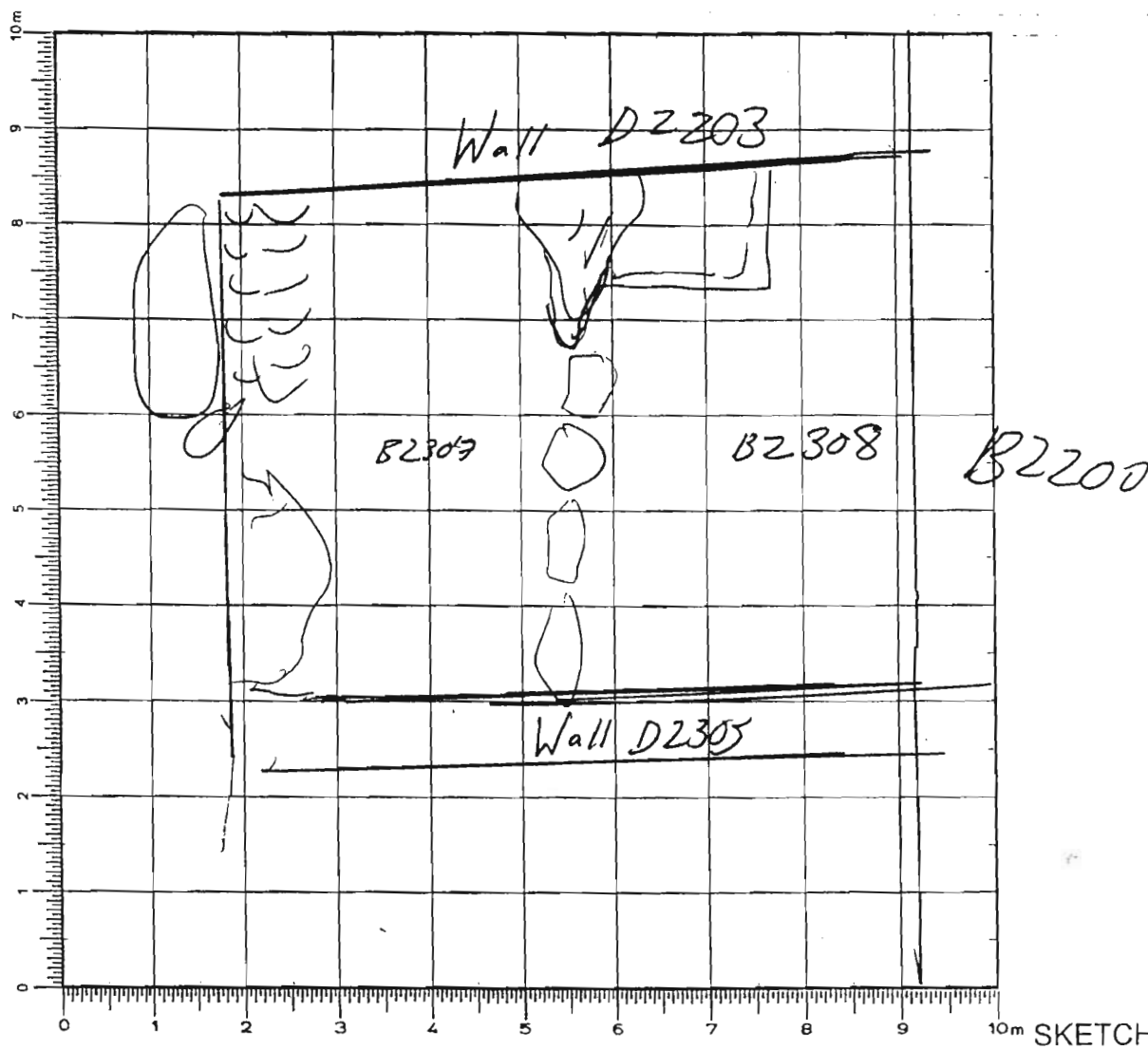
DEFINITION/DESCRIPTION of LOCUS (explain **why** you changed locus numbers):Today's date: 25 June 04 Locus above: B2302

Locus parameters:

Verbal description:

Locus Interpretative Comments (What do you think this is? DATE your comments, continue on additional pages if necessary):

[illegible]

OBJECTS

[illegible]

ADDITIONAL COLLECTED MATERIAL

[illegible]

Year 2004 Trench/Locus B2308 Excavator ESKA

DESCRIPTION of PROGRESS of EXCAVATION [date each entry and identify associated pottery pair(s)]:

← N

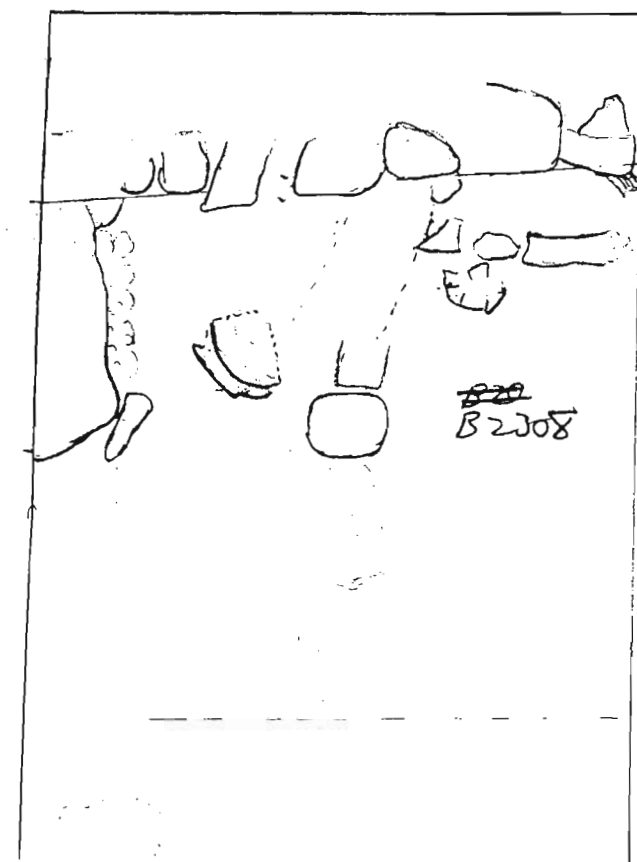

Year 2004 Trench/Locus B2308 Excavator ESK-A

DESCRIPTION of PROGRESS of EXCAVATION [date each entry and identify associated pottery pail(s)]:

28 June 04 B2308.1

We are beginning in this locus with Donald helping us to find the floor from along the southern edge of the trench just south of the column base. Here we had ²apithos scatterings resting upon the floor in B2200 and the surface between the two as our guide. The pass is between 4cm - 5.5cm deep - the roofing clay^{ing} that we are removing is composed of cream chunks as well the black and red burnt matrix we were encountering in B2307. The floor surface below is also whitish and compact.

- Just south of the column base and along the southern edge of the trench an ^①intensive soil sample was taken when a concentration of carbon-rich matrix was encountered.
- Moving further east, another ^②intensive soil sample was taken just west of the SW corner of the small bench - this is also just north of the round flattened stone sitting on the northern edge of trench B2200
- In this area, just between the the round stone in B2200 and the ^{SW} corner of our bench, we have met Pandelis who is working down to the same floor in B2200 - we are @ the same level!
- Our bench (B2306) is becoming more defined with this pass.
- The corner of a stone that appears to be square has been exposed south of the column base, & in line with another sitting in their midst
- An ^③intensive soil sample has been taken just west of the bench and just south of the pot scatter as it was a darkened matrix.
- The rounded body sherd of a pot(?) has been exposed just to the SW of the pot scatter - it may be associated

Year 2004 Trench/Locus BZ308 Excavator ESKA

DESCRIPTION of PROGRESS of EXCAVATION [date each entry and identify associated pottery pail(s)]:

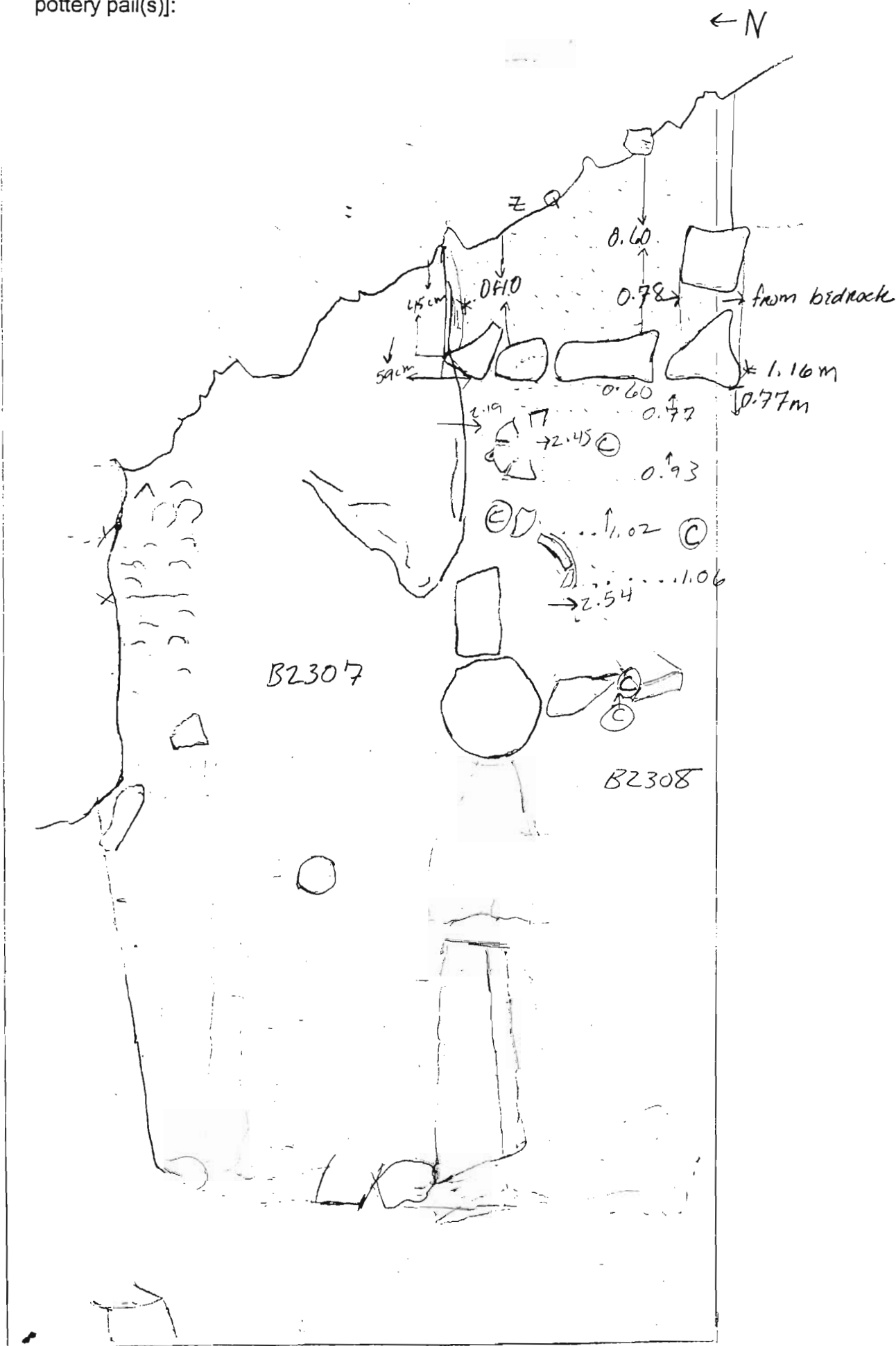

Year 2004 Trench/Locus B2308 Excavator ESKA

DESCRIPTION of PROGRESS of EXCAVATION [date each entry and identify associated pottery pail(s)]:

28 June 04

- an ^④ intensive soil sample has been taken from just north of the squared off stone - the second in line running south from the column base. The matrix was blackish with some carbon
- another ^⑤ intensive soil sample has been taken from just NW of the pot scatter and just south of the bedrock that extends westward from Wall B2203 into our trench
- another sherd, possibly associated with the pot scatter, has been exposed immediately west of it and immediately north of the new pot (or @ least part of one) discovered in this pass
- We will be removing the pot scatter as a separate pail B2308.2

354.37 ^{HZ. 358.02} R14 (3.649) Elevations for pot scatter!

- on matrix w/in
- 1 (2.805) 355.22
 - 2 (2.847) 355.17
 - 3 (2.879) 355.14
 - 4 (2.949) 355.07
 - 5 (2.928) 355.09
 - 6 (2.907) 355.11
 - 7 (2.882) 355.14
 - 8 (2.923) 355.10
 - 9 (2.873) 355.15
 - 10 (2.883) 355.14

- We are removing the matrix from within the pot scatter separately as an intensive sample for pail B2308.2

We will attempt to leave the body and base intact below for Rod to draw

Tassas did this successfully

- another long sherd, possibly from the pot's base, is in the matrix below the pot - this is probably in fact

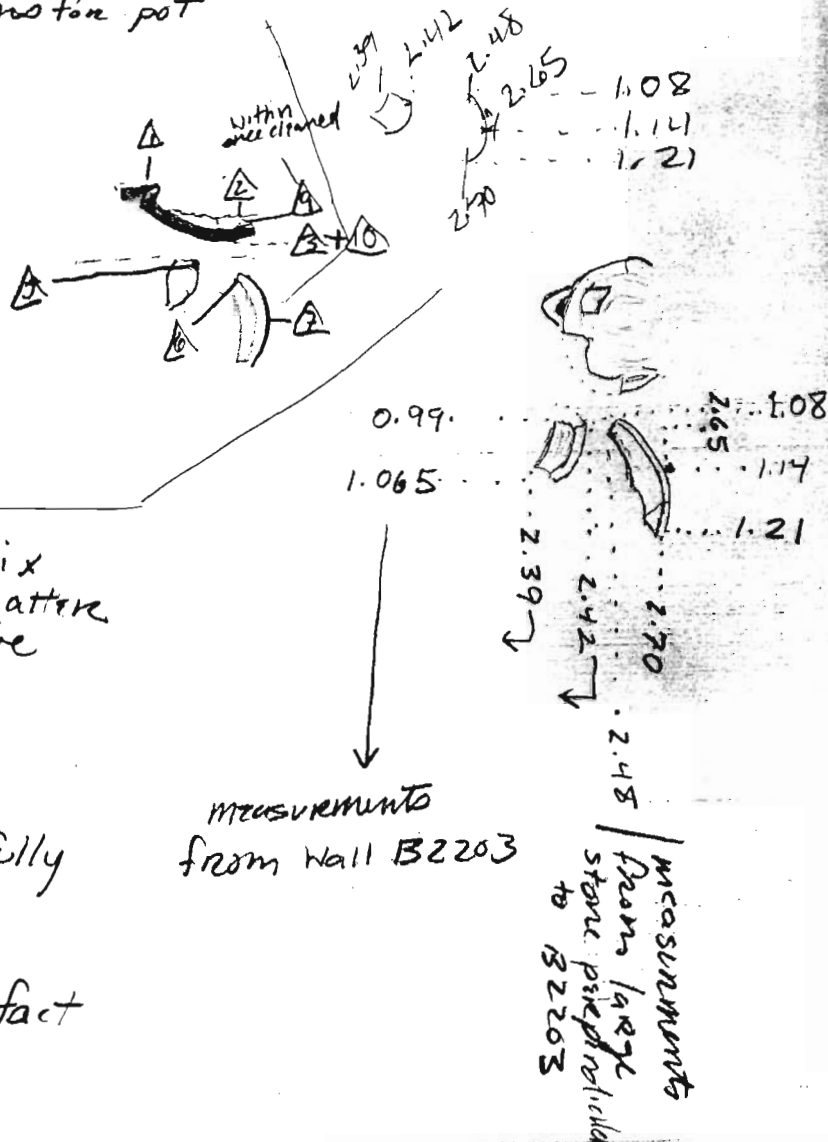

Year 2004 Trench/Locus B2308 Excavator ESKA

DESCRIPTION of PROGRESS of EXCAVATION [date each entry and identify associated pottery pail(s)]:

28 June 04, cont. . .

- We have pedestaled the pot scatter (the eastern-most portion that is highest) and are leaving it for now so that Rod can draw it now that it is cleaned and that we have found the two other pieces of it just west of the original portion discovered.
- We are continuing our pass, B2308.1, ~~from~~^{at} the western end, just east of wall B2305
- moving north here, approaching the line of stones that runs ~~to~~ E-W through the center of our trench, the soil began to become ~~red~~ reddened again as it had in the NE corner of B2307 as we came upon eroded bedrock. We have then come upon the same gravelly reddened matrix of this eroded rock here, and have not continued the pass through it as clearly the floor would have run up to or atop this bedrock. It seems that 'the line of stones' was built atop the bedrock in this area, where the bedrock is lower than it is along the line in the east ~~to~~ out from wall B2303.
- ⑥ - Intensive soil sample was taken when this reddened eroded matrix was encountered.
- We are now continuing by completing the removal of the pot scatter w/ the rest of B2308.2
- All 3 portions are being removed together
- We are screening the matrix that pedestaled the pot scatter as part of pail B2308.2 - this however should be considerably separate from the matrix of the intensive soil sample that was collected from within the pot scatter.

Year 2004 Trench/Locus B2308Excavator ESKA

DESCRIPTION of PROGRESS of EXCAVATION [date each entry and identify associated pottery pail(s)]:

Closing elevations for B2300

← N

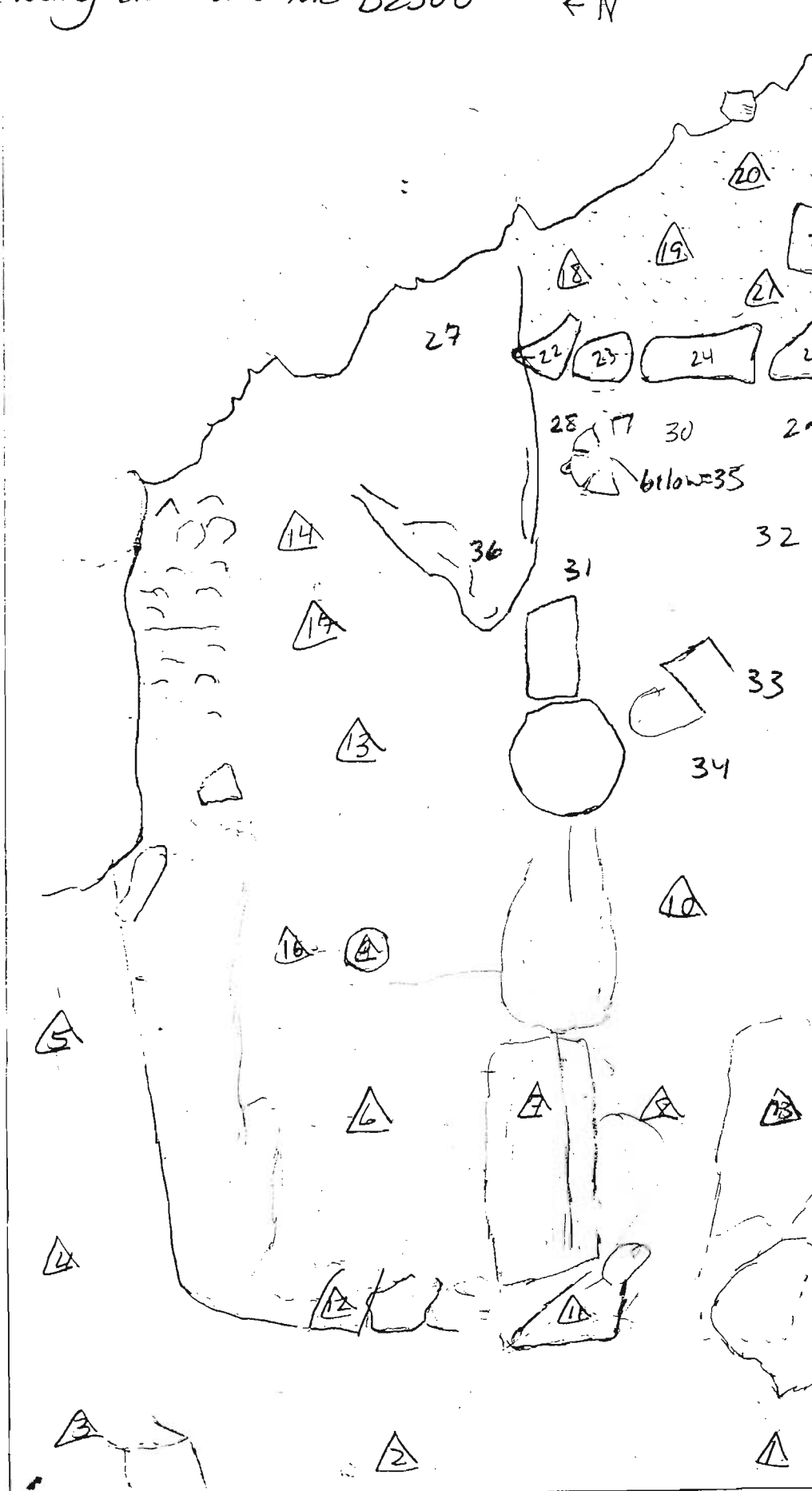
354.37 R14(3.645)
H.I.: 358.015

- 27 (2.676) 355.34
 28 (2.937) 355.08
 29 (2.927) 355.09
 30 (2.931) 355.08
 31 (2.953) 355.06
 32 (2.942) 355.07
 33 (2.945) 355.07
 34 (2.935) 355.08
 35 (2.956) 355.06
 36 (3.802) 354.21
 1 (3.182) 354.83
 2 (3.209) 354.81
 3 (3.104) 354.91
 4 (3.053) 354.96
 5 (3.027) 354.99
 6 (3.022) 354.99
 7 (2.898) 355.12
 8 (2.999) 355.02
 9 (2.702) 355.31
 10 (2.963) 355.05
 11 (3.148) 354.87
 12 (2.979) 355.04
 13 (2.893) 355.12
 14 (2.914) 355.10
 15
 16 (2.888) 355.13
 17 (2.902) 355.11
 18 (2.829) 355.19
 19 (2.839) 355.18
 20 (2.822) 355.17
 21 (2.824) 355.191
 22 (2.742) 355.27
 23 (2.765) 355.25
 24 (2.773) 355.24
 25 (2.737) 355.28
 26 (2.760) 355.26